



US00D388637S

# United States Patent [19]

Kelley et al.

[11] Patent Number: **Des. 388,637**

[45] Date of Patent: **\*\*Jan. 6, 1998**

[54] **WORK STATION**

[75] Inventors: **James O. Kelley**, Spring Lake;  
**Michael D. Warren**, Grand Rapids,  
both of Mich.

[73] Assignee: **Sligh Furniture Company**, Holland,  
Mich.

[\*\*] Term: **14 Years**

[21] Appl. No.: **61,065**

[22] Filed: **Sep. 3, 1996**

[51] LOC (6) Cl. .... **06-04**

[52] U.S. Cl. .... **D6/439; D6/425**

[58] Field of Search ..... D6/422-428, 429-431,  
D6/432-448, 396, 397; 312/204, 257, 194-196

[56] **References Cited**

**U.S. PATENT DOCUMENTS**

D. 180,094	4/1957	Miller	.....	D6/425
D. 356,220	3/1995	Belisle	.....	D6/446
D. 357,599	4/1995	Kelley	.....	D6/439
D. 363,835	11/1995	Paus	.....	D6/439

D. 364,756	12/1995	Felber	.....	D6/425 X
D. 370,797	6/1996	Miller	.....	D6/436
D. 376,491	12/1996	Kelley	.....	D6/439
D. 376,496	12/1996	Kelley et al.	.....	D6/446
D. 377,281	1/1997	McFarlane	.....	D6/446

*Primary Examiner*—Carmen H. Vales-Lado  
*Attorney, Agent, or Firm*—Waters & Morse, P.C.

[57] **CLAIM**

The ornamental design for a work station, as shown and described.

**DESCRIPTION**

FIG. 1 is a front perspective view of a work station showing our new design;  
FIG. 2 is a perspective view with the doors in open position;  
FIG. 3 is a perspective view of FIG. 2 with the drawers and pull-out ledge in extended position;  
FIG. 4 is a front elevational view of FIG. 1;  
FIG. 5 is a right side elevational view, the left side being a mirror image thereof;  
FIG. 6 is a top plan view thereof; and,  
FIG. 7 is a front elevational view of FIG. 2.

**1 Claim, 4 Drawing Sheets**

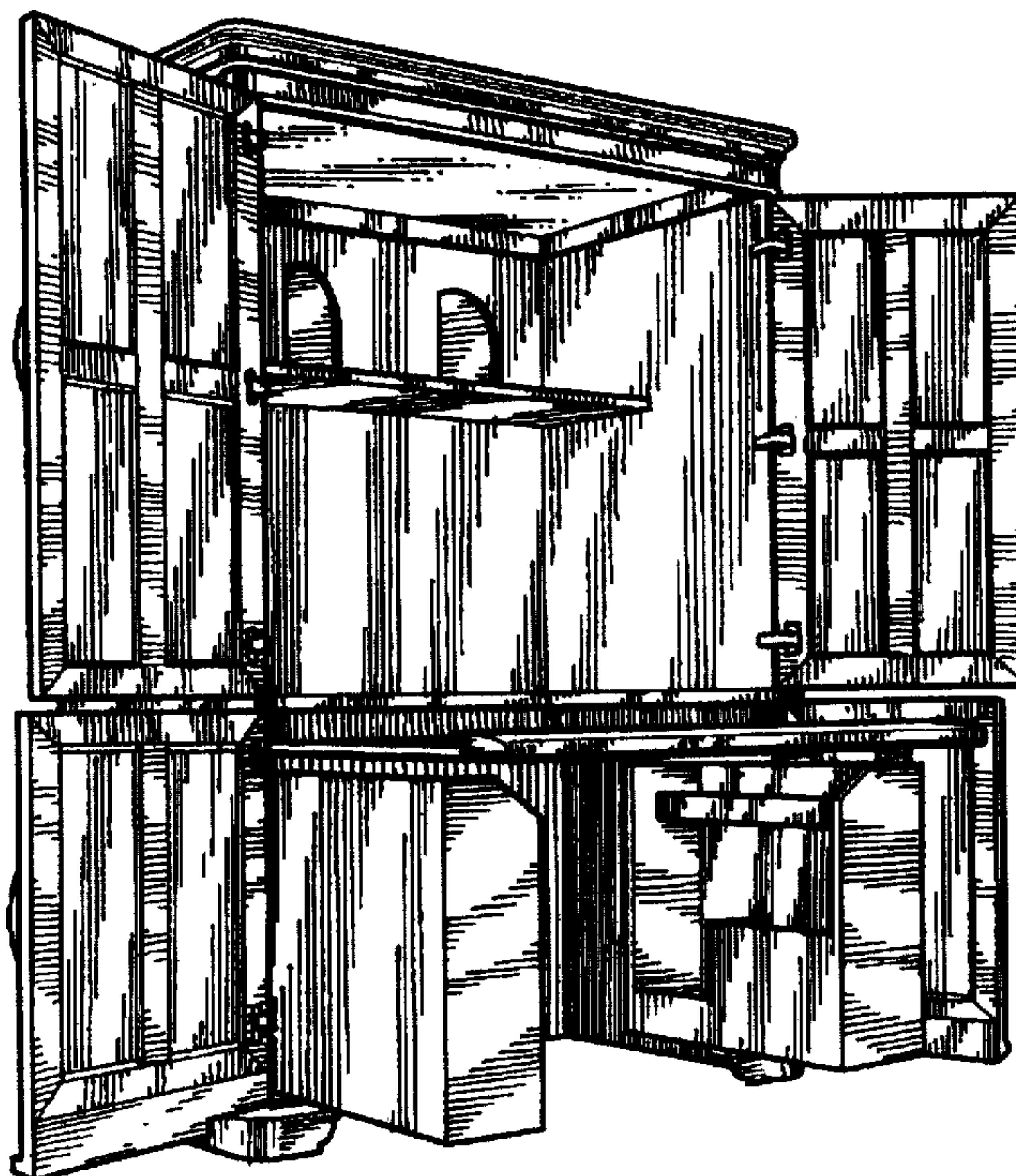
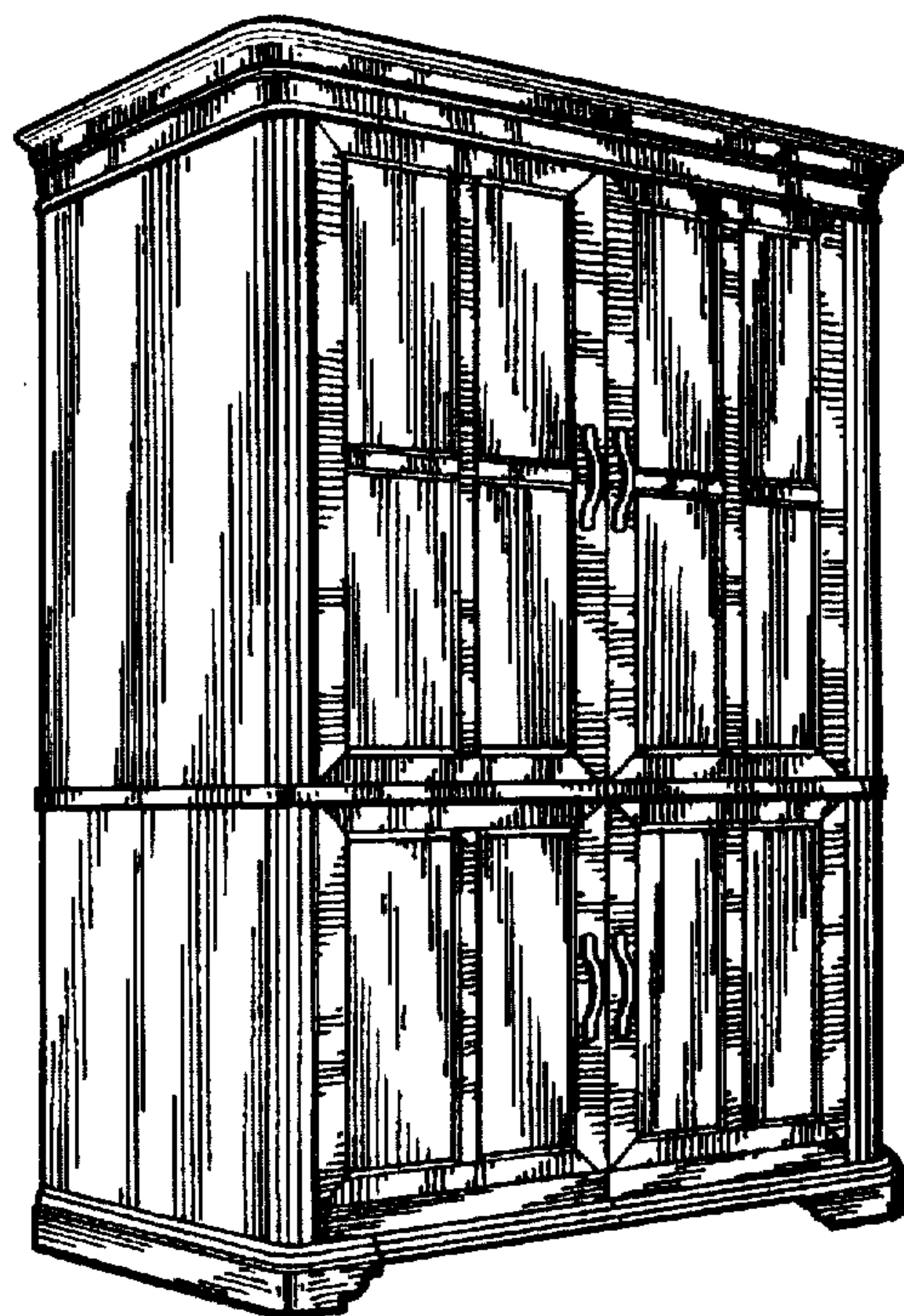

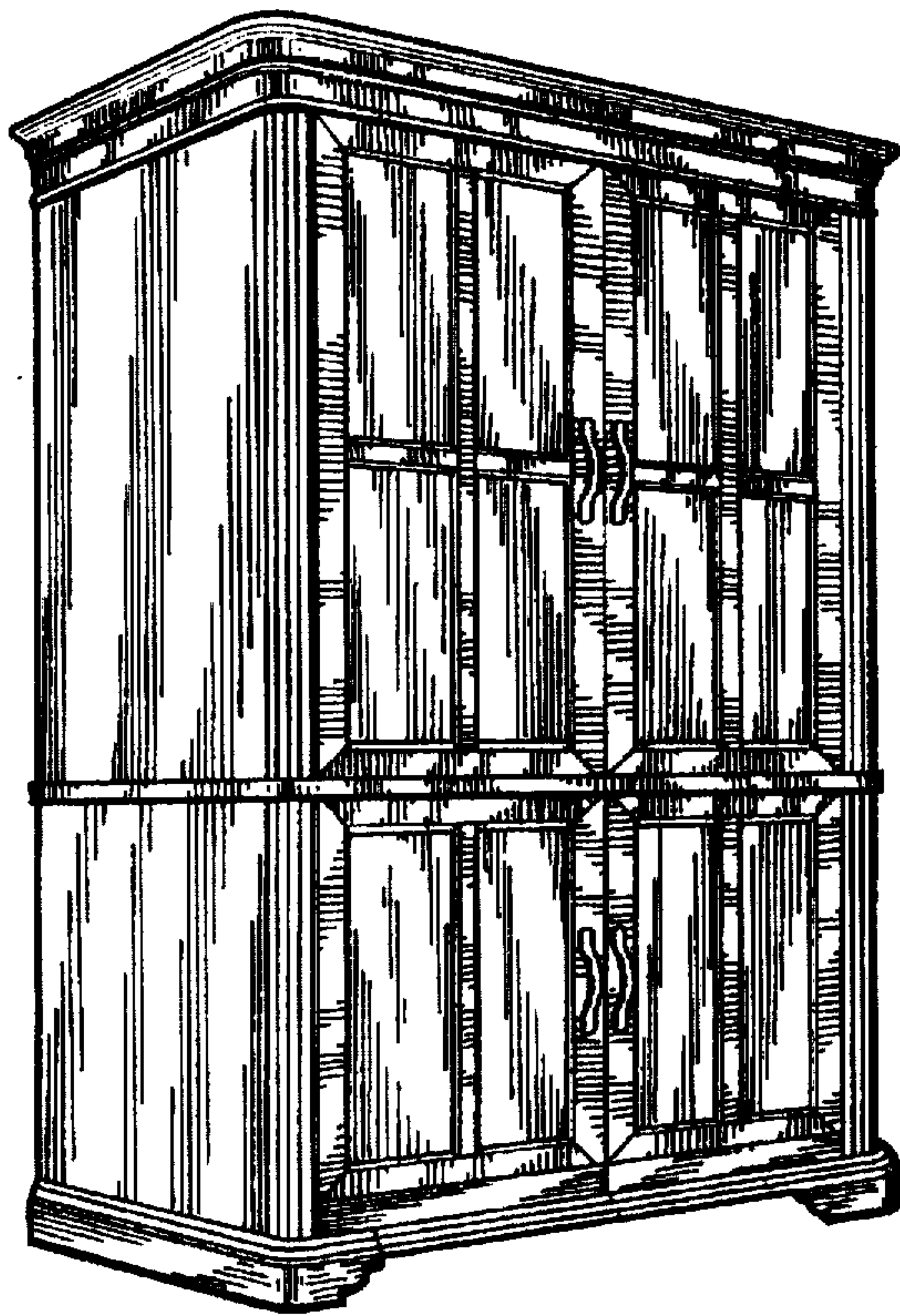

Fig. 1

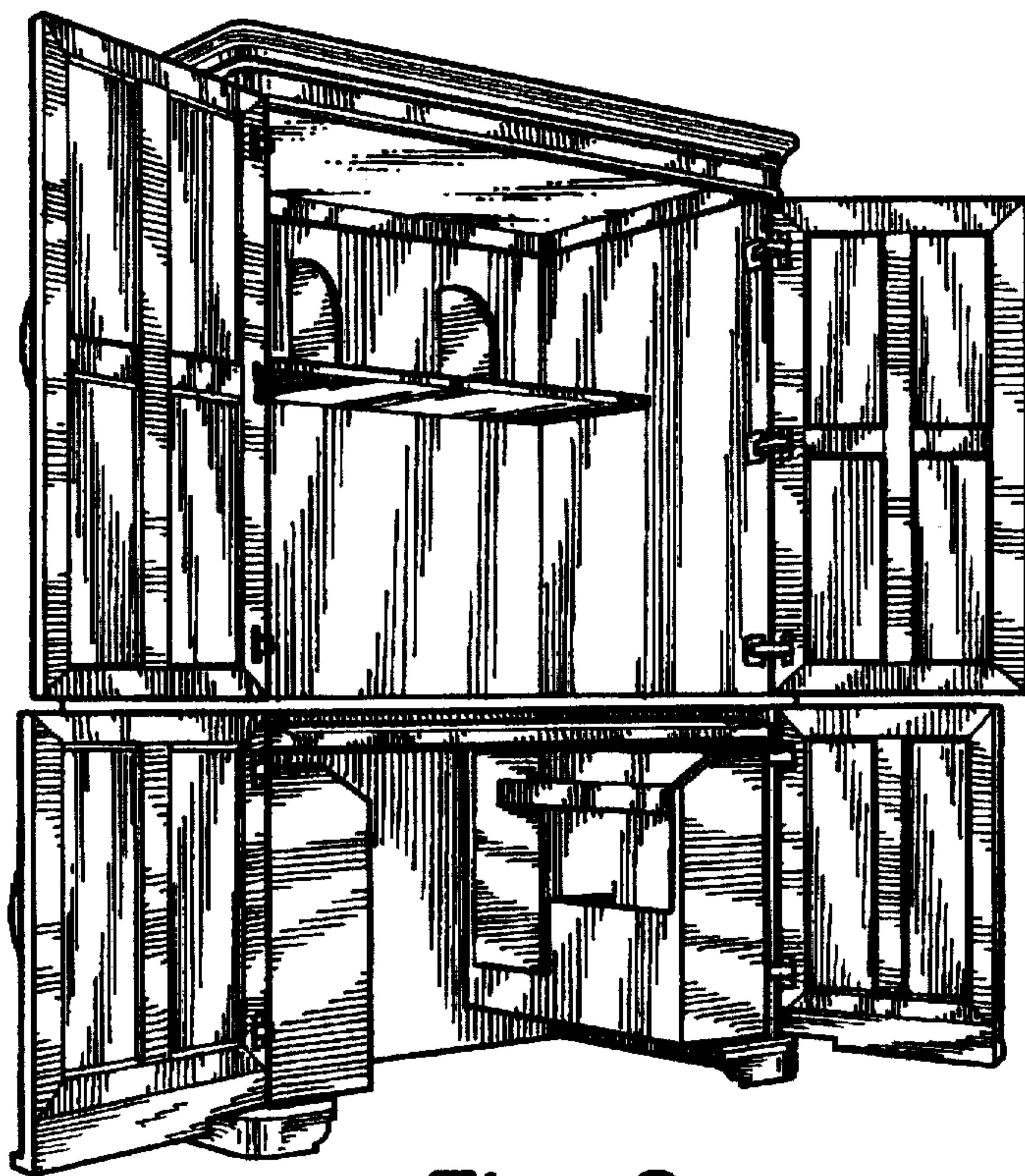

Fig. 2



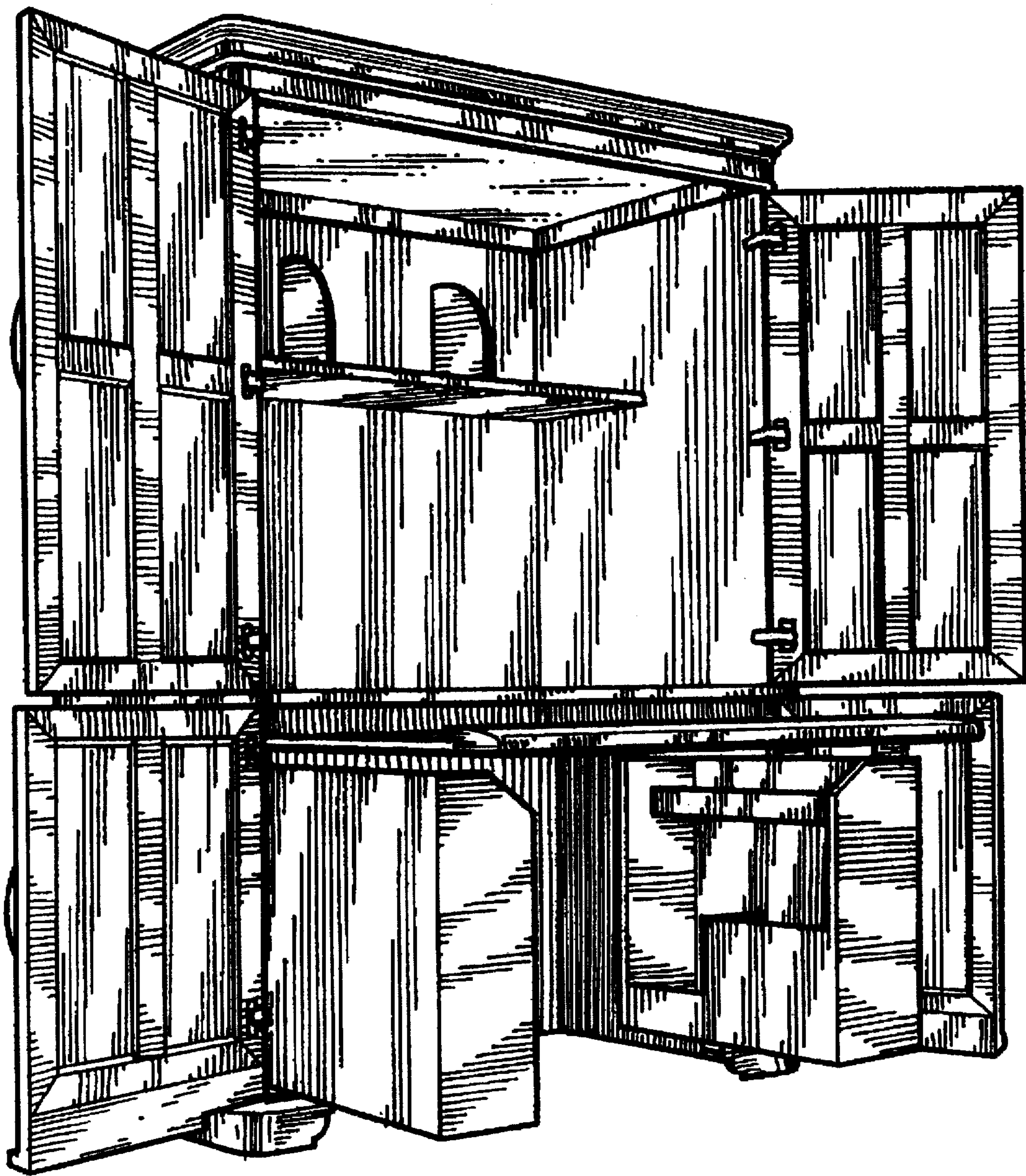

Fig. 3

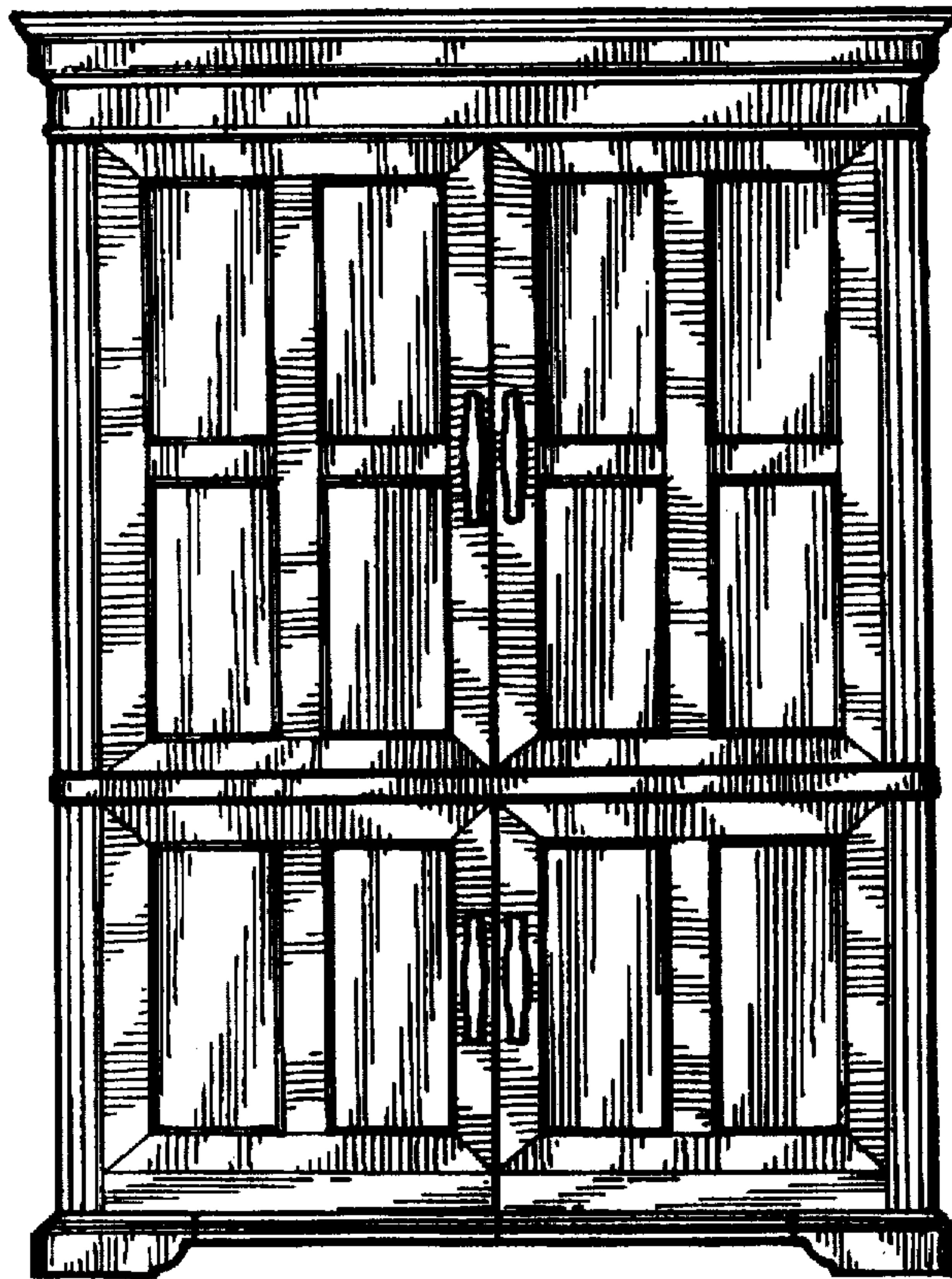

Fig. 4

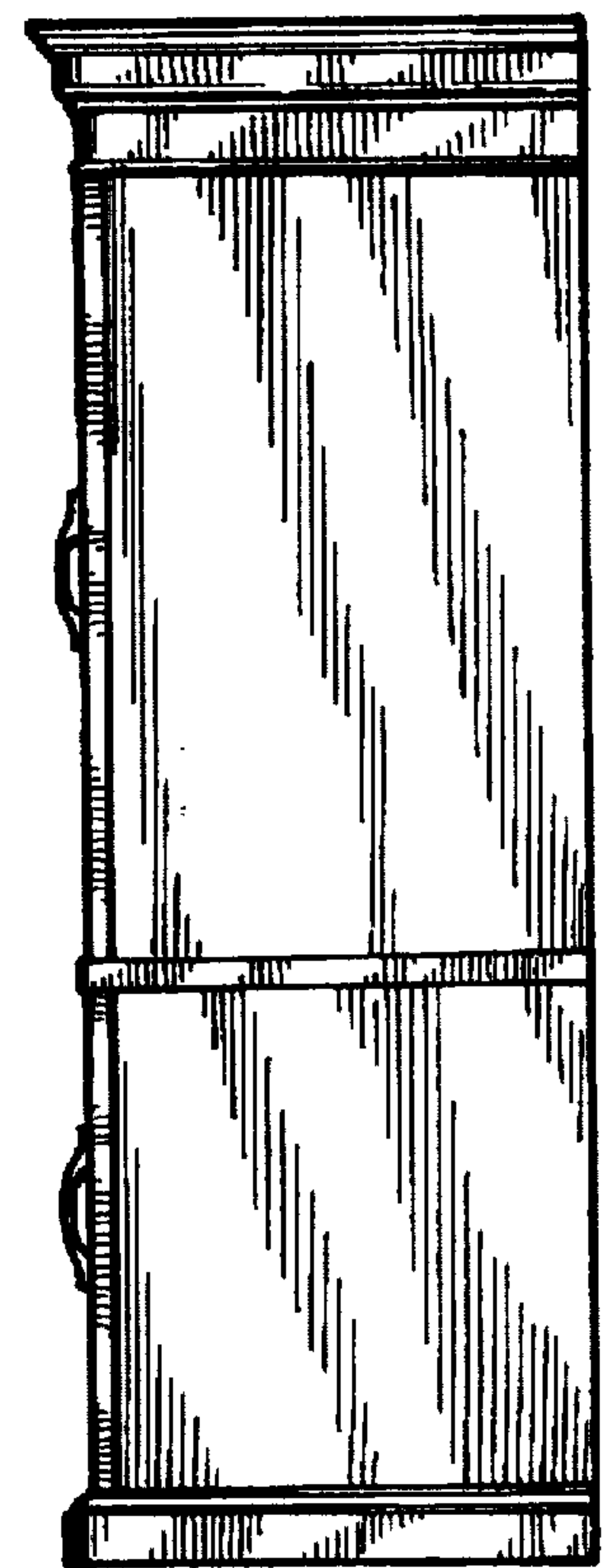

Fig. 5

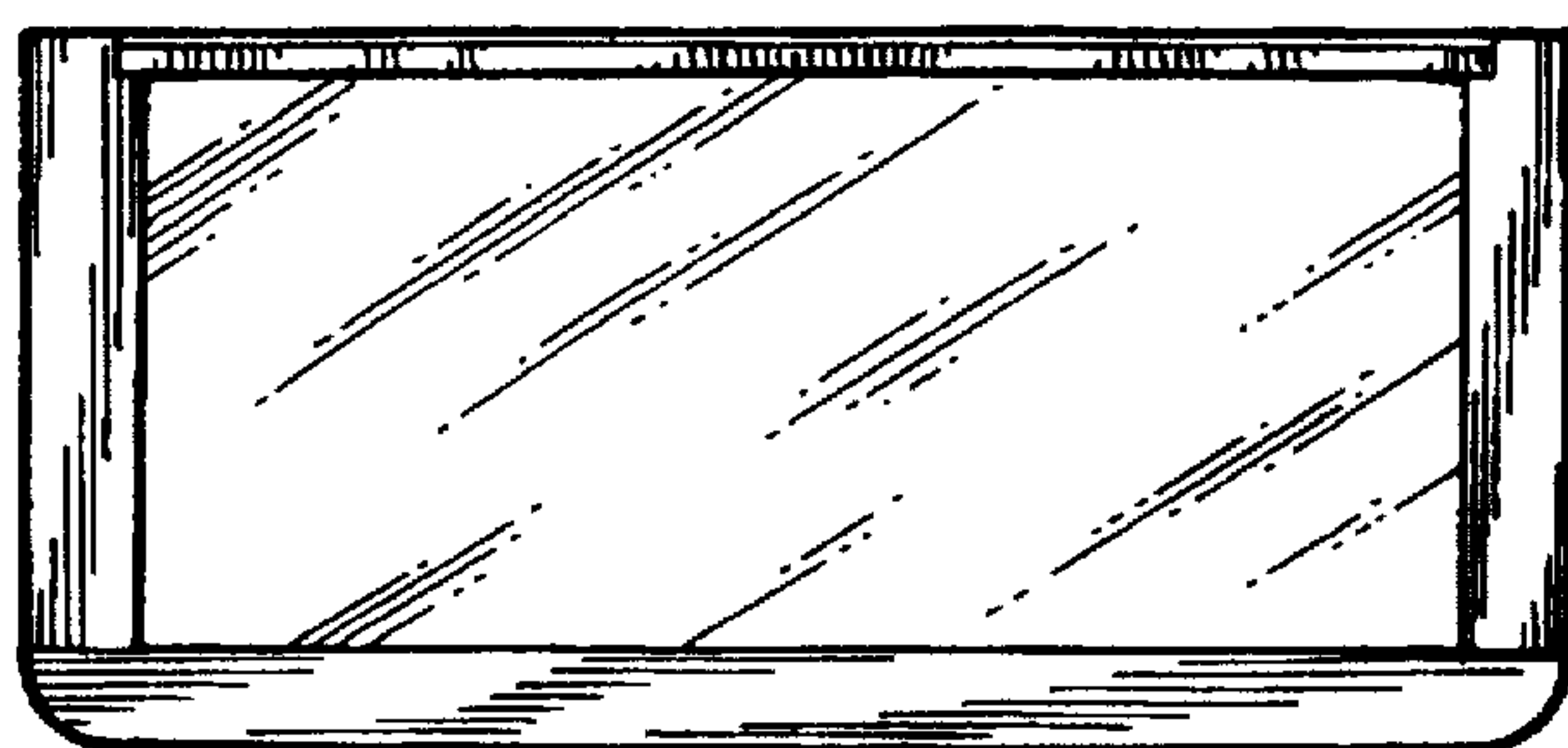

Fig. 6

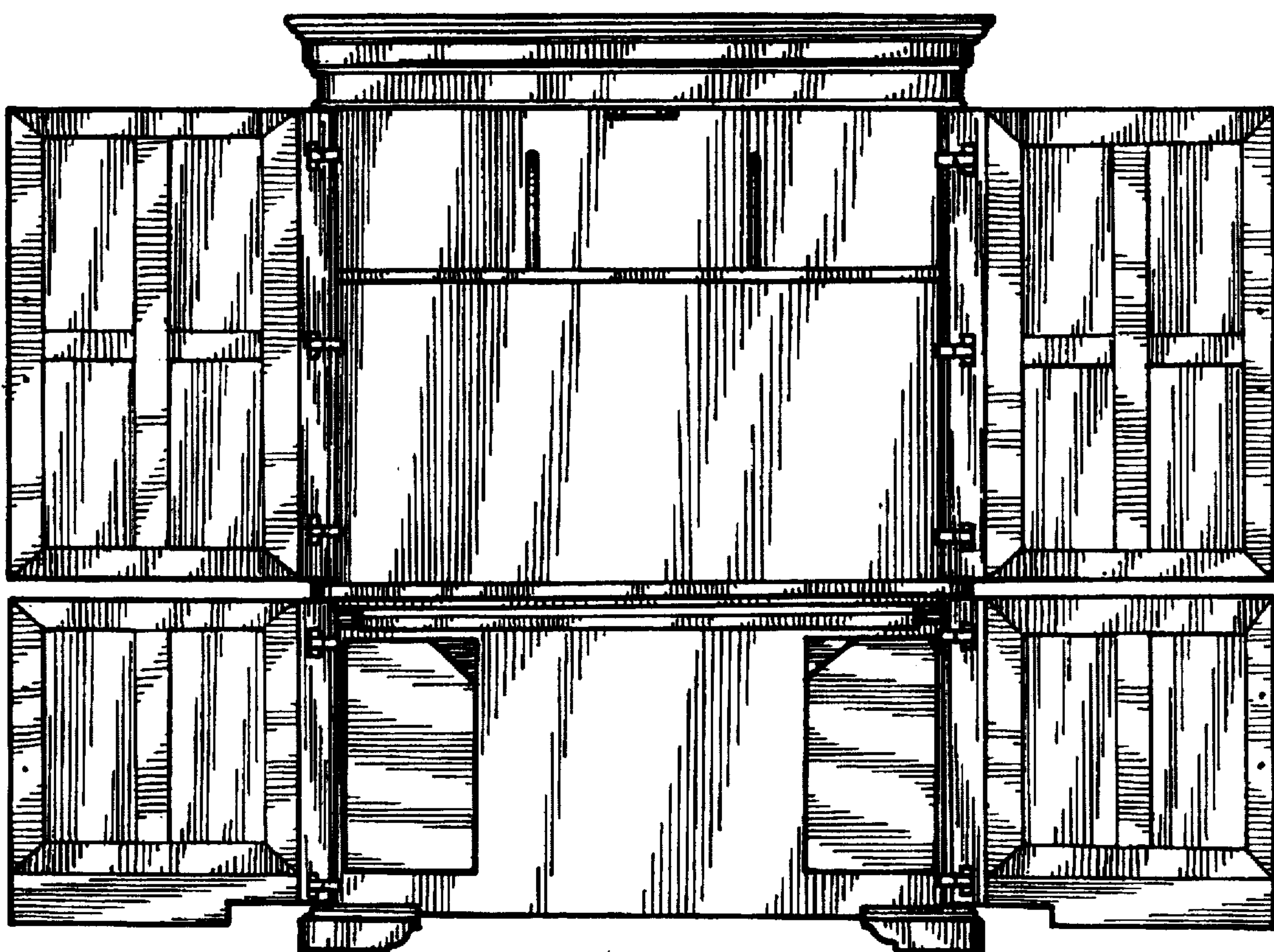

Fig. 7