



US00D387640S

United States Patent [19]
Von Fange

[11] **Patent Number: Des. 387,640**
[45] **Date of Patent: **Dec. 16, 1997**

[54] **WRENCH**

3,908,489 9/1975 Yamamoto et al. 81/124.3
5,295,422 3/1994 Chow 81/124.3

[76] **Inventor: Eric Von Fange, P.O. Box 767, Fort Mill, S.C. 29716**

Primary Examiner—Sandra L. Morris
Attorney, Agent, or Firm—Clifton Ted Hunt

[**] **Term: 14 Years**

[57] **CLAIM**

[21] **Appl. No.: 47,415**

The ornamental design for a wrench, as shown.

[22] **Filed: Dec. 4, 1995**

DESCRIPTION

[51] **LOC (6) Cl. 08-05**

FIG. 1 is a top, side perspective view of a wrench showing my new design;

[52] **U.S. Cl. D8/28**

FIG. 2 is a bottom, opposite side perspective view thereof; FIG. 3 is a top, side perspective view of an alternate embodiment of FIG. 1;

[58] **Field of Search D8/21-28; 81/124.3, 81/186; 7/138**

FIG. 4 is a bottom, opposite side perspective view of FIG. 3;

[56] **References Cited**

U.S. PATENT DOCUMENTS

| | | | |
|------------|---------|--------------------|------------|
| D. 57,113 | 2/1921 | Campbell, Sr. | D8/28 |
| D. 168,385 | 12/1952 | Watson | D8/28 |
| 1,684,215 | 9/1928 | Connell | 81/124.3 X |
| 2,775,341 | 12/1956 | Williams | 7/138 X |
| 3,324,748 | 6/1967 | Williams | 81/186 X |

FIG. 5 is a top, side perspective view of an alternate embodiment of FIG. 1; and, FIG. 6 is a bottom, opposite side perspective view of FIG. 5.

1 Claim, 2 Drawing Sheets

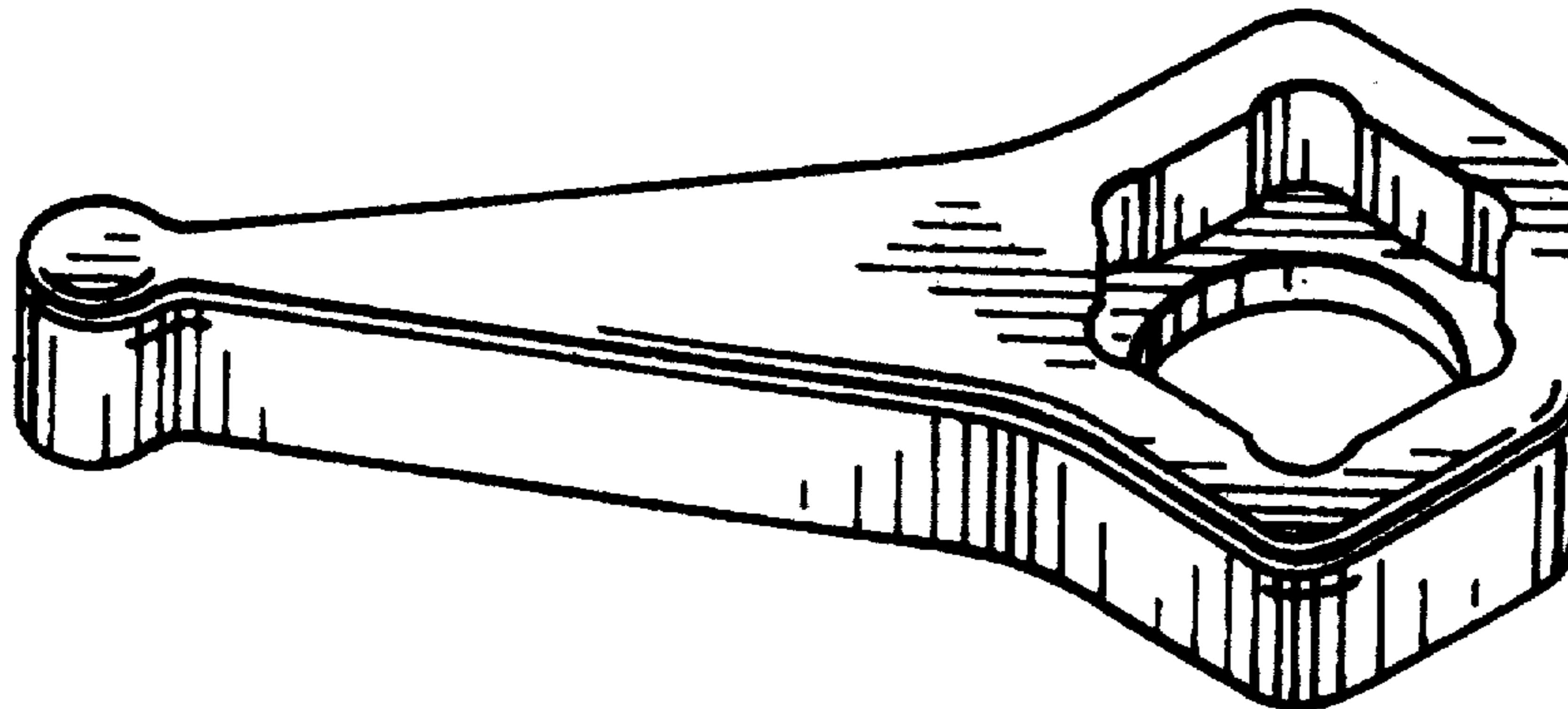

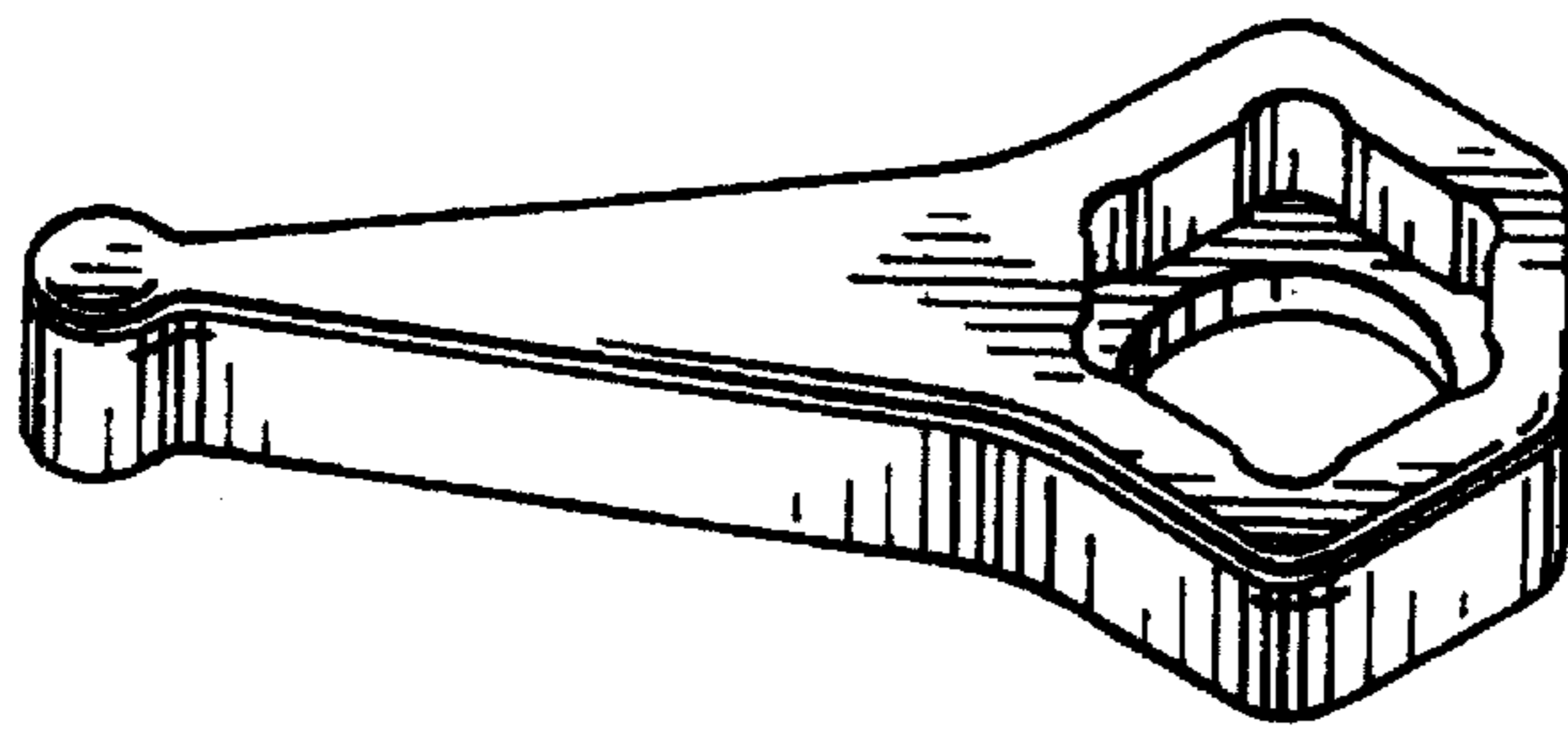

FIG. 1.

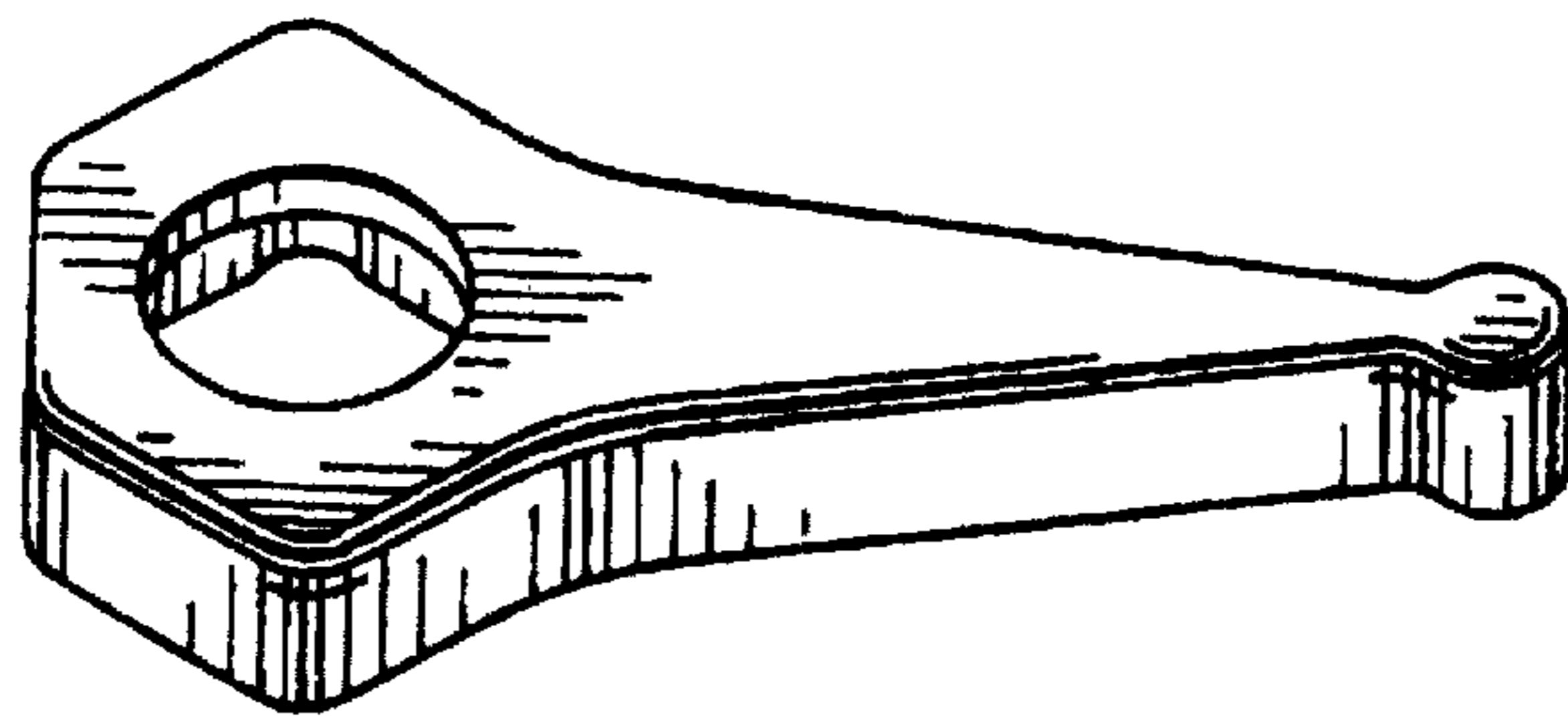

FIG. 2.

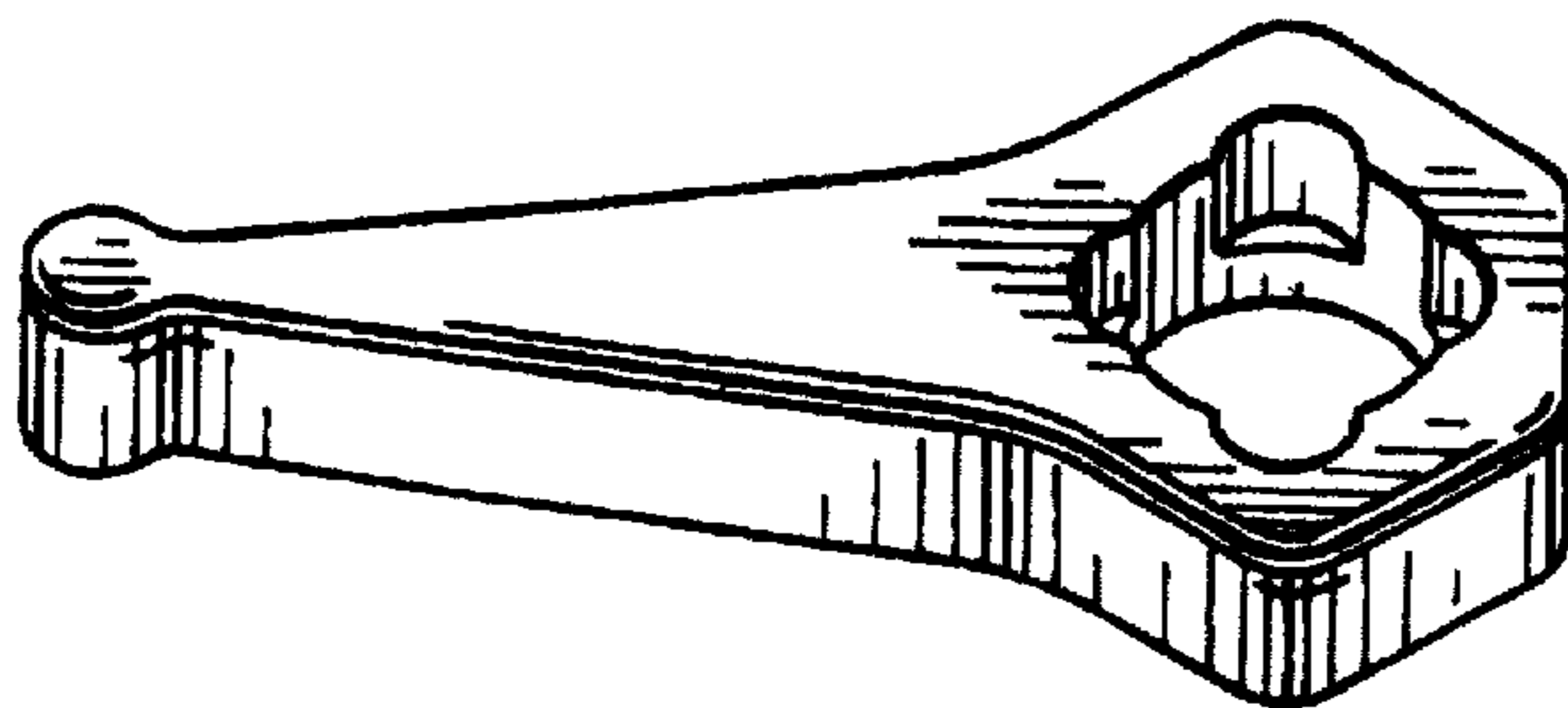

FIG. 3.

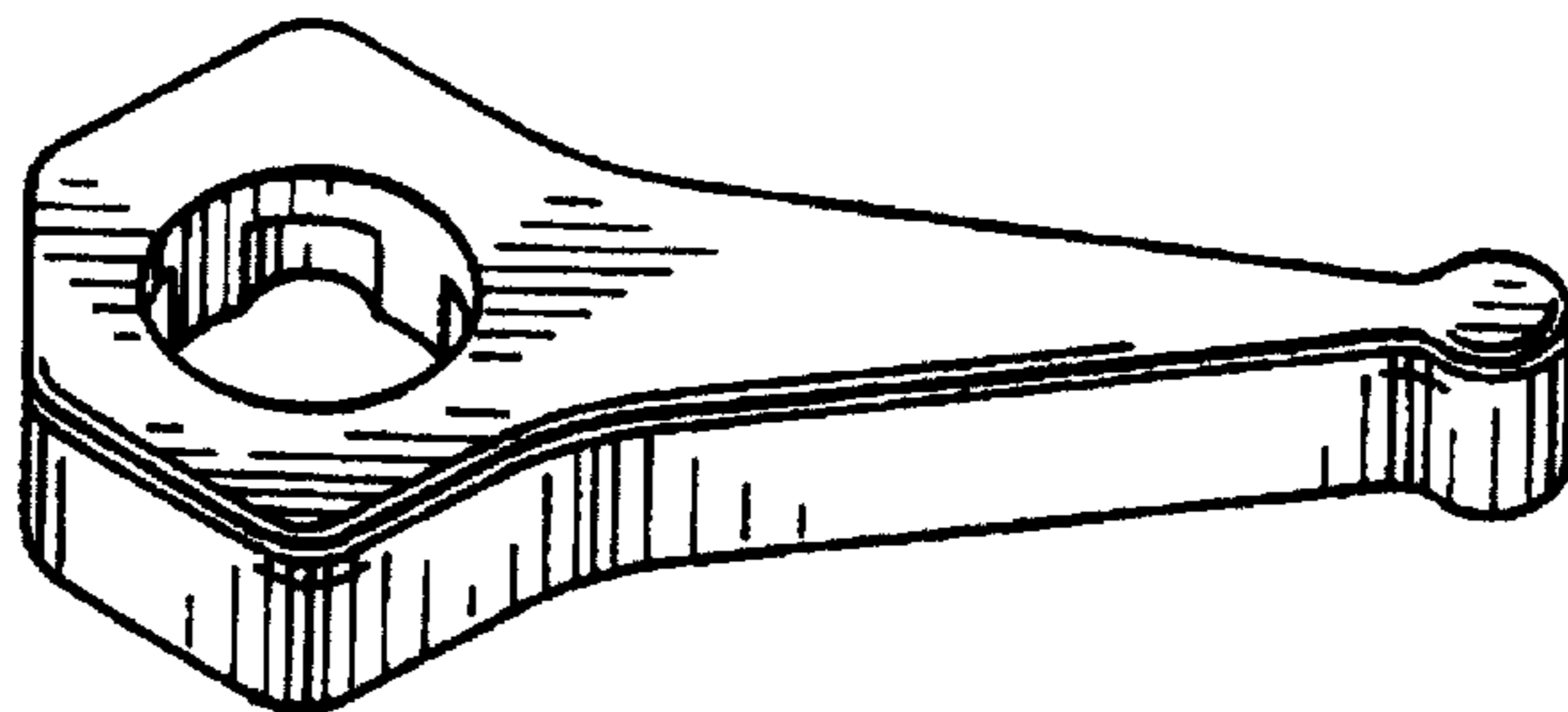

FIG. 4.

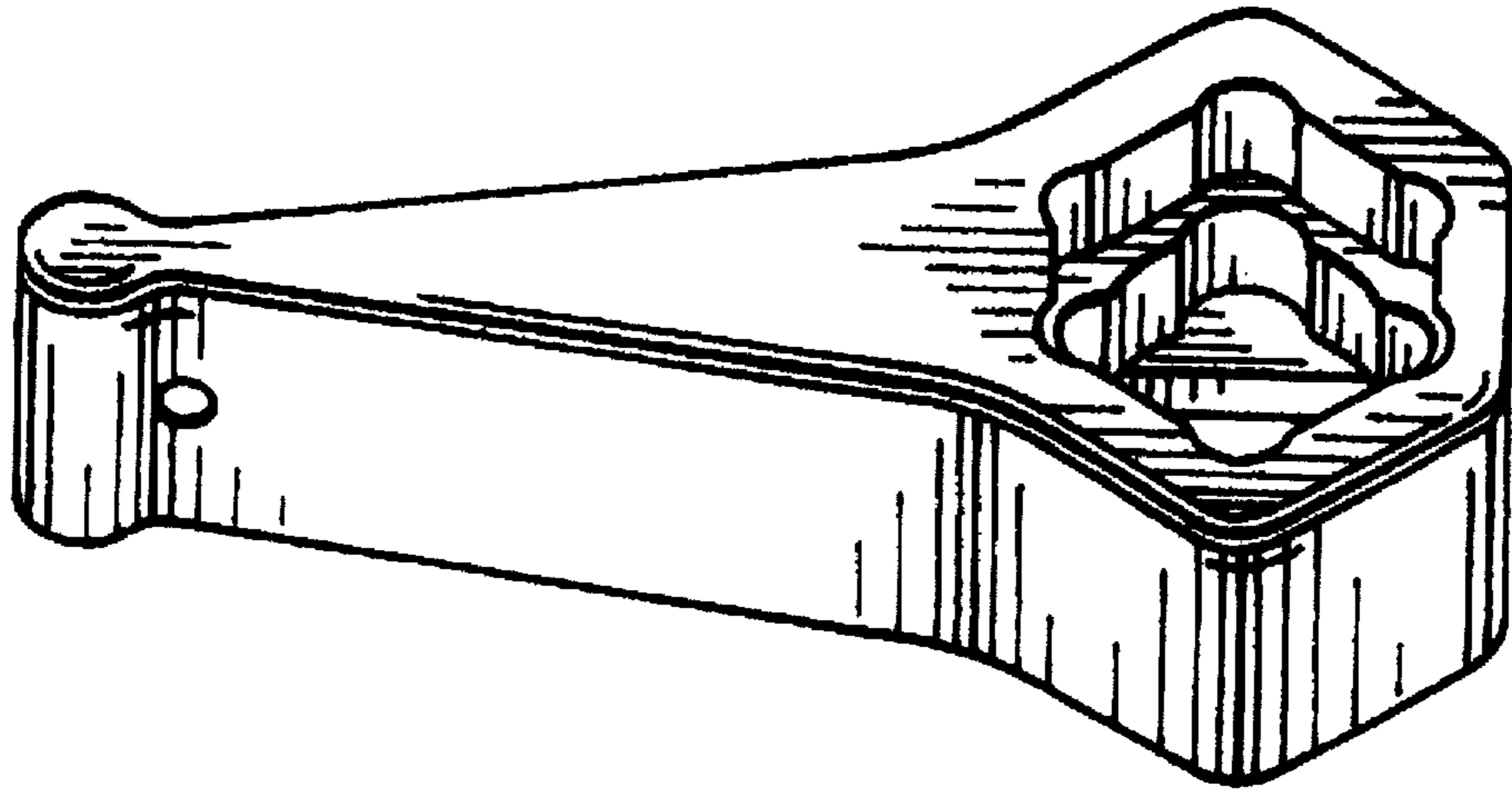

FIG. 5.

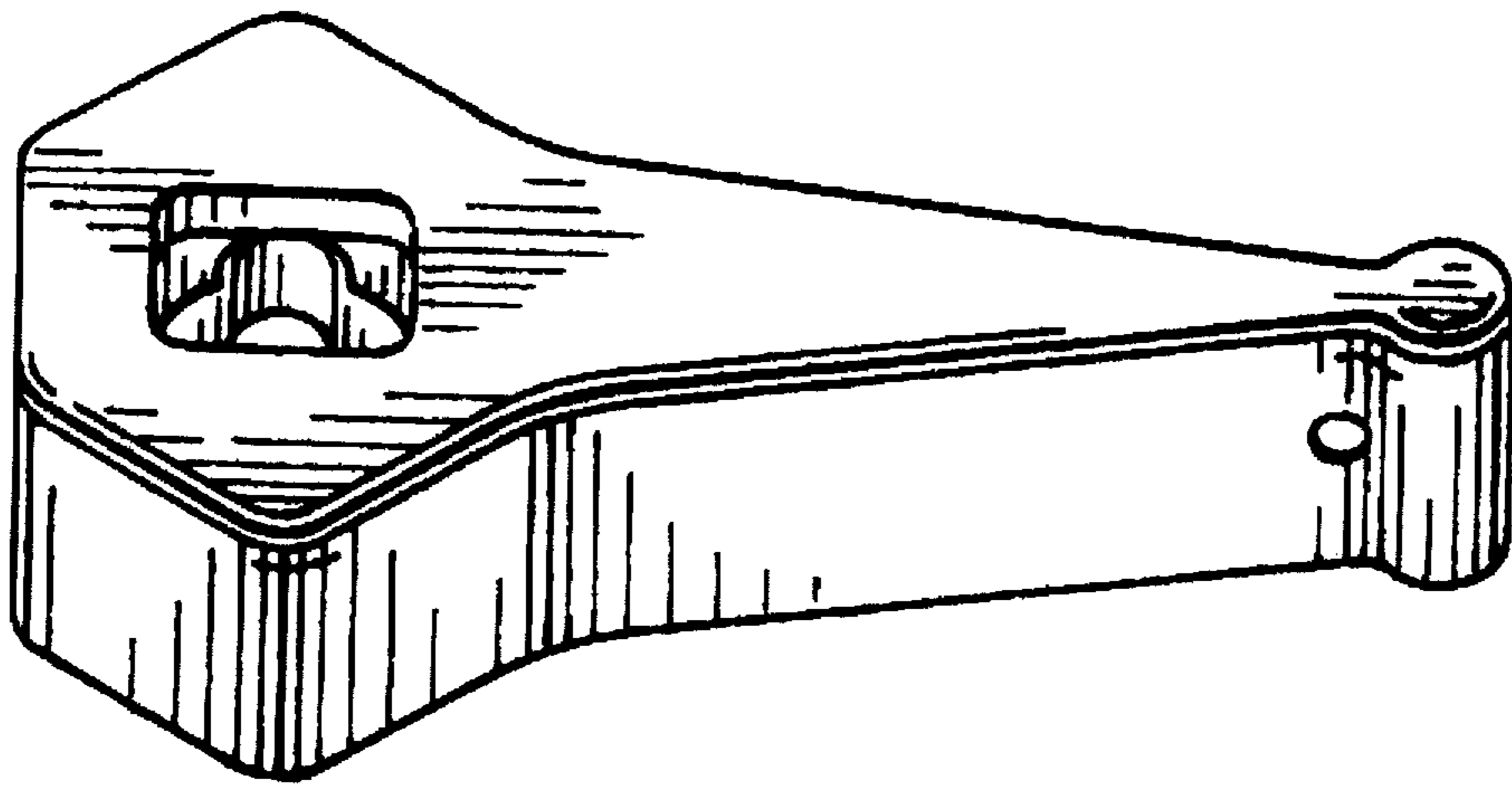

FIG. 6.