



US00D380057S

**United States Patent** [19]  
**Lukasik**

[11] **Patent Number: Des. 380,057**  
[45] **Date of Patent: \*\*Jun. 17, 1997**

[54] **CANDLE**

[76] **Inventor: Susan L. Lukasik**, 415 S. Westmore,  
Lombard, Ill. 60148

[\*\*] **Term: 14 Years**

[21] **Appl. No.: 43,223**

[22] **Filed: Aug. 29, 1995**

[51] **LOC (6) Cl. .... 26-04**

[52] **U.S. Cl. .... D26/6**

[58] **Field of Search .... D26/6, 7, 9, 10,**  
D26/16, 19, 22, 23; 431/125, 288-292

[56] **References Cited**

**U.S. PATENT DOCUMENTS**

D. 181,875	1/1958	Nitschke	.....	D26/6
D. 250,432	11/1978	Eklund	.....	D26/6
3,254,512	6/1966	Prentice	.....	431/288
3,759,675	9/1973	Lazarus et al.	.....	431/291
3,947,232	3/1976	Foster	.....	431/288
4,427,366	1/1984	Moore	.....	431/291

**OTHER PUBLICATIONS**

candle #s 361,362,363,364—Emkay Candle Wonderland  
1968.

*Primary Examiner*—A. Hugo Word  
*Assistant Examiner*—Robin V. Taylor  
*Attorney, Agent, or Firm*—Susan L. Lukasik

[57] **CLAIM**

The ornamental design for a candle, as shown and described.

**DESCRIPTION**

FIG. 1 is a top, front, and right perspective view of the candle showing my new design, wherein the broken line showing of a wick is for illustrative purposes only and forms no part of the claimed design;

FIG. 2 is a left side elevational view thereof, the broken line showing of the wick is for illustrative purposes only and forms no part of the claimed design; and,

FIG. 3 is a bottom plan view thereof.

**1 Claim, 1 Drawing Sheet**

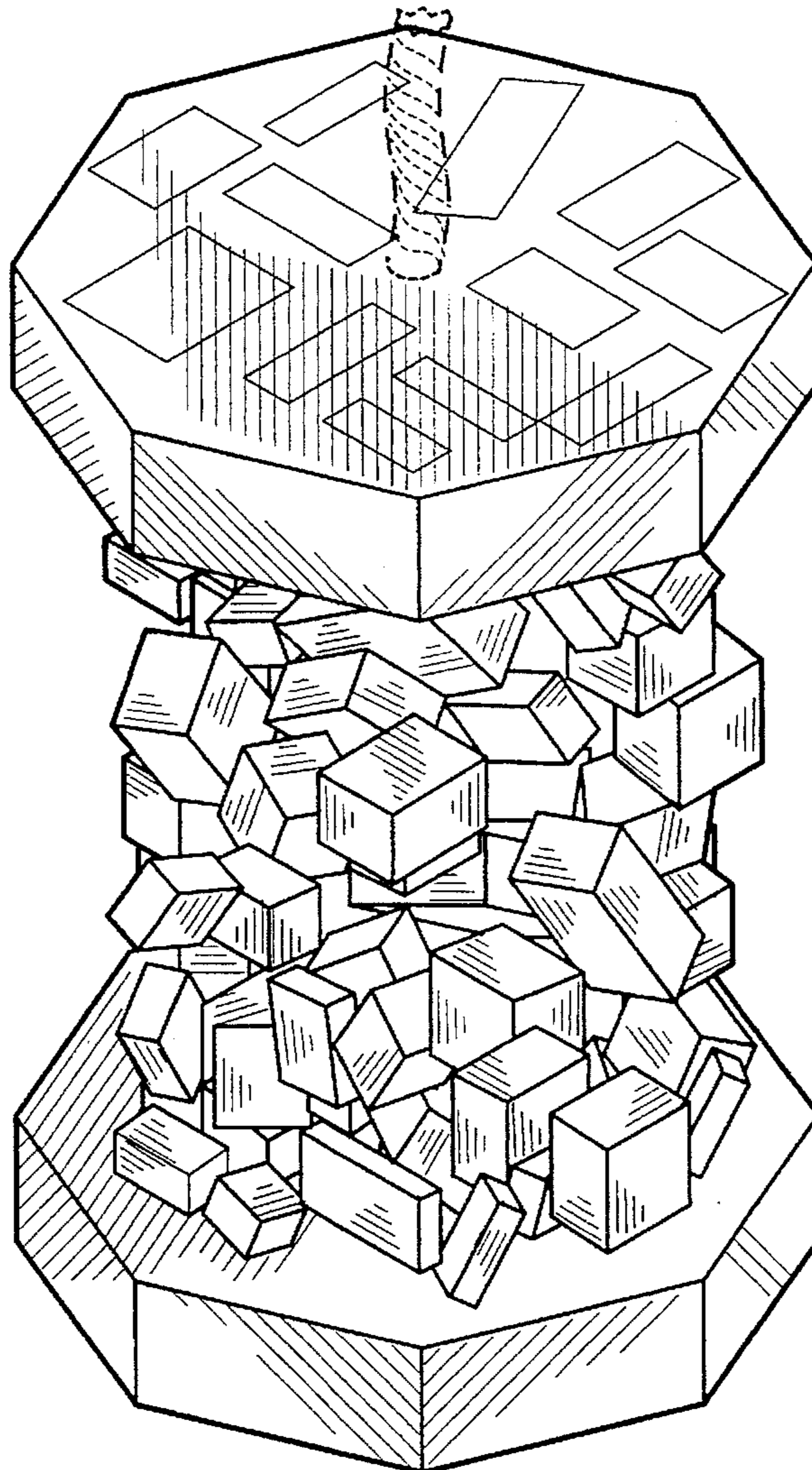

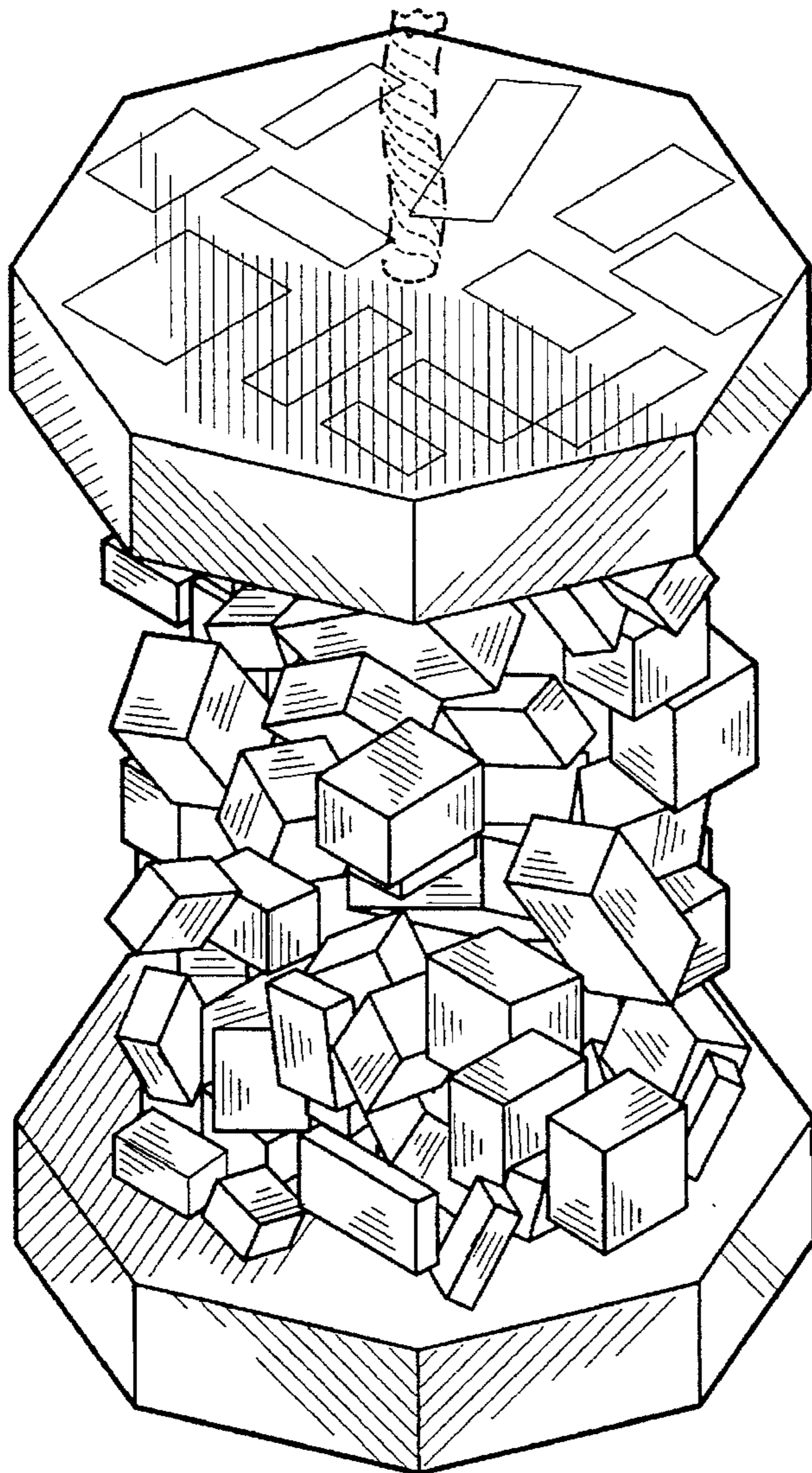

FIG. 1

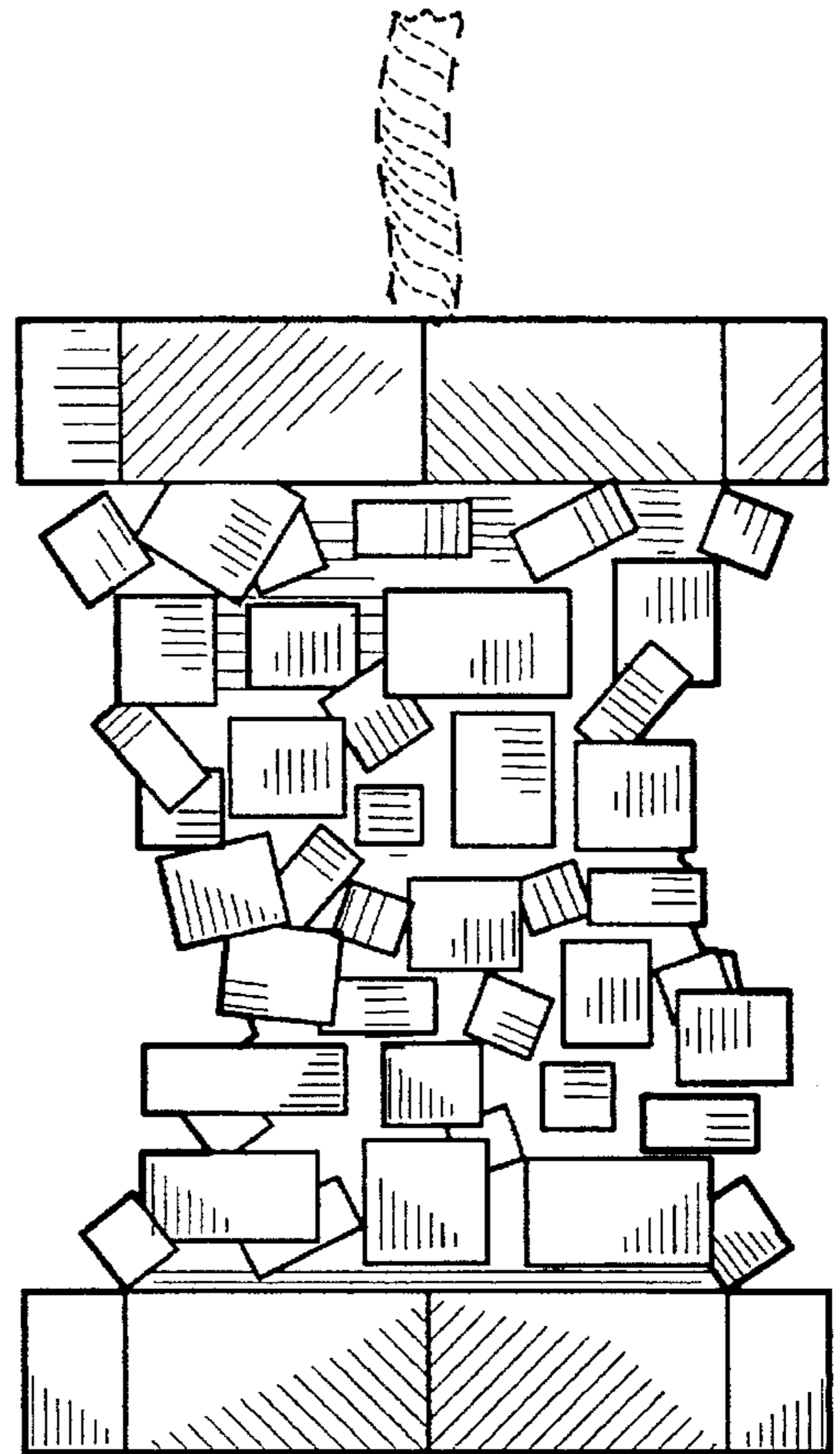

FIG. 2

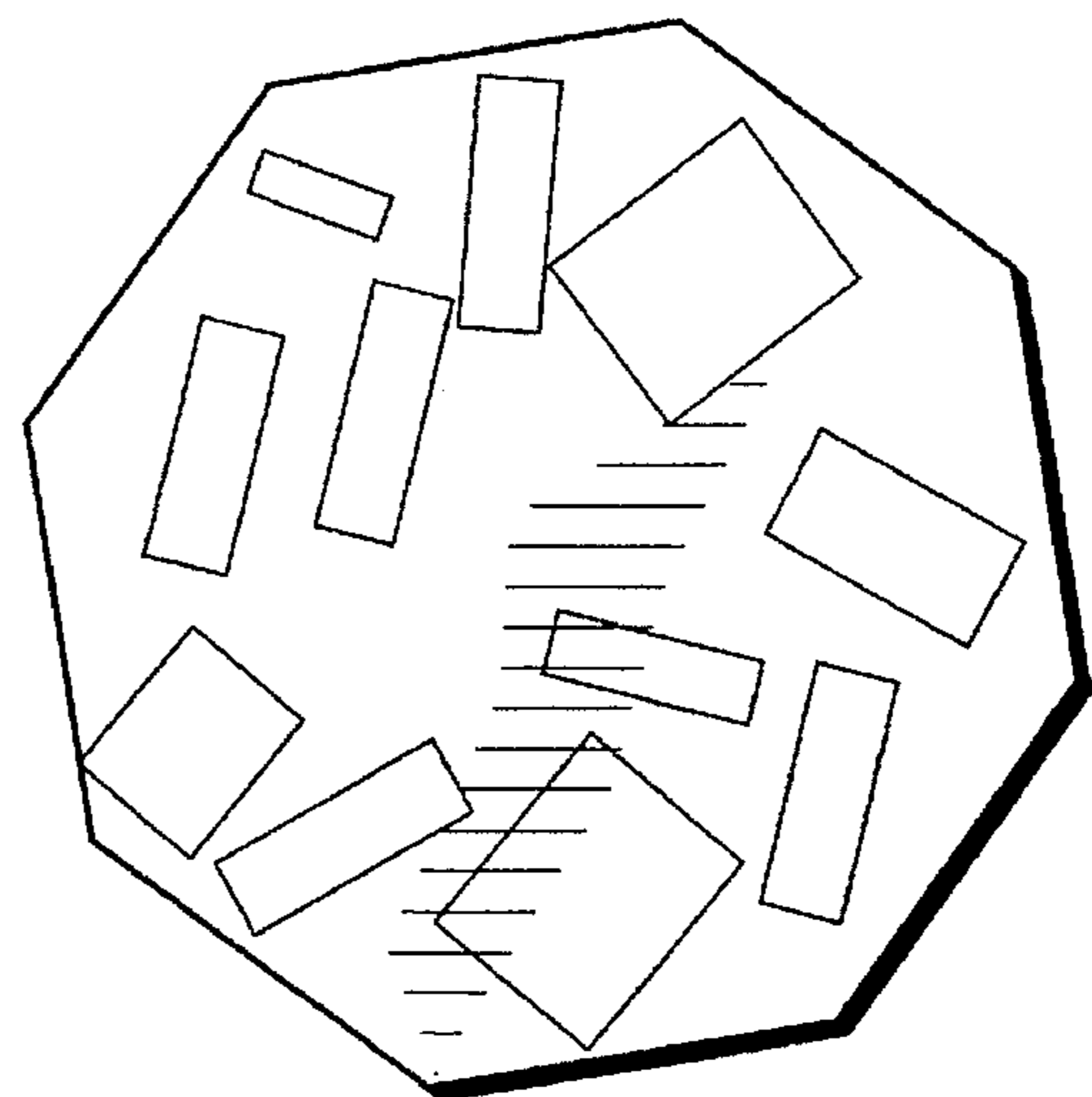

FIG. 3