



US00D380021S

United States Patent [19] Hartsfield

[11] Patent Number: **Des. 380,021**

[45] Date of Patent: ****Jun. 17, 1997**

[54] **COLORABLE PLAYHOUSE**

[76] Inventor: **Richard Hartsfield**, 218 S. Calhoun St., Magnolia, Ark. 71753

[**] Term: **14 Years**

[21] Appl. No.: **48,943**

[22] Filed: **Jan. 16, 1996**

[51] LOC (6) Cl. **21-01**

[52] U.S. Cl. **D21/114**

[58] Field of Search D21/114, 240;
D9/322, 307, 414, 418, 432; 446/476, 478,
488; D25/16, 17

[56] **References Cited**

U.S. PATENT DOCUMENTS

| | | | | |
|------------|--------|-----------|-------|---------|
| D. 176,551 | 1/1956 | Patterson | | D21/114 |
| D. 274,916 | 7/1984 | Hunt | | D9/322 |
| D. 335,904 | 5/1993 | Krebs | | D21/114 |
| D. 350,692 | 9/1994 | Seki | | D9/322 |
| 1,130,818 | 3/1915 | Herman | | D21/114 |
| 1,899,241 | 2/1933 | Marr | | D21/114 |

| | | | | |
|-----------|---------|-------------|-------|---------|
| 3,231,942 | 2/1966 | O'Brien | | 446/478 |
| 5,011,446 | 4/1991 | Feinberg | | 446/476 |
| 5,261,848 | 11/1993 | Michaud | | 446/478 |
| 5,369,920 | 12/1994 | Taylor | | 446/488 |
| 5,482,490 | 1/1996 | Weldon-Ming | | 446/478 |

Primary Examiner—Ted Shooman
Assistant Examiner—R. Barkai
Attorney, Agent, or Firm—Harold H. Dutton, Jr.; W. Charles L. Jamison; Diane F. Liebman

[57] **CLAIM**

The ornamental design for a colorable playhouse, as shown.

DESCRIPTION

FIG. 1 is a perspective view of a colorable playhouse showing my new design;
FIG. 2 is a rear view thereof;
FIG. 3 is a left side view thereof;
FIG. 4 is a right side view thereof;
FIG. 5 is a top view thereof; and,
FIG. 6 is a bottom view thereof.

1 Claim, 4 Drawing Sheets

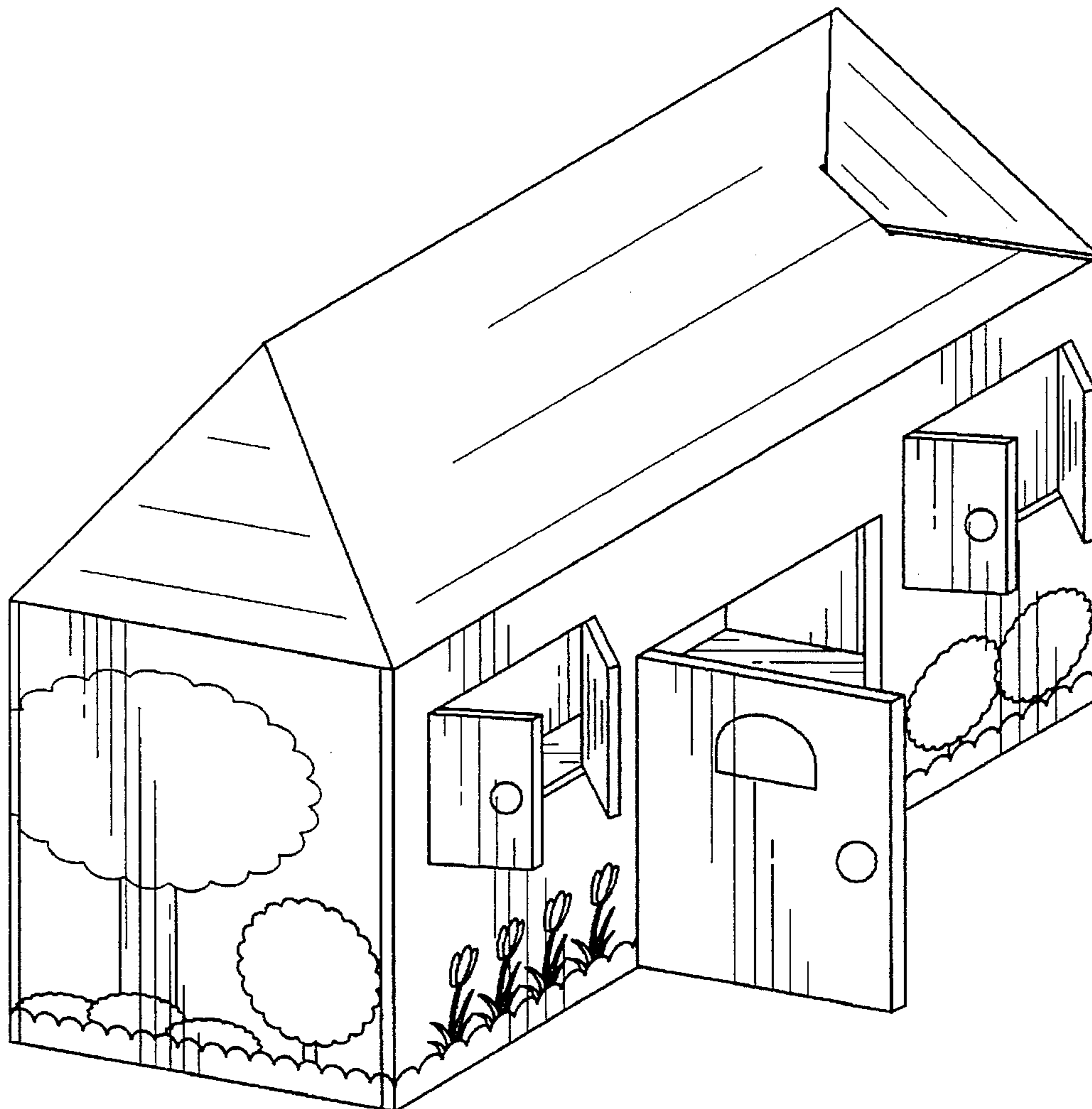

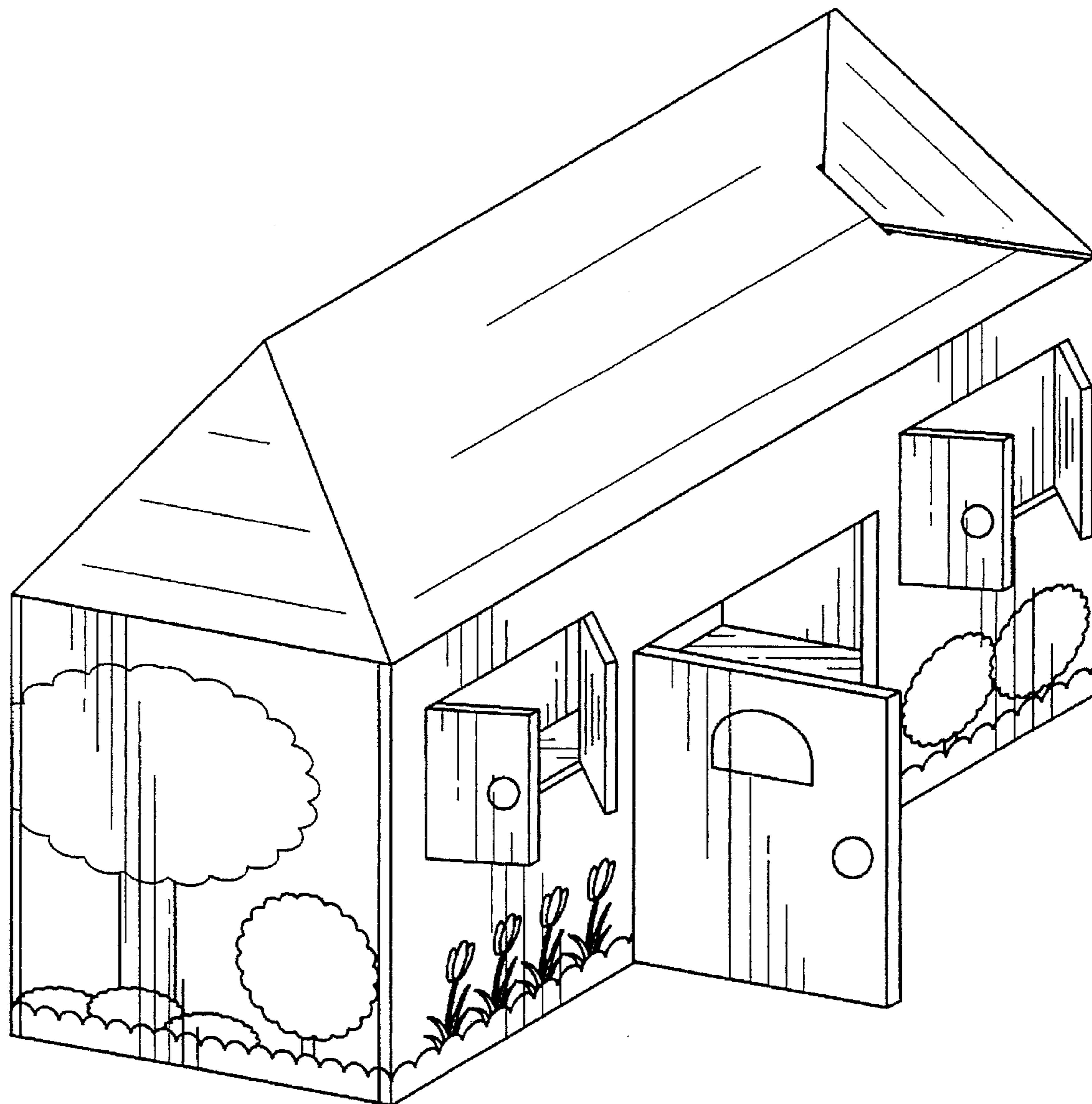

FIG. 1

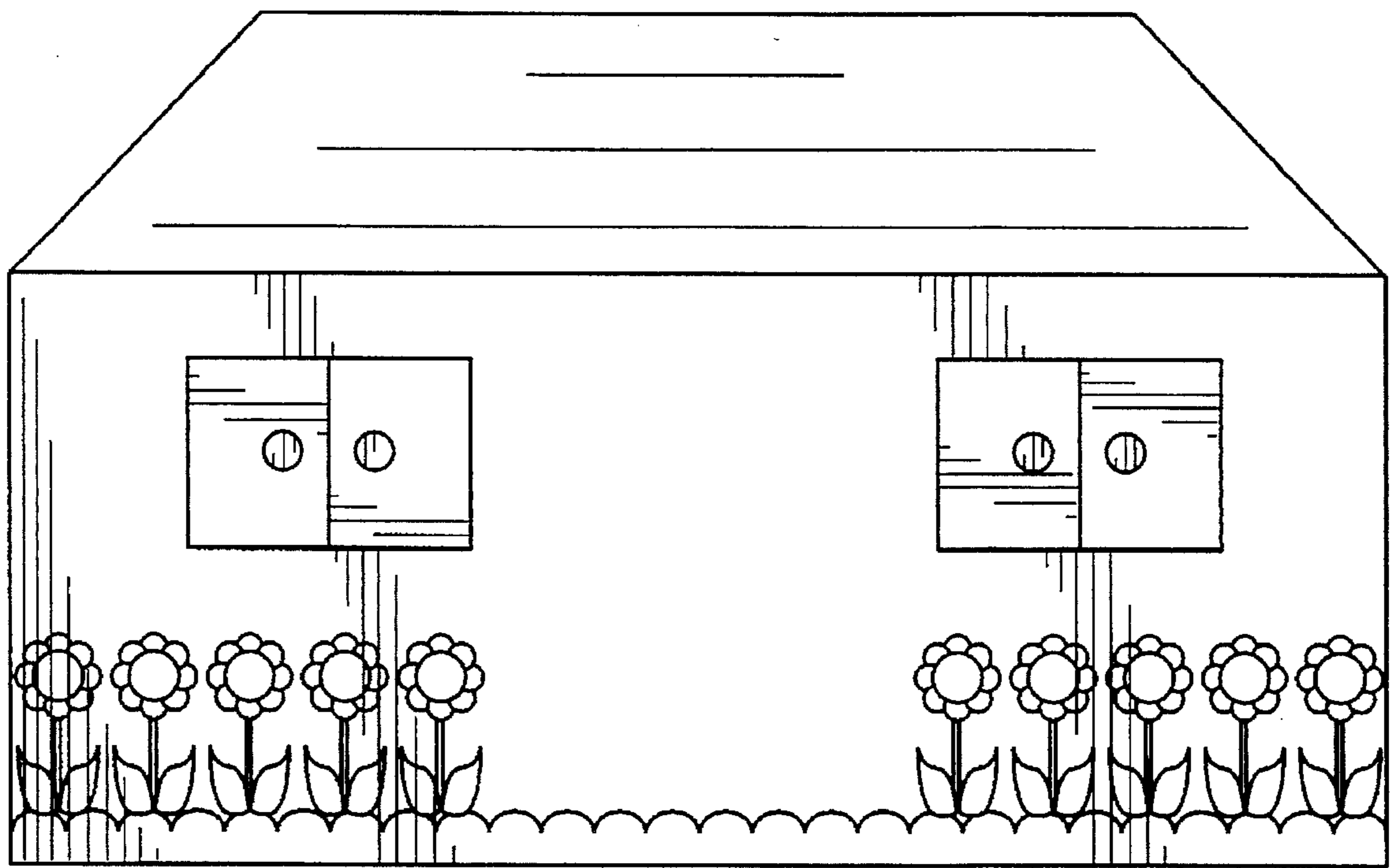

FIG. 2

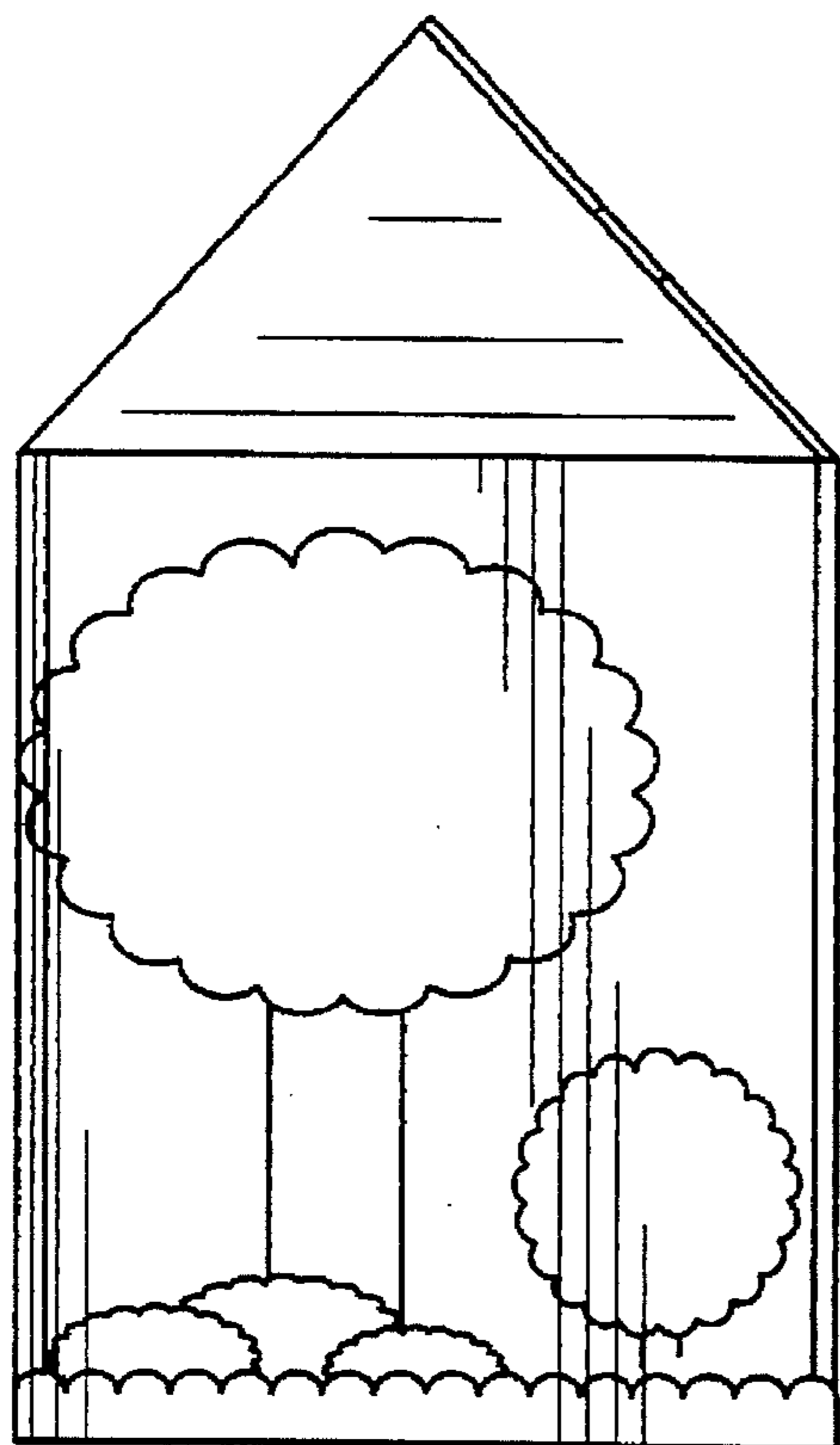
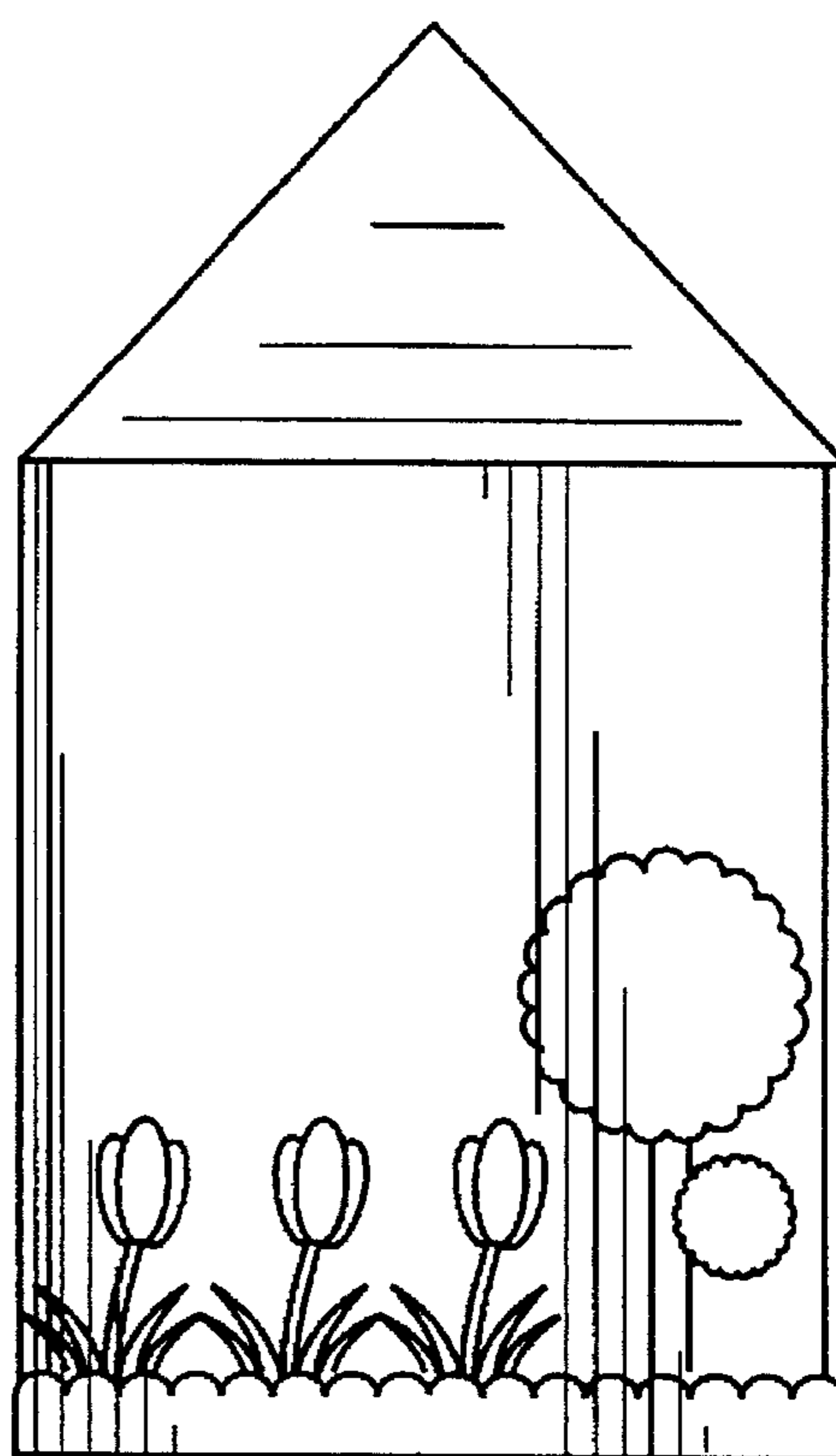

FIG. 3

FIG. 4



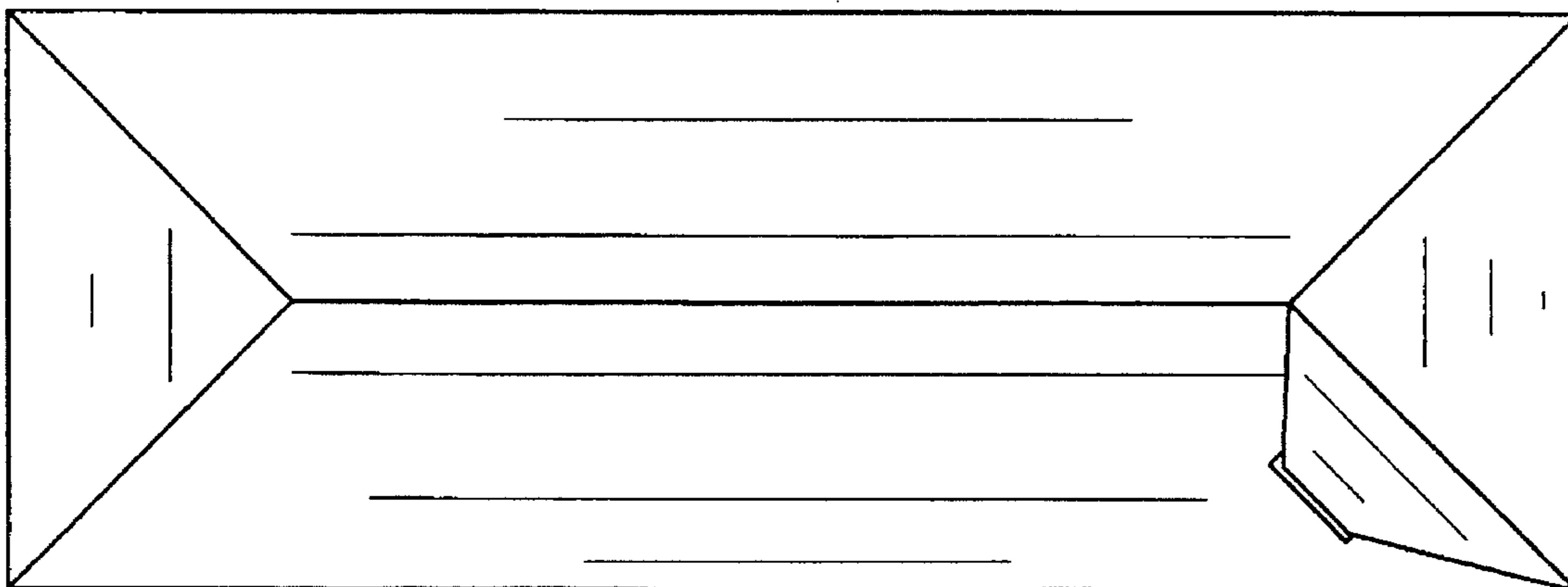

FIG. 5

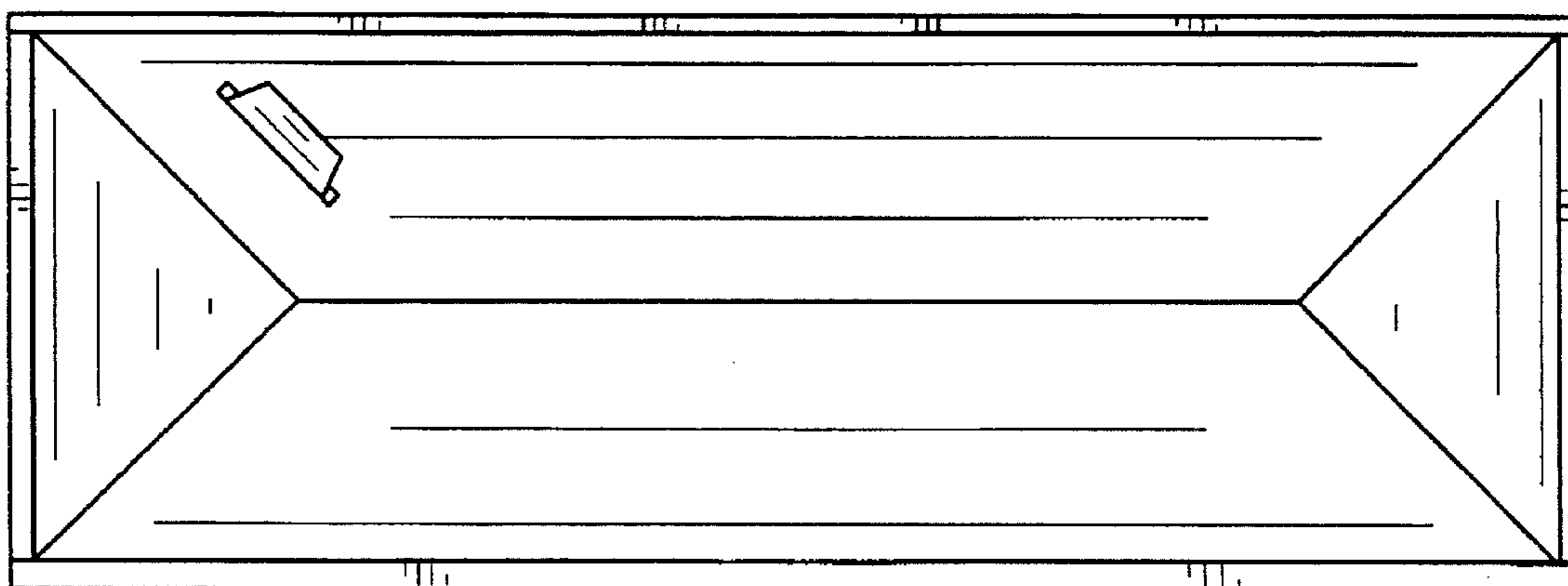

FIG. 6