



US00D377007S

United States Patent [19]

Tan et al.

[11] Patent Number: **Des. 377,007**

[45] Date of Patent: ****Dec. 31, 1996**

[54] **SHIELDED CONNECTOR**
[75] Inventors: **Haw-Chan Tan**, Diamond Bar; **Tim S. L. Chang**, Chino Hills, both of Calif.

4,913,664 4/1990 Dixon et al. 439/607
5,030,140 7/1991 Sugiyama 439/607
5,266,038 11/1993 Nakamura 439/79
5,281,169 1/1994 Kiat et al. 439/607

[73] Assignee: **Hon Hai Precision Ind. Co., Ltd.**, Taiwan

Primary Examiner—Joel Sincavage

[**] Term: **14 Years**

[57] CLAIM

The ornamental design for a shielded connector, as shown.

[21] Appl. No.: **47,635**

DESCRIPTION

[22] Filed: **Dec. 8, 1995**

FIG. 1 is a perspective view of the shielded connector showing our design;

[52] U.S. Cl. **D13/147**

FIG. 2 is a rear elevational view thereof;

[58] Field of Search D13/147; 439/62, 439/76, 78, 82, 83, 607, 608, 609, 610

FIG. 3 is a front elevational view thereof;

FIG. 4 is a right view thereof;

FIG. 5 is a left view thereof;

[56] References Cited

U.S. PATENT DOCUMENTS

FIG. 6 is a top plan view thereof; and,

FIG. 7 is a bottom plan view thereof.

D. 318,650 7/1991 Matsuzaki D13/147

1 Claim, 4 Drawing Sheets

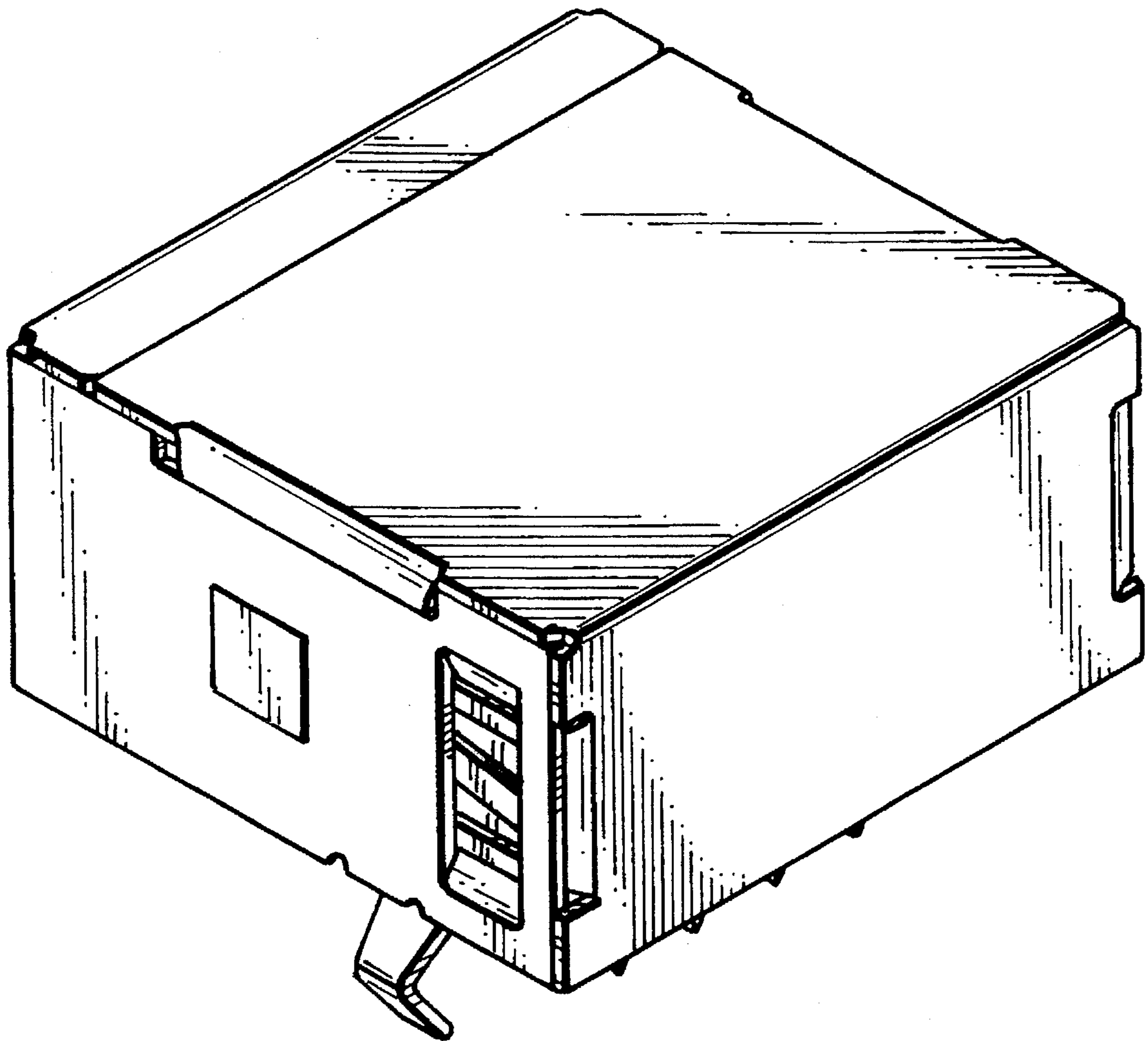

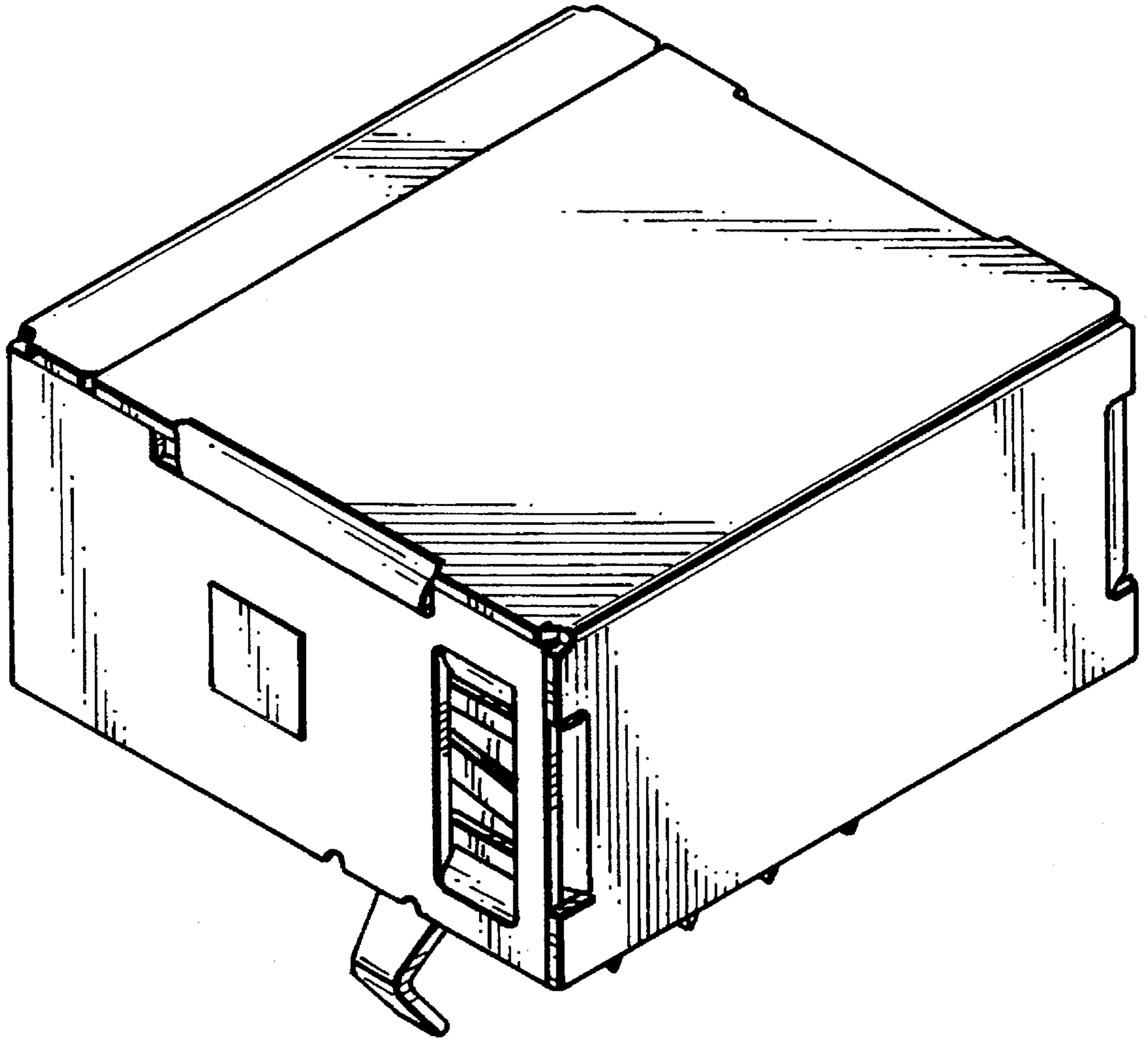

FIG. 1

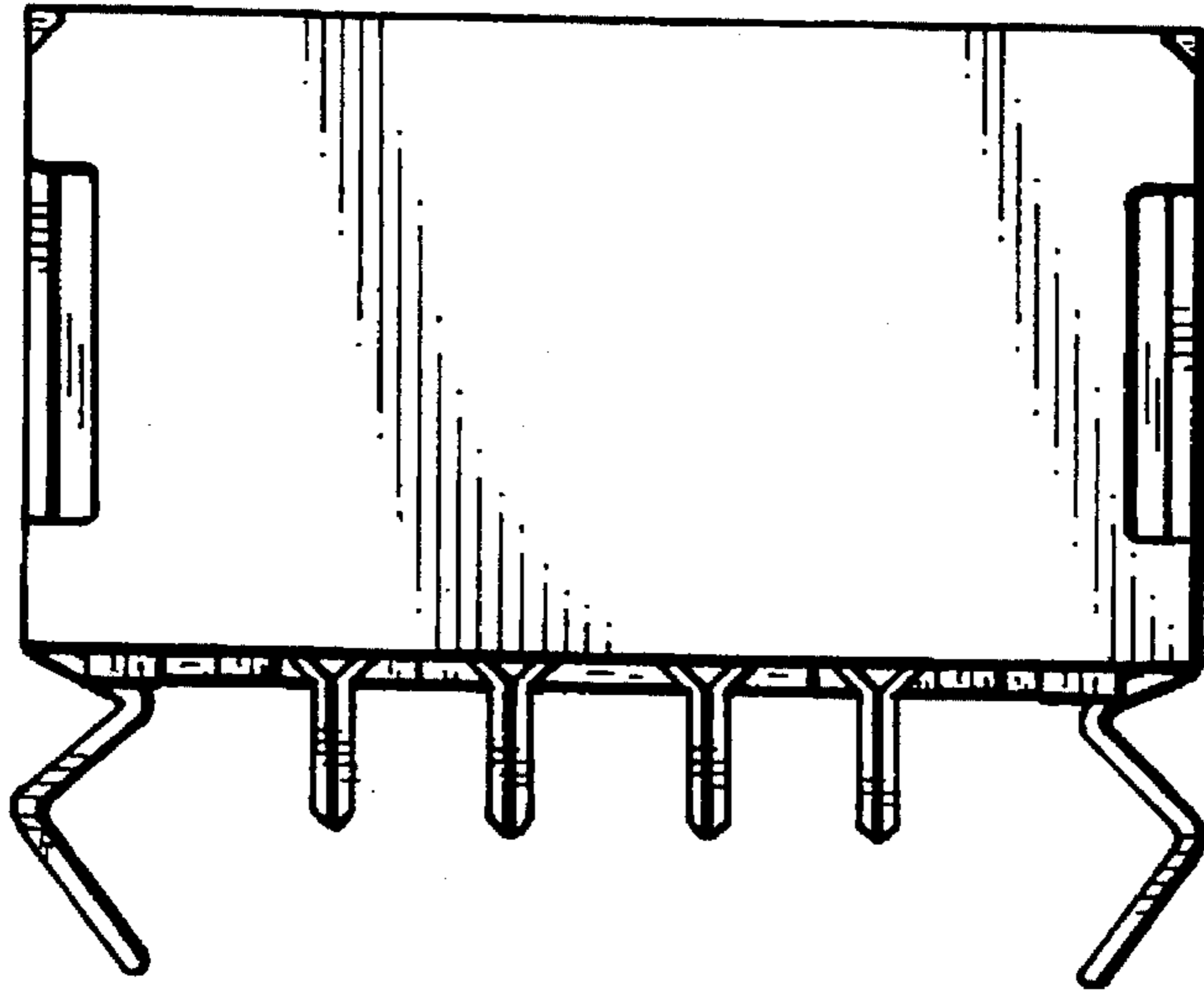

FIG. 2

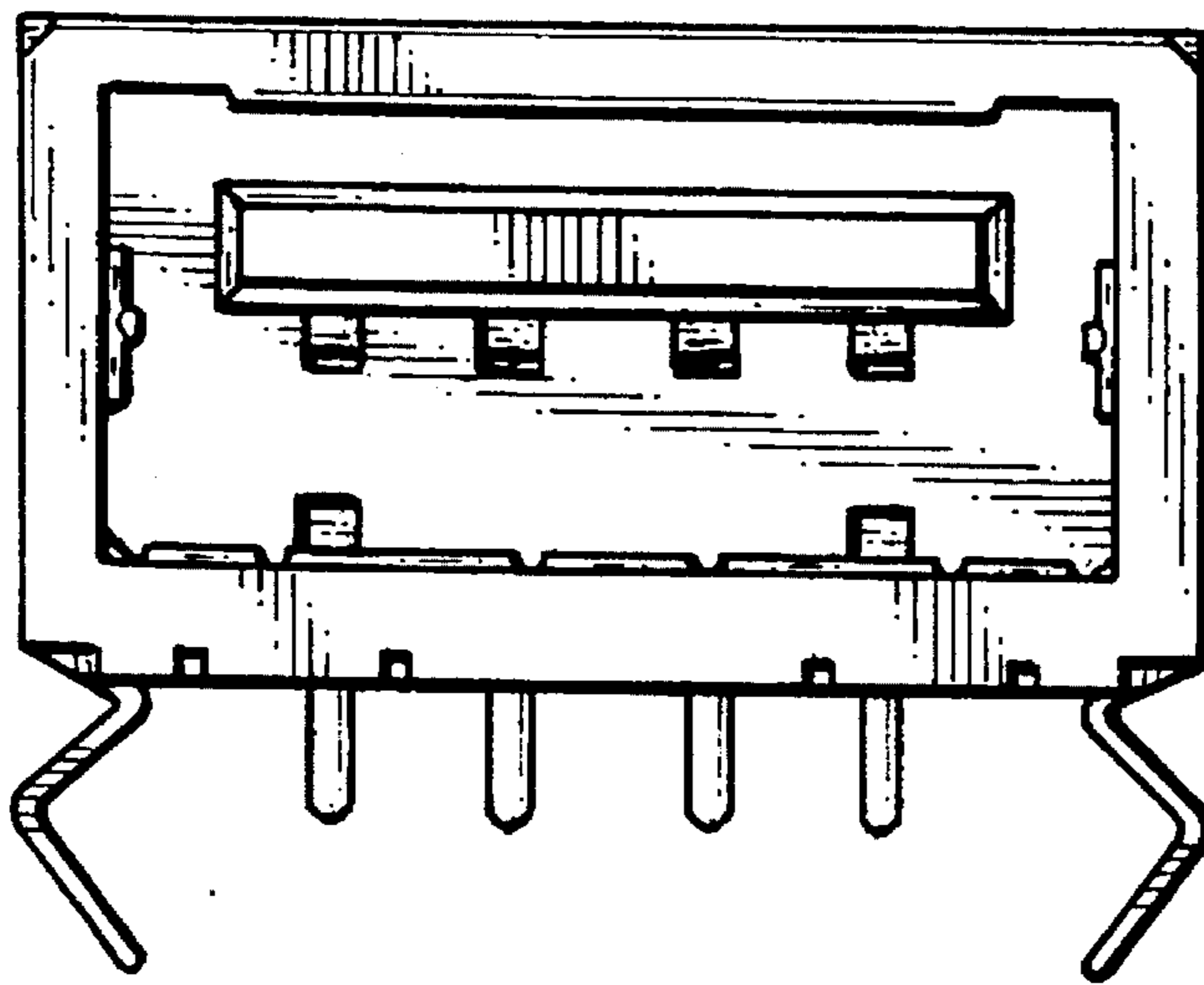

FIG. 3

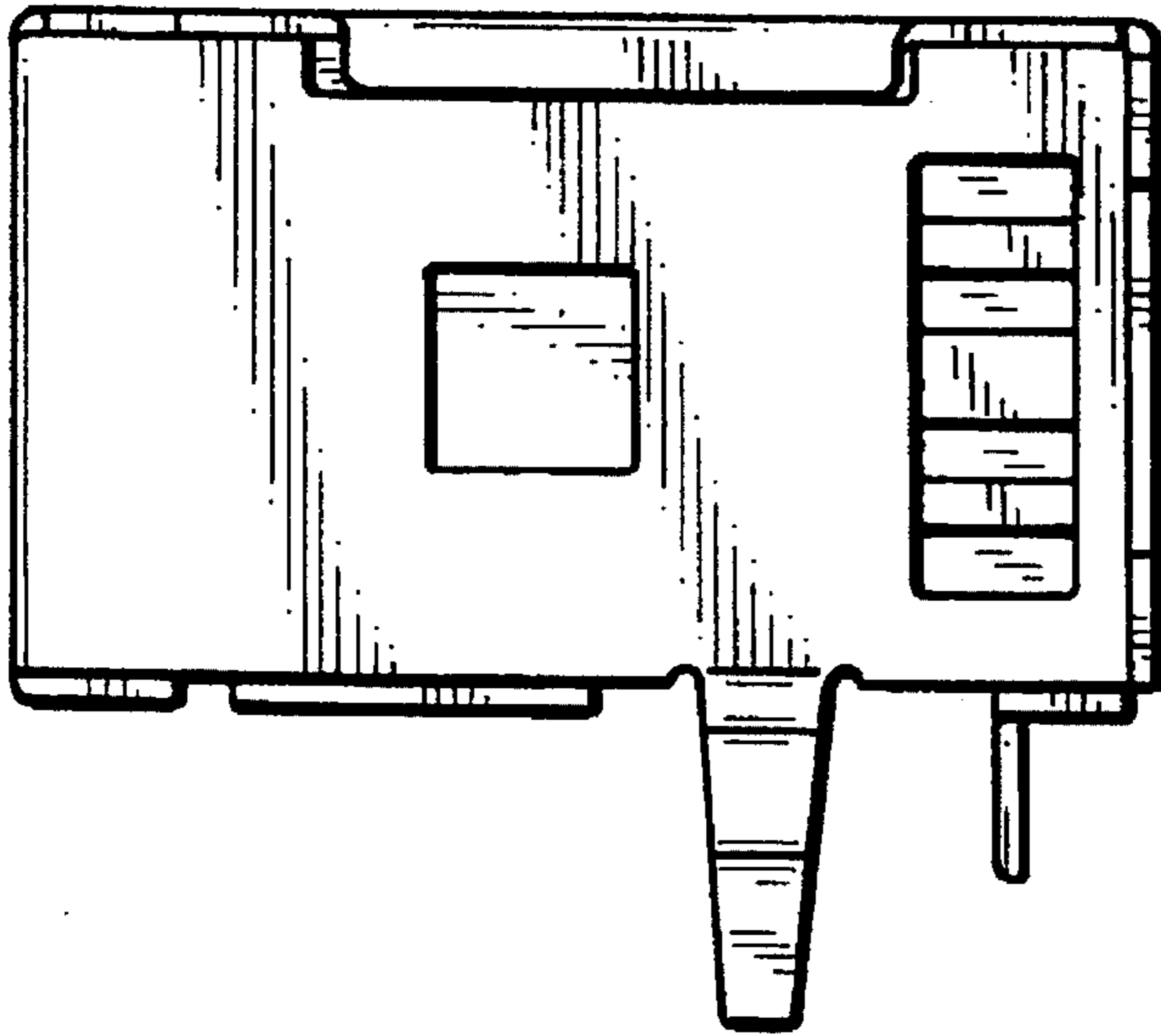

FIG. 4

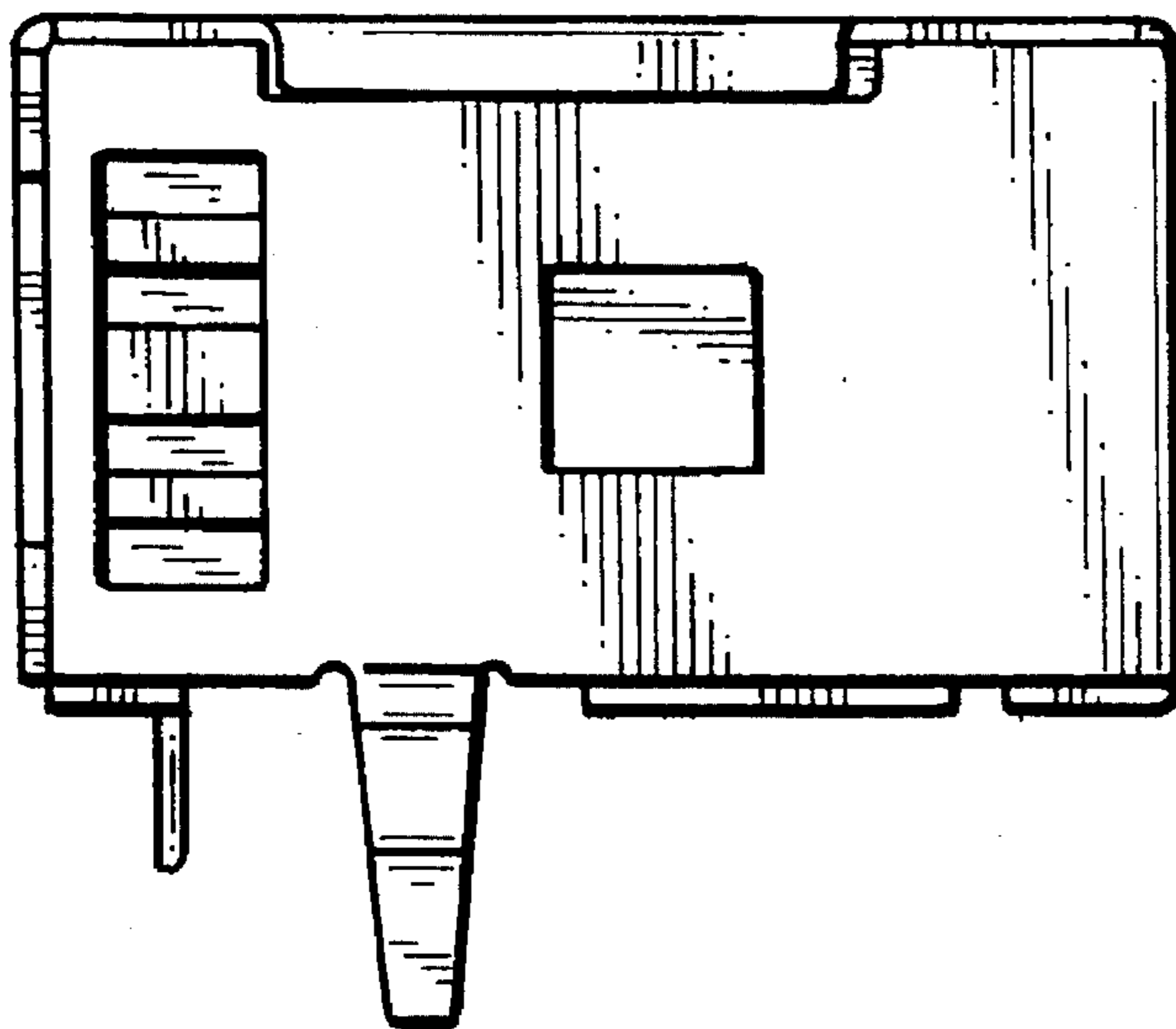

FIG. 5

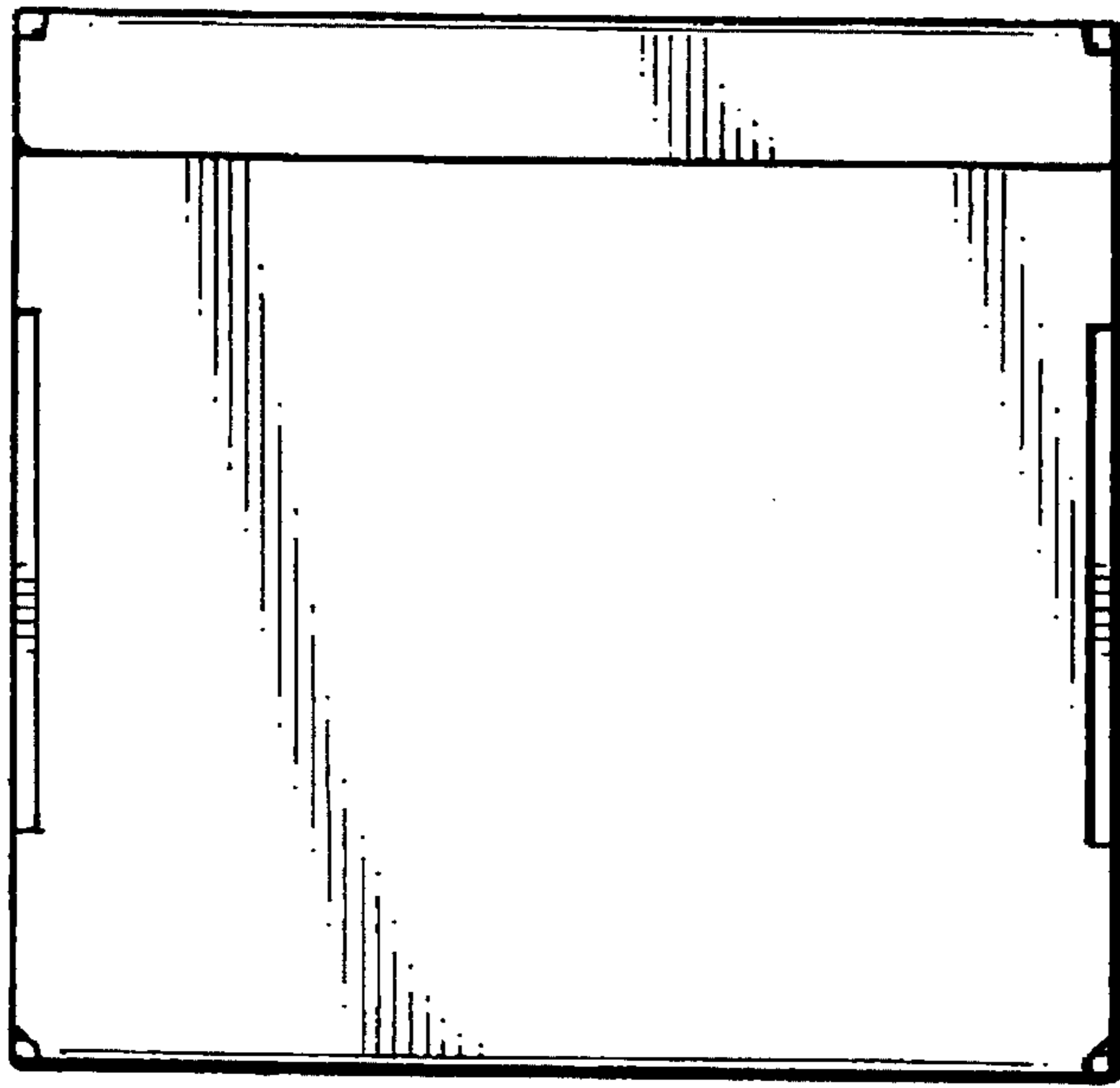

FIG. 6

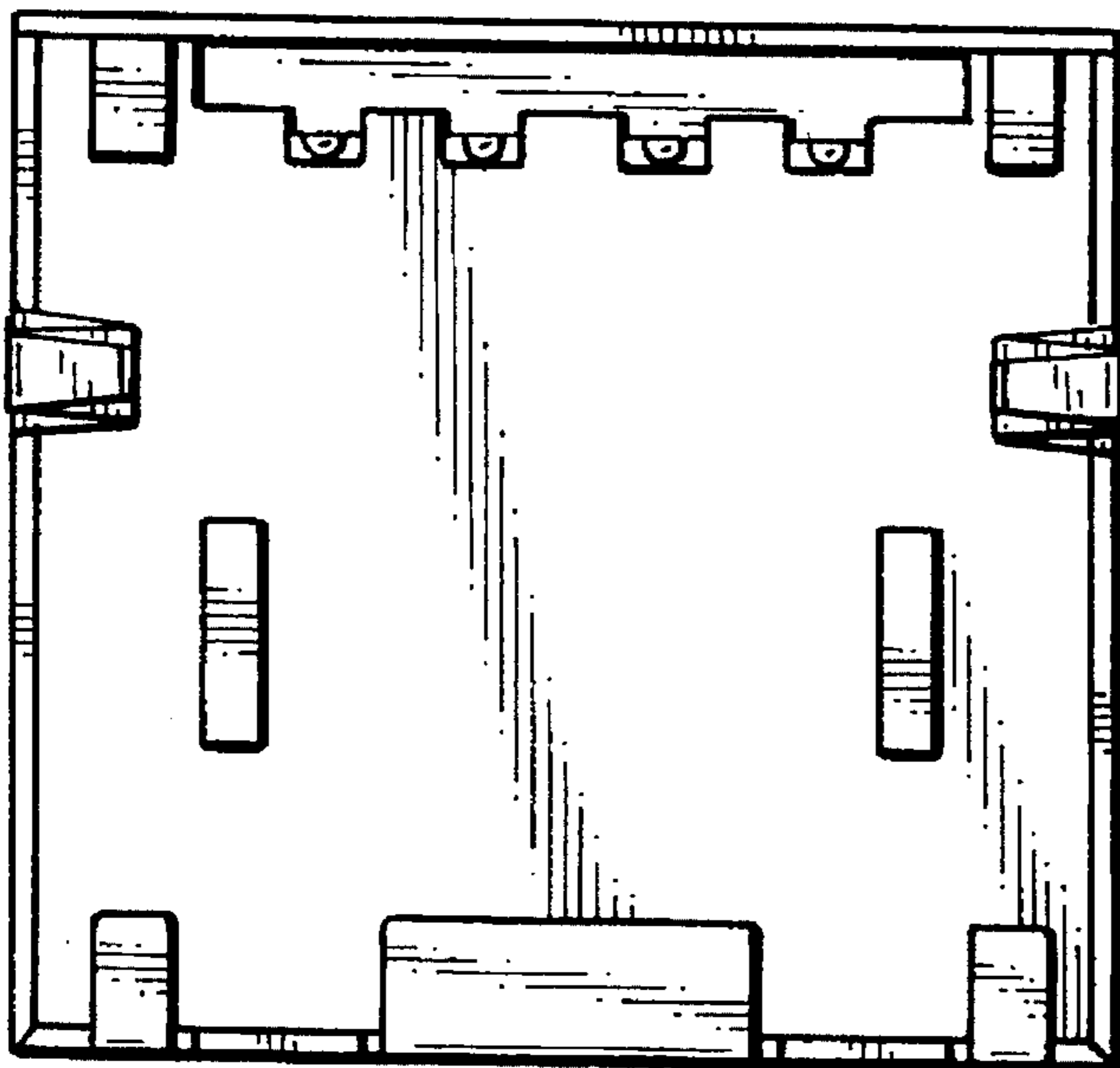

FIG. 7