



US00D372538S

United States Patent [19]

[11] Patent Number: **Des. 372,538**

Del Monte

[45] Date of Patent: ****Aug. 6, 1996**

[54] **SIX DOORWAY MODULAR HOUSING UNIT**

[76] Inventor: **Ernest J. Del Monte**, 46 Harwood La.,
East Rochester, N.Y. 14445

[**] Term: **14 Years**

[21] Appl. No.: **33,069**

[22] Filed: **Jan. 4, 1995**

[52] U.S. Cl. **D25/35**

[58] Field of Search D25/35; D21/114;
52/79.1; 446/476; D12/101, 103, 105

[56] **References Cited**

U.S. PATENT DOCUMENTS

1,754,590	5/1930	Allen	446/476
2,893,075	7/1959	Potchen et al.	D25/35
3,162,863	12/1964	Wokas	52/79.1
3,623,285	11/1971	Kelly	D25/35
3,811,722	5/1974	Jones	D12/103
4,114,328	9/1978	Lawrence	52/79.1
4,443,992	4/1984	Shechter	52/79.1

FOREIGN PATENT DOCUMENTS

350449306	6/1993	Australia	52/79.1
899022	5/1972	Canada	52/79.1
779485	7/1957	United Kingdom	52/79.1

Primary Examiner—Louis S. Zarfes
Assistant Examiner—Gregory Andoll
Attorney, Agent, or Firm—Cumpston & Shaw

[57] **CLAIM**

The ornamental design for a six doorway modular housing unit, as shown and described.

DESCRIPTION

FIG. 1 is a perspective view of the first embodiment of my design on a reduced scale;
 FIG. 2 is a top plan view thereof;
 FIG. 3 is a front elevational view thereof;
 FIG. 4 is a rear elevational view thereof;
 FIG. 5 is a left end elevational view thereof;
 FIG. 6 is a right end elevational view thereof;
 FIG. 7 is a bottom plan view thereof;
 FIG. 8 is a perspective view of the second embodiment of my design on a reduced scale thereof;
 FIG. 9 is a top plan view thereof;
 FIG. 10 is a front elevational view thereof;
 FIG. 11 is a rear elevational view thereof;
 FIG. 12 is a left end elevational view thereof;
 FIG. 13 is right end elevational view thereof; and,
 FIG. 14 is a bottom plan view thereof.

1 Claim, 14 Drawing Sheets

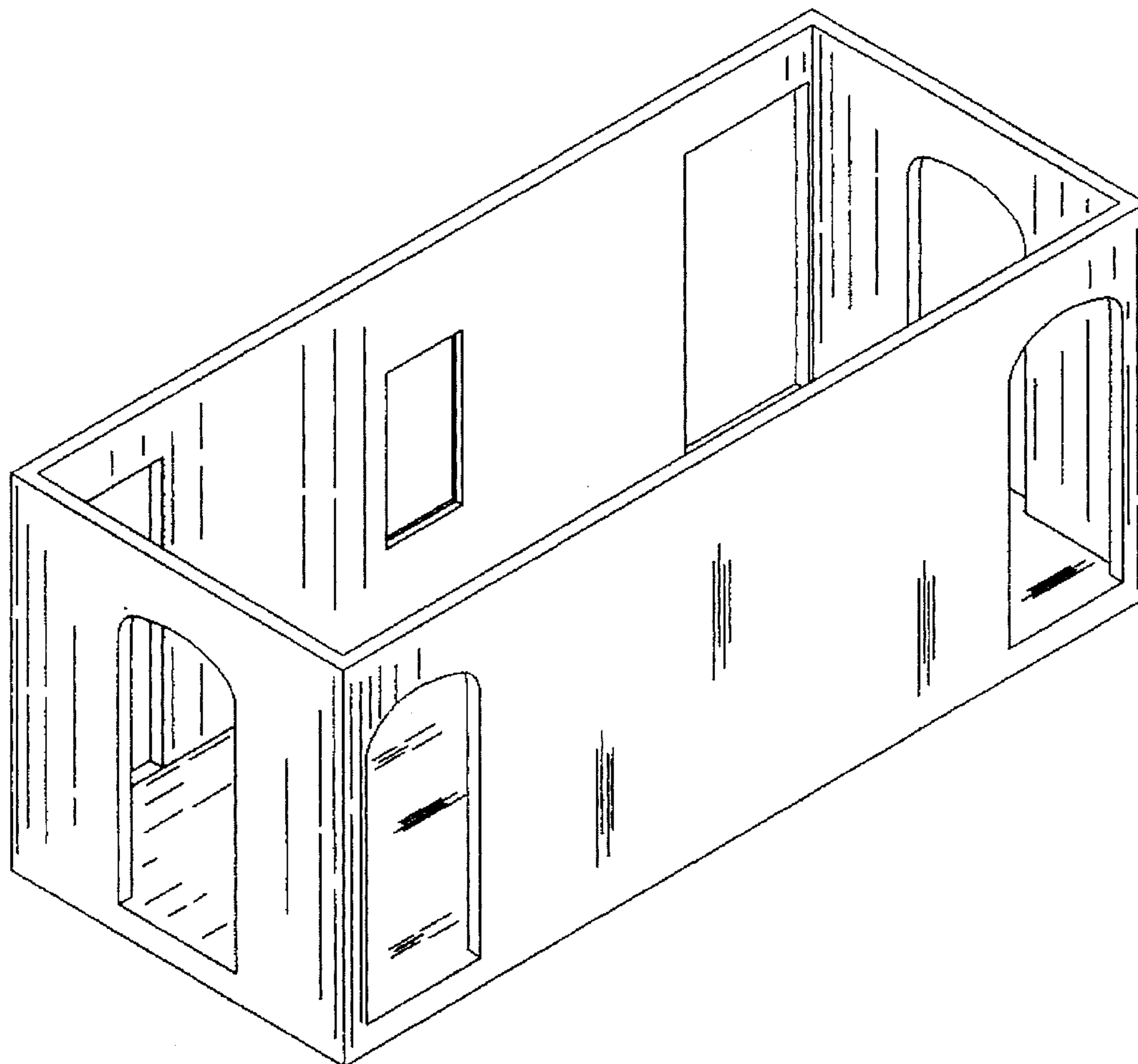

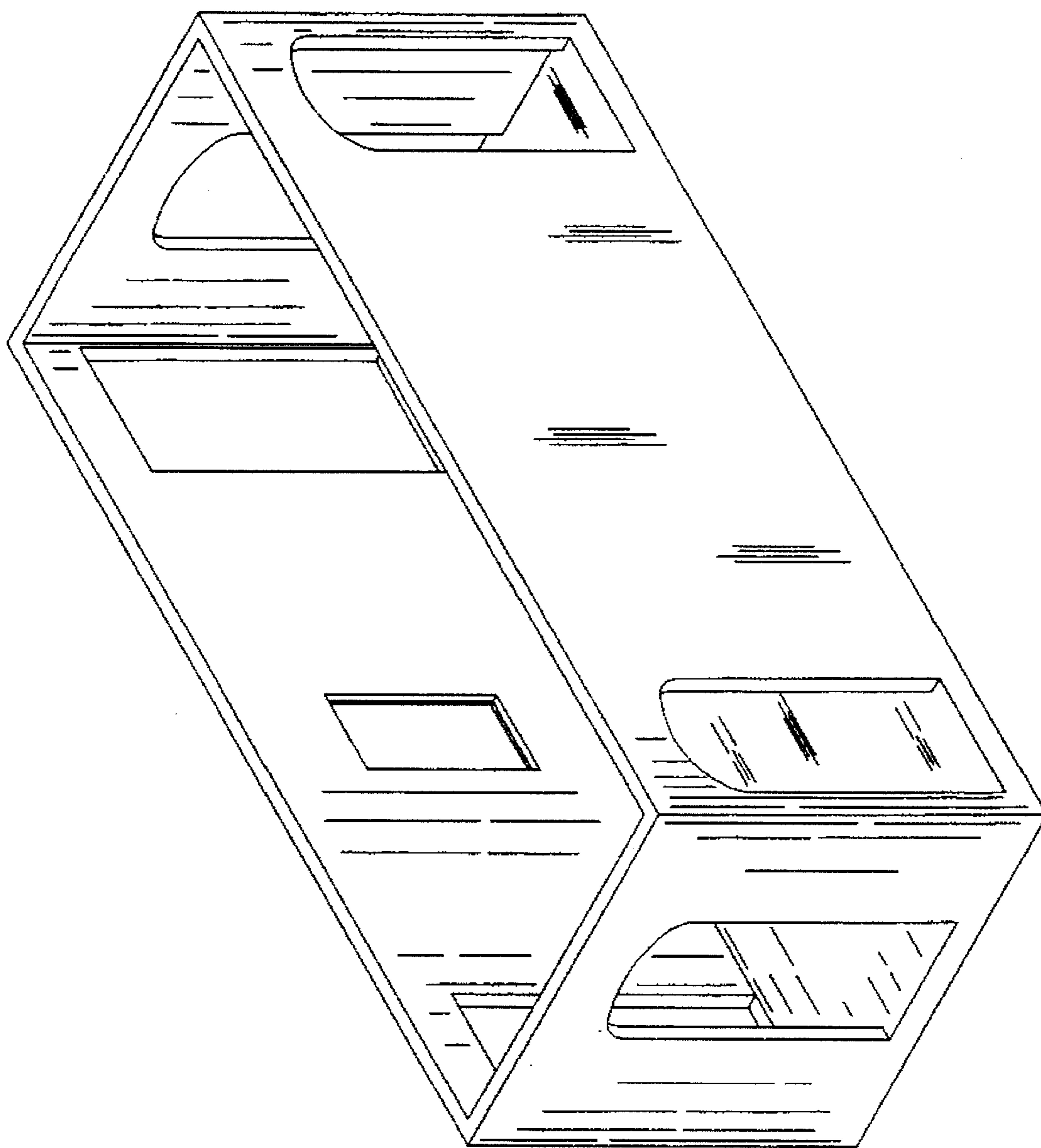

Figure 1

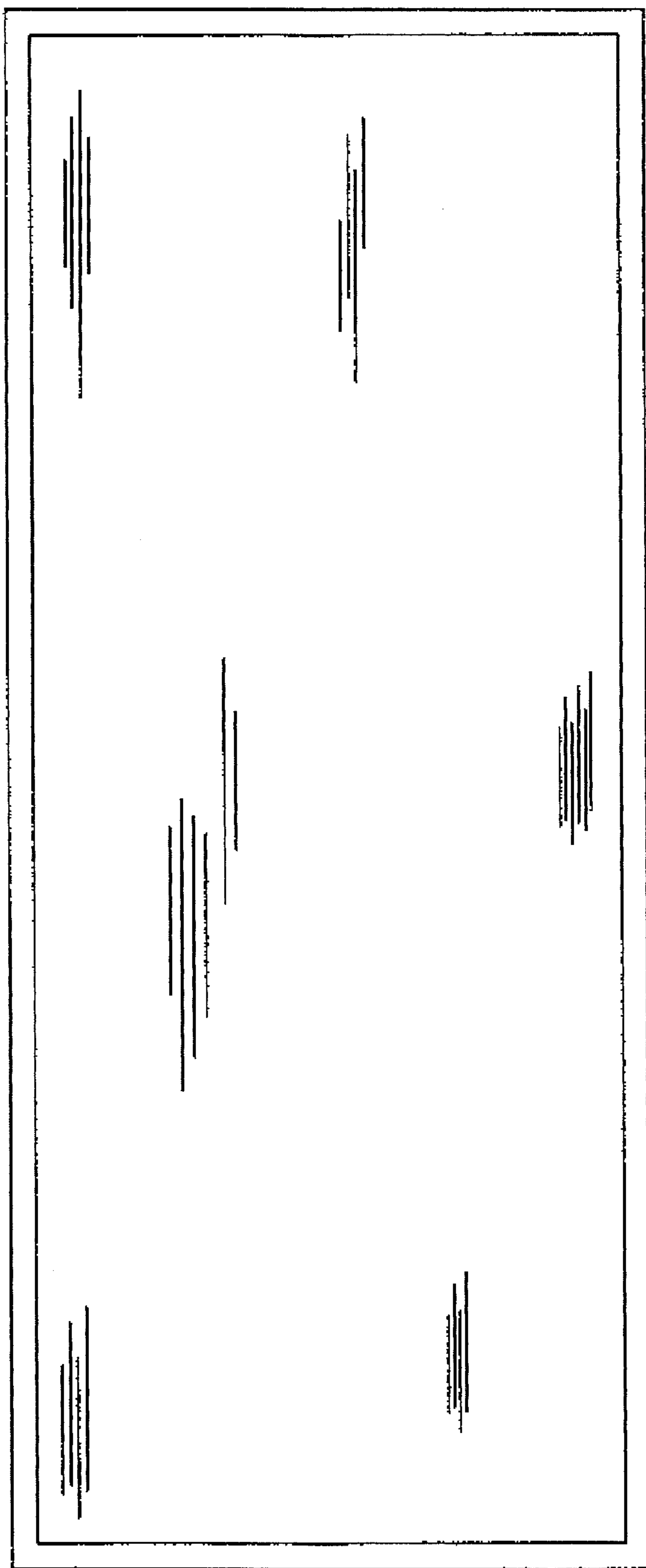

Figure 2

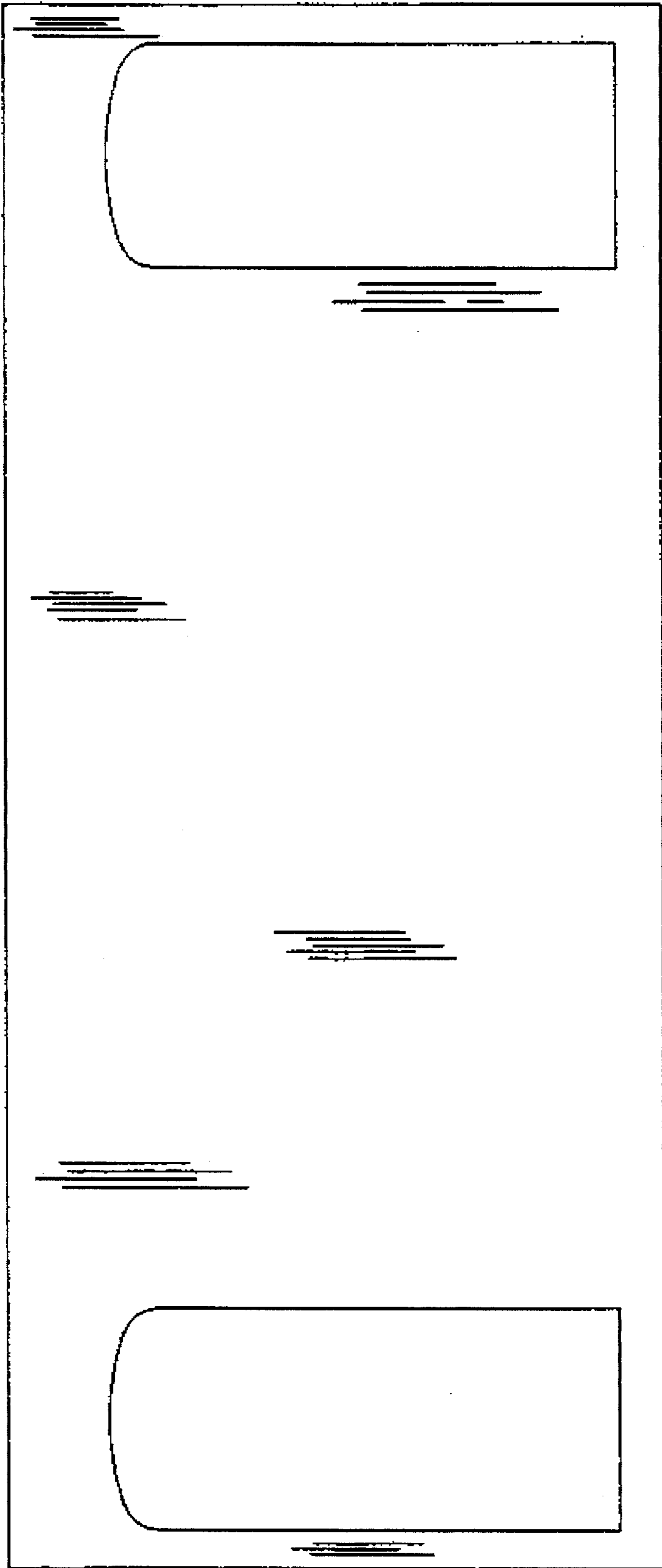

Figure 3

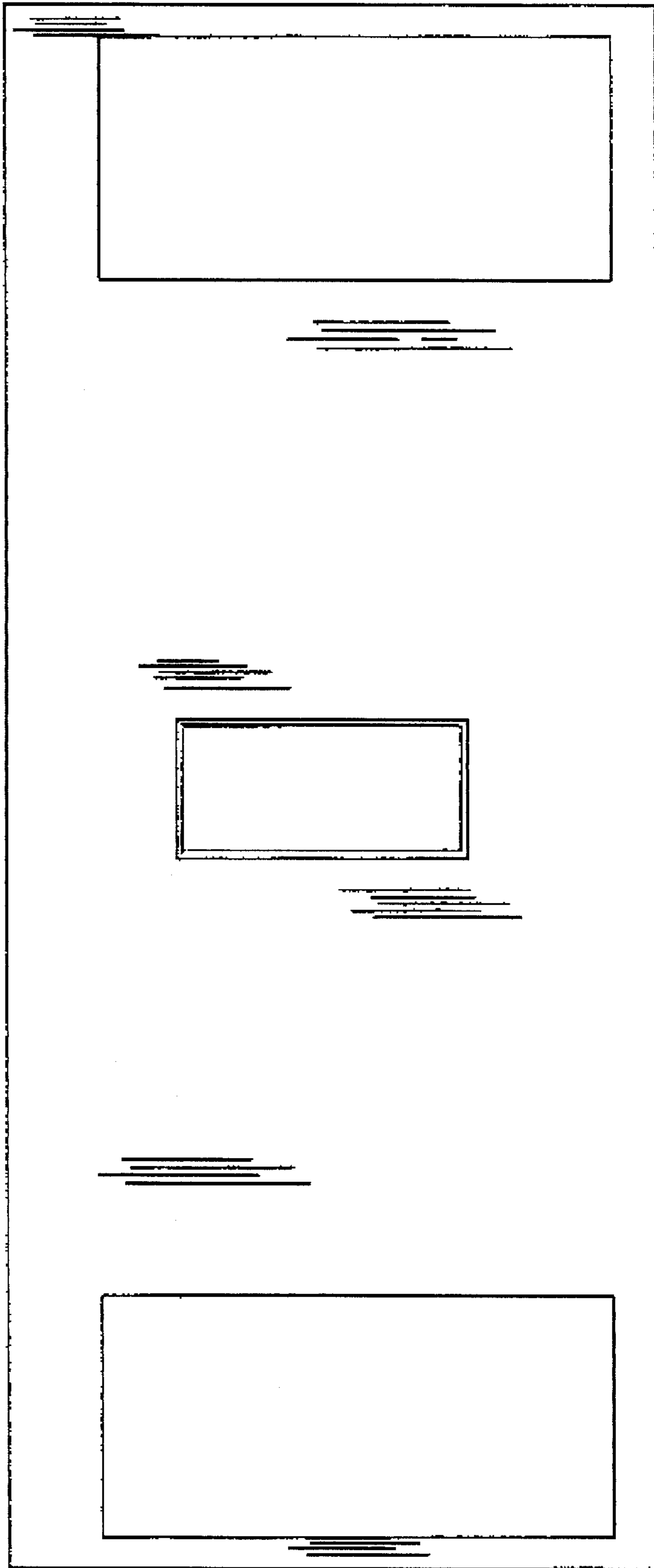

Figure 4

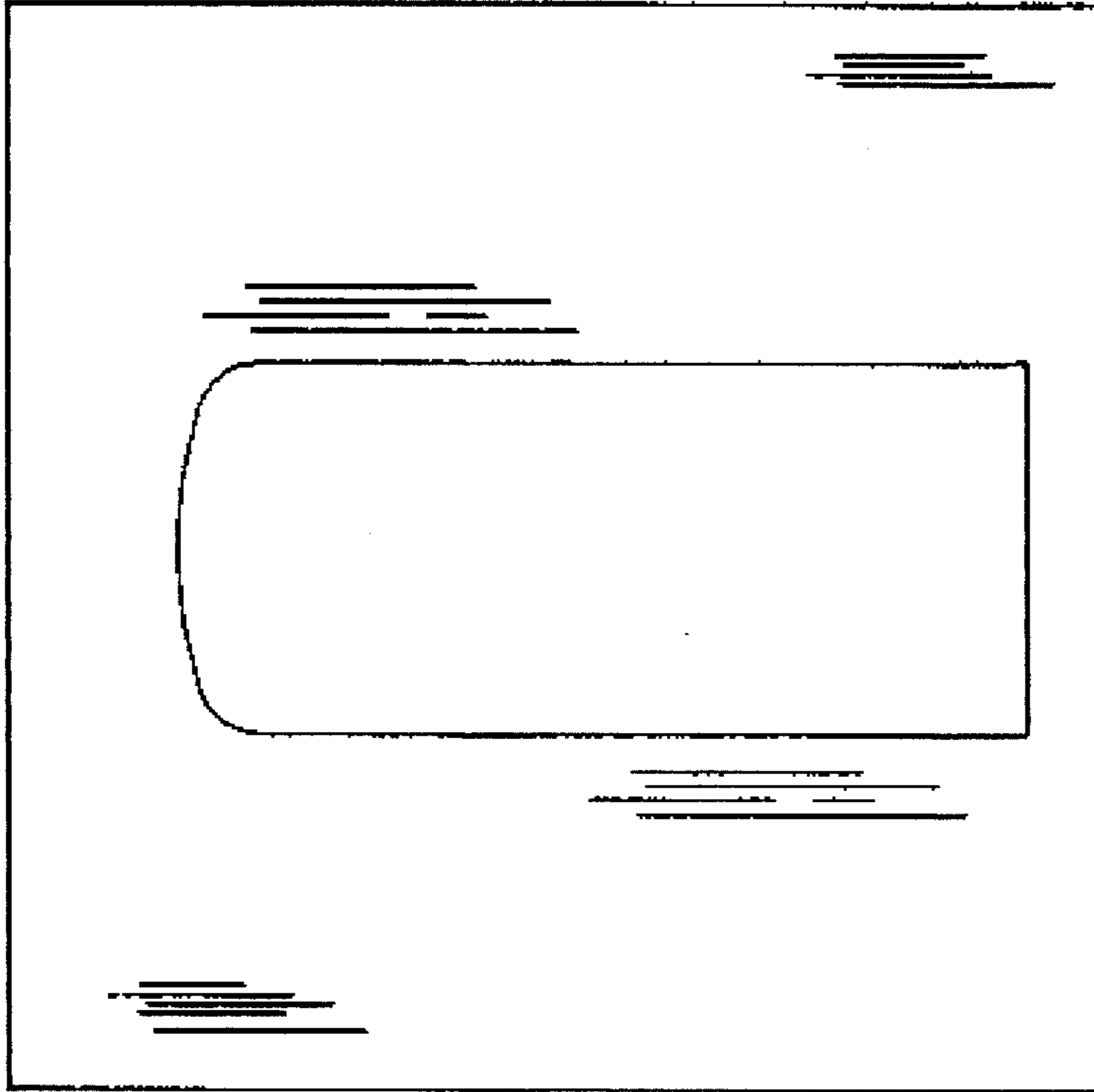

Figure 5

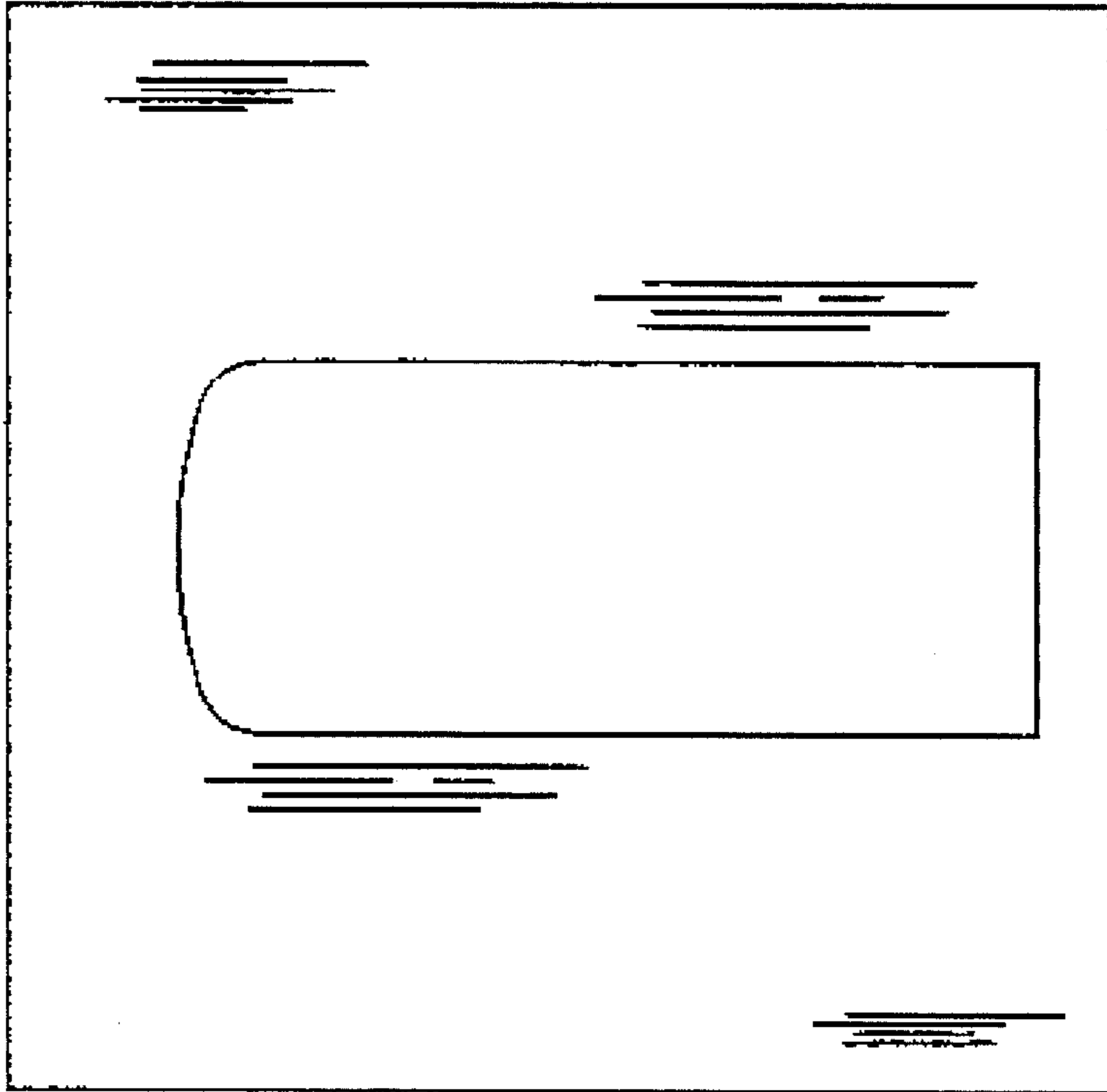

Figure 6

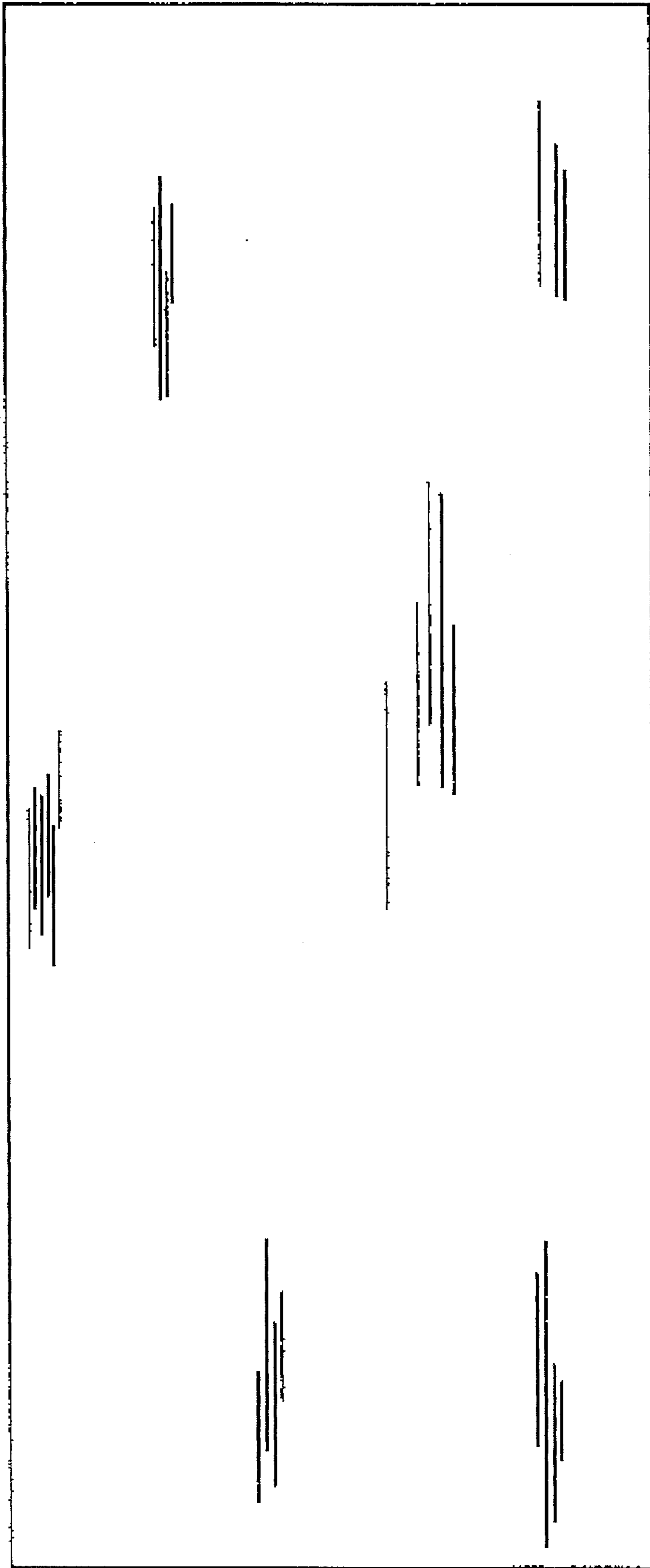

Figure 7

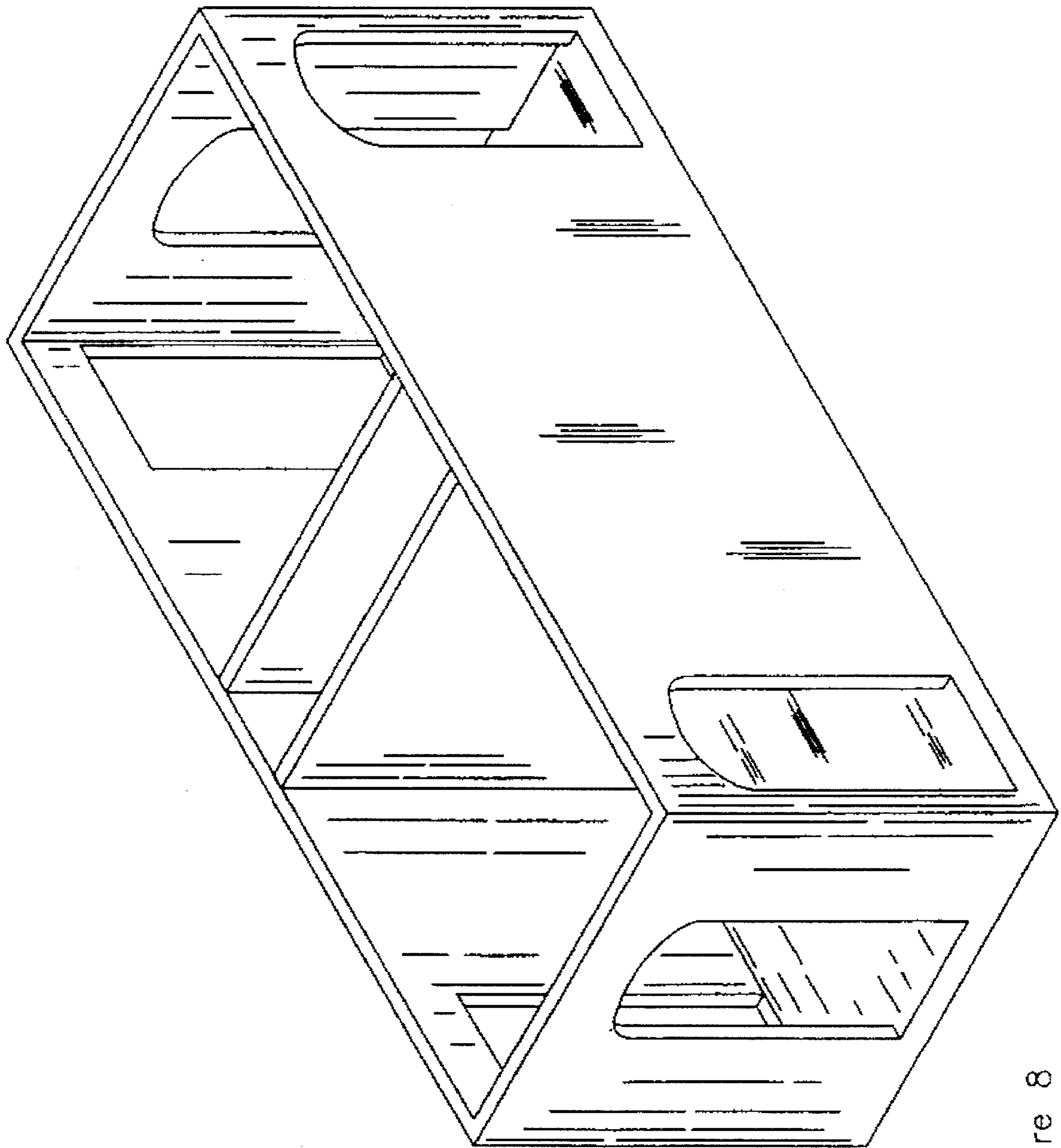

Figure 8

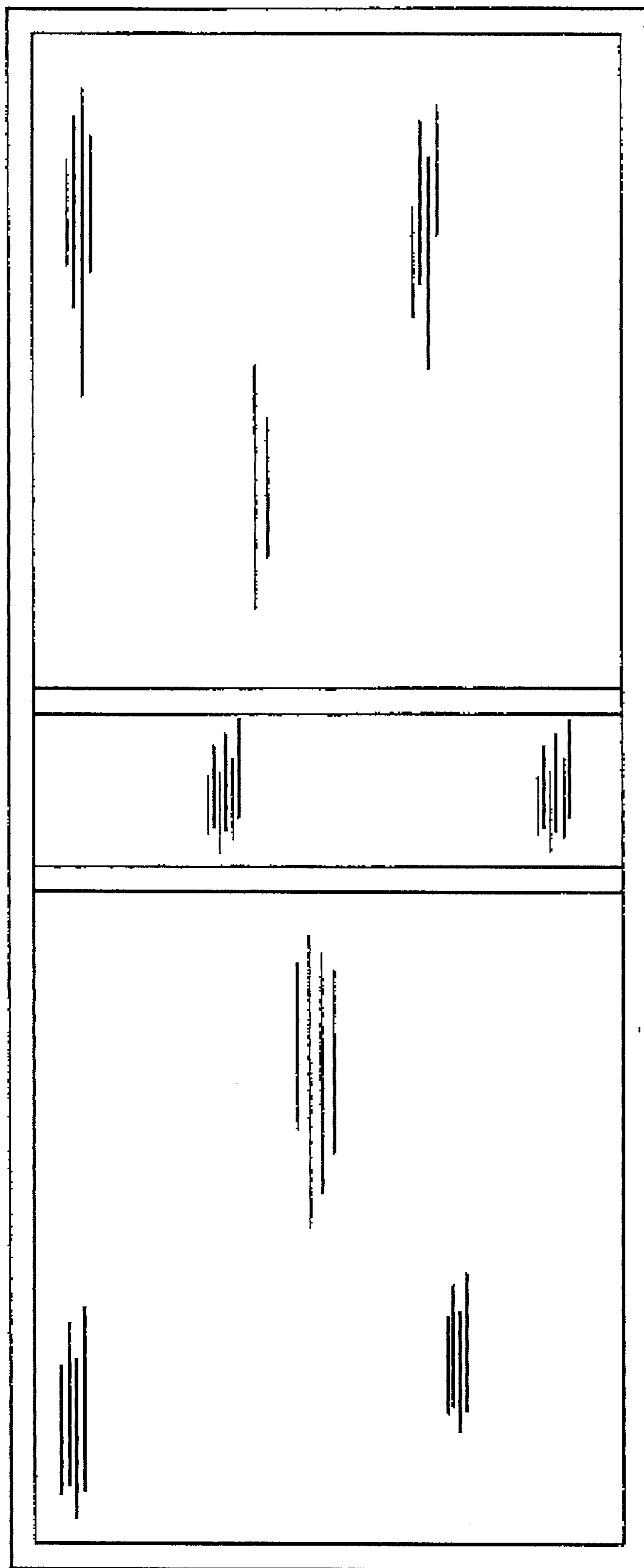

Figure 9

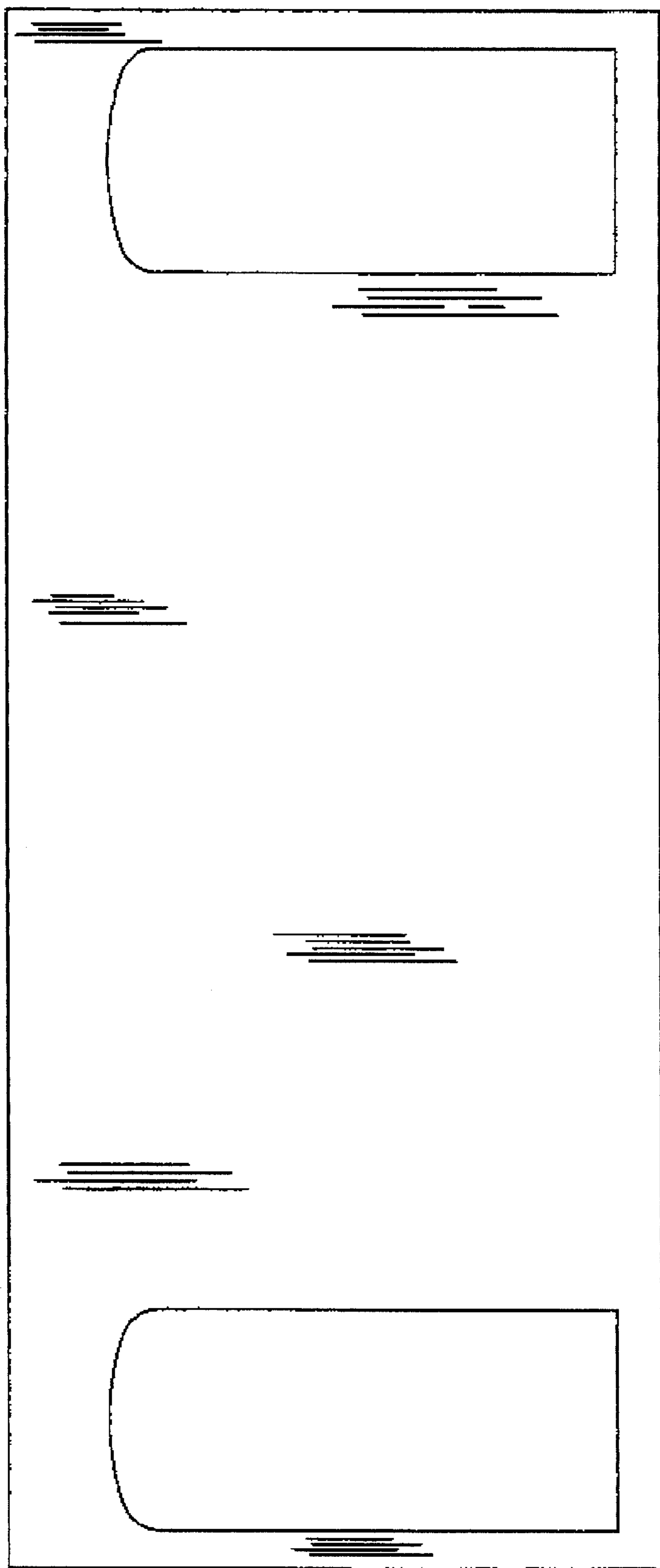

Figure 10

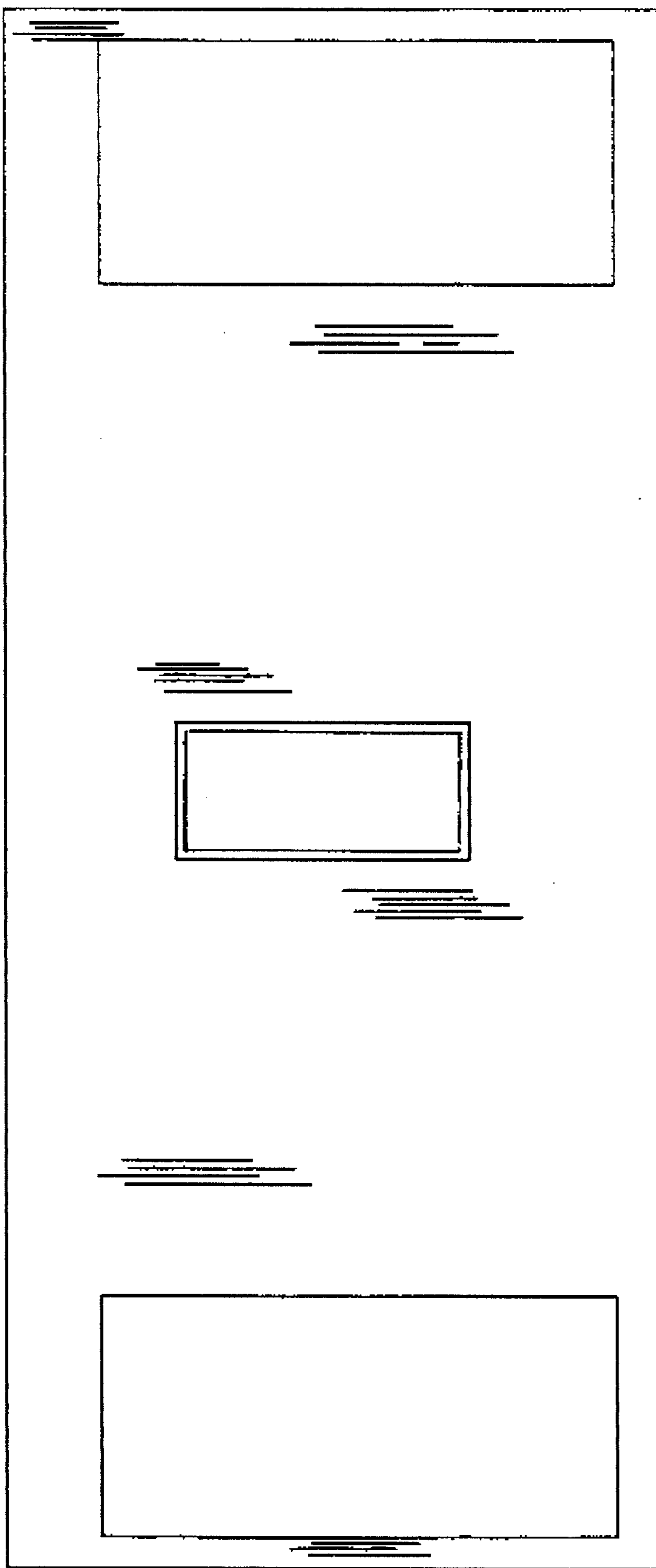

Figure 11

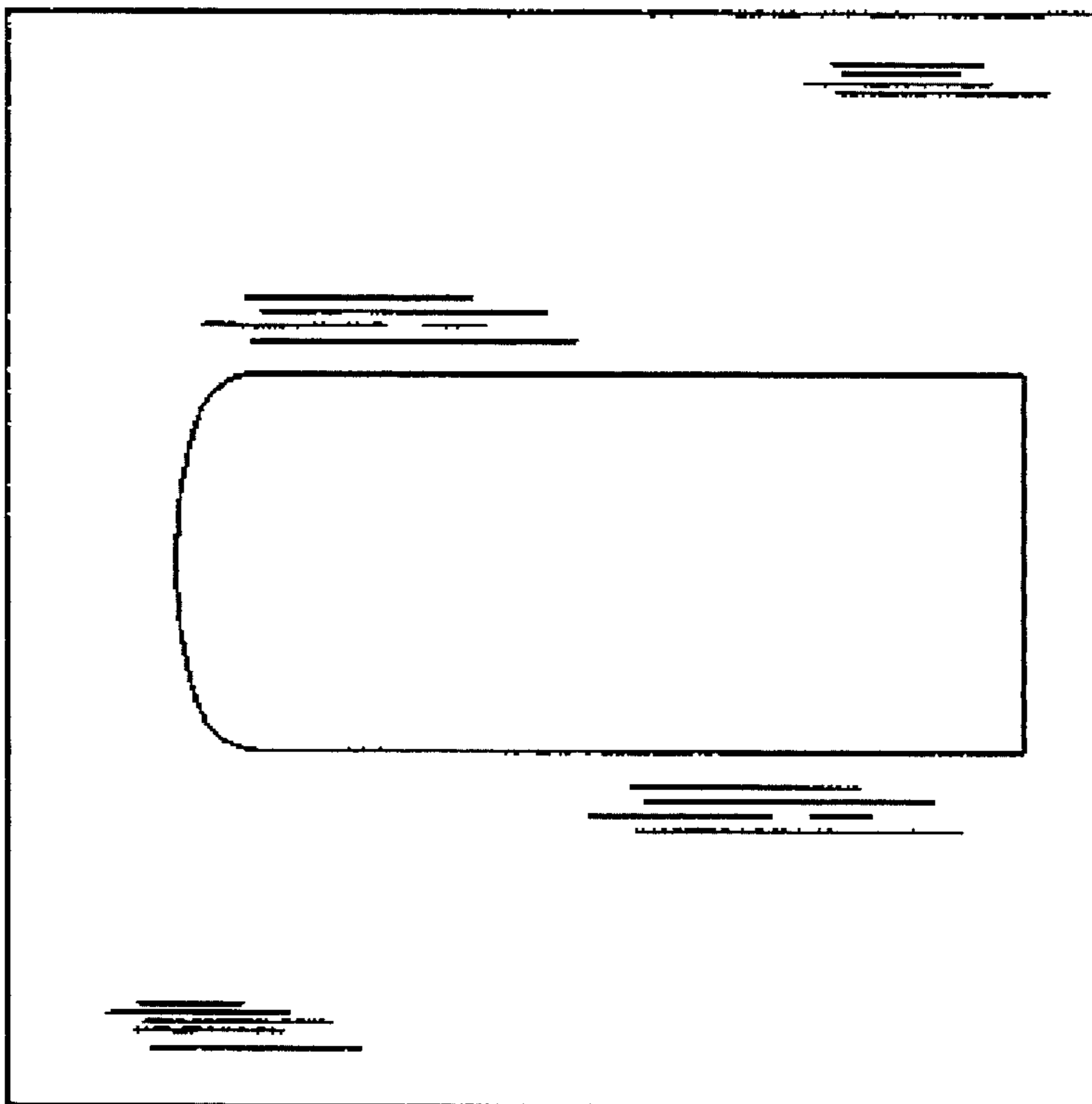

Figure 12

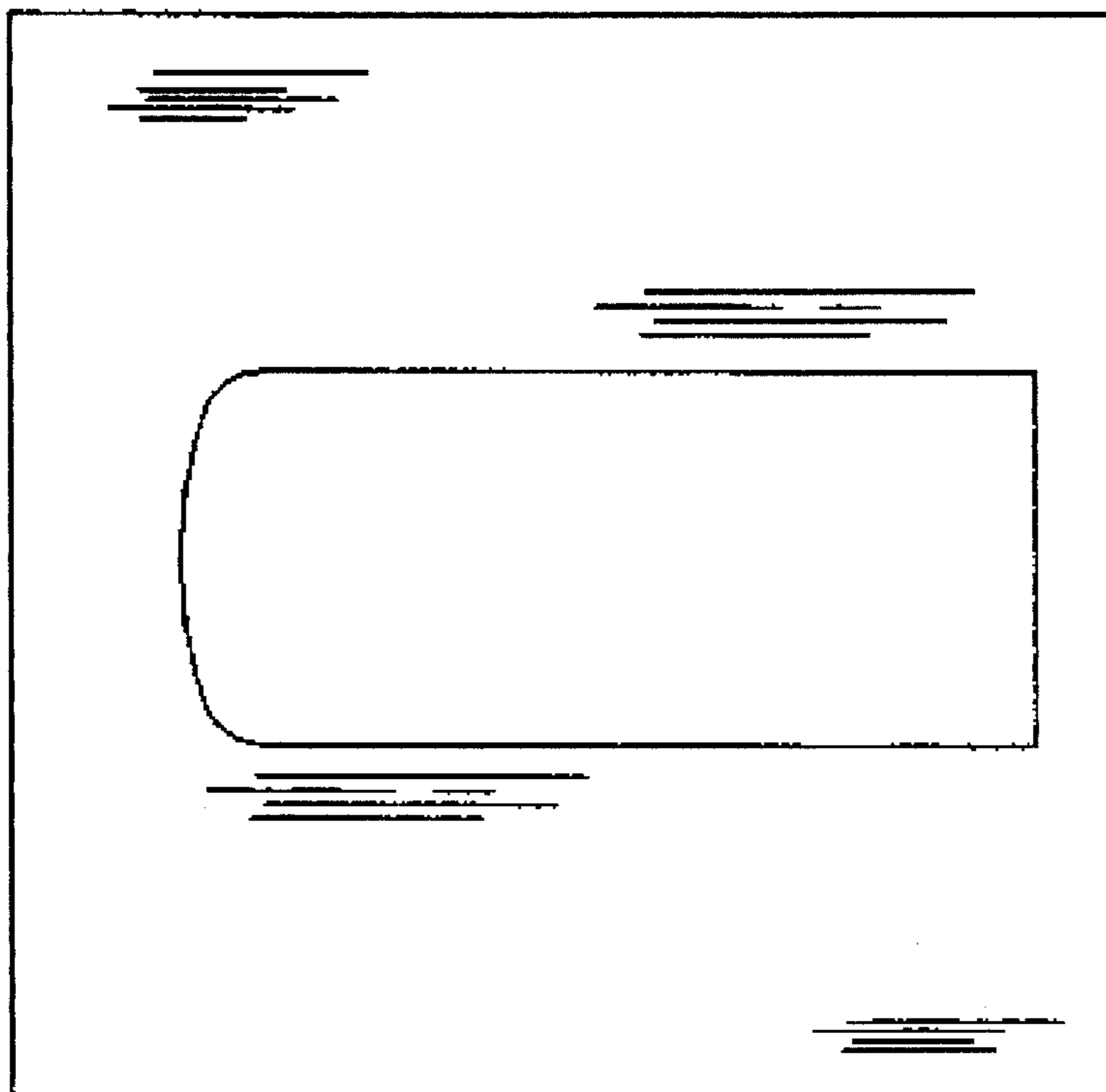

Figure 13

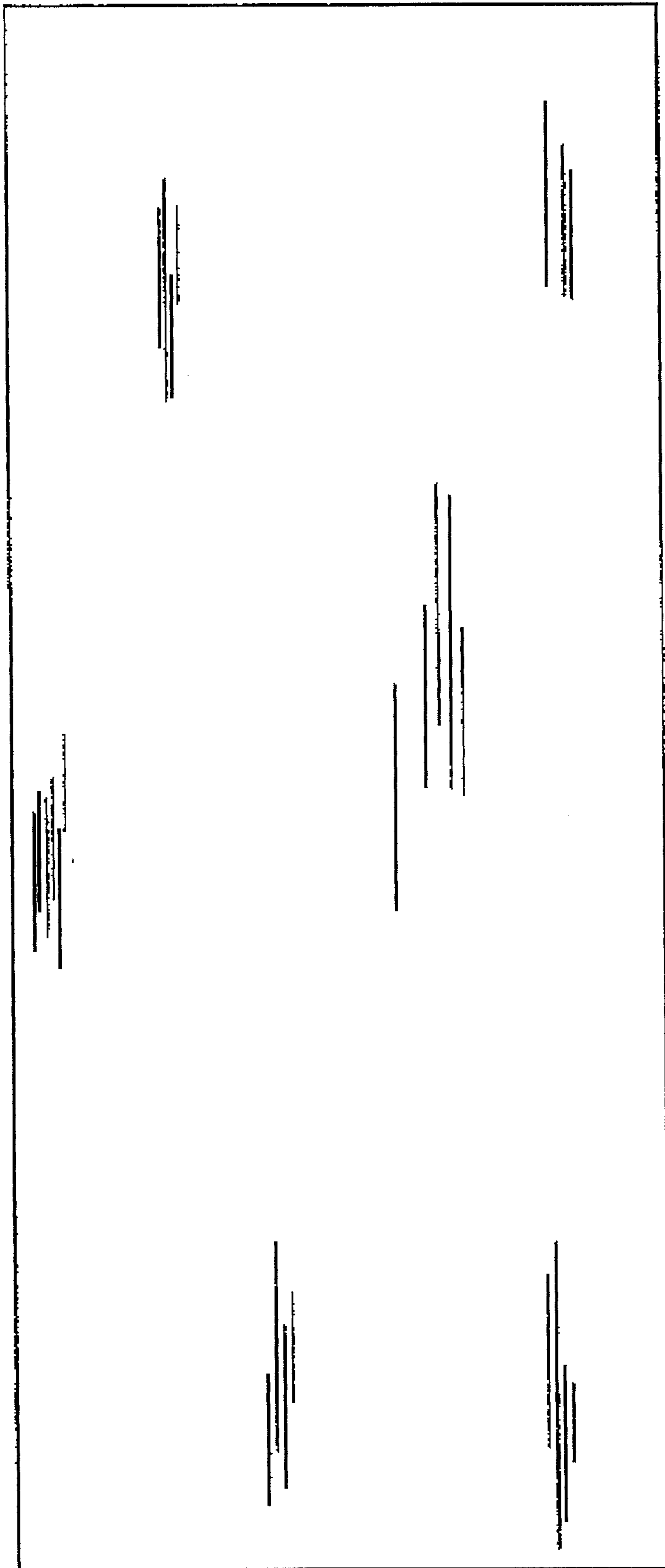

Figure 14