



US00D372107S

# United States Patent [19]

[11] Patent Number: **Des. 372,107**

Dunlap et al.

[45] Date of Patent: **\*\*Jul. 23, 1996**

[54] **FENCE PANEL**

*Attorney, Agent, or Firm*—Eckert Seamans Cherin & Mellott

[75] Inventors: **Donald W. Dunlap**, Lancaster; **John J. Morris, Jr.**, Downingtown, both of Pa.

[57] **CLAIM**

The ornamental design for a fence panel, as shown and described.

[73] Assignee: **Hessian Co., Limited**, Downingtown, Pa.

[\*\*] Term: **14 Years**

### DESCRIPTION

[21] Appl. No.: **19,256**

FIG. 1 is a front perspective view of the fence panel of the invention (the other side being substantially identical thereto);

[22] Filed: **Feb. 25, 1994**

FIG. 2 is a top plan view of the fence panel of FIG. 1 (the bottom plan view being substantially identical thereto);

[52] U.S. Cl. .... **D25/113; D25/38; D25/58**

FIG. 3 is a front elevational view of the fence panel of FIG. 1;

[58] Field of Search ..... **D25/38, 39, 58, D25/113, 138; 256/24, 73; 405/284, 286**

### [56] References Cited

#### U.S. PATENT DOCUMENTS

D. 191,867	12/1961	Luck .....	D13/1
D. 248,571	7/1978	Herbst .....	D25/38
D. 275,705	9/1984	Gabriel .....	D25/73
1,012,868	12/1911	Laney .	
3,132,447	5/1964	Hoslein .....	D25/113
3,298,668	1/1967	Schoeren .....	D25/113
3,393,896	7/1968	Poland .....	256/19
3,554,495	1/1971	Bach .....	256/19
3,902,702	9/1975	Kinranna .....	256/24
4,143,495	3/1979	Hintz .....	52/145
4,402,384	9/1983	Smith et al. ....	181/210
4,512,685	4/1985	Hegle .....	405/284
4,558,850	12/1985	Melfi .....	256/24
4,605,090	8/1986	Melfi .....	181/210
4,674,593	6/1987	McCarthy .....	181/210
4,825,619	5/1989	Forsberg .....	D25/58
4,838,524	6/1989	McKeown et al. ....	256/24
4,964,486	10/1990	D'Antonio et al. ....	181/285
5,044,834	9/1991	Janopaul, Jr. ....	405/284
5,145,288	9/1992	Borchardt .....	405/286

FIG. 4 is a front perspective view of one side of another embodiment of the fence panel (the other side being substantially identical thereto);

FIG. 5 is a top plan view of the fence panel of FIG. 4 (the bottom plan view being substantially identical thereto);

FIG. 6 is a front elevational view of the fence panel of FIG. 4;

FIG. 7 is a front perspective view of one side of a third embodiment of the fence panel (the other side being substantially identical thereto);

FIG. 8 is a top plan view of the fence panel of FIG. 7 (the bottom plan view being substantially identical thereto);

FIG. 9 is a front elevational view of the fence panel of FIG. 7;

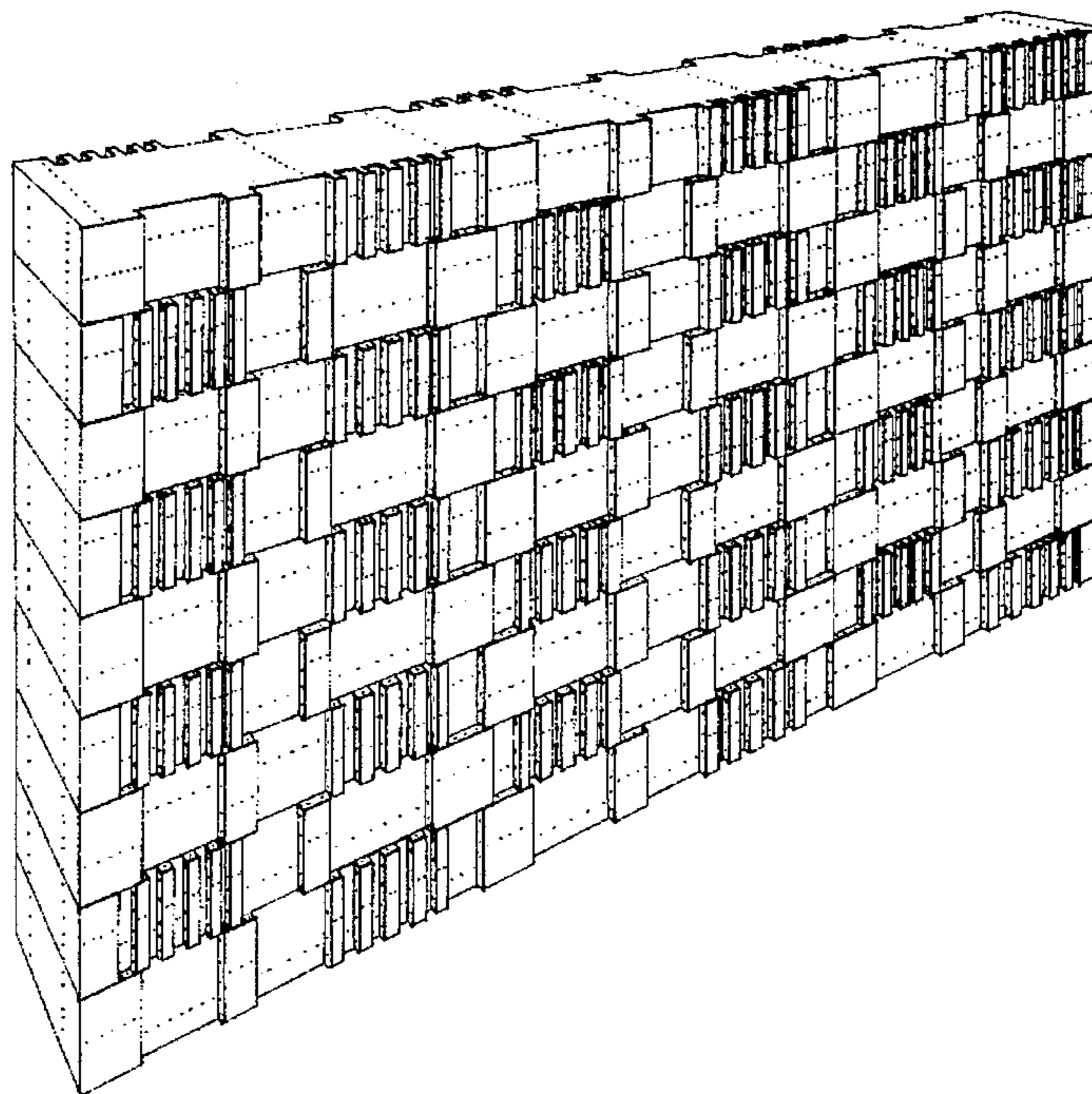
FIG. 10 is a front perspective view of one side of a fourth embodiment of the fence panel (the other side being substantially identical thereto);

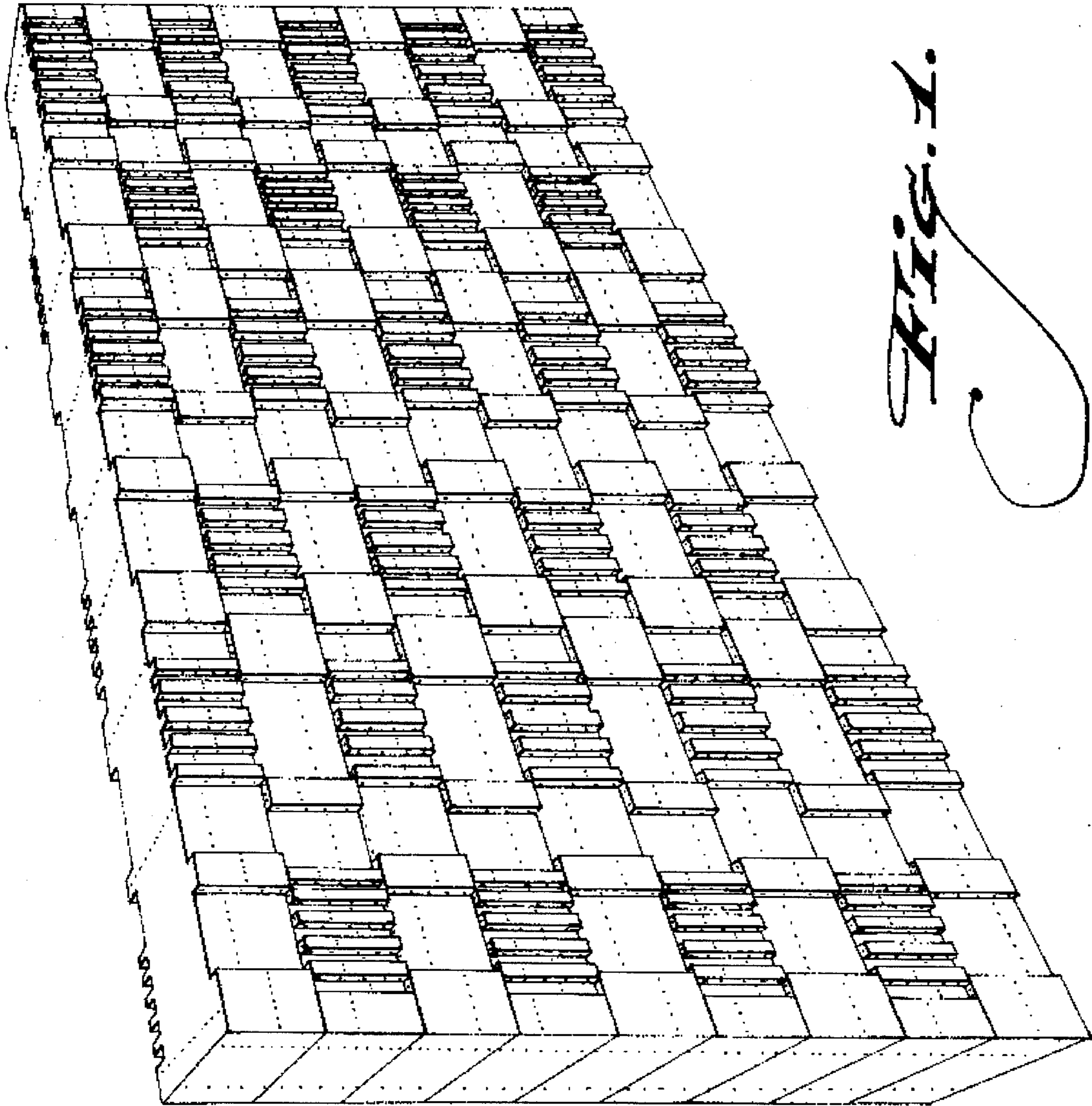
FIG. 11 is a top plan view of the fence panel of FIG. 10 (the bottom plan view being substantially identical thereto); and,

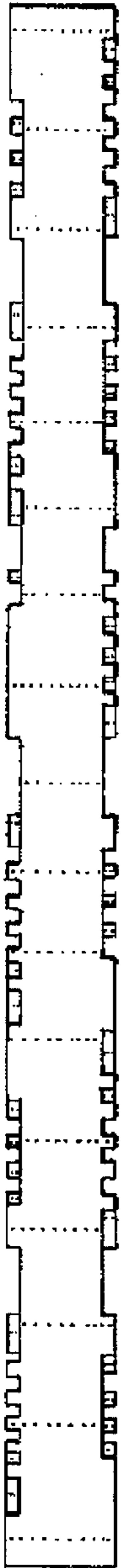
FIG. 12 is a front elevational view of the fence panel of FIG. 10.

*Primary Examiner*—Doris Clark

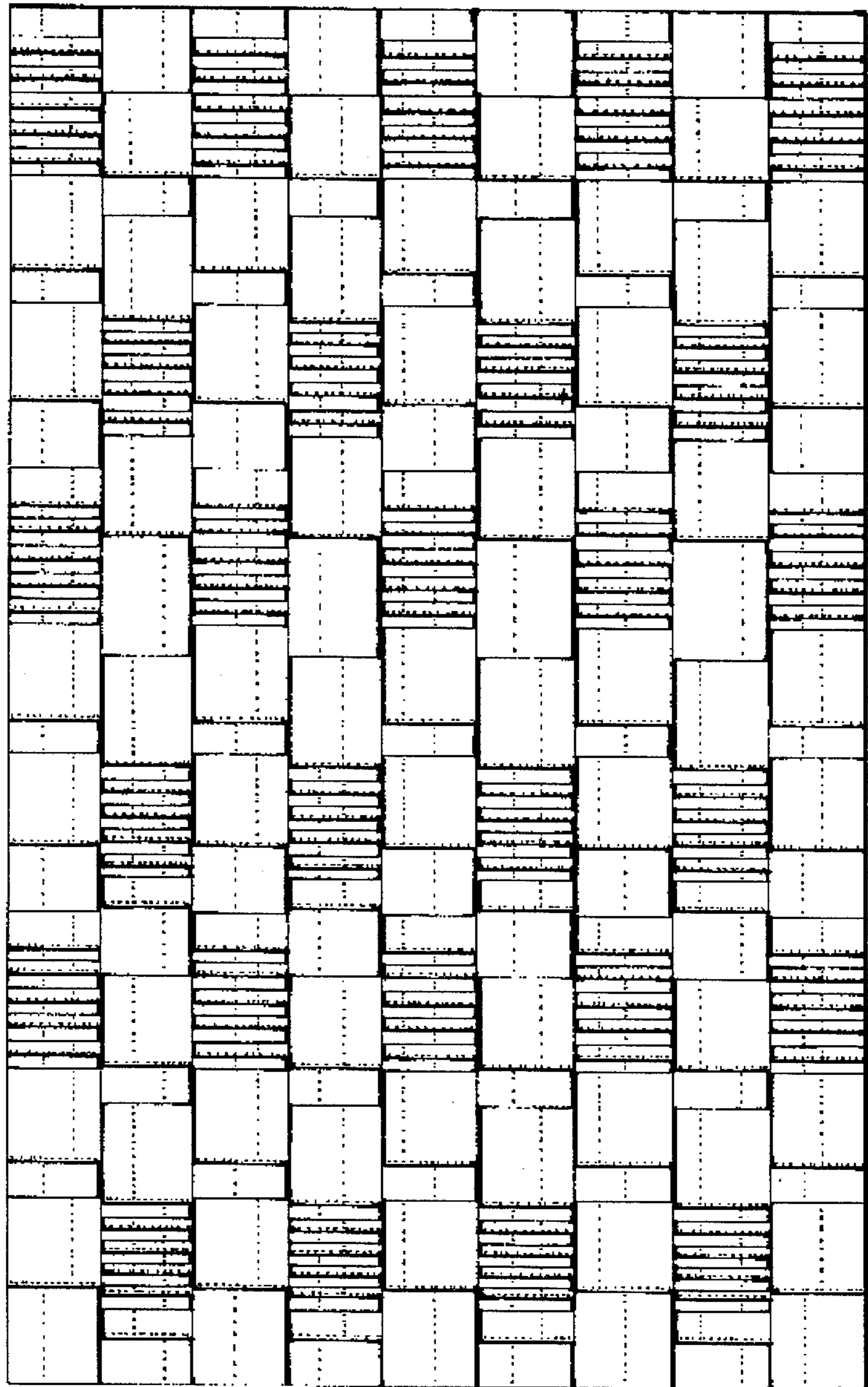
**1 Claim, 8 Drawing Sheets**



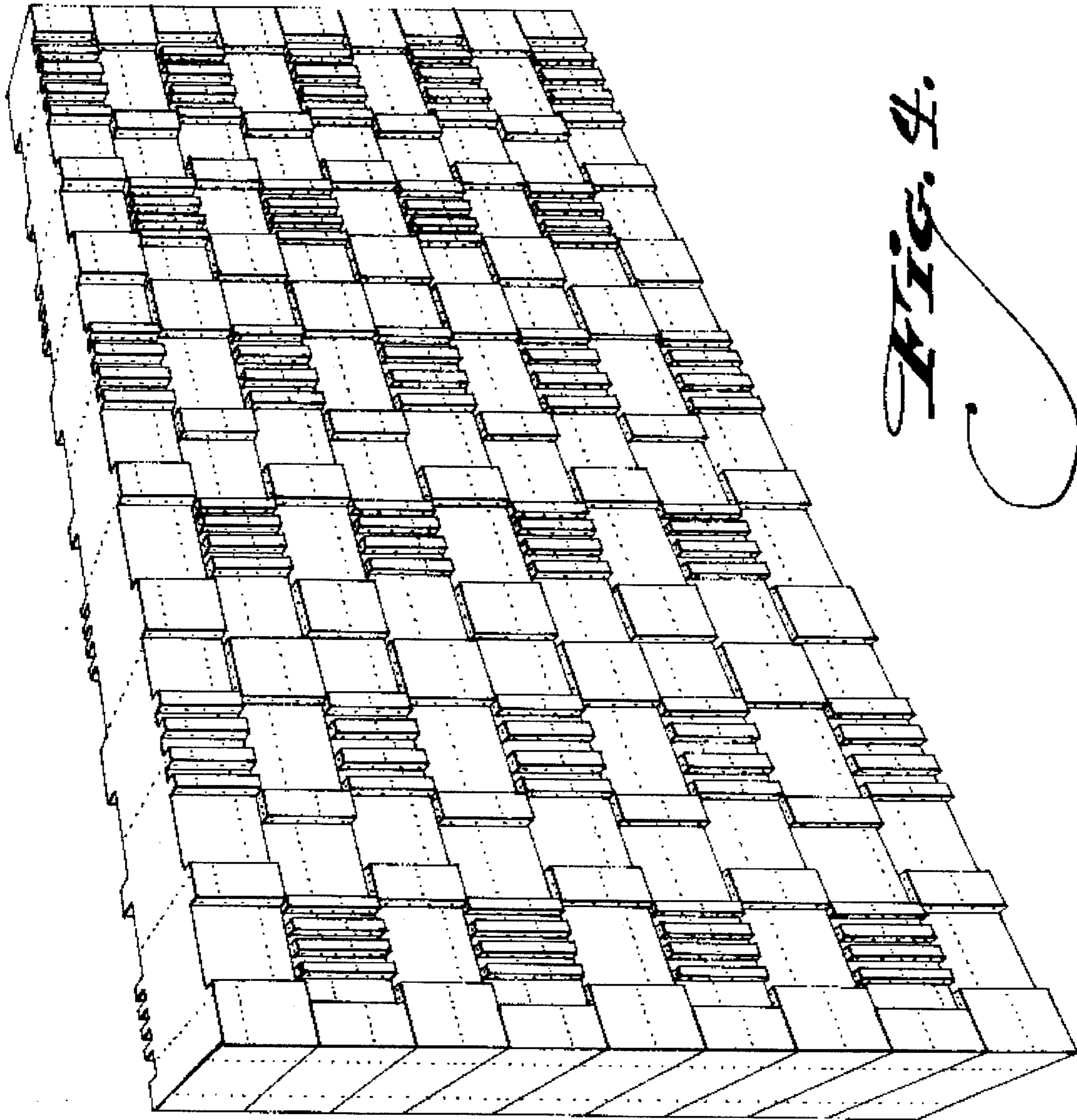




*FIG. 2.*



*FIG. 3.*



*FIG. 4.*

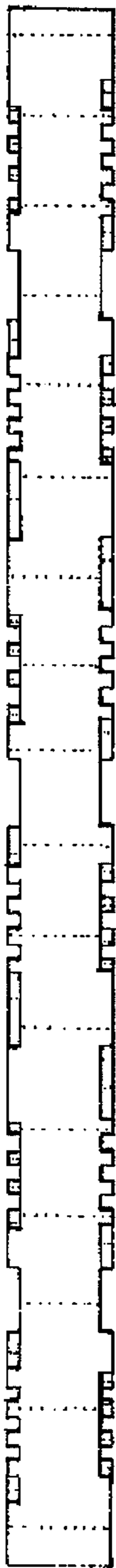


FIG. 5.

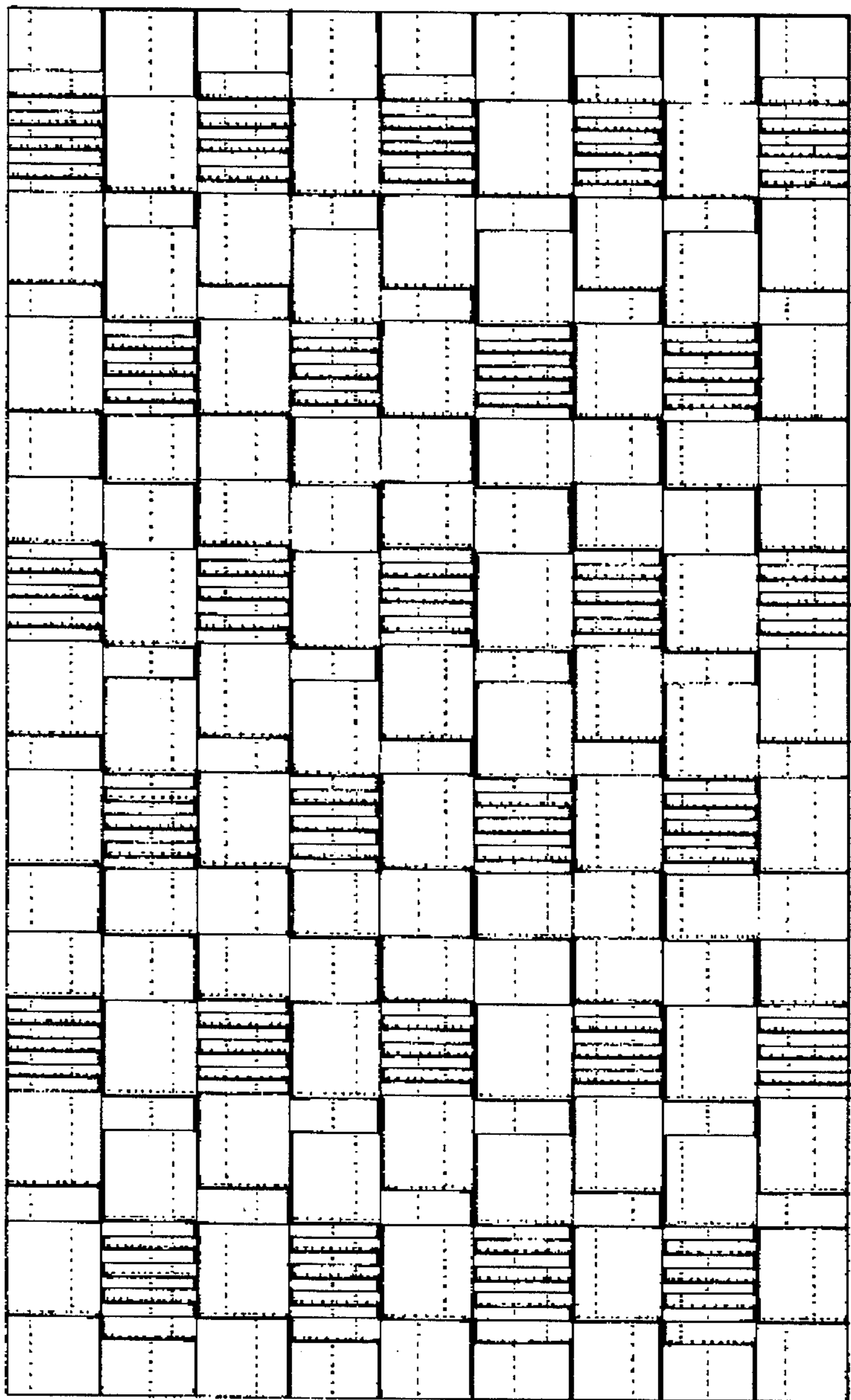
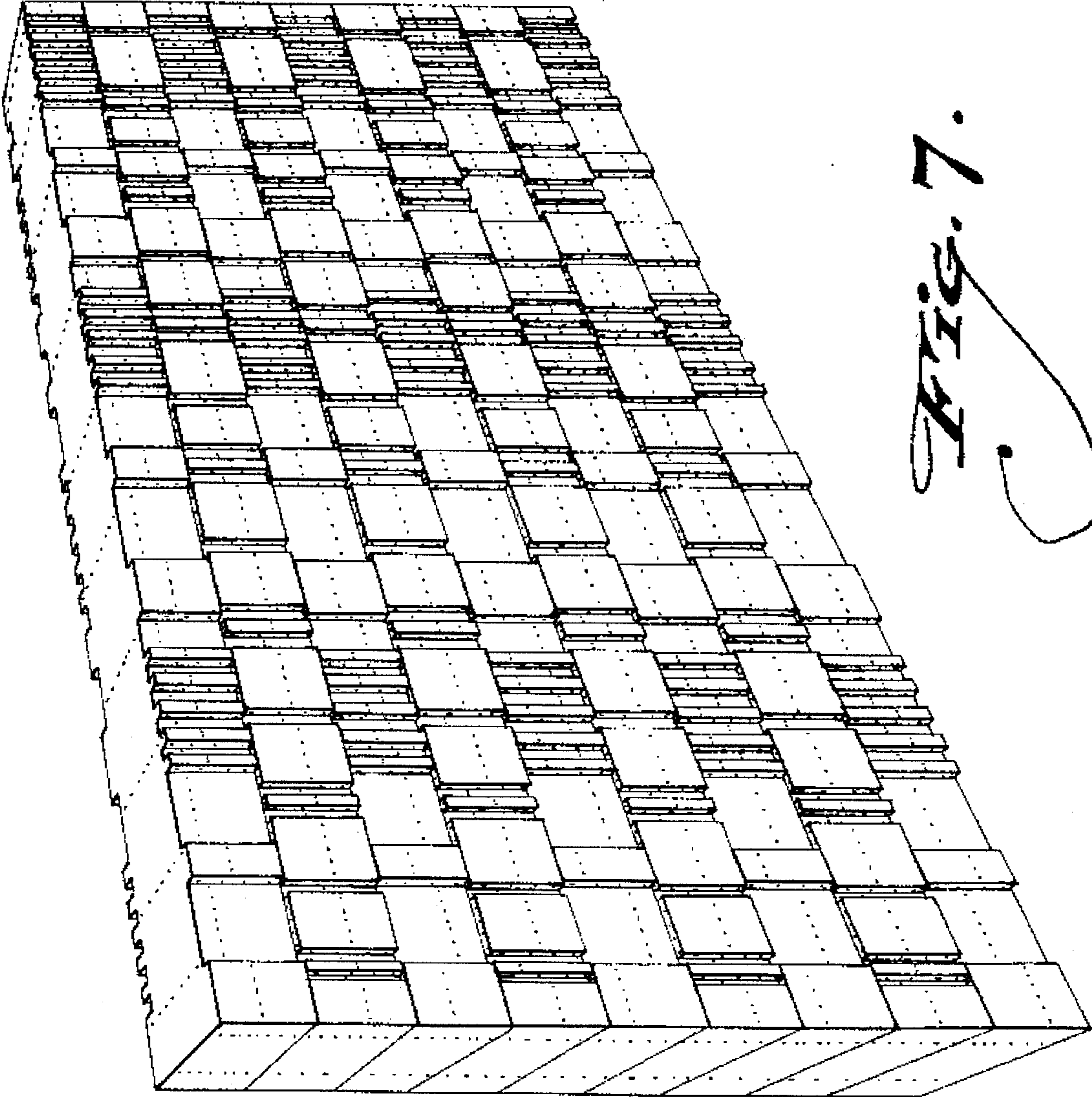
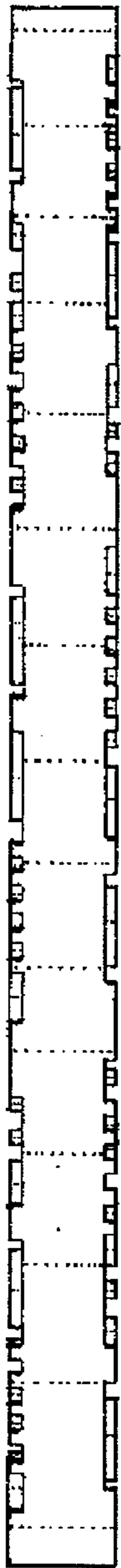


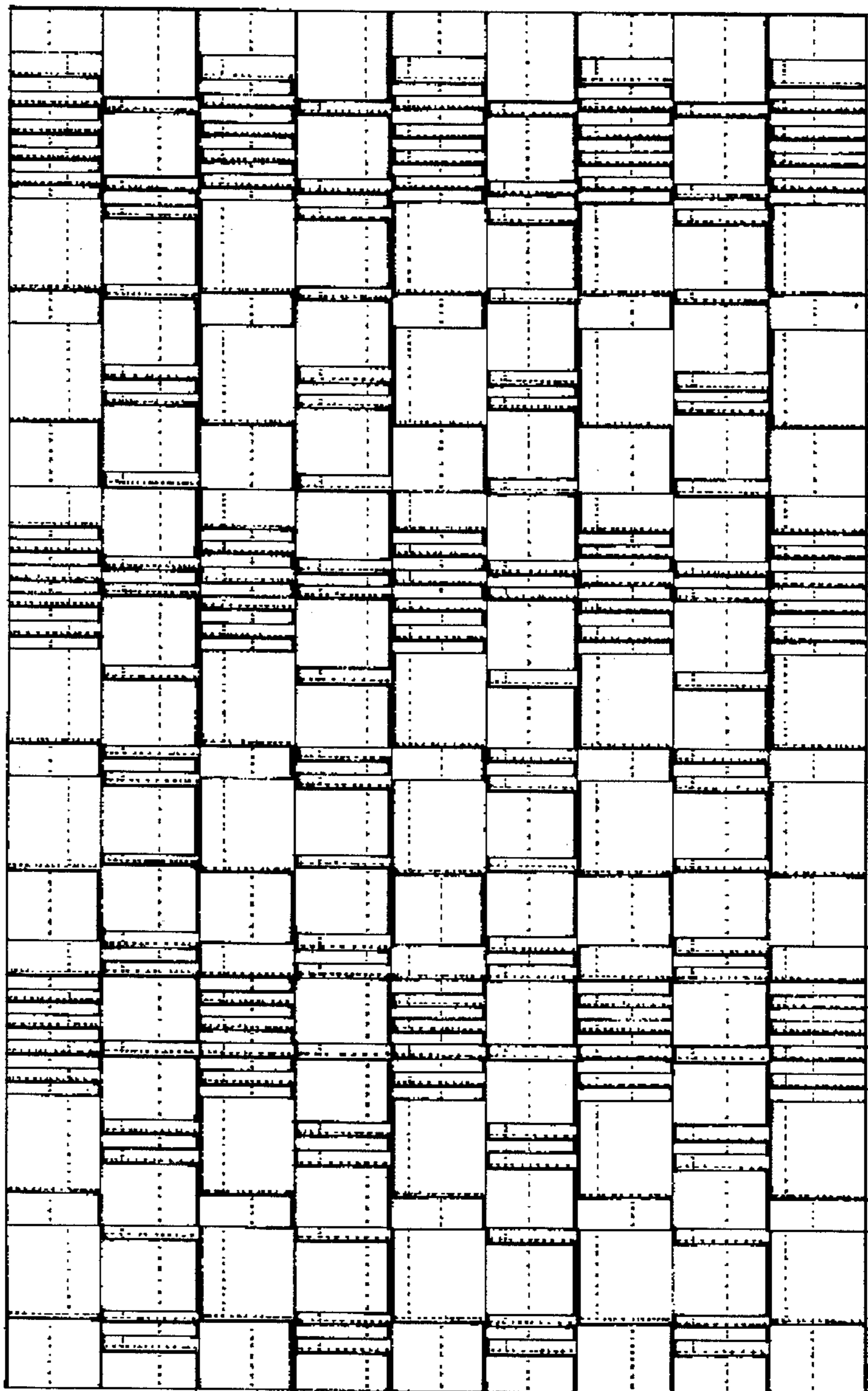
FIG. 6.



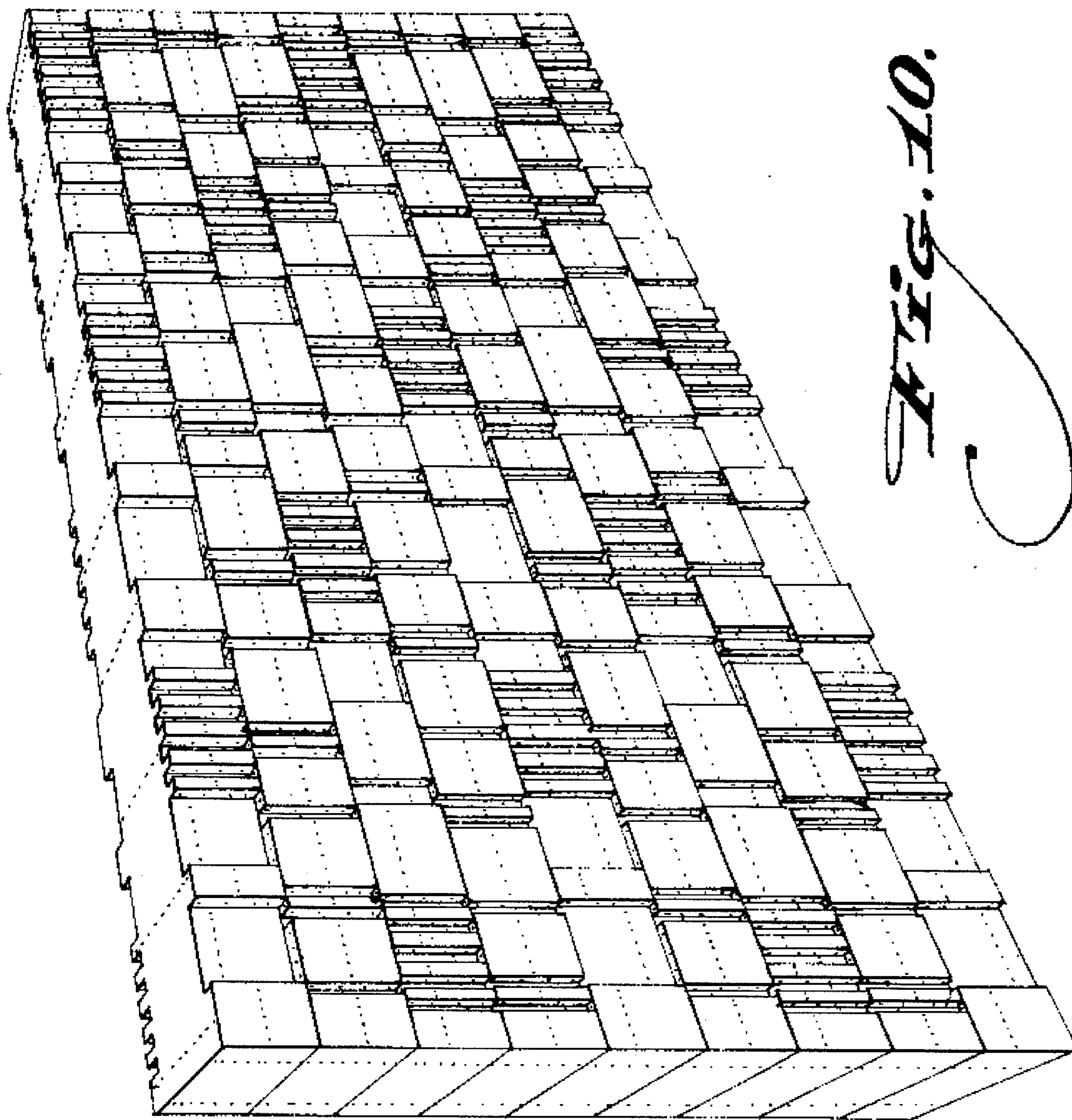
*FIG. 7.*



*FIG. 8.*

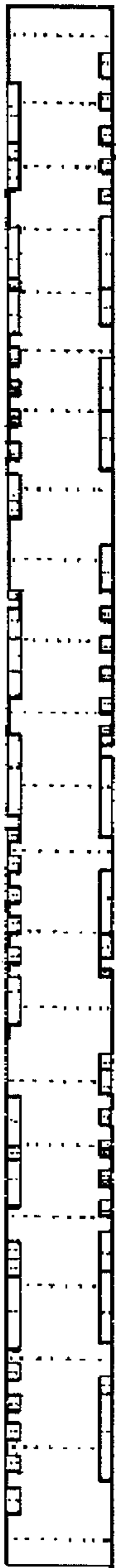


*FIG. 9.*

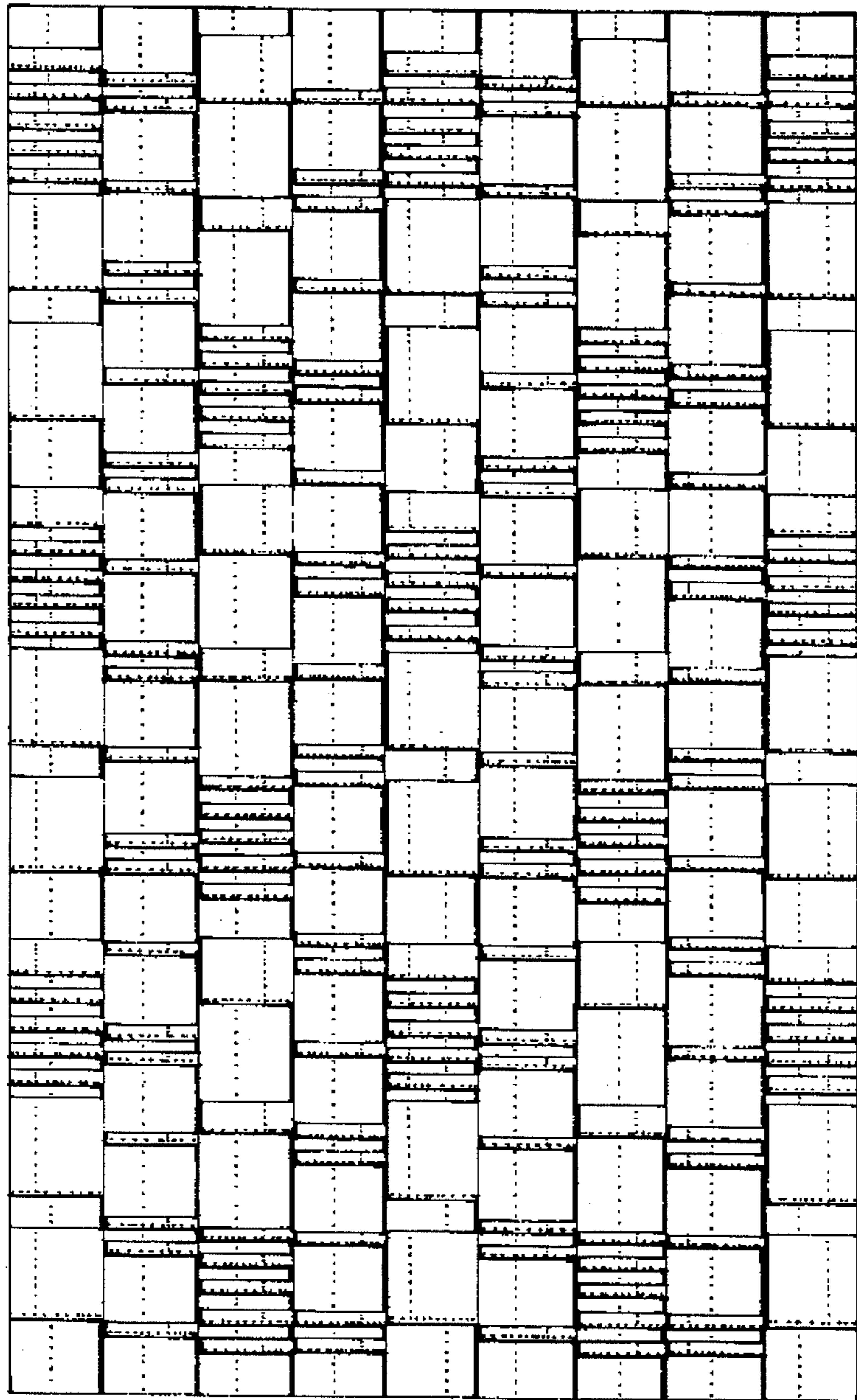


*FIG. 10.*





*FIG. 11.*



*FIG. 12.*