



US00D368619S

United States Patent [19] Garber

[11] **Patent Number:** **Des. 368,619**
[45] **Date of Patent:** ****Apr. 9, 1996**

[54] **FRY MACHINE**
[75] **Inventor:** **Jack C. Garber**, Sherman Oaks, Calif.
[73] **Assignee:** **Fry Factory, Inc.**, Studio City, Calif.
[**] **Term:** **14 Years**

D. 343,090 1/1994 Connell D7/339
D. 356,342 3/1995 Reese et al. D20/4

Primary Examiner—Ted Shooman
Assistant Examiner—Mitchell I. Siegel
Attorney, Agent, or Firm—Poms, Smith, Lande & Rose

[21] **Appl. No.:** **30,830**
[22] **Filed:** **Nov. 9, 1994**
[52] **U.S. Cl.** **D7/339; D20/1**
[58] **Field of Search** **D20/1, 4, 5; D7/338,**
D7/339, 347, 348, 350, 354, 360; 99/330,
357, 403, 407-410, 416, 468, 483

[57] **CLAIM**

The ornamental design for a fry machine, as shown and described.

DESCRIPTION

FIG. 1 is a perspective view of a fry machine showing my new design;
FIG. 2 is an front elevational view thereof;
FIG. 3 is a top plan view thereof;
FIG. 4 is a rear elevational view thereof;
FIG. 5 is a right side elevational view thereof;
FIG. 6 is a left side elevational view thereof; and,
FIG. 7 is a bottom plan view thereof.

[56] **References Cited**

U.S. PATENT DOCUMENTS

D. 290,269 6/1987 McGarrah D20/5
D. 306,092 2/1990 Rockola D20/5
D. 314,795 2/1991 McGarrah D20/5
D. 334,950 4/1993 Wyman et al. D20/4

1 Claim, 3 Drawing Sheets

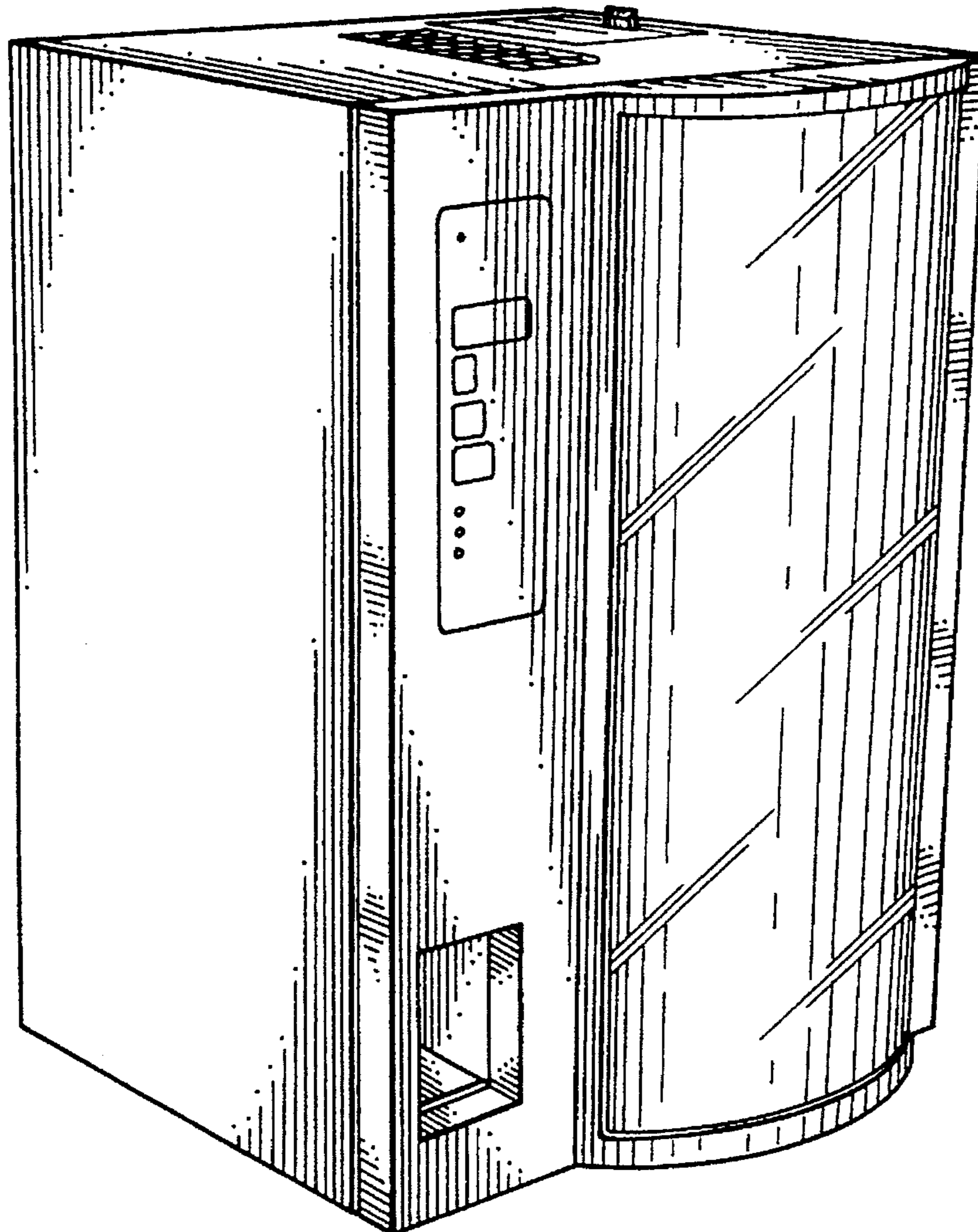

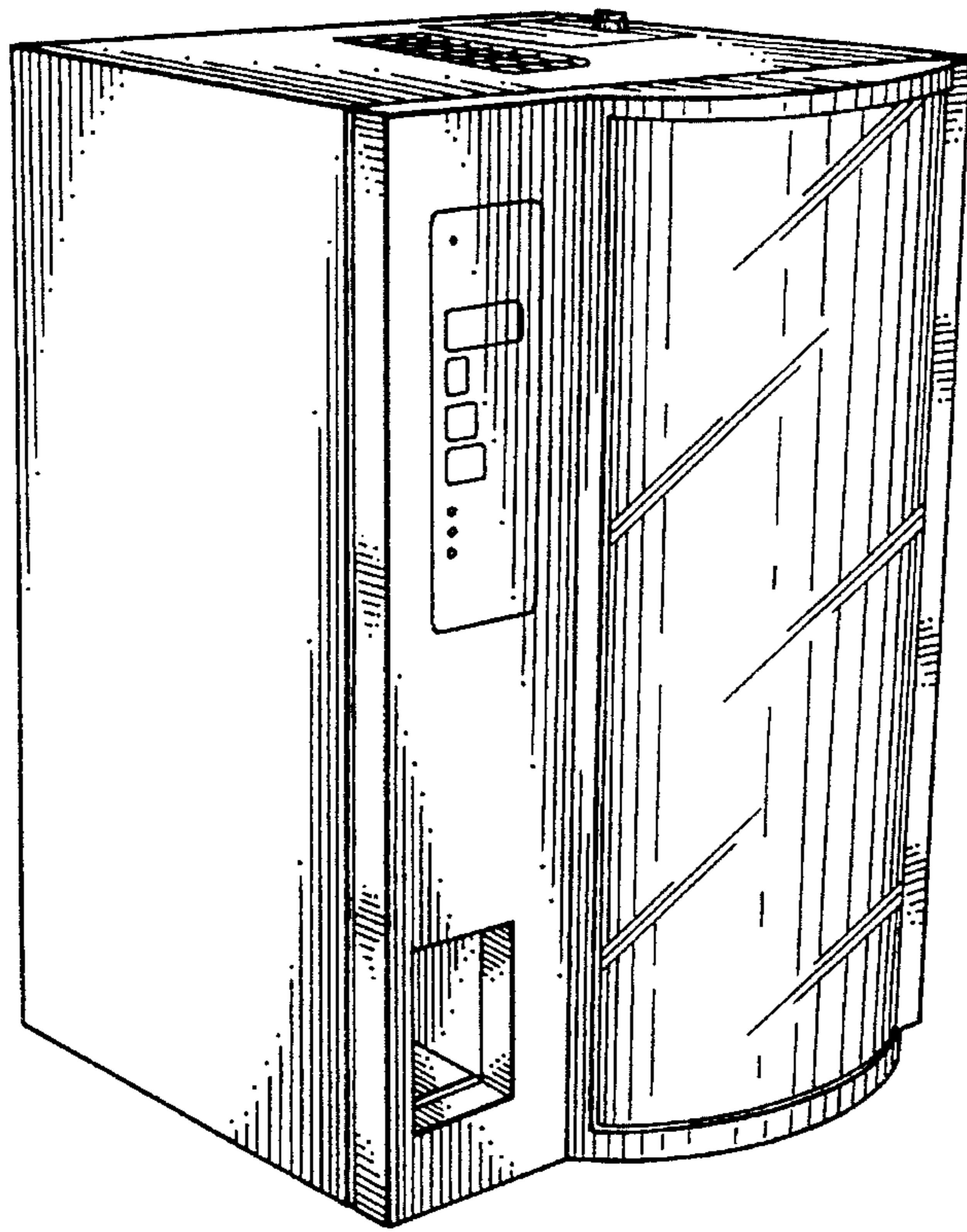

FIG. 1

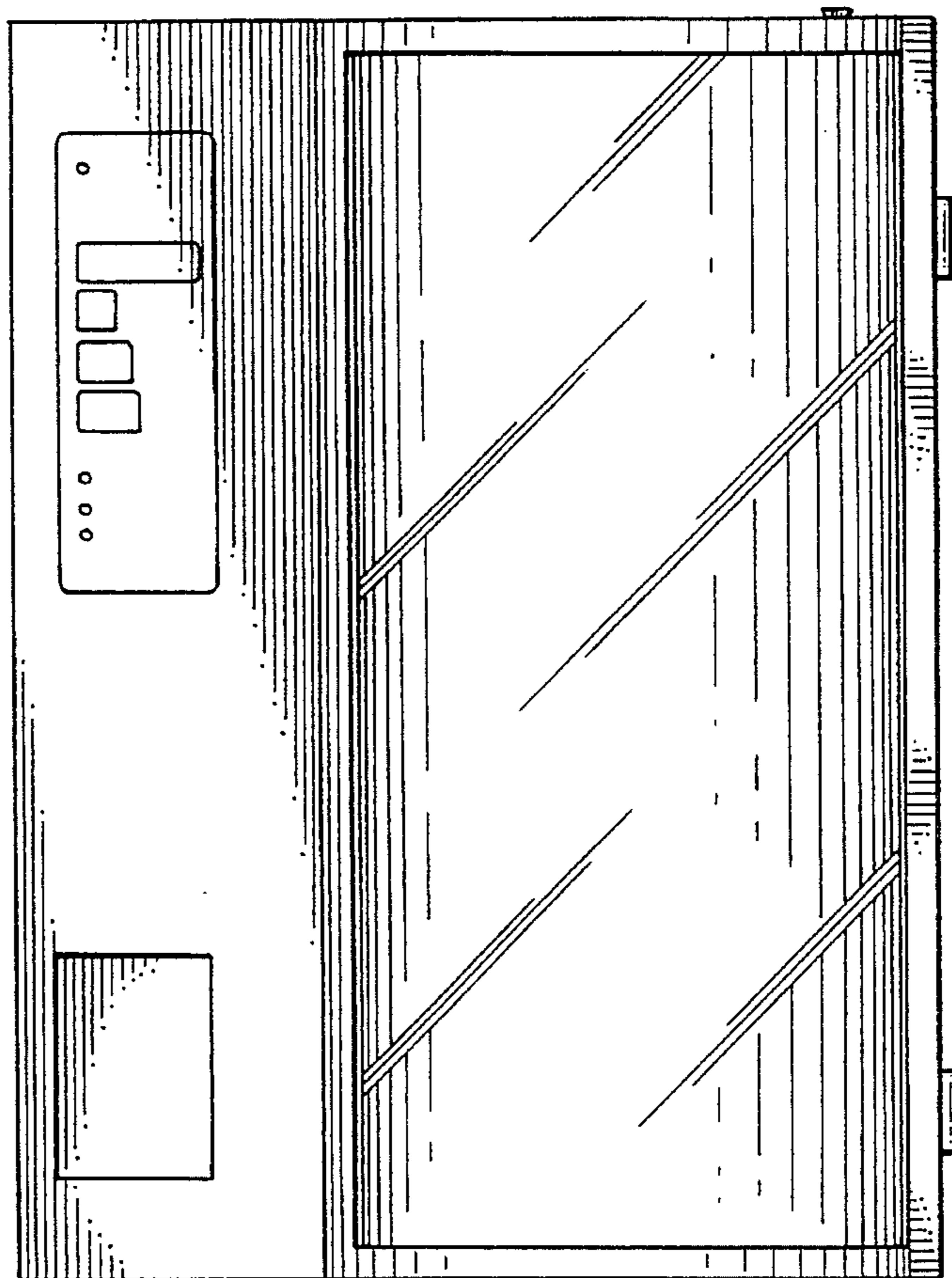

FIG. 2

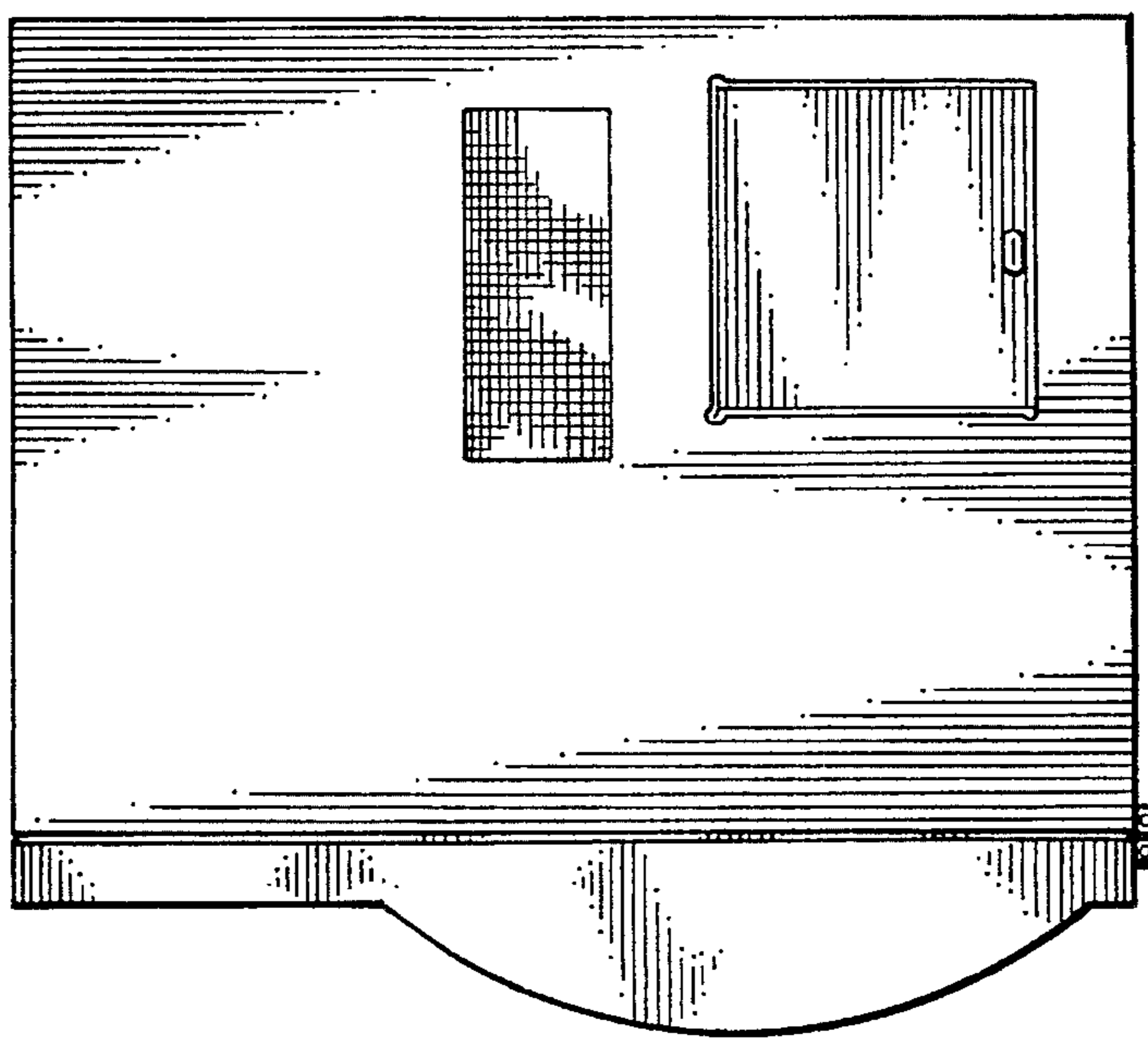
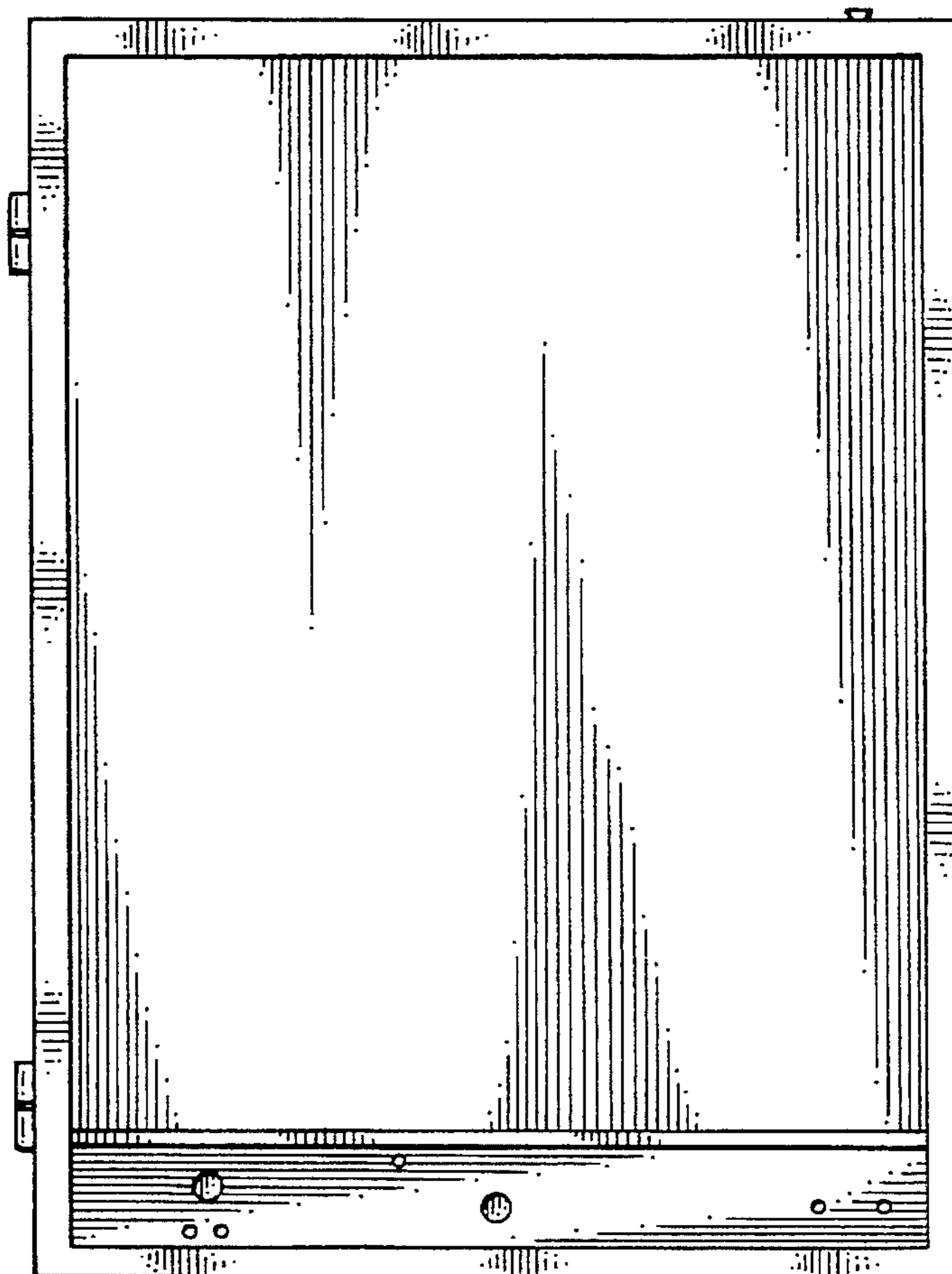

FIG. 3

FIG. 4



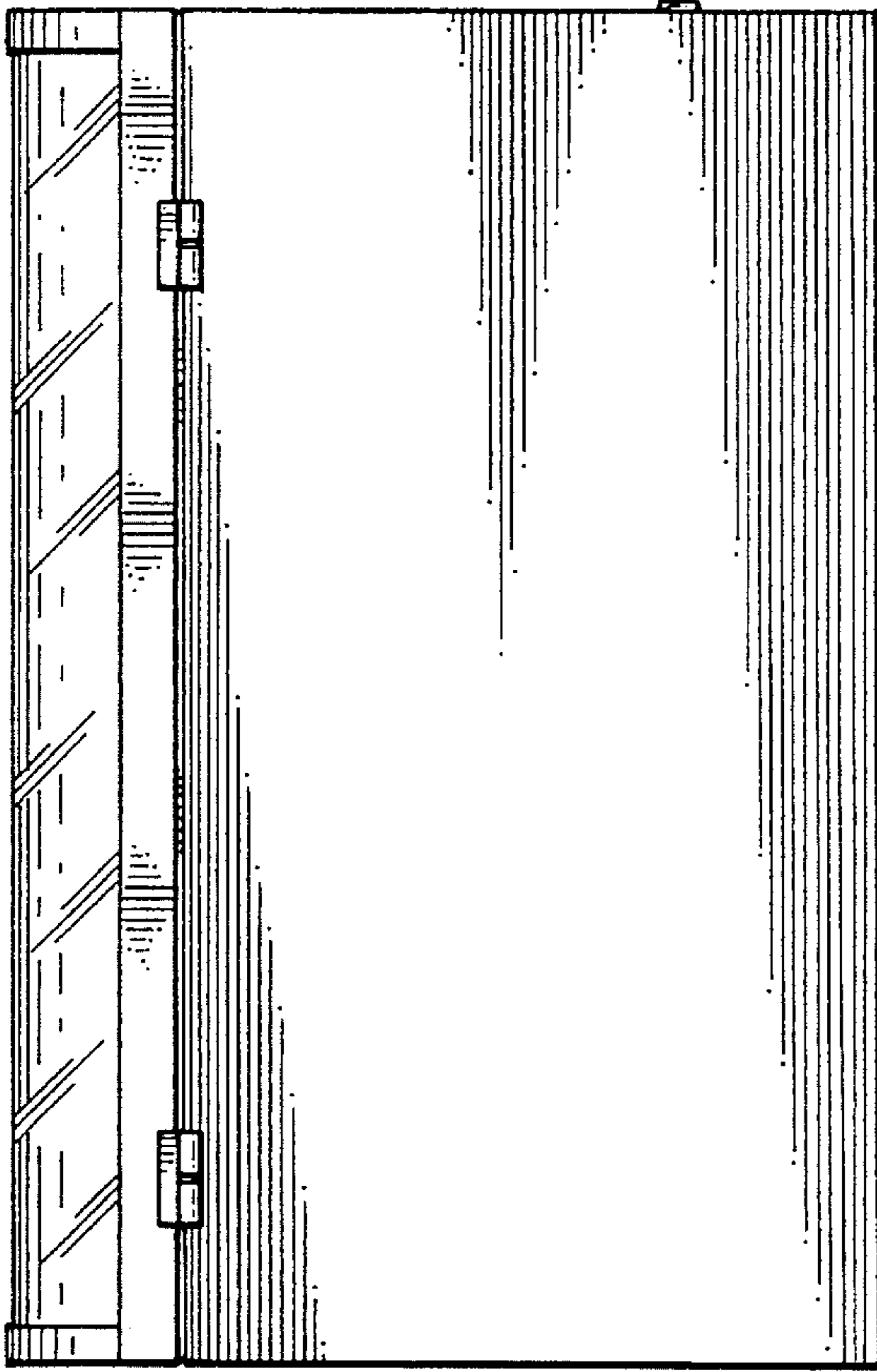

FIG. 5

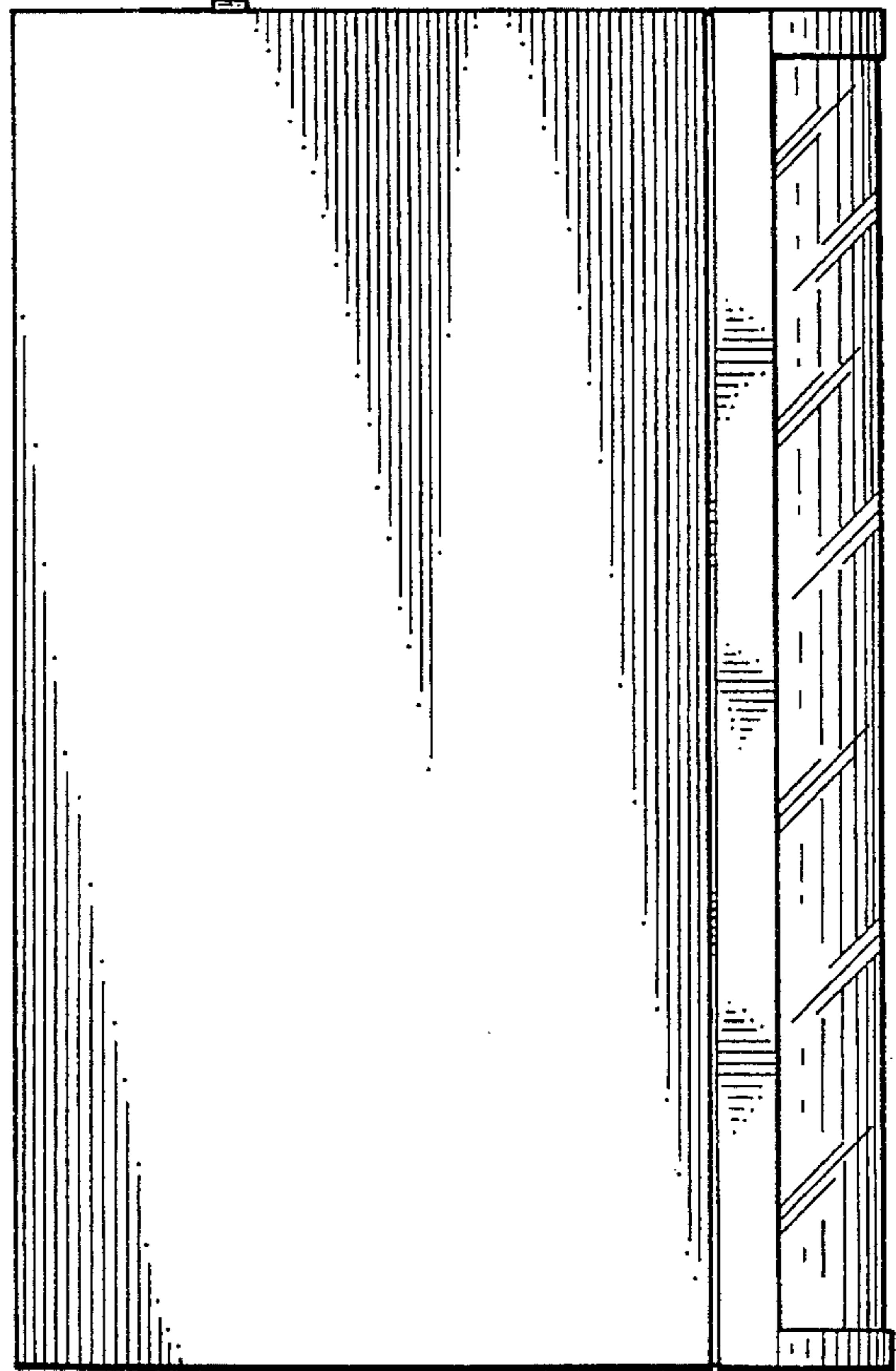

FIG. 6

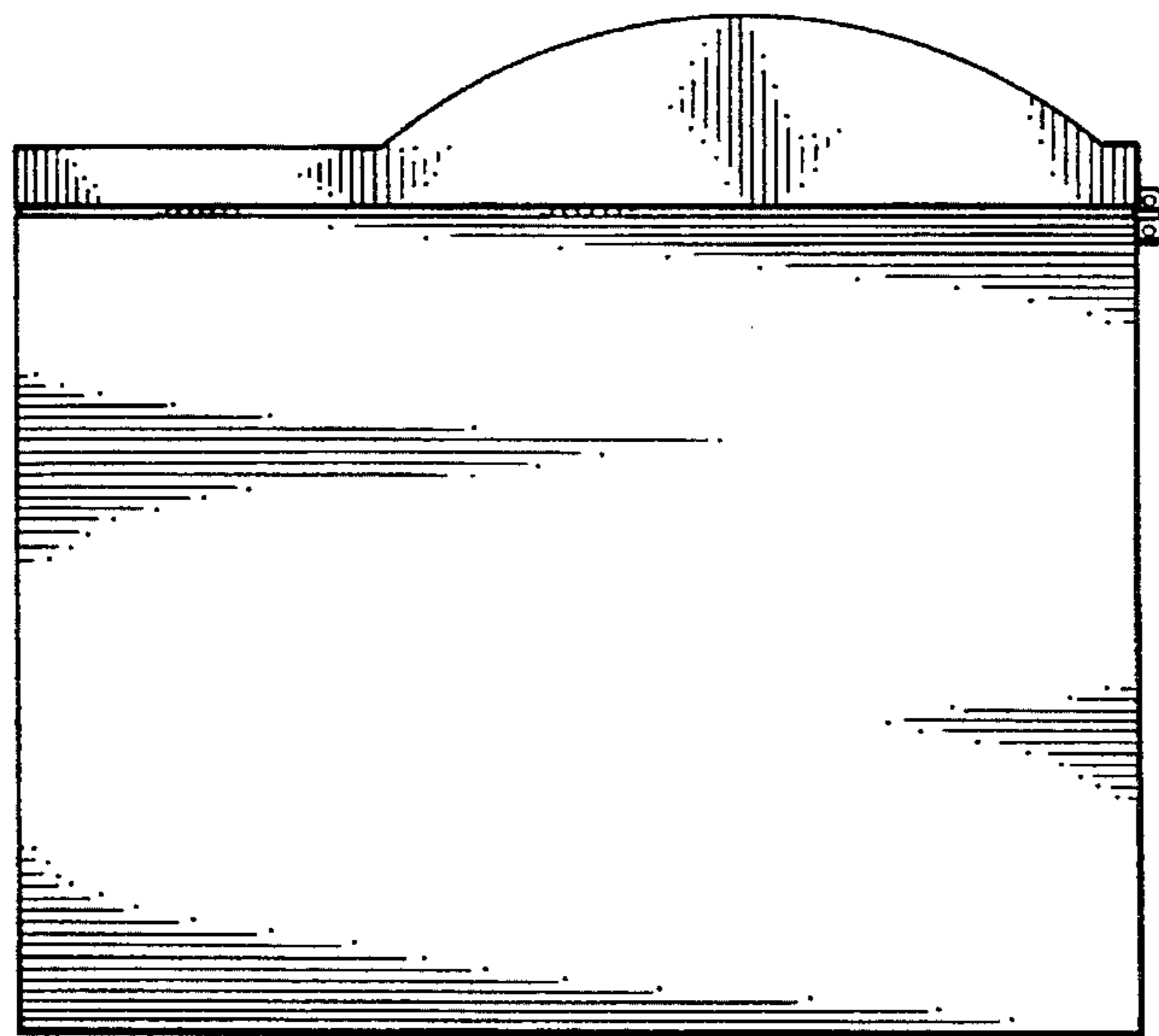

FIG. 7