



US00D366287S

# United States Patent [19] Kino

[11] Patent Number: **Des. 366,287**

[45] Date of Patent: **\*\*Jan. 16, 1996**

[54] RATTLE

[75] Inventor: **Moriya Kino**, Yokohama, Japan

[73] Assignee: **Royal Co., Ltd.**, Japan

[\*\*] Term: **14 Years**

[21] Appl. No.: **32,848**

[22] Filed: **Dec. 30, 1994**

[52] U.S. Cl. .... **D21/65**

[58] Field of Search ..... D21/59, 64, 65;  
D17/22; 446/408, 418, 419, 421

[56] **References Cited**

**U.S. PATENT DOCUMENTS**

- D. 276,845 12/1984 Daugherty ..... D21/65 X
- D. 277,880 3/1985 Paczko ..... D21/65
- D. 317,473 6/1991 Copper et al. .... D21/65

**OTHER PUBLICATIONS**

Royal Co., Ltd., "Toyroyal", 1991, No. 3028 (Rattle House).  
Early Learning Centre, "Autumn-Winter-1991/2", 1991, No. 1168 (Pig Rattle), No. 1263 (Rabbit Rattle).

Kiddicraft, 1980, NO. K02 416 (Birdie Rattle).

*Primary Examiner*—Dominic Simone  
*Attorney, Agent, or Firm*—Ostrolenk, Faber, Gerb & Soffen

[57] **CLAIM**

The ornamental design for a rattle, as shown and described.

**DESCRIPTION**

FIG. 1 is a front elevational view of a rattle showing my new design;  
 FIG. 2 is a right side elevational view thereof and is also a mirror image of the left side elevational view thereof;  
 FIG. 3 is a top plan view thereof;  
 FIG. 4 is a cross-sectional view taken along a line IV—IV in FIG. 1;  
 FIG. 5 is a bottom plan view thereof;  
 FIG. 6 is a cross-sectional view taken along a line IV—IV in FIG. 1;  
 FIG. 7 is a rear elevational view thereof; and,  
 FIG. 8 is a front elevational view thereof in a operating condition.

**1 Claim, 4 Drawing Sheets**

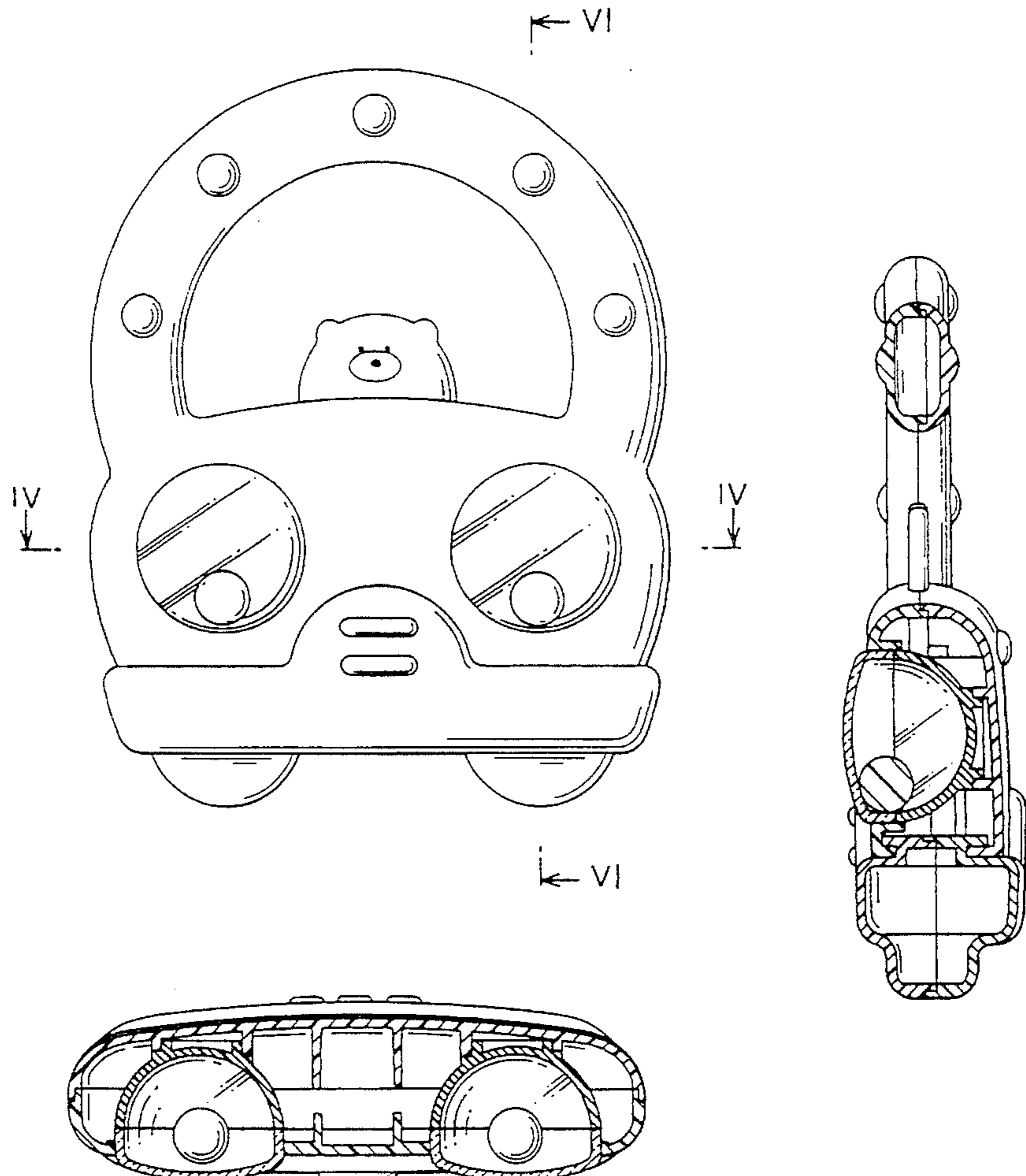
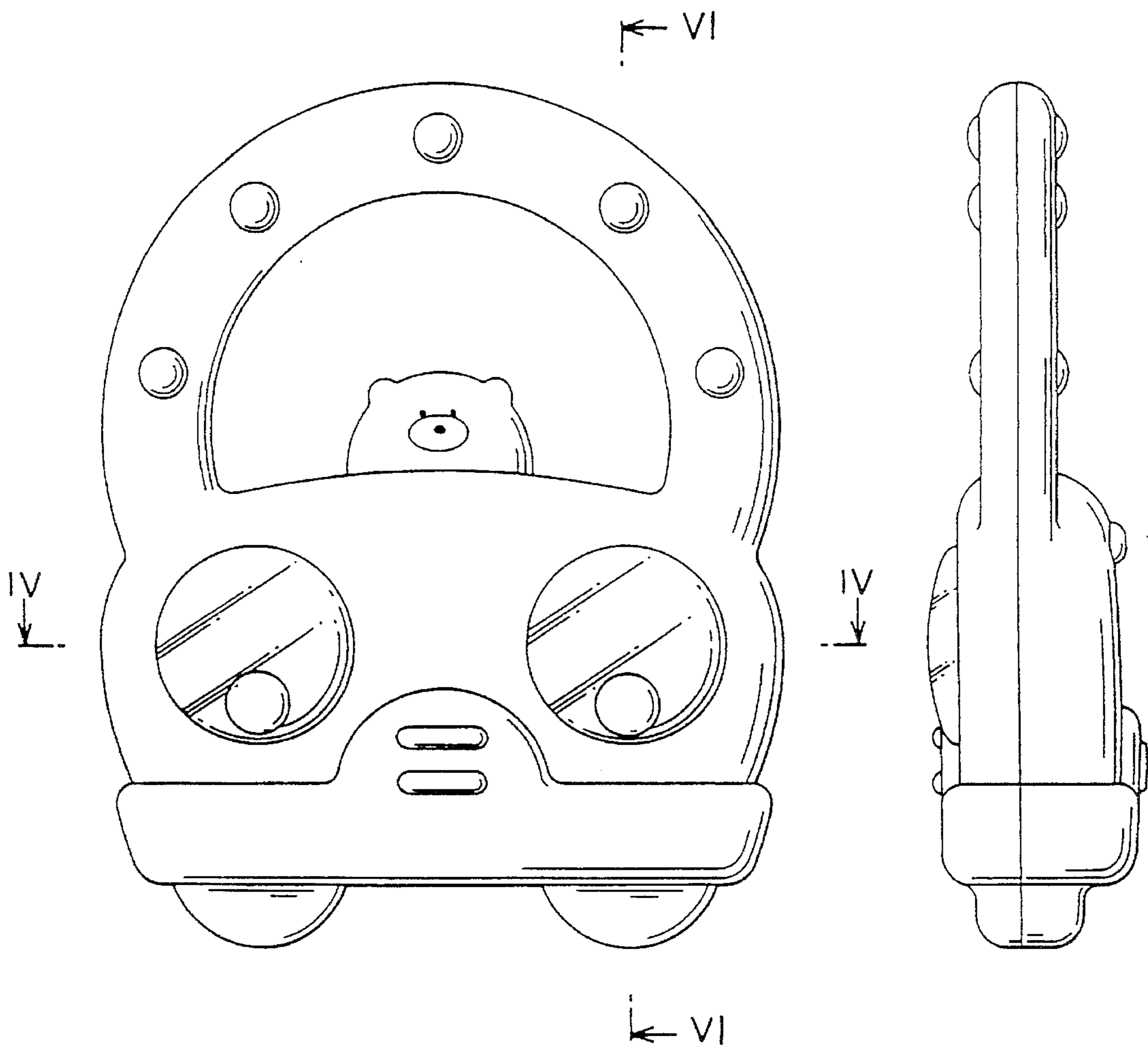
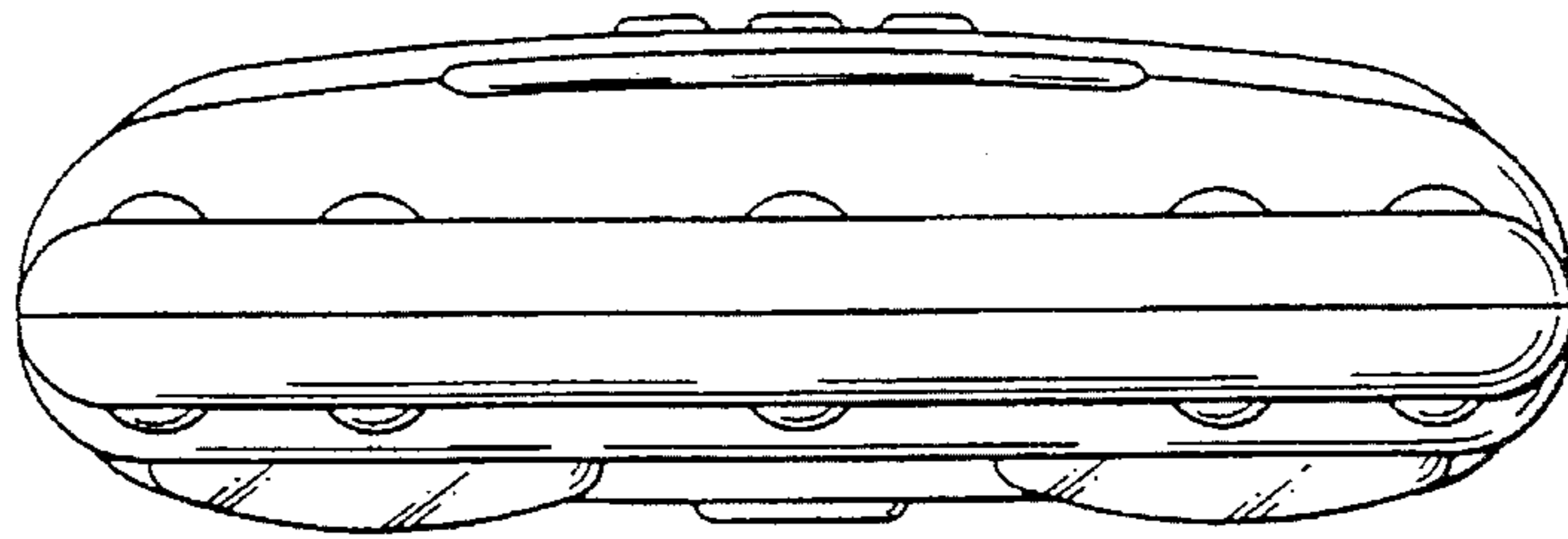

Fig. 1

Fig. 2



*Fig. 3*



*Fig. 4*

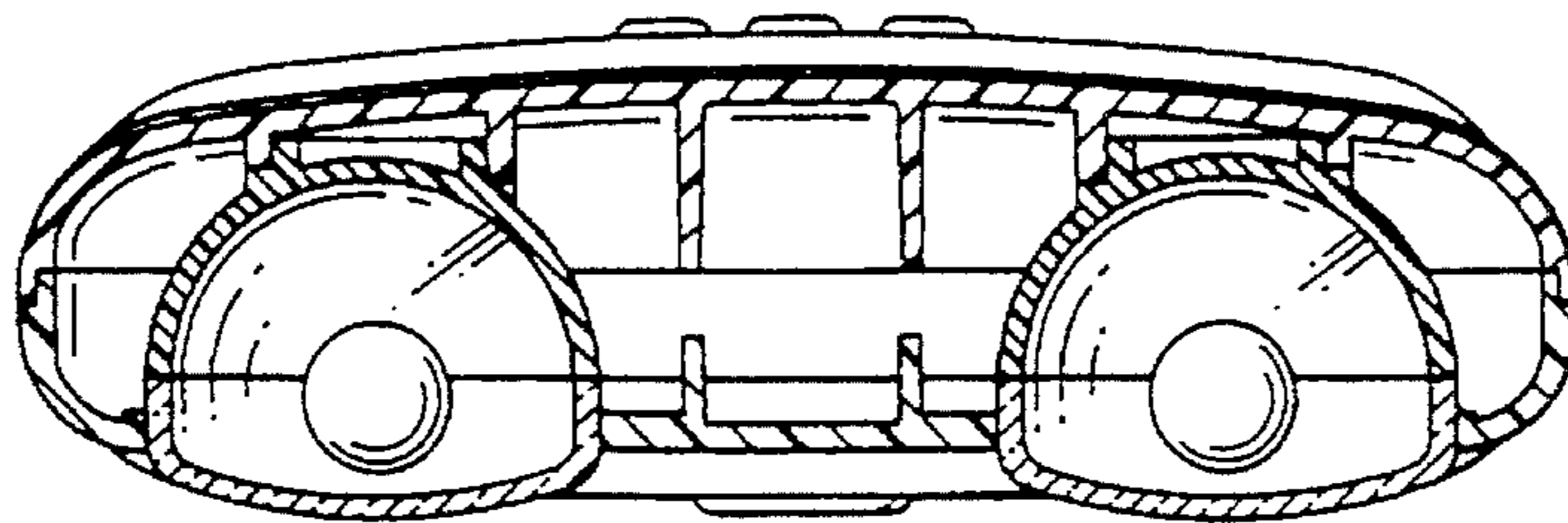

*Fig. 5*

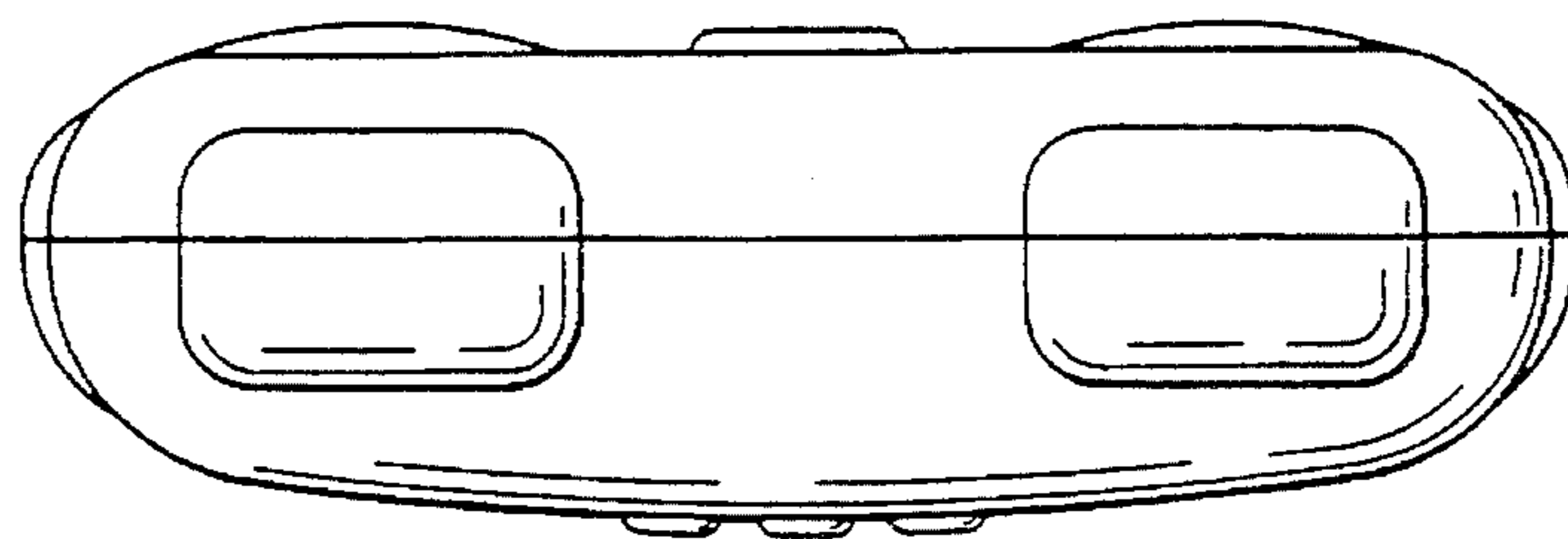

*Fig. 6*

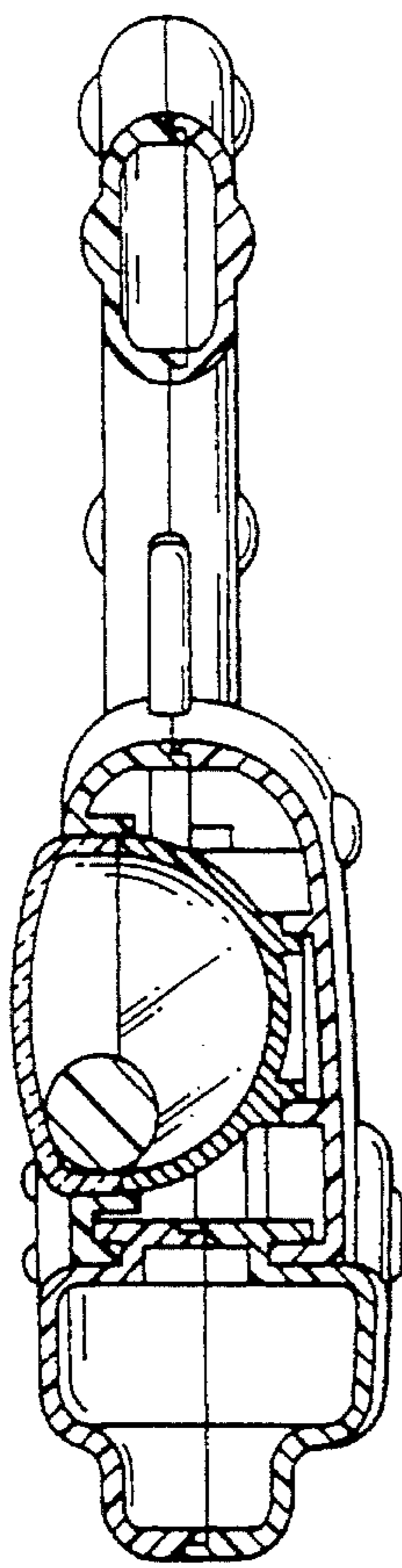

*Fig. 7*

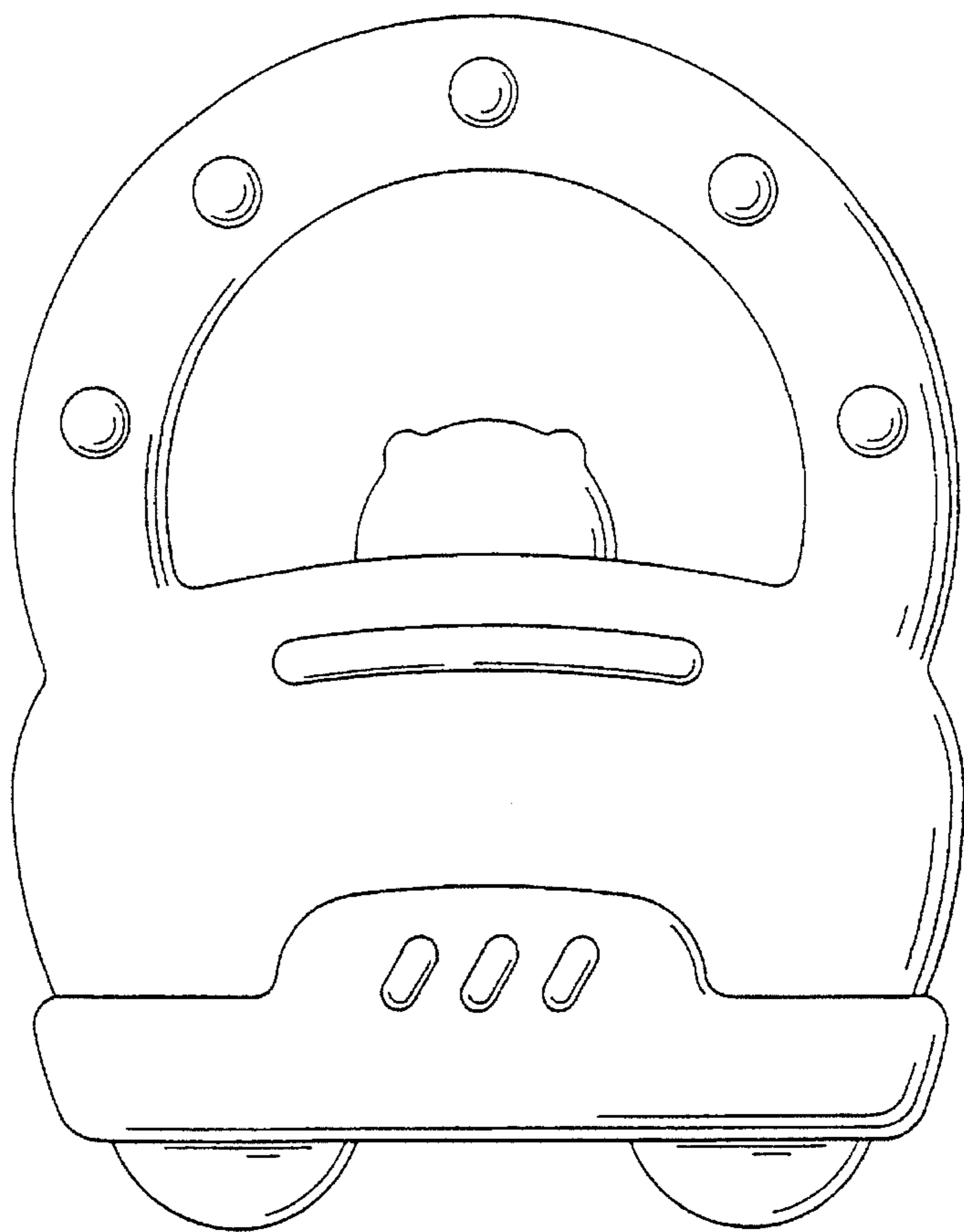

*Fig. 8*

