



US00D362015S

# United States Patent [19]

Uchiyama

[11] Patent Number: **Des. 362,015**

[45] Date of Patent: **\*\* Sep. 5, 1995**

[54] **TAPE CARTRIDGE FOR TAPE PRINTER**

[75] Inventor: **Yoichi Uchiyama, Nagoya, Japan**

[73] Assignee: **Brother Kogyo Kabushiki Kaisha, Aichi, Japan**

[\*\*] Term: **14 Years**

[21] Appl. No.: **18,947**

[22] Filed: **Feb. 18, 1994**

[30] **Foreign Application Priority Data**

Aug. 19, 1993 [JP] Japan ..... 5-25207

Aug. 19, 1993 [JP] Japan ..... 5-25208

[52] U.S. Cl. .... **D18/56**

[58] Field of Search ..... **D18/56; 400/208**

[56] **References Cited**

### U.S. PATENT DOCUMENTS

D. 319,070	8/1991	Lavander	.....	D18/56
D. 344,755	3/1994	Yamazaki	.....	D18/56
D. 352,305	11/1994	Cooper	.....	D18/56
4,341,479	7/1982	Sanada	.....	400/208
4,815,874	3/1989	Richardson et al.	.....	400/208
4,974,977	12/1990	Morgan et al.	.....	400/208
5,098,208	3/1992	Martinez	.....	400/208

### FOREIGN PATENT DOCUMENTS

0555954	8/1993	European Pat. Off.	.....	400/208
---------	--------	--------------------	-------	---------

0154880 7/1986 Japan ..... 400/208

0166572 7/1988 Japan ..... 400/208

865846-1 4/1993 Japan .

865846 4/1993 Japan .

5262005 10/1993 Japan ..... 400/208

865846-2 12/1993 Japan .

*Primary Examiner*—Cathy Anne MacCormac  
*Attorney, Agent, or Firm*—Oliff & Berridge

### [57] CLAIM

The ornamental design for a tape cartridge for tape printer, as shown and described.

### DESCRIPTION

FIG. 1 is a top plan view of the tape cartridge;  
 FIG. 2 is a front view of the tape cartridge;  
 FIG. 3 is a bottom plan view of the tape cartridge;  
 FIG. 4 is a left side view of the tape cartridge;  
 FIG. 5 is a right side view of the tape cartridge;  
 FIG. 6 is a rear view of the tape cartridge;  
 FIG. 7 is a perspective view of the tape cartridge;  
 FIG. 8 is a top plan view of a second embodiment of FIG. 1;  
 FIG. 9 is a front view of FIG. 8;  
 FIG. 10 is a bottom plan view of FIG. 8;  
 FIG. 11 is a left side view of FIG. 8;  
 FIG. 12 is a right side view of FIG. 8;  
 FIG. 13 is a rear view of FIG. 8; and,  
 FIG. 14 is a perspective view of FIG. 8.

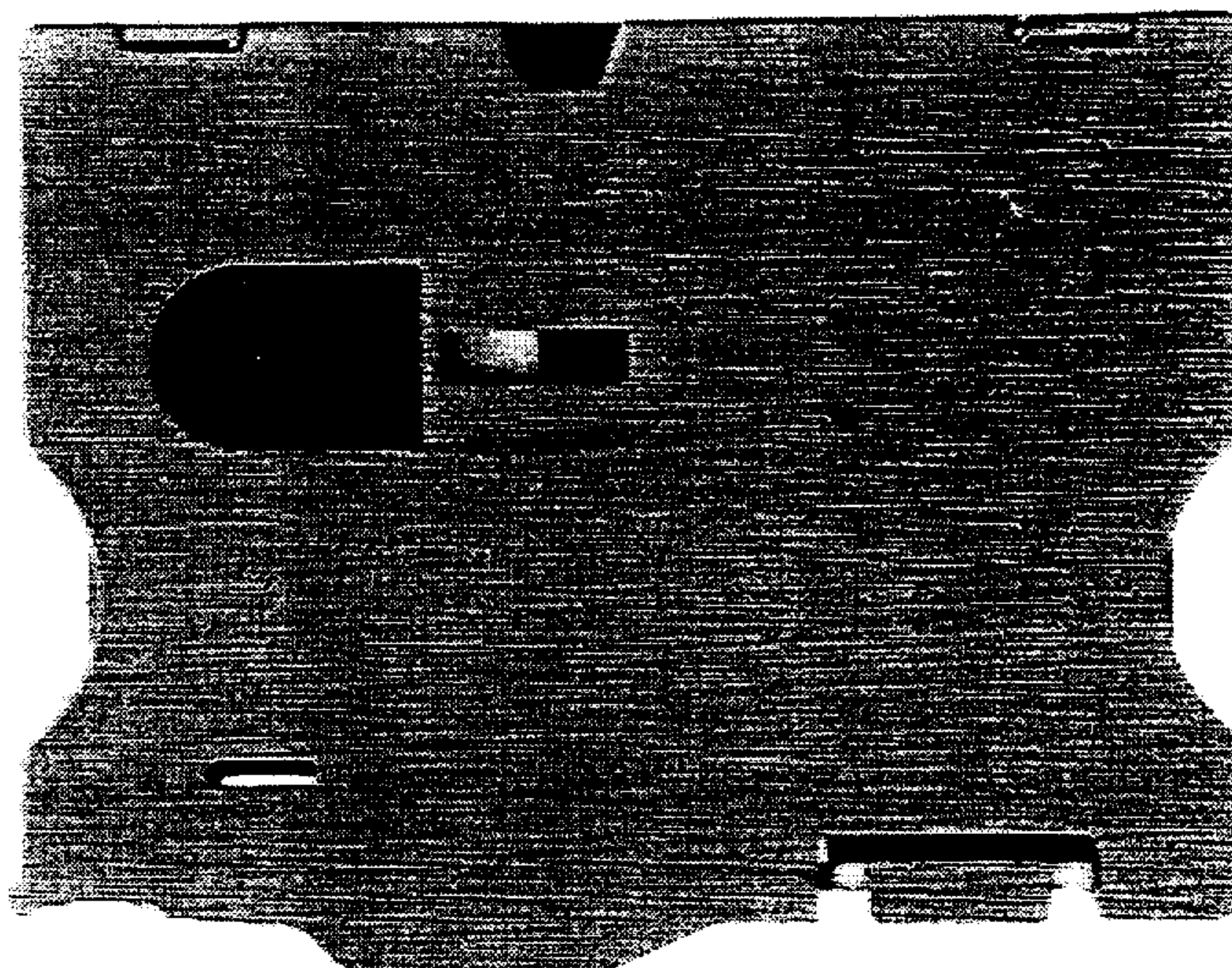

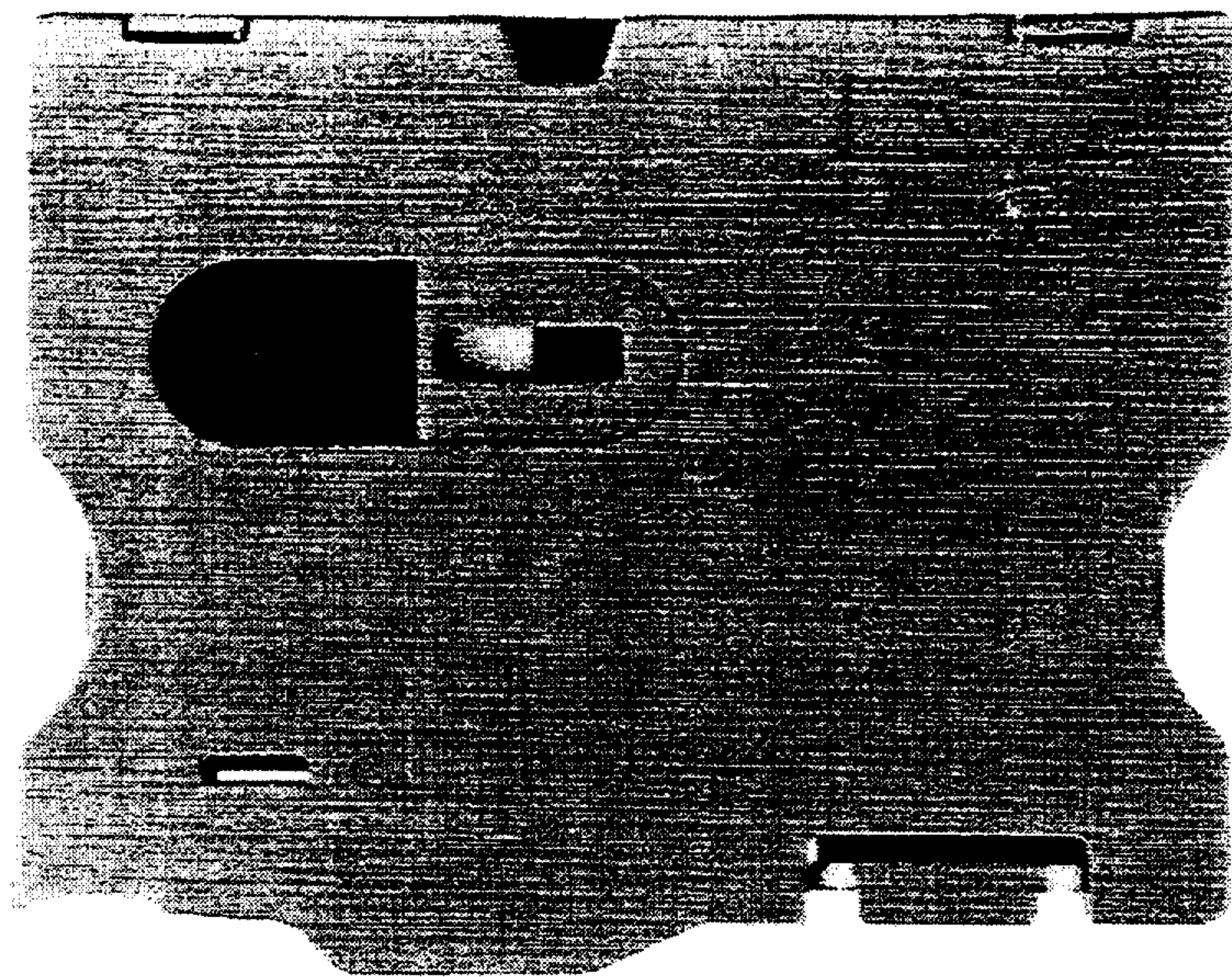

FIG. 1

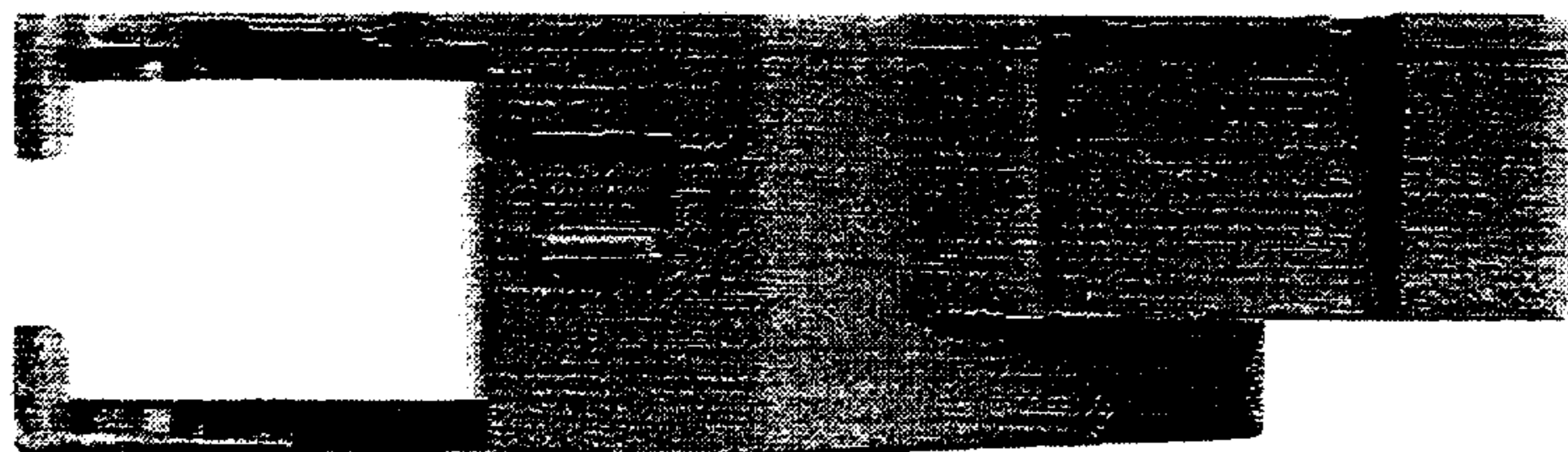

FIG. 2

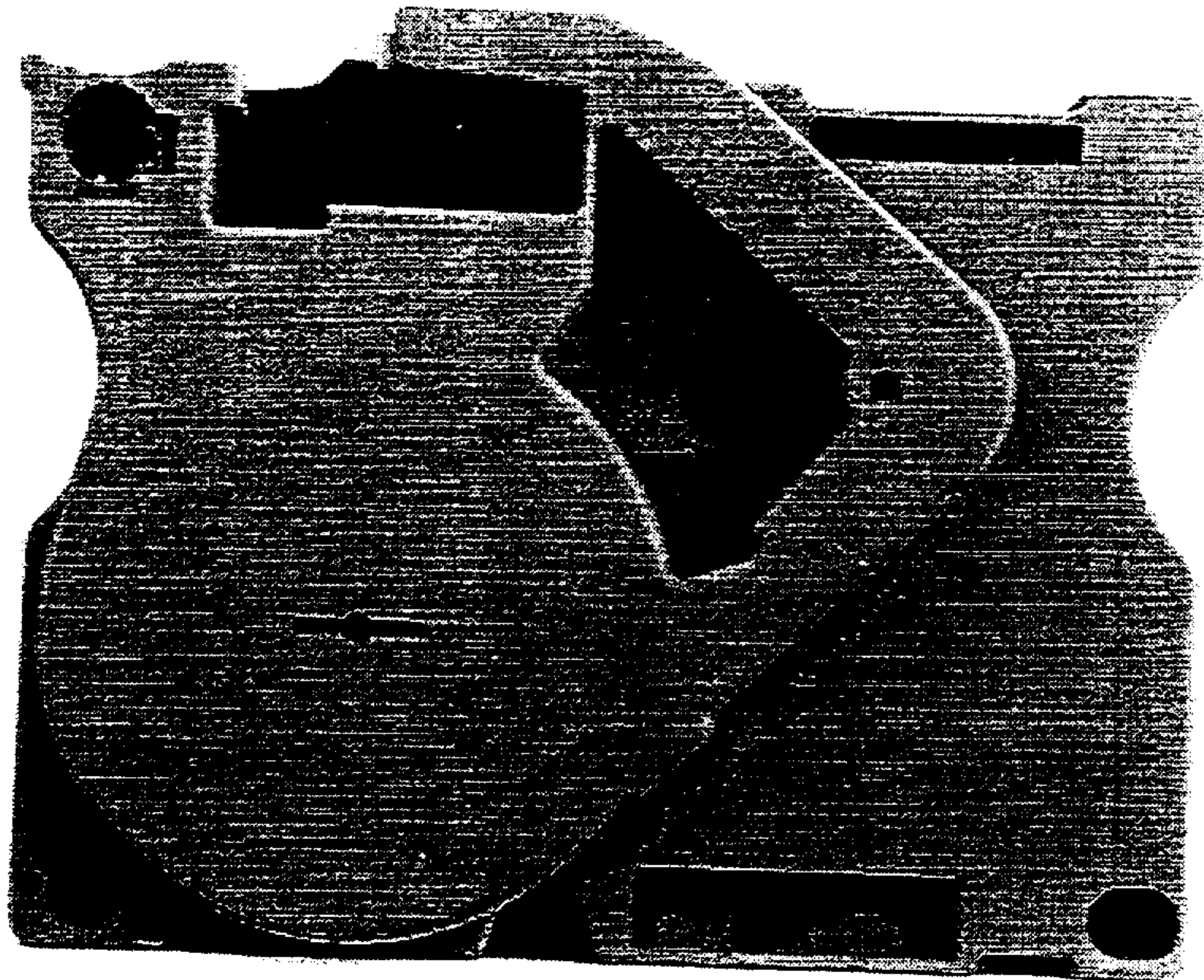

FIG. 3

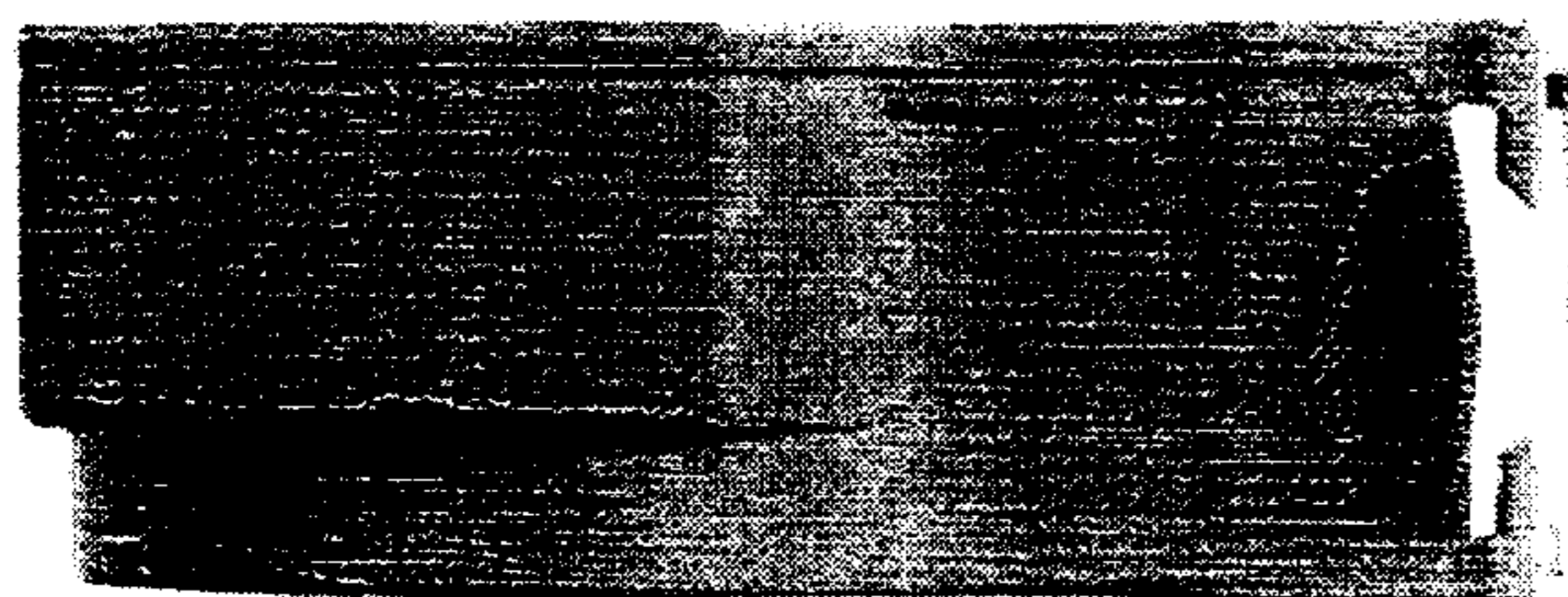

FIG. 4

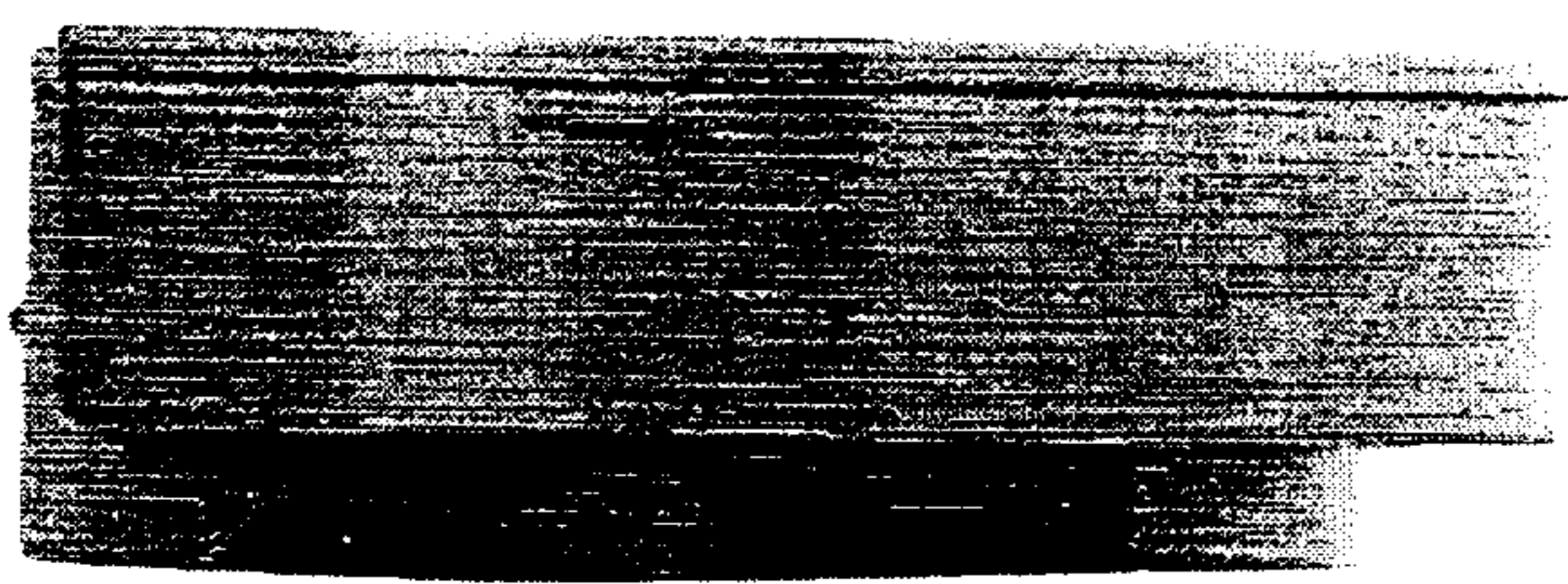

FIG. 5

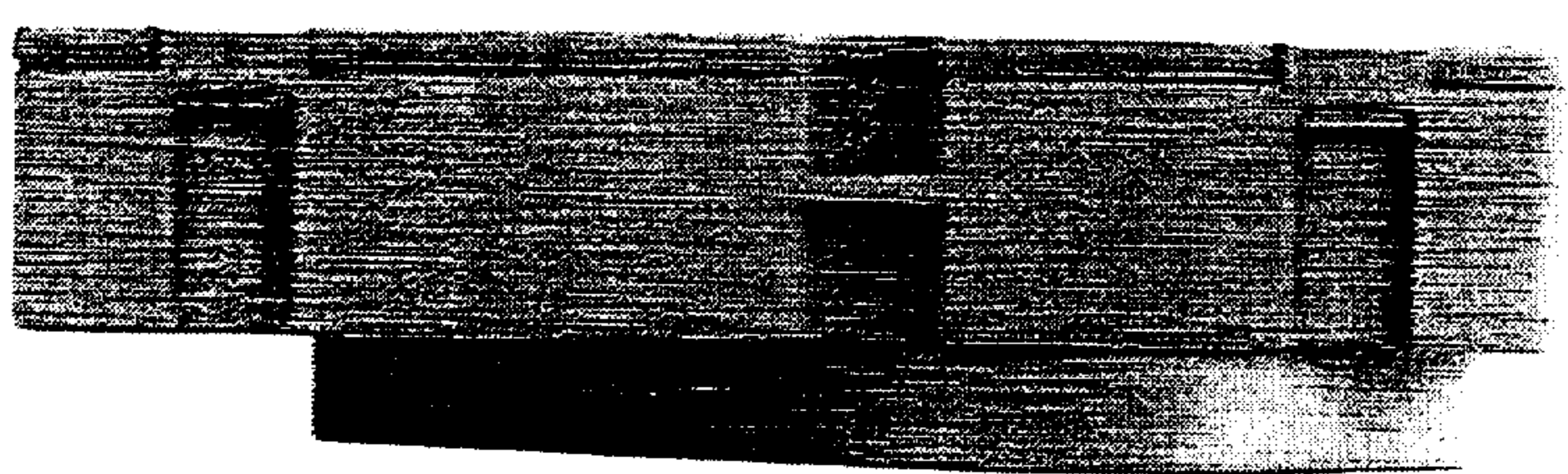

FIG. 6

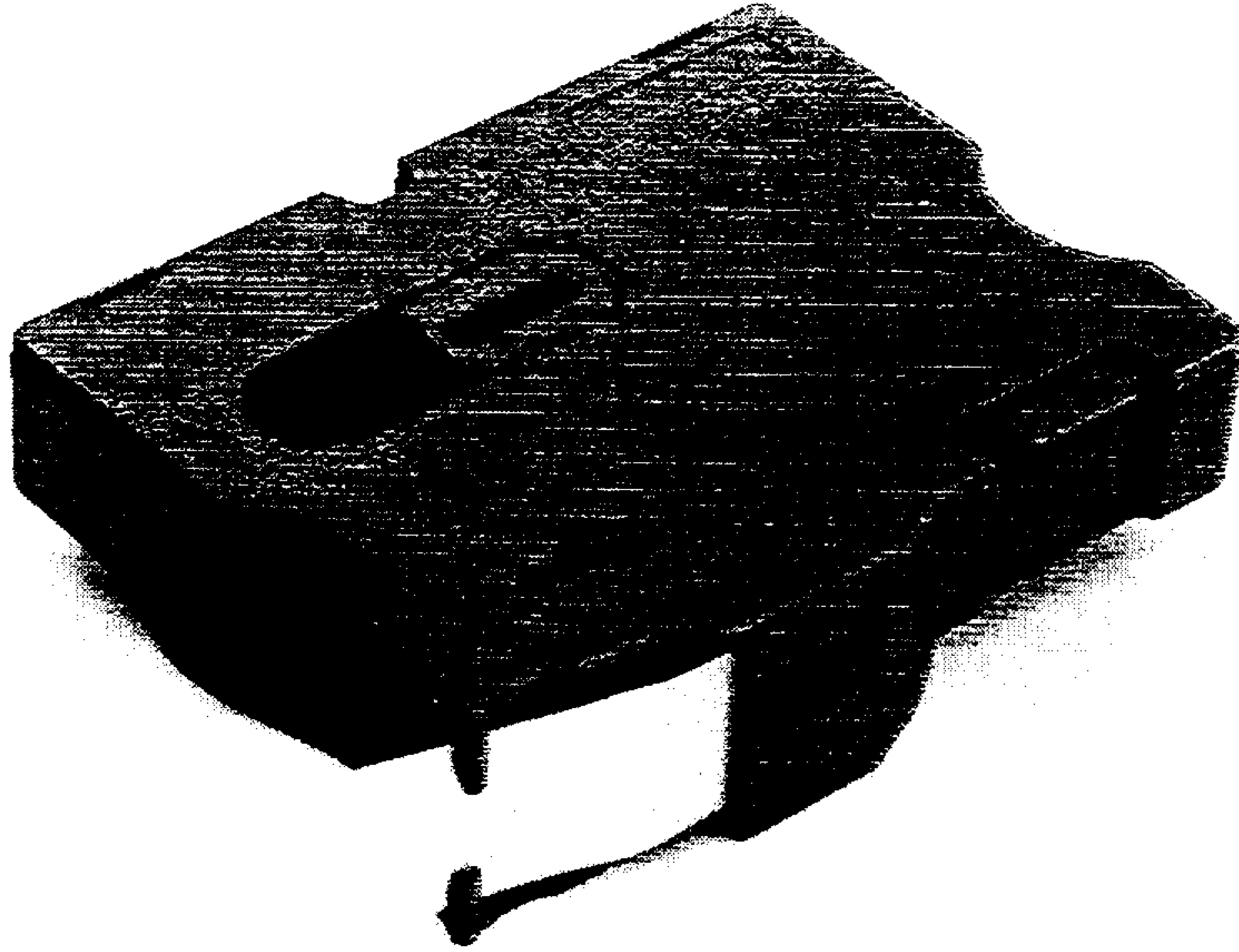

FIG. 7

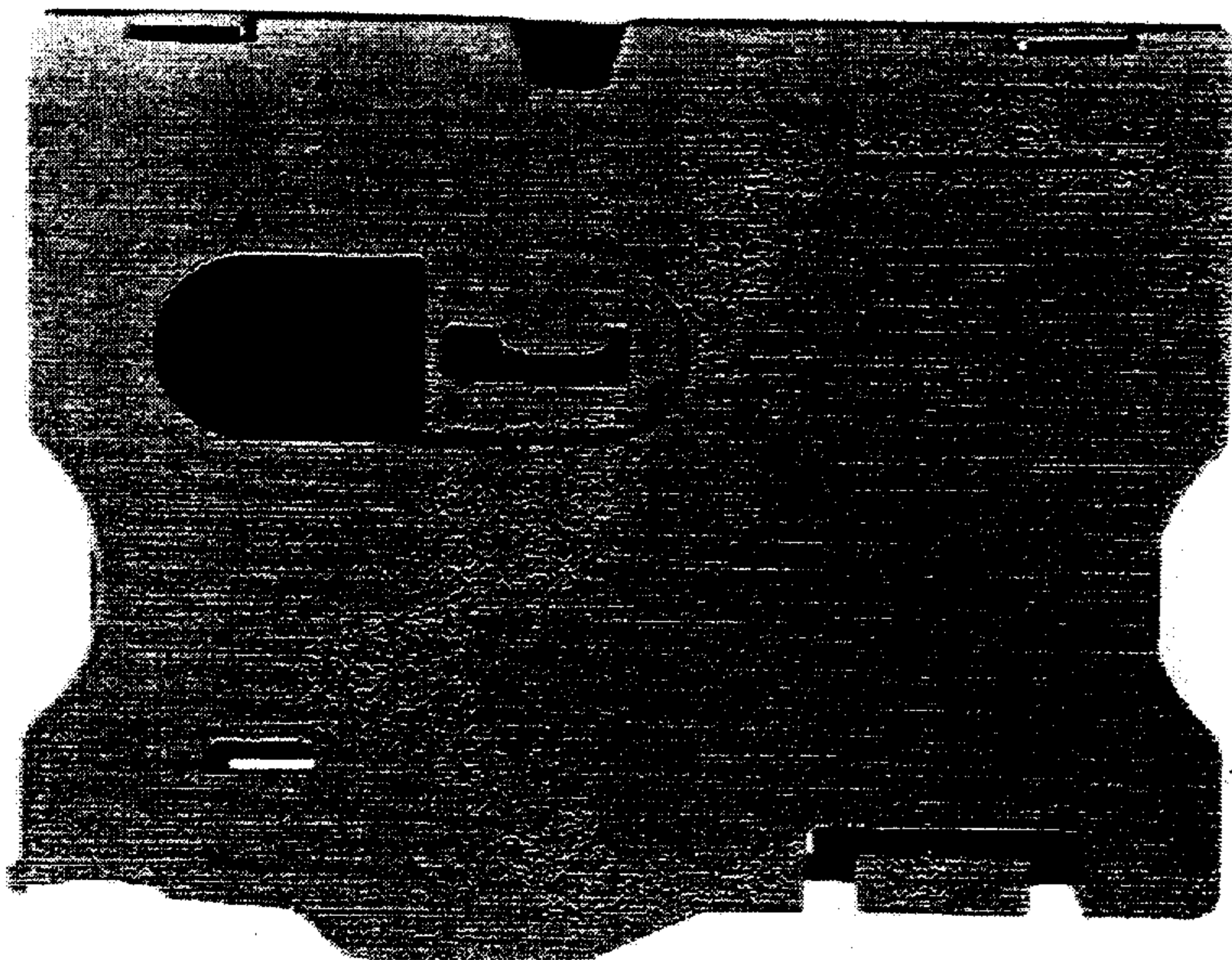

FIG. 8

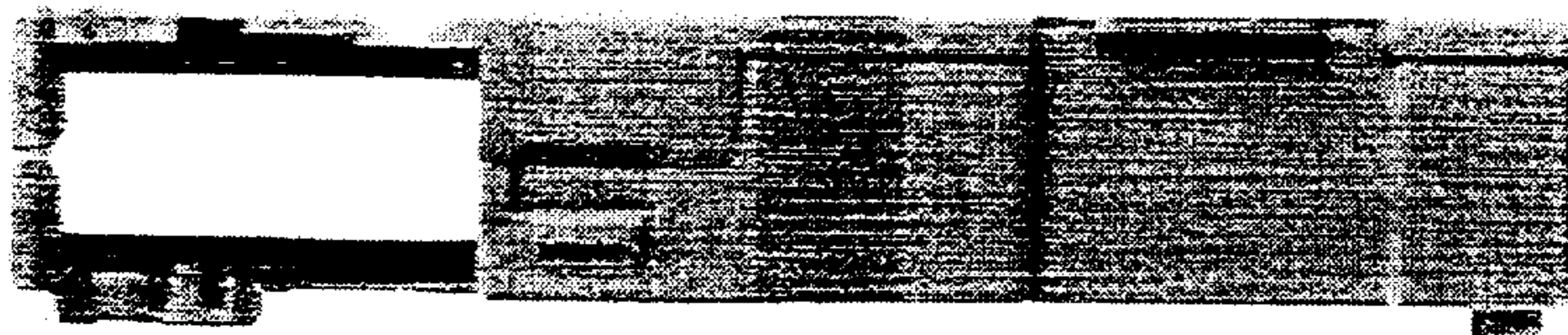

FIG. 9

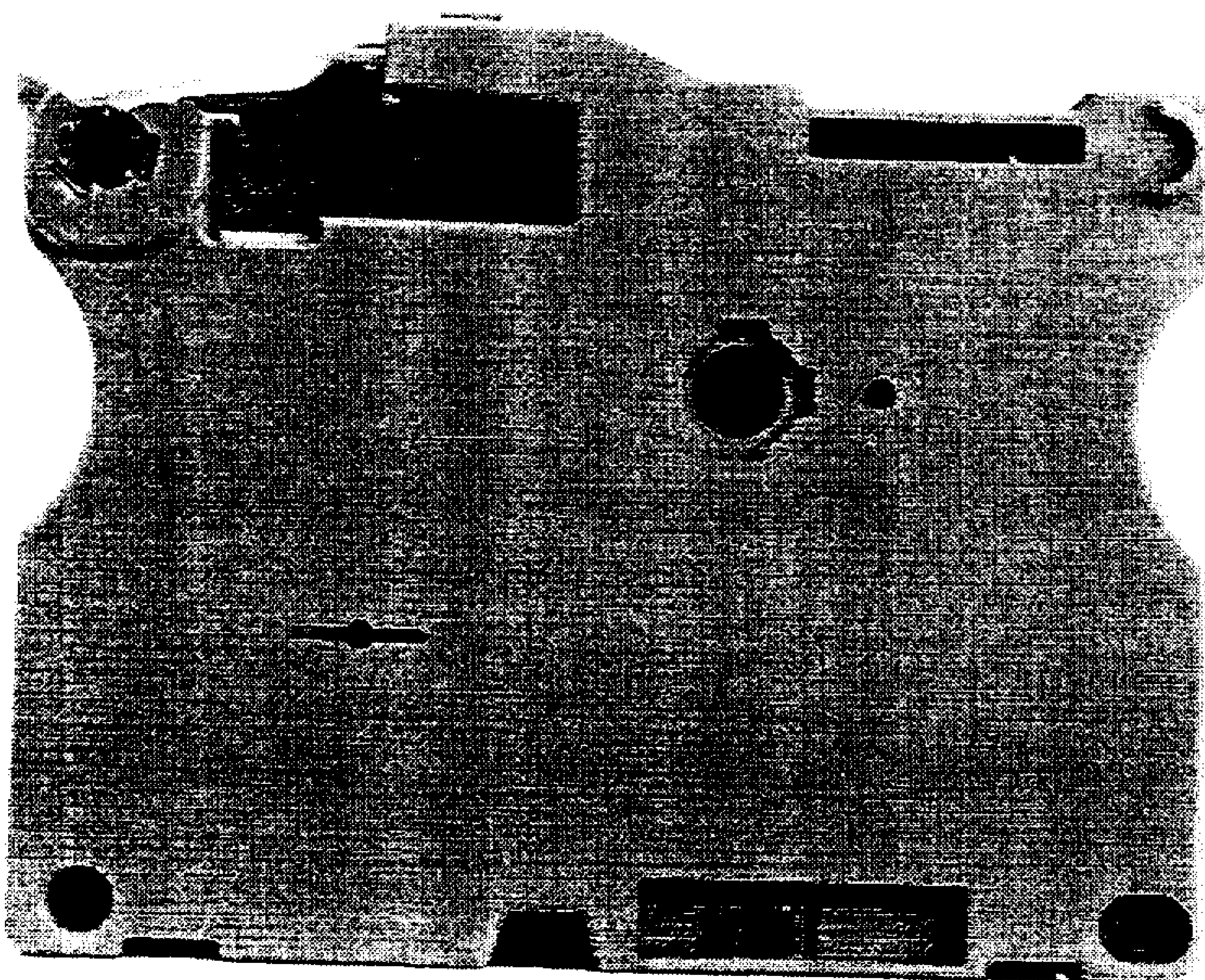

FIG. 10

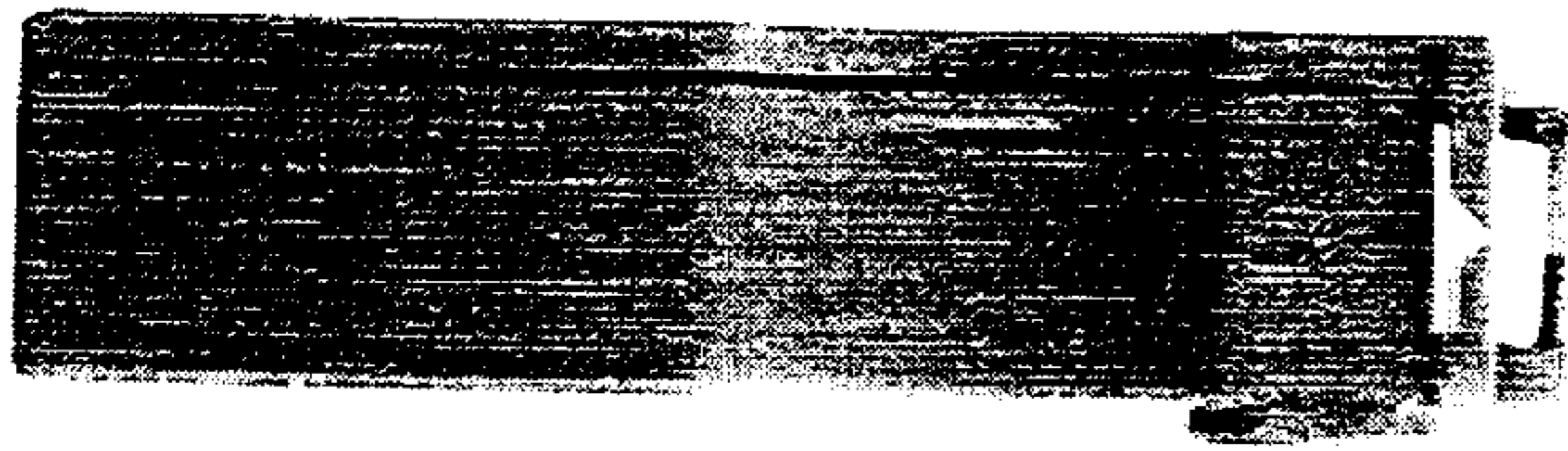

FIG. 11

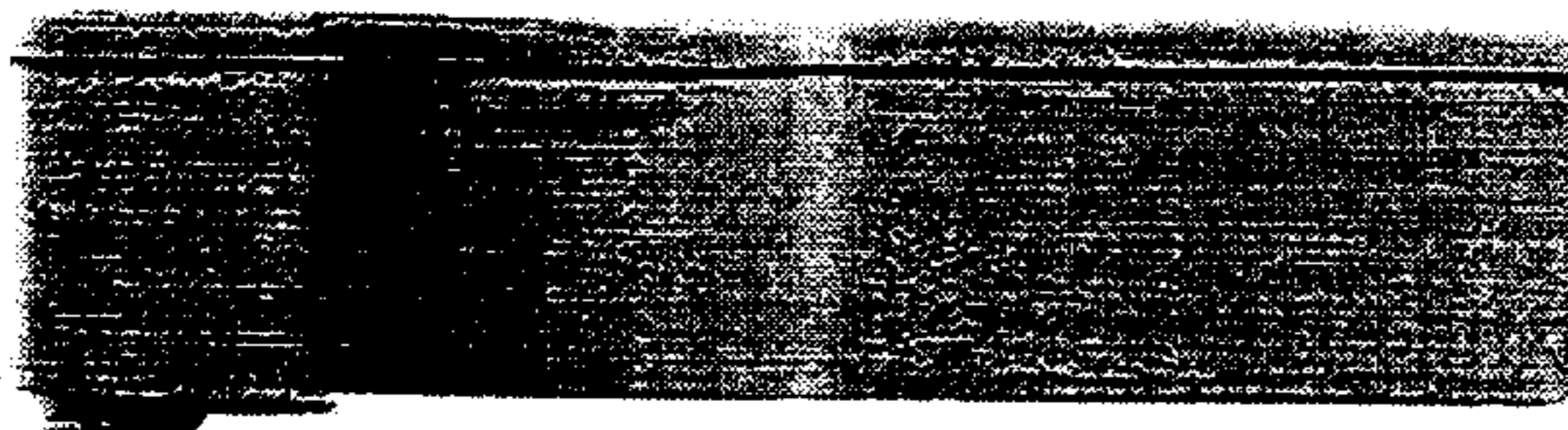

FIG. 12



FIG. 13

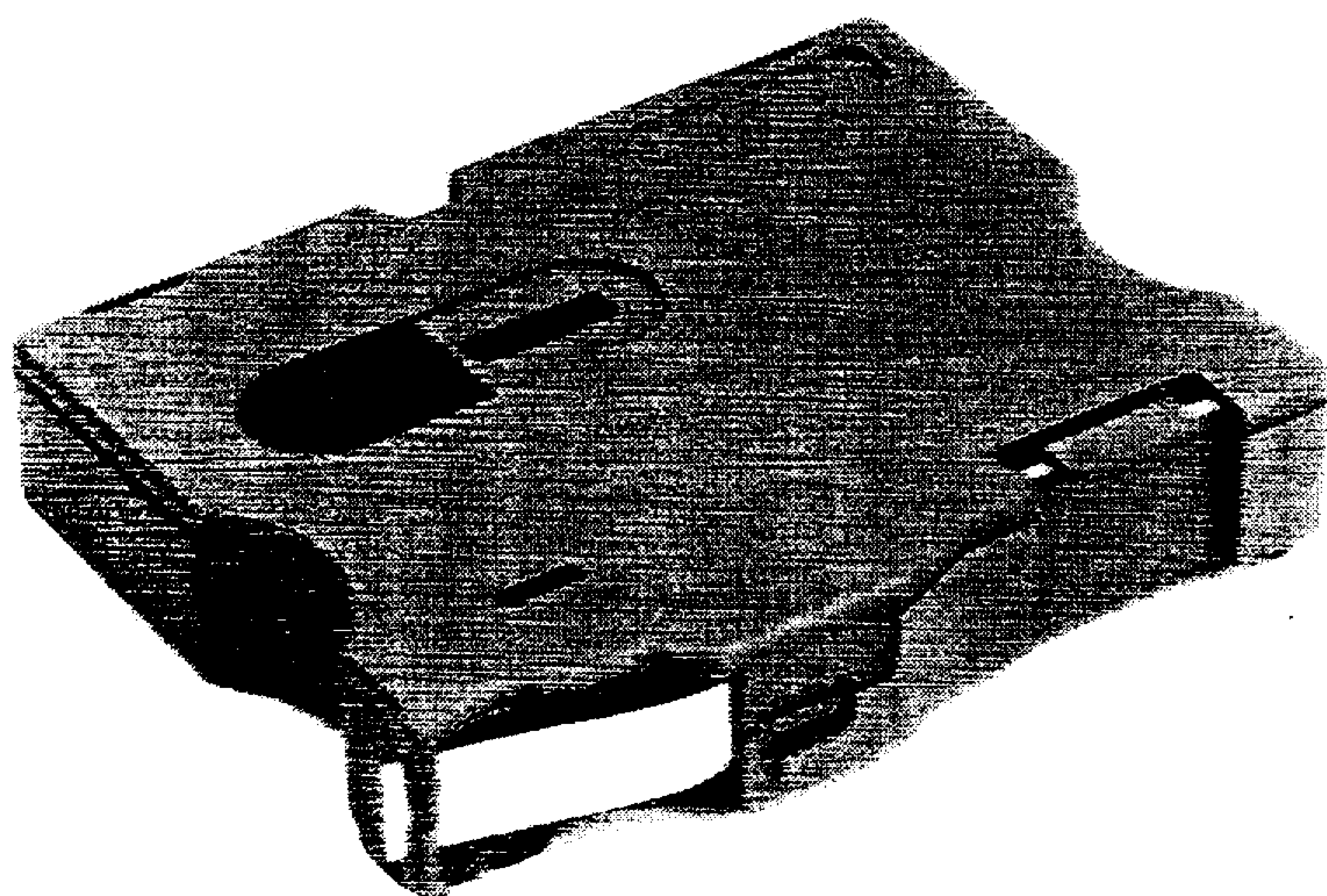

FIG. 14