



US00D354805S

United States Patent [19]

[11] Patent Number: **Des. 354,805**

Bowen et al.

[45] Date of Patent: **** Jan. 24, 1995**

[54] HEARTH CUSHION

[76] Inventors: **Cynthia L. Bowen; Walter L. Bowen**,
both of 2132 Kilkenney Hill Rd.,
Matthews, N.C. 28105

[**] Term: **14 Years**

[21] Appl. No.: **772,012**

[22] Filed: **Oct. 7, 1991**

[52] U.S. Cl. **D23/403; D6/601**

[58] Field of Search **D23/403, 404-406;**
D6/596, 595, 601; 126/12, 13, 201, 277, 500;
5/100, 448

[56] **References Cited**

U.S. PATENT DOCUMENTS

4,903,686 2/1990 Jennings 126/500

FOREIGN PATENT DOCUMENTS

271643 6/1927 United Kingdom 126/500

410917 5/1934 United Kingdom 126/500

412654 7/1934 United Kingdom 126/500

588999 6/1947 United Kingdom 126/500

Primary Examiner—Wallace R. Burke
Assistant Examiner—Robin V. Taylor
Attorney, Agent, or Firm—Ralph H. Dougherty

[57] **CLAIM**

The ornamental design for a hearth cushion, as shown and described.

DESCRIPTION

FIG. 1 is a perspective view of a hearth cushion, showing our new design;

FIG. 2 is a front elevational view thereof;

FIG. 3 is a rear elevational view thereof;

FIG. 4 is a right side elevational view thereof, the left side elevational view being a mirror image;

FIG. 5 is a top plan view thereof;

FIG. 6 is a bottom plan view thereof;

FIG. 7 is a perspective view of a second embodiment;

FIG. 8 is a front elevational view thereof;

FIG. 9 is a rear elevational view thereof;

FIG. 10 is a top plan view thereof; and,

FIG. 11 is a bottom plan view thereof.

The broken line showing is for illustrative purposes only and forms no part of the claimed design.

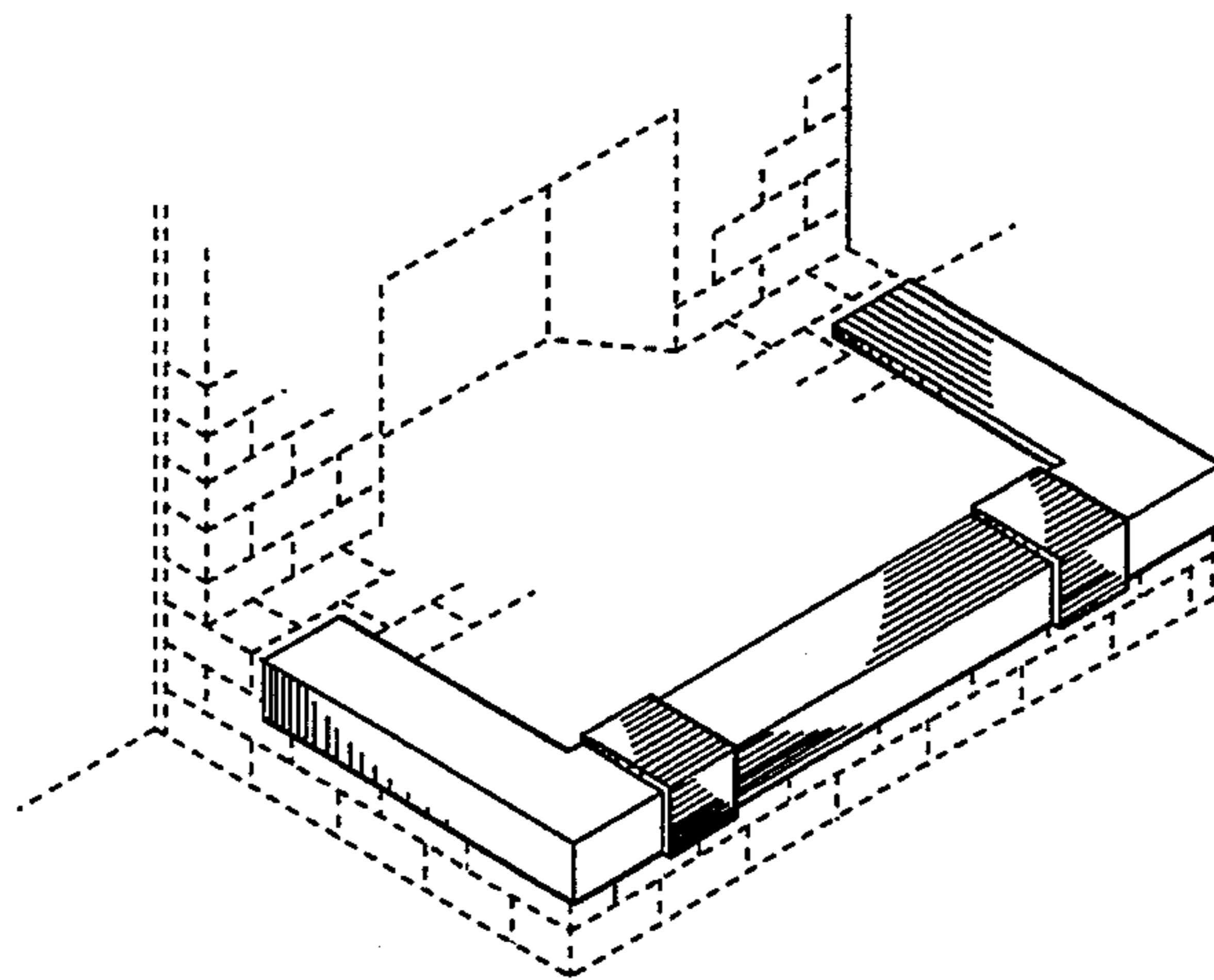
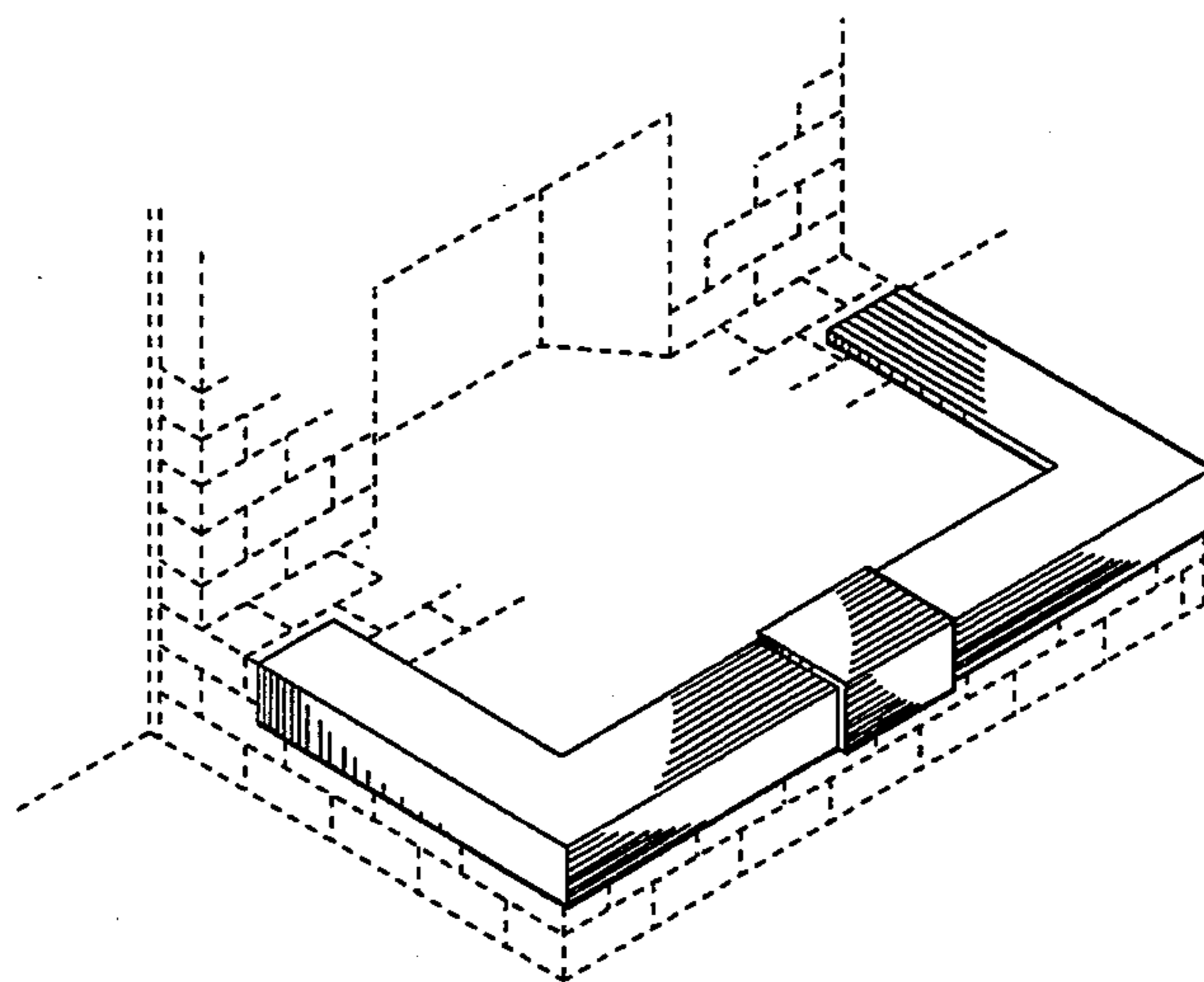

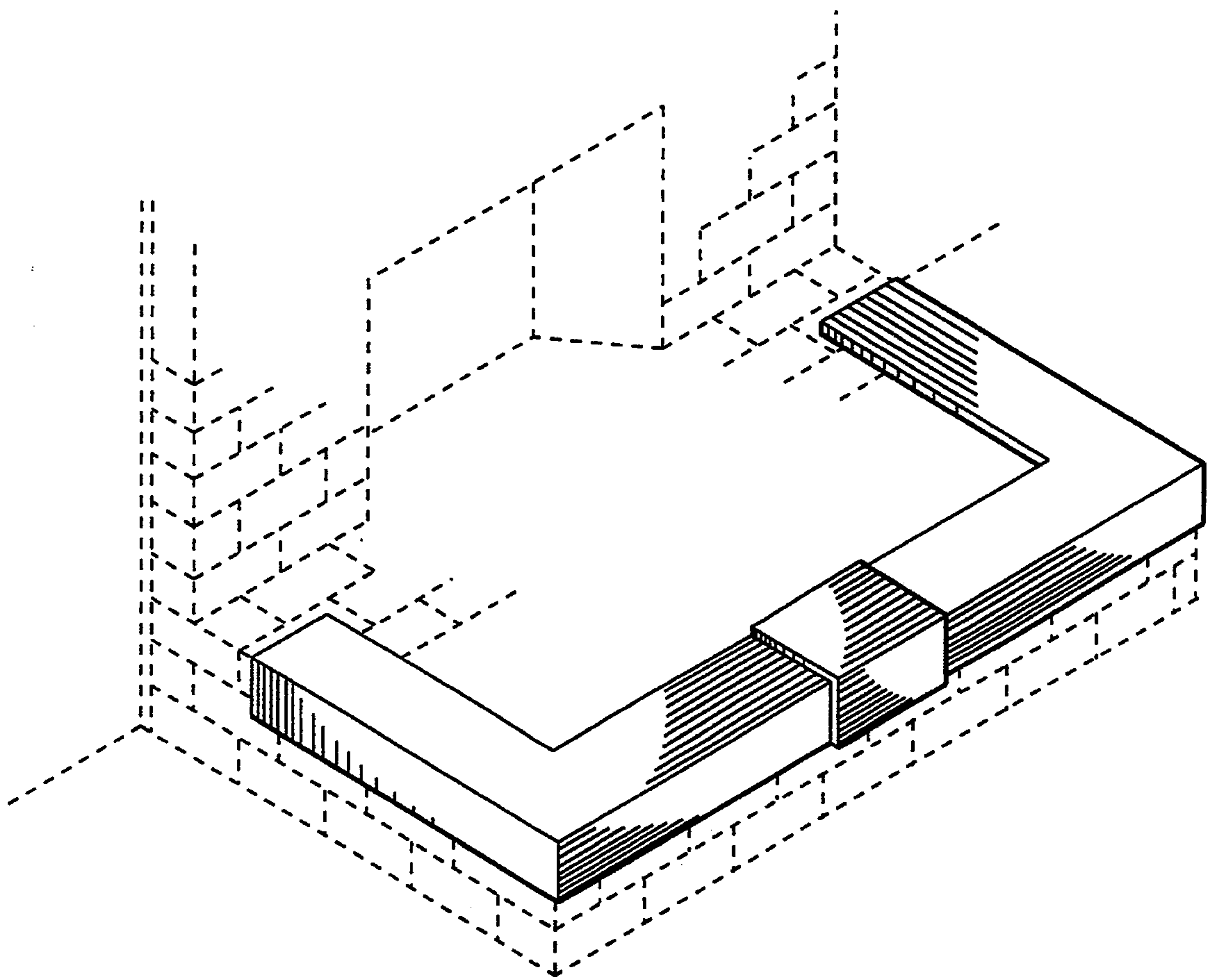

Fig. 1

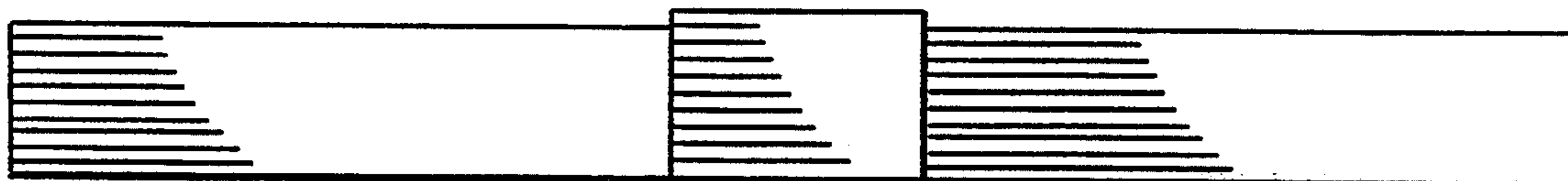

Fig. 2

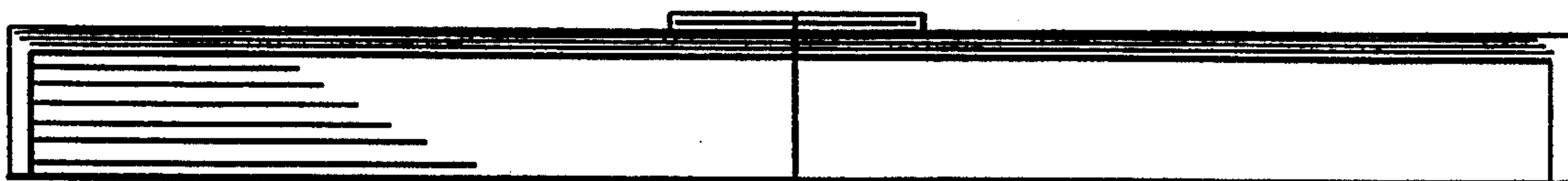

Fig. 3

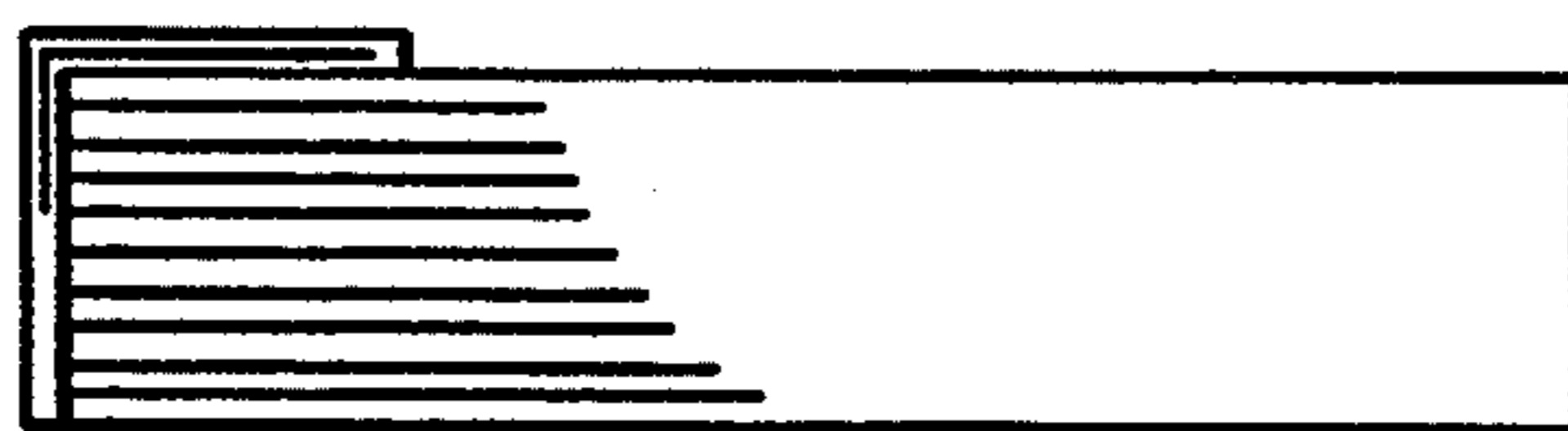

Fig. 4

Fig. 5

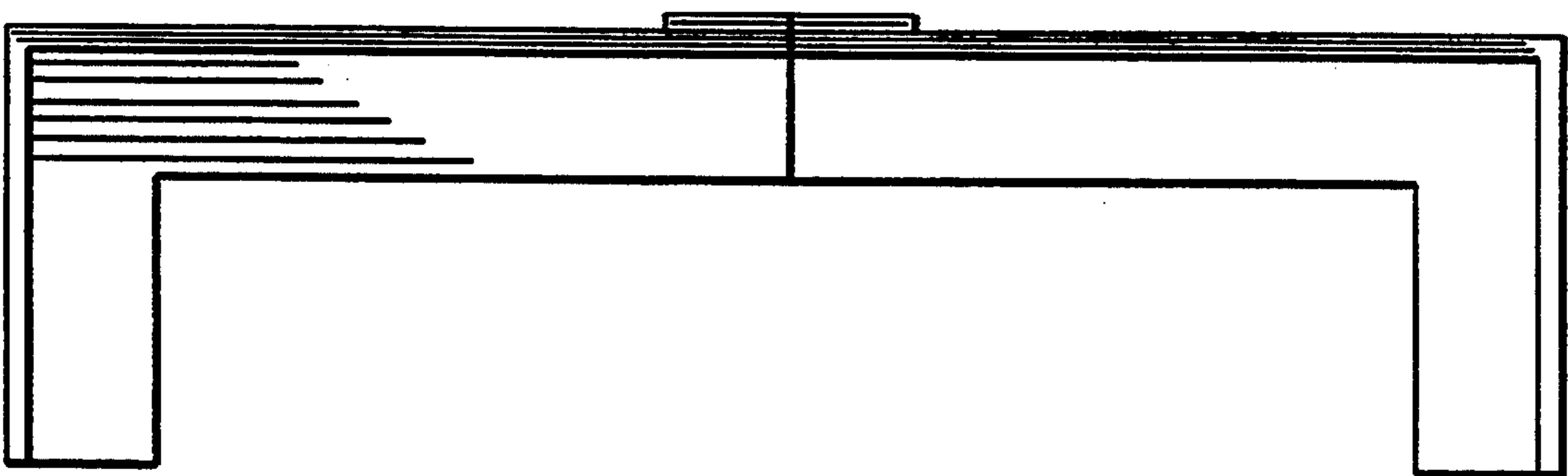
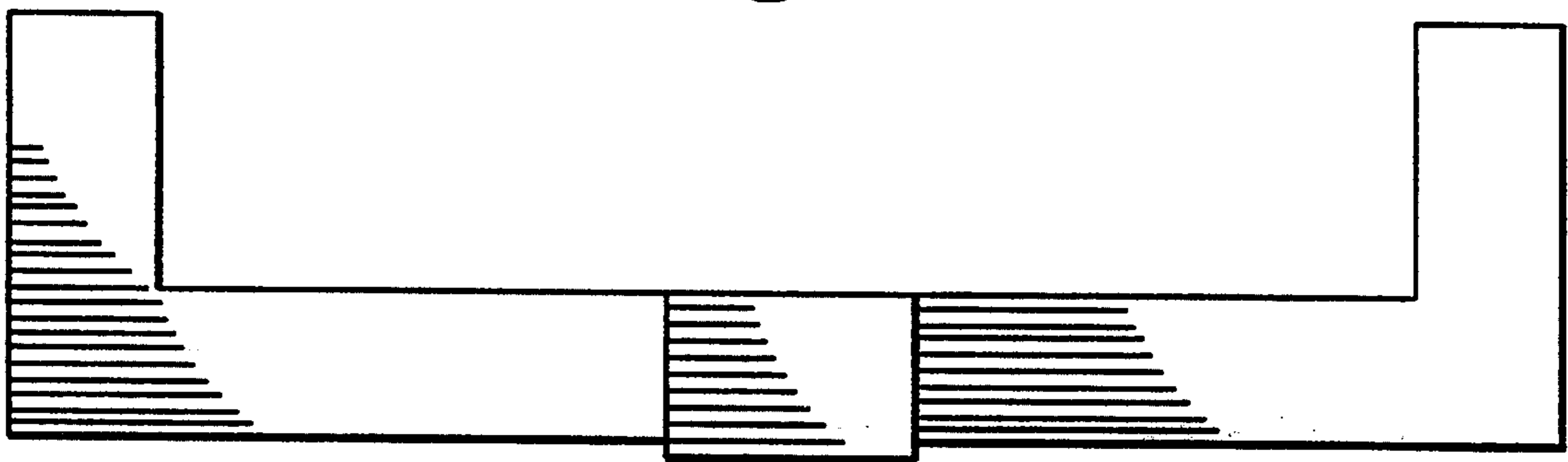

Fig. 6

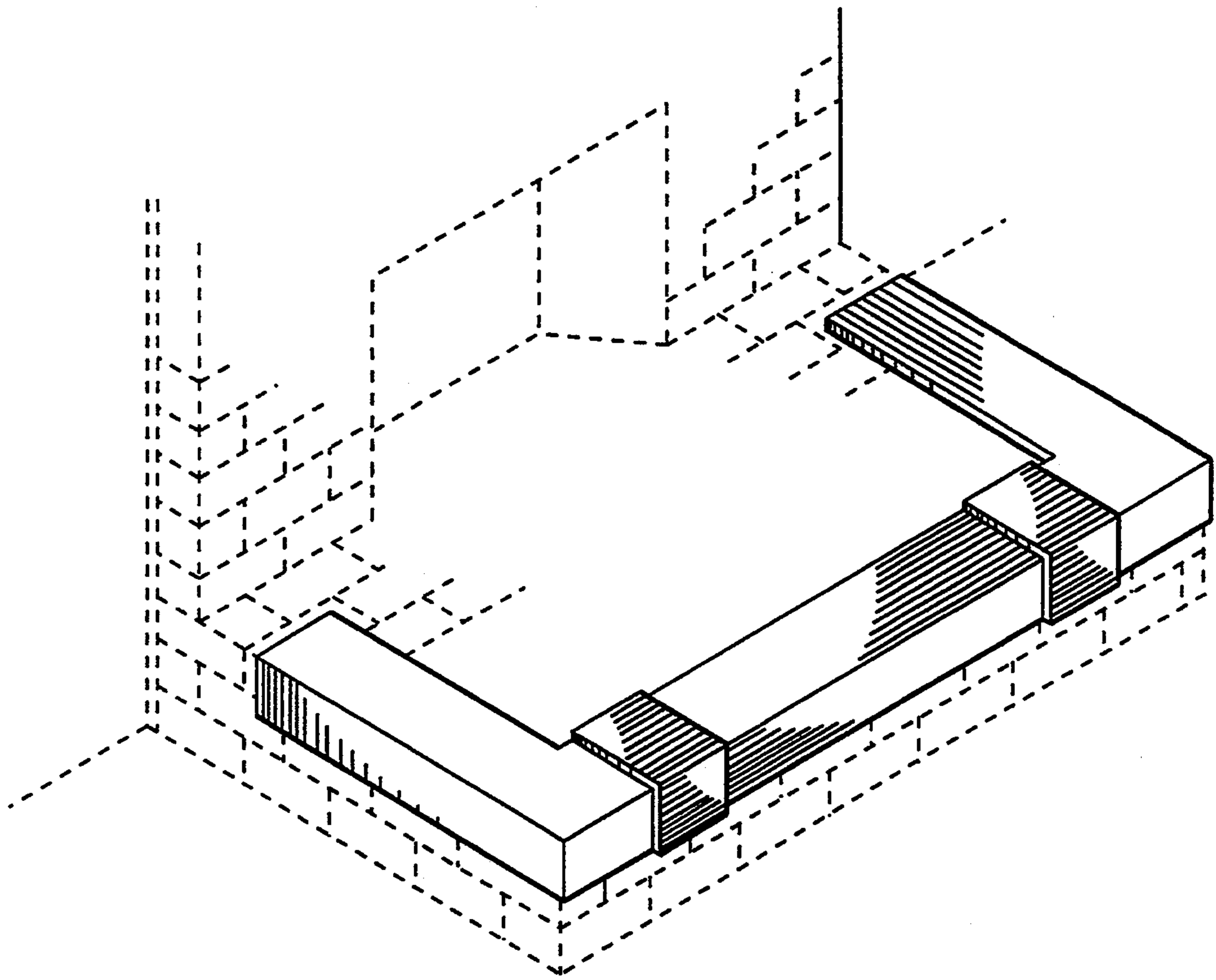

Fig. 7

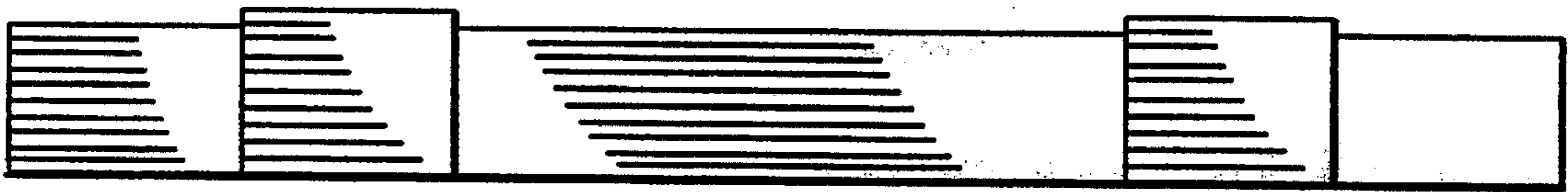

Fig. 8

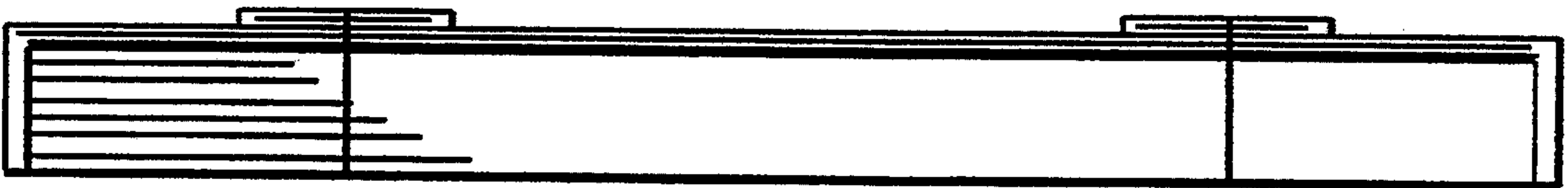

Fig. 9

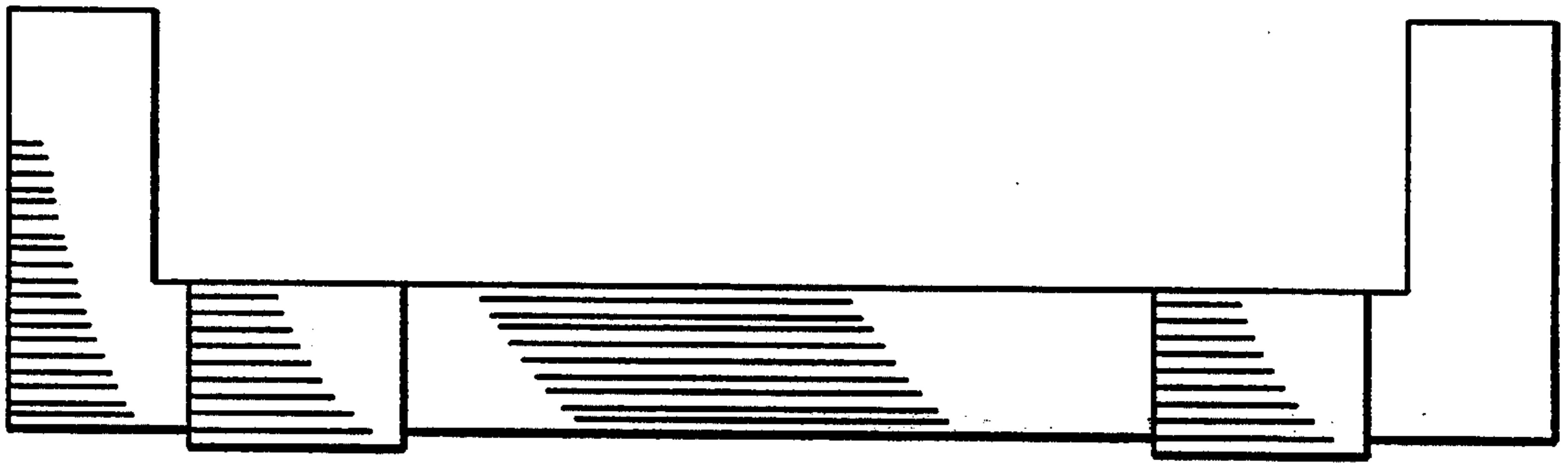

Fig. 10

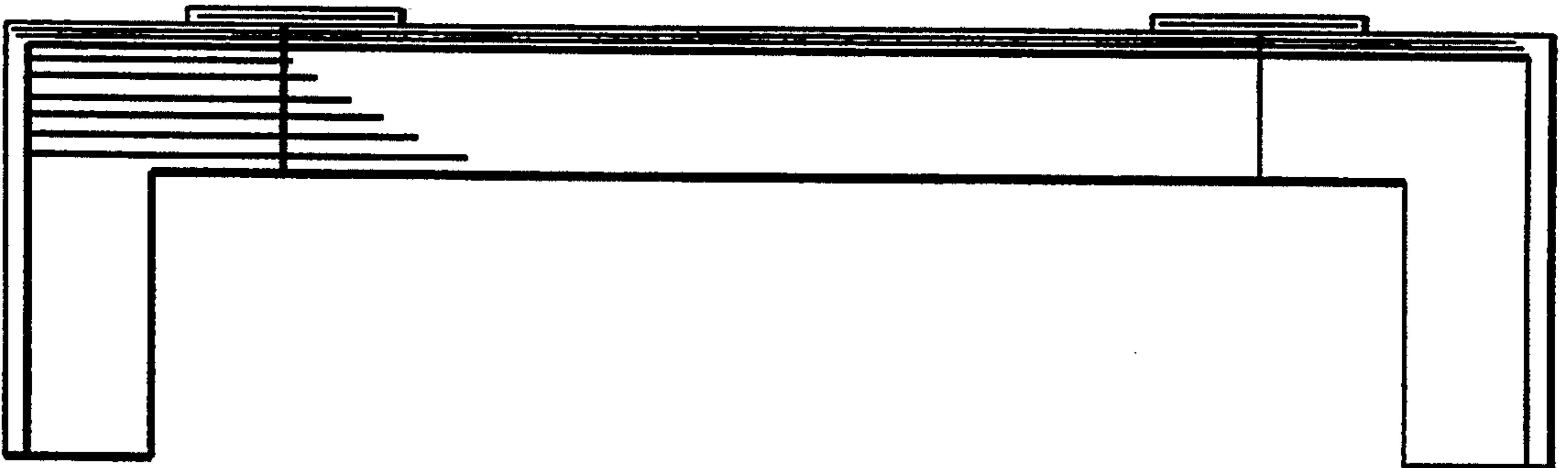

Fig. 11