



US00D354071S

# United States Patent [19]

[11] Patent Number: **Des. 354,071**

Lawson et al.

[45] Date of Patent: **\*\* Jan. 3, 1995**

[54] **TYPEWRITER**

- D. 300,434 3/1989 Tamada et al. .... D18/1
- D. 328,606 8/1992 Mendel et al. .... D18/1
- D. 332,617 1/1993 Omino ..... D18/1

[75] Inventors: **Freddie M. Lawson**, Mt. Sterling;  
**Peter J. Mendel**; **Steven A. Silverstein**, both of Lexington, all of Ky.

*Primary Examiner*—Martie Thompson  
*Assistant Examiner*—Caron D. Veynar  
*Attorney, Agent, or Firm*—John J. McArdle, Jr.

[73] Assignee: **Lexmark International, Inc.**,  
Greenwich, Conn.

[57] **CLAIM**

[\*\*] Term: **14 Years**

The ornamental design for a typewriter, as shown and described.

[21] Appl. No.: **7,748**

**DESCRIPTION**

[22] Filed: **Apr. 29, 1993**

[52] U.S. Cl. .... **D18/1**

[58] Field of Search ..... **D18/1, 2, 11;**  
400/109-111, 472, 485, 486, 691-694

FIG. 1 is a top plan view of a typewriter showing our new design;  
FIG. 2 is a front elevational view thereof;  
FIG. 3 is a right side elevational view thereof;  
FIG. 4 is a left side elevational view thereof;  
FIG. 5 is a rear elevational view thereof;  
FIG. 6 is a bottom plan view thereof; and,  
FIG. 7 is a top, front, left side perspective view thereof.

[56] **References Cited**

**U.S. PATENT DOCUMENTS**

D. 281,701 12/1985 Wang ..... D18/1

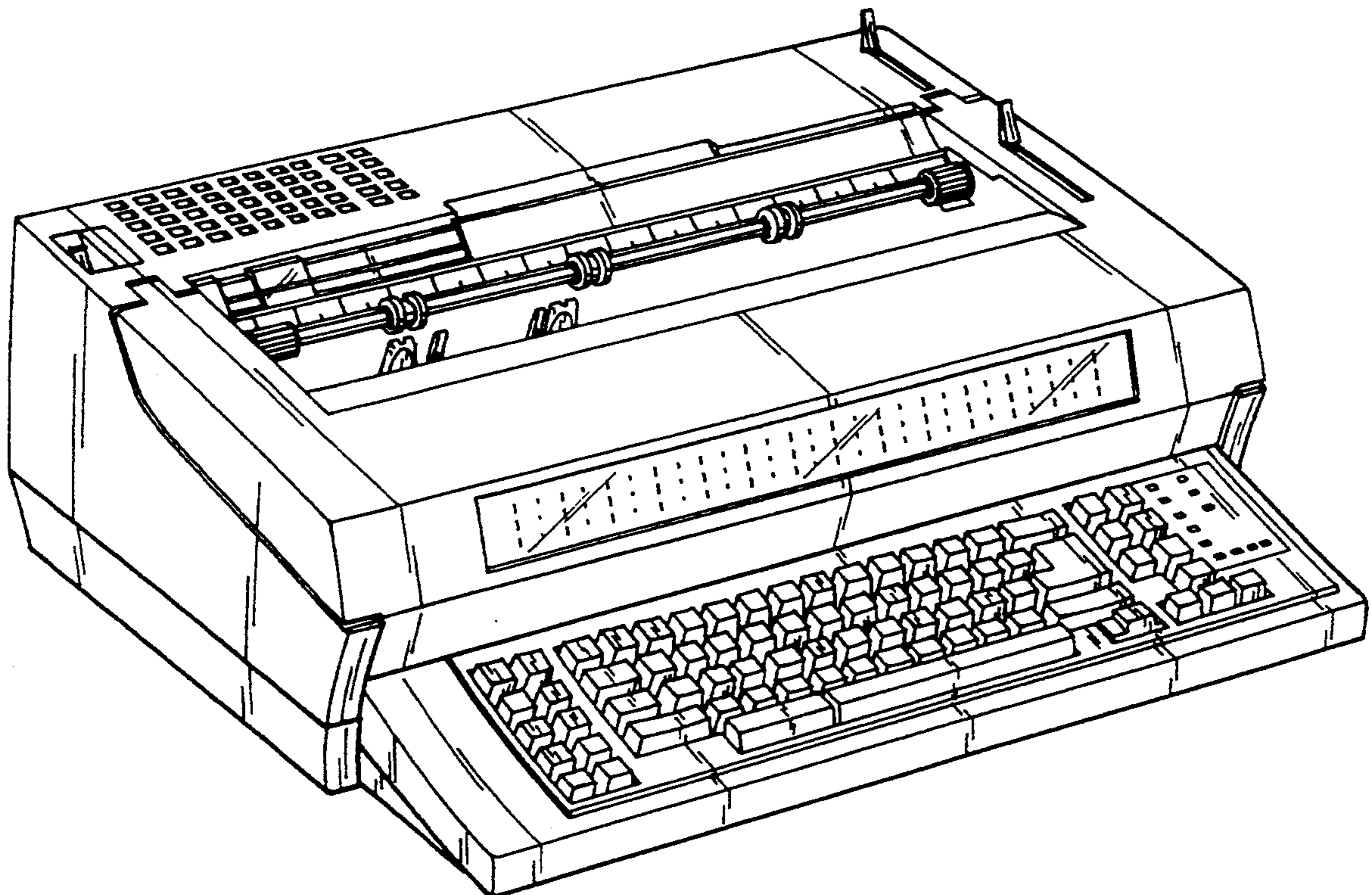

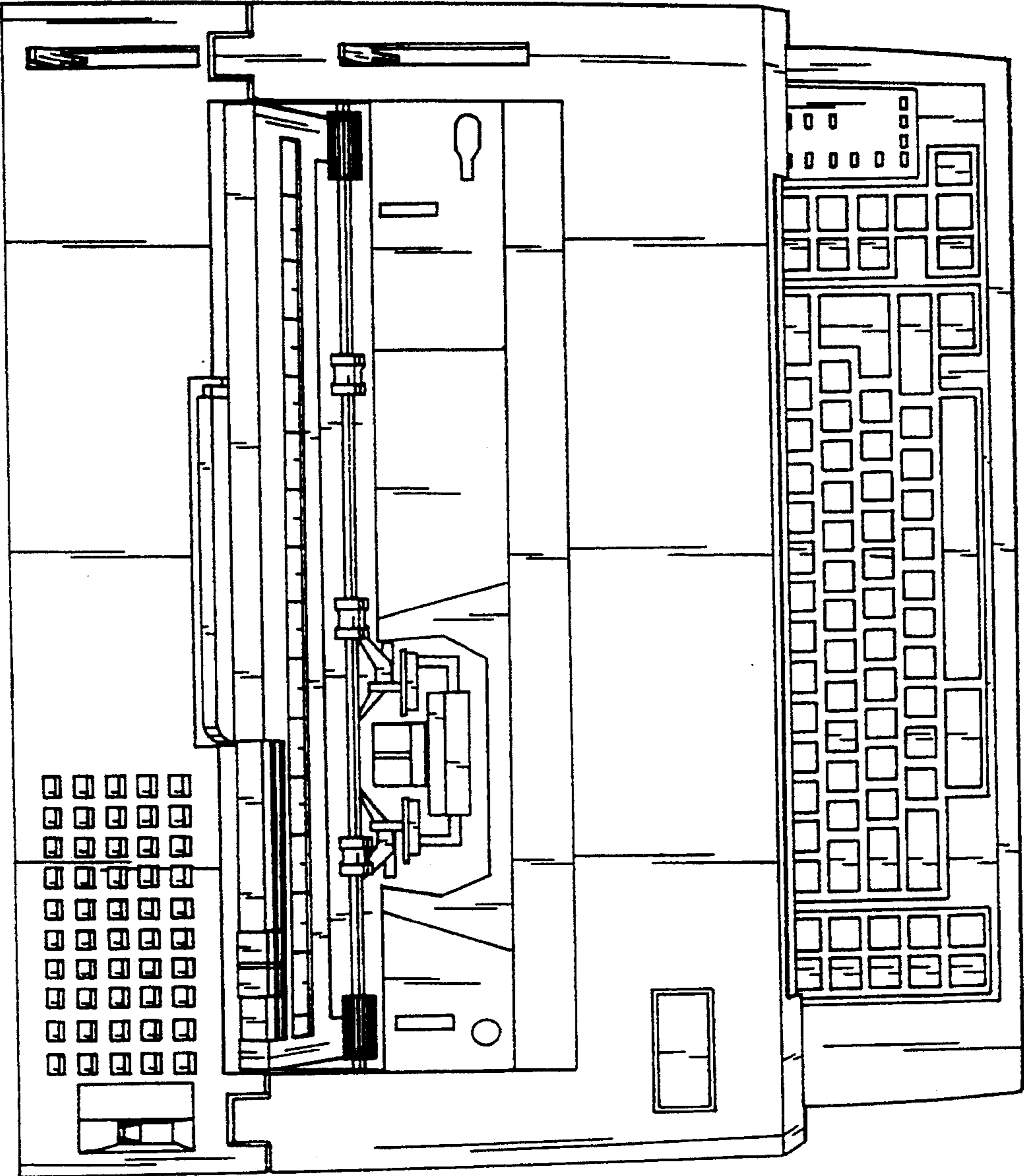

Fig. 1

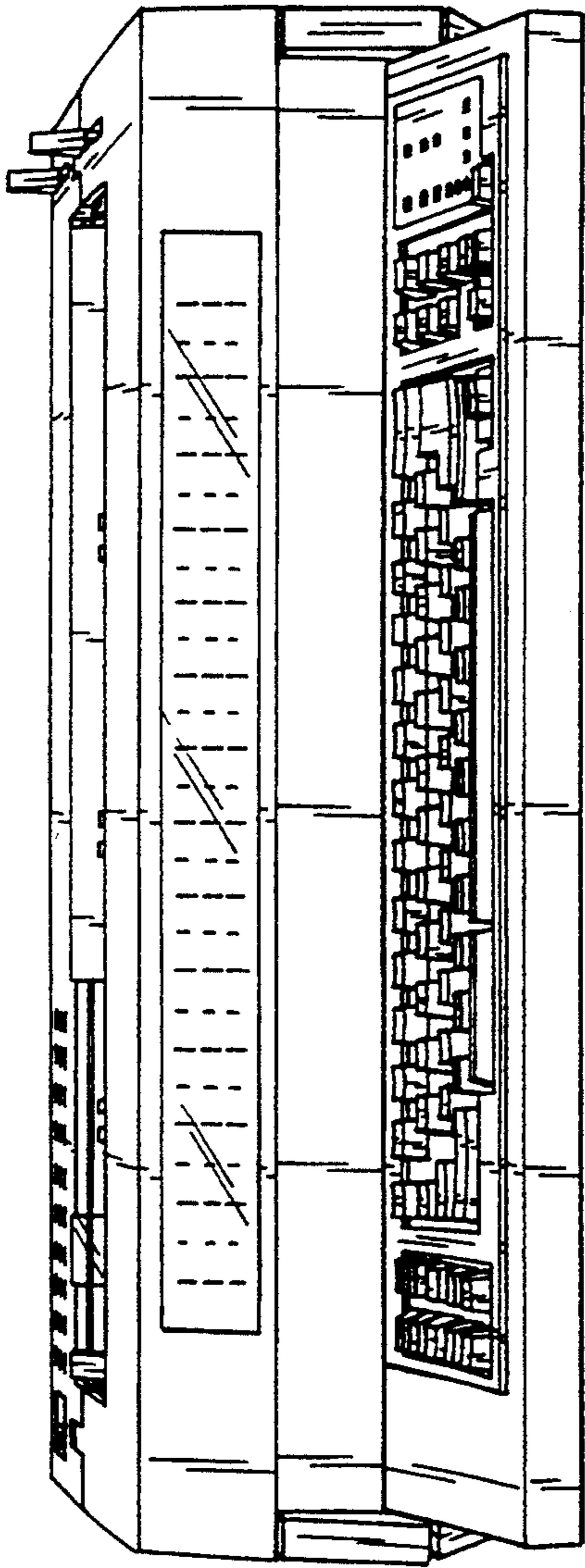

Fig. 2

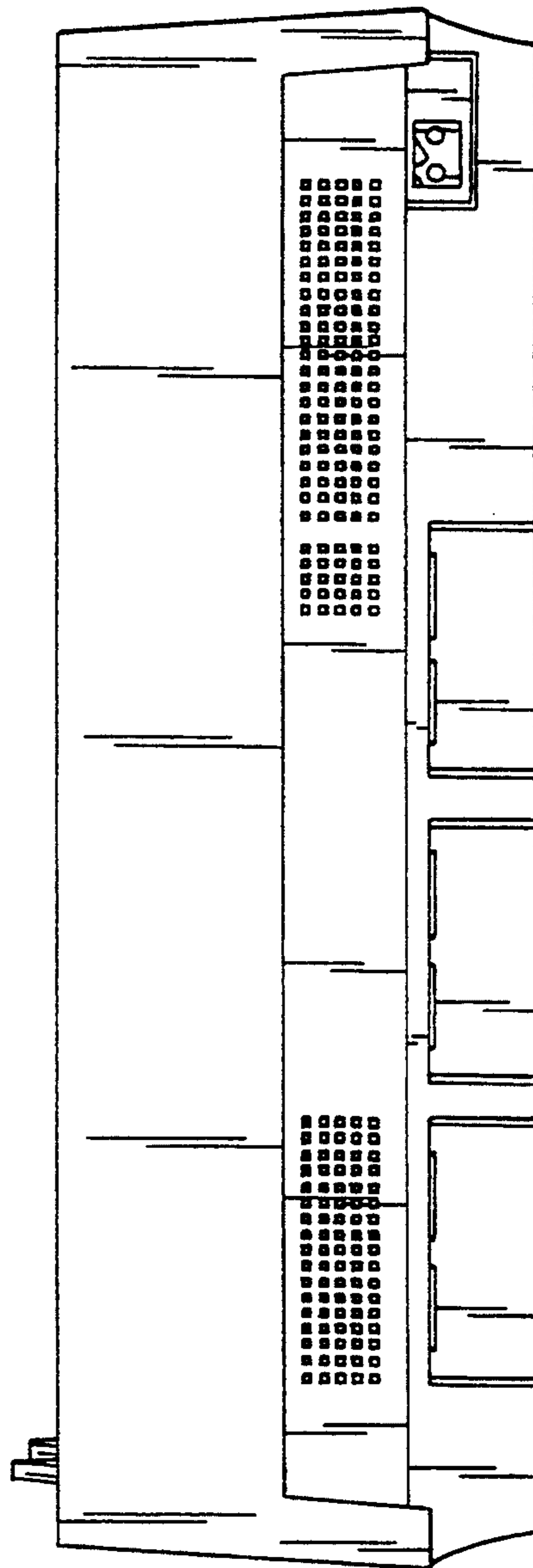

Fig. 5

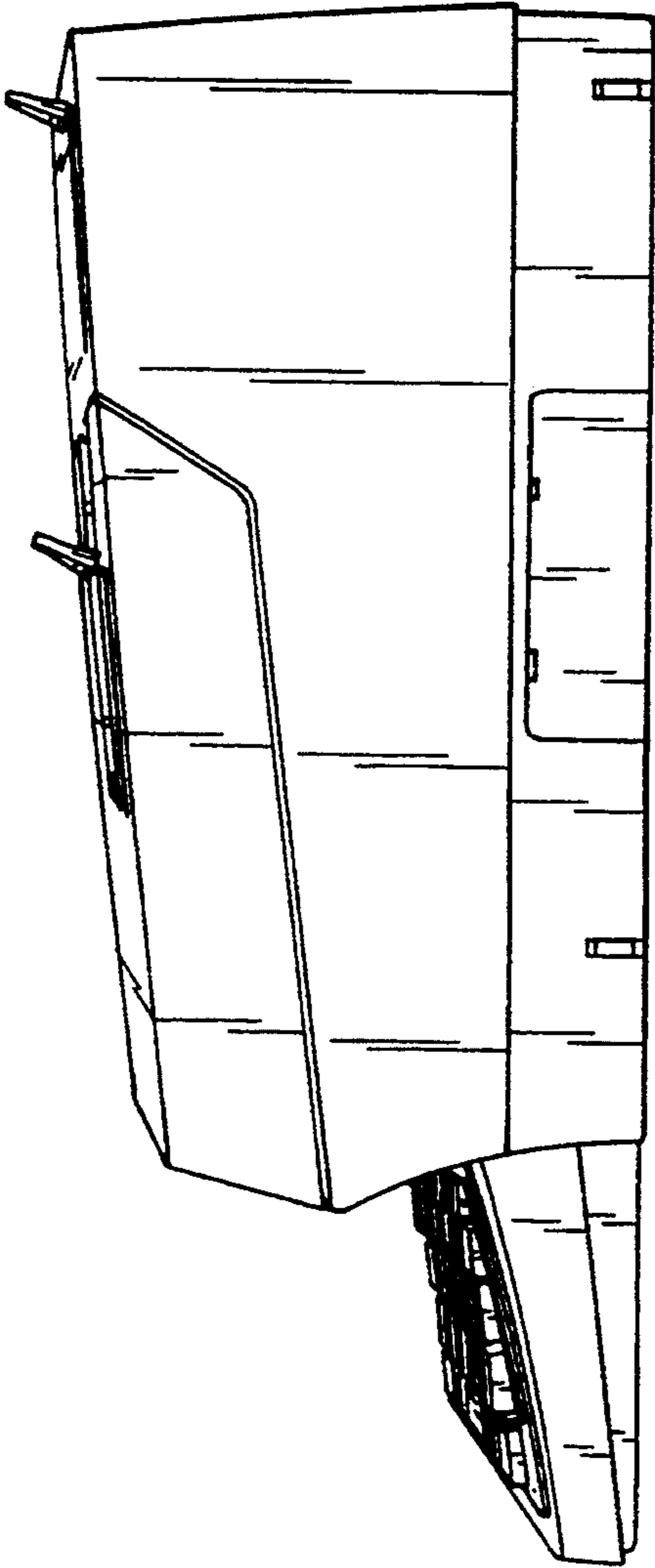

Fig. 3

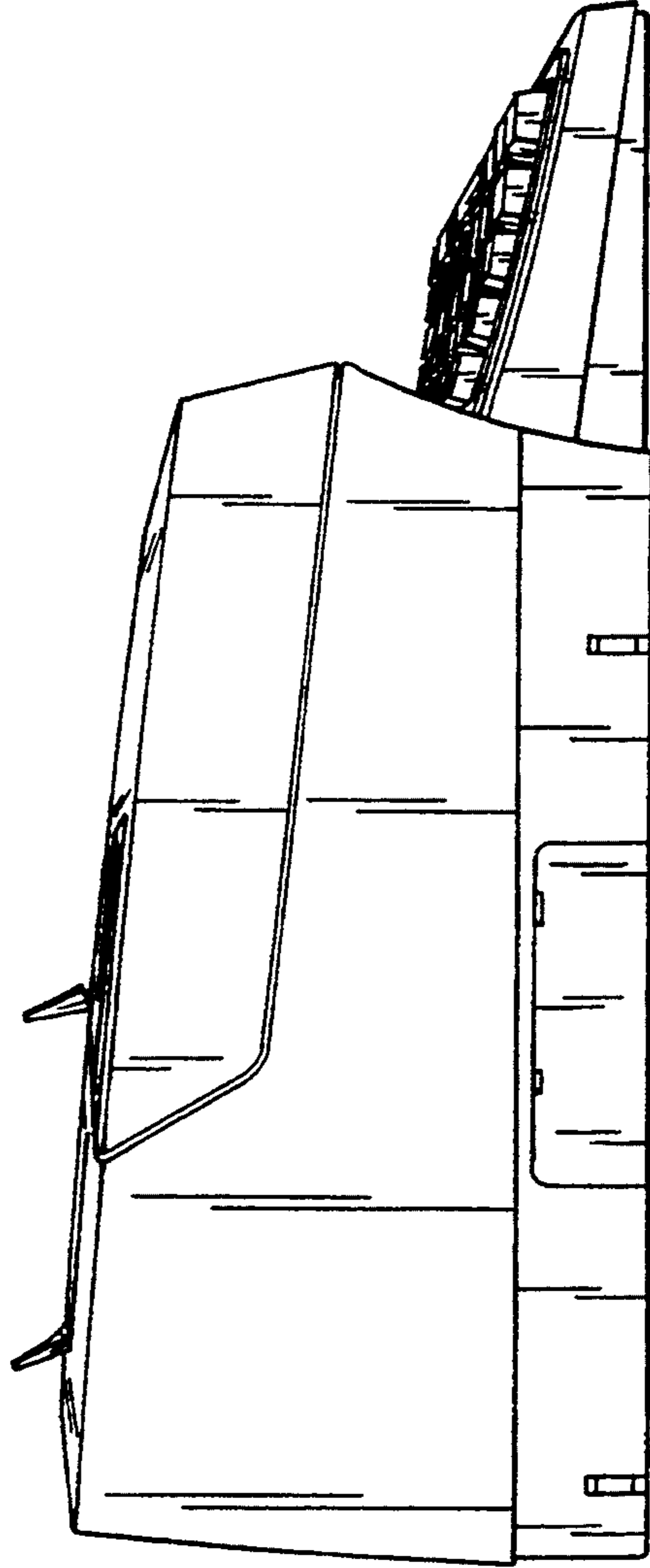

Fig. 4



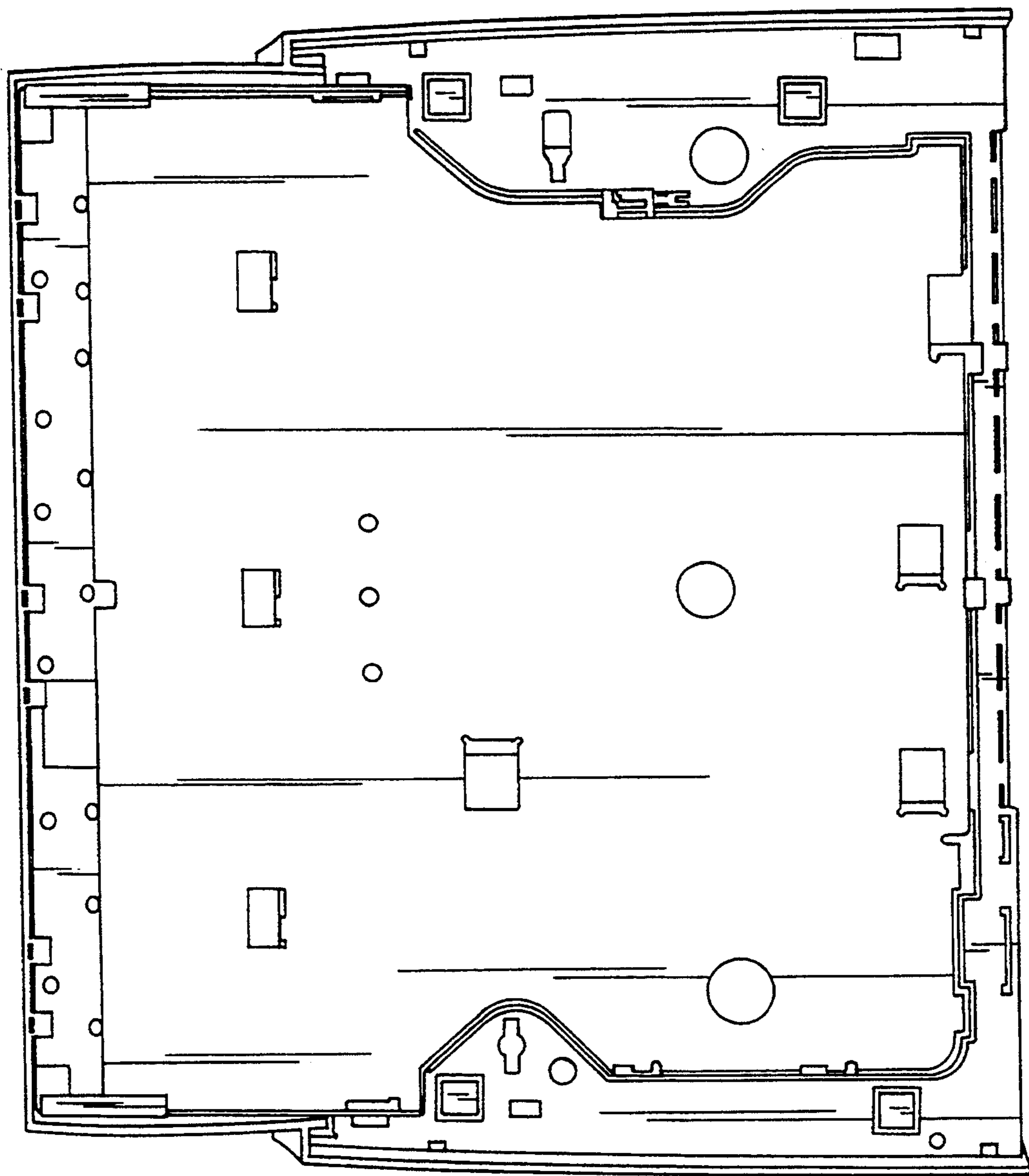

Fig. 6

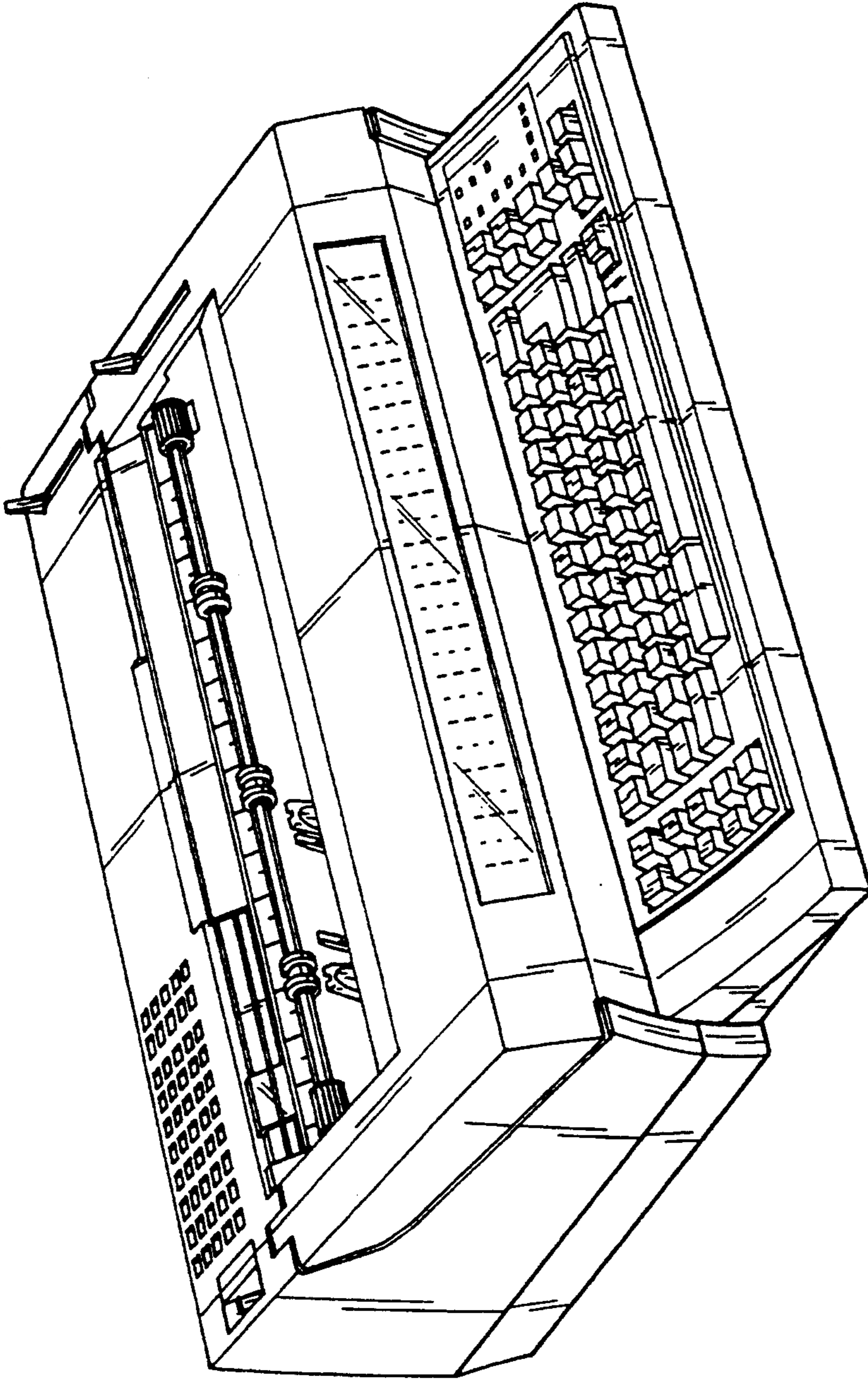

Fig. 7