



US00D353386S

United States Patent [19]

[11] Patent Number: **Des. 353,386**

Noda

[45] Date of Patent: **** Dec. 13, 1994**

[54] **CUTTING MACHINE FOR RAILROAD RAIL**

4,156,991 6/1979 Mellrath 51/108 R
4,765,098 8/1988 Duff et al. 51/178 X

[75] Inventor: **Hirotooshi Noda, Atsugi, Japan**

Primary Examiner—Alan P. Douglas
Assistant Examiner—Antoine D. Davis
Attorney, Agent, or Firm—Keck, Mahin & Cate

[73] Assignee: **Kabushiki Kaisha Yamazaki
Haguruma Seisakusho, Toda Atsugi,
Japan**

[57] **CLAIM**

[**] Term: **14 Years**

The ornamental design for a cutting machine for railroad rail, as shown and described.

[21] Appl. No.: **10,673**

DESCRIPTION

[22] Filed: **Jul. 15, 1993**

[52] U.S. Cl. **D15/127**

[58] **Field of Search** D8/61; 30/372, 388;
51/99, 178, 241 LG, 241 S, 241 R, 166 R, 985,
166 FB, 166 B, 166.35, 93, 179, 108 R; 83/490,
486, 574, 745, 743; 104/9, 13, 14, 17.1, 17.2;
144/103; 414/329; D15/127, 199

FIG. 1 is a left side perspective view of a cutting machine for railroad rail showing my design; FIG. 2 is a right side perspective view thereof; FIG. 3 is a right side elevational view thereof; FIG. 4 is a left side elevational view thereof; FIG. 5 is a front elevational view thereof; FIG. 6 is a rear elevational view thereof; and, FIG. 7 is a top plan view thereof.

[56] **References Cited**

U.S. PATENT DOCUMENTS

4,033,074 7/1977 Lutts 51/108 R
4,068,415 1/1978 Mellrath 51/108 R

The cutting disk shown in FIG. 2 has been omitted from the balance of the drawing figures for ease and clarity of illustration.

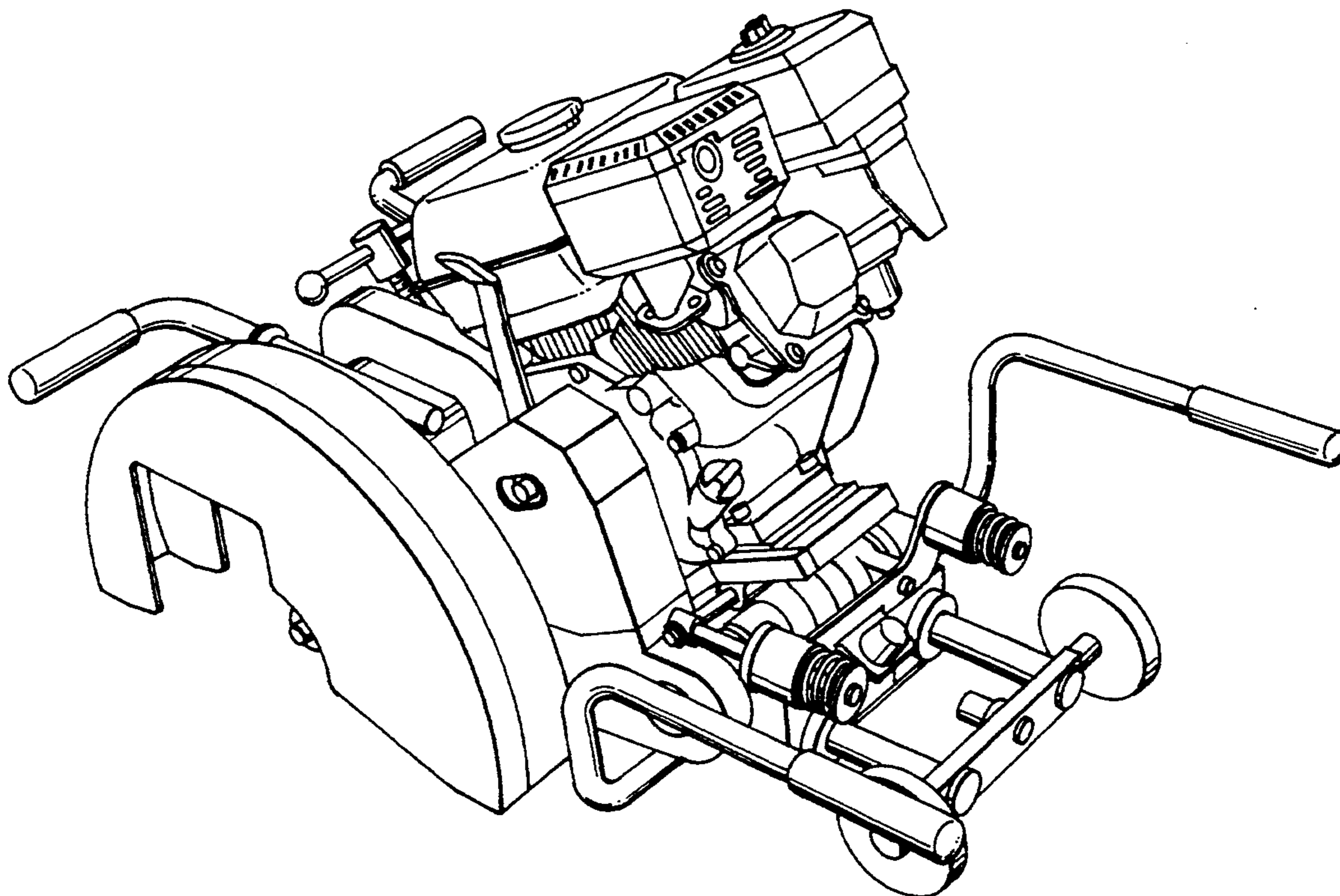

FIG. 1

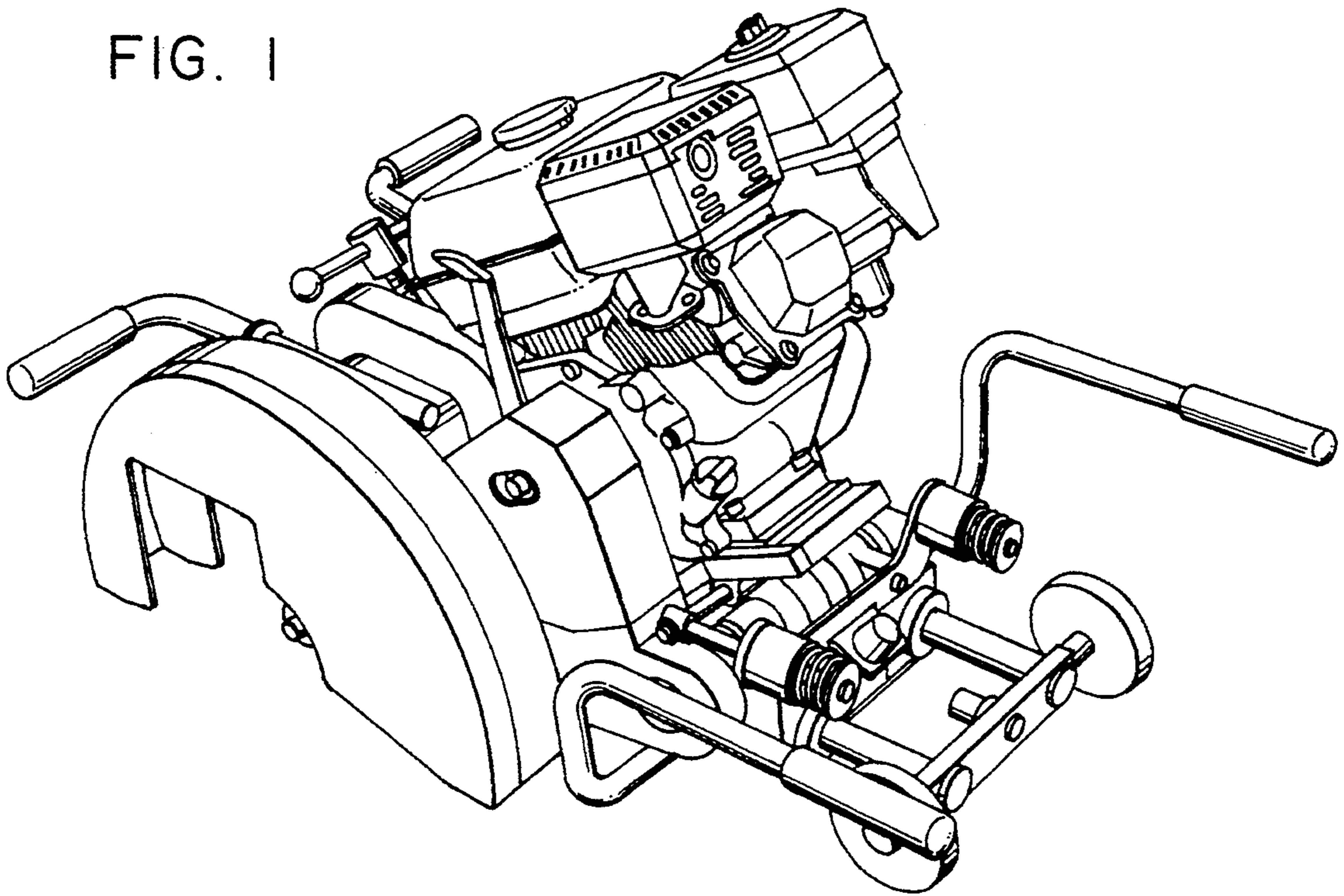

FIG. 2

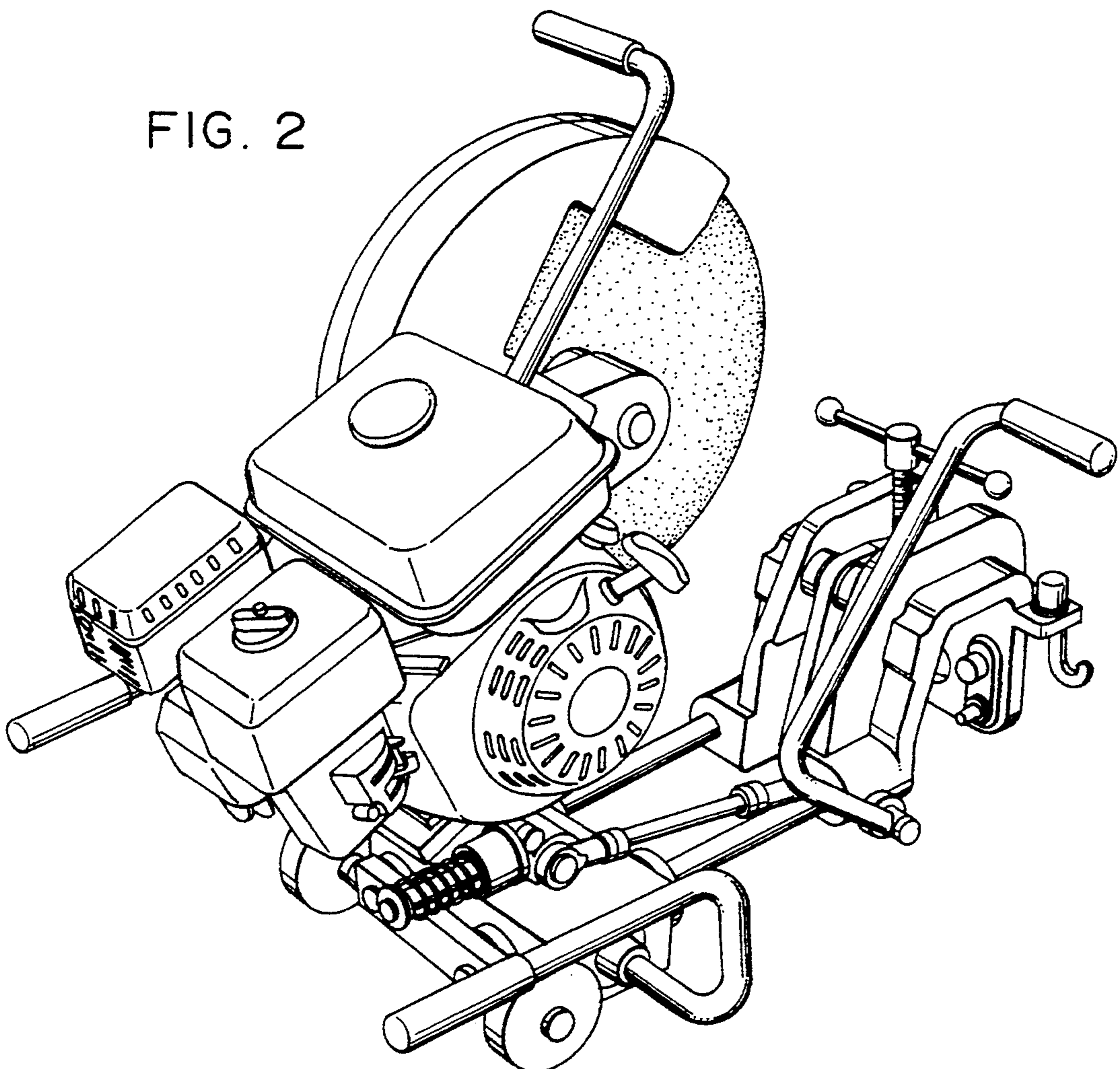

FIG. 3

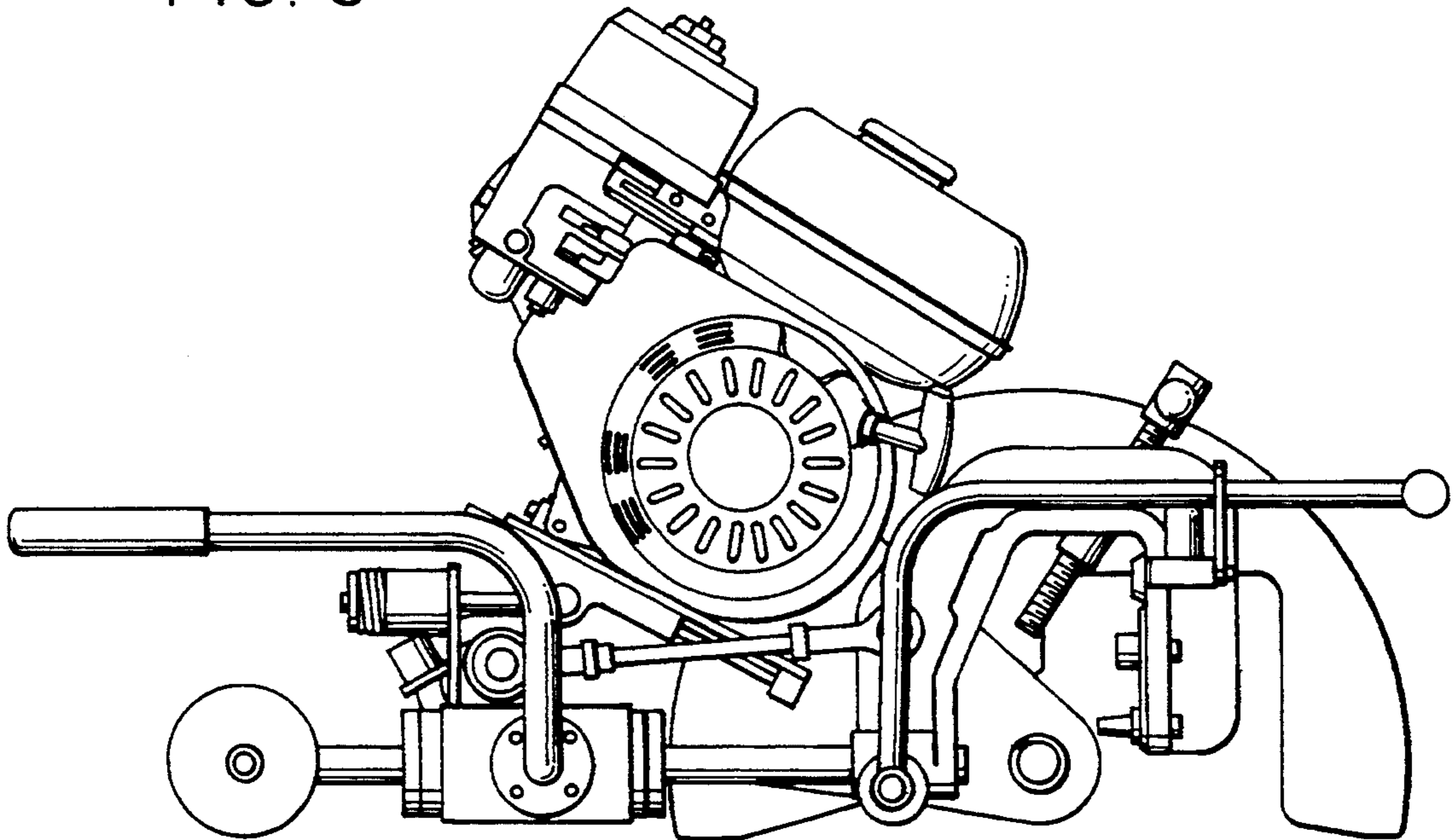

FIG. 4

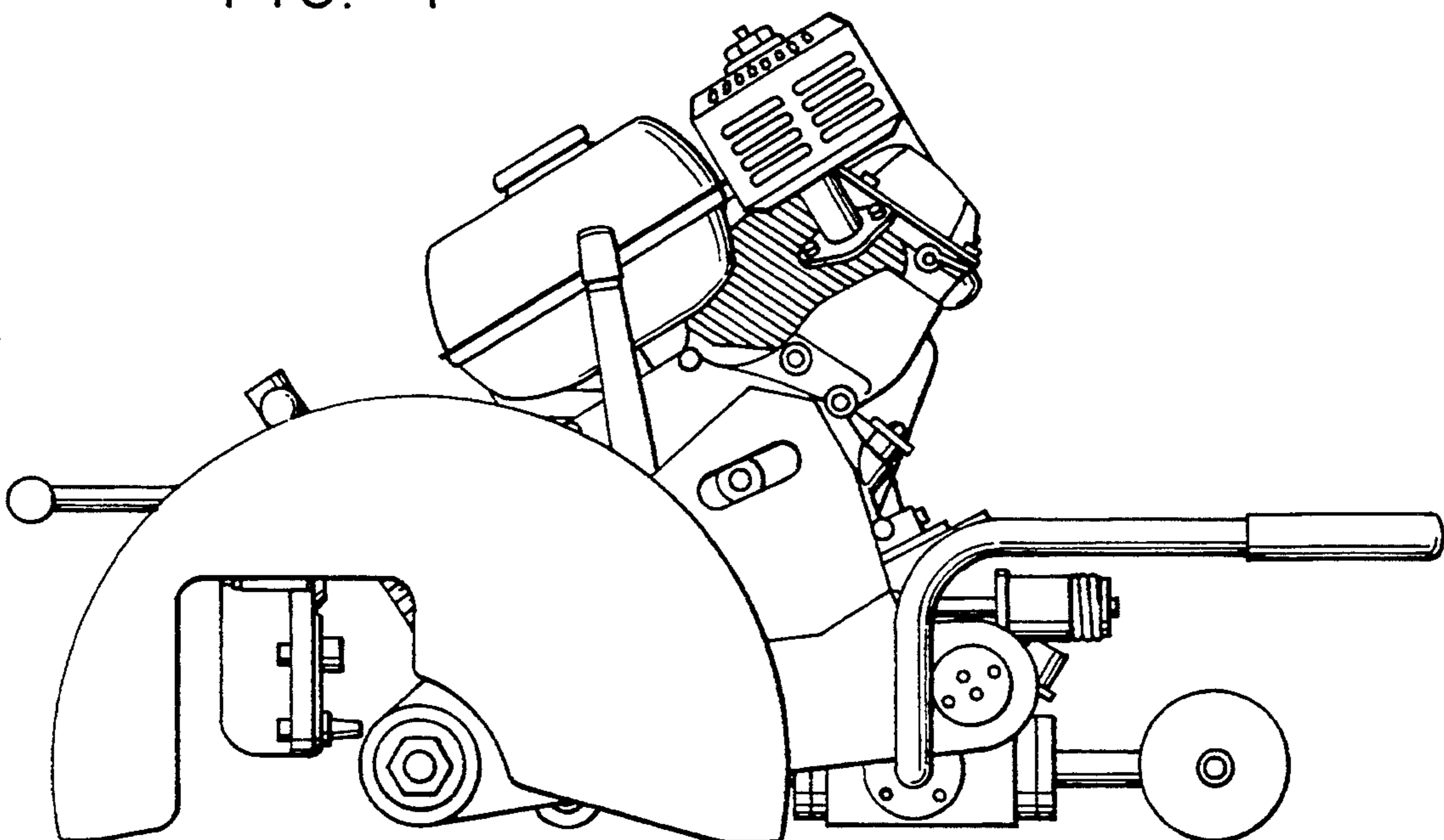

FIG. 5

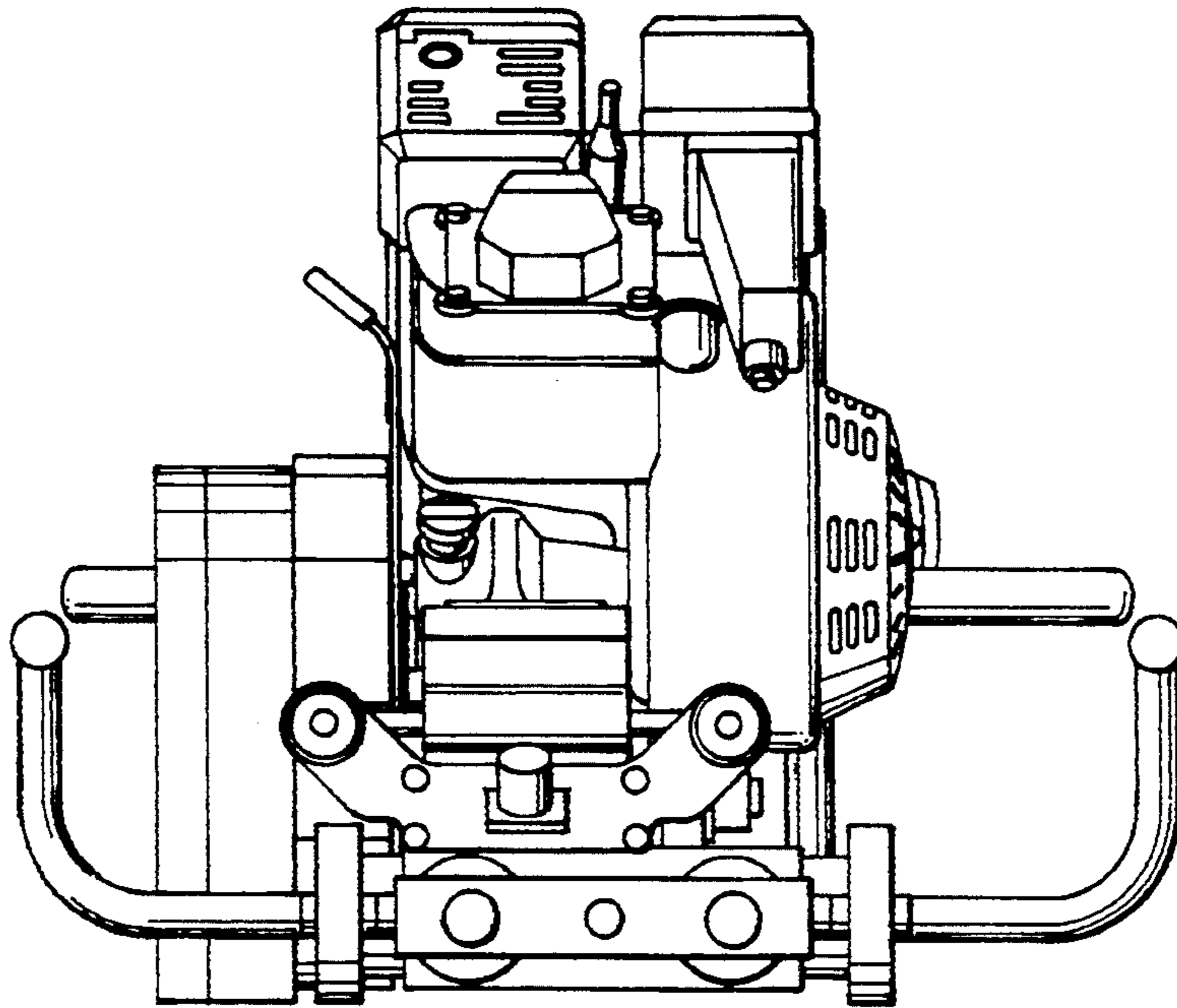

FIG. 6

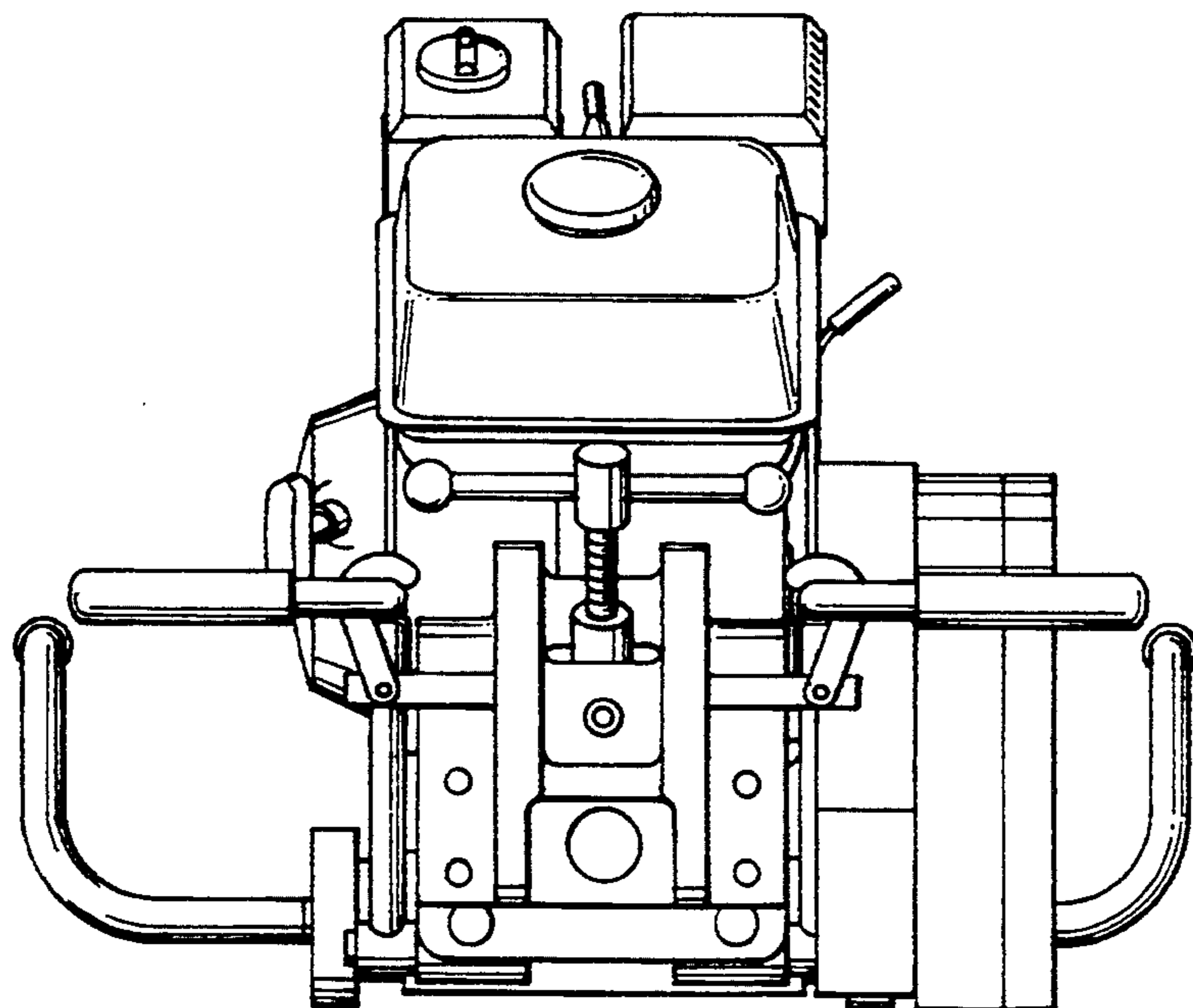

FIG. 7

