



US00D350995S

# United States Patent [19]

[11] Patent Number: **Des. 350,995**

Baxter et al.

[45] Date of Patent: **\*\* Sep. 27, 1994**

[54] AMUSEMENT CASTLE

[76] Inventors: **Anthony W. Baxter**, 7635 Silver Dollar La., Anaheim Hills, Calif. 92807; **Thomas K. Morris**, 2025 Fathom La., Anaheim, Calif. 92801; **Mark A. Lescault**, 5535 Shady Creek La., Yorba Linda, Calif. 92687

[\*\*] Term: **14 Years**

[21] Appl. No.: **854,272**

[22] Filed: **Mar. 20, 1992**

[52] U.S. Cl. .... **D21/115**

[58] Field of Search ..... 446/476; D21/114, 115, D21/242; D25/17

in 1955 at Disneyland in Anaheim, California (11 pages).

Collection of pictures of Cinderella's Castle constructed in 1971 at Walt Disney World in Orlando, Florida (24 pages).

Collection of pictures of Cinderella's Castle constructed in 1982 at Tokyo Disneyland in Tokyo, Japan (10 pages).

*Primary Examiner*—Bernard Ansher  
*Assistant Examiner*—R. Barkai

### [57] CLAIM

The ornamental design for an amusement castle, as shown and described.

### [56] References Cited

#### U.S. PATENT DOCUMENTS

- D. 141,560 6/1945 Tackett ..... D21/114
- D. 228,777 10/1973 Mueller ..... D21/114
- D. 262,902 2/1982 Duarte ..... D21/114

#### OTHER PUBLICATIONS

International Playthings 1984 p. 122 #RC 684/2 (Design Library).  
Collection of pictures of Cinderella's Castle constructed

### DESCRIPTION

FIG. 1 is a front elevational view of an amusement castle showing our new design;  
FIG. 2 is a left side elevational view of the castle;  
FIG. 3 is a right side elevational view of the castle;  
FIG. 4 is a rear elevational view of the castle; and,  
FIG. 5 is a top plan view of the castle.

The broken lines showing of environmental structure corresponding to landscaping is for illustrative purposes only and forms no part of the claimed design.



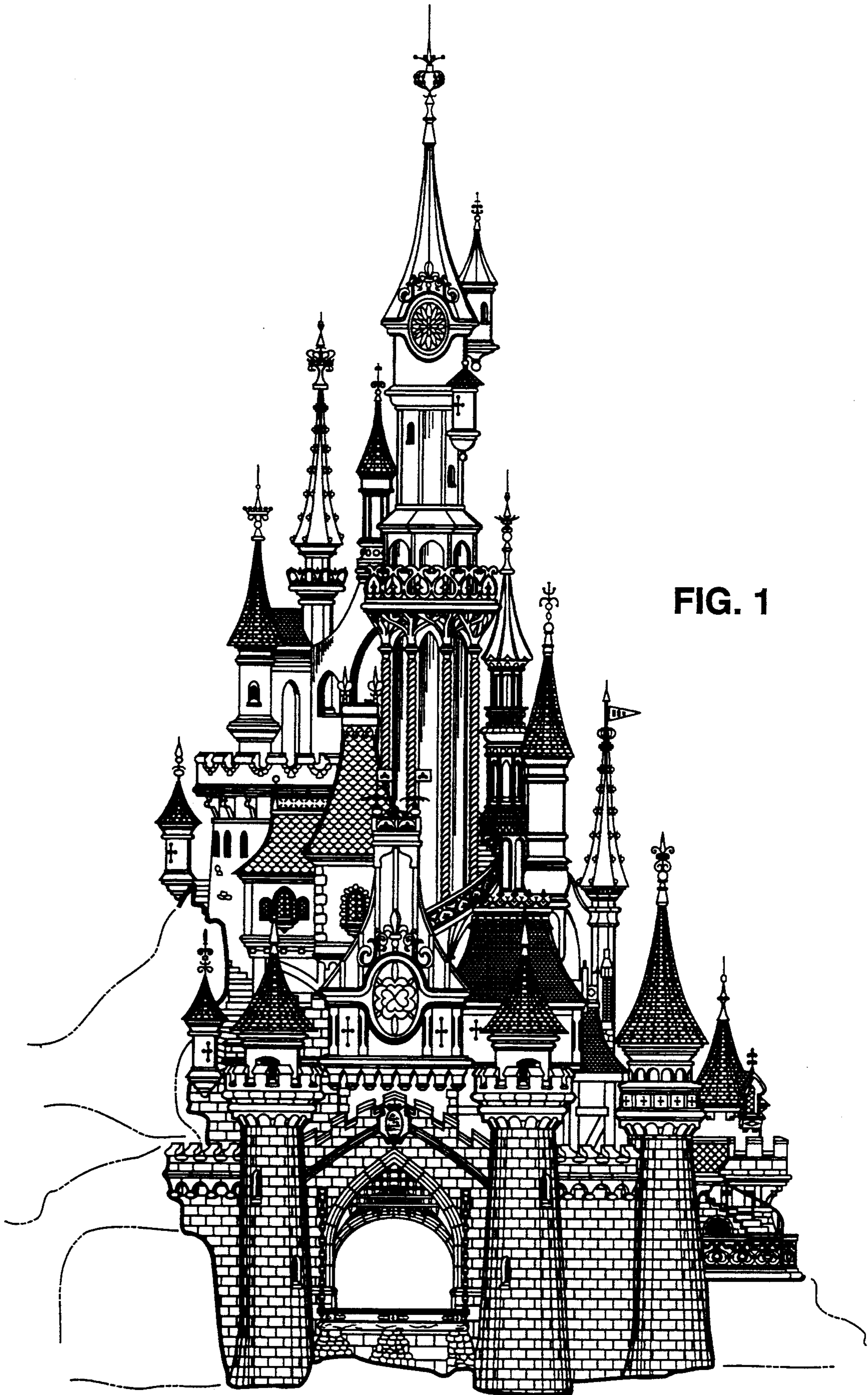

FIG. 1

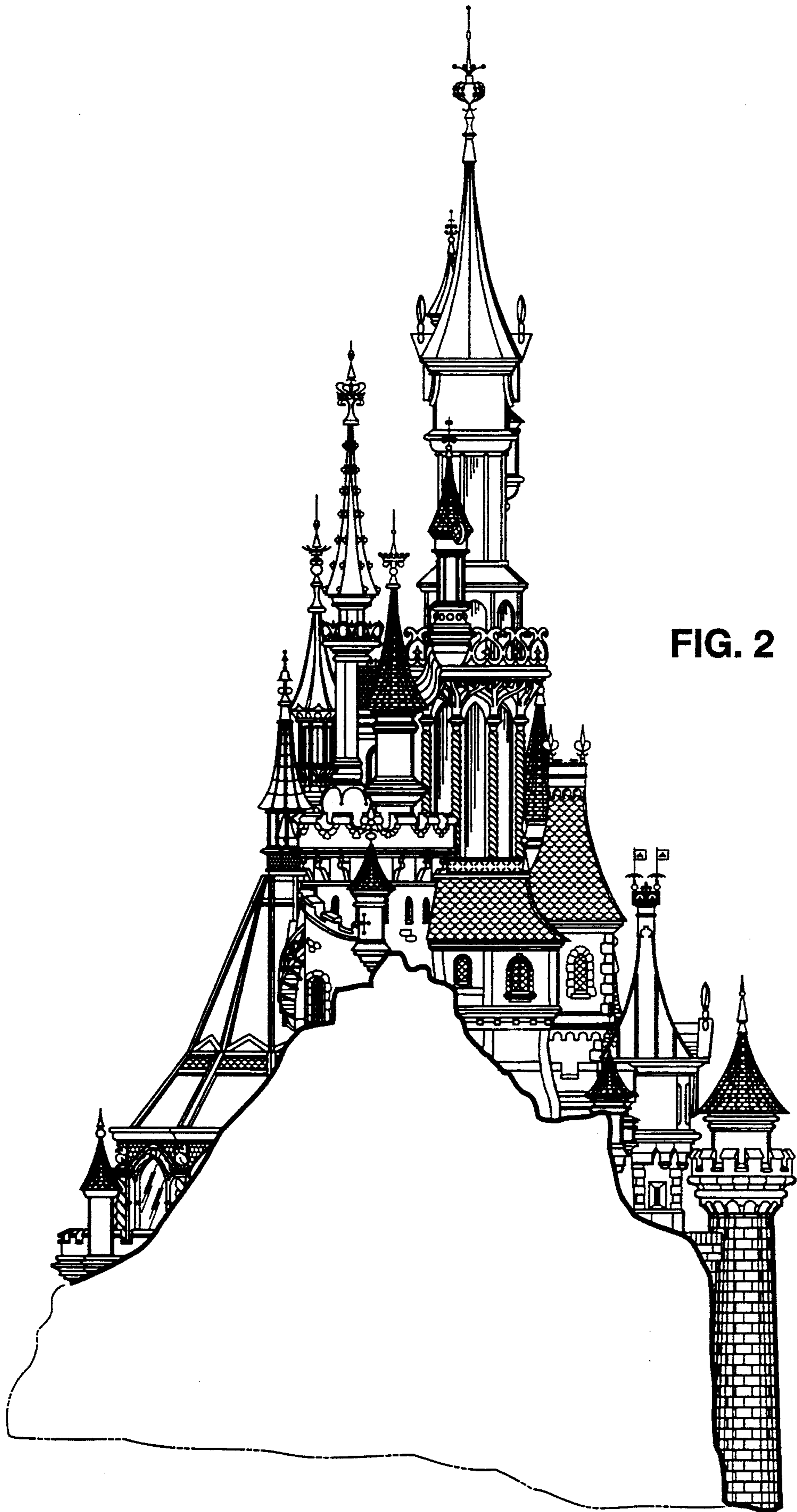

FIG. 2

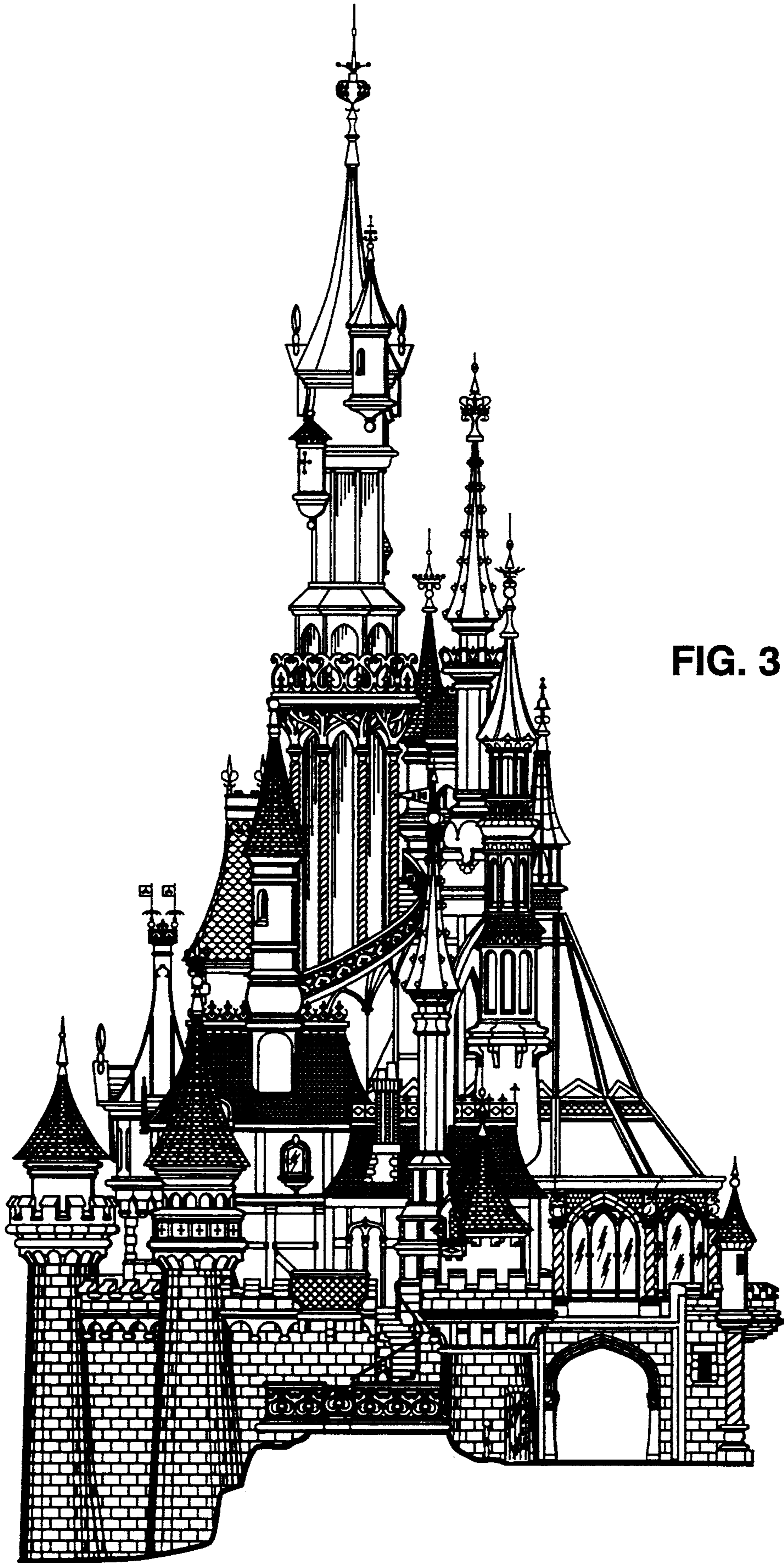

FIG. 3

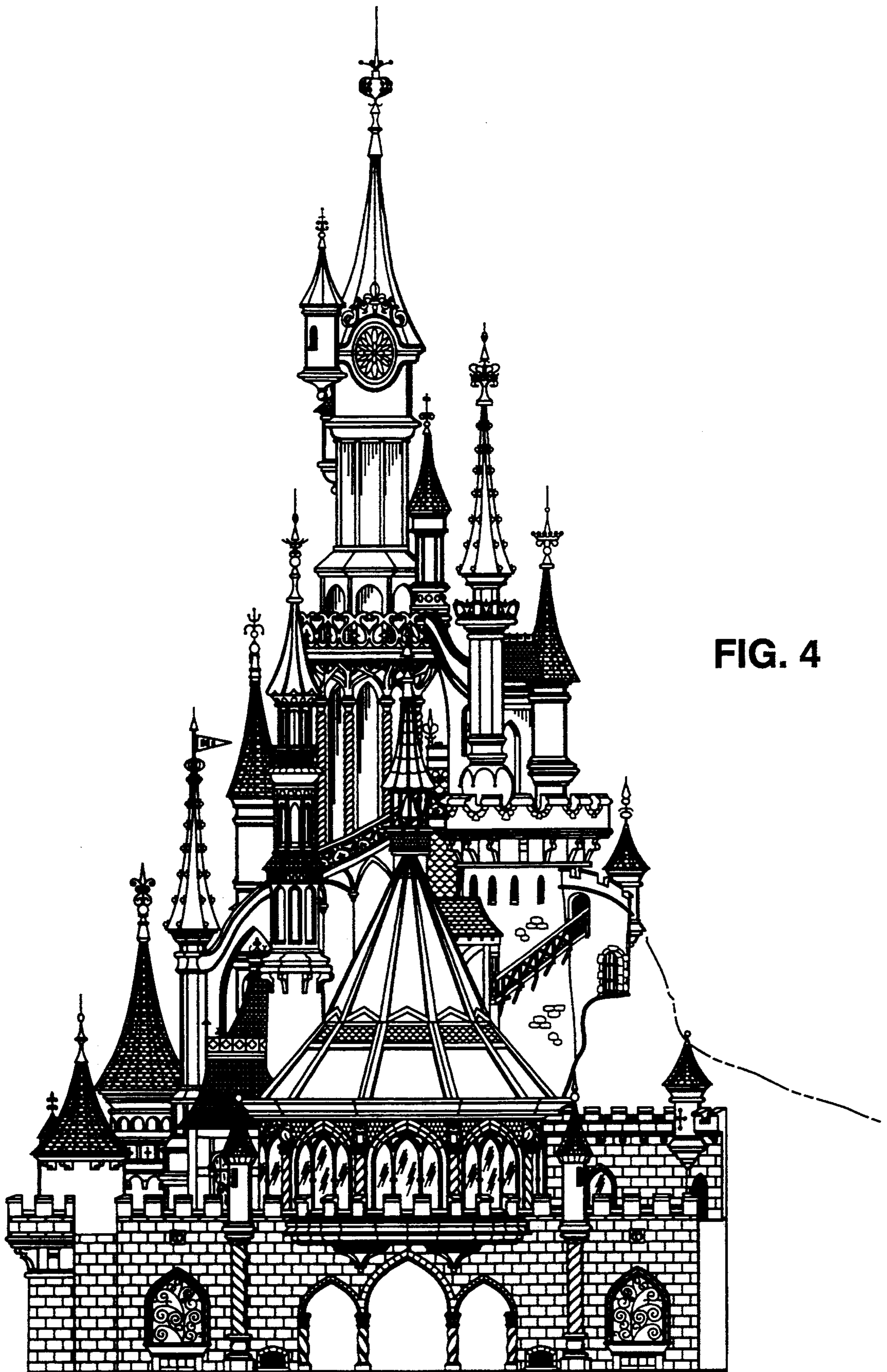

FIG. 4

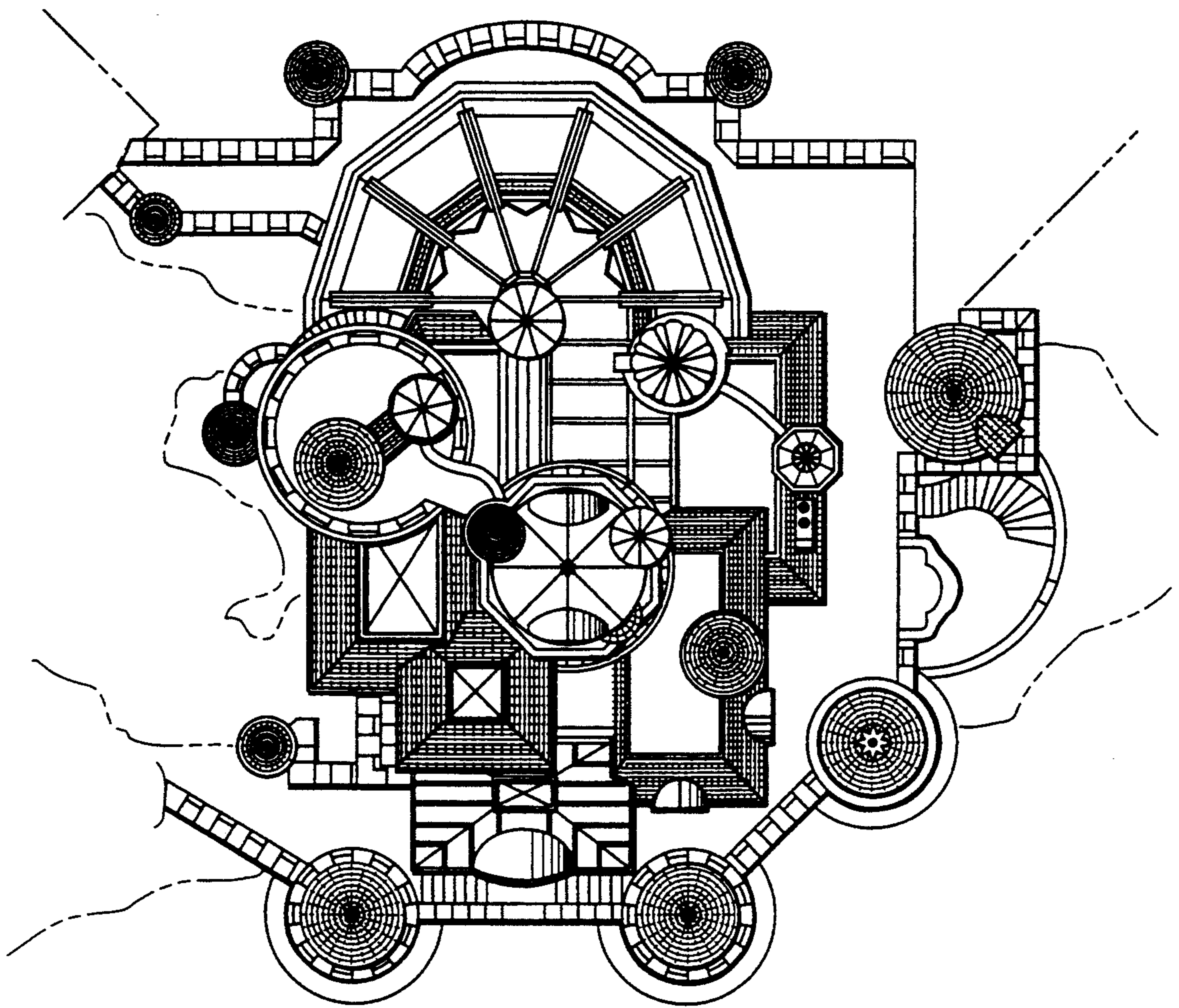

FIG. 5