



US00D349022S

United States Patent [19]

Kiyooka et al.

[11] Patent Number: Des. 349,022

[45] Date of Patent: ** Jul. 26, 1994

[54] POWER UNIT SHAFT ATTACHMENT FOR CUTTING IMPLEMENTS

[75] Inventors: Katsumi Kiyooka, Togane; Kaori Katoh, Chiba, both of Japan

[73] Assignee: Maruyama Mfg. Co., Inc., Tokyo, Japan

[**] Term: 14 Years

[21] Appl. No.: 777,100

[22] Filed: Oct. 16, 1991

[52] U.S. Cl. D8/8

[58] Field of Search D8/1, 8; 30/276; 56/12.7; D15/10

[56] References Cited

U.S. PATENT DOCUMENTS

D. 260,394 8/1981 Tuggle D8/8 X
D. 333,954 3/1993 Karlsson et al. D8/8
4,122,601 10/1978 Katsuya 30/276 X
4,179,805 12/1979 Yamada 30/276 X
4,188,719 2/1980 Hoff 56/12.7 X

4,285,127 8/1981 Zerrer et al. 30/276
4,662,158 5/1987 Zerrer 30/276
4,881,363 11/1989 Terai et al. 30/276 X
4,916,886 4/1990 Nakamura et al. 56/12.7
5,174,099 12/1992 Matsuura 30/276 X

Primary Examiner—Wallace R. Burke

Assistant Examiner—H. Baynham

Attorney, Agent, or Firm—Keck, Mahin & Cate

[57] CLAIM

The ornamental design for a power unit shaft attachment for cutting implements, as shown.

DESCRIPTION

FIG. 1 is a front elevational view of a power unit shaft attachment for cutting implements according to the present design;

FIG. 2 is a rear elevational view thereof;

FIG. 3 is a right side elevational view thereof;

FIG. 4 is a left side elevational view thereof;

FIG. 5 is a top plan view thereof;

FIG. 6 is a bottom plan view thereof;

FIG. 7 is a front perspective view thereof; and,

FIG. 8 is a rear perspective thereof.

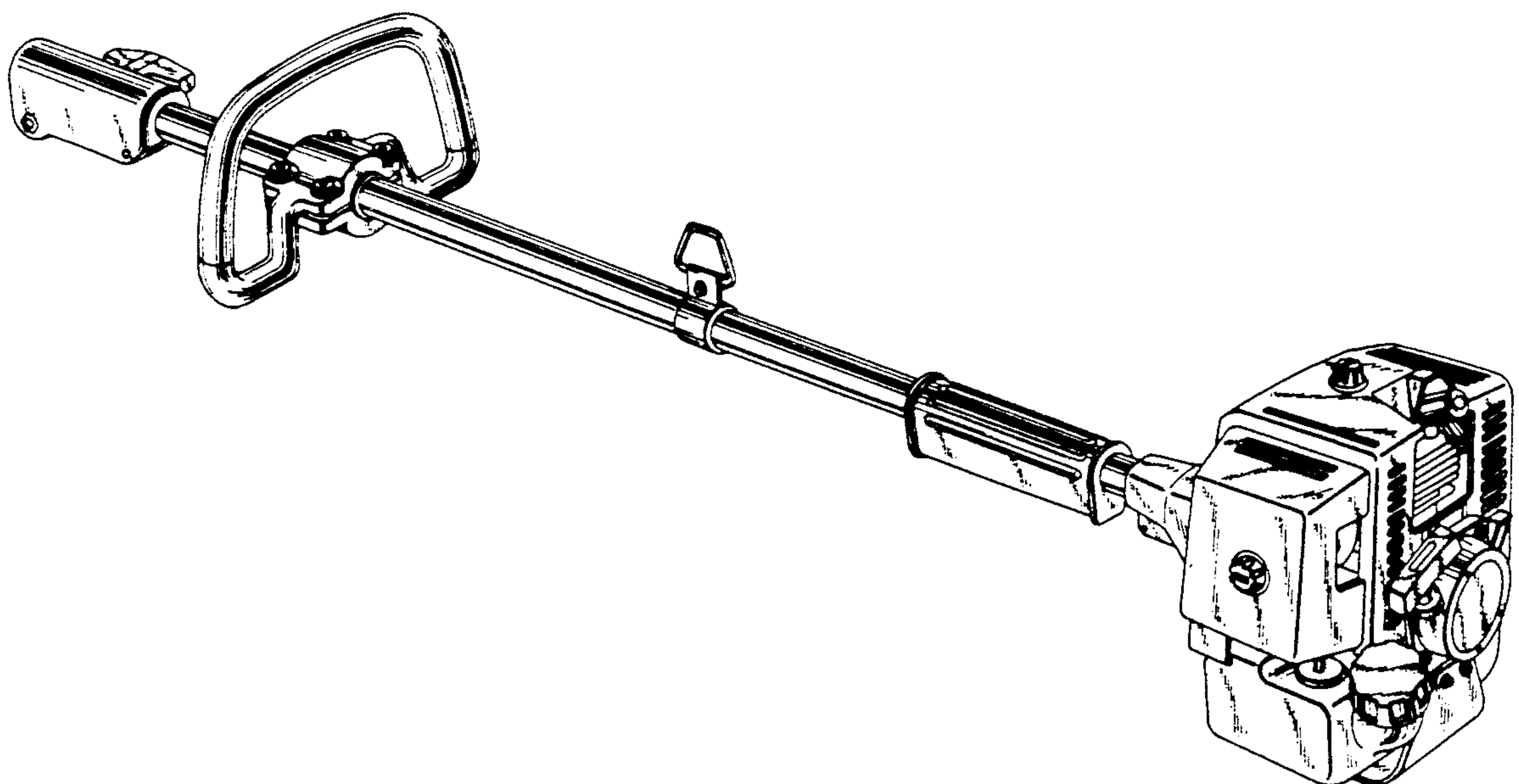

FIG.1

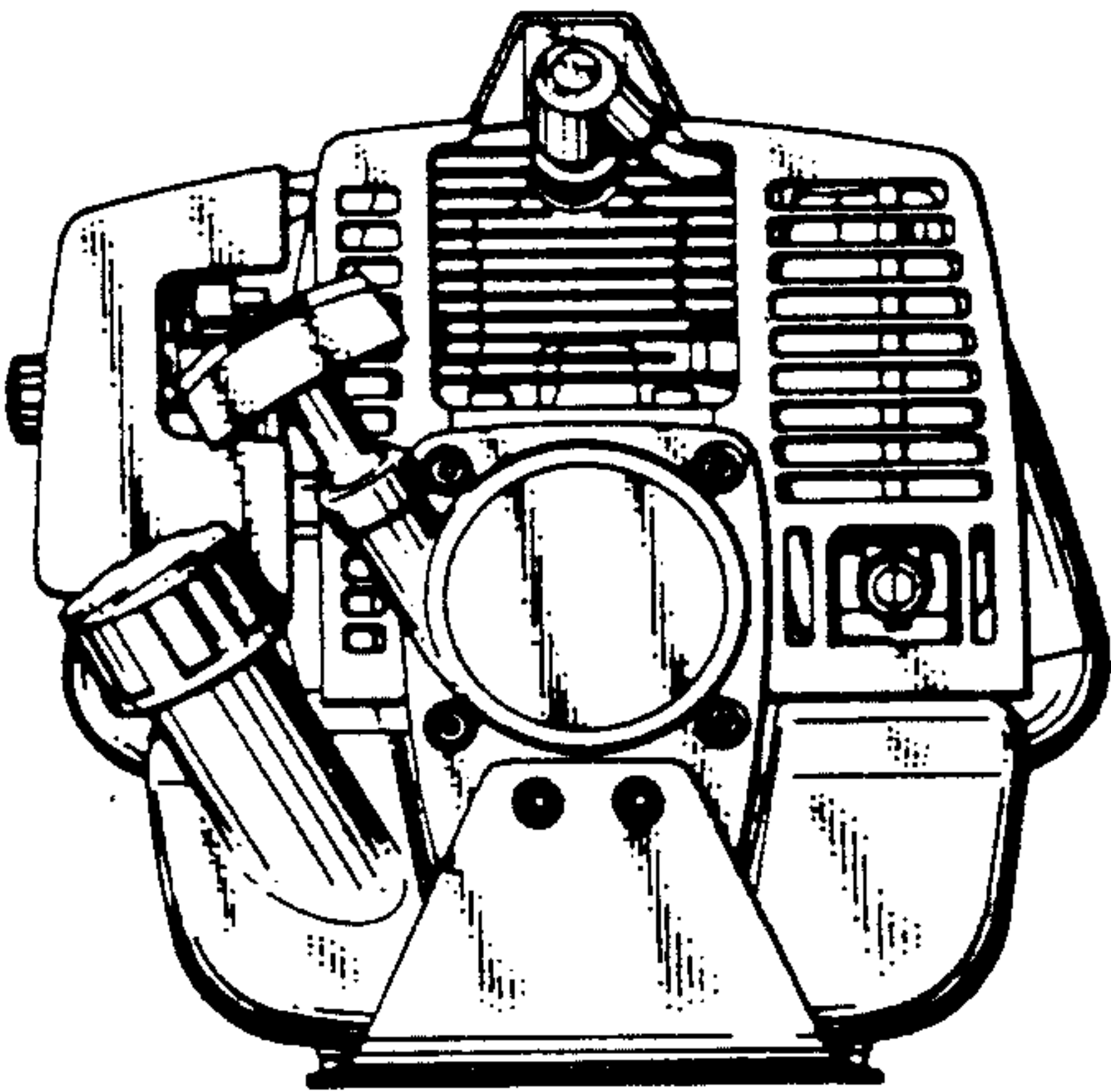

FIG.2

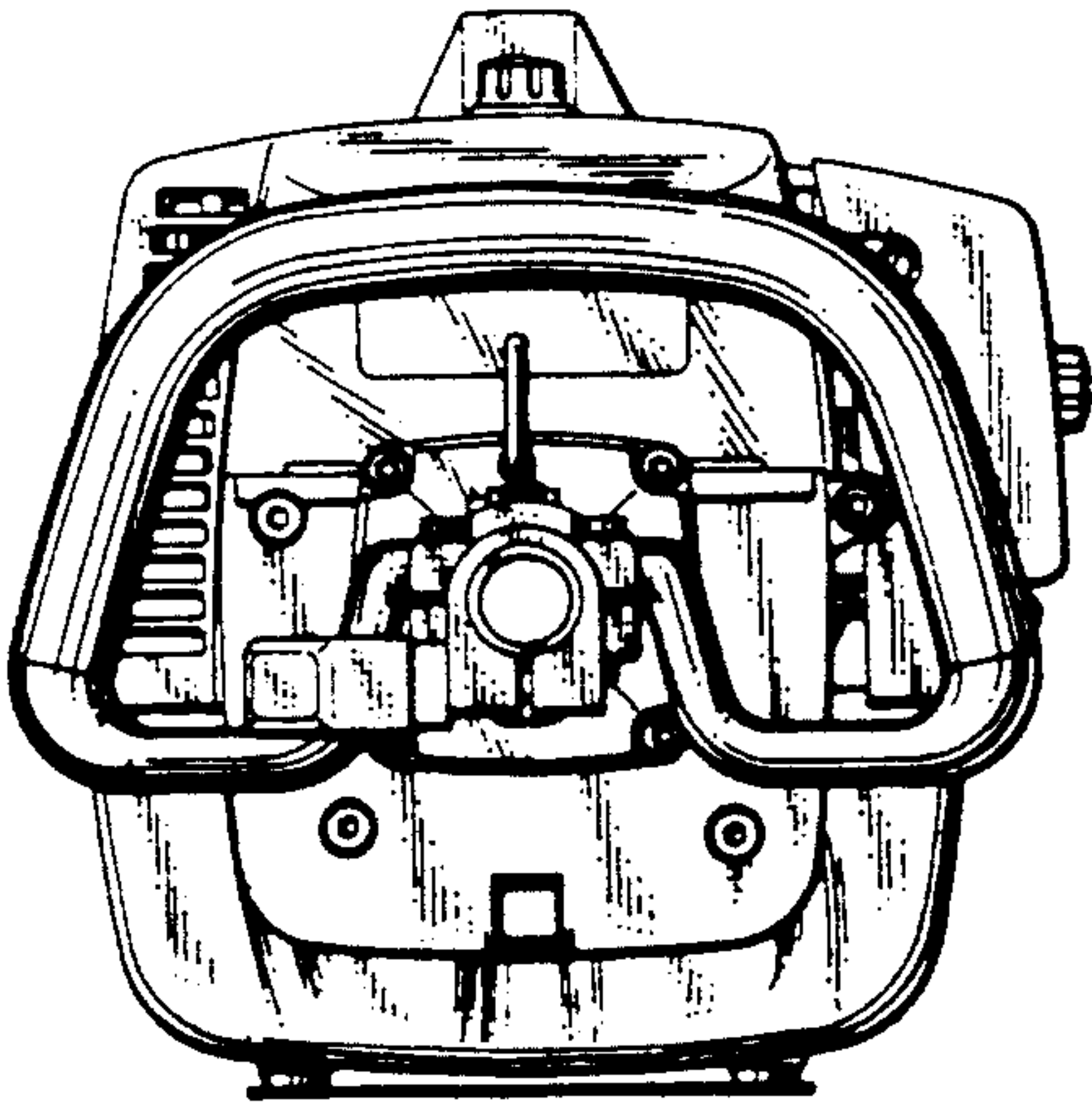

FIG. 3

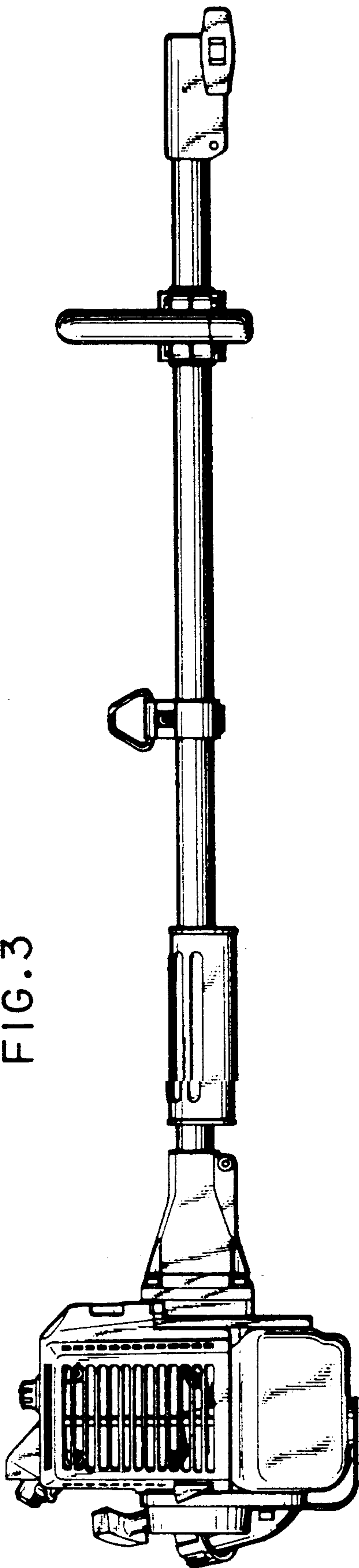

FIG. 4

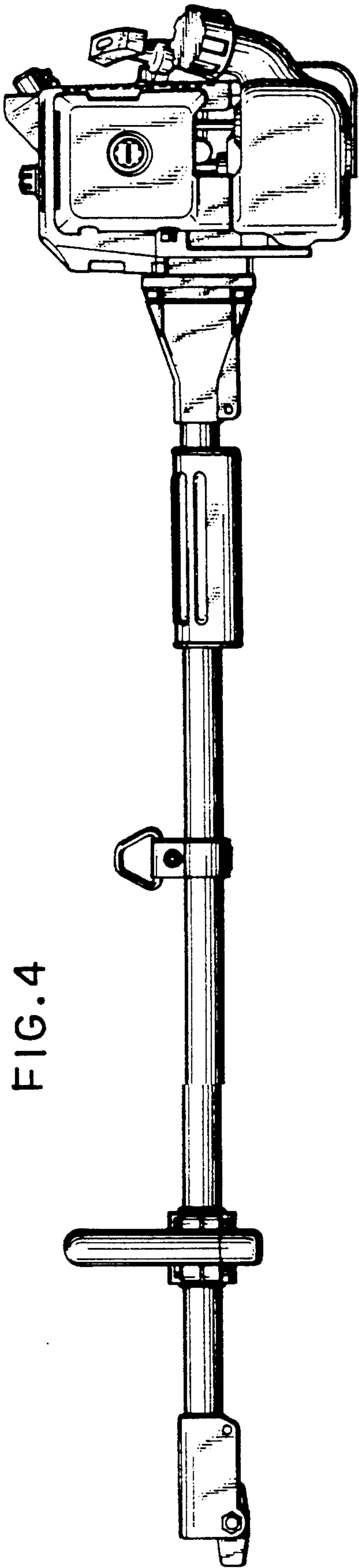

FIG.5

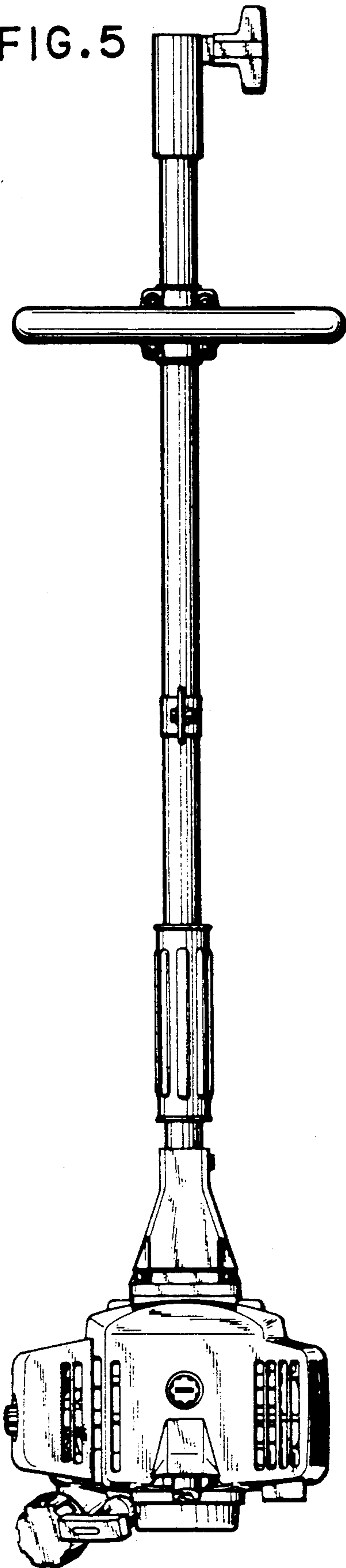

FIG.6

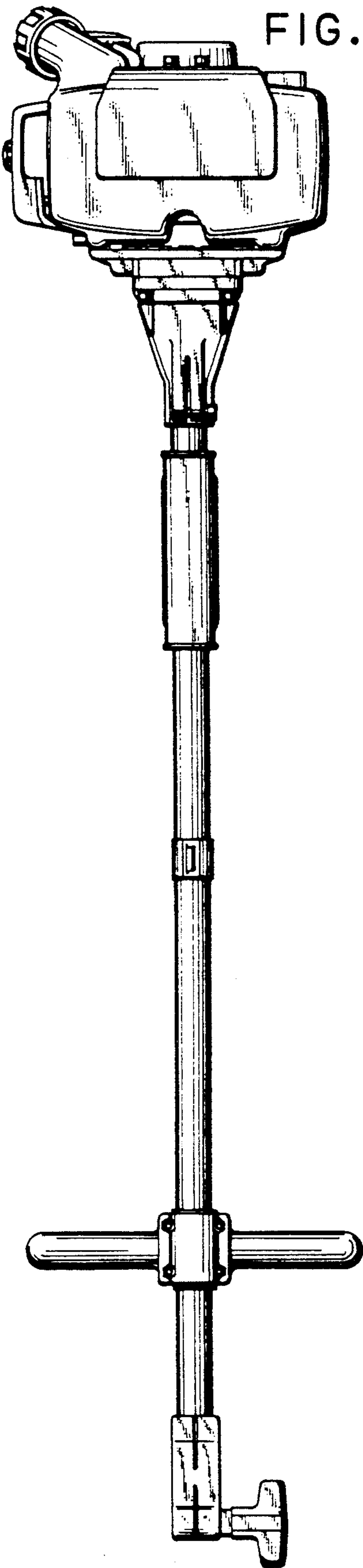

FIG. 7

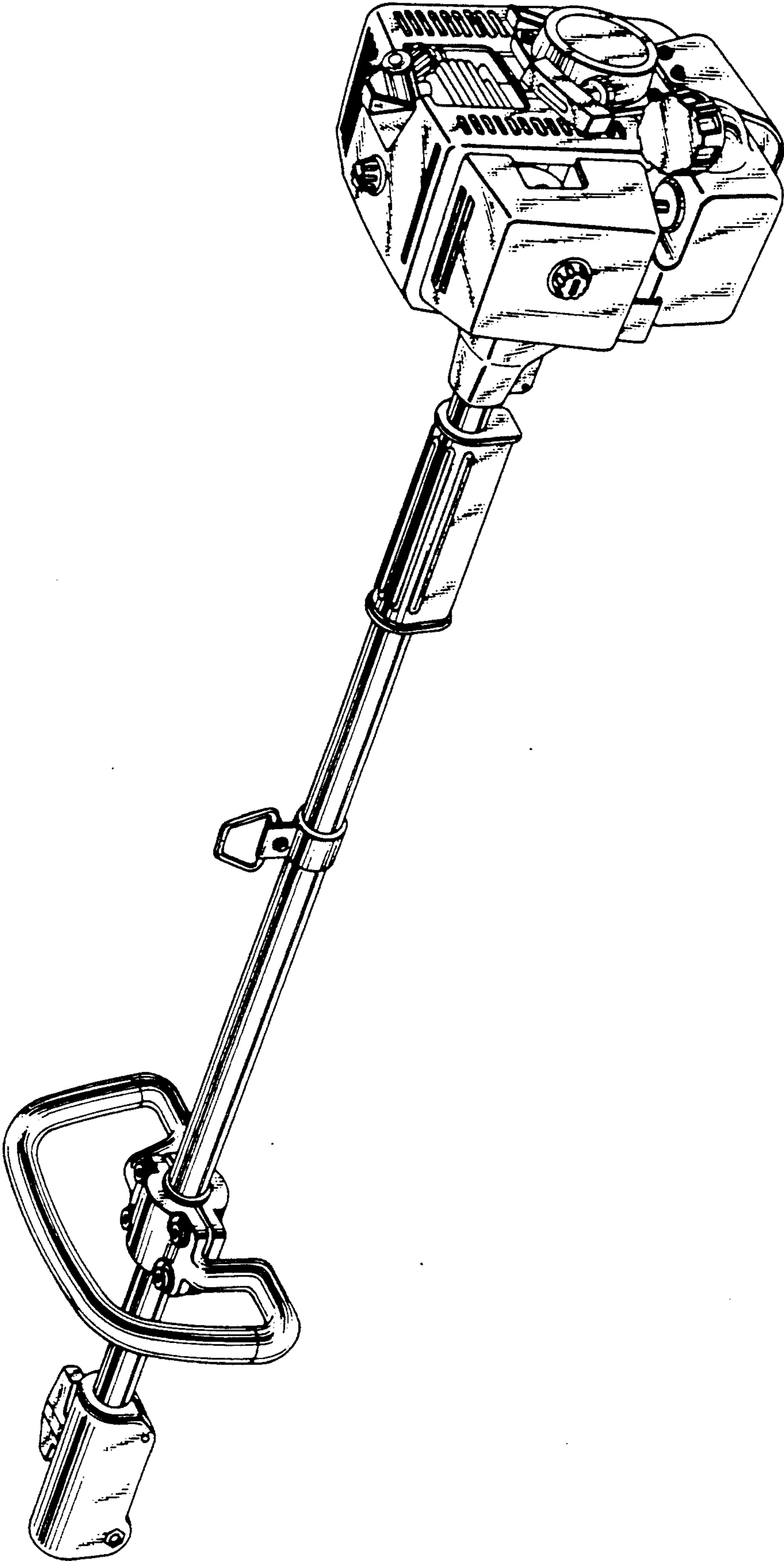

FIG. 8

