



US00D348678S

United States Patent [19]

[11] Patent Number: **Des. 348,678**

Budde

[45] Date of Patent: **** Jul. 12, 1994**

[54] **VEHICLE CAB**

[75] Inventor: **Paul Budde**, Nottuln, Fed. Rep. of Germany

[73] Assignee: **Claas OHG**, Harsewinkel, Fed. Rep. of Germany

[**] Term: **14 Years**

[21] Appl. No.: **886,483**

[22] Filed: **May 22, 1992**

[30] **Foreign Application Priority Data**

Nov. 22, 1991 [DE] Fed. Rep. of Germany M 91 08 081.9

[52] U.S. Cl. **D15/30**

[58] Field of Search 180/89.13, 89.9; 296/190, 202; D15/10, 22-26, 28, 30

[56] **References Cited**

U.S. PATENT DOCUMENTS

D. 239,965	5/1976	Kermes et al.	D15/30
D. 248,475	7/1978	Parks et al.	D15/30
D. 259,045	4/1981	Mende	D15/30
D. 270,860	10/1983	Turner	D15/30
D. 273,494	4/1984	Hurlburt et al.	D15/30

D. 312,827	12/1990	Boddin et al.	D15/30
4,440,437	4/1984	Hahm et al.	296/190
4,515,234	5/1985	Loy et al.	296/190
4,605,259	8/1986	Hurlburt	296/190
4,652,043	3/1987	Hurlburt	296/190
4,772,065	9/1988	Nakata et al.	296/190

OTHER PUBLICATIONS

Step Into The 90's, John Deere Catalog, undated.
Look Into The 90's, unknown authorship, undated.

Primary Examiner—Bernard Ansher
Assistant Examiner—Sandra Morris
Attorney, Agent, or Firm—Spencer, Frank & Schneider

[57] **CLAIM**

The ornamental design for a vehicle cab, as shown and described.

DESCRIPTION

FIG. 1 is a right side elevational view of a vehicle cab, showing my new design, the broken line showing of the vehicle is for illustrative purposes only, and forms no part of the claimed design;
FIG. 2 is a front elevational view thereof;
FIG. 3 is a rear elevational view thereof;
FIG. 4 is a top plan view thereof; and,
FIG. 5 is an enlarged rear elevational view thereof.

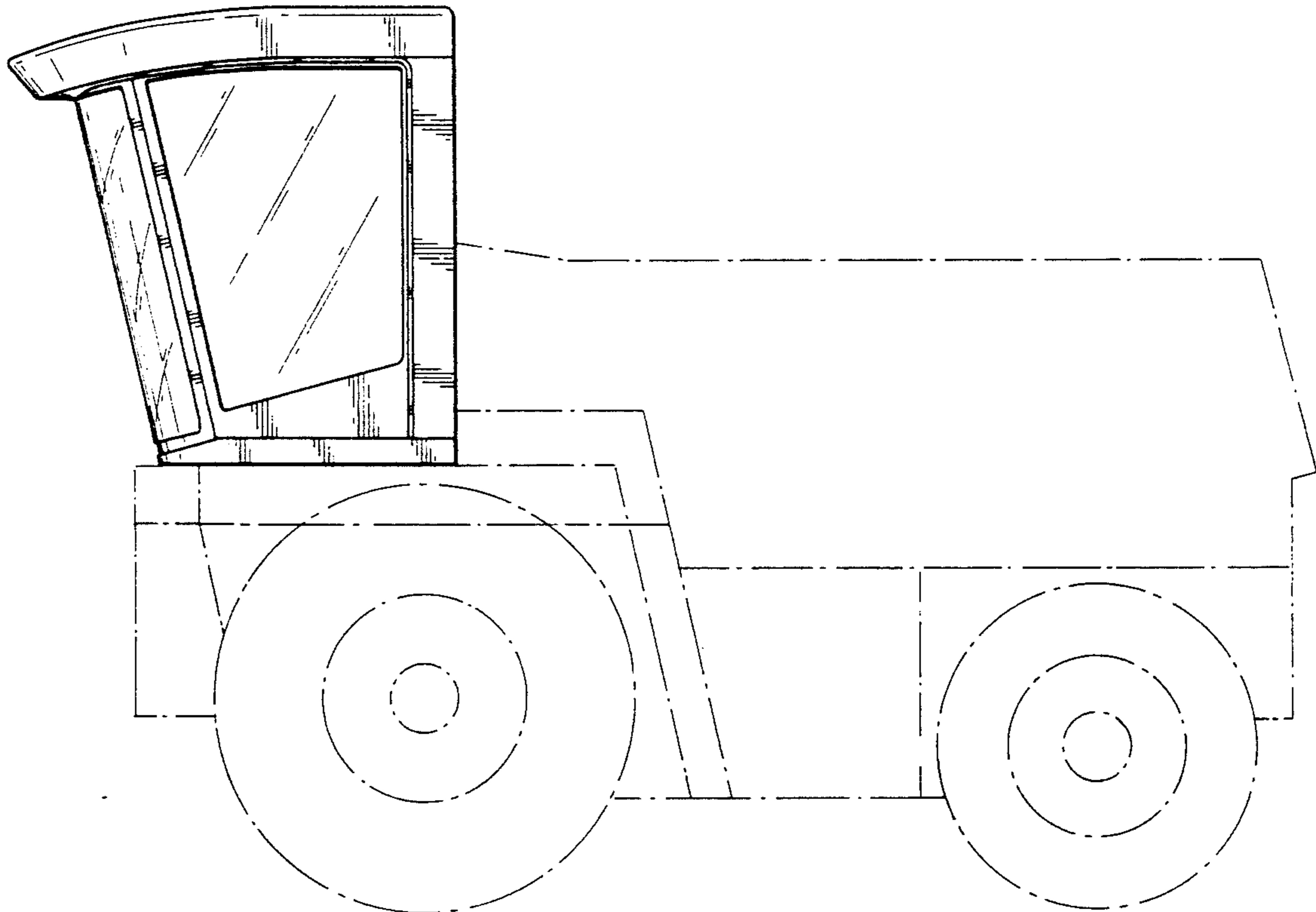

FIG. 1

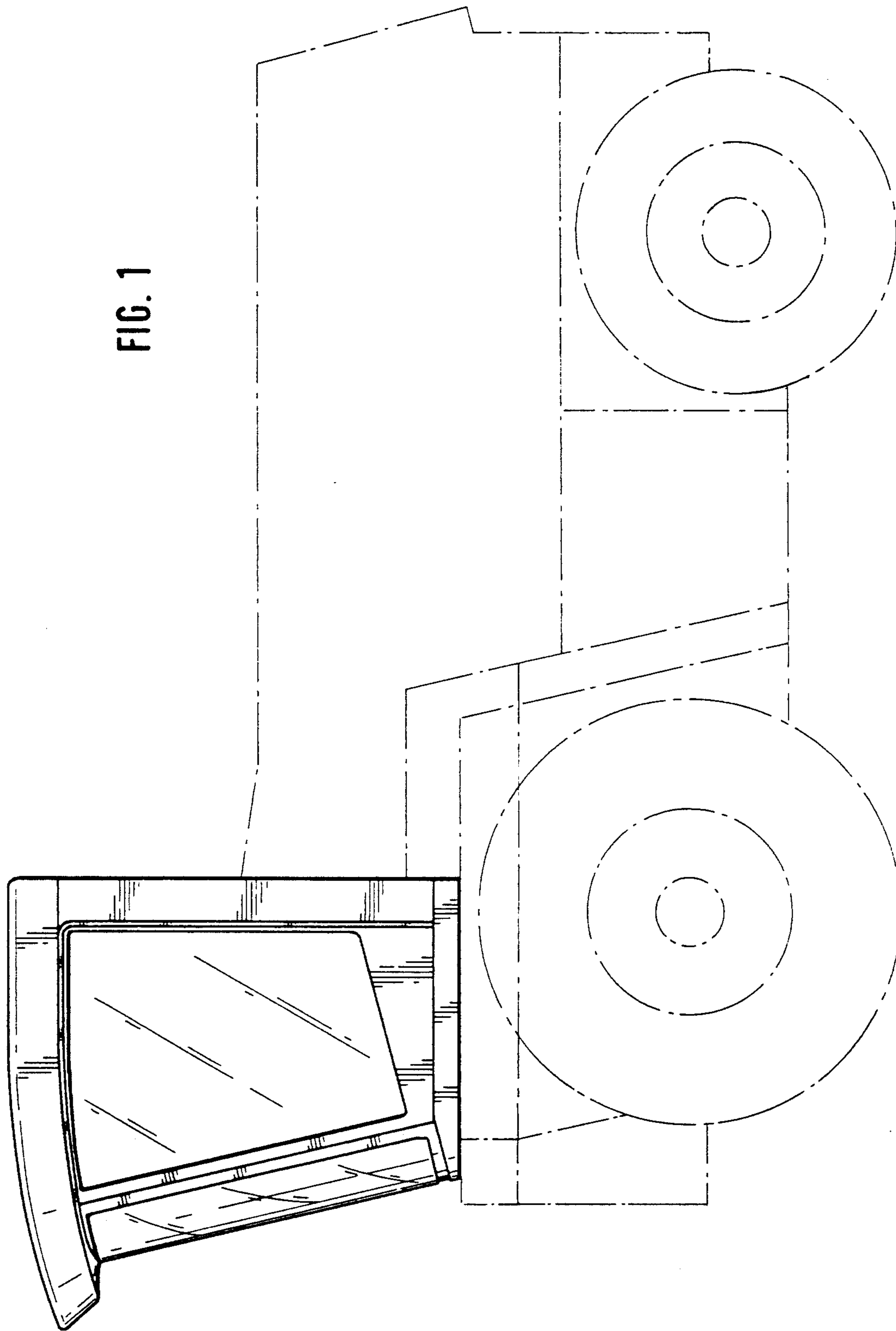

FIG. 2

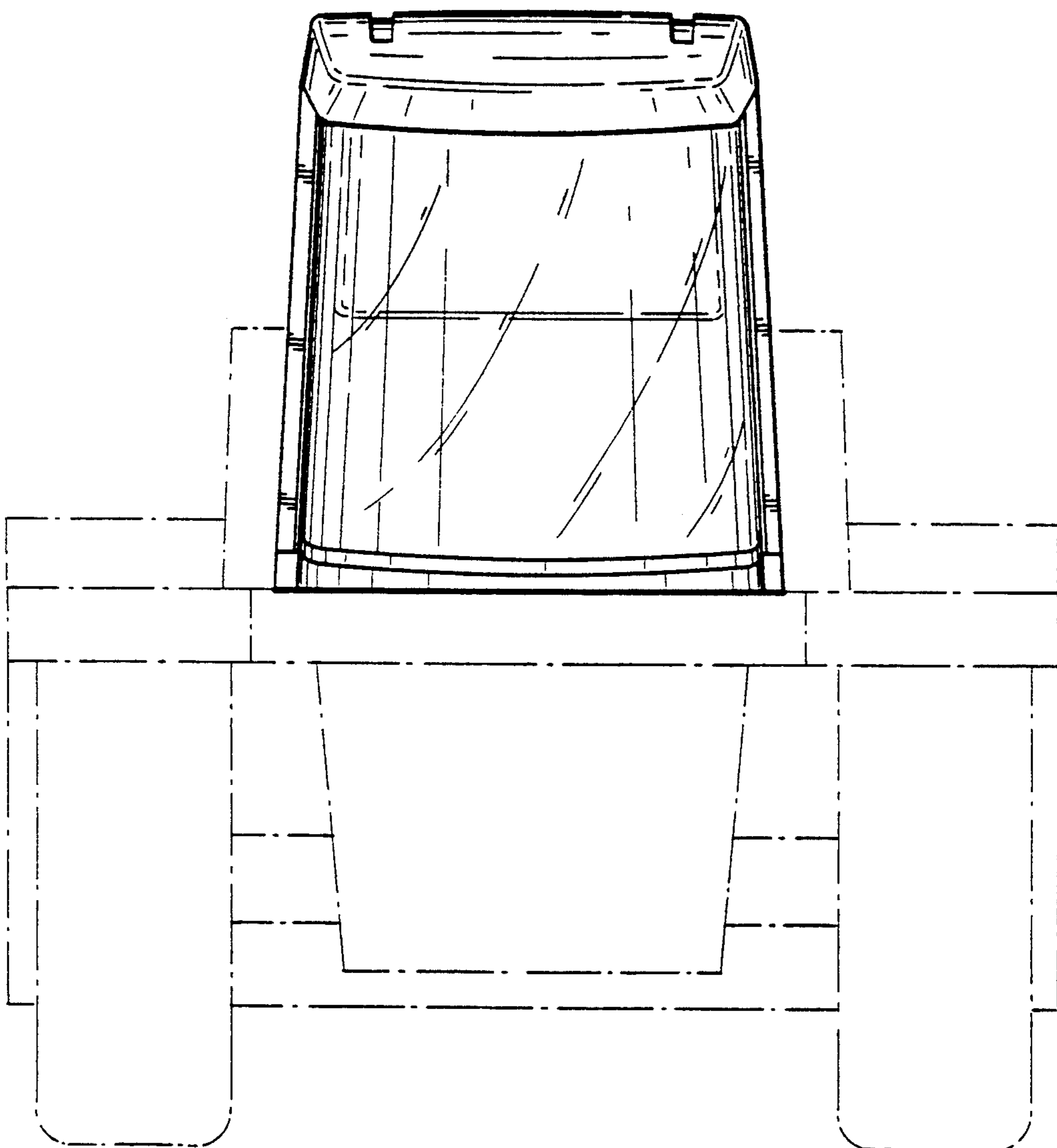
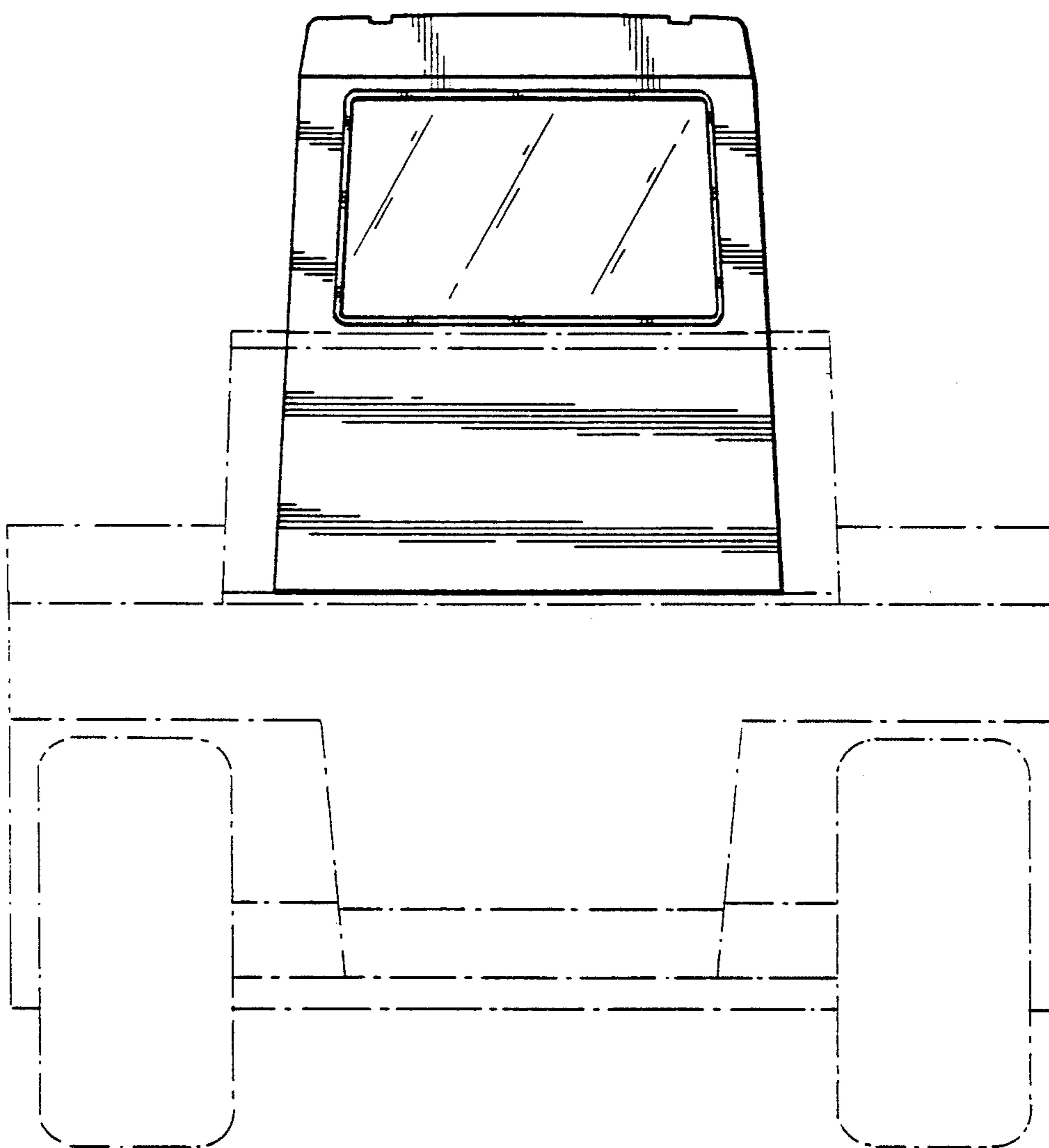

FIG. 3



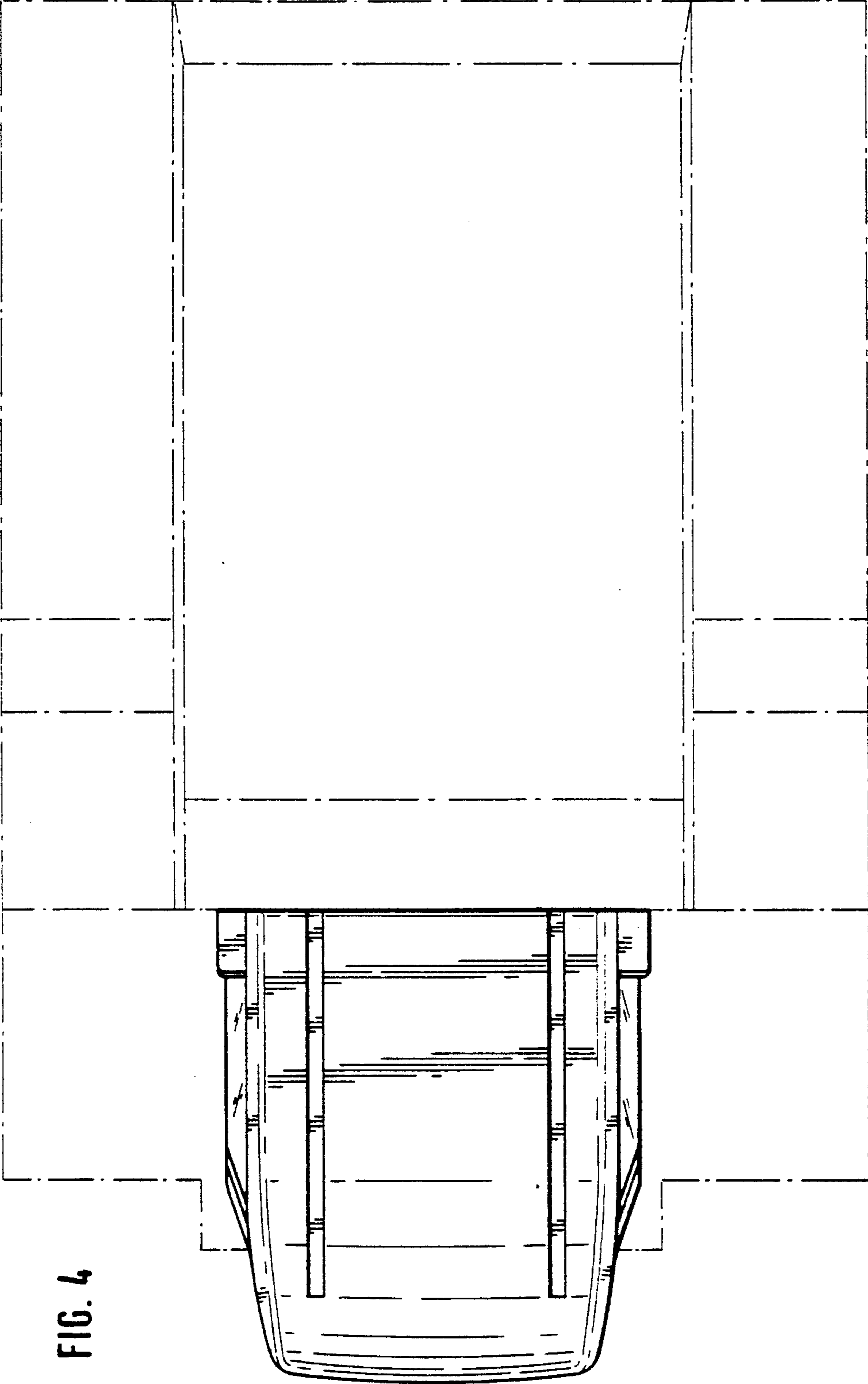

FIG. 4

FIG. 5

