



US00D345699S

United States Patent [19]

[11] Patent Number: **Des. 345,699**

Yang

[45] Date of Patent: **** Apr. 5, 1994**

[54] **CLOCK**

[76] Inventor: **Tao-Ching Yang**, No. 22, Lane 130, Taping St., Taping Li, Hsihu Chen Changhua Hsien, Taiwan

[**] Term: **14 Years**

[21] Appl. No.: **799,612**

[22] Filed: **Nov. 27, 1991**

[52] U.S. Cl. **D10/21; D10/15**

[58] Field of Search **368/276-277, 368/285; D10/1-40, 122-132**

[56] **References Cited**

U.S. PATENT DOCUMENTS

- D. 250,174 11/1978 Hedgecock D10/21 X
- D. 304,161 10/1989 Nomizu D10/21
- D. 315,682 3/1991 Lin D10/21
- D. 318,622 7/1991 Wada D10/21 X
- D. 327,223 6/1992 Kawashima D10/21 X

OTHER PUBLICATIONS

Hong Kong Enterprise-Jul. 1988-p. 113-Pyramid Clock.
Jeweler's Circular-Keystone-May 1984 p. 12-Pyramid Clocks at right center.

Primary Examiner-Nelson C. Holtje
Attorney, Agent, or Firm-Morton J. Rosenberg; David I. Klein

[57] **CLAIM**

The ornamental design for a clock, as shown and described.

DESCRIPTION

FIG. 1 is a perspective view of a clock showing my new design;
FIG. 2 is a front elevational view thereof;
FIG. 3 is a rear elevational view thereof;
FIG. 4 is a top plan view thereof;
FIG. 5 is a bottom plan view thereof;
FIG. 6 is a left side elevational view thereof;
FIG. 7 is a right side elevational view thereof; and,
FIG. 8 is a top, front and right side perspective view thereof, with another representative time indication.

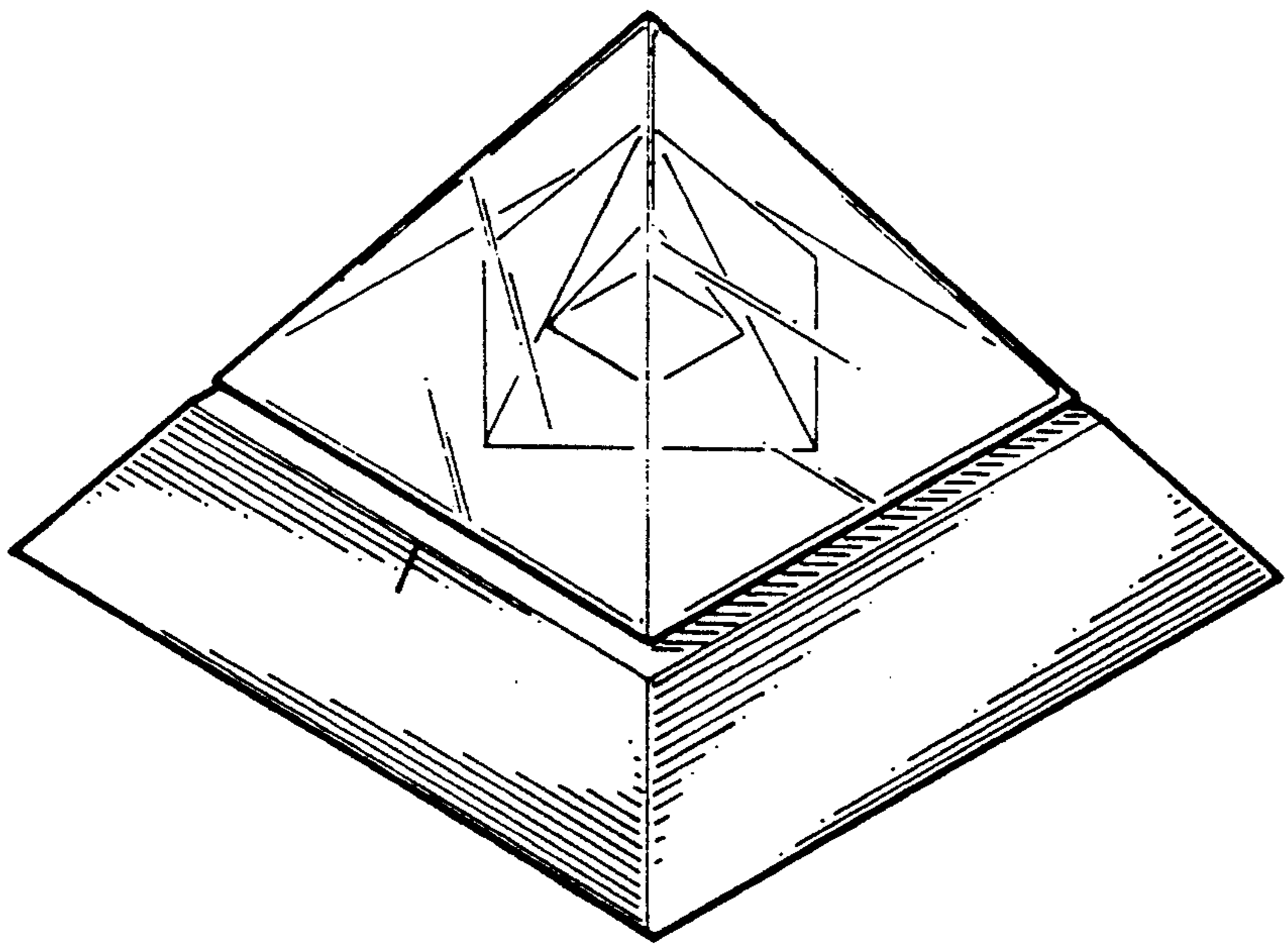

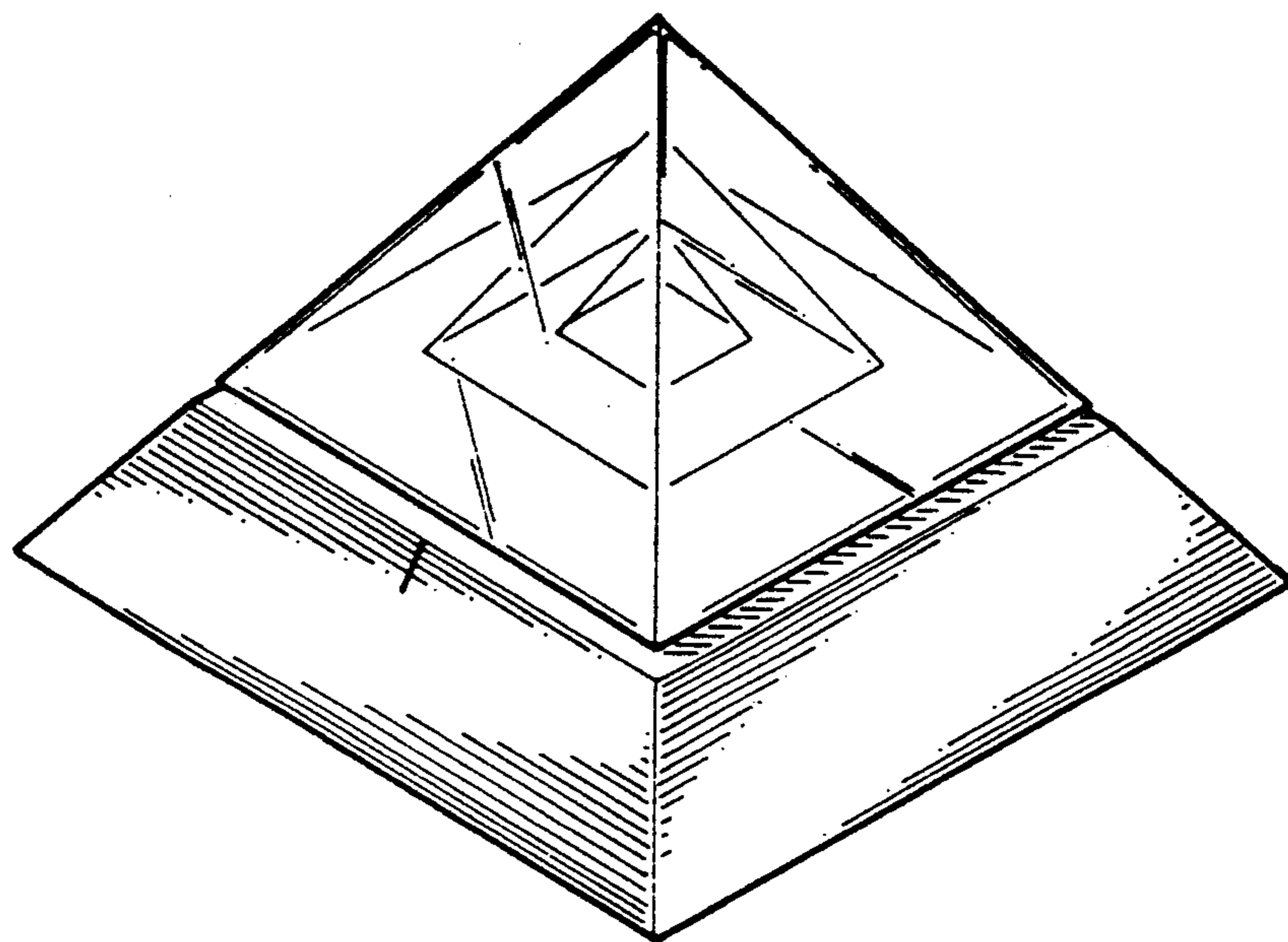

FIG. 1

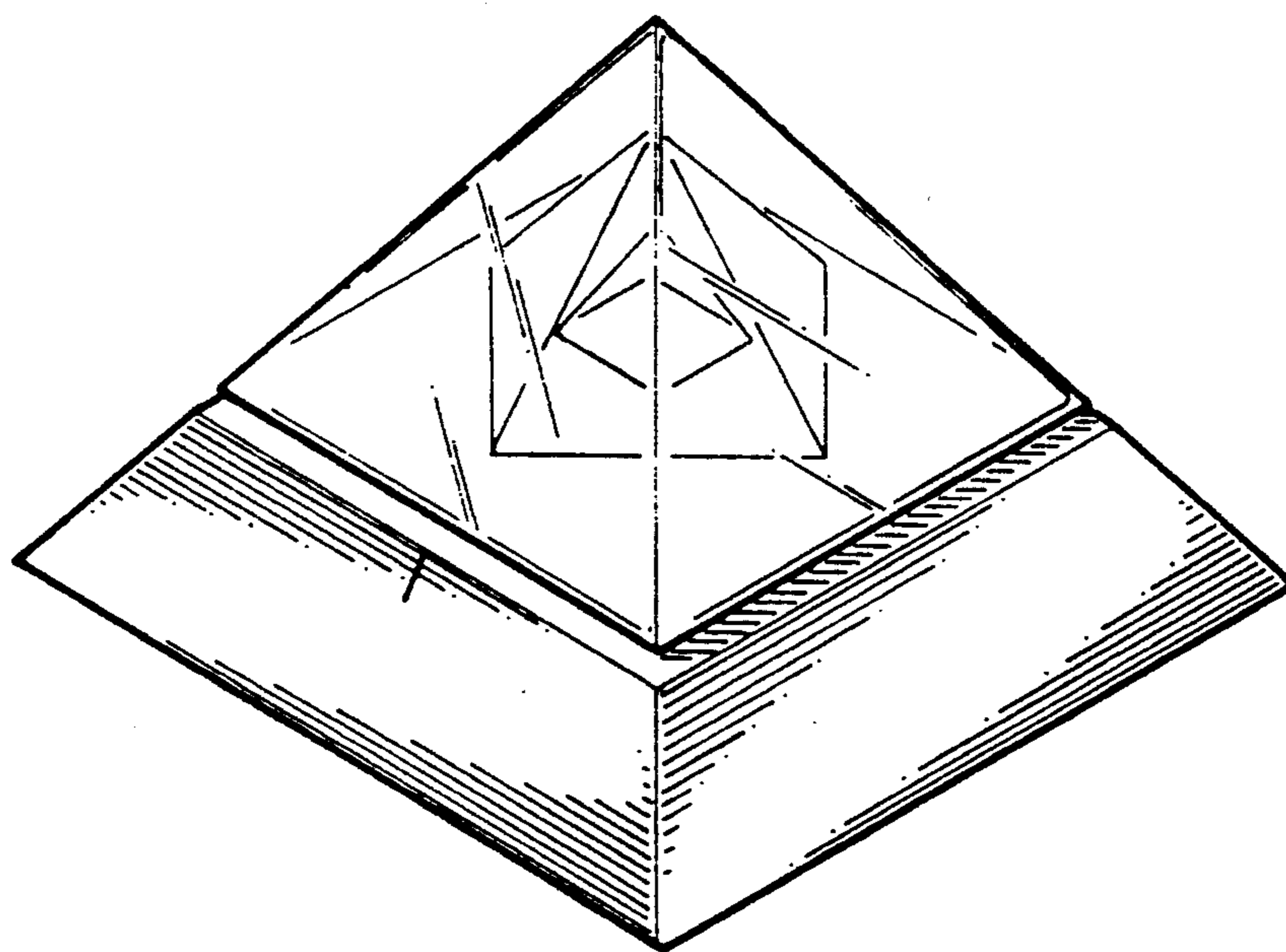

FIG. 8

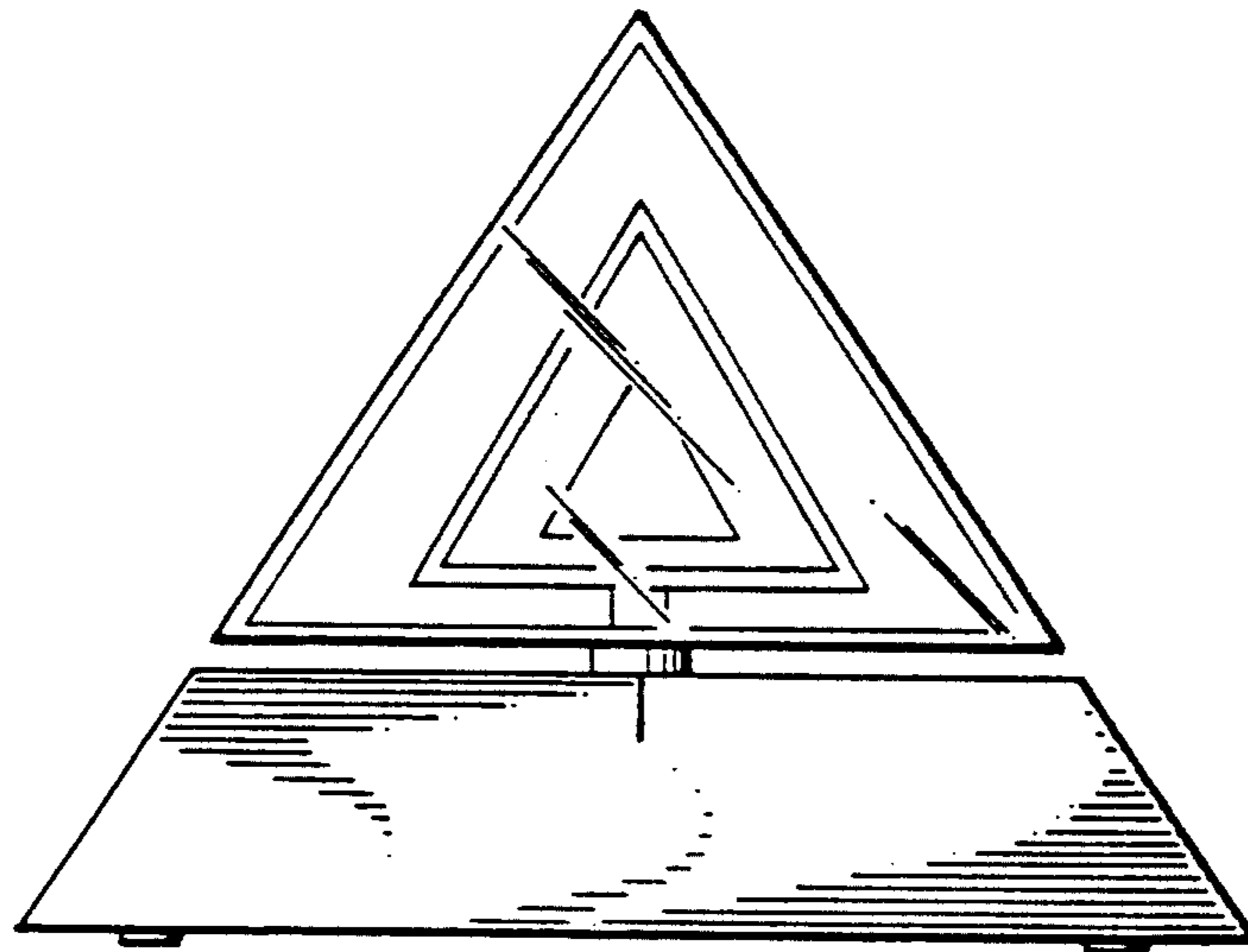
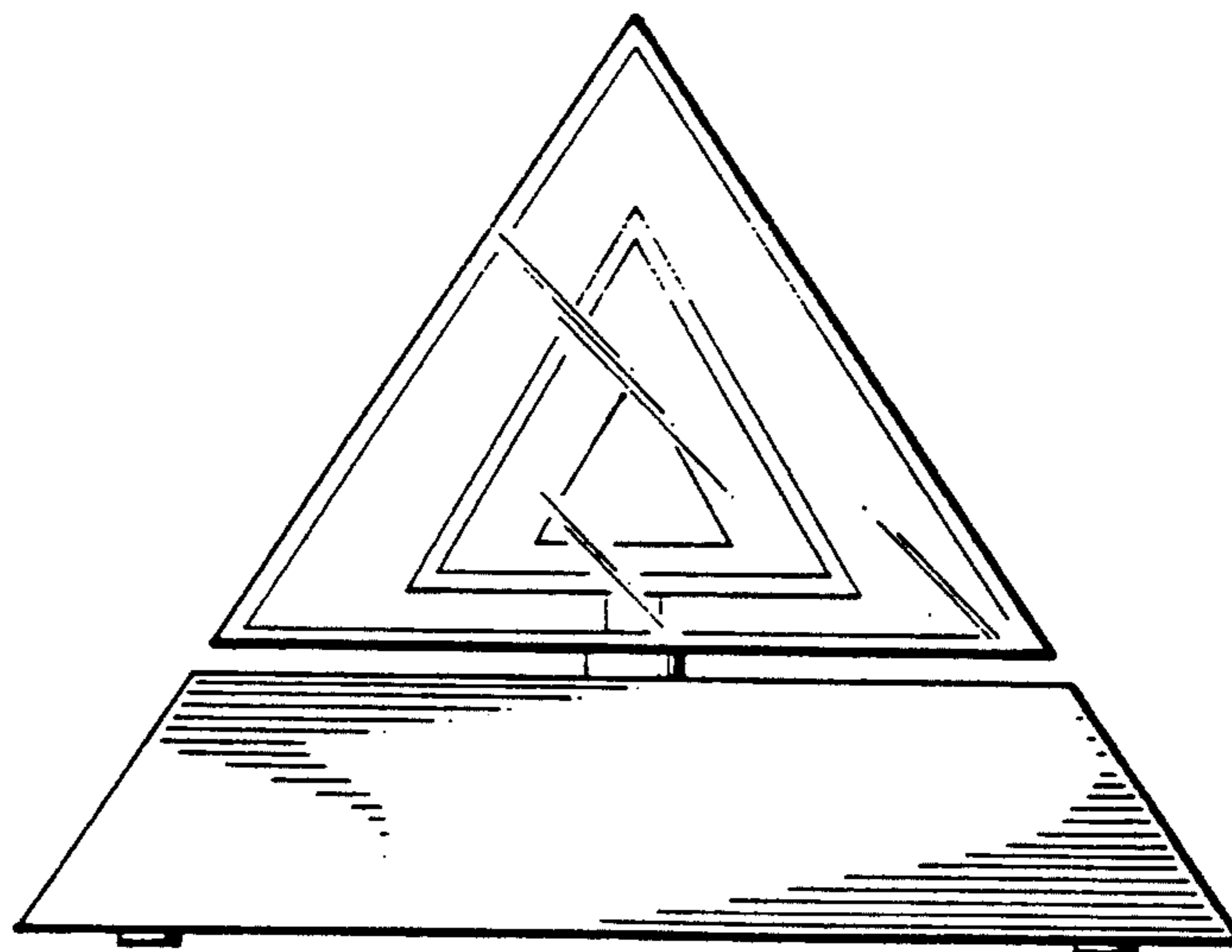

FIG. 2

FIG. 3



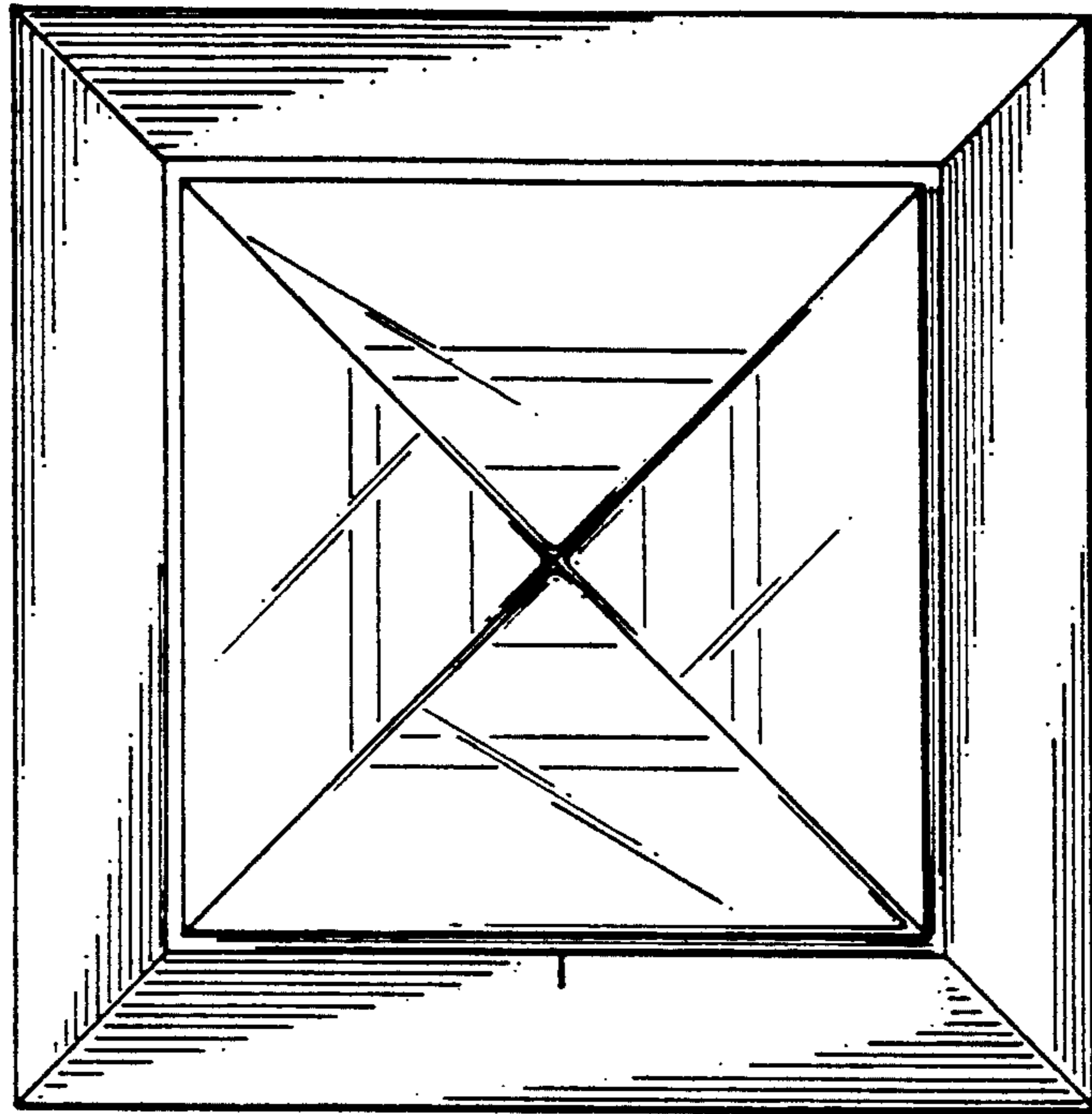

FIG. 4

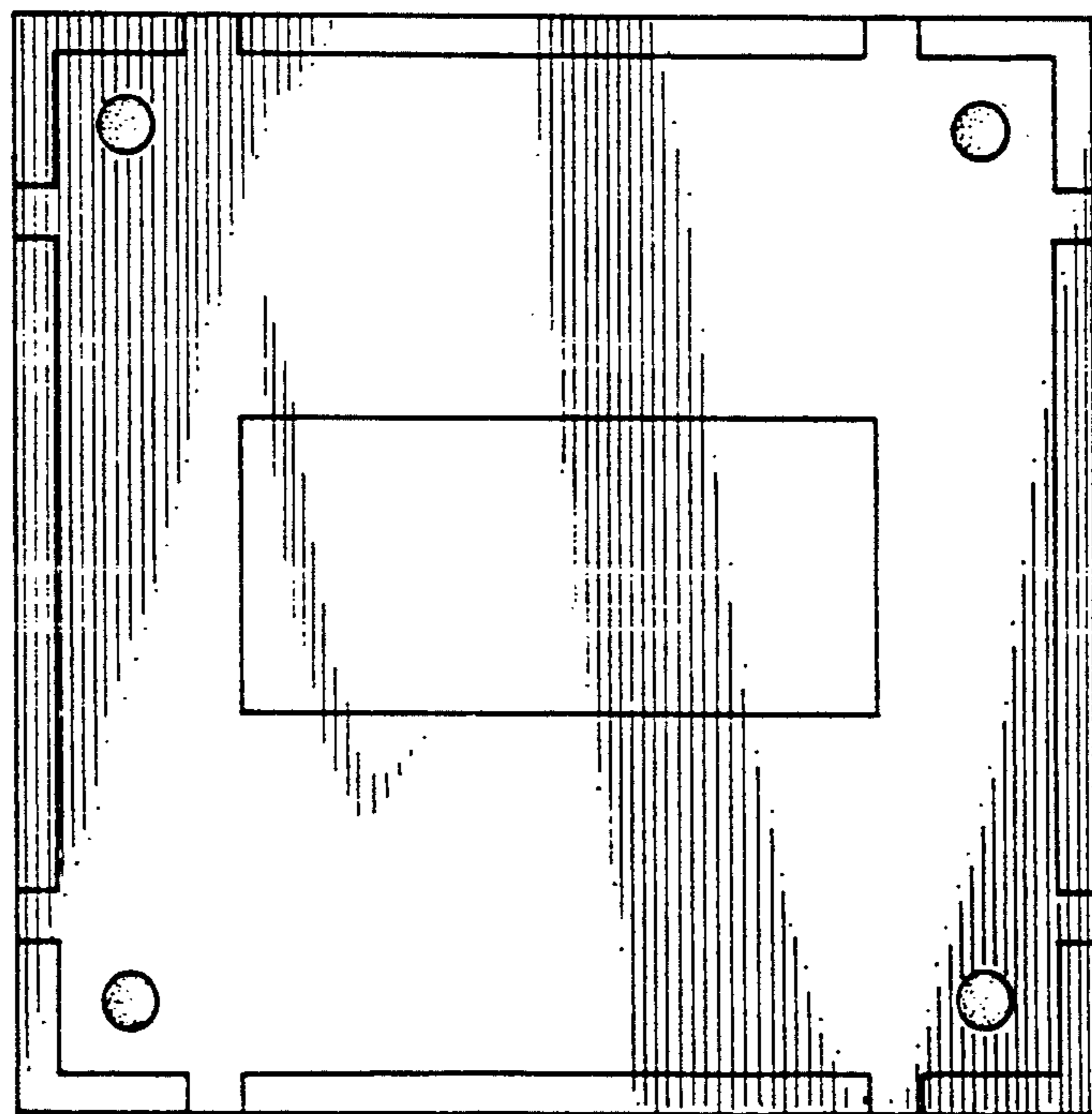

FIG. 5

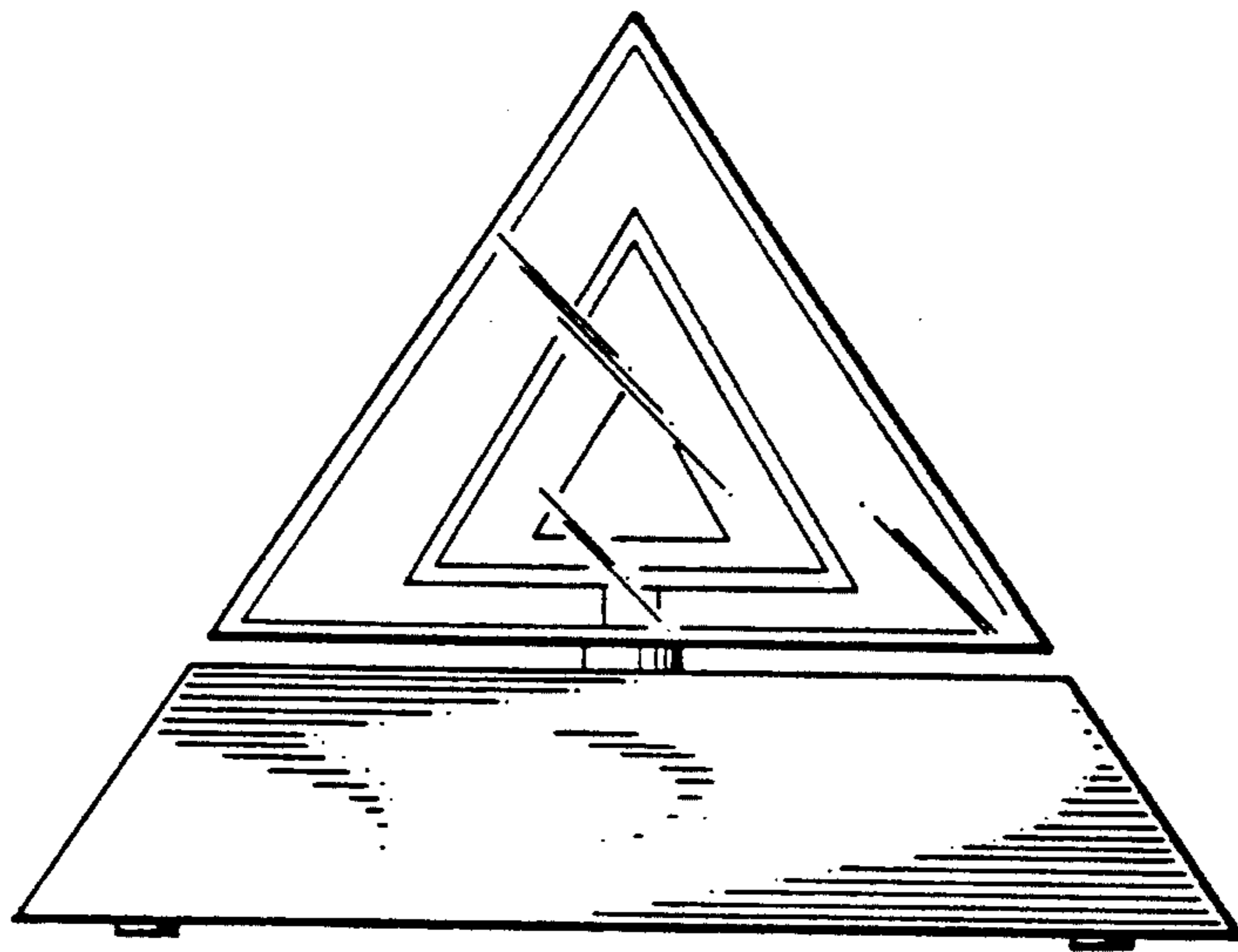

FIG. 6

FIG. 7

