



US00D344495S

# United States Patent [19]

[11] Patent Number: **Des. 344,495**

Cruz et al.

[45] Date of Patent: **\*\* Feb. 22, 1994**

[54] **TOWER COMPUTER HOUSING**

[75] Inventors: **Edward V. Cruz, Newbury Park;  
Barry P. Sween, Santa Monica, both  
of Calif.**

[73] Assignee: **Zeuscom Systems, Inc., Simi Valley,  
Calif.**

[\*\*] Term: **14 Years**

[21] Appl. No.: **884,982**

[22] Filed: **May 18, 1992**

[52] U.S. Cl. .... **D14/102**

[58] Field of Search ..... 312/208.1, 223.2, 223.3;  
360/99.12; 361/390-395; D14/100, 102, 108,  
109; D13/162, 184, 199

[56] **References Cited**

**U.S. PATENT DOCUMENTS**

- D. 316,083 4/1991 Abe et al. .... D14/102
- D. 316,084 4/1991 Imamura et al. .... D14/102
- D. 323,822 2/1992 Fujihara et al. .... D14/102 X

- D. 334,737 4/1993 Lanory ..... D14/102
- D. 337,318 7/1993 Reiter et al. .... D14/102

*Primary Examiner*—Wallace R. Burke  
*Assistant Examiner*—Freda S. Nunn  
*Attorney, Agent, or Firm*—Thomas I. Rozsa; Tony D. Chen

[57] **CLAIM**

The ornamental design for a tower computer housing, as shown and described.

**DESCRIPTION**

FIG. 1 is a perspective view of the new design of our invention of a tower computer housing;  
FIG. 2 is a front elevational view thereof;  
FIG. 3 is a left side elevational view thereof;  
FIG. 4 is a right side elevational view thereof;  
FIG. 5 is a rear elevational view thereof;  
FIG. 6 is a top plan view thereof;  
FIG. 7 is a bottom plan view thereof; and,  
FIG. 8 is a front elevational view thereof with the front cover open.

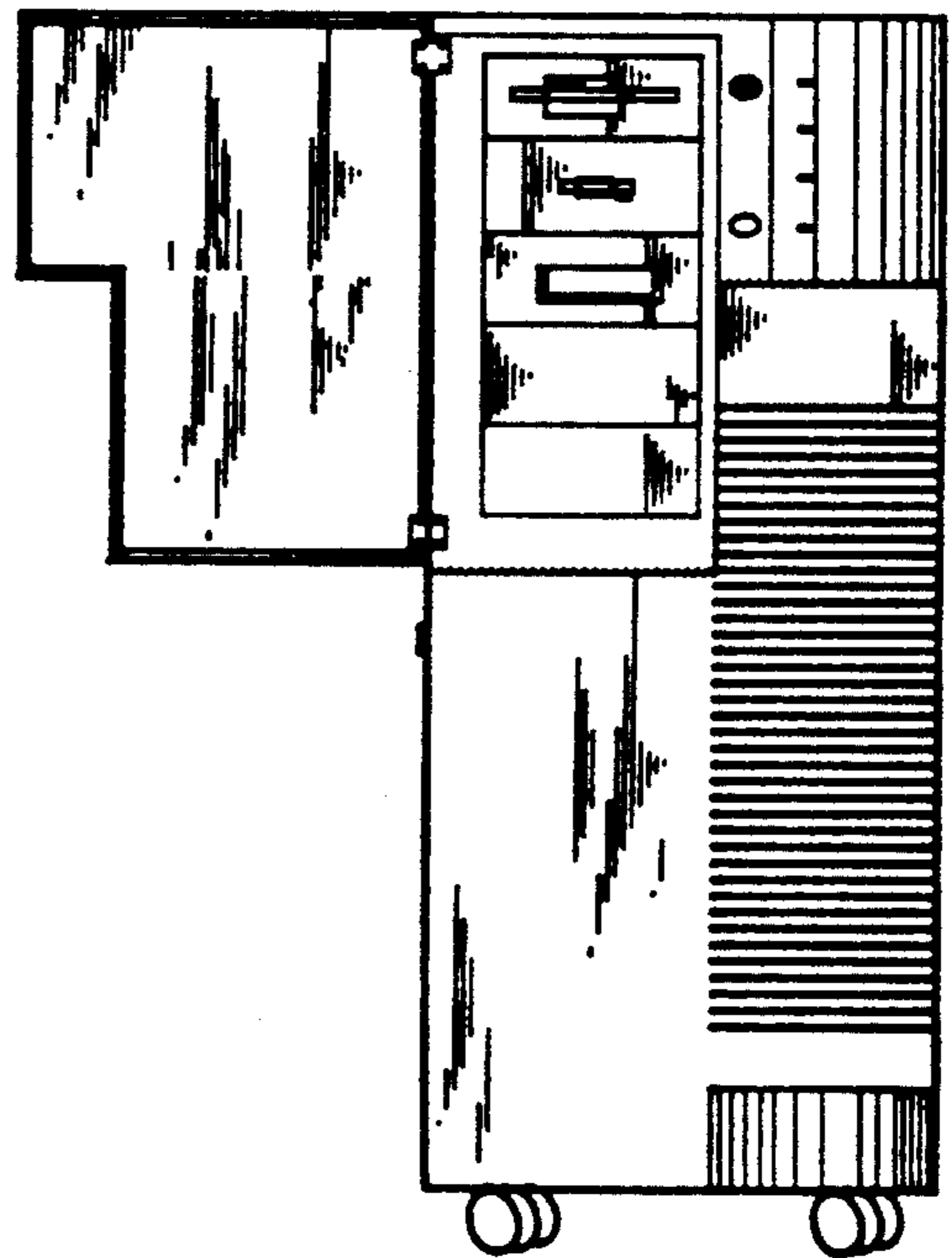
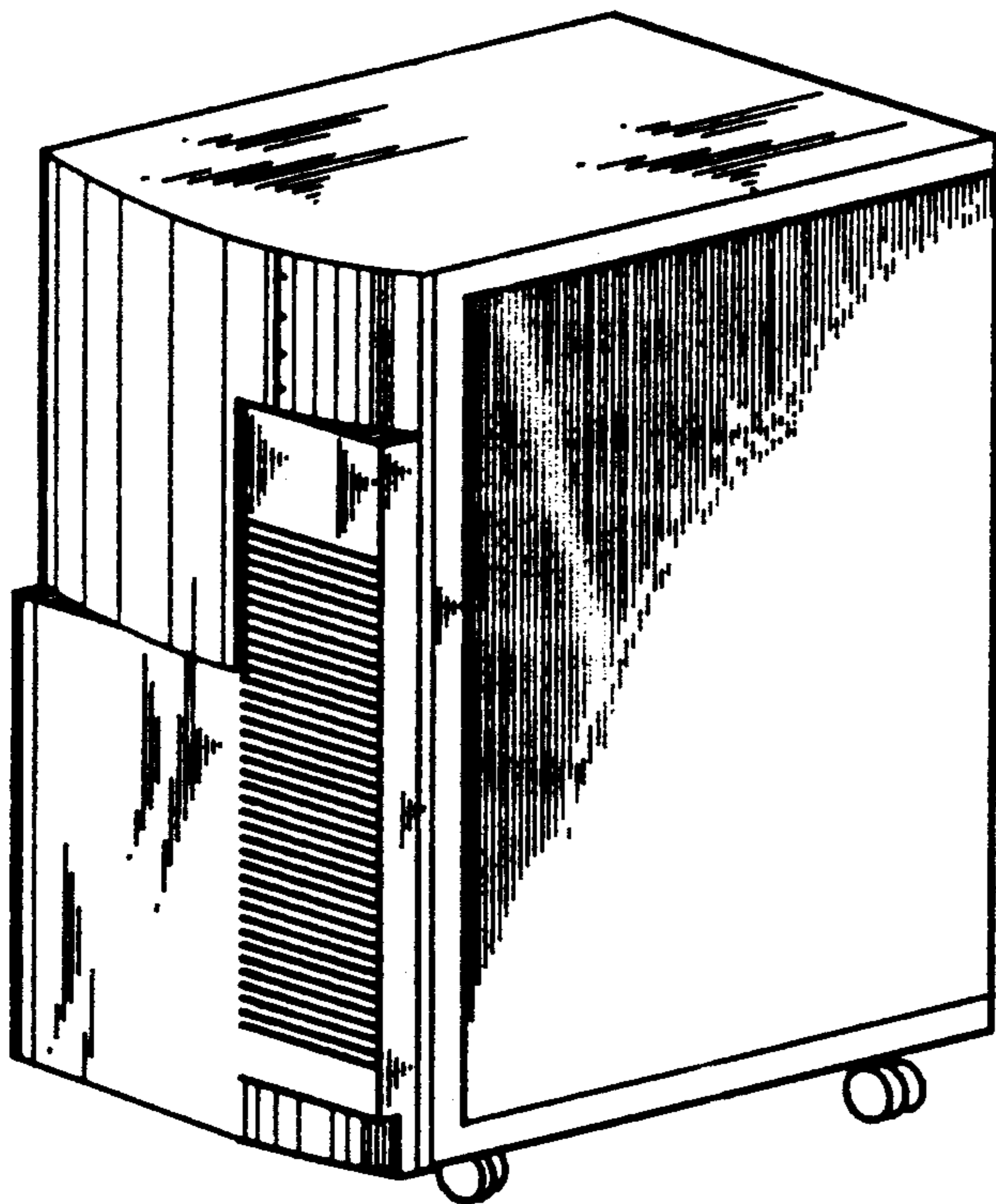

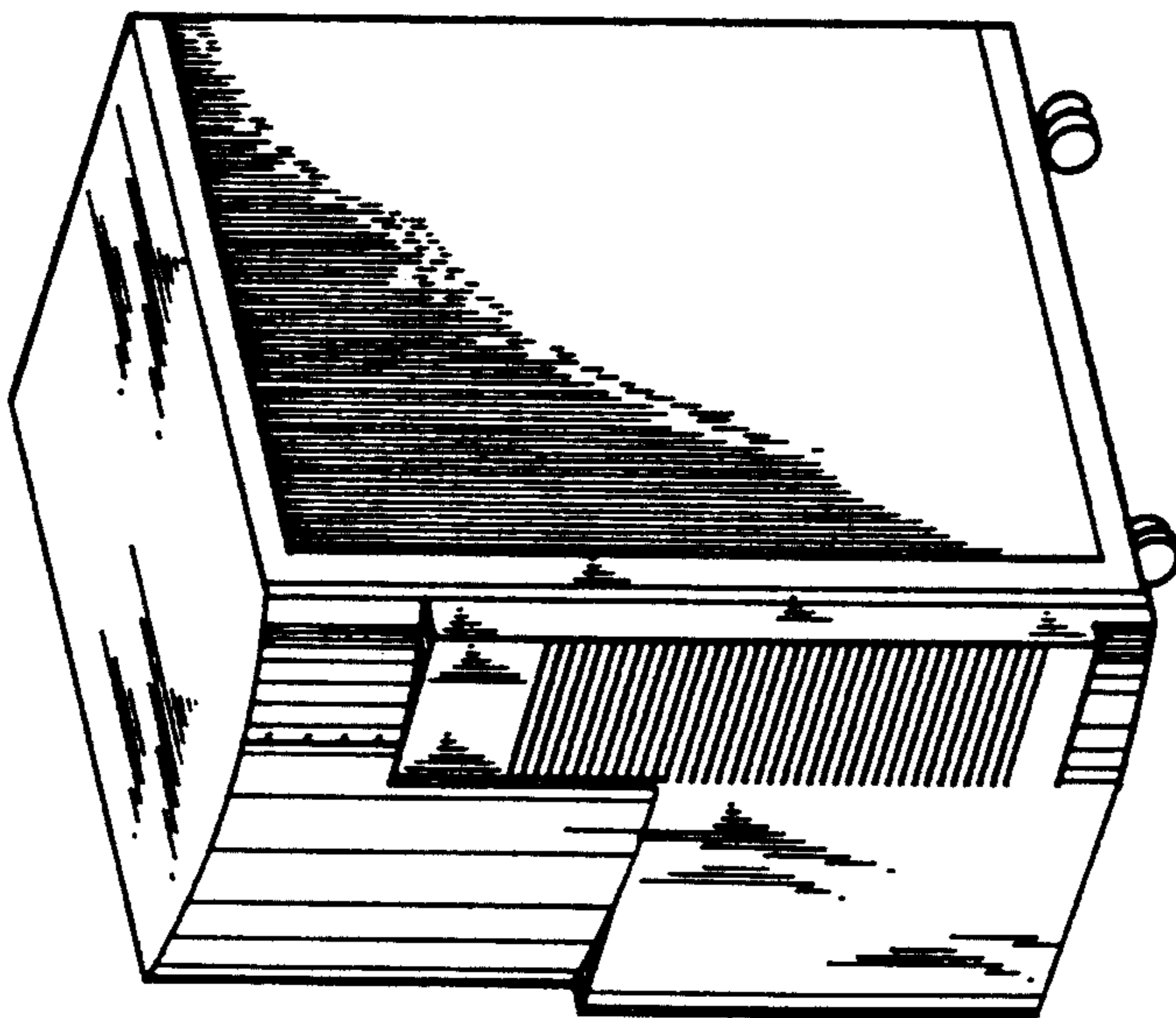

FIG. 1

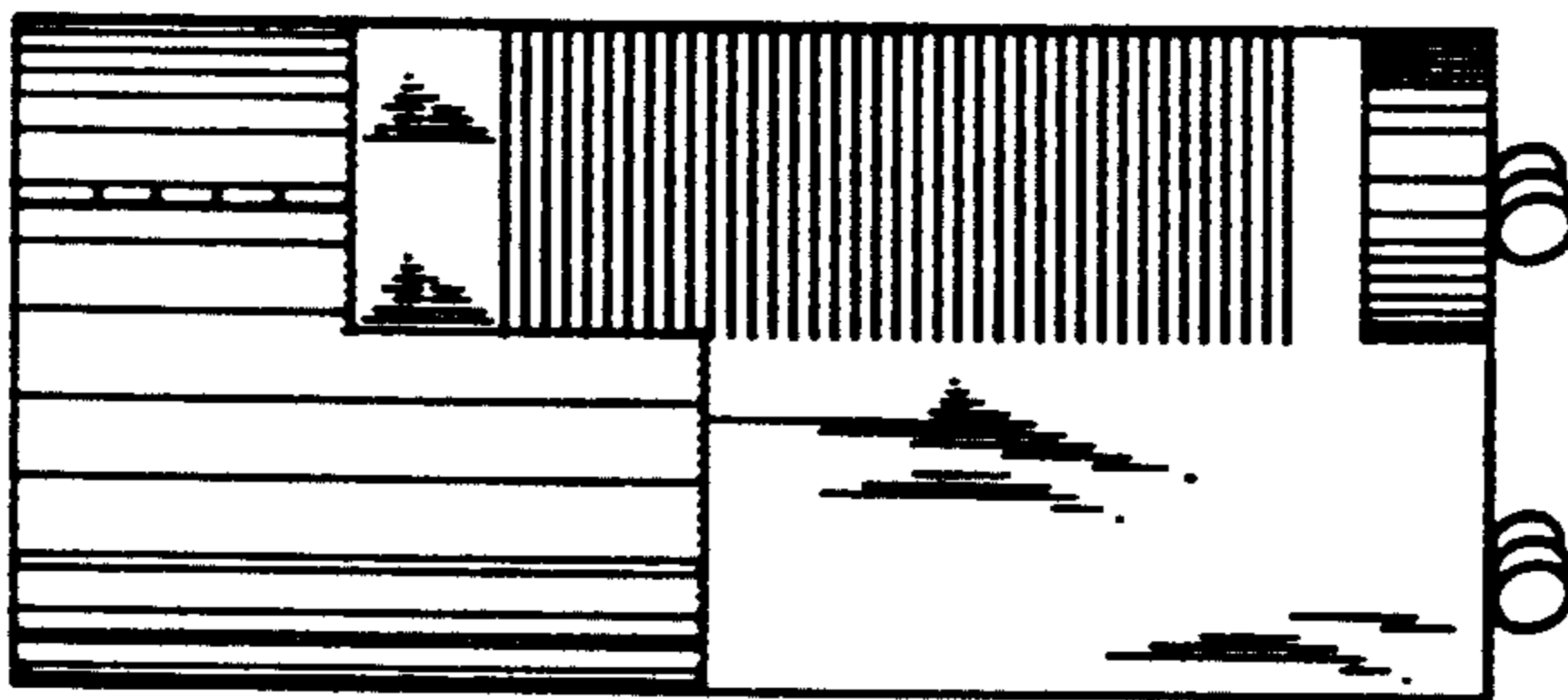

FIG. 2



FIG. 3

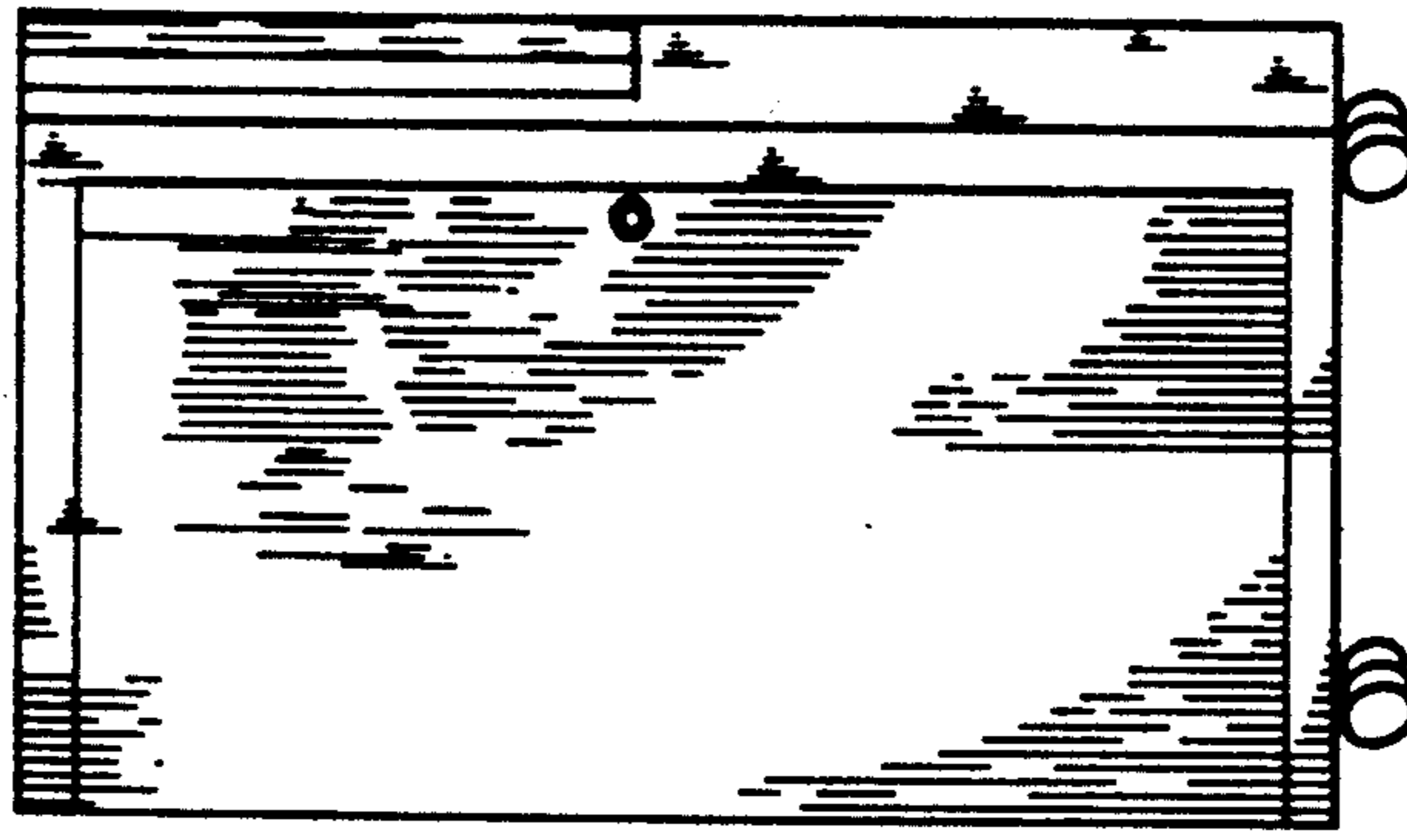

FIG. 4

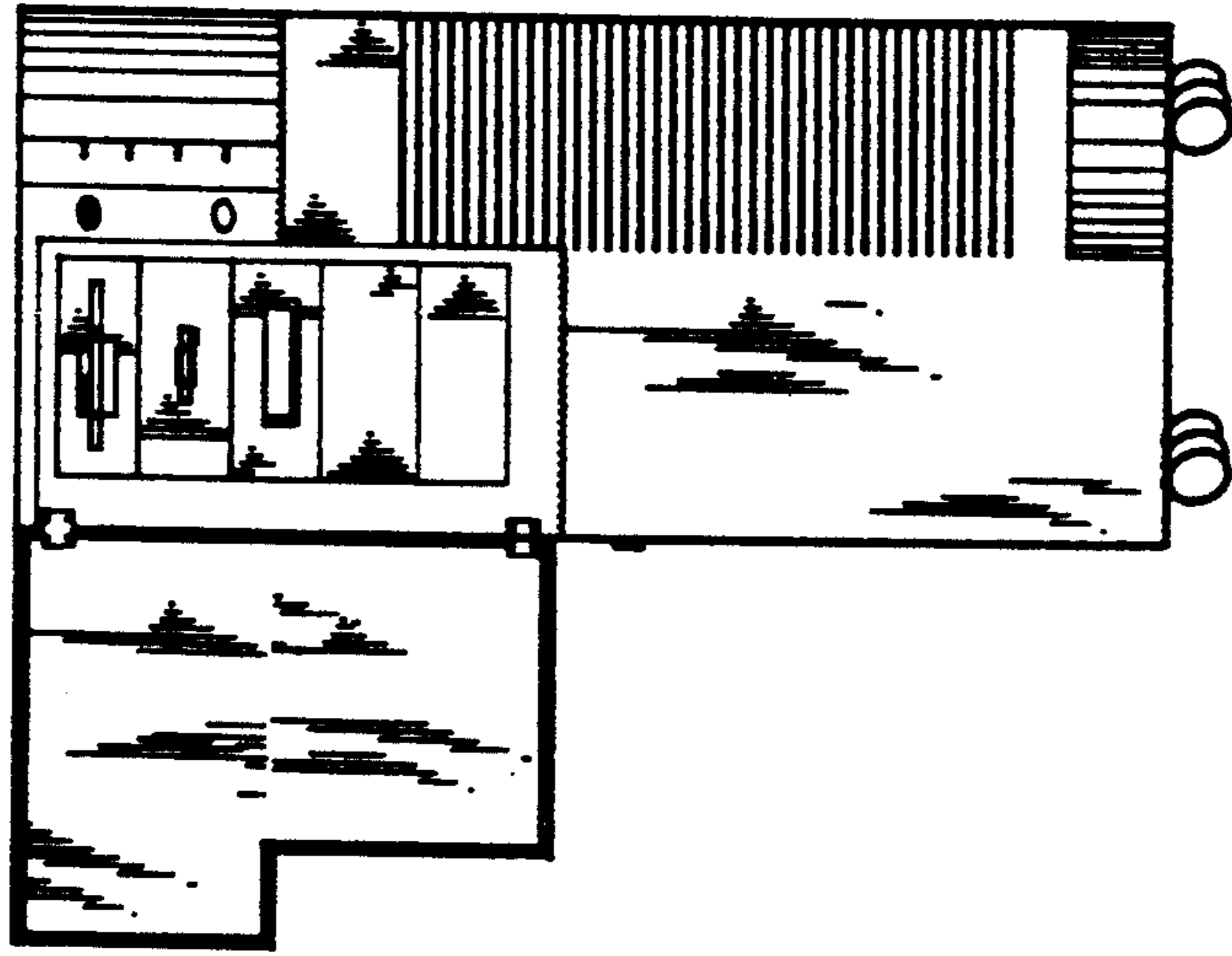

FIG. 8

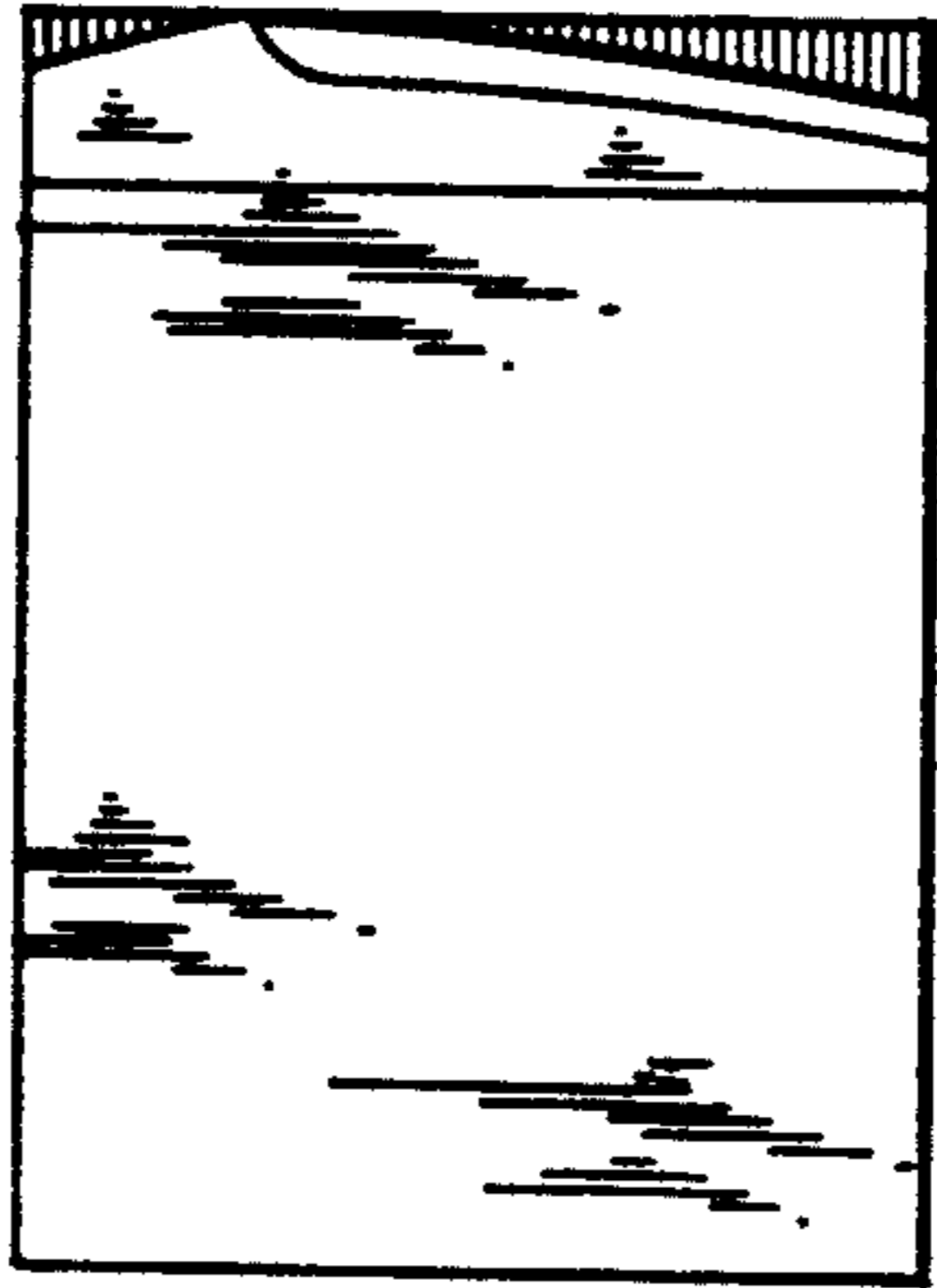

FIG. 6

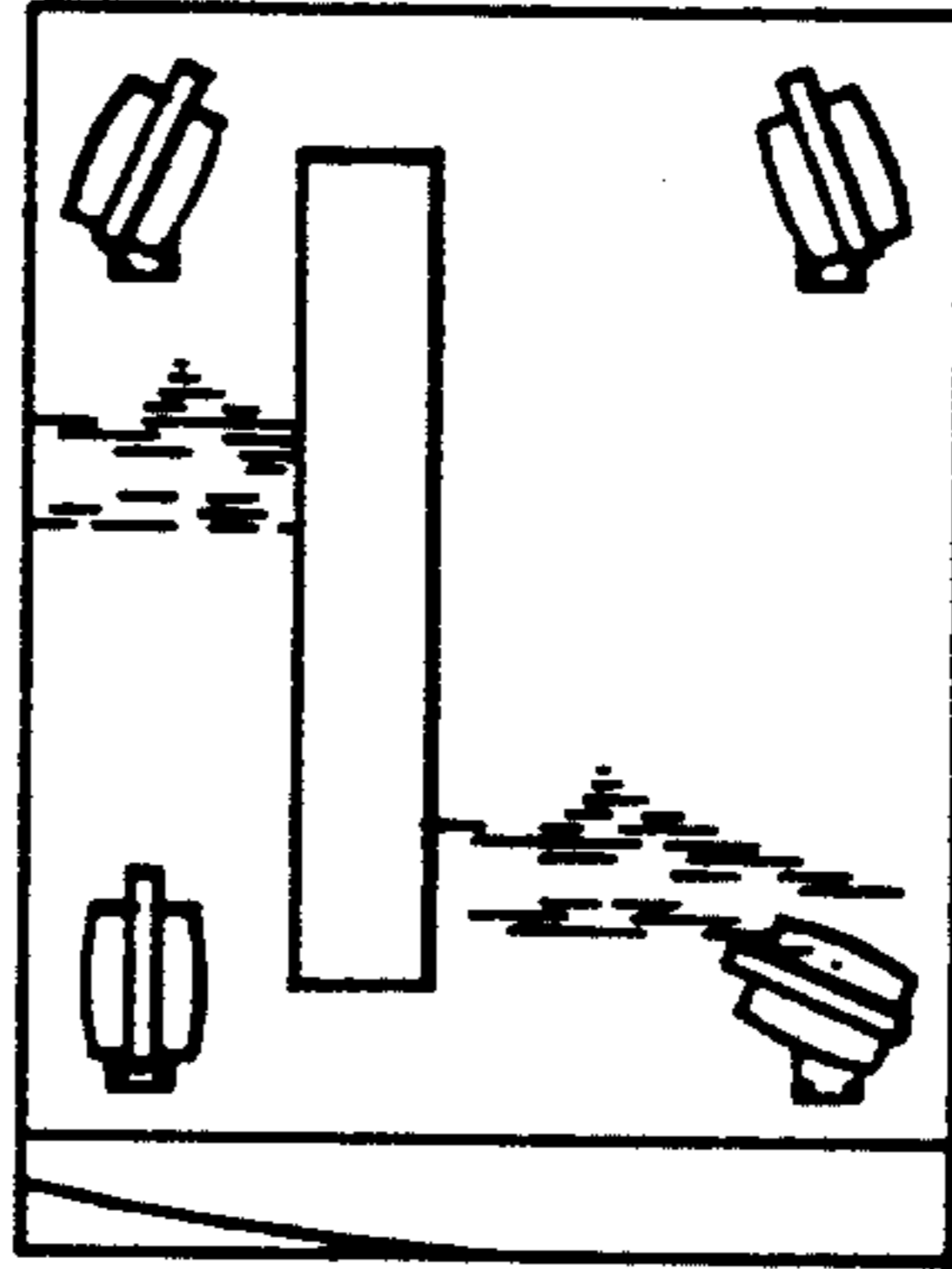

FIG. 7

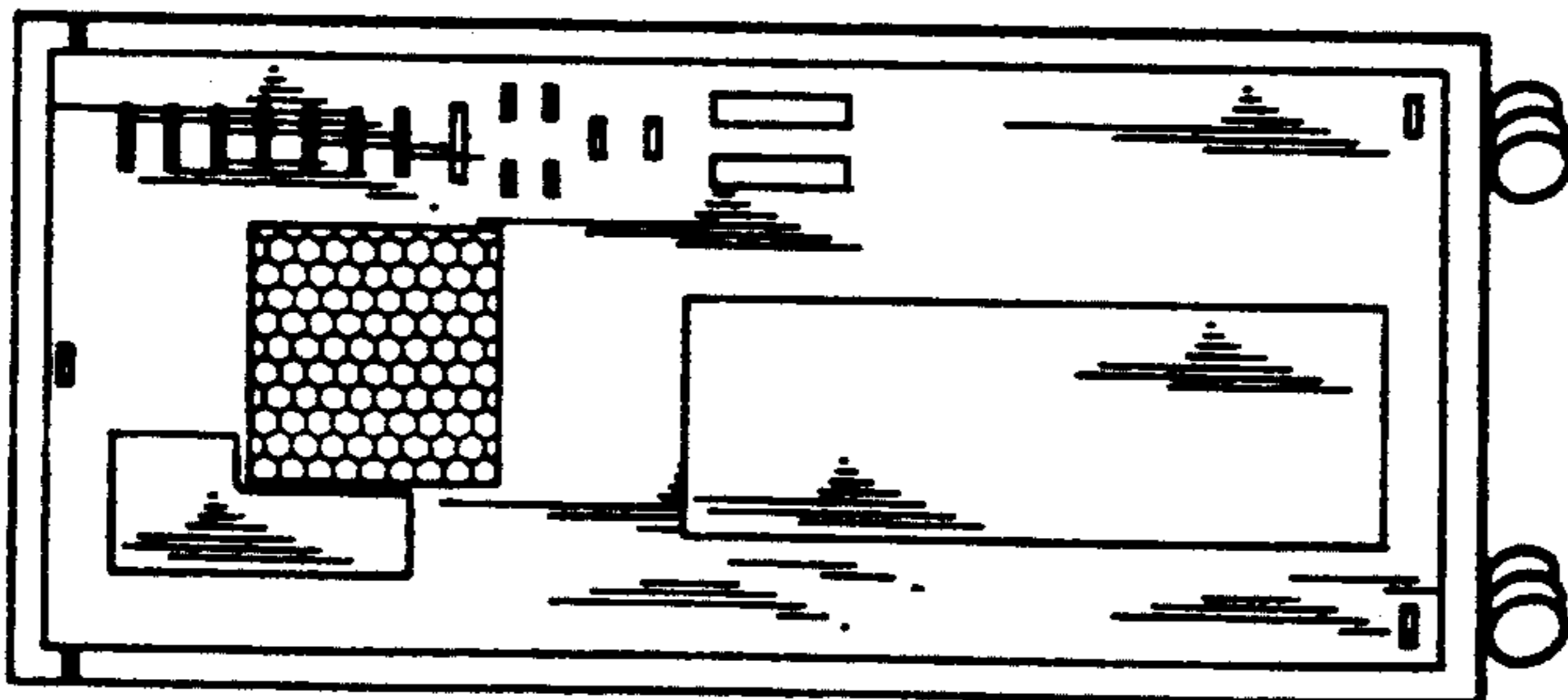

FIG. 5