



US00D341633S

United States Patent [19]

Krebs

[11] Patent Number: **Des. 341,633**

[45] Date of Patent: **** Nov. 23, 1993**

[54] TOY BOAT

[75] Inventor: **T. A. Krebs**, Englewood, Fla.

[73] Assignee: **Brown Box Too, Inc.**, Sarasota, Fla.

[**] Term: **14 Years**

[21] Appl. No.: **754,696**

[22] Filed: **Sep. 26, 1991**

[52] U.S. Cl. **D21/130**

[58] Field of Search **D21/130, 71, 73; D12/300, 315, 318; 446/94, 7, 487, 153, 160**

[56] **References Cited**

U.S. PATENT DOCUMENTS

| | | | | |
|------------|--------|----------|-------|---------|
| 39,802 | 2/1909 | Pease | | D21/130 |
| D. 87,647 | 8/1932 | Scarponi | | D21/130 |
| D. 95,004 | 3/1935 | Weddell | | D21/130 |
| D. 140,720 | 4/1945 | Ripley | | D21/130 |

| | | | | |
|------------|--------|--------|-------|---------|
| D. 162,628 | 3/1951 | Carlin | | D21/130 |
| D. 236,145 | 7/1975 | Tong | | D21/130 |
| 4,212,130 | 7/1980 | Walker | | 446/482 |

Primary Examiner—Bernard Ansher
Assistant Examiner—R. Barkai
Attorney, Agent, or Firm—Charles J. Prescott

[57] **CLAIM**

The ornamental design for a toy boat, as shown and described.

DESCRIPTION

FIG. 1 is a perspective view of a toy boat showing my new design;
FIG. 2 is a right side elevational view thereof, the left side being a mirror image of that shown;
FIG. 3 is a front elevational view thereof;
FIG. 4 is a rear elevational view thereof; and,
FIG. 5 is a top plan view thereof.

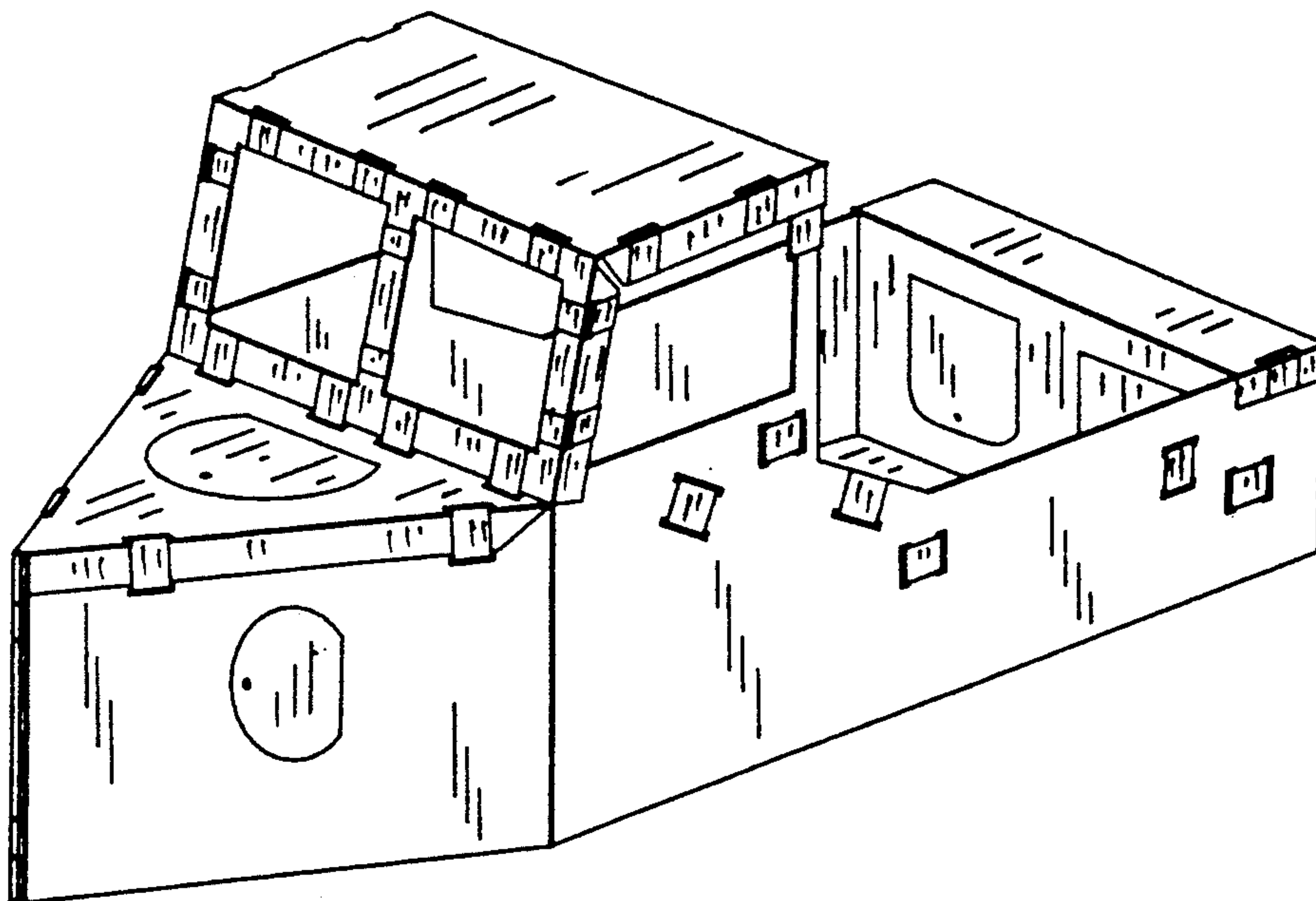

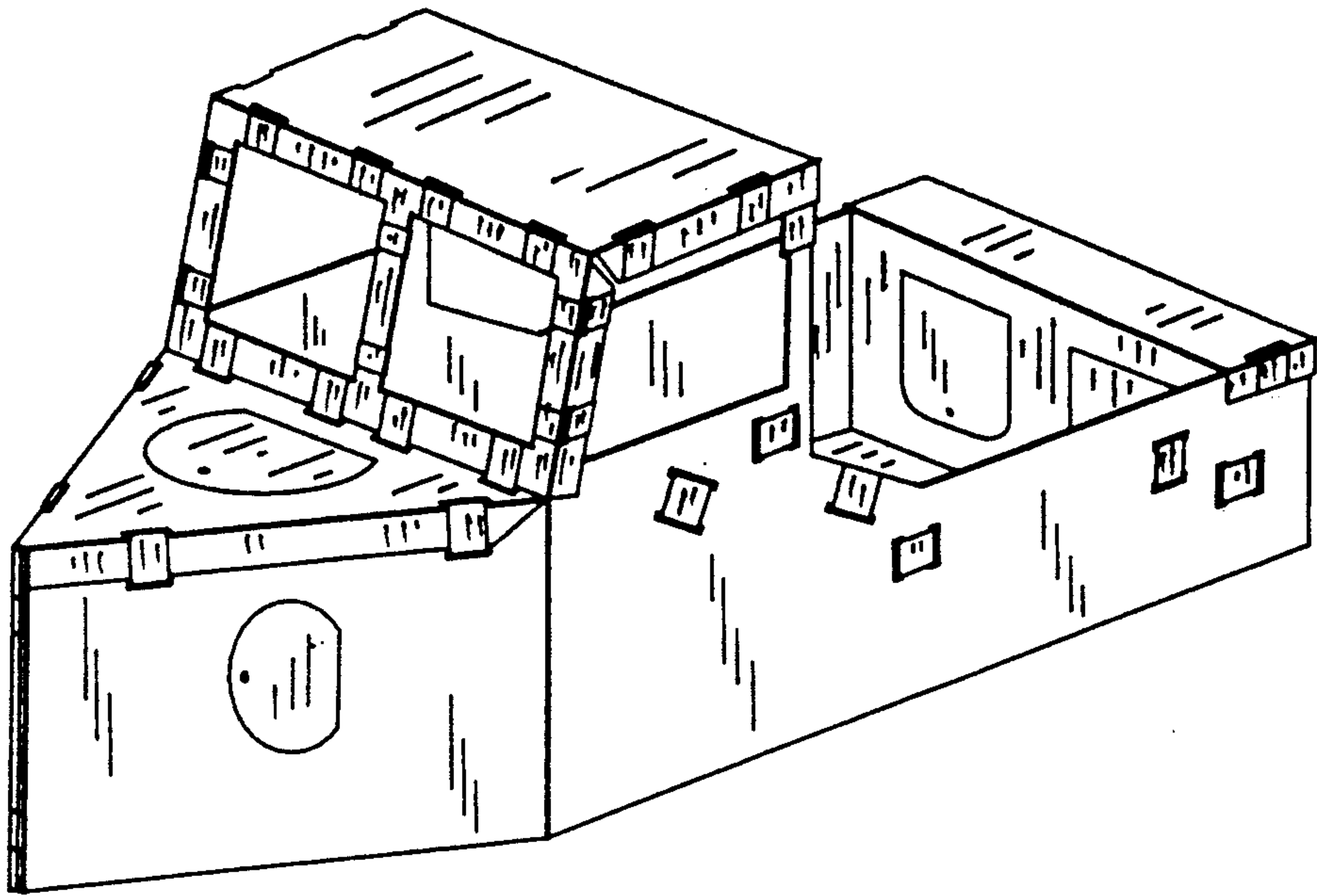

FIG. 1

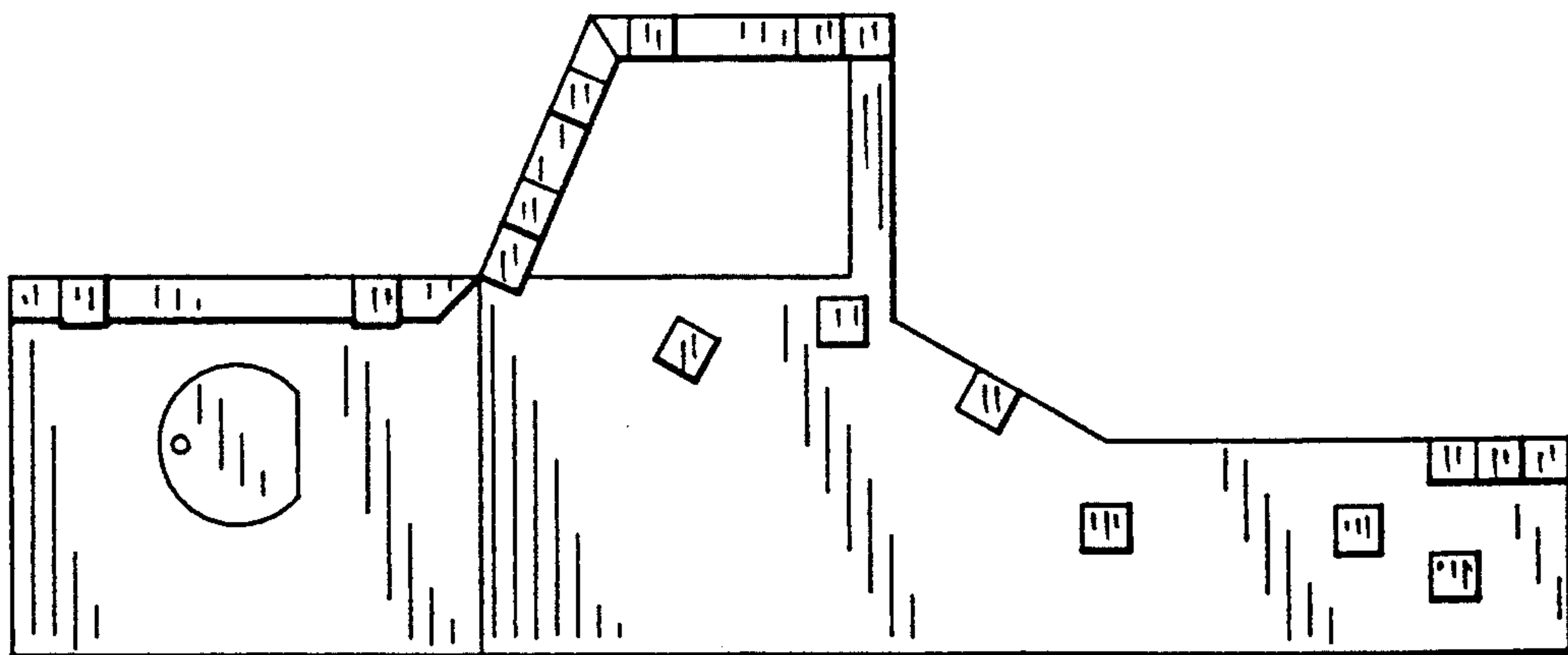

FIG. 2

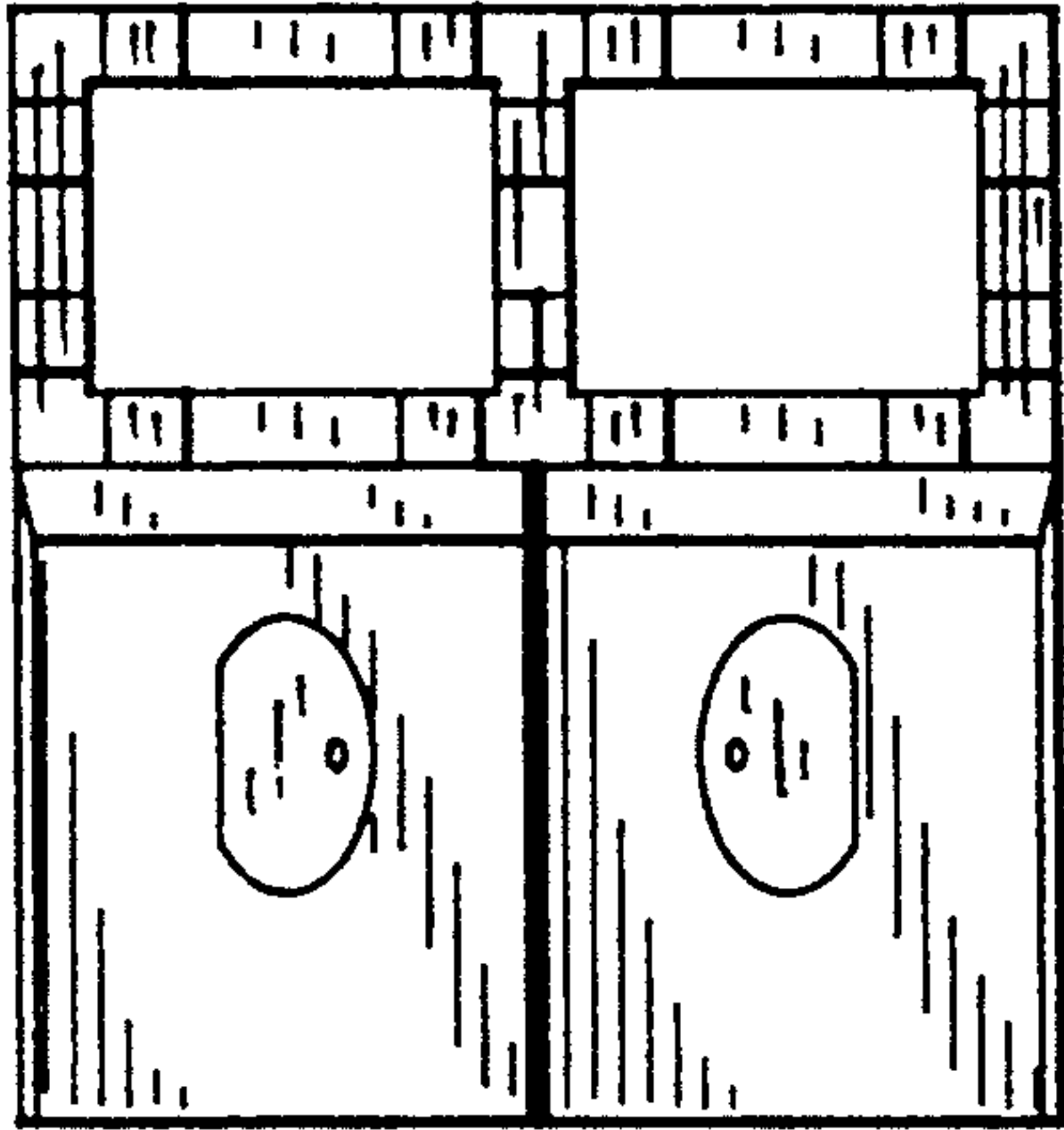

FIG. 3

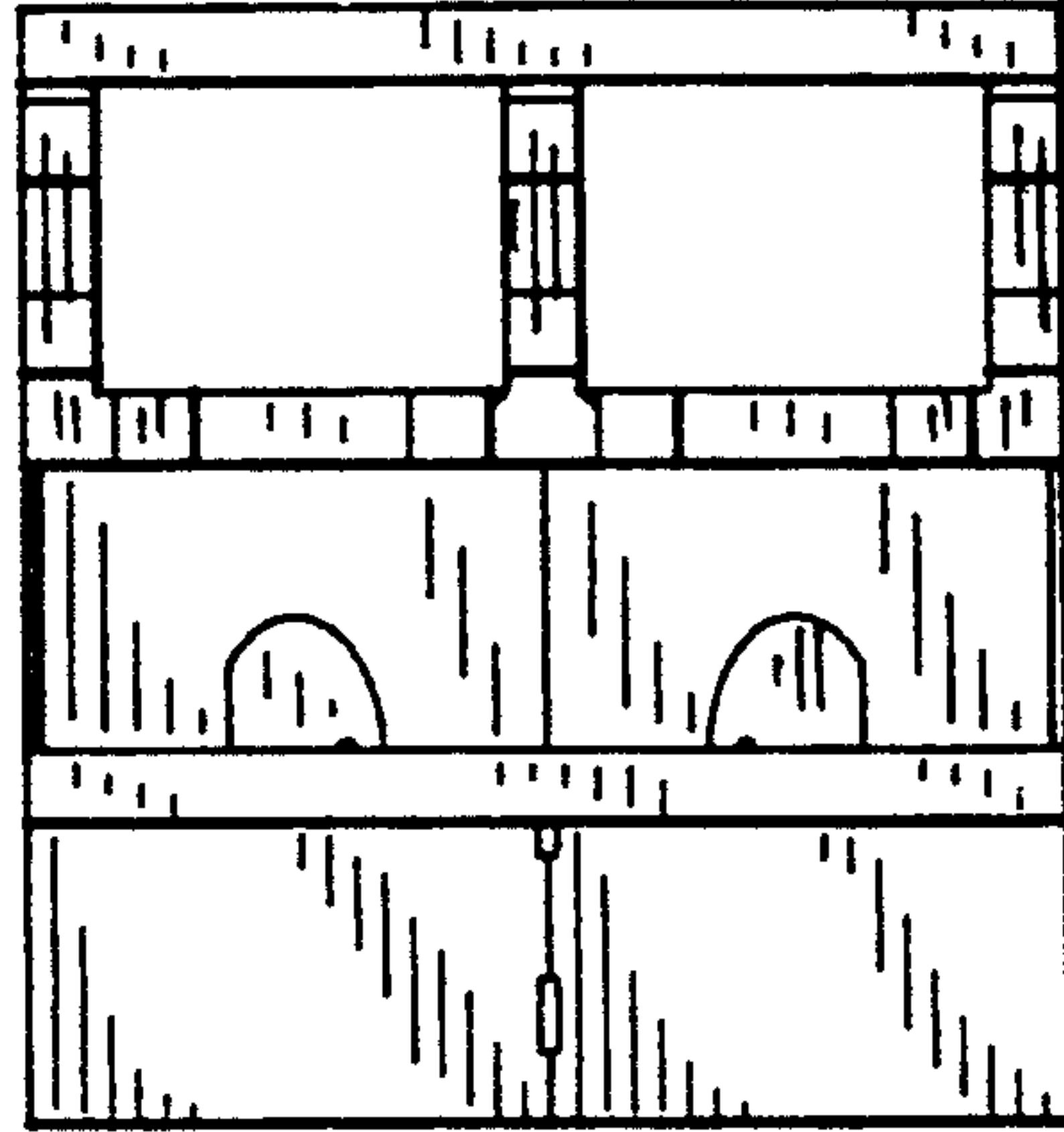

FIG. 4



FIG. 5