



US00D340449S

# United States Patent [19] Chu

[11] Patent Number: **Des. 340,449**

[45] Date of Patent: **\*\* Oct. 19, 1993**

[54] **COMPUTER MAINFRAME FRONT PANEL**

D. 332,949 2/1993 Aderman ..... D14/115

[76] Inventor: **Edward Chu**, 2F, No. 10, Lane 329,  
Sec. 1, Tunhua S. Rd., Taipei,  
Taiwan

*Primary Examiner*—Wallace R. Burke  
*Assistant Examiner*—Freda S. Nunn  
*Attorney, Agent, or Firm*—Varndell Legal Group

[\*\*] Term: **14 Years**

[57] **CLAIM**

[21] Appl. No.: **784,783**

The ornamental design for a computer mainframe front panel, as shown and described.

[22] Filed: **Oct. 30, 1991**

### DESCRIPTION

[52] U.S. Cl. .... **D14/115**

[58] Field of Search ..... D14/100, 102, 109, 115;  
D13/162, 184, 199; 360/99.12; 361/380-385,  
390-395; 312/223

FIG. 1 is a perspective view of a computer mainframe front panel showing my new design;  
FIG. 2 is a front elevational view thereof;  
FIG. 3 is a rear elevational view thereof;  
FIG. 4 is a left side elevational view thereof;  
FIG. 5 is a right side elevational view thereof;  
FIG. 6 is a top plan view thereof;  
FIG. 7 is a bottom plan view thereof; and,  
FIG. 8 is a front elevational view thereof showing the door of the panel in an open position.

### [56] References Cited

#### U.S. PATENT DOCUMENTS

D. 238,495 1/1976 Kalvitis et al. .... D14/115 X  
D. 249,945 10/1978 Freijd ..... D14/115  
D. 332,947 2/1993 Kline et al. .... D14/115

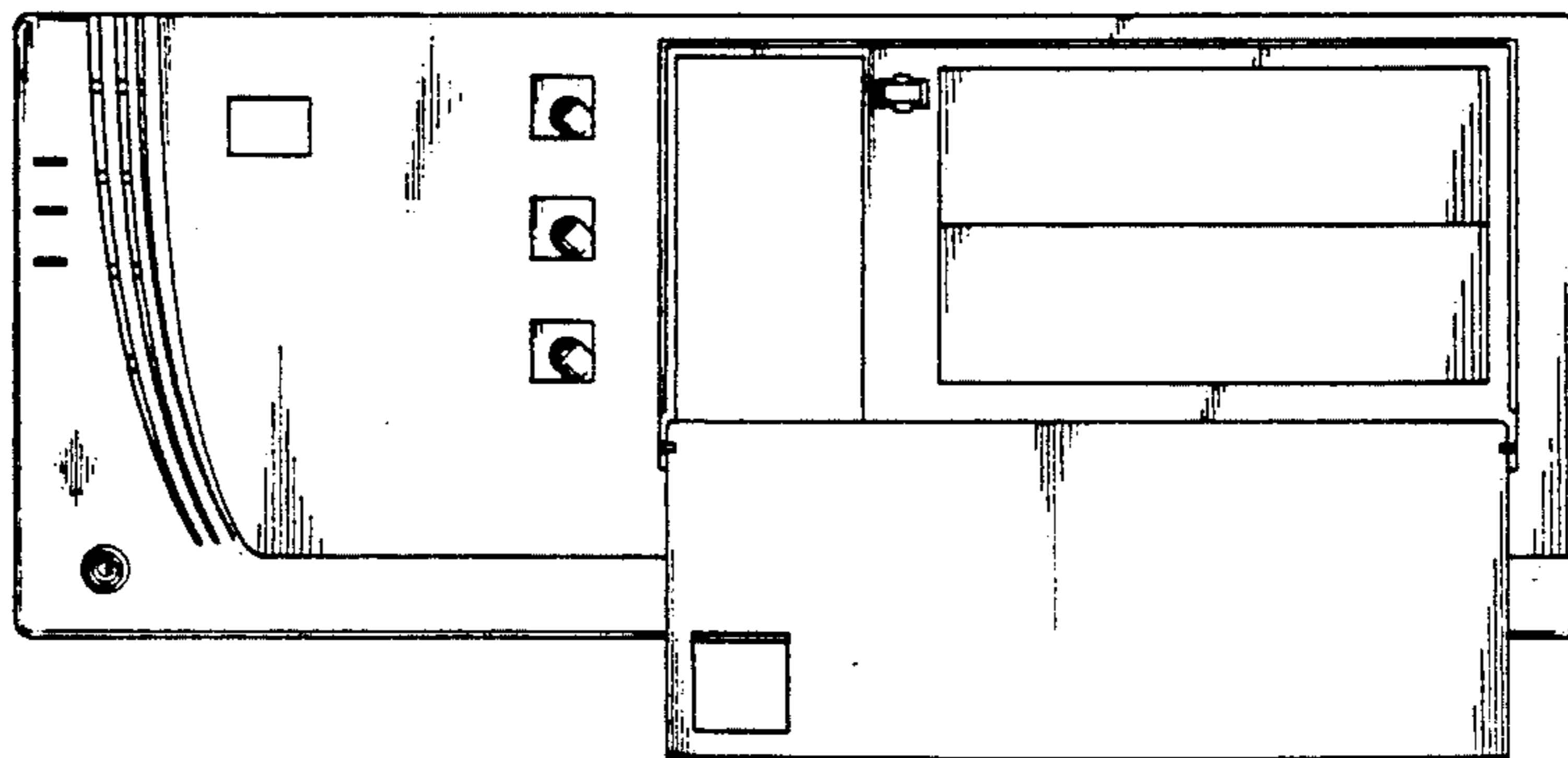
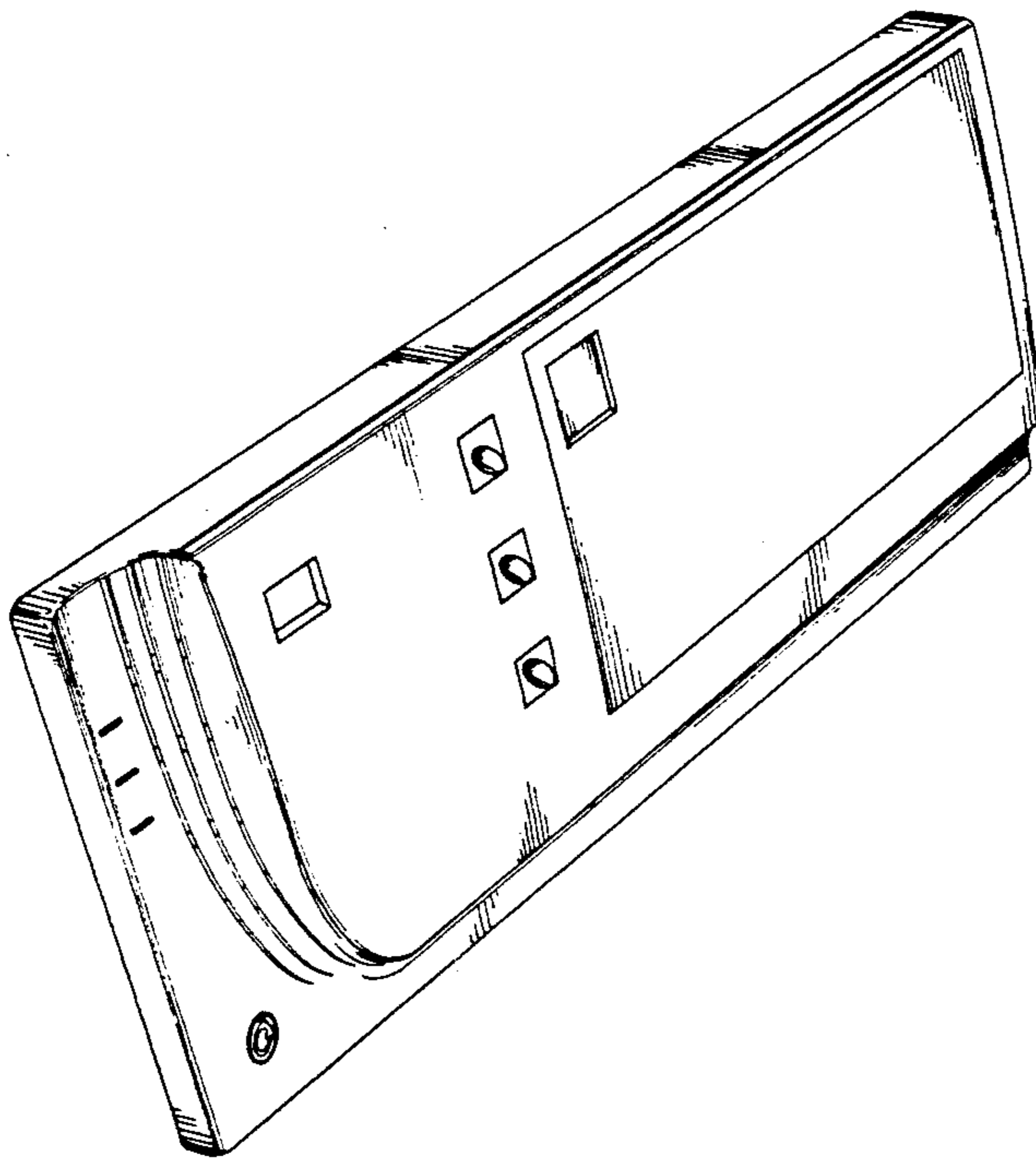

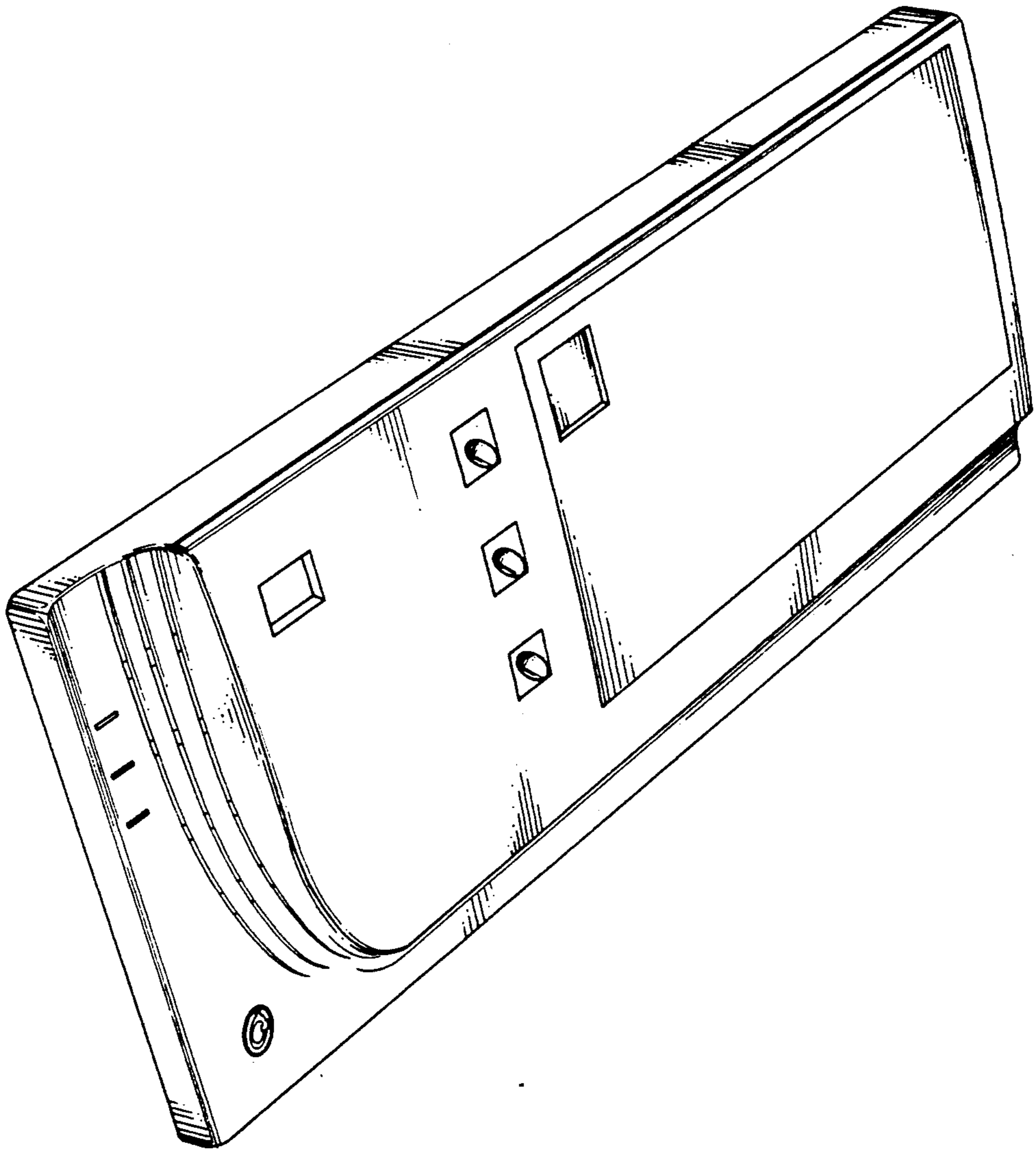

Fig.1

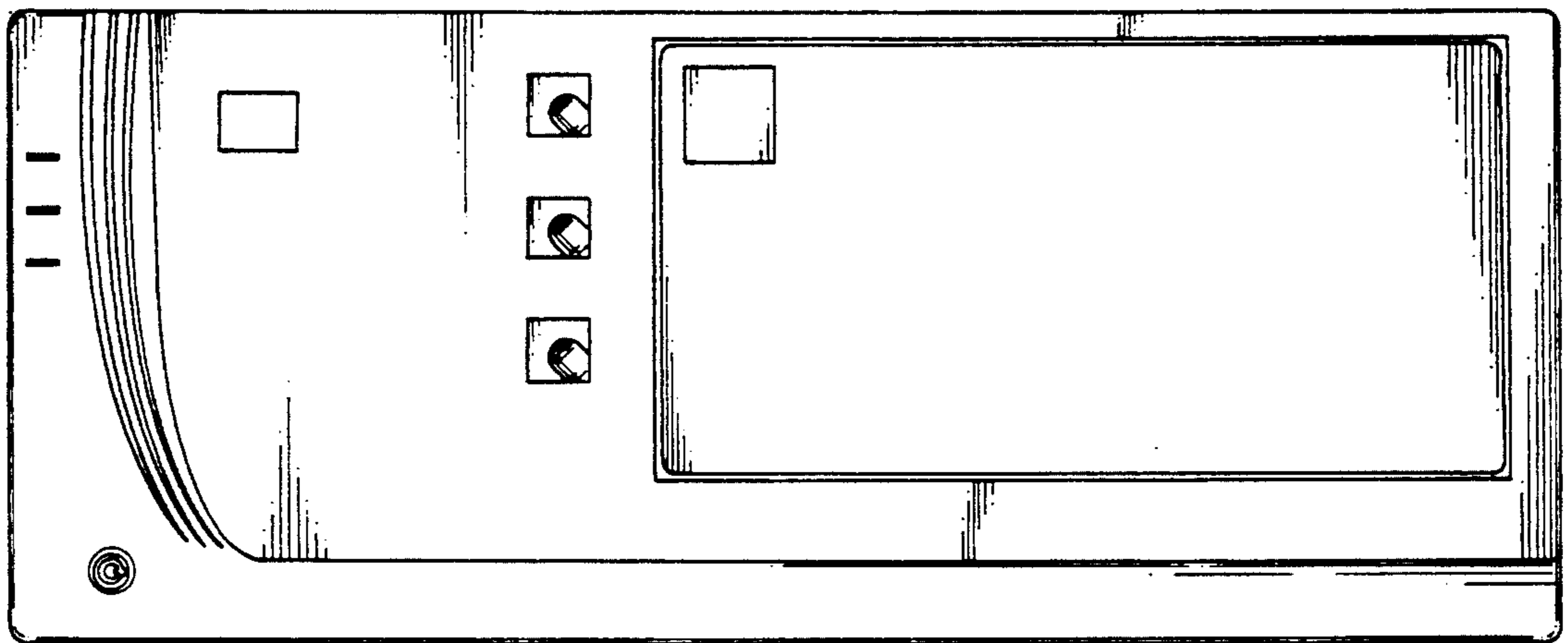

Fig. 2

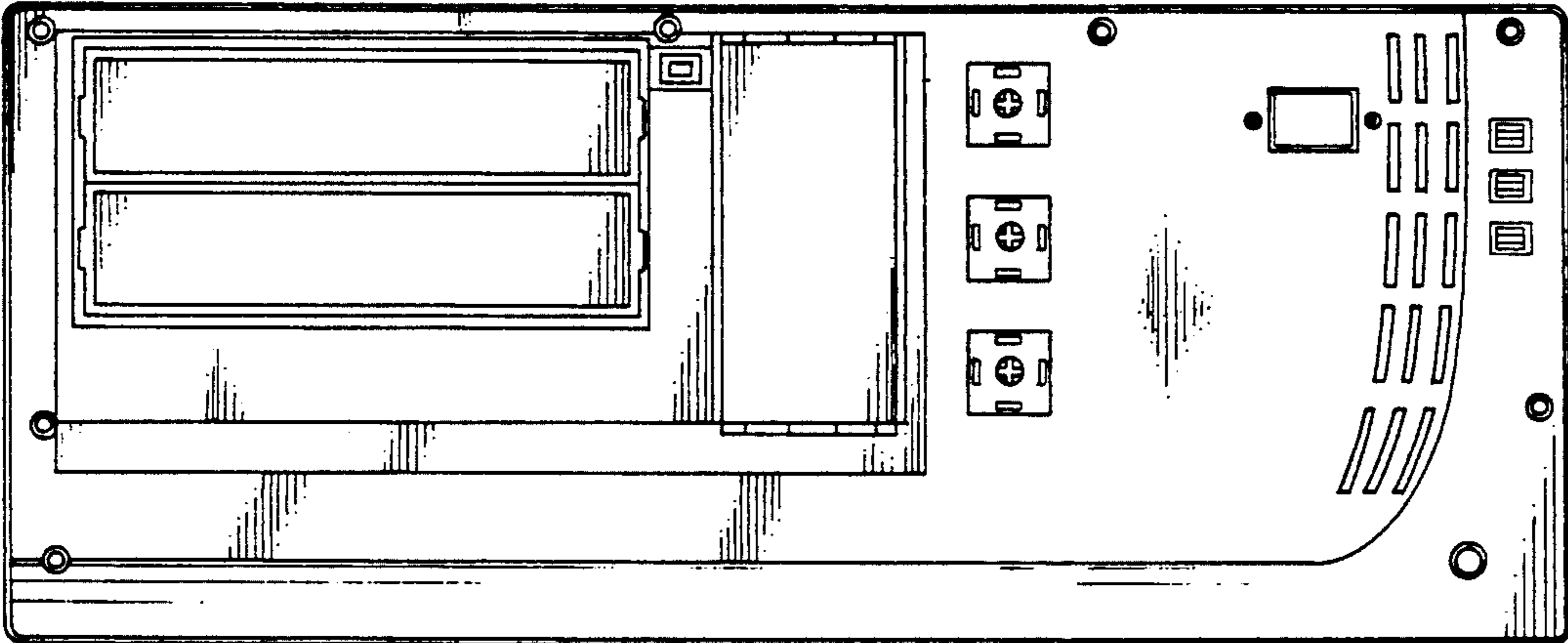

Fig.3



Fig. 4



Fig. 5



Fig.6

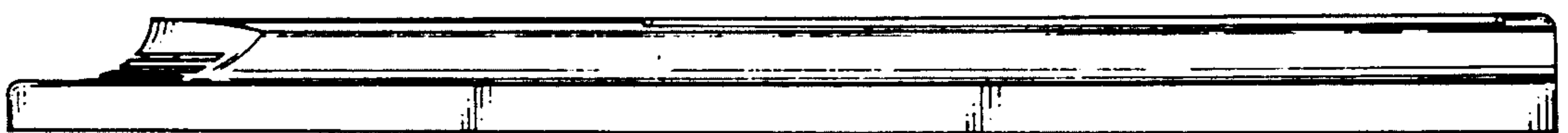

Fig.7

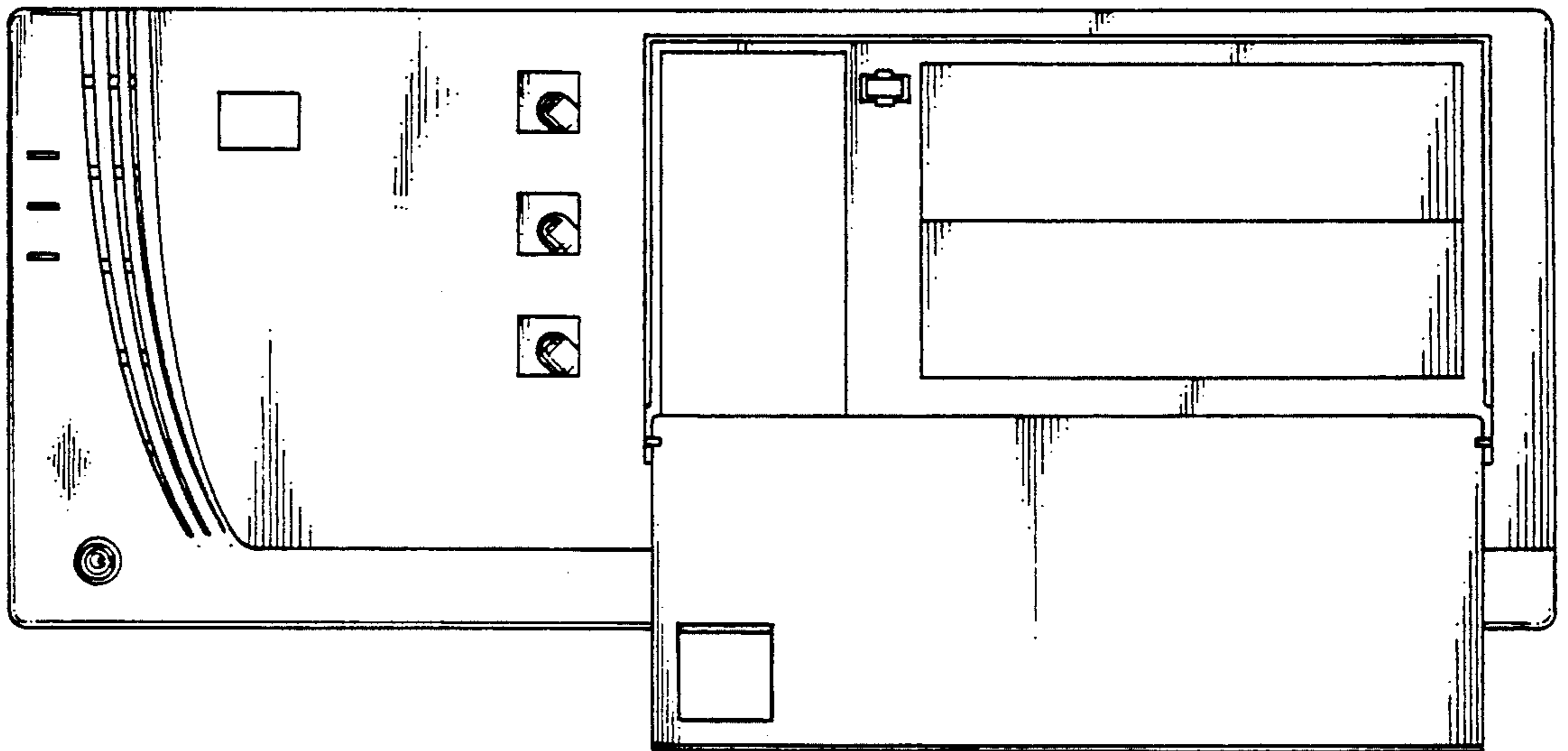

Fig. 8