



US00D337903S

# United States Patent [19]

[11] Patent Number: **Des. 337,903**

Shelton, Jr.

[45] Date of Patent: **\*\* Aug. 3, 1993**

## [54] COMBINATION SEAT UNIT AND FURNITURE SUPPORT

D. 327,188 6/1992 Allen ..... D6/455 X

[76] Inventor: **Bernard L. Shelton, Jr.**, 2502 Queens Chapel Rd. #3, Hyattsville, Md. 20782

*Primary Examiner*—Alan P. Douglas  
*Assistant Examiner*—Jeffrey Asch

[\*\*] Term: **14 Years**

### [57] CLAIM

[21] Appl. No.: **735,926**

The ornamental design for combination seat unit and furniture support, as shown and described.

[22] Filed: **Aug. 26, 1991**

### DESCRIPTION

[52] U.S. Cl. .... **D6/474; D6/397; D6/449**

FIG. 1 is an exploded perspective view of a combination seat unit and furniture support showing my new design;

[58] Field of Search ..... **D6/449, 474, 455, 457, D6/466, 468, 475, 476, 364, 365, 396, 397; 211/13, 163; 248/174, 346**

FIG. 2 is a right front elevational view, the left front being a mirror image thereof;

### [56] References Cited

#### U.S. PATENT DOCUMENTS

- D. 145,950 11/1946 Martino ..... D6/474
- D. 300,489 4/1989 Antonellis ..... D6/449 X

FIG. 3 is a right rear elevational view; the left rear being a mirror image thereof;

FIG. 4 is a top plan view;

FIG. 5 is a bottom plan view of the top portion as shown in FIG. 1; and,

FIG. 6 is a bottom plan view thereof.

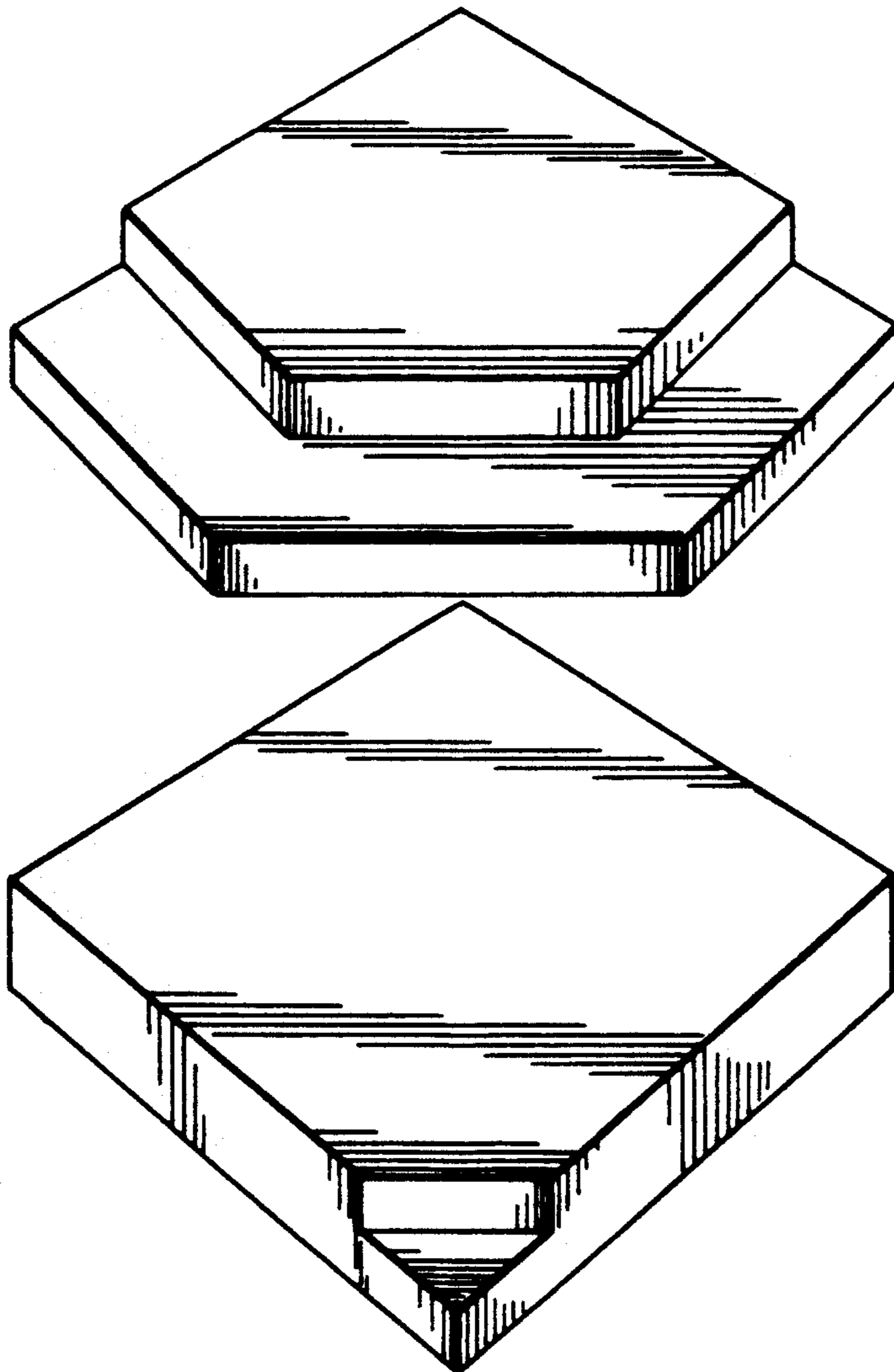

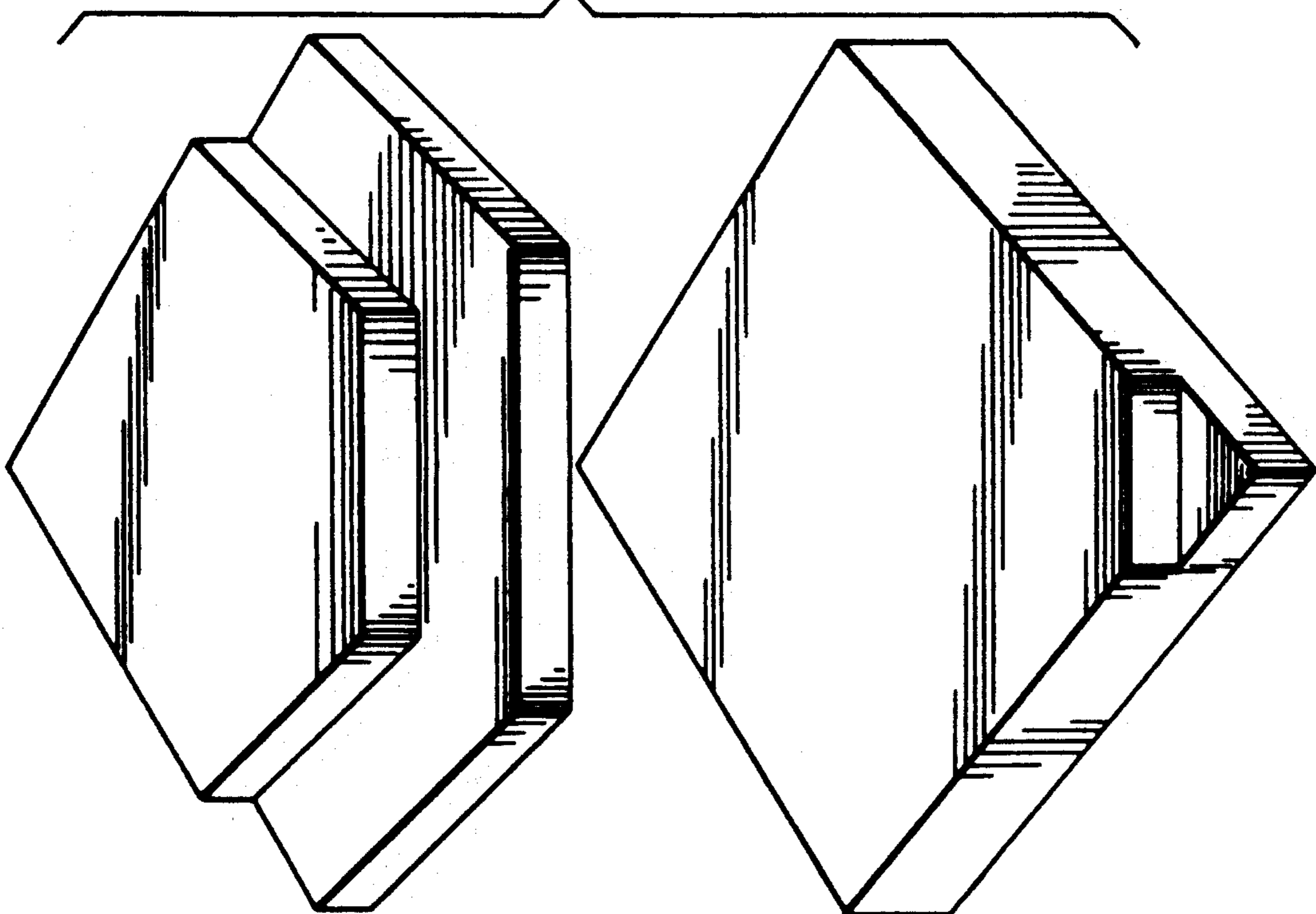

Fig. 1

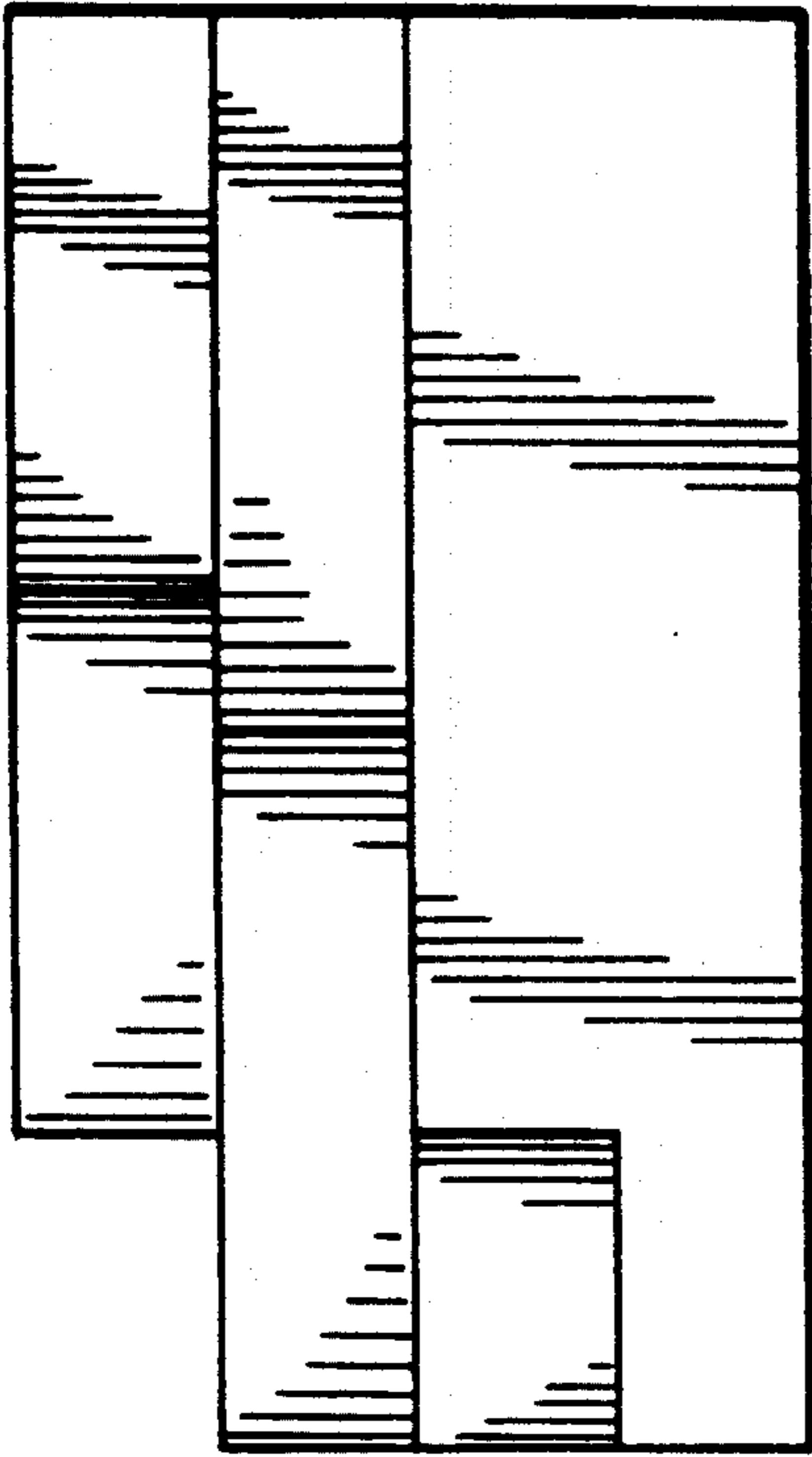

Fig. 2

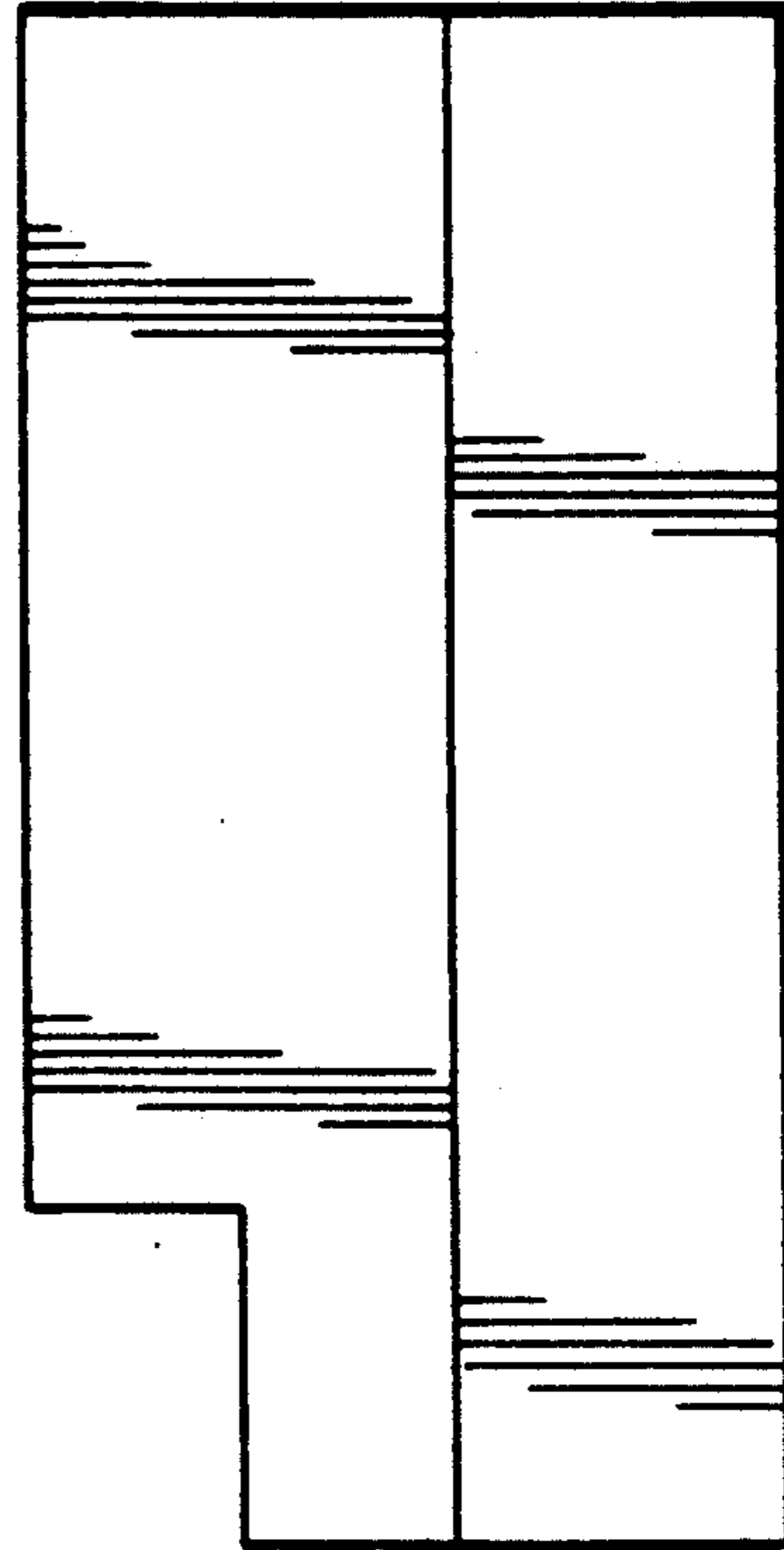

Fig. 3

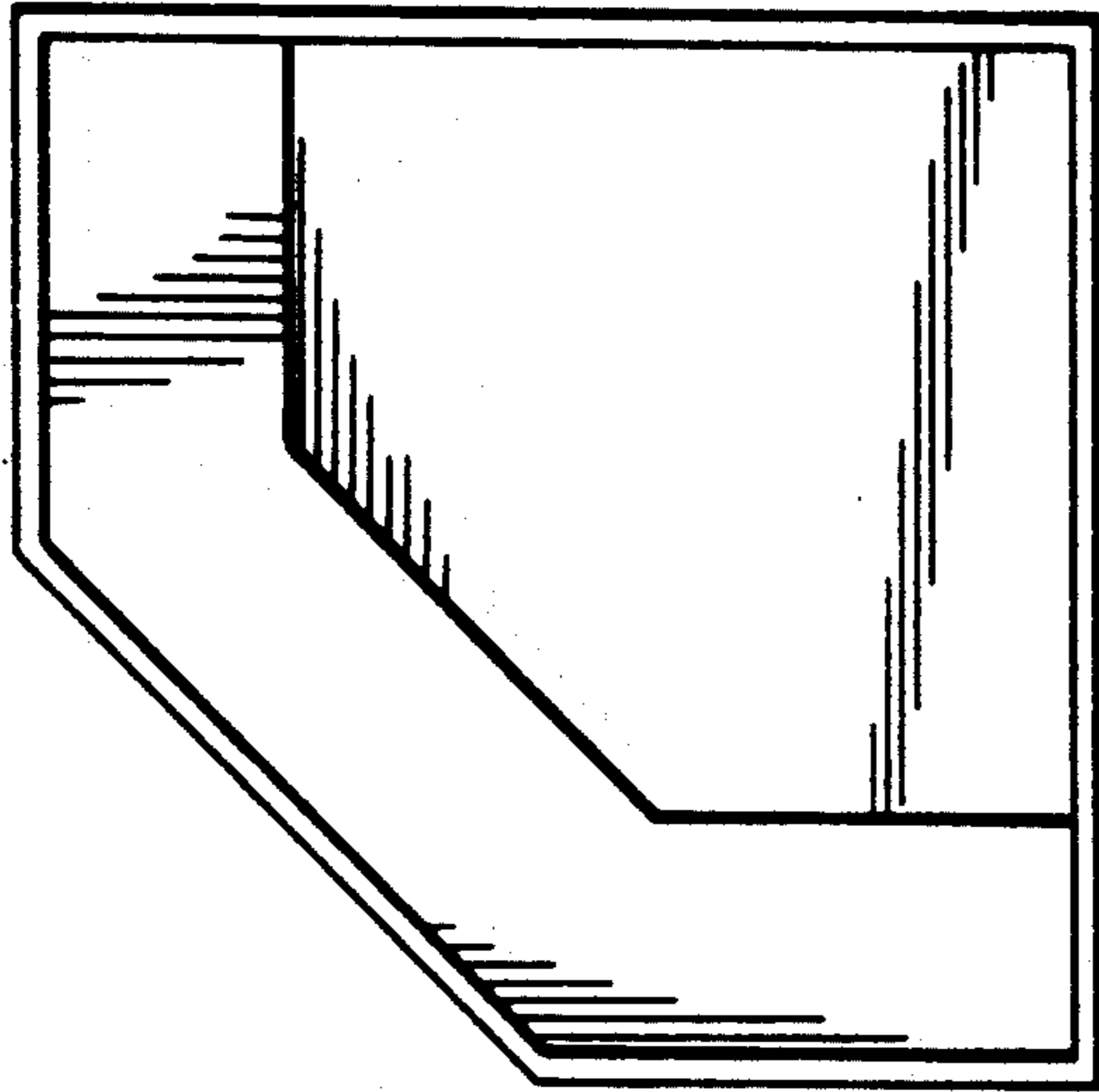

Fig. 5

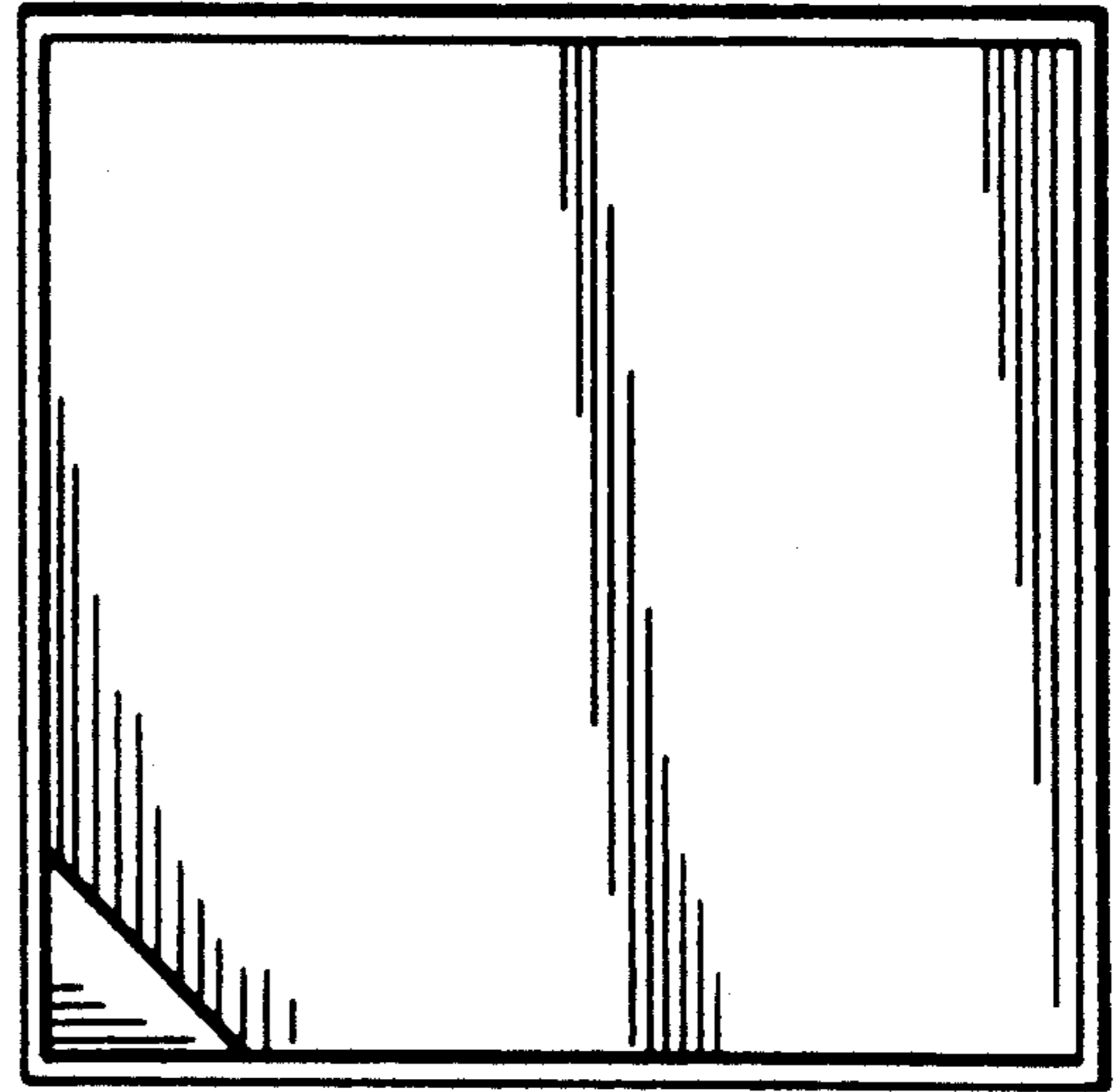

Fig. 6

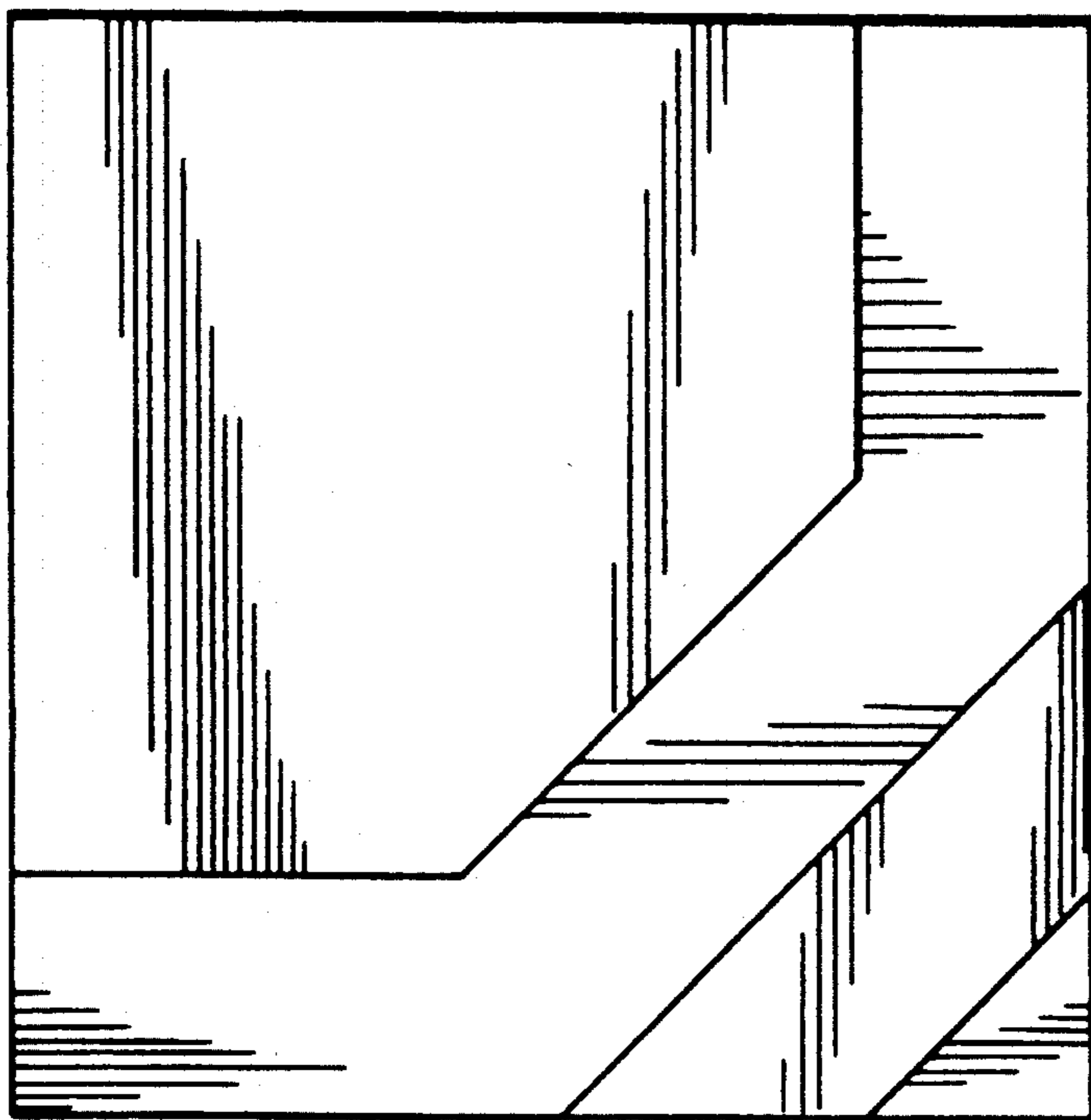

Fig. 4