



US00D335904S

United States Patent [19]

[11] Patent Number: **Des. 335,904**

Krebs

[45] Date of Patent: **** May 25, 1993**

[54] TOY HOUSE

[75] Inventor: **T. A. Krebs, Englewood, Fla.**

[73] Assignee: **Brown Box Too, Inc., Englewood, Fla.**

[**] Term: **14 Years**

[21] Appl. No.: **754,694**

[22] Filed: **Sep. 26, 1991**

[52] U.S. Cl. **D21/114**

[58] Field of Search **D21/108, 114, 115, 242; D25/7, 16, 59; D6/335, 446/110, 476, 477, 478, 482, 487**

D. 251,265	3/1979	Shorten	D21/114
D. 326,689	6/1992	Farinelli	D21/114
4,946,414	8/1990	Zimmer	446/110
5,011,446	4/1991	Feinberg	446/476

Primary Examiner—Bernard Ansher
Assistant Examiner—R. Barkai
Attorney, Agent, or Firm—Charles J. Prescott

[57] CLAIM

The ornamental design for a toy house, as shown and described.

DESCRIPTION

FIG. 1 is a perspective view of a toy house showing my new design;
FIG. 2 is a right side elevational view thereof;
FIG. 3 is a left side elevational view thereof;
FIG. 4 is a front elevational view thereof;
FIG. 5 is a rear elevational view thereof; and,
FIG. 6 is a top plan view thereof.

[56] References Cited

U.S. PATENT DOCUMENTS

D. 43,949	4/1913	Thayer	D21/114
D. 55,485	6/1920	Payne	D21/114
D. 245,639	8/1977	Powell	D21/114

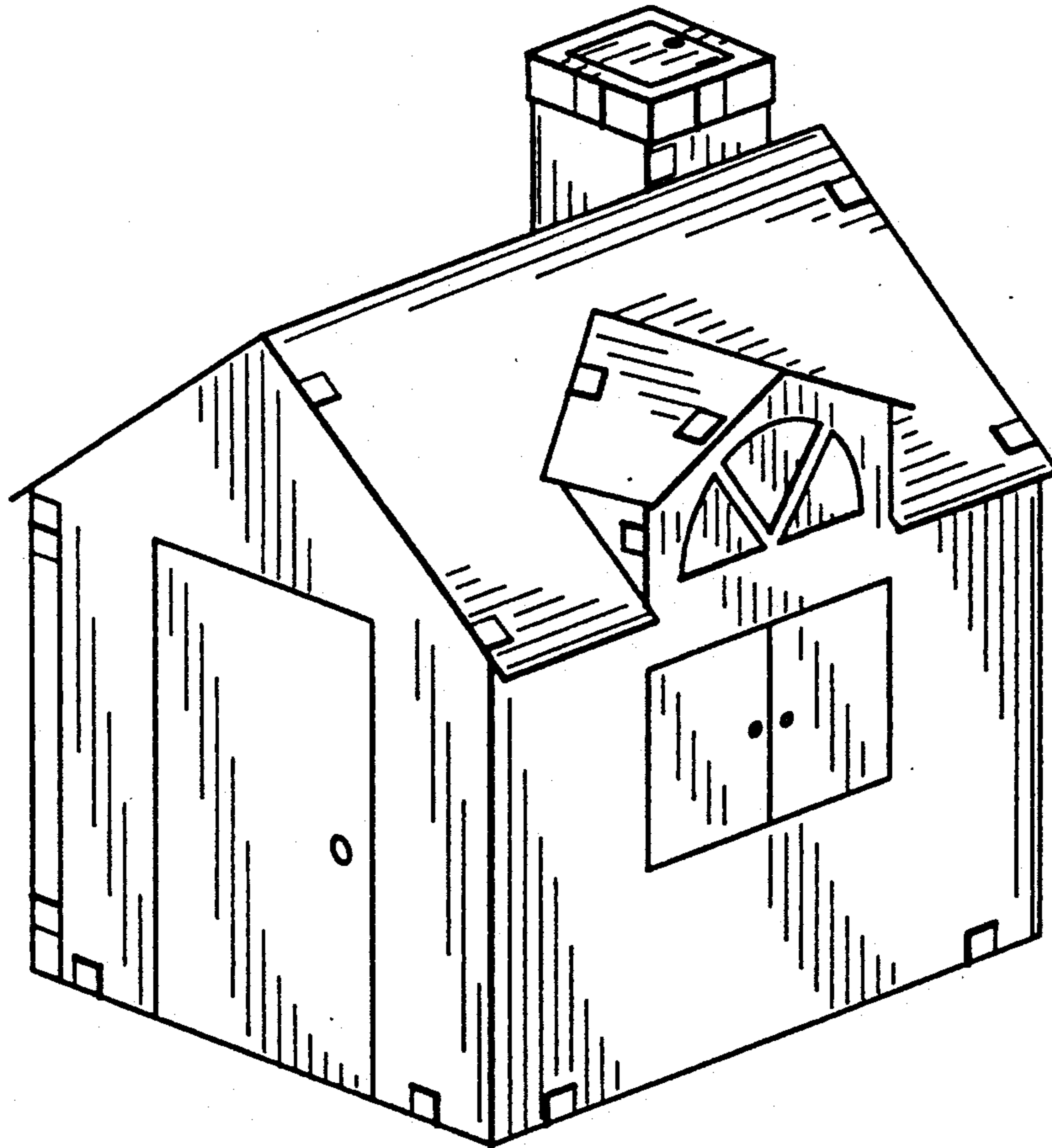

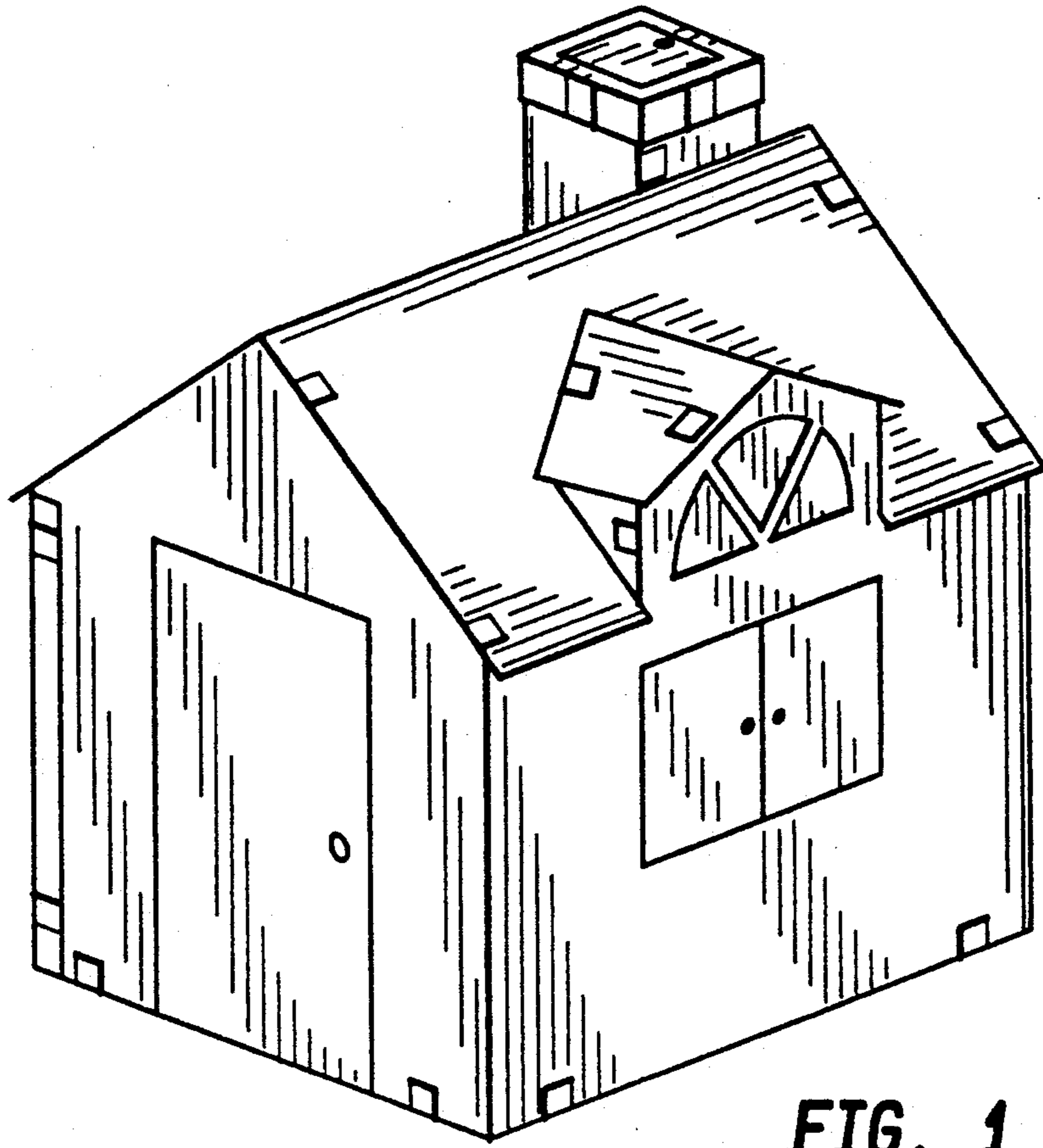

FIG. 1

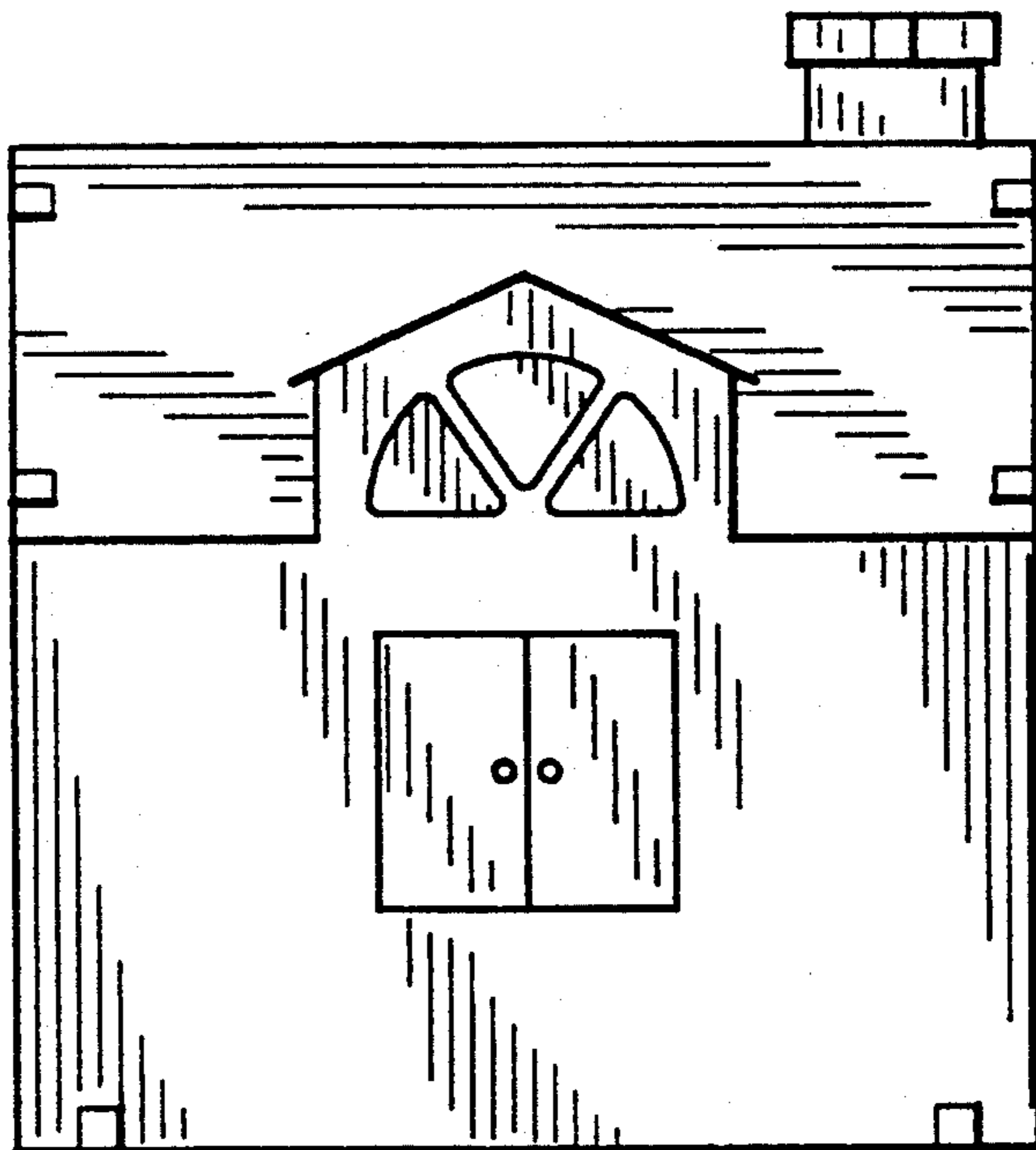

FIG. 2

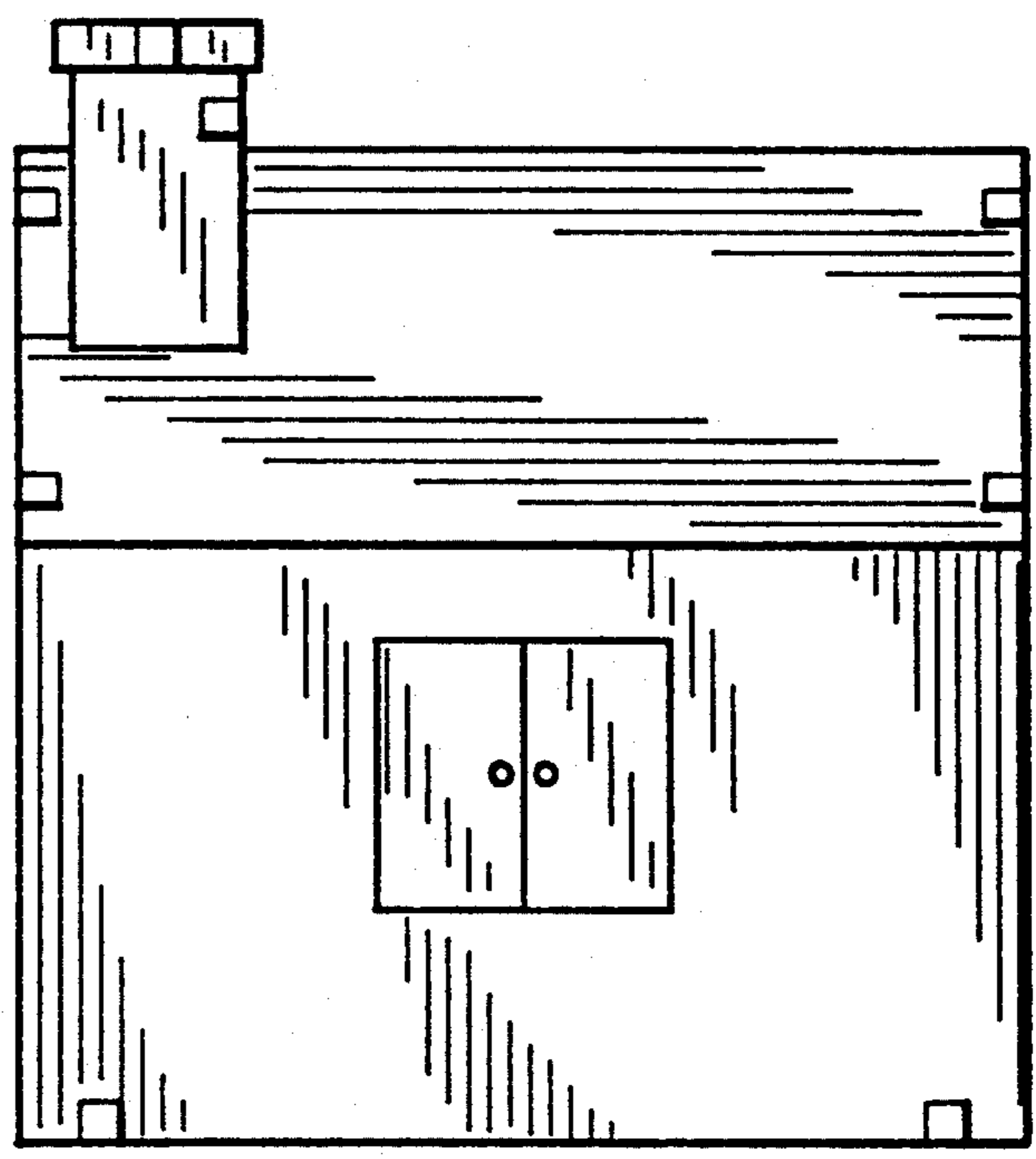

FIG. 3

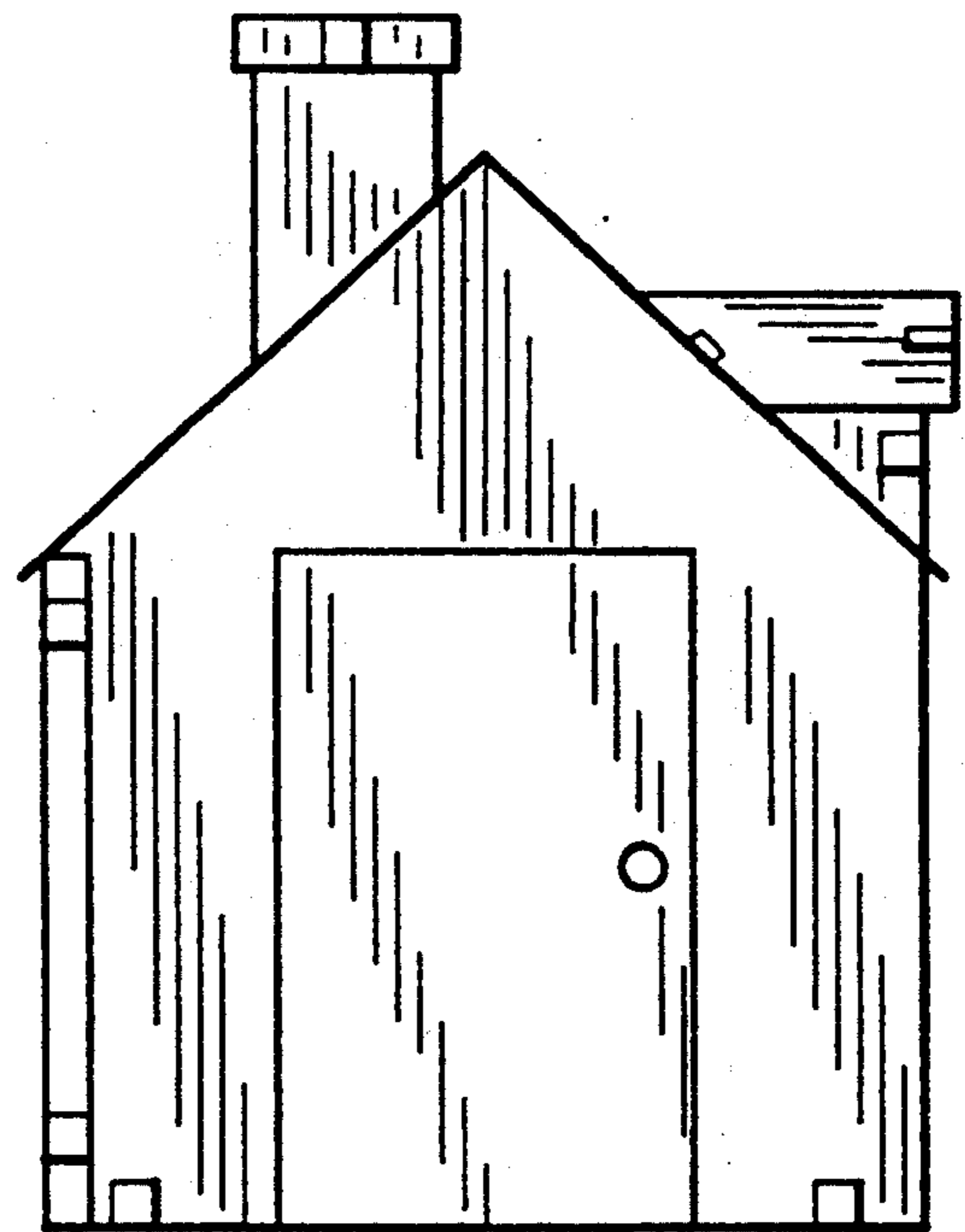

FIG. 4

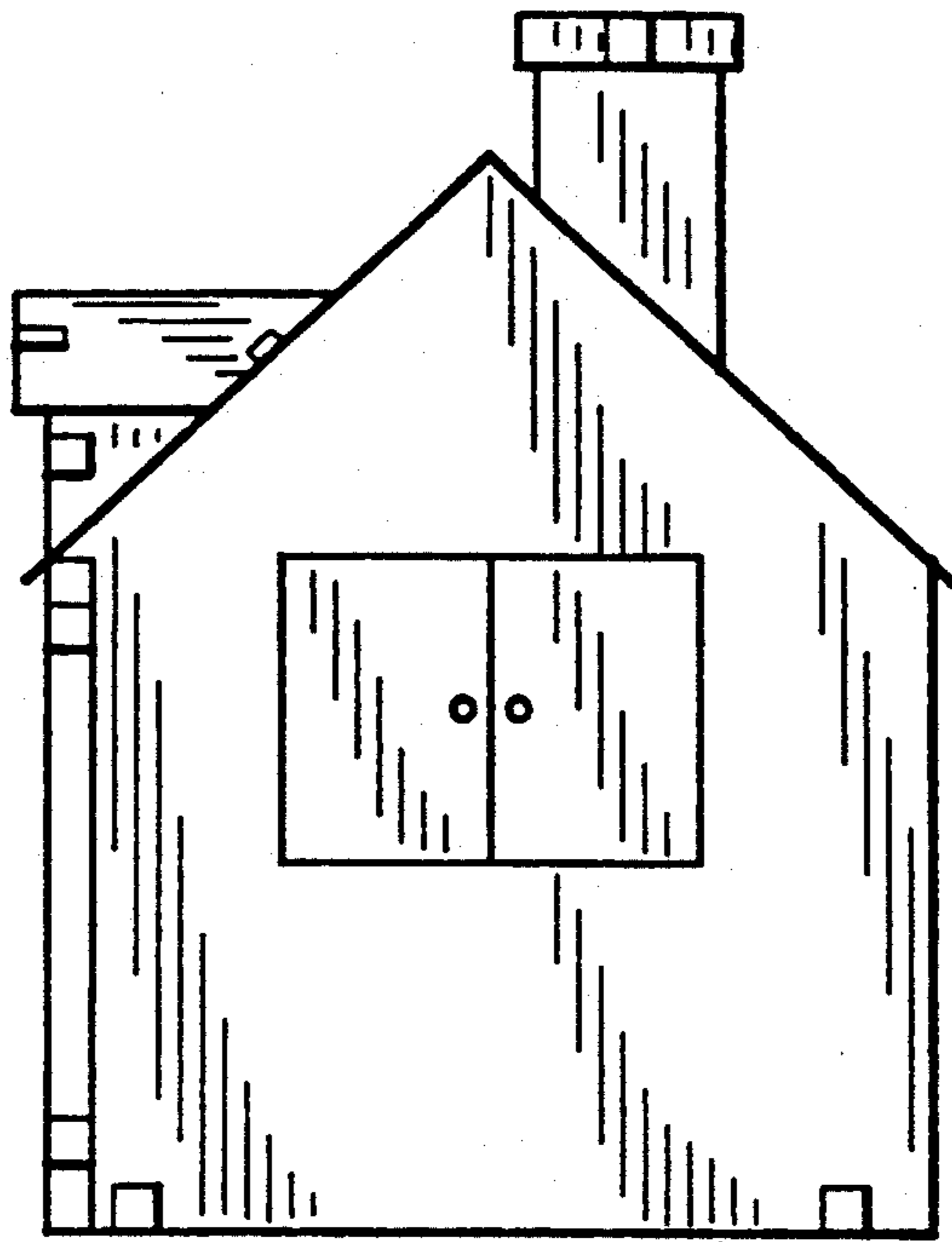

FIG. 5

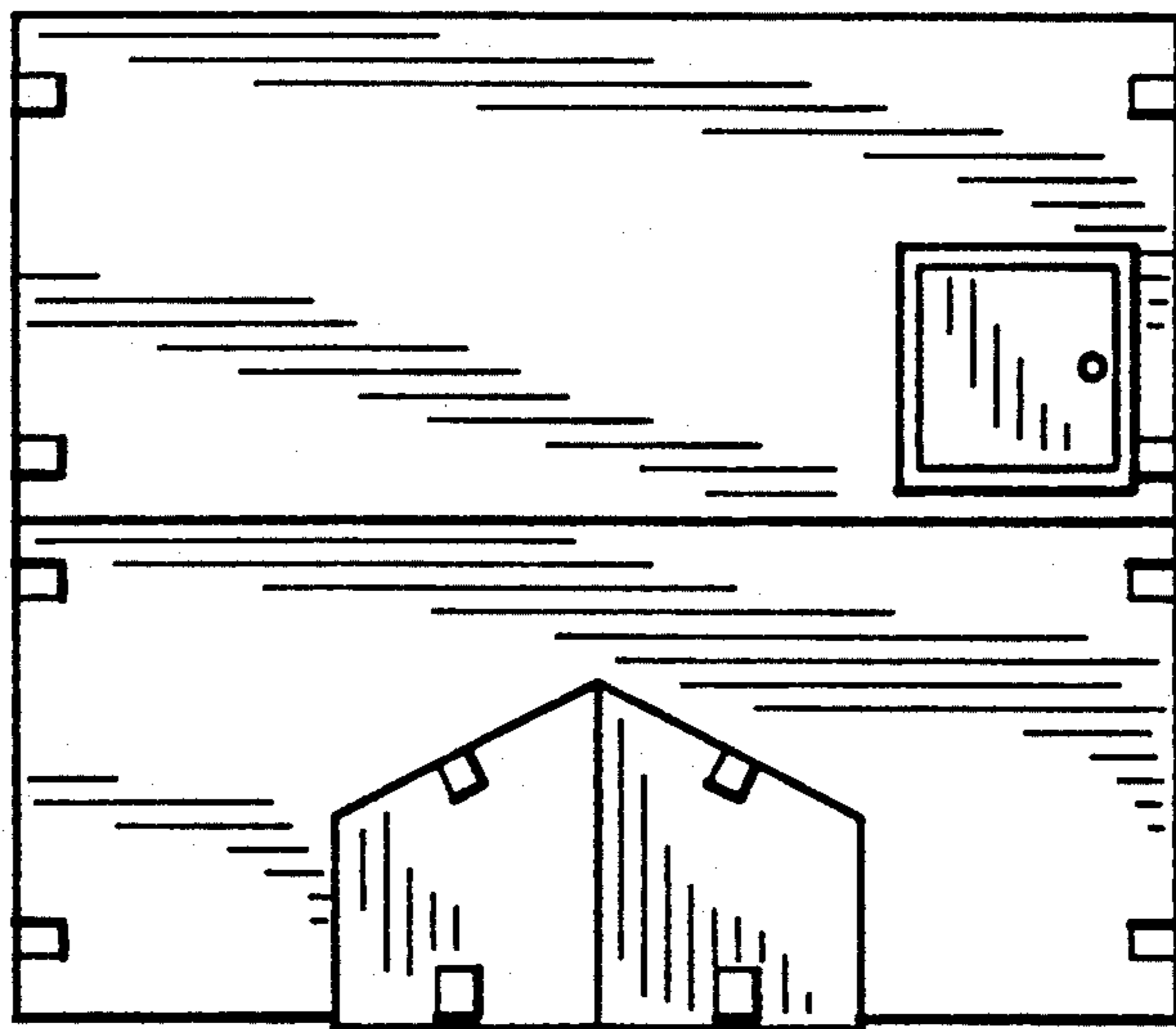

FIG. 6