



US00D334738S

# United States Patent [19]

[11] Patent Number: **Des. 334,738**

**Kim**

[45] Date of Patent: **\*\* Apr. 13, 1993**

[54] **LAP TOP COMPUTER**  
[75] Inventor: **Gyu C. Kim**, Yongin-gun, Rep. of Korea

D. 313,403 1/1991 Esslinger et al. .... D14/106  
D. 314,558 2/1991 Iino ..... D14/106  
D. 317,443 6/1991 Wilson et al. .... D14/106  
D. 324,855 3/1992 Iino ..... D14/106

[73] Assignee: **Samsung Electronics Co., Ltd.**,  
Kyunggi-do, Rep. of Korea

*Primary Examiner*—Wallace R. Burke  
*Assistant Examiner*—Freda S. Nunn  
*Attorney, Agent, or Firm*—Cushman, Darby & Cushman

[\*\*] Term: **14 Years**

### [57] CLAIM

[21] Appl. No.: **554,847**

The ornamental design for a lap top computer, as shown and described.

[22] Filed: **Jul. 19, 1990**

### [30] Foreign Application Priority Data

### DESCRIPTION

Apr. 25, 1990 [KR] Rep. of Korea ..... 90-5623

[52] U.S. Cl. .... **D14/106; D14/113**

[58] Field of Search ..... D14/100, 101, 106, 113,  
D14/115; D18/1, 7; 235/145 A, 145 R;  
340/700, 706, 711, 712; 341/22, 23;  
364/706-708; 361/390

FIG. 1 is a top front and right side perspective view of a lap top computer showing my new design in an opened condition;

FIG. 2 is a top plan view thereof;

FIG. 3 is a front elevational view thereof;

FIG. 4 is a bottom plan view thereof;

FIG. 5 is a rear elevational view thereof;

FIG. 6 is a right side elevational view thereof;

FIG. 7 is a left side elevational view thereof; and,

FIG. 8 is a perspective view thereof in a closed condition.

### [56] References Cited

#### U.S. PATENT DOCUMENTS

D. 310,517 9/1990 Hara et al. .... D14/106  
D. 311,527 10/1990 Fujii et al. .... D14/106

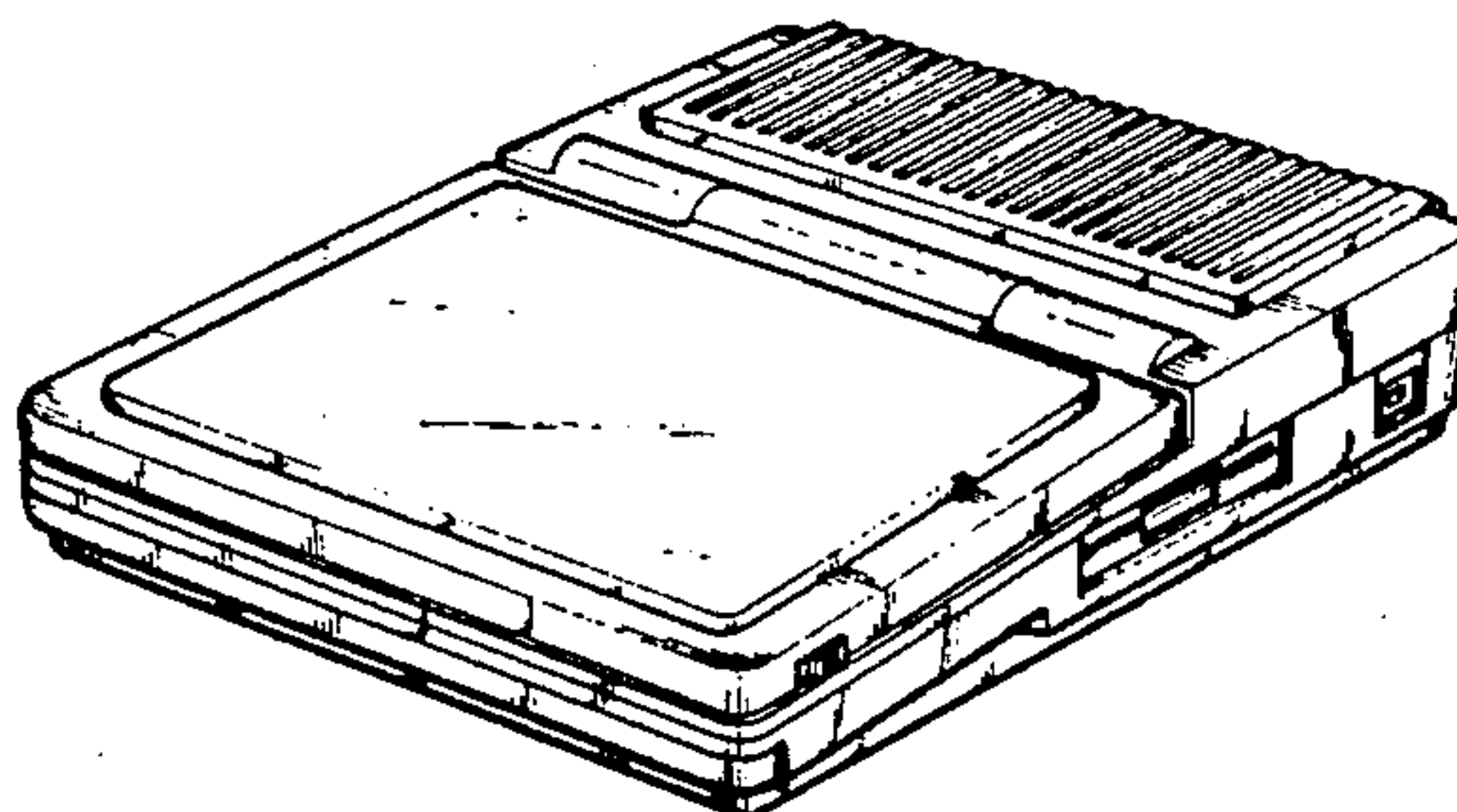
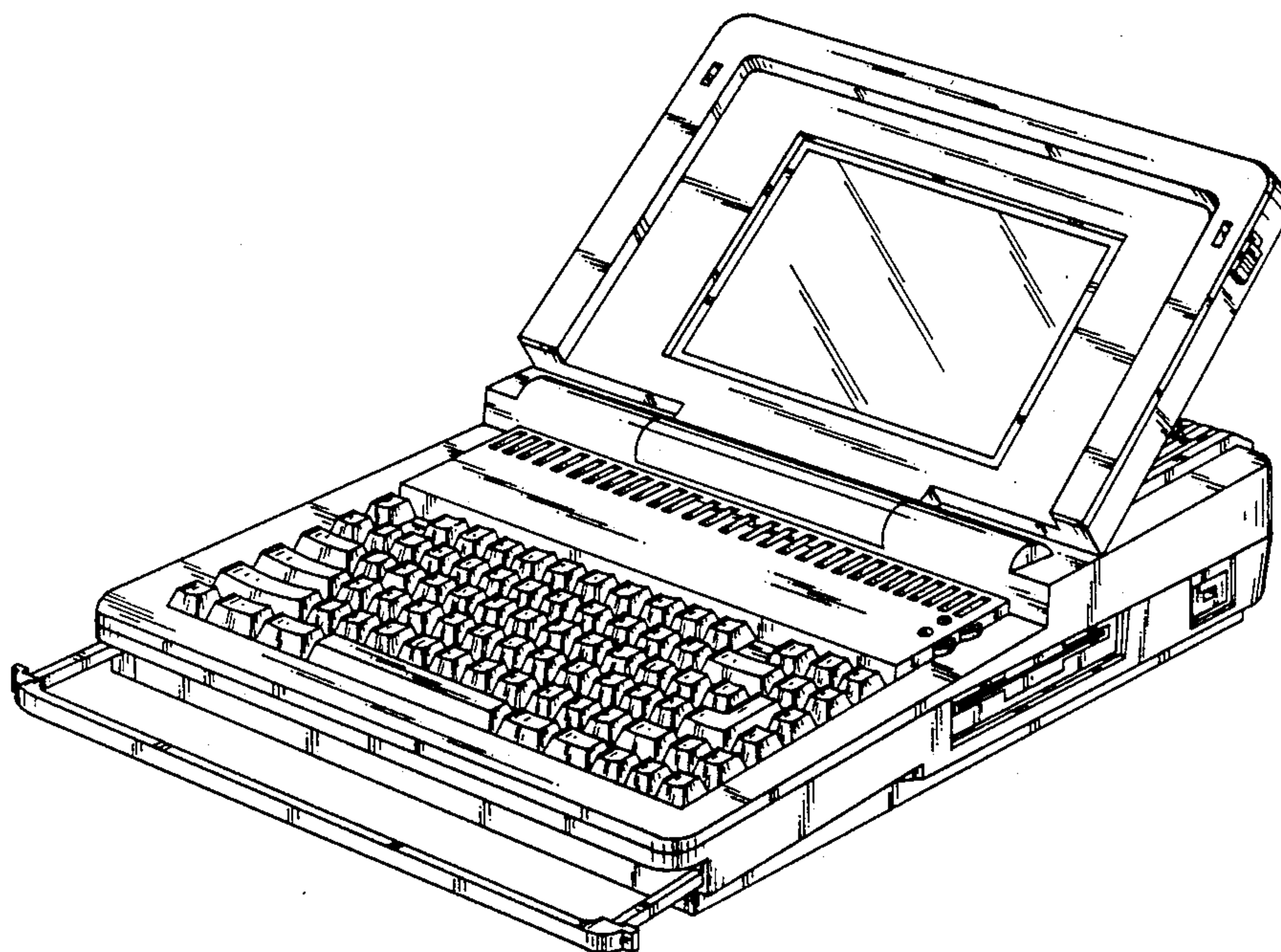

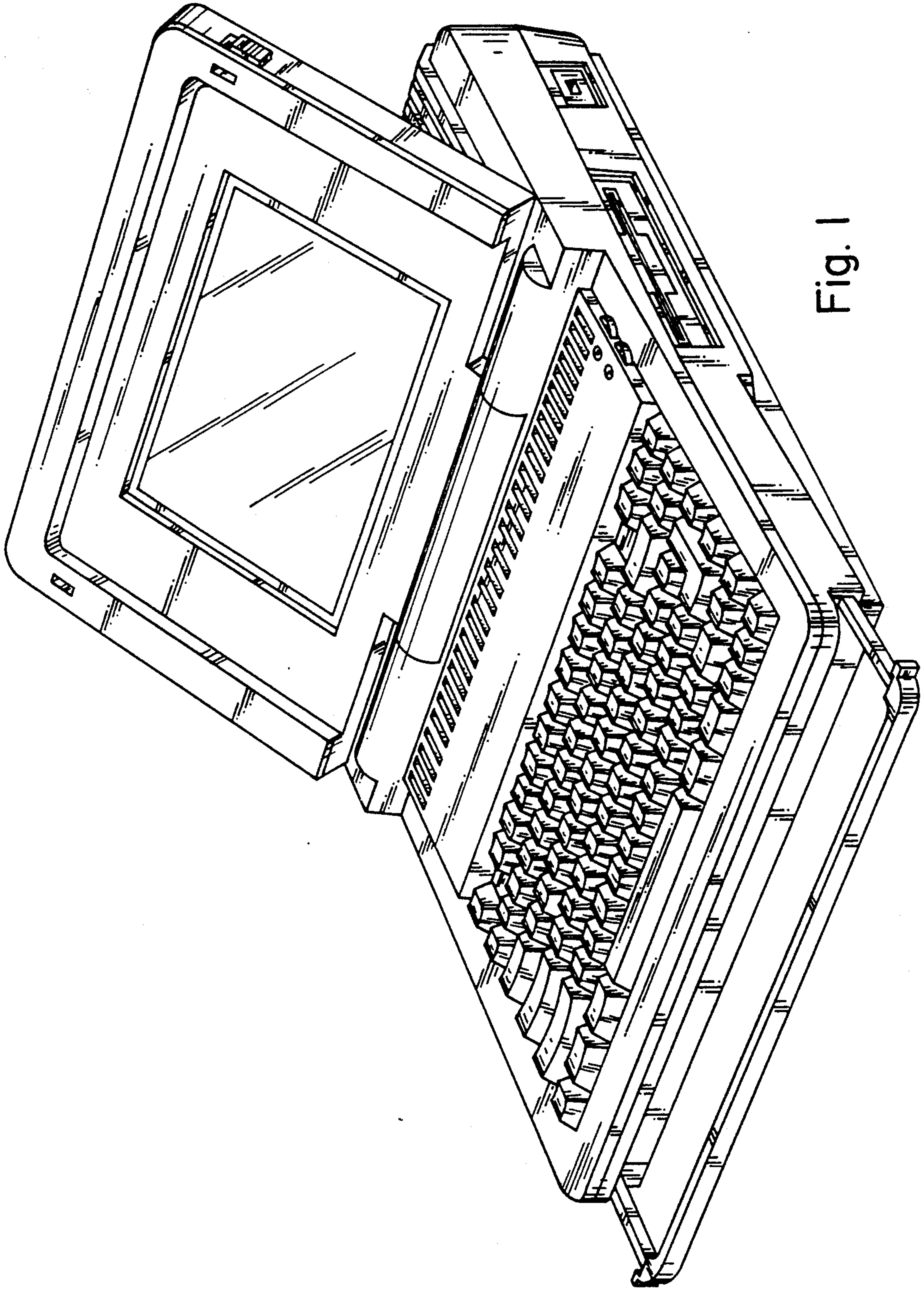

Fig. 1



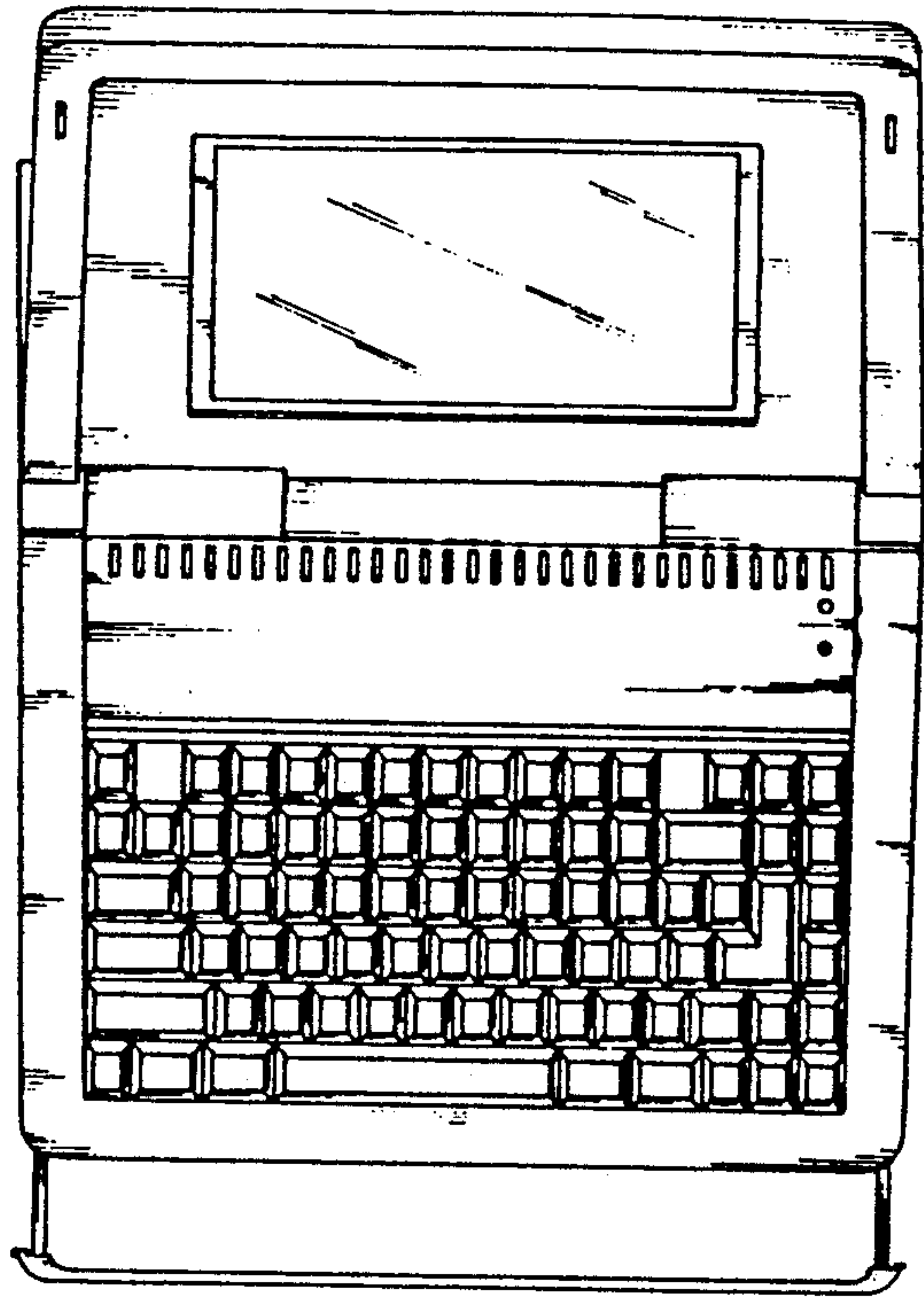

Fig. 2

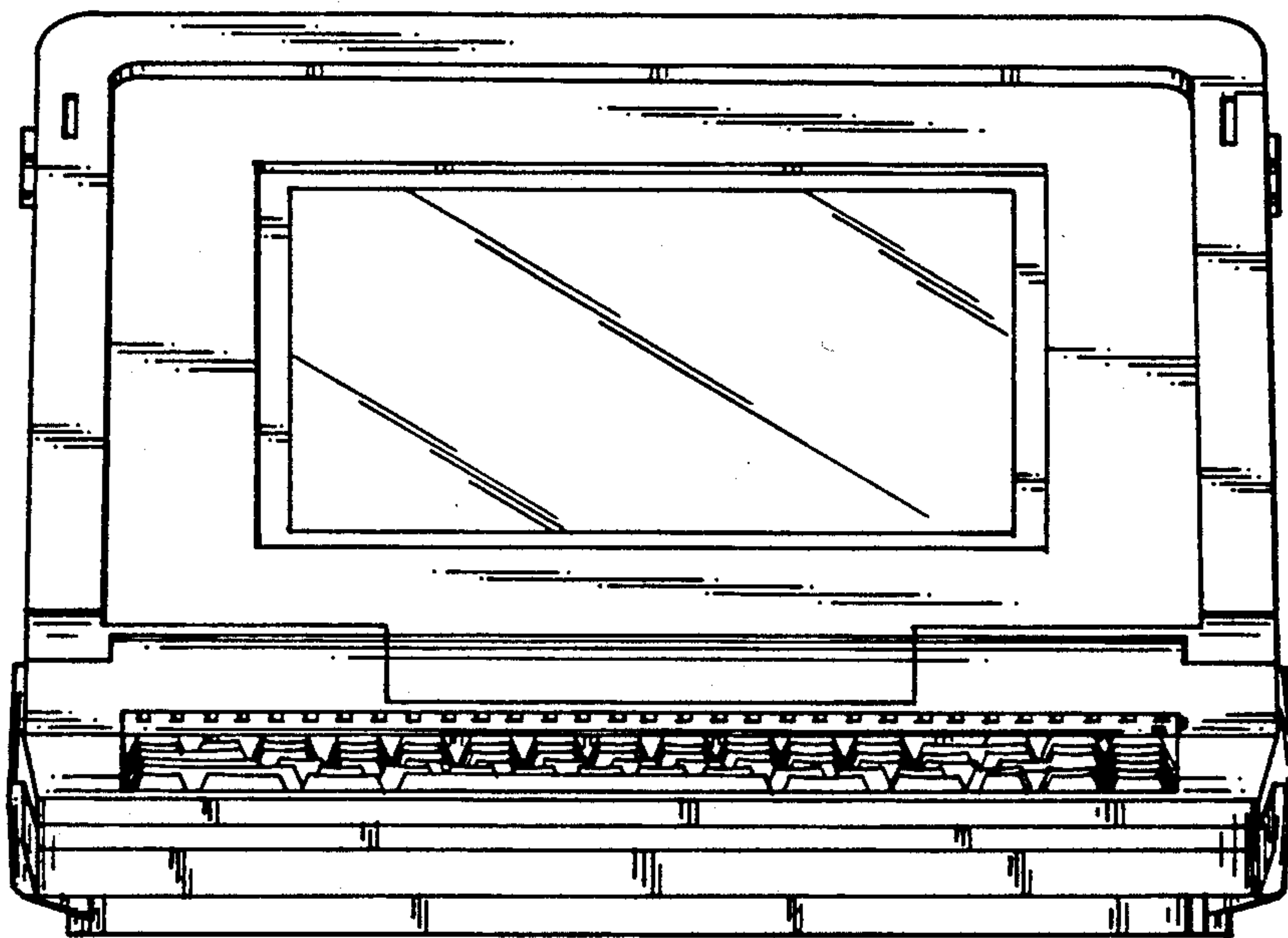

Fig. 3

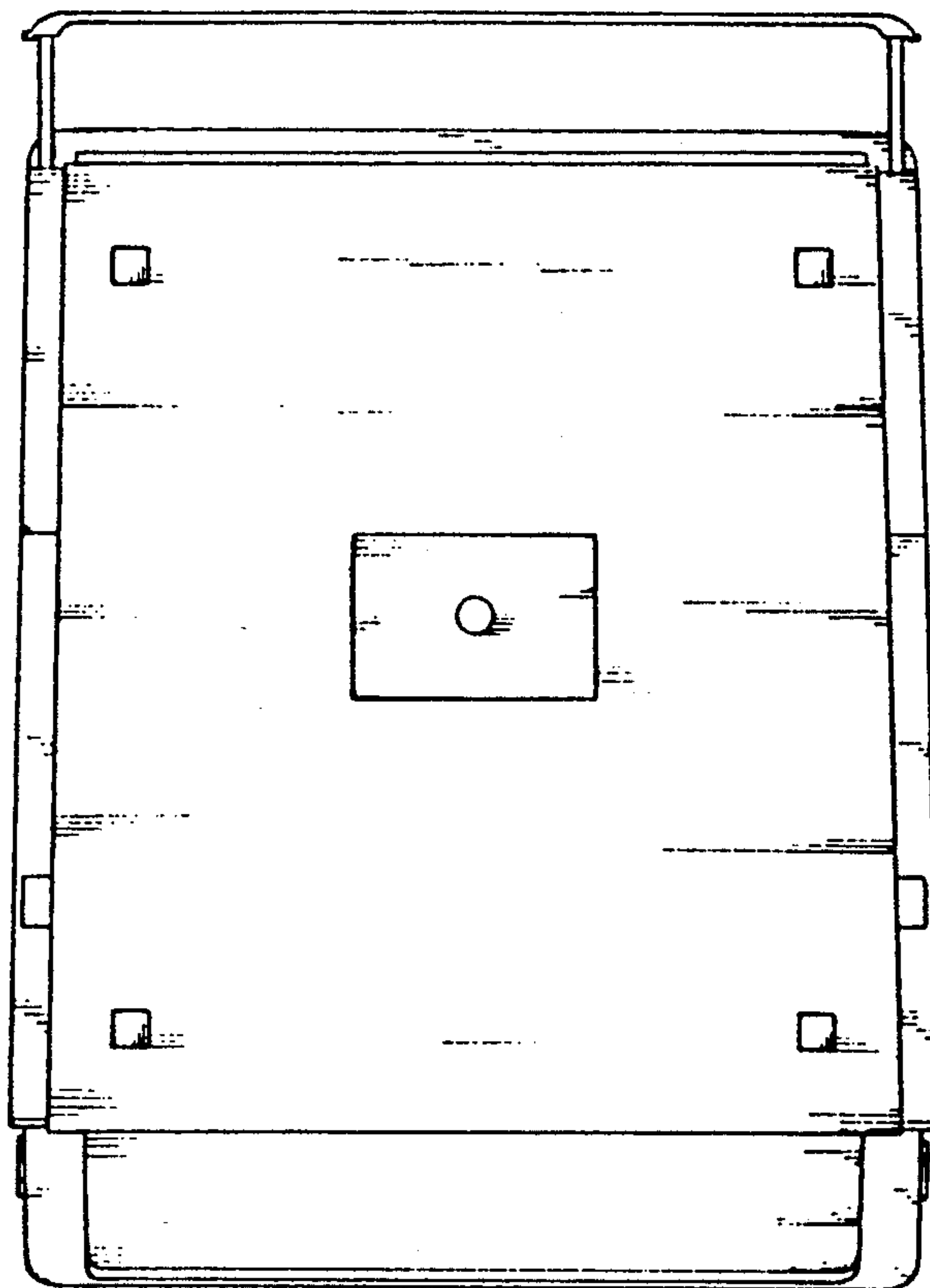

Fig. 4

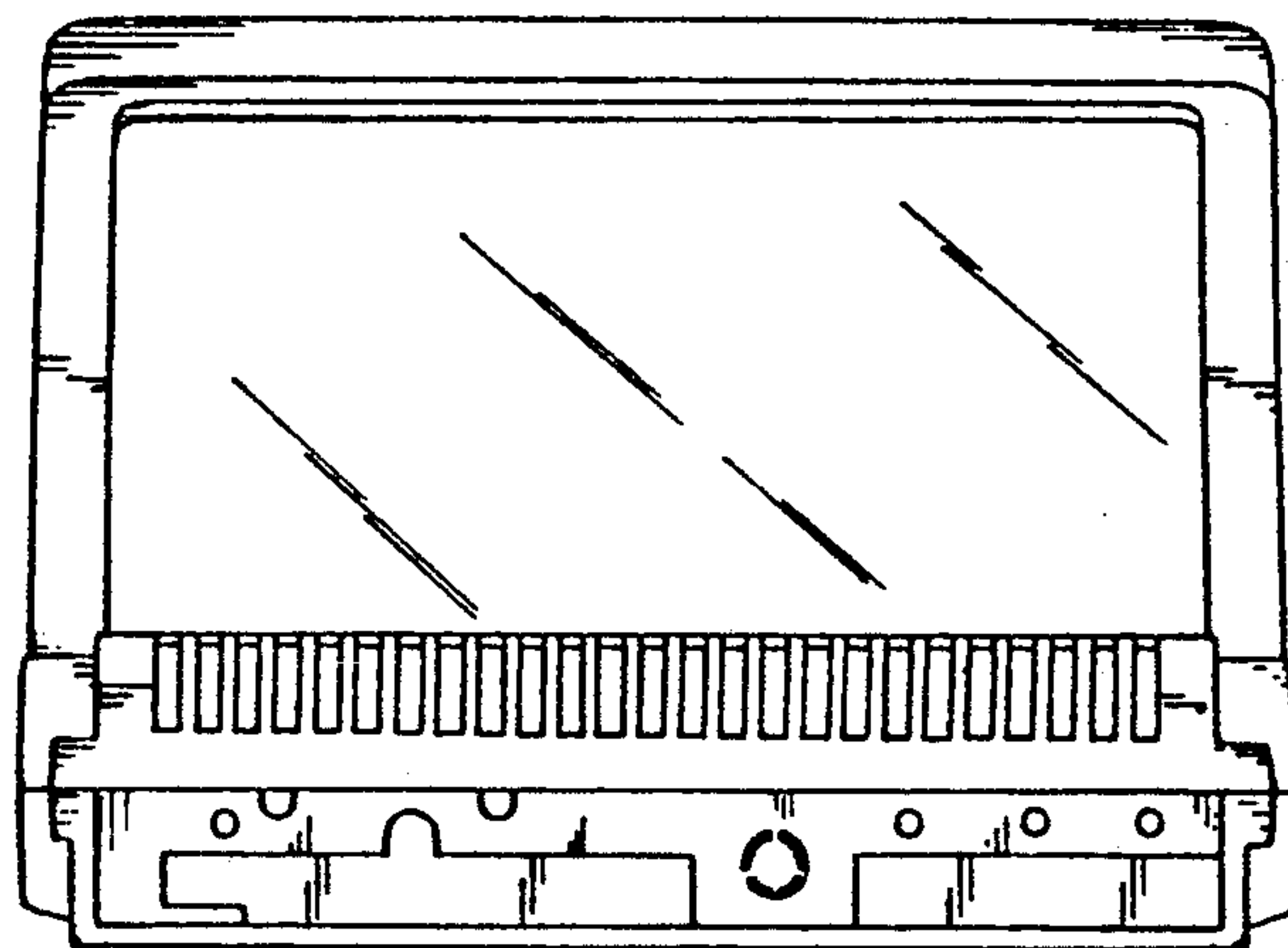

Fig. 5

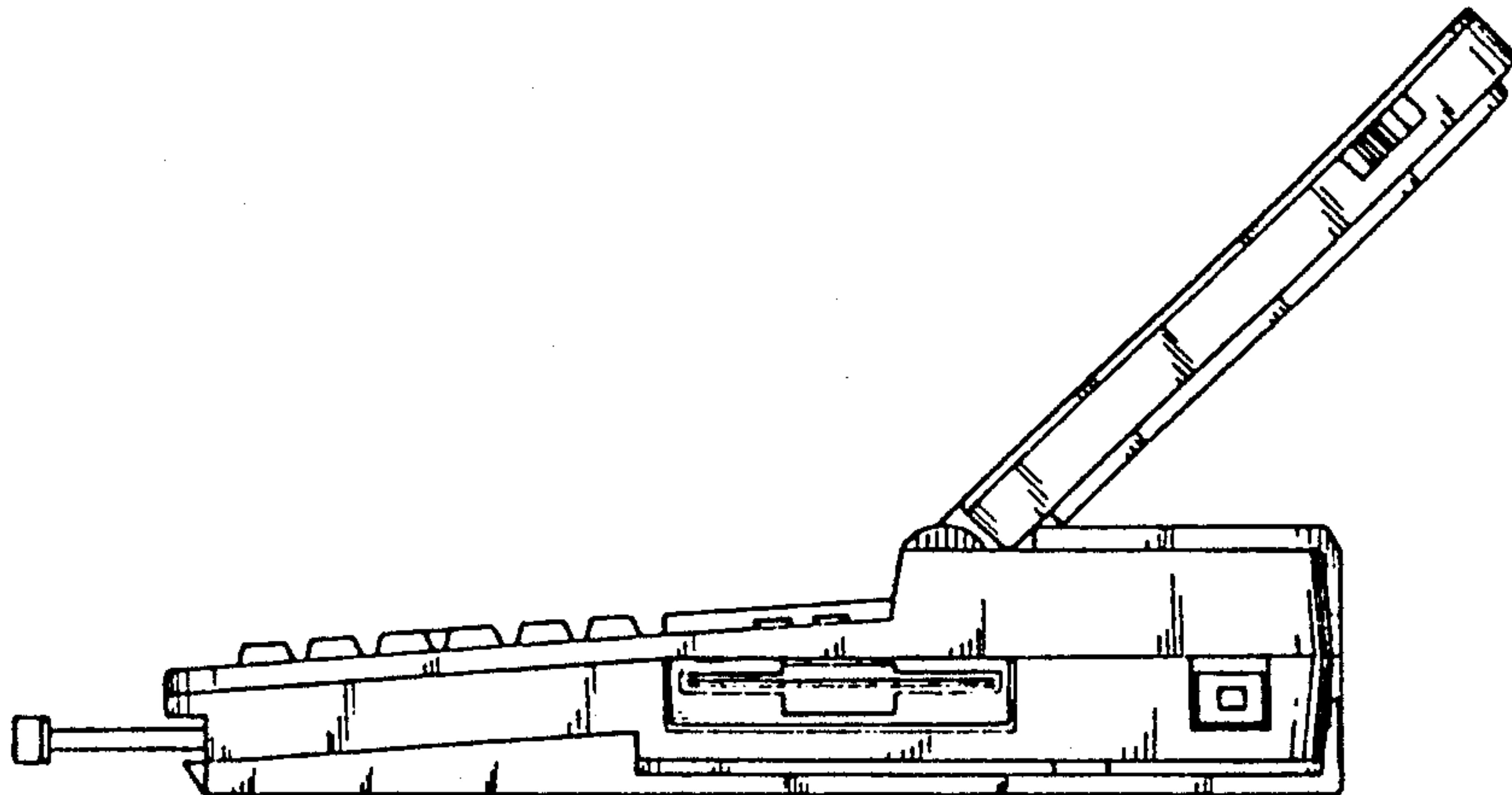

Fig. 6

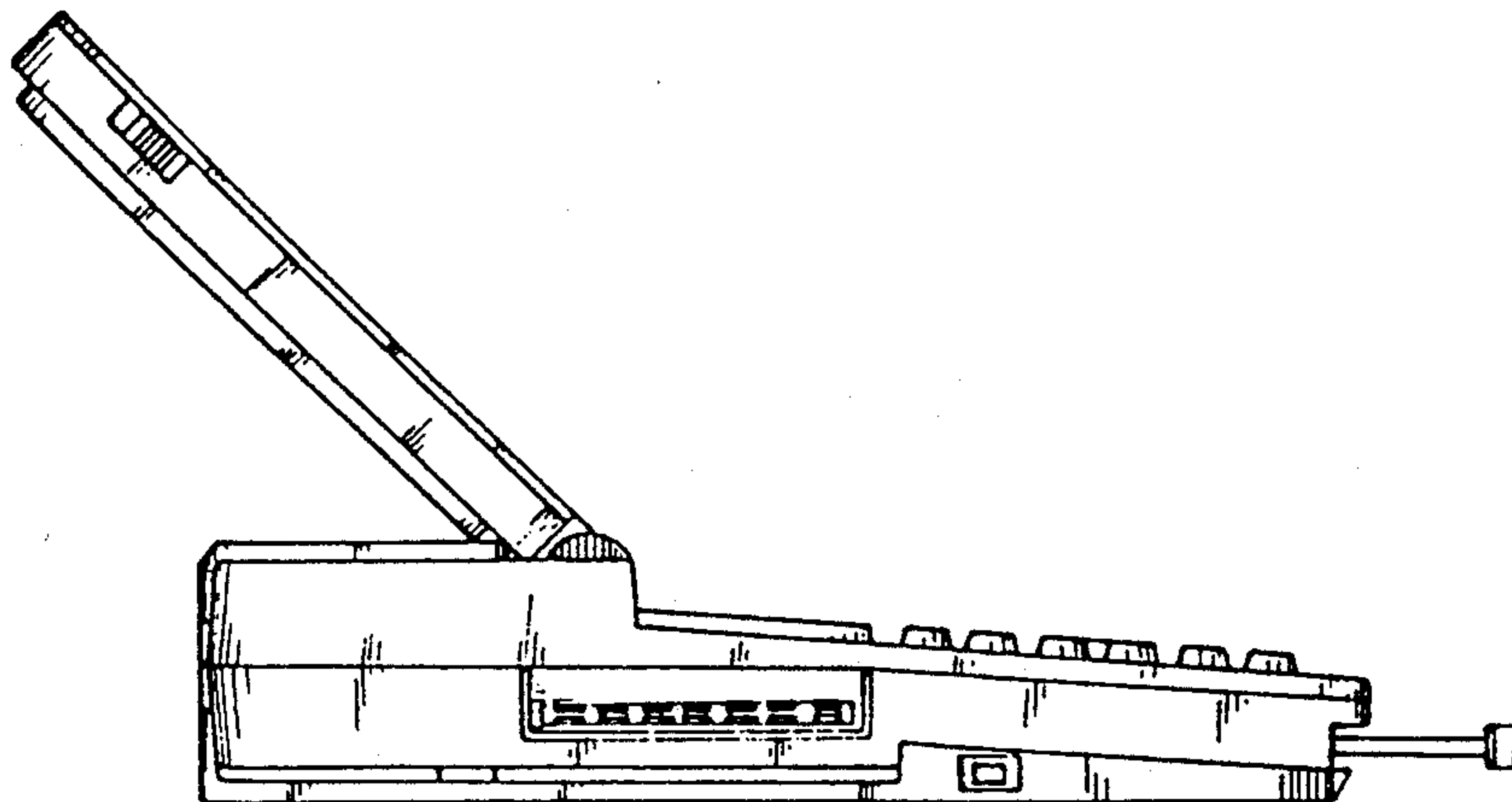

Fig. 7

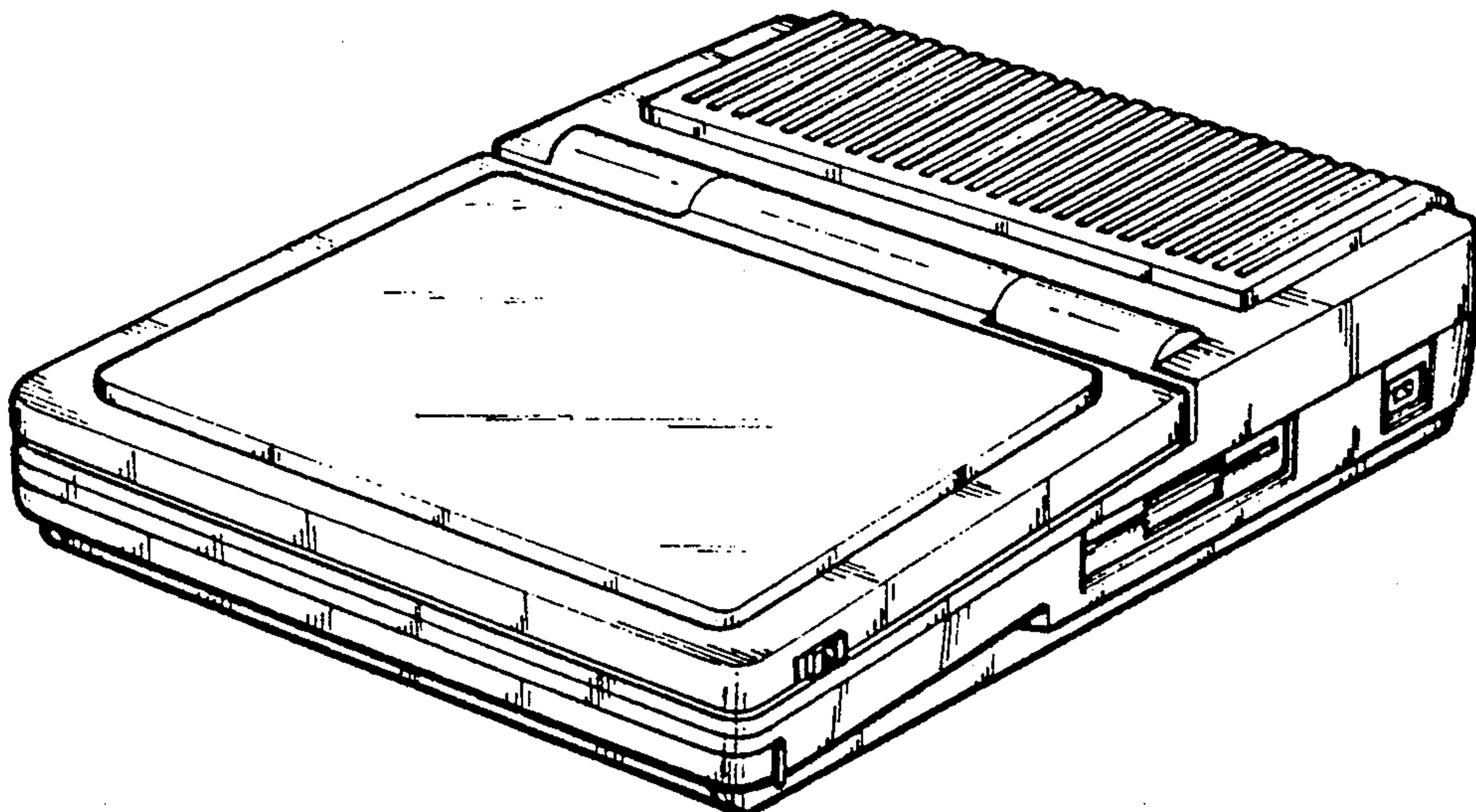

Fig. 8