



US00D331930S

United States Patent [19]

Whetsel

[11] Patent Number: Des. 331,930

[45] Date of Patent: ** Dec. 22, 1992

[54] CUTTING HEAD ASSEMBLY FOR A LINE TRIMMER

[75] Inventor: James R. Whetsel, Kankakee, Ill.

[73] Assignee: Inertia Dynamics Corporation,
Chandler, Ariz.

[**] Term: 14 Years

[21] Appl. No.: 544,482

[22] Filed: Jun. 27, 1990

[52] U.S. Cl. D15/16

[58] Field of Search D15/10-13,
D15/14, 16; 30/276, 390, DIG. 5; 56/12.7, 239,
249, 255, 289, 295

[56] References Cited

U.S. PATENT DOCUMENTS

D. 290,365	6/1987	Hatano et al.	D15/10
4,285,128	8/1981	Schnell et al.	56/295
4,584,771	4/1986	Tillotson	56/12.7
4,756,148	7/1988	Gander et al.	56/12.7
4,852,258	8/1989	Foster	30/276
4,860,451	8/1989	Pilztowicz et al.	56/12.7
4,916,886	4/1990	Nakamura et al.	30/276

OTHER PUBLICATIONS

Lawn-boy ©1987 p. 10 trimmer, bottom left.

Toro ©1988 p. 16 trimmer, bottom right.

Primary Examiner—Bernard Ansher

Assistant Examiner—Sandra Morris

Attorney, Agent, or Firm—Brooks & Kushman

[57] CLAIM

The ornamental design for a cutting head assembly for a line trimmer, as shown and described.

DESCRIPTION

FIG. 1 is a perspective view of a cutting head assembly for a line trimmer, showing my new design, the broken line showing the housing is for illustrative purposes only, and forms no part of the claimed design;

FIG. 2 is an enlarged left side elevational view thereof;

FIG. 3 is an enlarged top plan view thereof;

FIG. 4 is an enlarged front elevational view thereof;

FIG. 5 is an enlarged rear elevational view thereof;

FIG. 6 is an enlarged right side elevational view thereof; and,

FIG. 7 is an enlarged bottom plan view thereof.

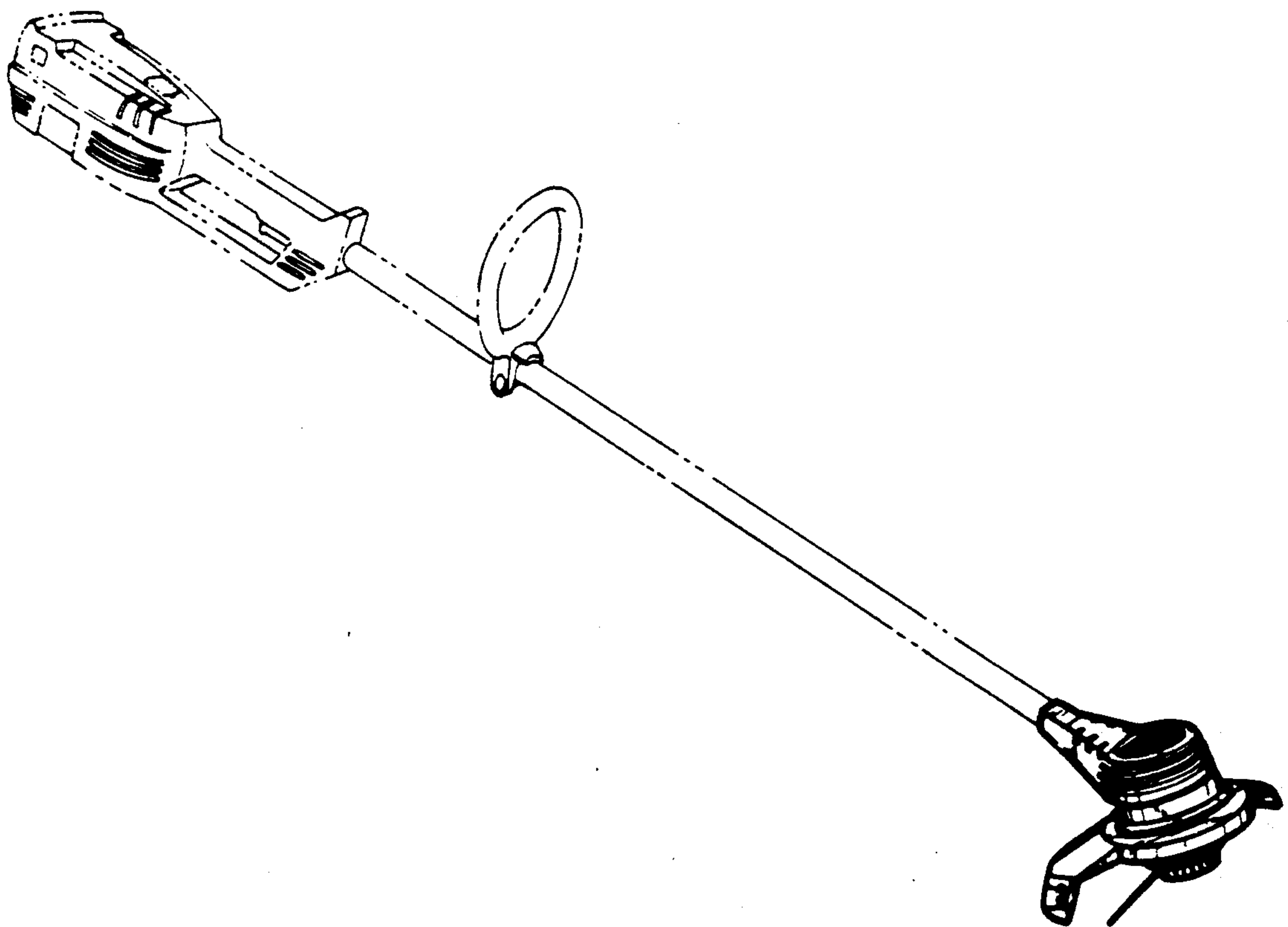

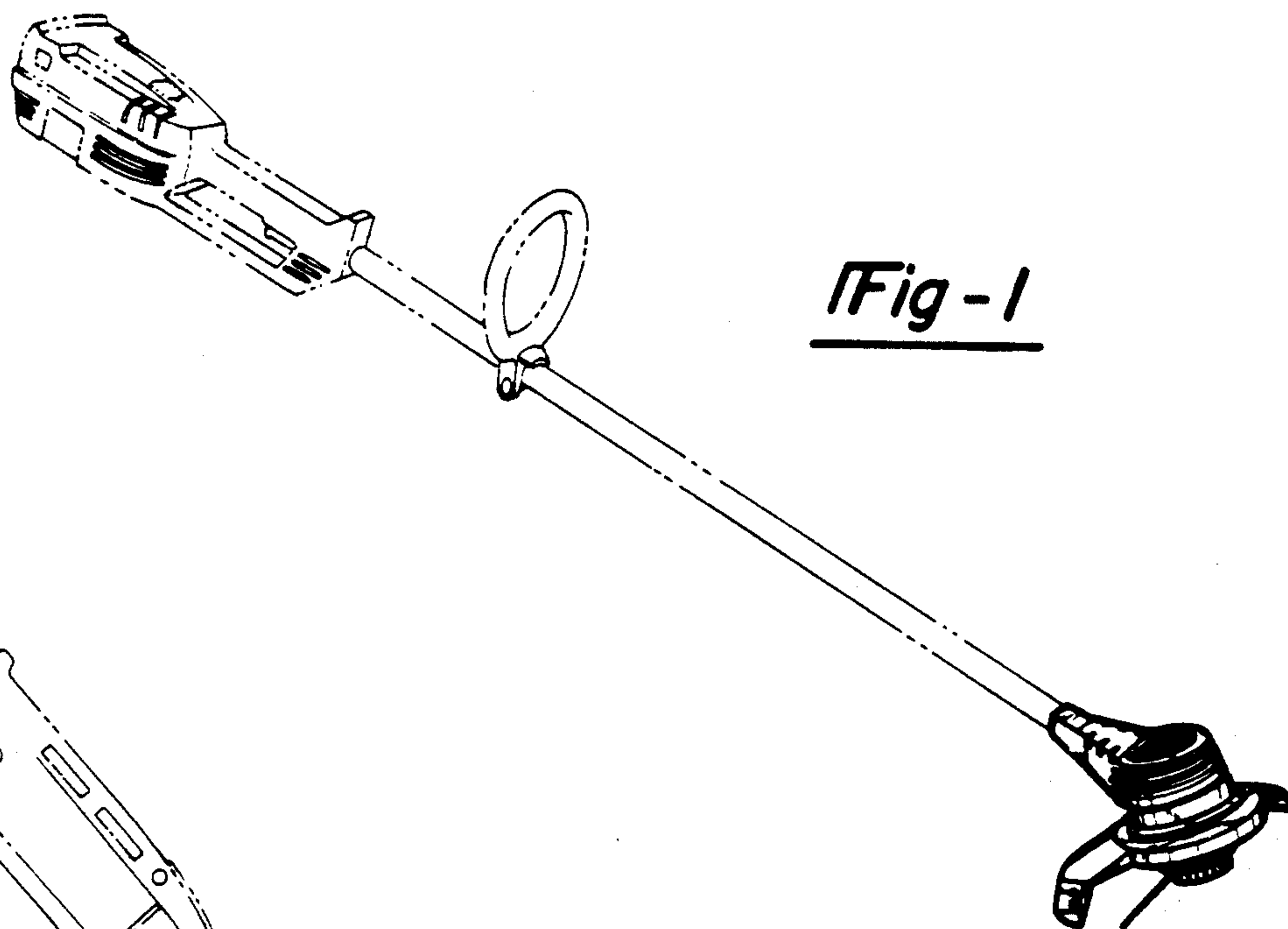

Fig-1

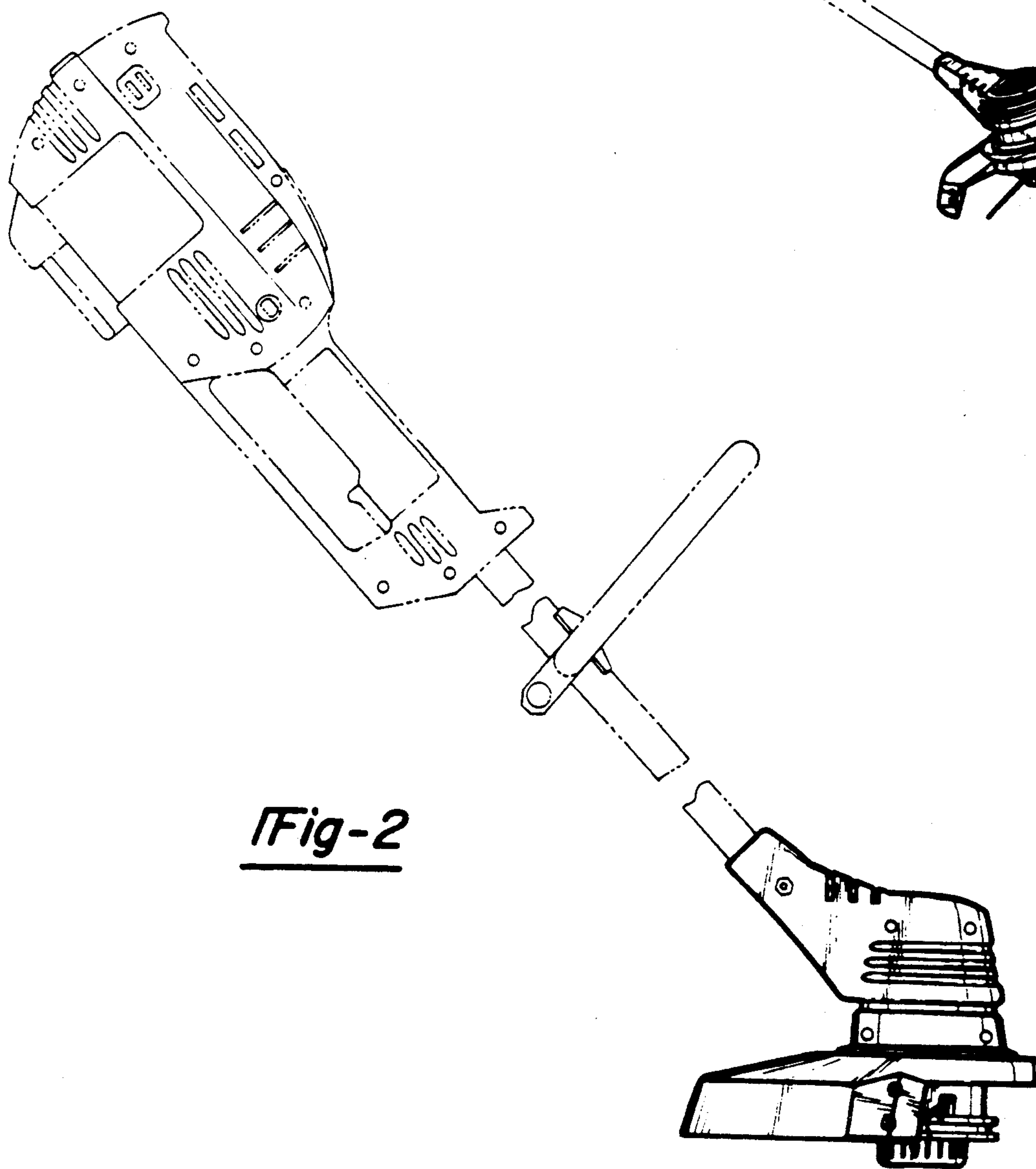

Fig-2

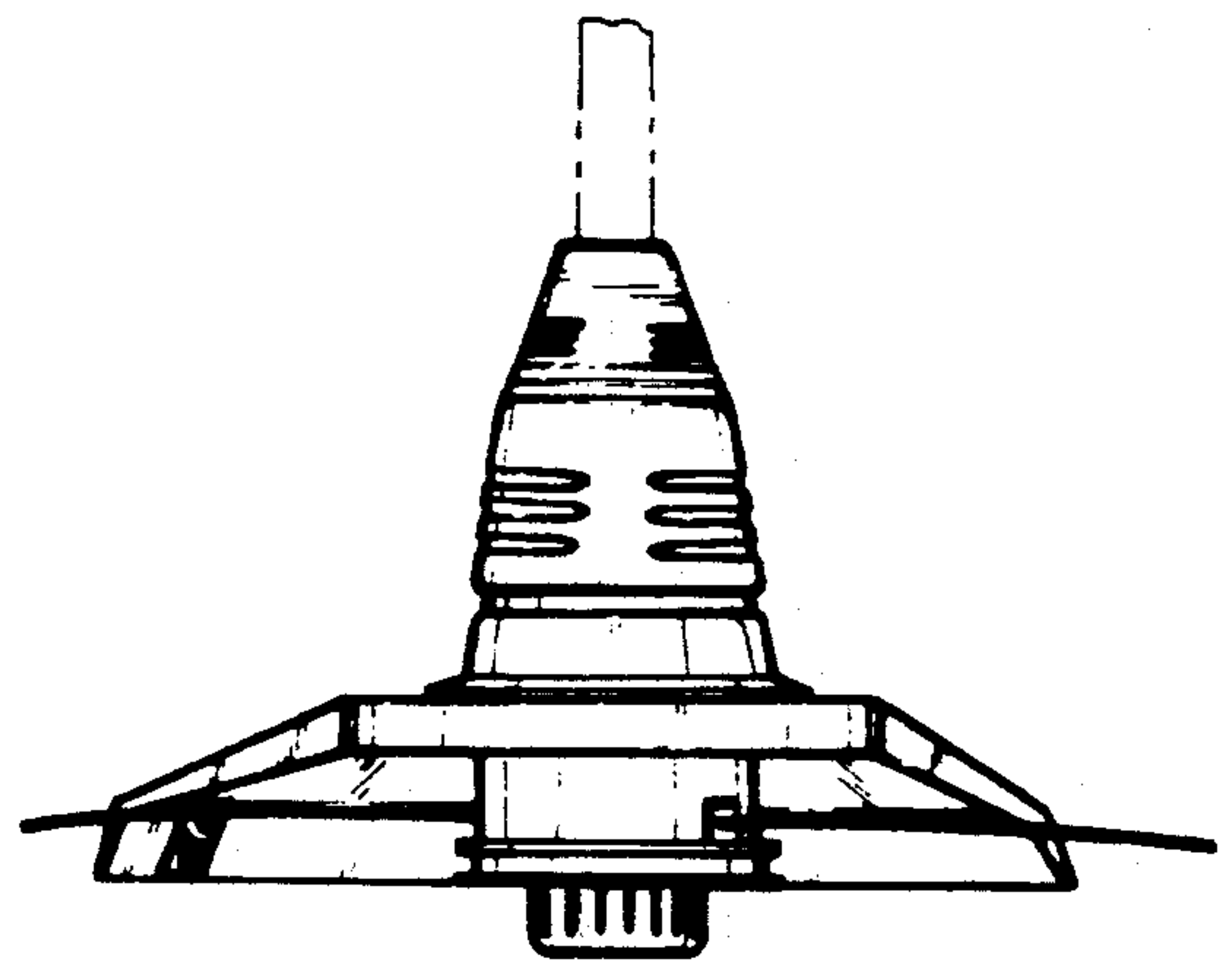
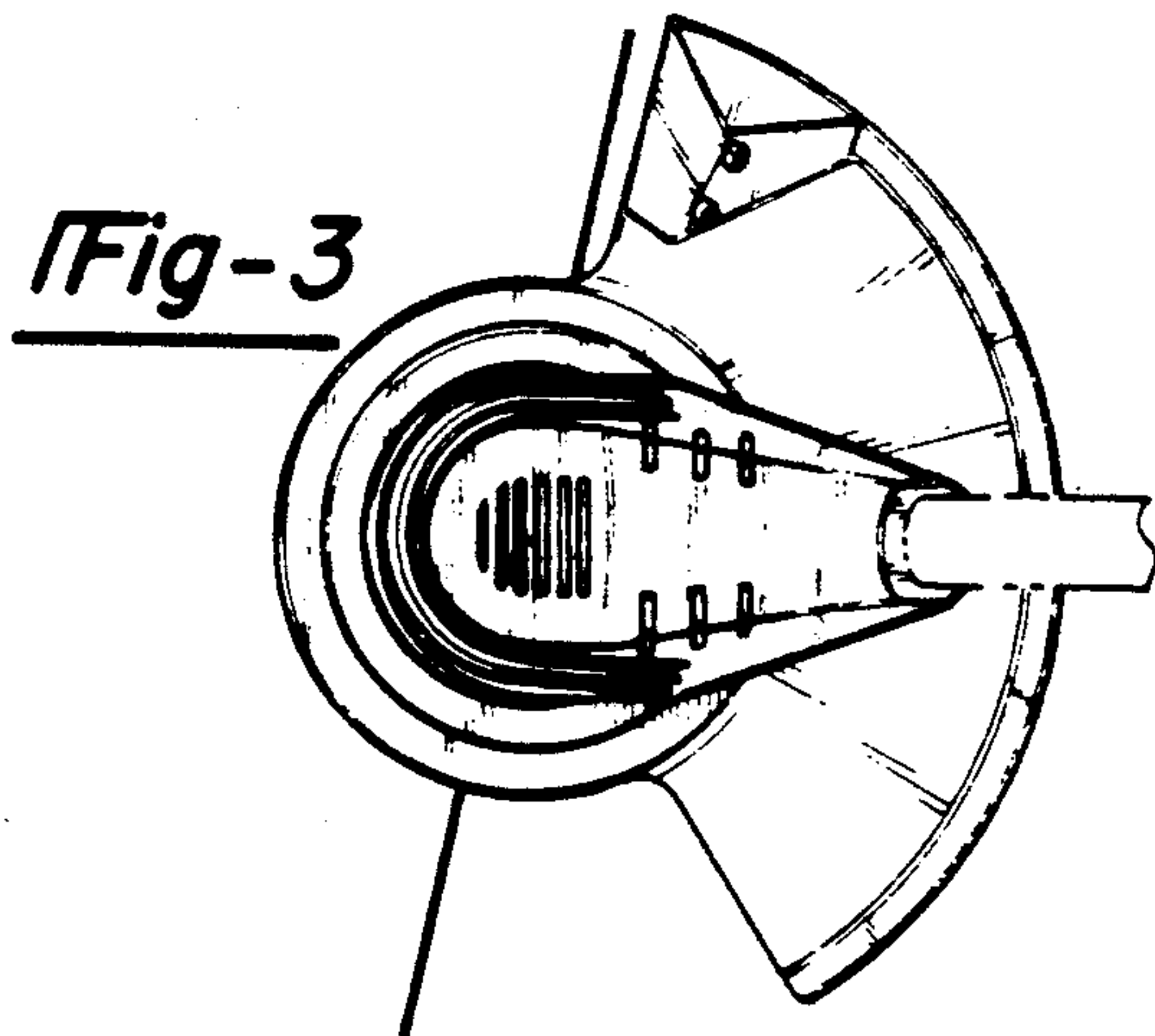

Fig-4

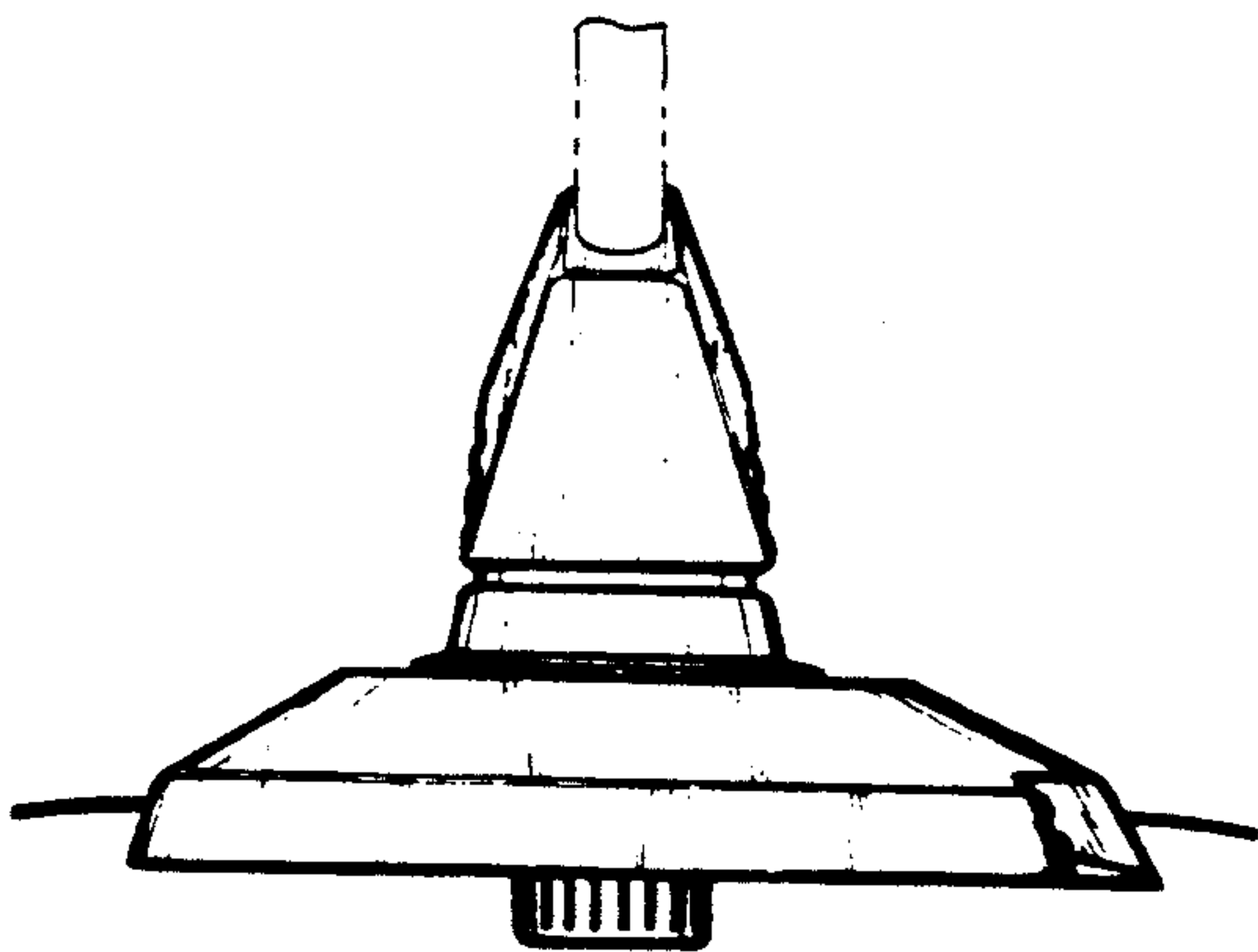

Fig-5

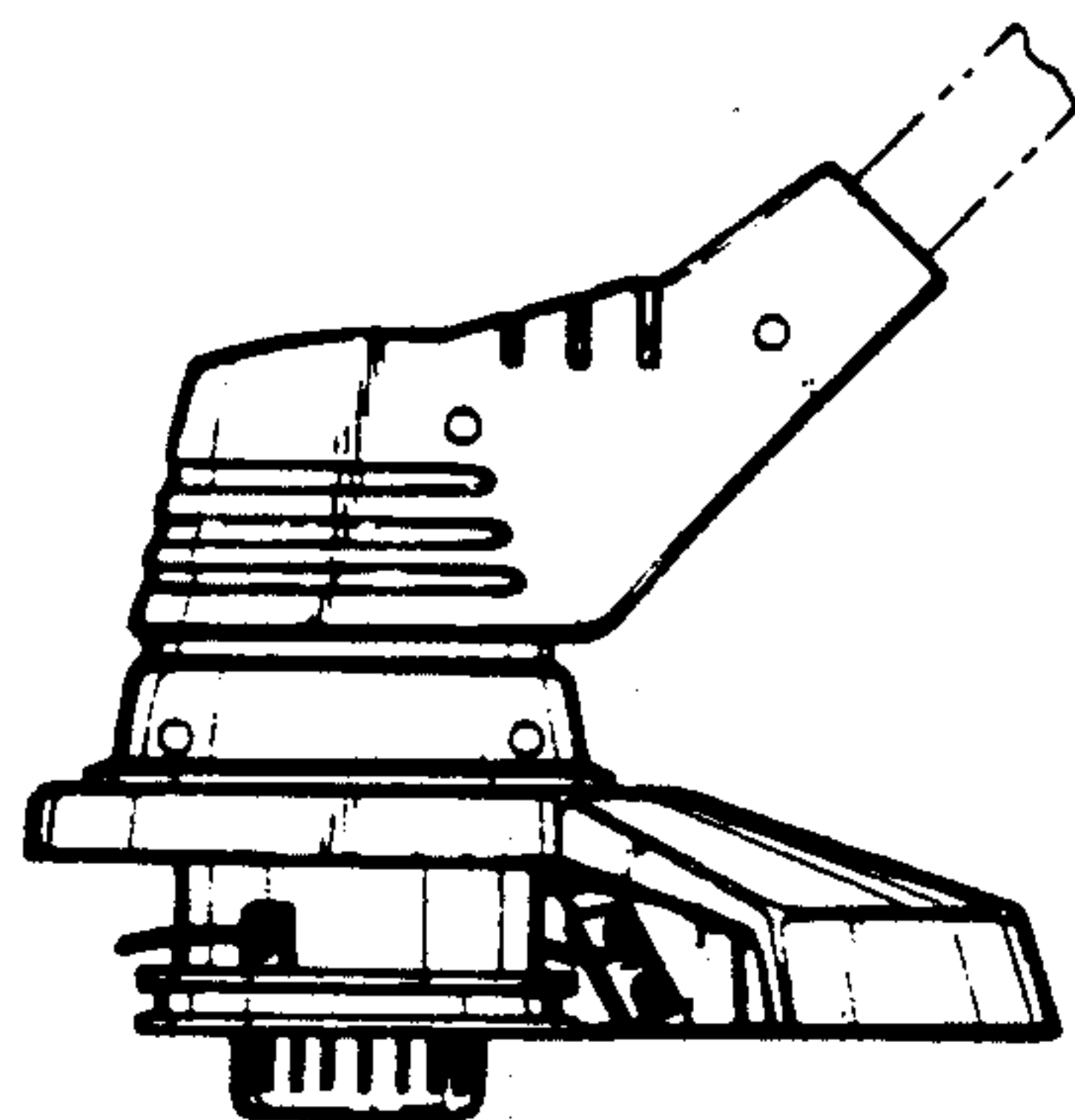

Fig-6

Fig-7

