



US00D328762S

United States Patent [19]

[11] Patent Number: **Des. 328,762**

Muniz, Jr.

[45] Date of Patent: **** Aug. 18, 1992**

[54] **DISPLAY MAP FOR VEHICLES**

4,174,889	11/1979	Peters	353/12
4,312,577	1/1982	Fitzgerald	353/12
4,800,662	1/1989	Belrose	40/426

[76] Inventor: **Reynaldo A. Muniz, Jr.**, 413-B Pat Booker Rd., Universal City, Tex. 78148

Primary Examiner—Wallace R. Burke
Assistant Examiner—Marcus Jackson
Attorney, Agent, or Firm—Gunn, Lee & Miller

[**] Term: **14 Years**

[21] Appl. No.: **483,412**

[57] **CLAIM**

[22] Filed: **Feb. 22, 1990**

The ornamental design for a display map for vehicles, as shown.

[52] U.S. Cl. **D20/18**

[58] Field of Search D20/10, 18, 19, 20, D20/21, 39, 40, 41; 40/426, 427, 429, 430, 436, 584, 585; 353/27, 12

DESCRIPTION

[56] **References Cited**

U.S. PATENT DOCUMENTS

D. 99,038	3/1936	Manchester	D20/21
D. 247,264	2/1978	Smith	D20/21
D. 262,383	12/1981	Skrobisch	D20/21
3,570,445	3/1971	Johnson	40/426
4,033,684	7/1977	Toriumi et al.	353/27 A
4,138,726	2/1979	Girault et al.	364/521
4,152,722	5/1979	Inulya	358/102

FIG. 1 is a front elevational view of a display map for vehicles showing my new design, with broken line showing for illustrative purposes only and forming no part of the claimed design;

FIG. 2 is a bottom plan view thereof;

FIG. 3 is a left side elevational view thereof;

FIG. 4 is a top plan view thereof;

FIG. 5 is a rear elevational view thereof;

FIG. 6 is a right side elevational view thereof;

FIG. 7 is a rear perspective view thereof; and,

FIG. 8 is a front perspective view thereof.

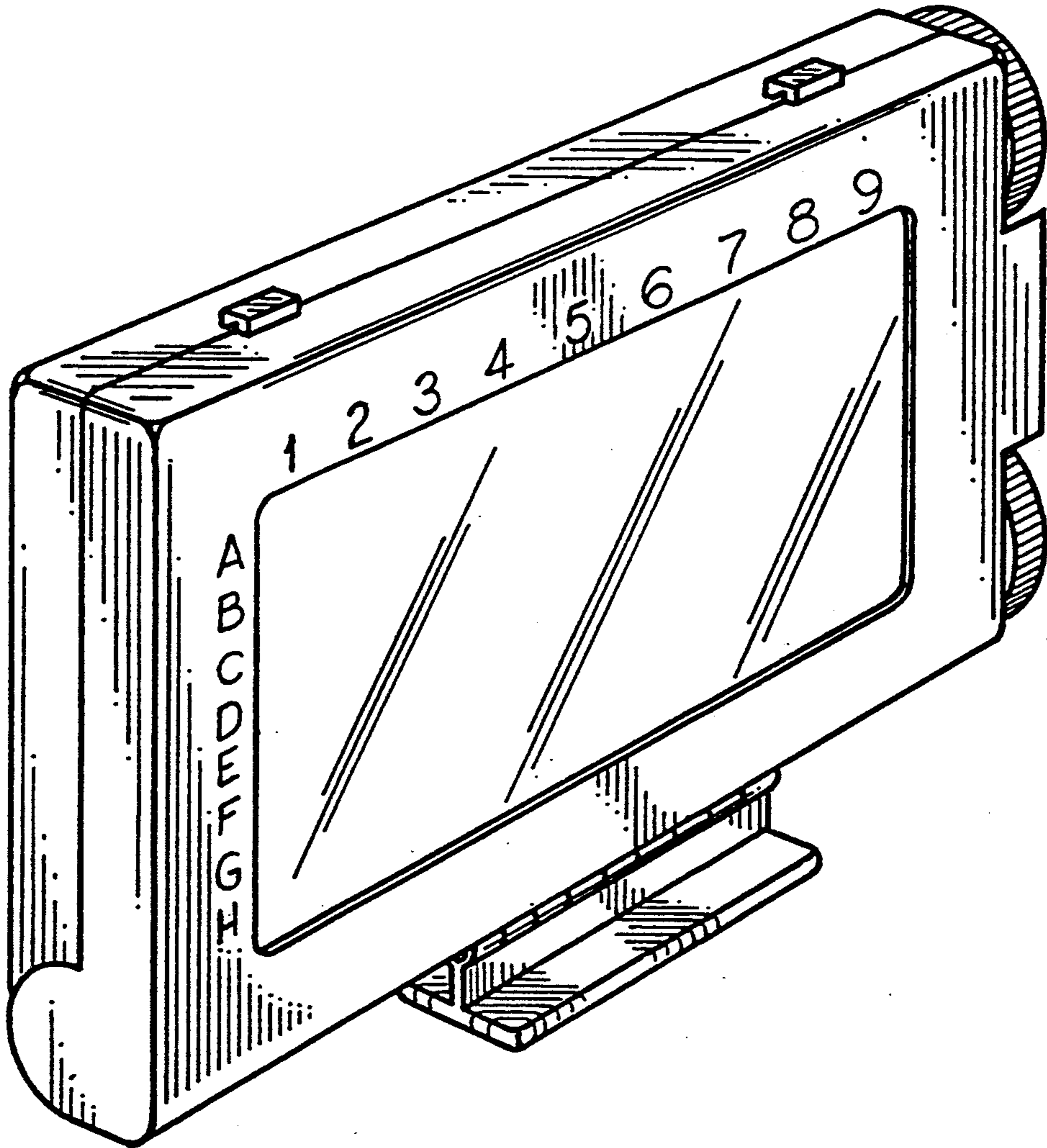

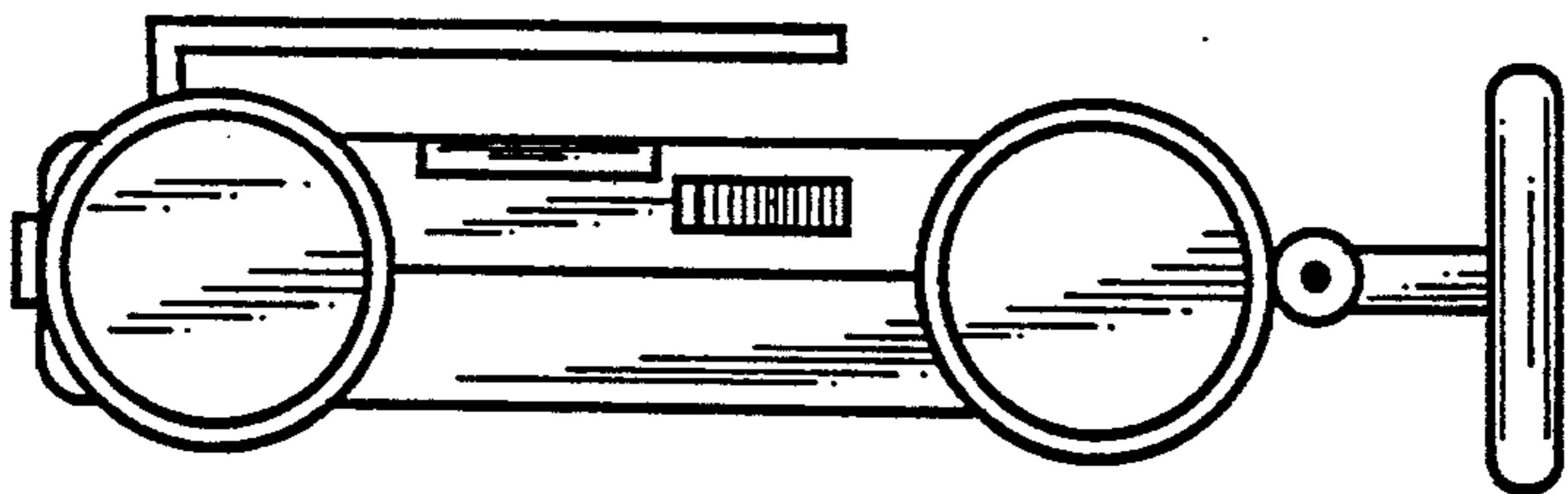

Figure 3

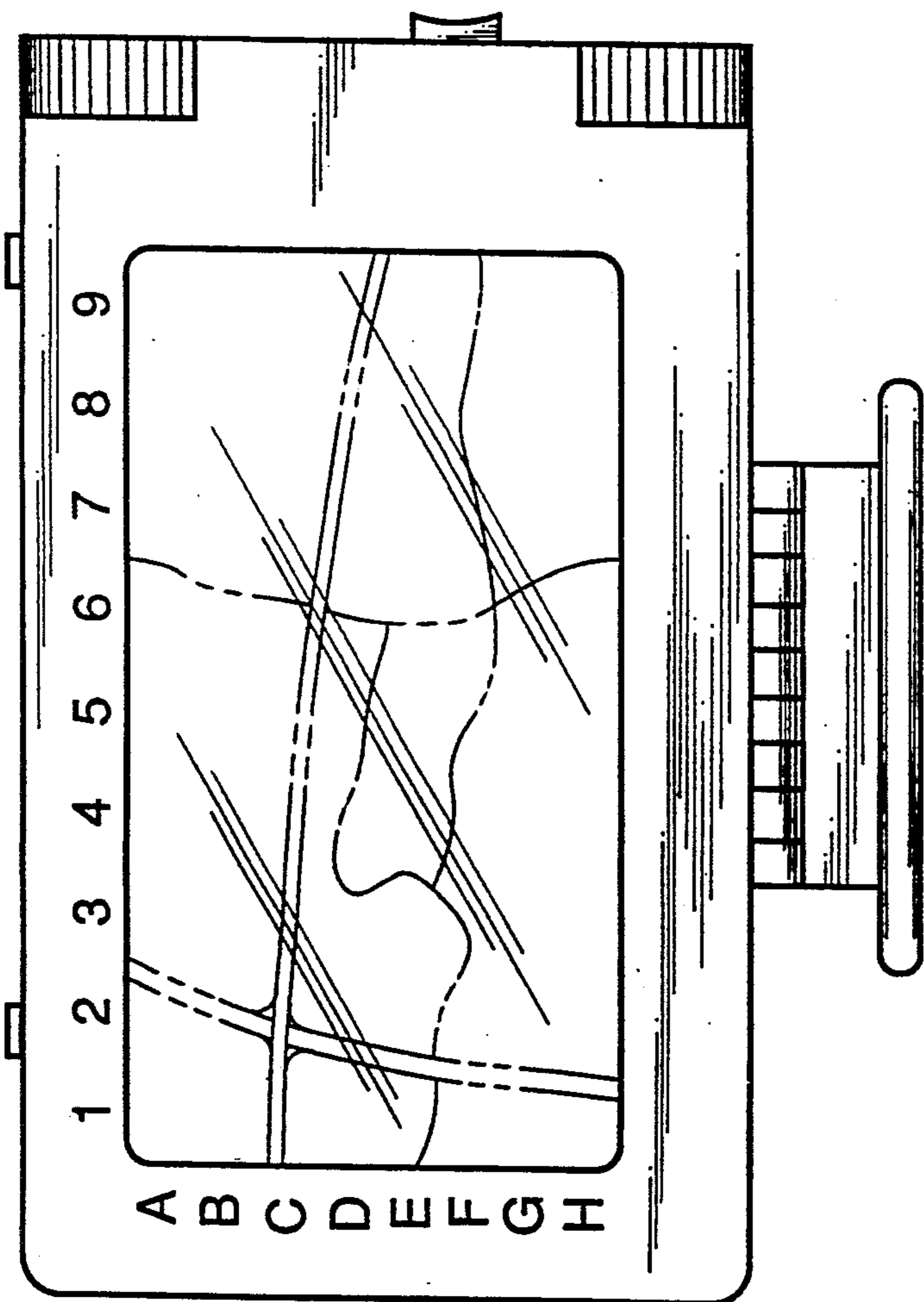

Figure 1

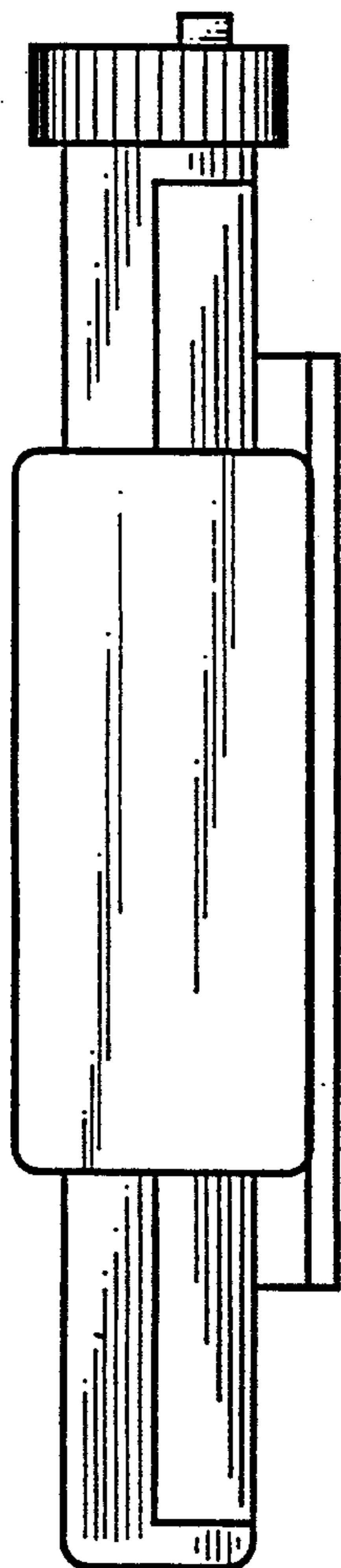

Figure 2

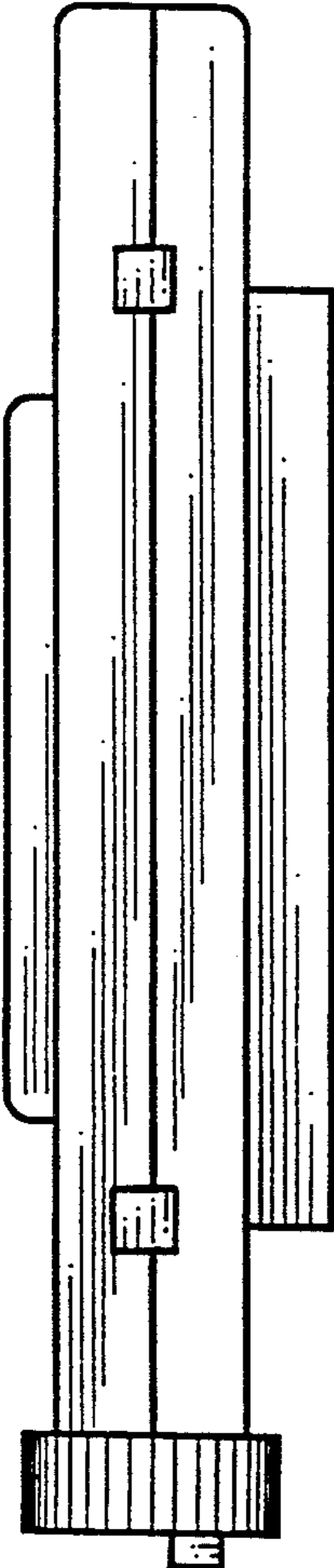

Figure 4

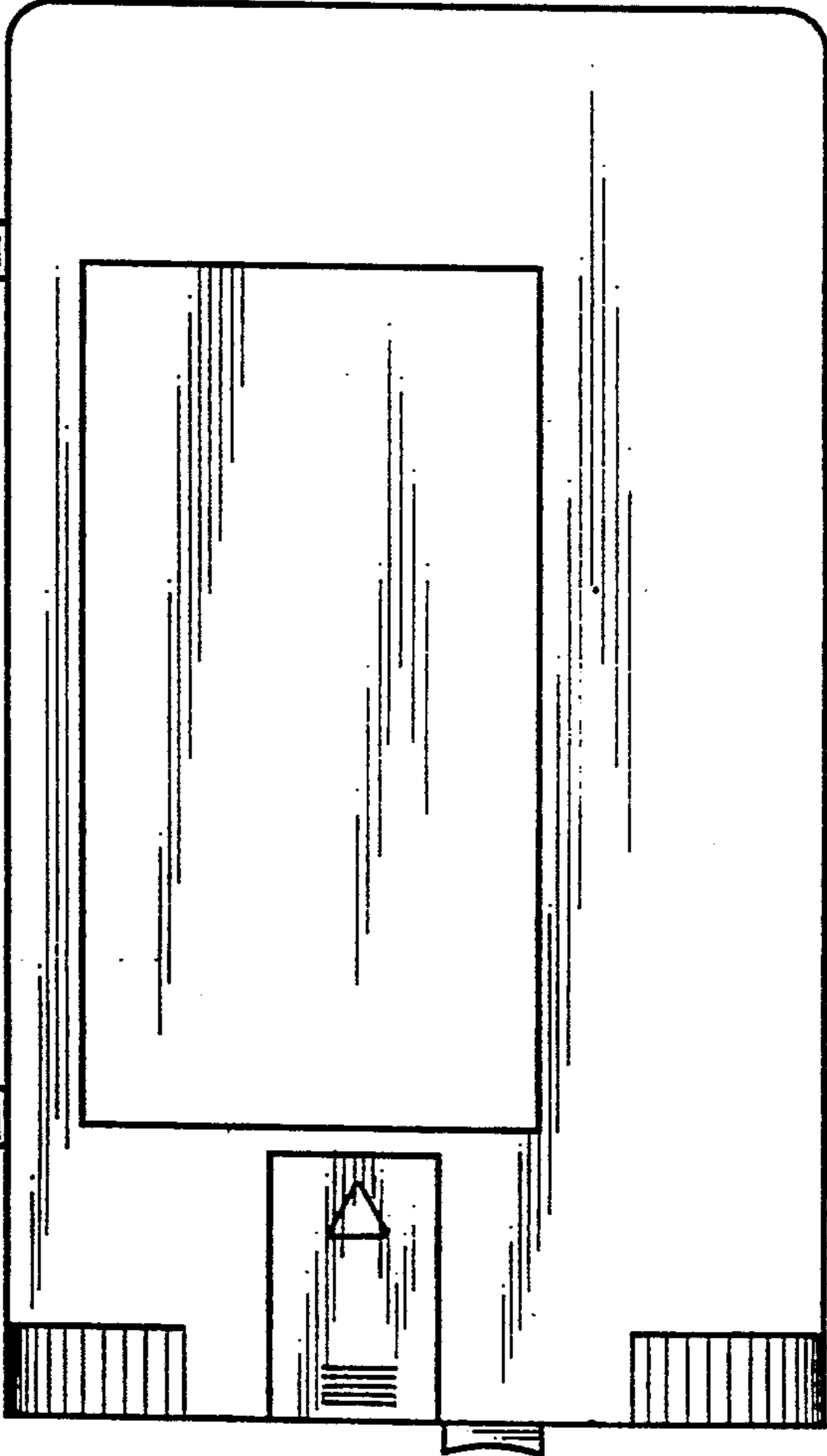

Figure 5

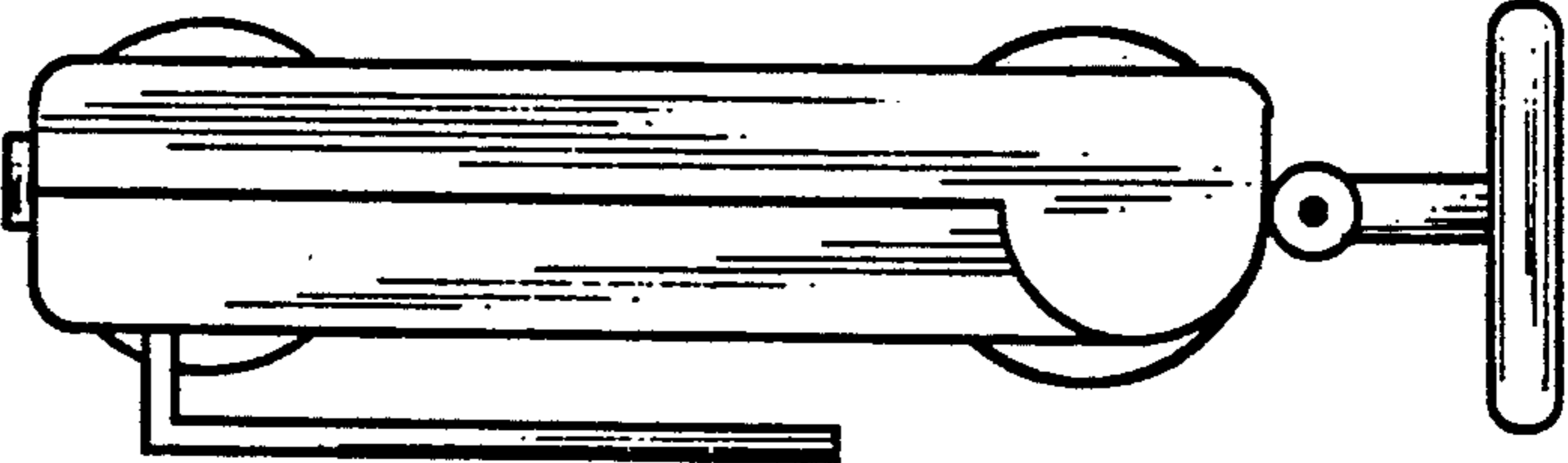

Figure 6

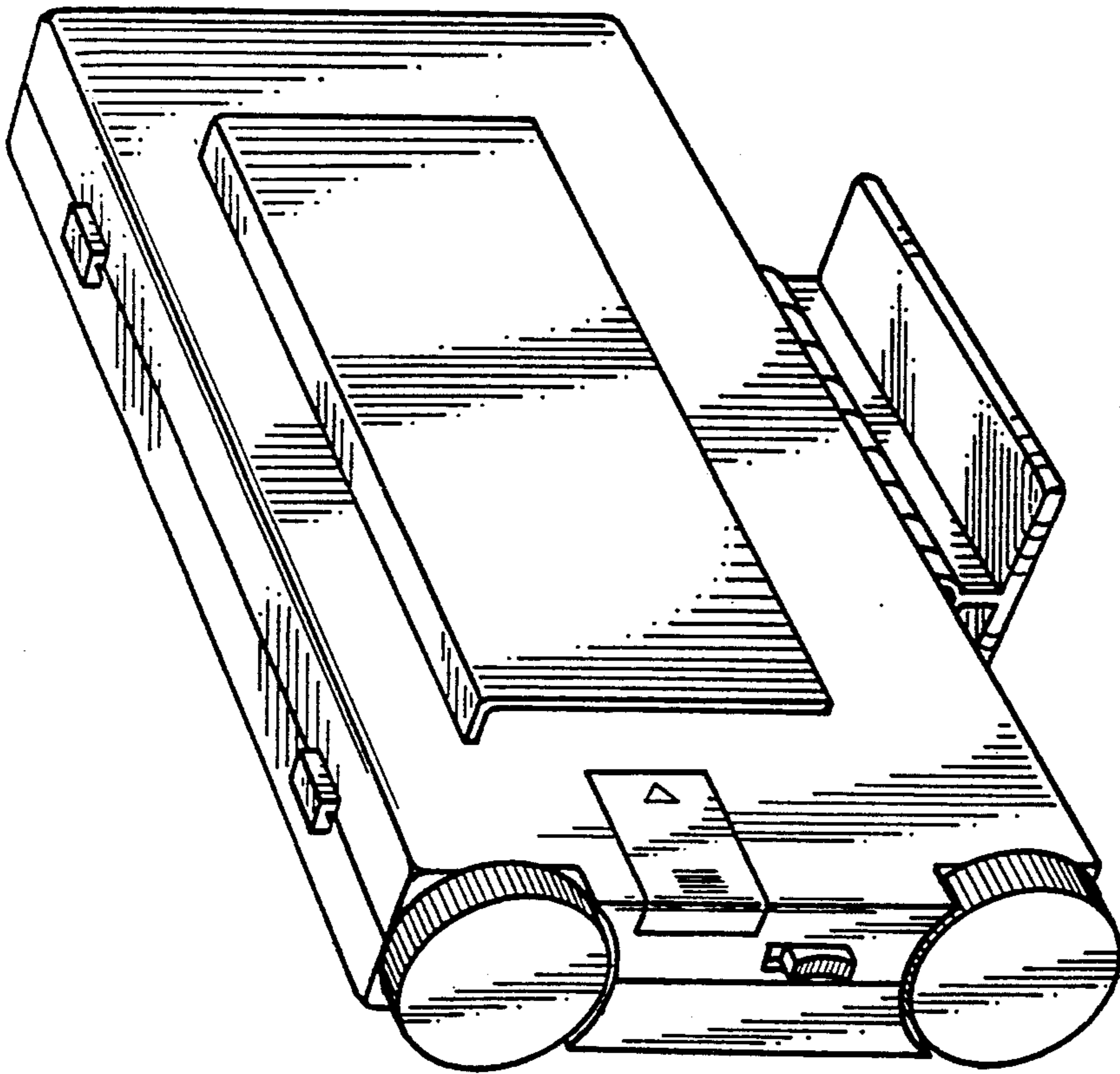

Figure 7

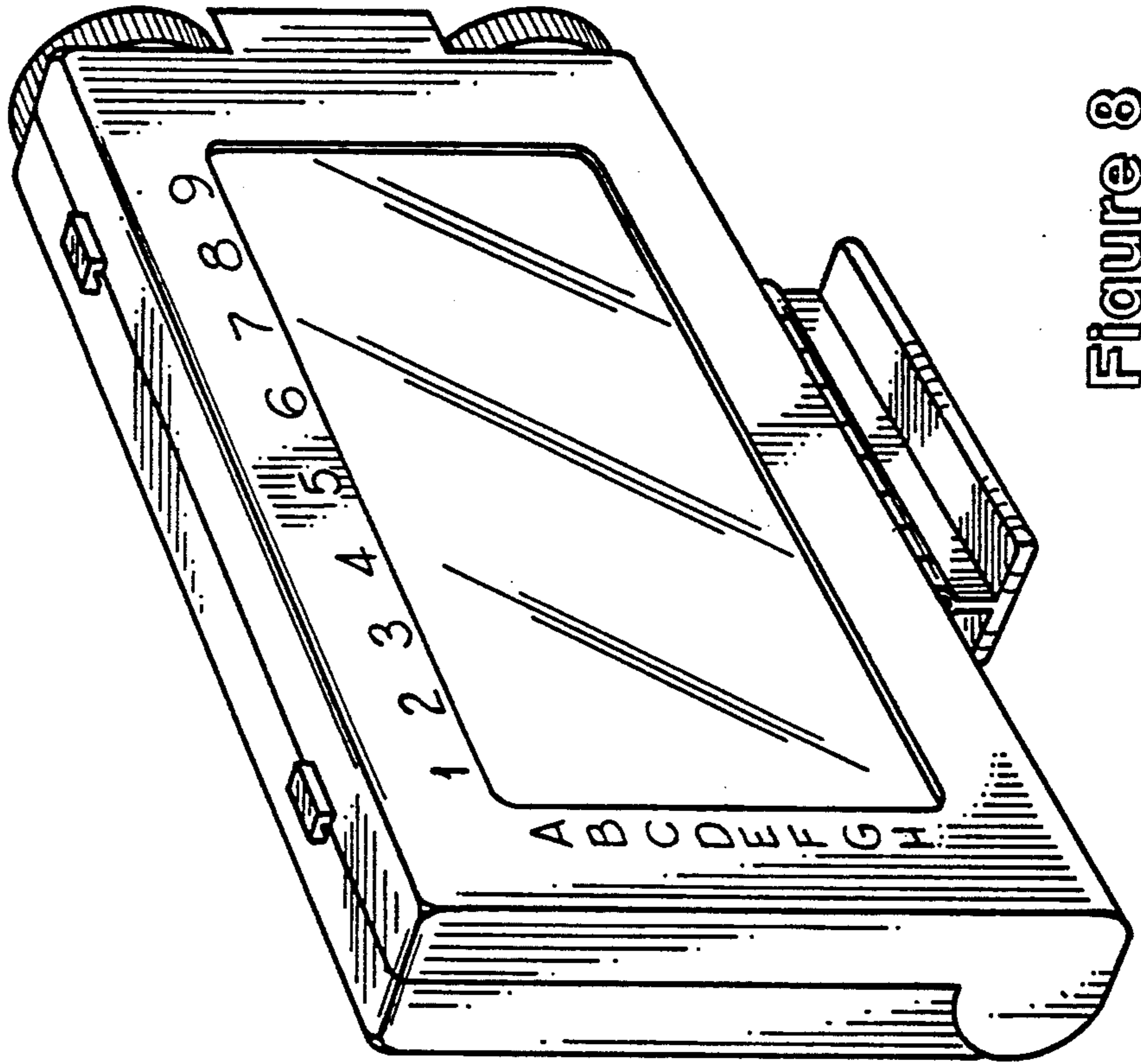

Figure 8