



US00D327465S

United States Patent [19]

[11] Patent Number: **Des. 327,465**

Word et al.

[45] Date of Patent: **** Jun. 30, 1992**

[54] TRUCK TAIL GATE

[76] Inventors: **Thomas N. Word**, 3150 E. 68th, Tulsa, Okla. 74136; **Kenneth C. Haremza**, 2925 E. 93rd Pl., Tulsa, Okla. 74137; **William R. Bowman**, 6705 S. First St., Broken Arrow, Okla. 74011; **Cecil L. Hartman**, Rte. 1, Box 1035, Talala, Okla. 74080; **J. W. Bane**, 607 N. Moccasin Pl., Sapulpa, Okla. 74066

[**] Term: **14 Years**

[21] Appl. No.: **435,792**

[22] Filed: **Nov. 13, 1989**

[52] U.S. Cl. **D12/196**

[58] Field of Search **D12/196, 98; 296/50, 296/56, 57.1, 61**

[56] References Cited

U.S. PATENT DOCUMENTS

D. 250,014	10/1978	Jensen	D12/196
4,353,589	10/1982	Hartberg	296/50
4,902,066	2/1990	Norman	296/57.1

OTHER PUBLICATIONS

J. C. Whitney Catalog No. 505m, p. 20, Stainless Steel Air Gate 1A, top center of page.

Primary Examiner—James M. Gandy

Attorney, Agent, or Firm—Laney, Dougherty, Hessin & Beavers

[57] CLAIM

The ornamental design for a truck tail gate, as shown and described.

DESCRIPTION

FIG. 1 is a top, front, left end perspective view of a first embodiment of the truck tail gate of the present design installed in a closed position on a truck, it being understood that the broken lines are for illustrative purposes only and form no part of the claimed design;

FIG. 2 is an enlarged front elevational view thereof;

FIG. 3 is an enlarged top plan view thereof;

FIG. 4 is an enlarged bottom plan view thereof;

FIG. 5 is a right side elevational view thereof, at a

greatly enlarged scale, the opposite end being a mirror image of that shown;

FIG. 6 is a cross-sectional view taken along line 6—6 of FIG. 2 at an enlarged scale and showing the horizontal members as being generally teardrop-shaped in cross-section;

FIG. 7 is a cross-sectional view of a second embodiment of a truck tail gate taken along a line similar to 6—6 of FIG. 2 at an enlarged scale wherein the only differences resides in the horizontal members being round in cross-section;

FIG. 8 is a rear elevational view of FIG. 2;

FIG. 9 is a front elevational view of a third embodiment of a truck tail gate showing our new design, the only differences being that the ends of the horizontal members extend into the vertical end panels and there is only a single centrally located vertical support for the horizontal members;

FIG. 10 is a front elevational view of a fourth embodiment of a truck tail gate showing our new design, the ends of the fourth embodiment being plain and unornamented, it being understood that the appearance and shape of the two vertical supports for the horizontal members is the same as those for the first and second embodiments shown in FIGS. 6 and 7;

FIG. 11 is a cross-sectional view taken along line 11—11 of FIG. 10 at an enlarged scale and showing the horizontal members as being generally teardrop-shaped in cross-section;

FIG. 12 is a cross-sectional view of a fifth embodiment of a truck tail gate showing our new design taken along a line similar to 11—11 of FIG. 10 at an enlarged scale which differs from the fourth embodiment only in the round cross-section of the horizontal members;

FIG. 13 is a front elevational view of a sixth embodiment of a truck tail gate showing our new design, the ends of the sixth embodiment of the truck tail gate being plain and unornamented;

FIG. 14 is a cross-sectional view at an enlarged scale taken along line 14—14 of FIG. 13 and showing horizontal members that are teardrop-shaped in cross-section; and,

FIG. 15 is a cross-sectional view of a seventh embodiment of a truck tail gate showing our new design taken along a line similar to 14—14 of FIG. 13 at an enlarged scale which differs from the sixth embodiment only in the round cross-section of the horizontal members.

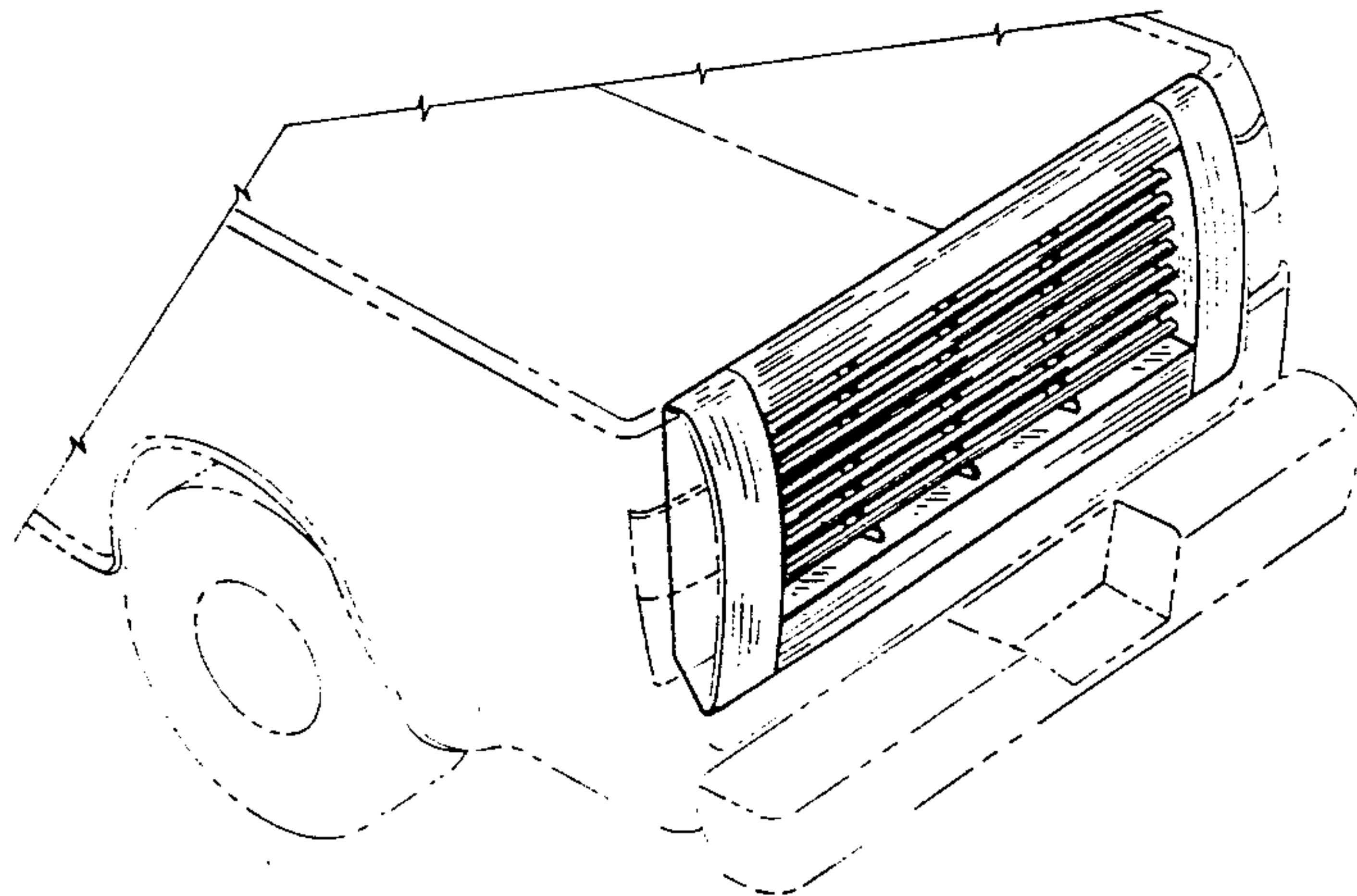

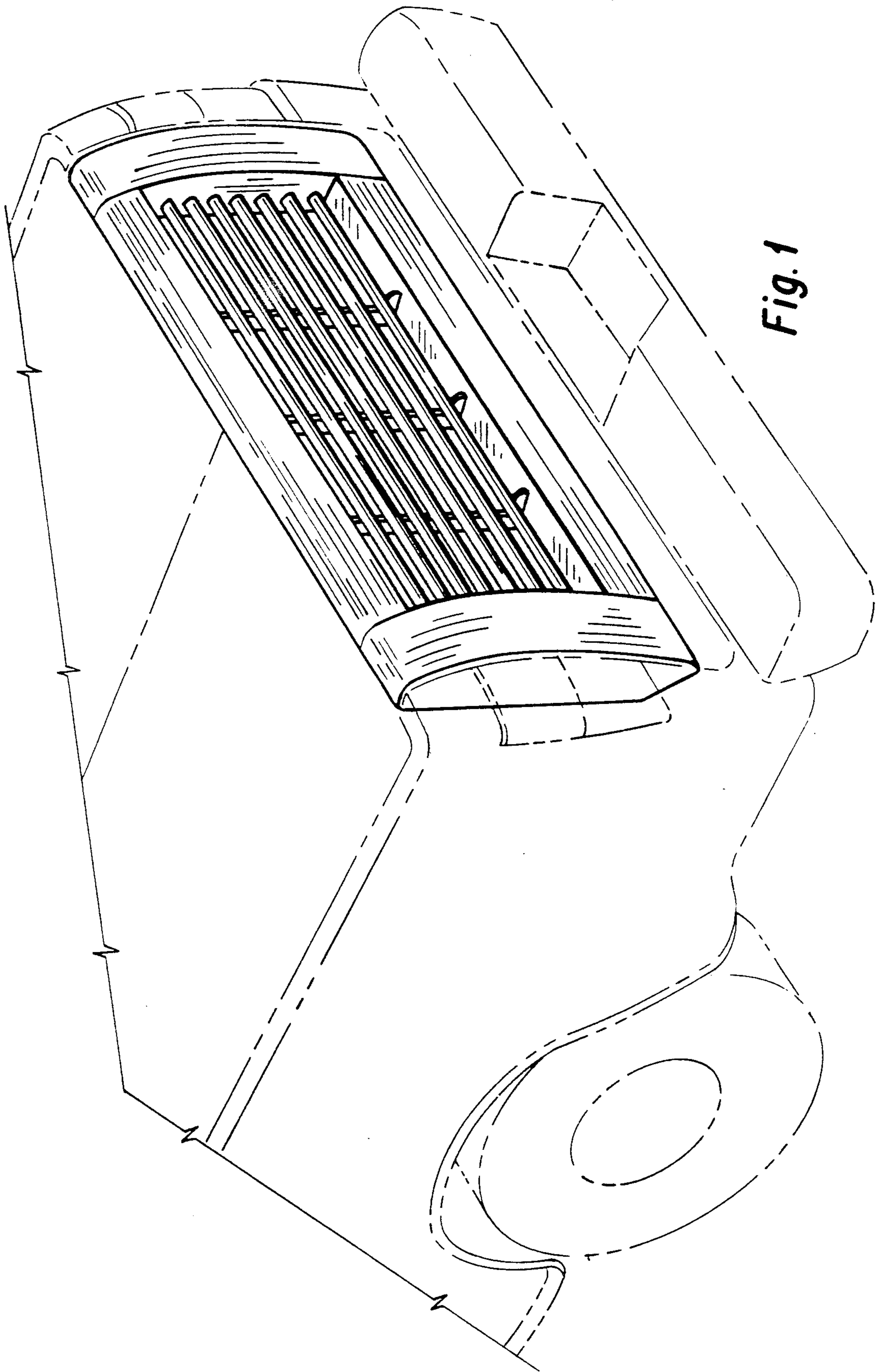

Fig. 1



Fig. 3

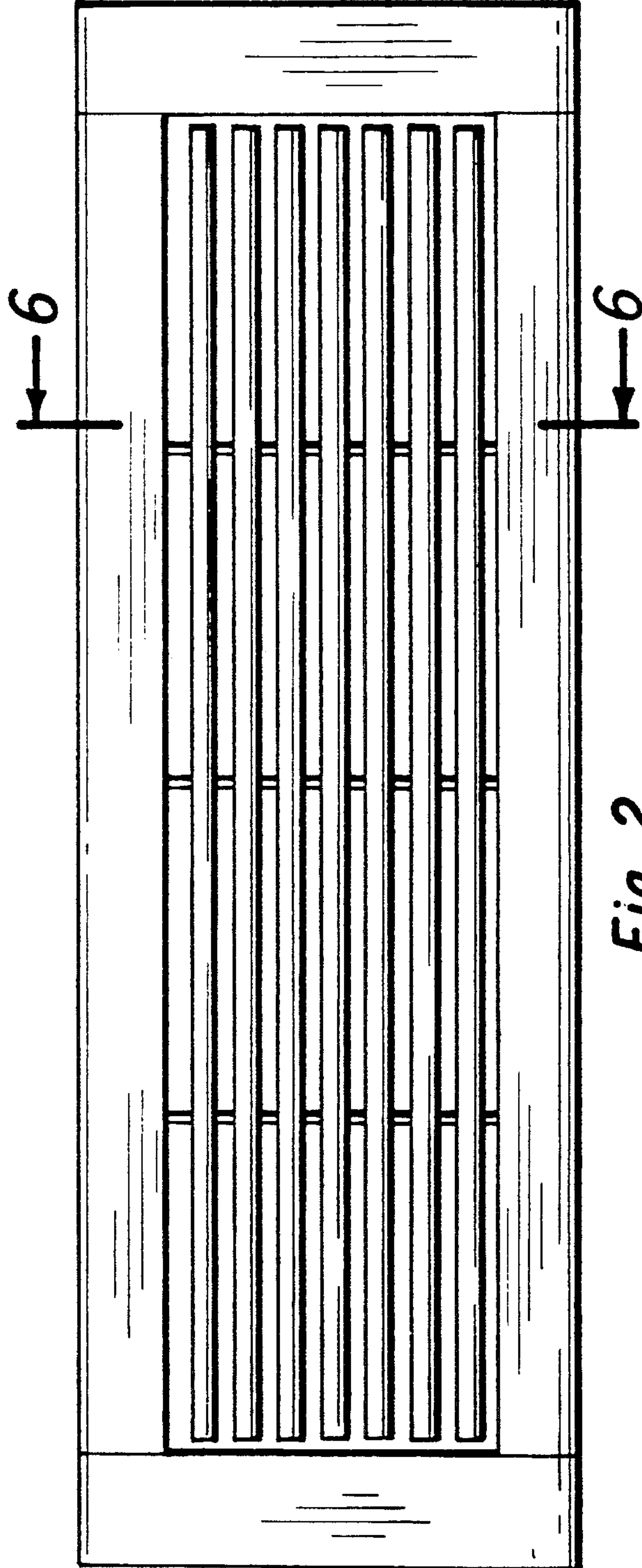

Fig. 2

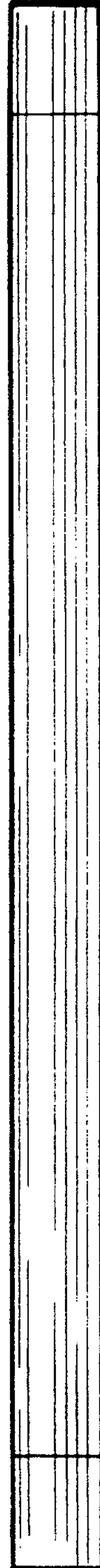

Fig. 4

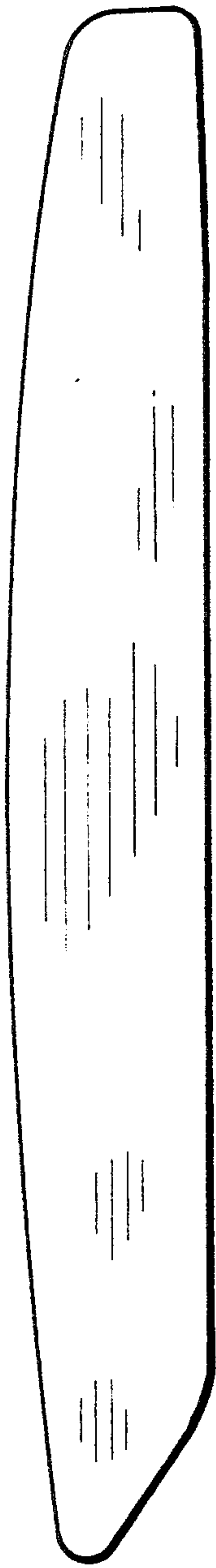

Fig. 5

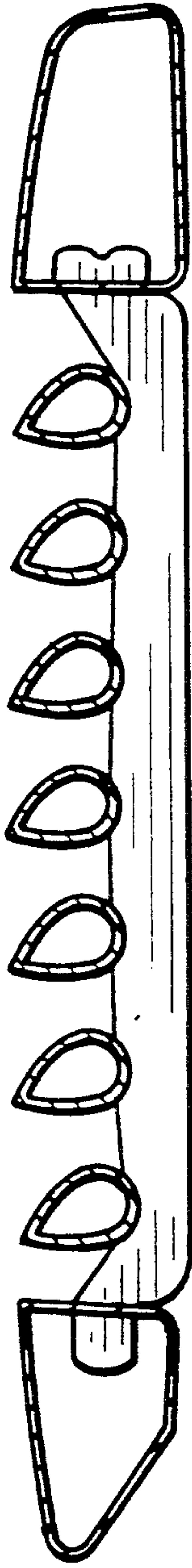

Fig. 6

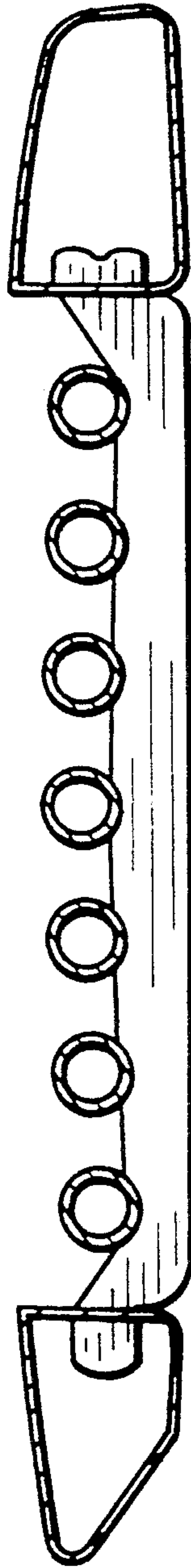

Fig. 7

Fig. 8

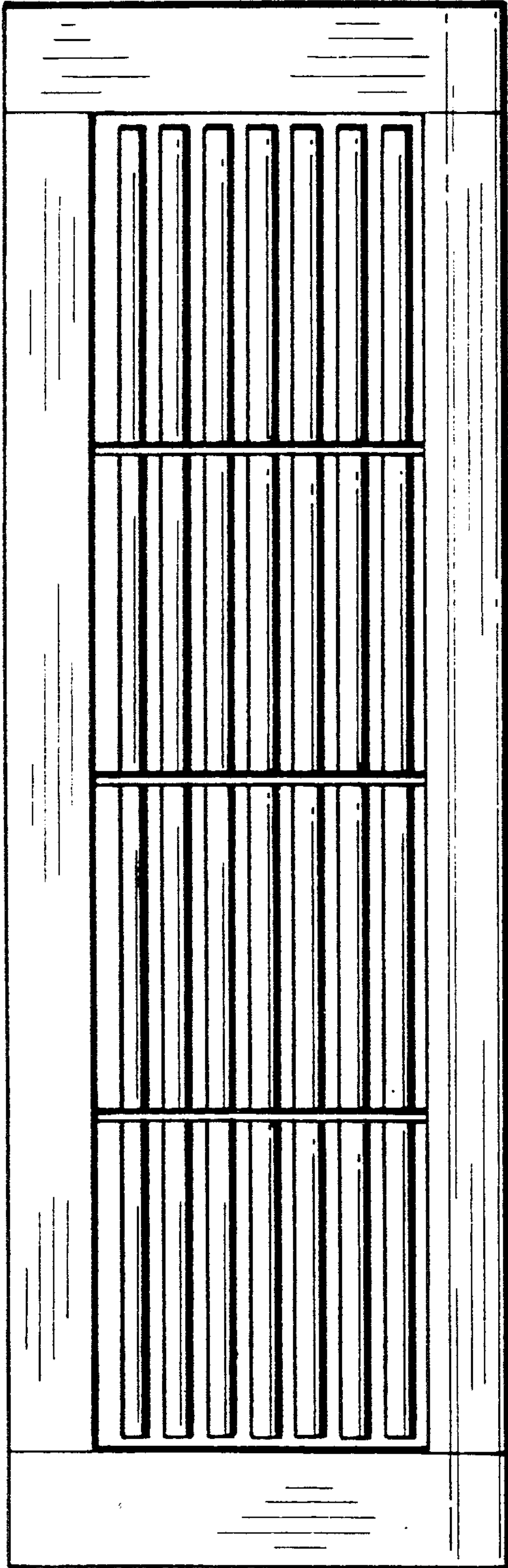
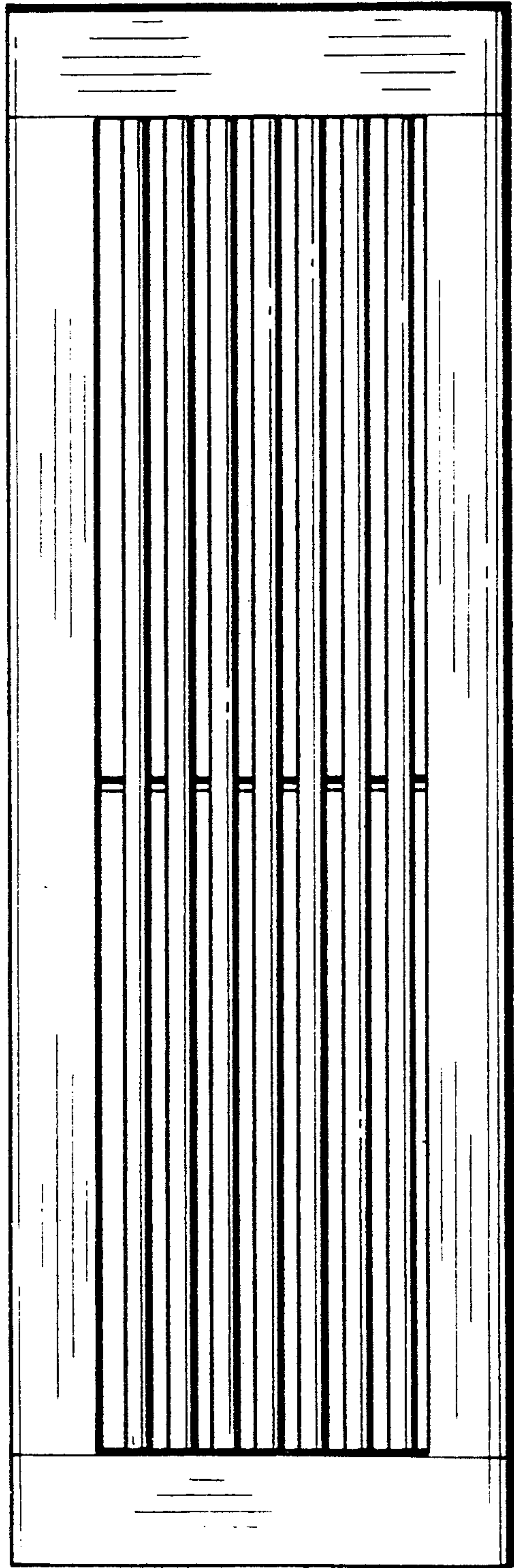

Fig. 9



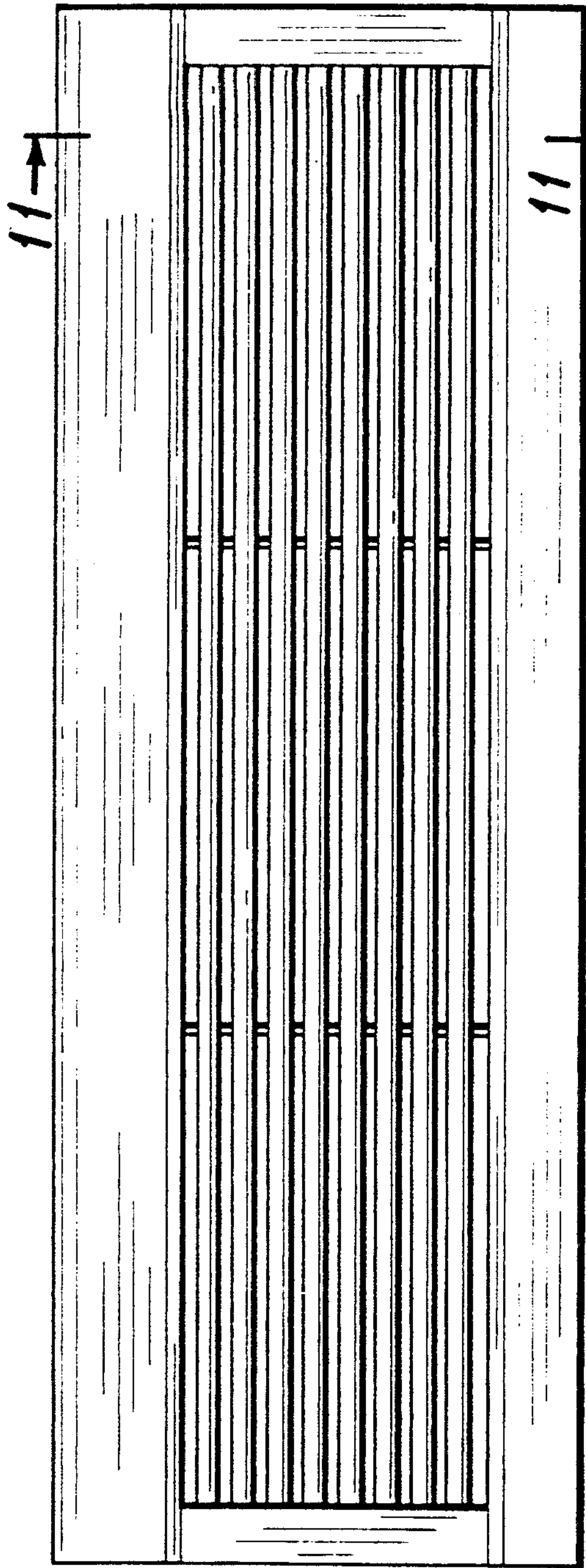

Fig. 10

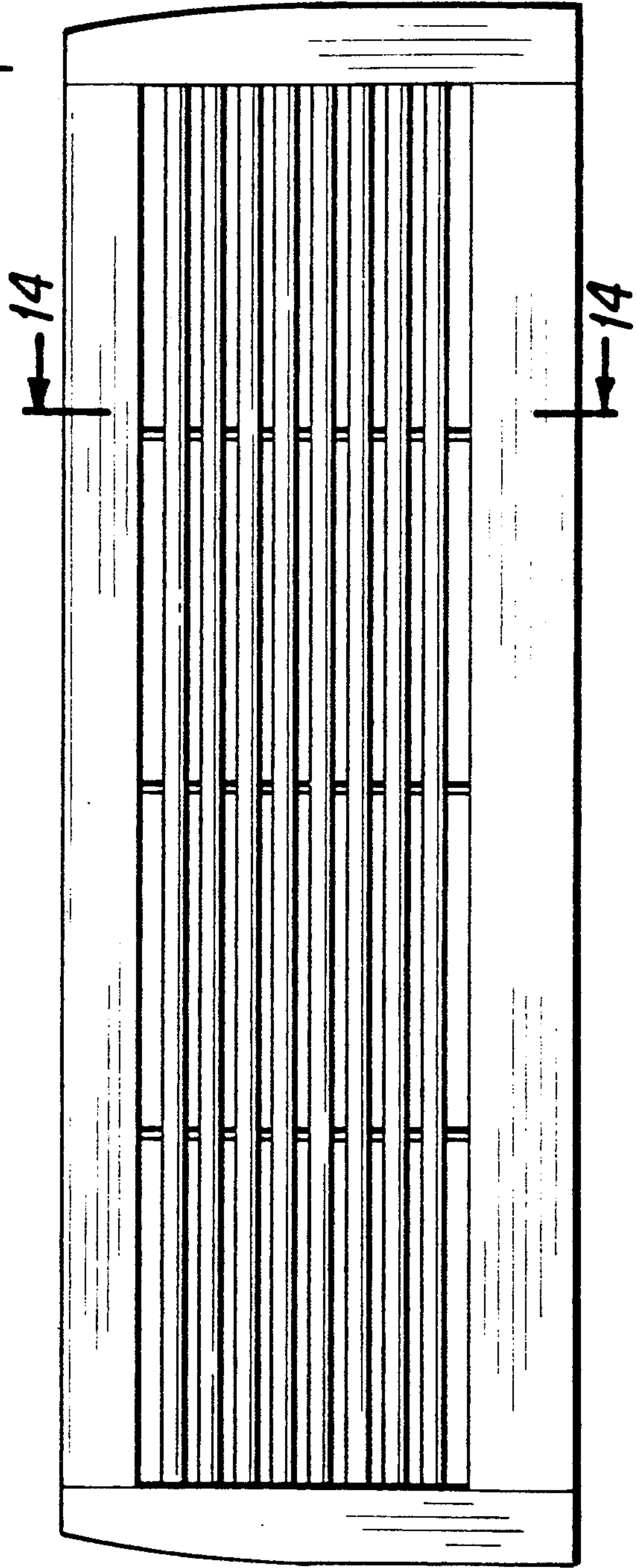

Fig. 13

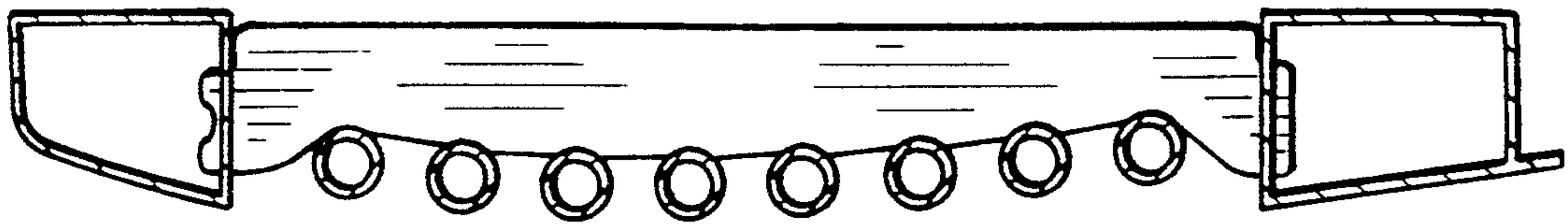

Fig. 15

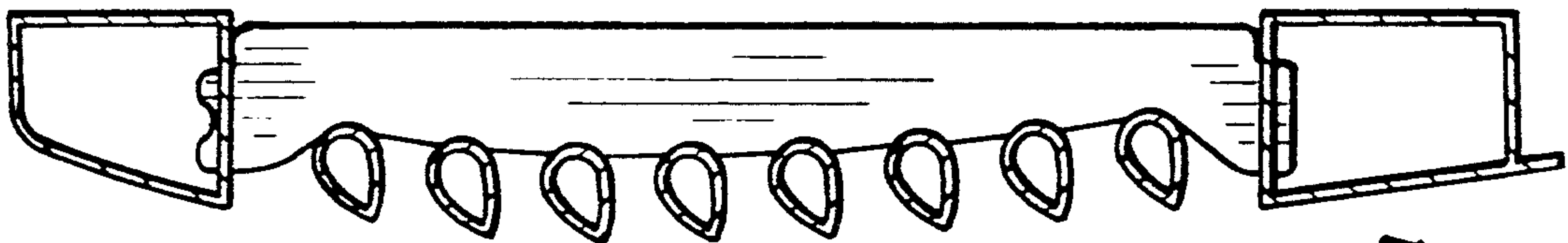

Fig. 14

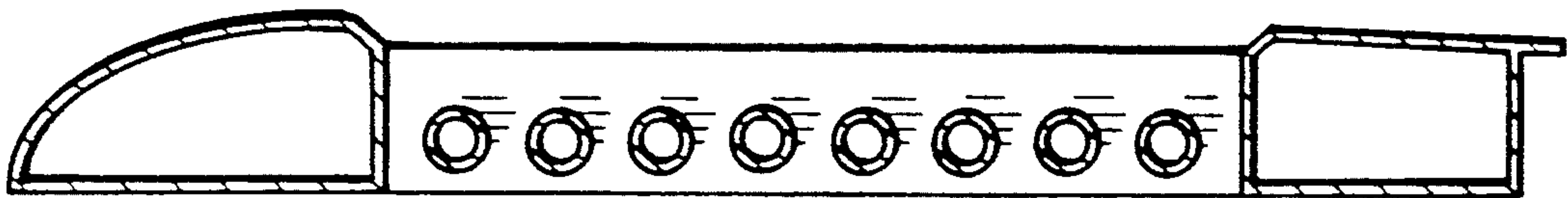

Fig. 12

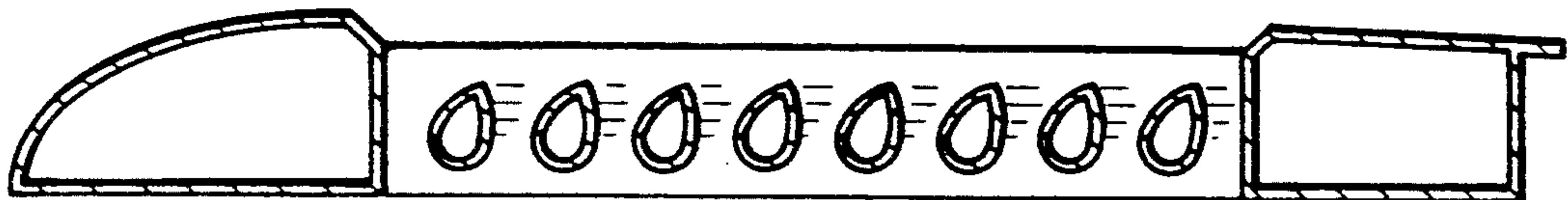

Fig. 11