



US00D325178S

United States Patent [19]

[11] Patent Number: **Des. 325,178**

Corneal

[45] Date of Patent: **** Apr. 7, 1992**

[54] **PHOTO-ELECTRIC CELL ALARM HOUSING FOR SWIMMING POOLS OR THE LIKE**

3,434,258 3/1969 Zeurent D25/122
3,451,183 6/1969 Zespagnol et al. D25/119

[76] Inventor: **Nicholas W. Corneal**, 79 Bassett Blvd., Whitby, Ontario, Canada, L1N 8N6

Primary Examiner—Wallace R. Burke
Assistant Examiner—Marcus Jackson
Attorney, Agent, or Firm—Wegner, Cantor, Mueller & Player

[**] Term: **14 Years**

[57] **CLAIM**

[21] Appl. No.: **403,810**

The ornamental design for a photo-electric cell alarm housing for swimming pools or the like, as shown and described.

[22] Filed: **Sep. 7, 1989**

[30] **Foreign Application Priority Data**

DESCRIPTION

May 8, 1989 [CA] Canada 08-05-89-17

[52] U.S. Cl. **D10/106; D25/122; D10/121**

[58] Field of Search D10/104, 105, 106, 121; D25/119, 122; 340/540, 541, 542, 546, 547, 549, 550, 552, 561, 565, 568, 566, 567, 572, 571

FIG. 1 is a front perspective view of a photo-electric cell alarm housing for swimming pools or the like showing my new design, with the center broken away to indicate indeterminate length;

FIG. 2 is a top plan view thereof, with the bottom being a mirror image;

FIG. 3 is a rear elevational view taken from the left side, with the opposite side being a mirror image;

FIG. 4 is a rear perspective view taken from the left side thereof;

FIG. 5 is a left side elevational view thereof; and,

FIG. 6 is a right side elevational view thereof.

[56] **References Cited**

U.S. PATENT DOCUMENTS

D. 269,859 7/1983 Paladini D10/121
D. 271,055 10/1983 Cascone et al. D25/119
D. 274,297 6/1984 Wright D10/104

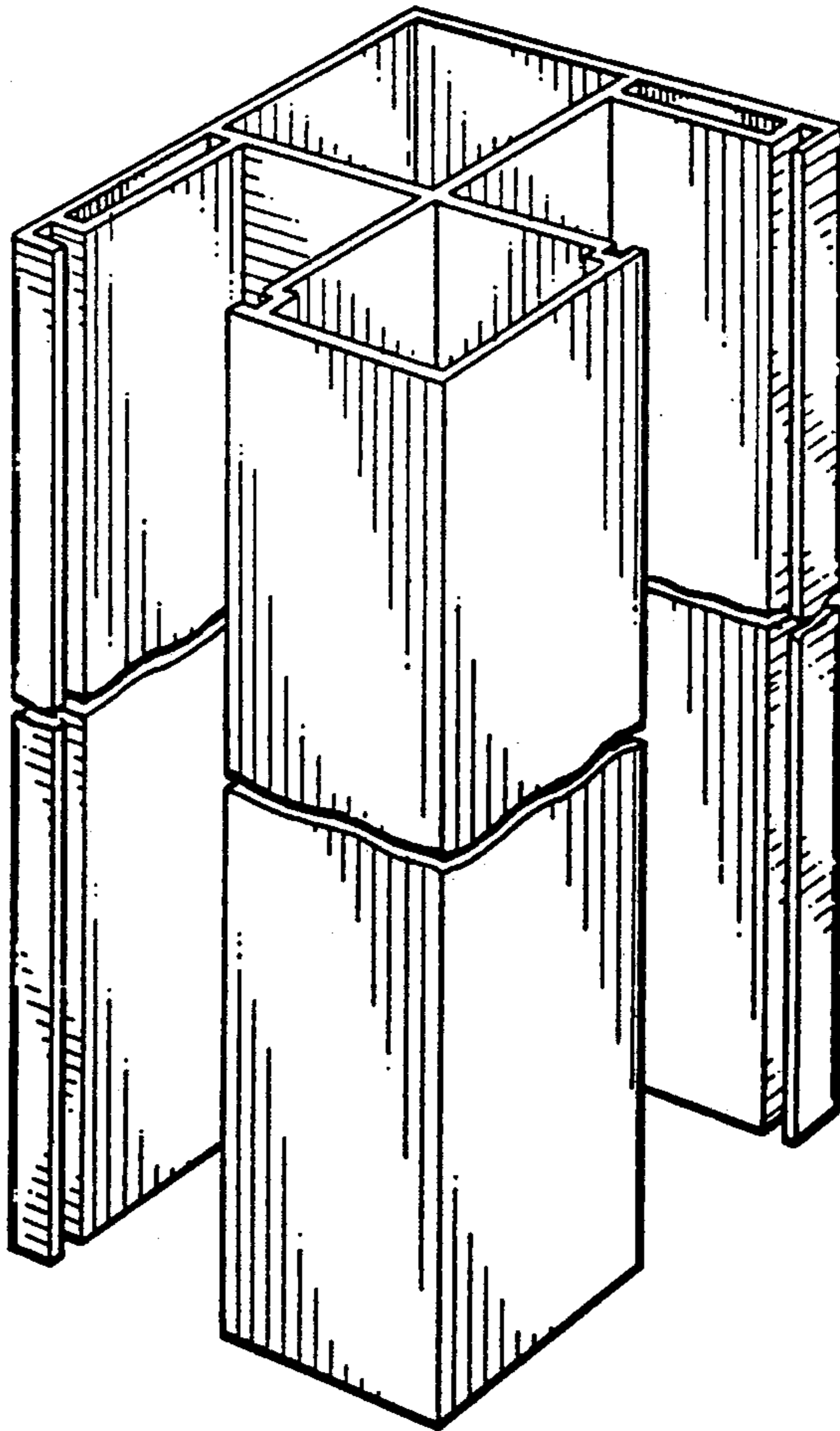

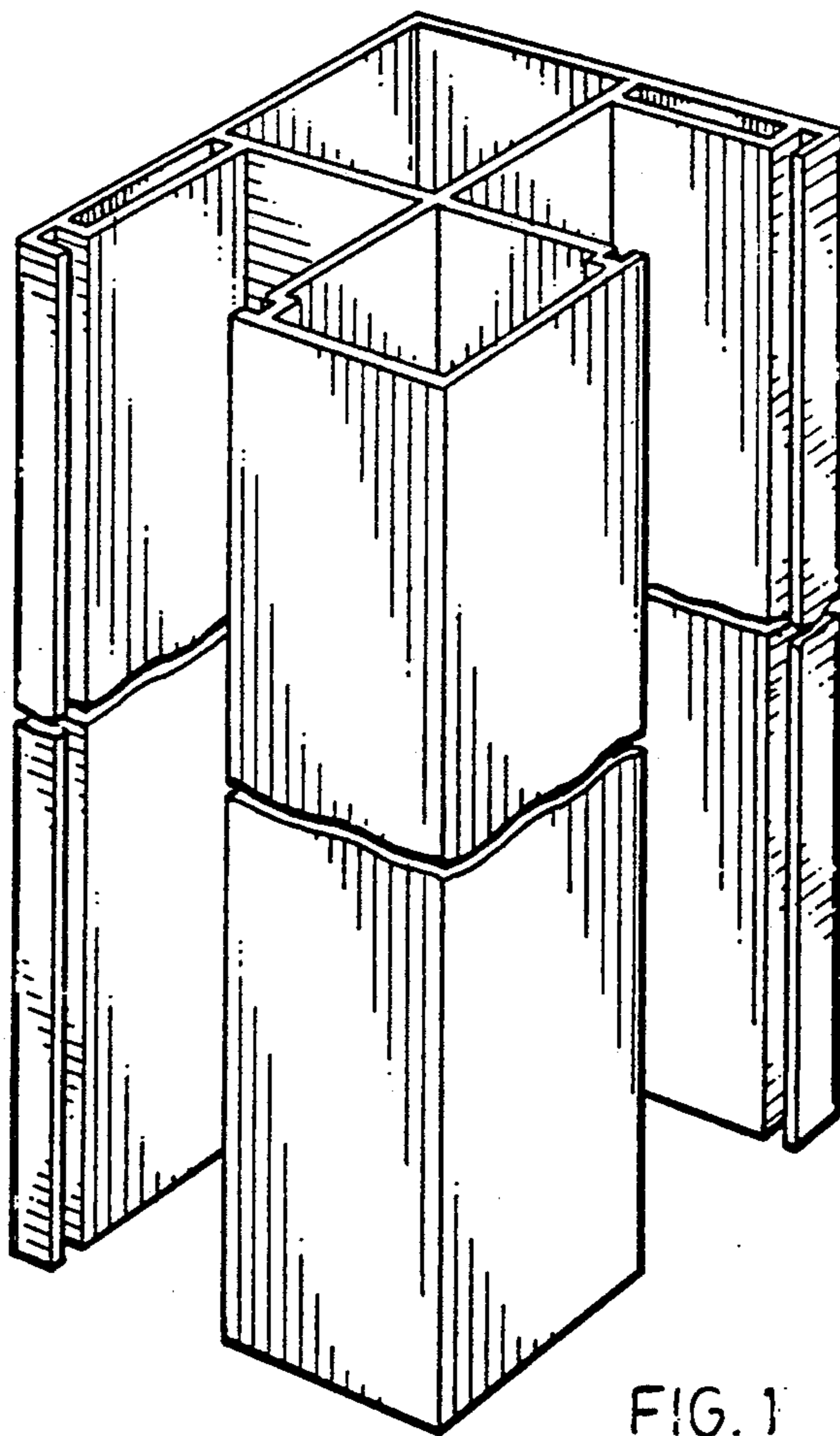

FIG. 1

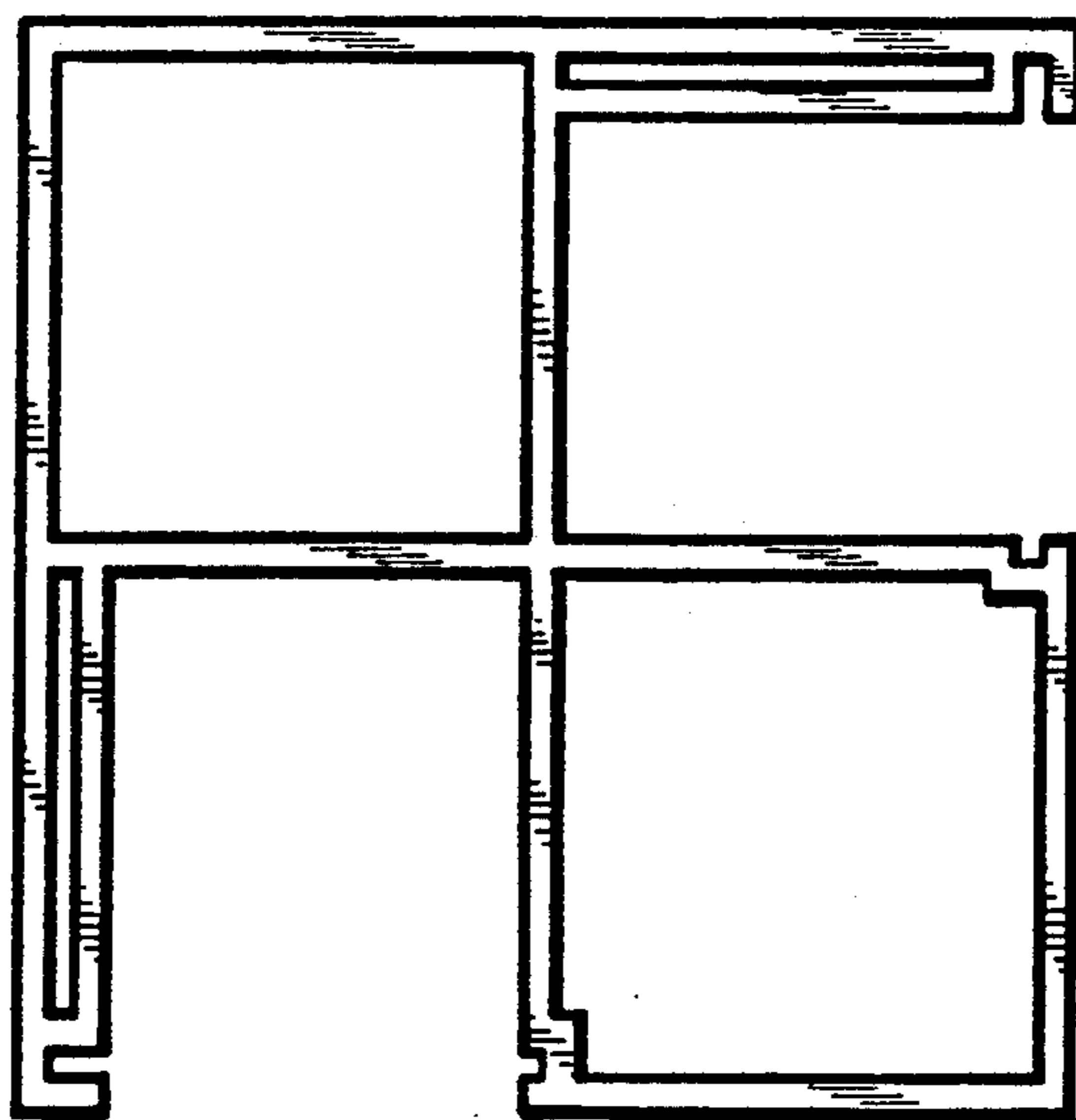

FIG. 2

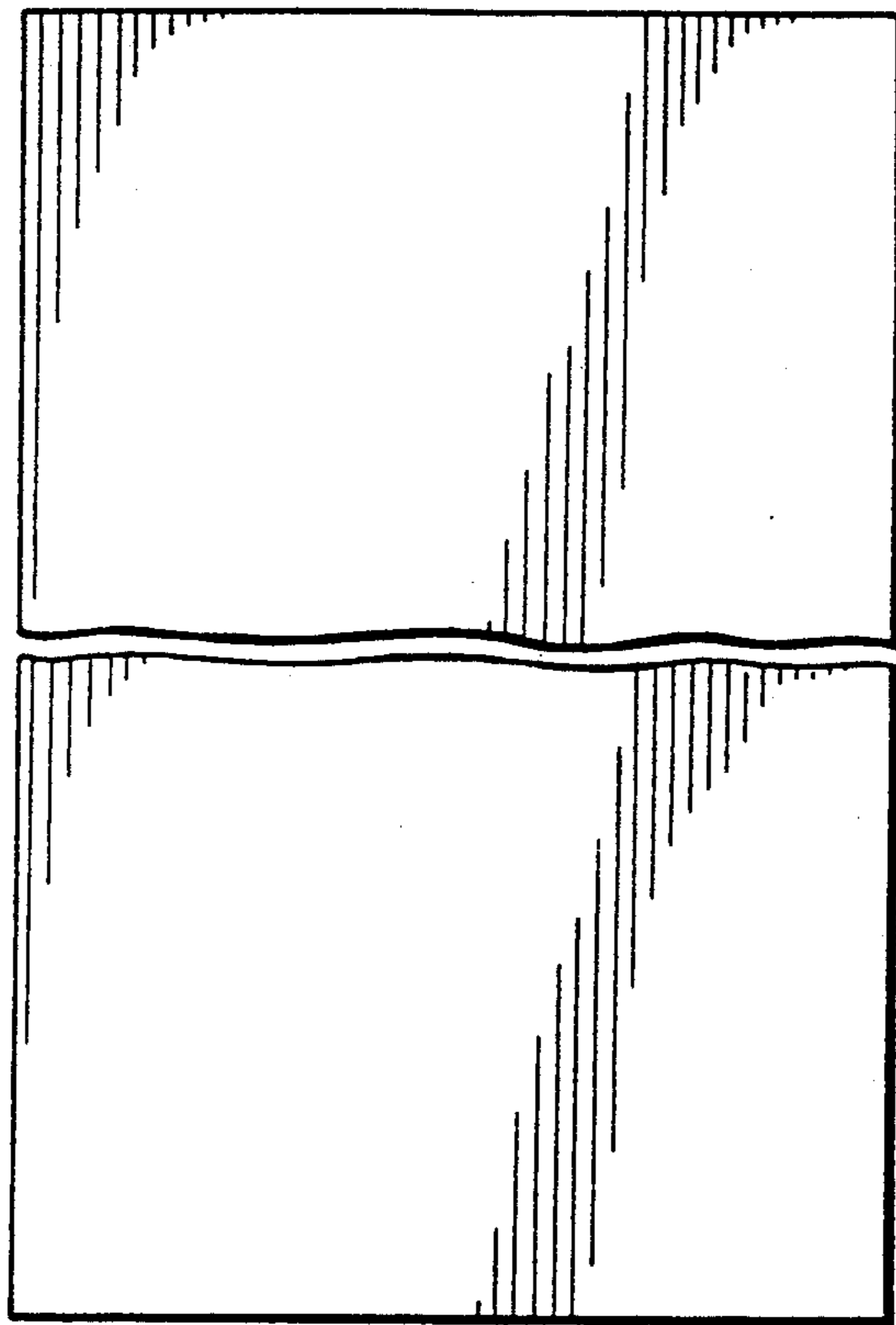

FIG. 3

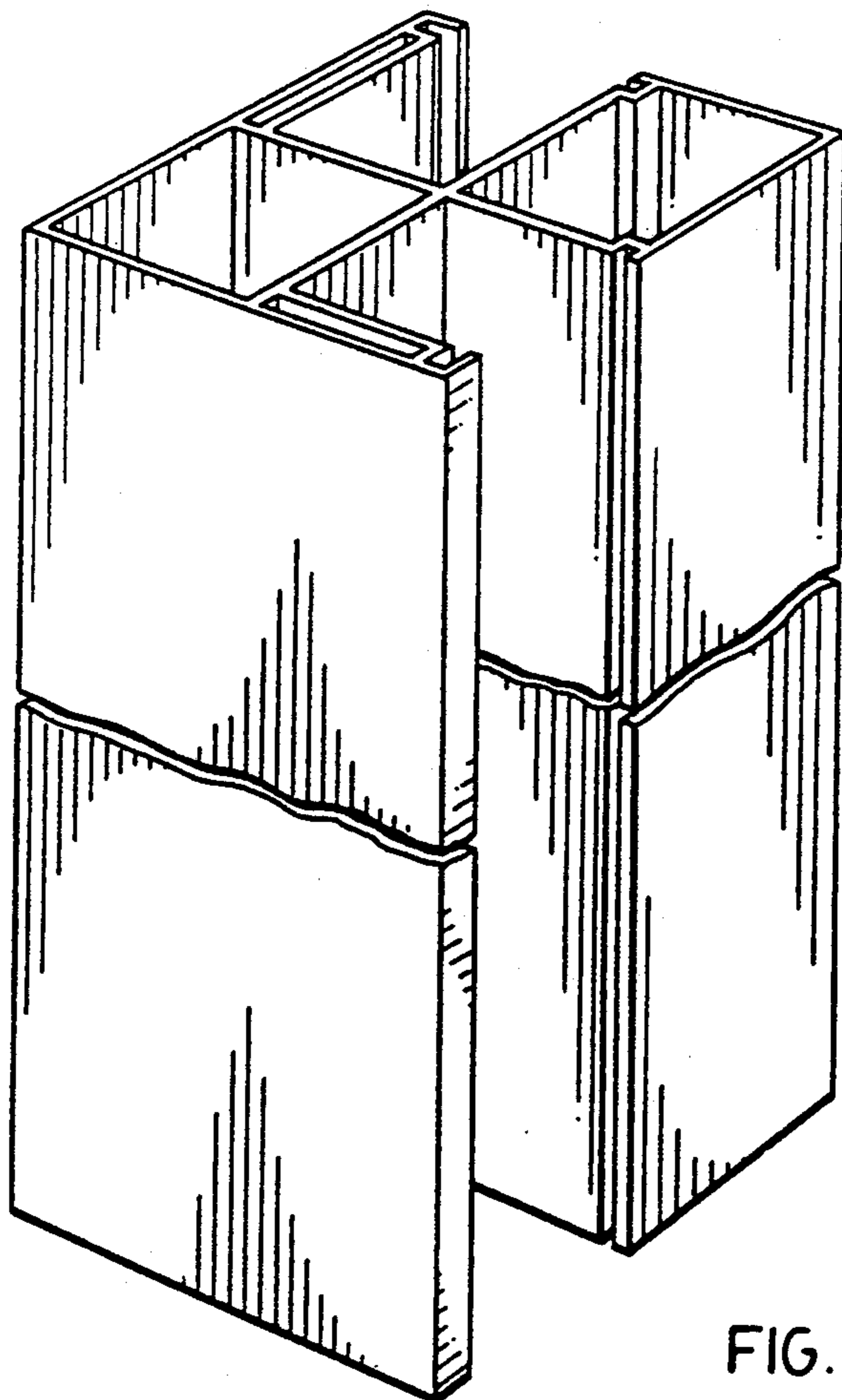

FIG. 4

