



US00D323347S

United States Patent [19]

[11] Patent Number: **Des. 323,347**

Vlassich

[45] Date of Patent: **** Jan. 21, 1992**

[54] **PERPETUAL CALENDAR**

3,984,107 10/1976 Nelson 40/109 X

[76] Inventor: **Marcelo Vlassich**, Av. Mitre 5980, Wilde, Prov. Buenos Aires, Argentina, 1875

Primary Examiner—Wallace R. Burke
Assistant Examiner—Pamela Schmidt
Attorney, Agent, or Firm—Anthony A. O'Brien

[**] Term: **14 Years**

[57] **CLAIM**

[21] Appl. No.: **460,730**

The ornamental design for a perpetual calendar, as shown and described.

[22] Filed: **Jan. 4, 1990**

DESCRIPTION

[30] **Foreign Application Priority Data**

Aug. 8, 1989 [AR] Argentina 55.321

[52] U.S. Cl. **D19/25**

[58] Field of Search **D19/20-25;**
283/2, 3, 1 A, 4; D3/56, 57; 40/107, 109, 118,
113, 115, 111; 229/92.8

FIG. 1 is a top perspective view of a perpetual calendar showing my new design;
FIG. 2 is a top perspective view thereof, shown with the card portion partially displaced for clarity of illustration only;
FIG. 3 is a front elevational view thereof;
FIG. 4 is a rear elevational view thereof;
FIG. 5 is a cross-sectional view taken along line 5—5 of FIG. 3, with the sectional dimensions shown on an enlarged scale; and
FIG. 6 is a front elevational view of a second embodiment of FIG. 1, the only difference residing in the notched features.

[56] **References Cited**

U.S. PATENT DOCUMENTS

866,172 9/1907 Westphall 229/92.8 X
1,266,610 5/1918 Moerk 40/109
2,051,264 8/1936 Maddock 40/109
2,335,713 11/1943 Vogel 40/109

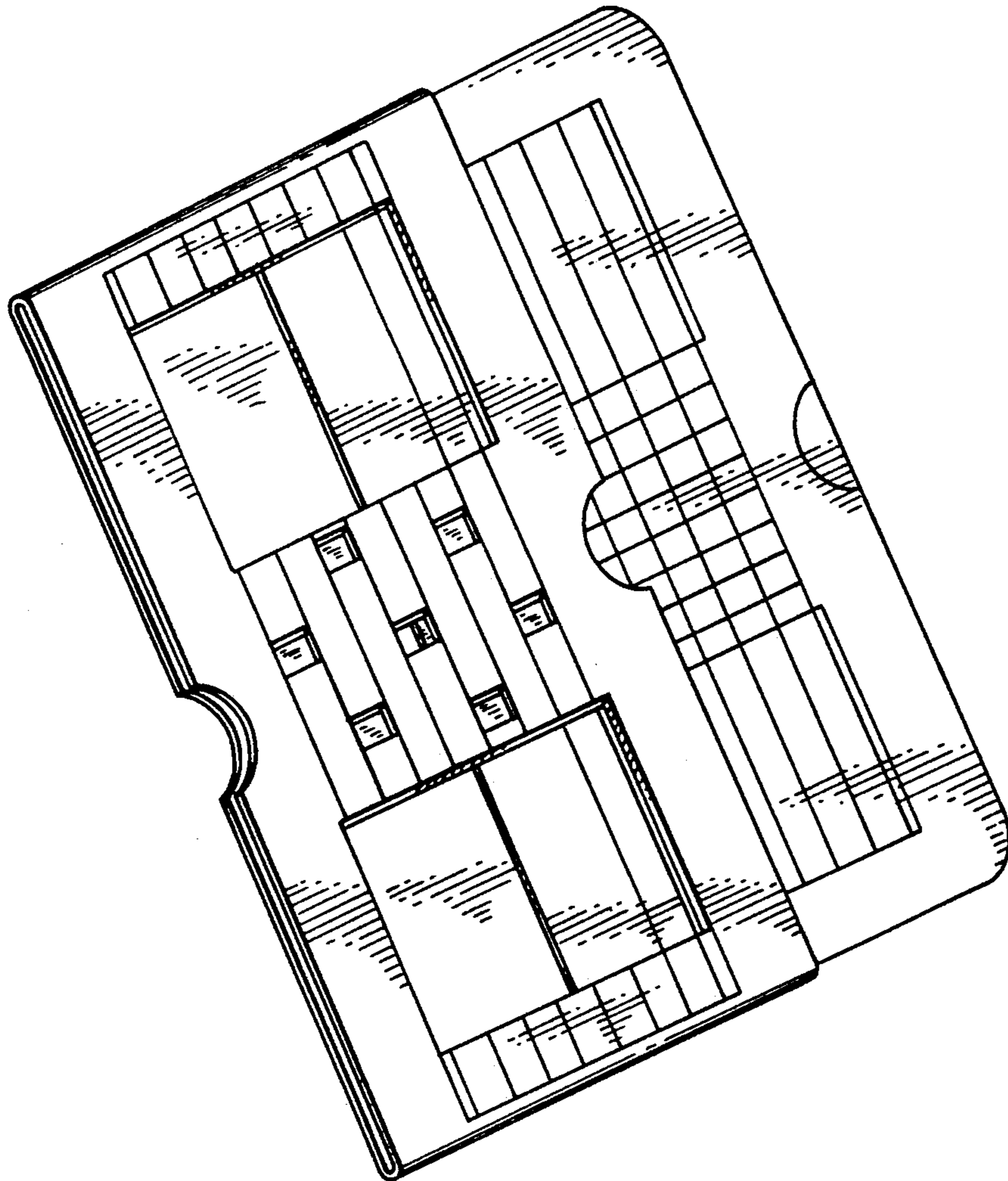

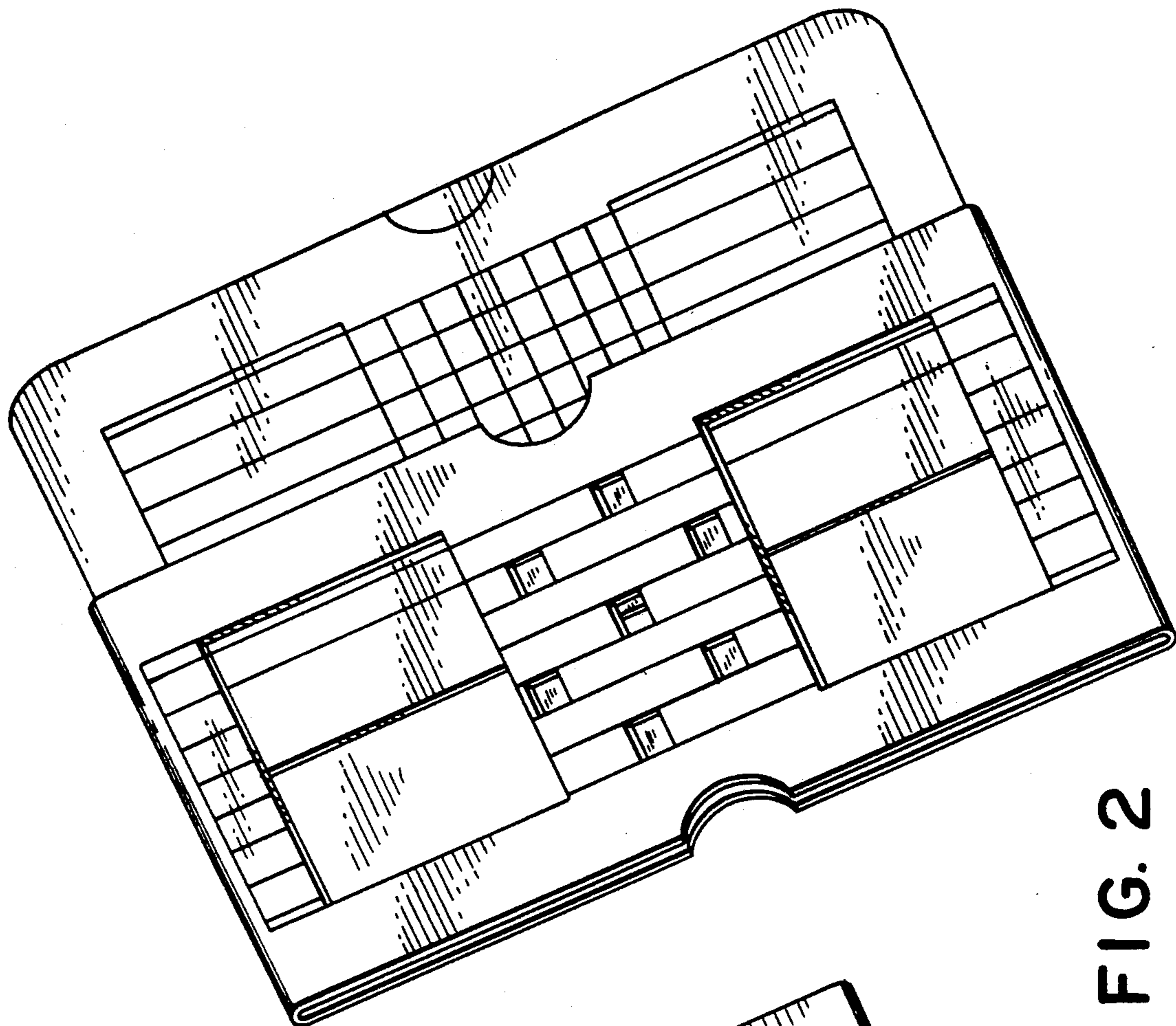

FIG. 2

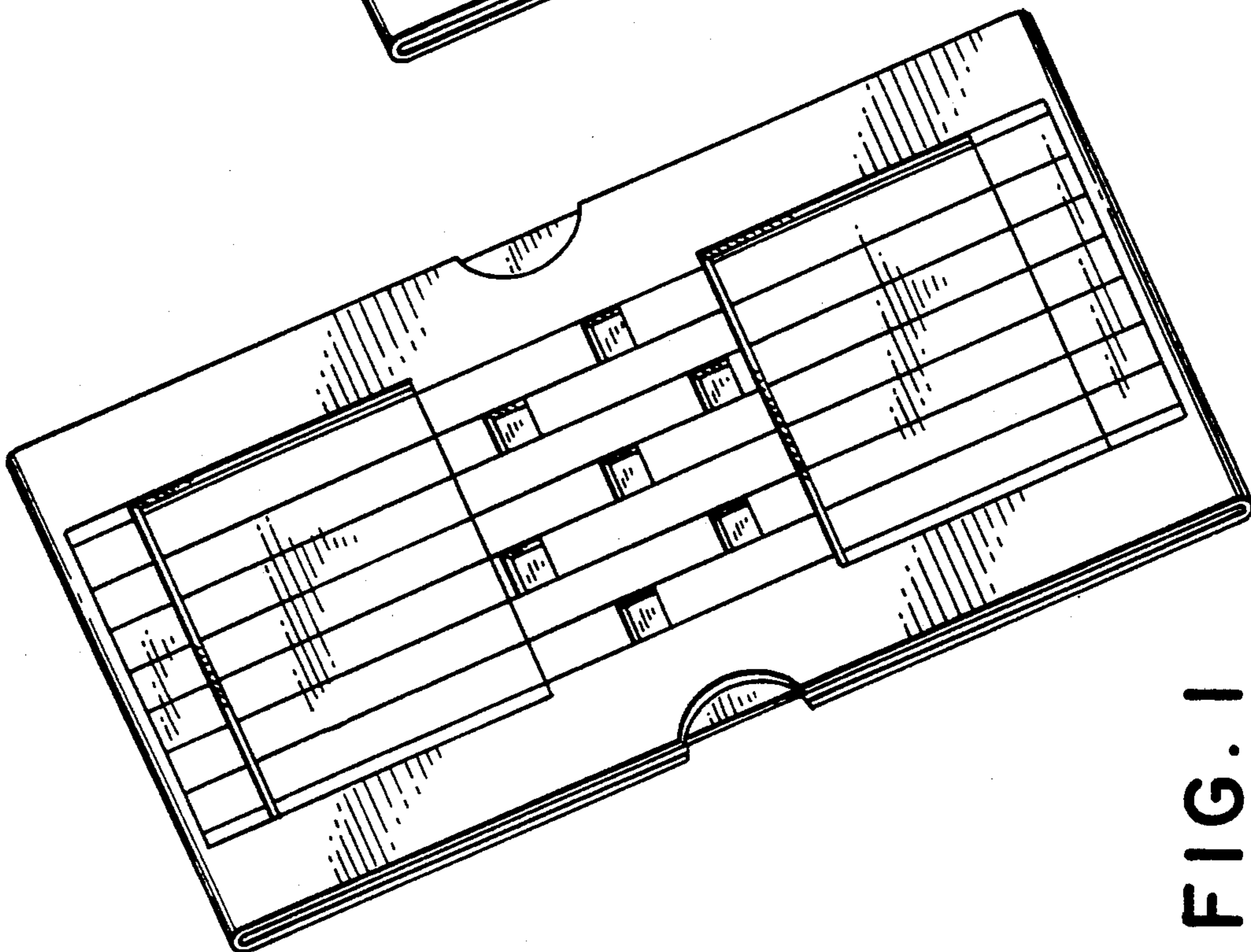

FIG. 1

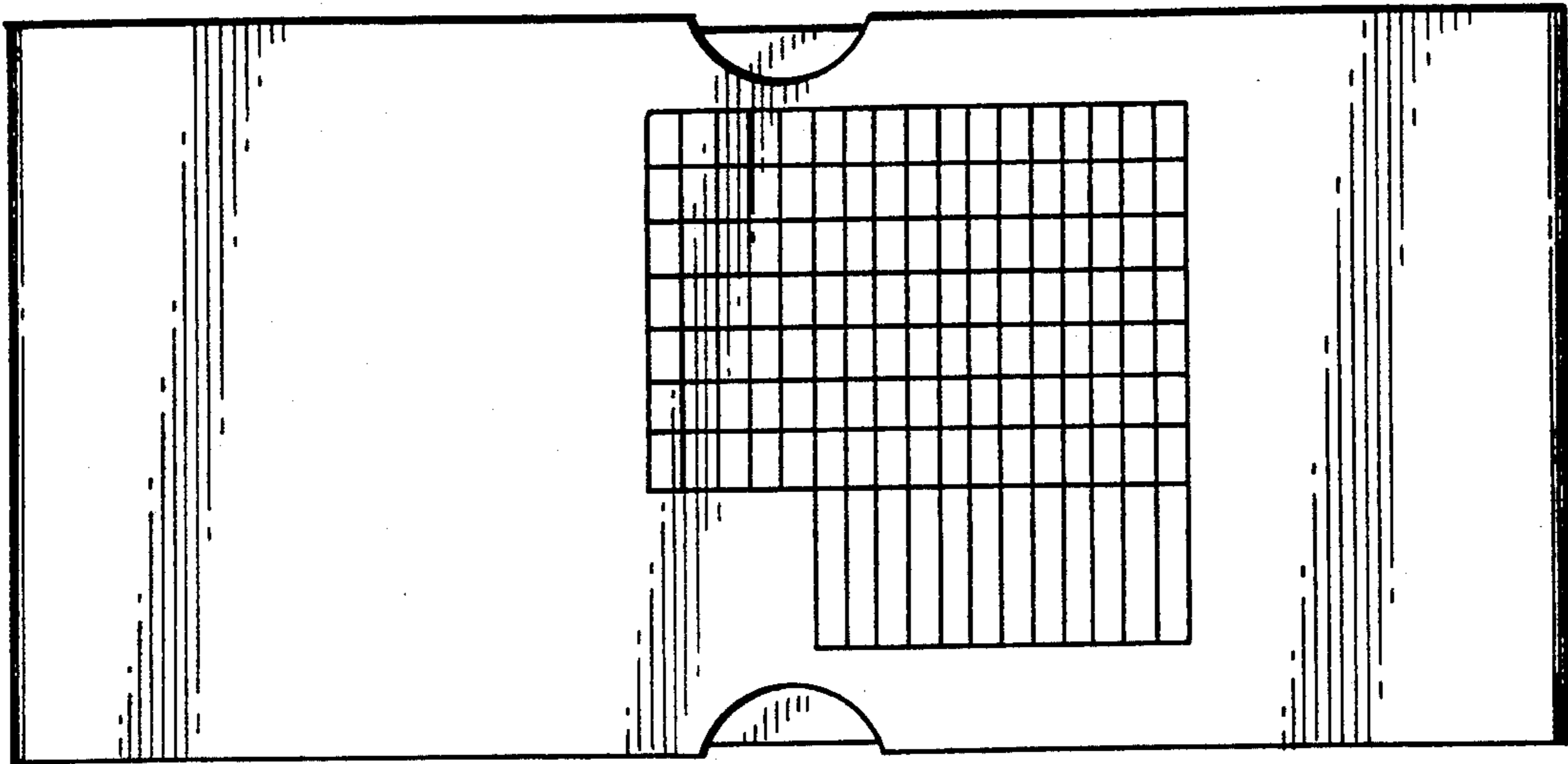

FIG. 4

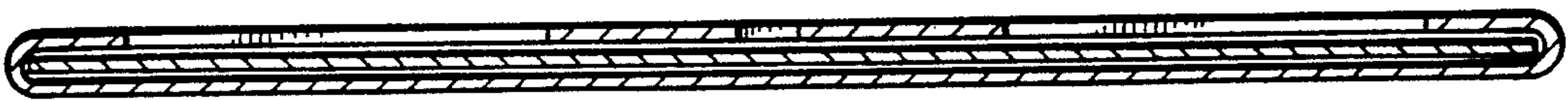

FIG. 5

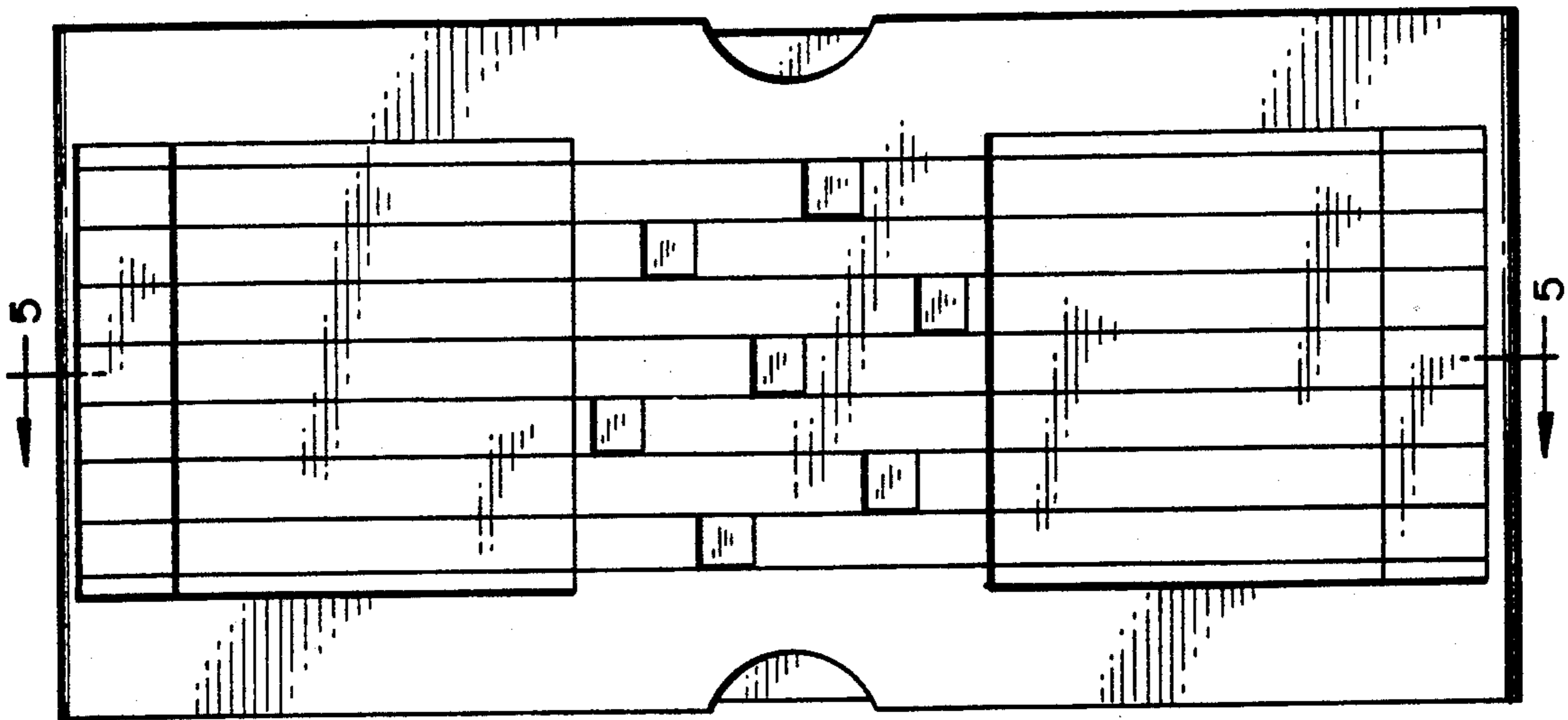

FIG. 3

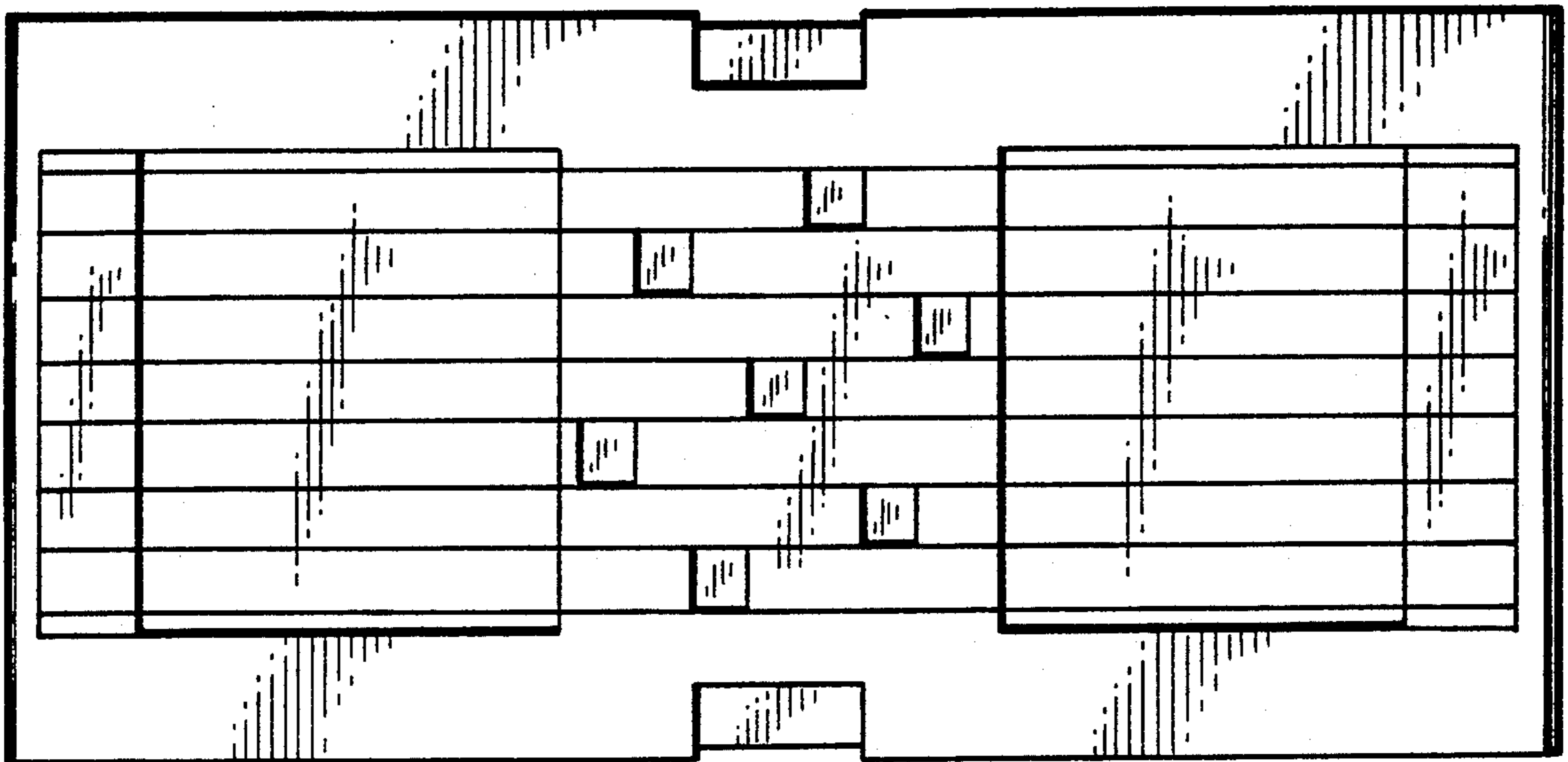

FIG. 6