

[54] TEA BREWER

[75] Inventor: Maurice J. Dust, Springfield, Ill.

[73] Assignee: Bunn-O-Matic Corporation,
Springfield, Ill.

[**] Term: 14 Years

[21] Appl. No.: 261,184

[22] Filed: Oct. 24, 1988

[52] U.S. Cl. D7/309; D7/311

[58] Field of Search D7/300, 301, 305, 306-309,
D7/311-313; 99/307, 295, 305

[56] References Cited

U.S. PATENT DOCUMENTS

D. 274,029 5/1984 Daugherty D7/309
D. 292,468 10/1987 Ryan, Jr. D7/309
4,829,888 5/1989 Webster et al. 99/284

OTHER PUBLICATIONS

Jet Spray® Buyer's Guide, "Jethot"® Instant Hot Water Dispenser, Model JH1—shown on front and back of flyer.

Primary Examiner—Winifred E. Herrmann
Attorney, Agent, or Firm—Richard Bushnell

[57] CLAIM

The ornamental design for a tea brewer, as shown and described.

DESCRIPTION

FIG. 1 is a top, front, and left side perspective view of a tea brewer showing my new design; FIG. 2 is a left side elevation thereof; FIG. 3 is a front elevation thereof; FIG. 4 is a right side elevation thereof; FIG. 5 is a rear elevation thereof; FIG. 6 is a top plan view thereof; and FIG. 7 is a bottom plan view thereof.

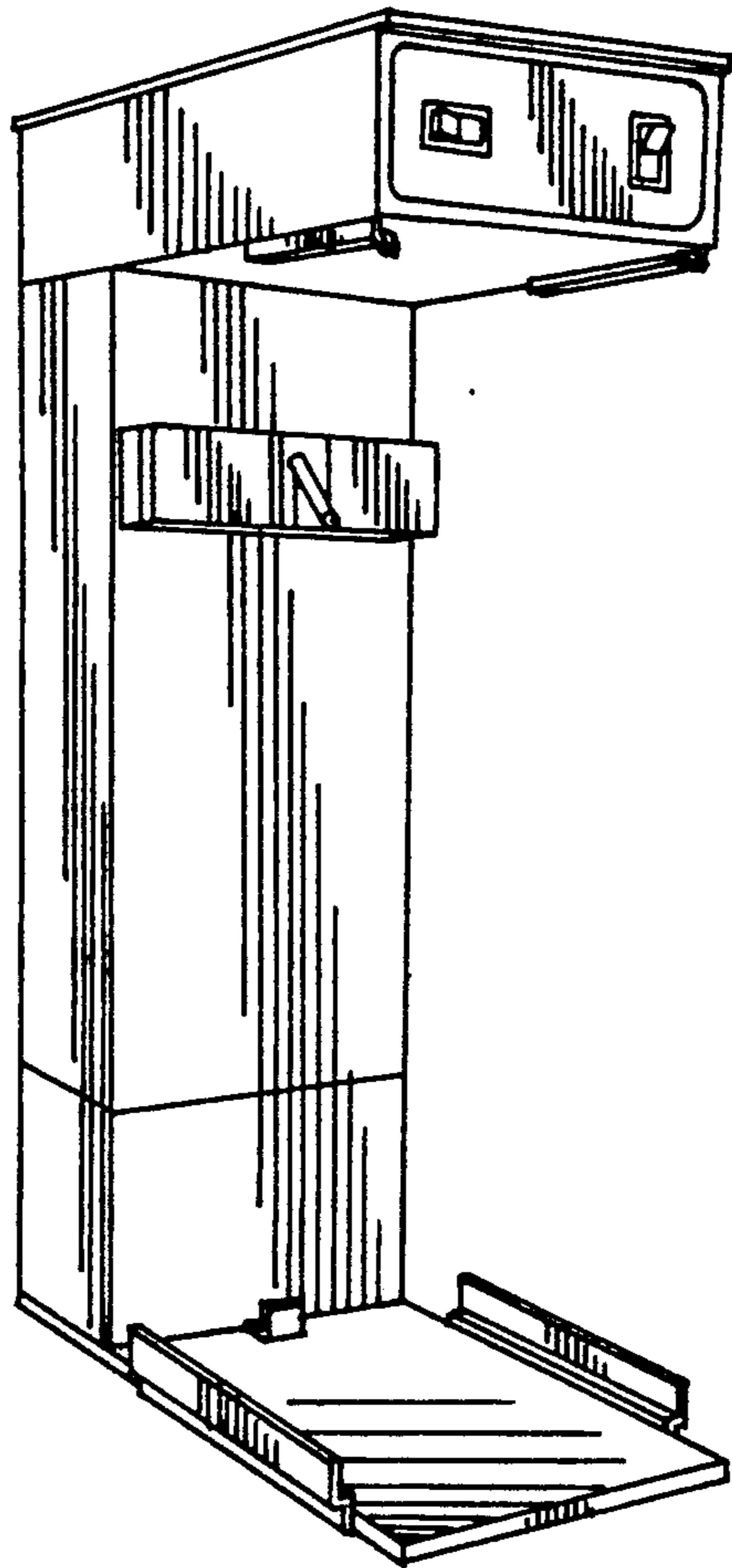

FIG. 1.

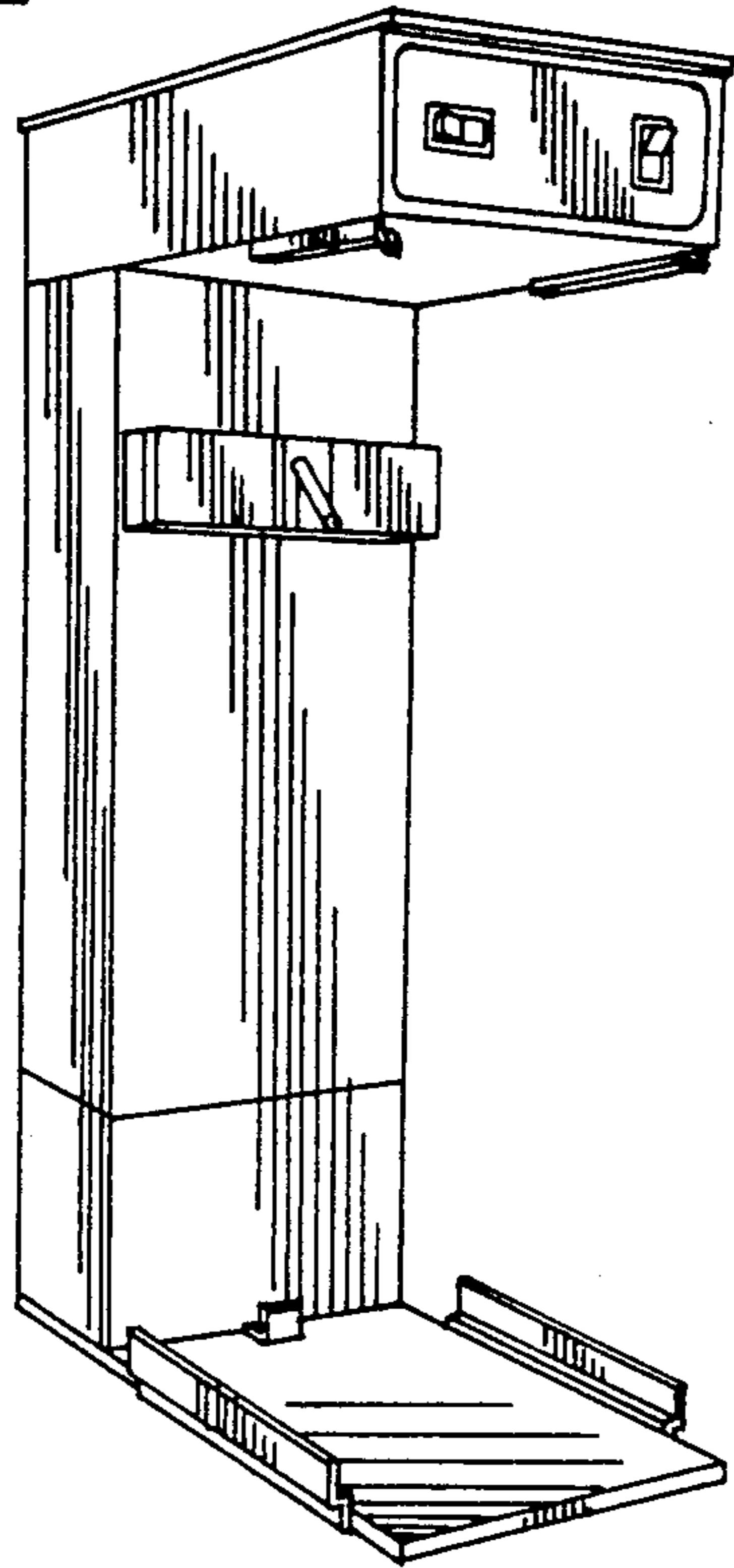

FIG. 2.

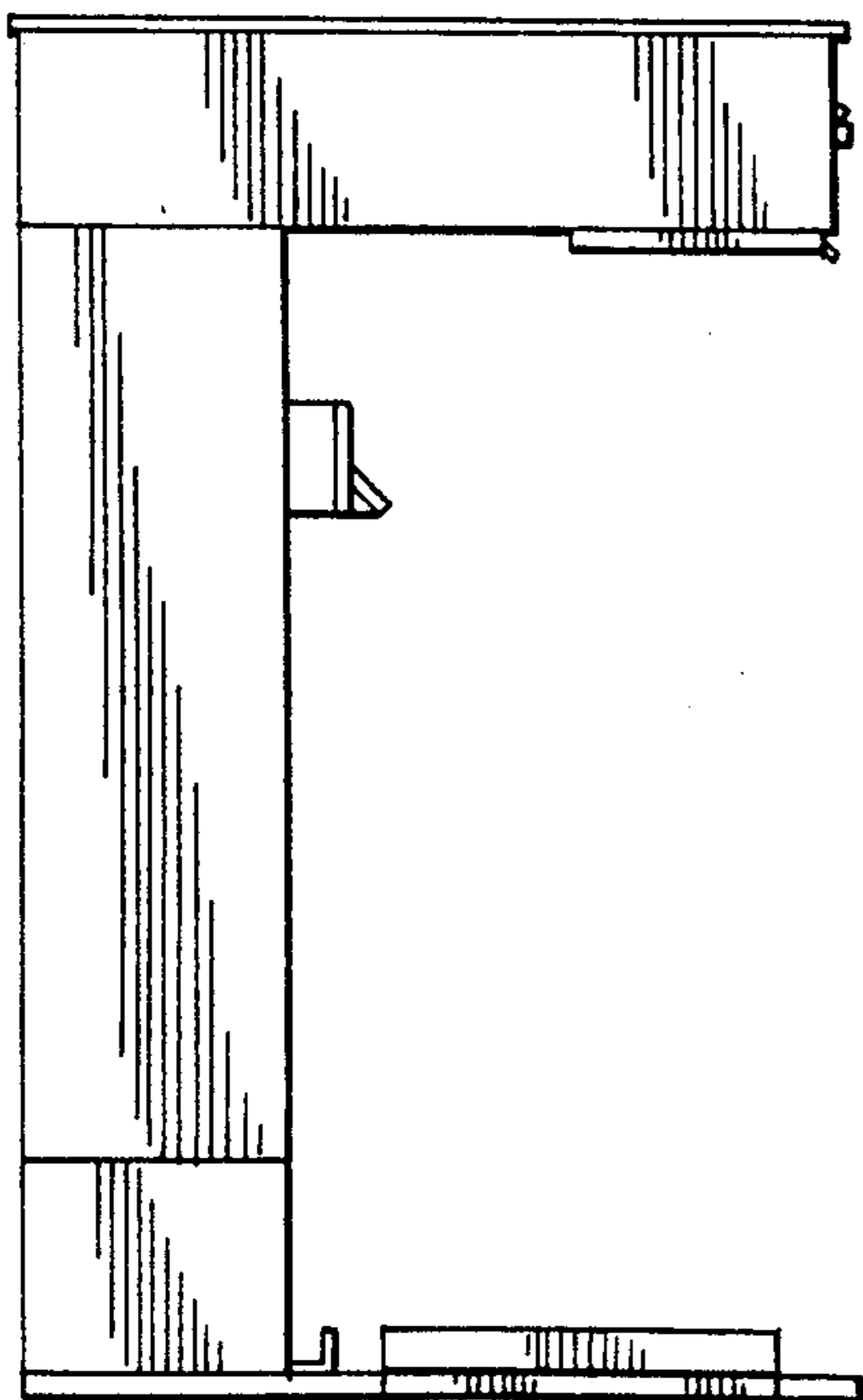

FIG. 3.

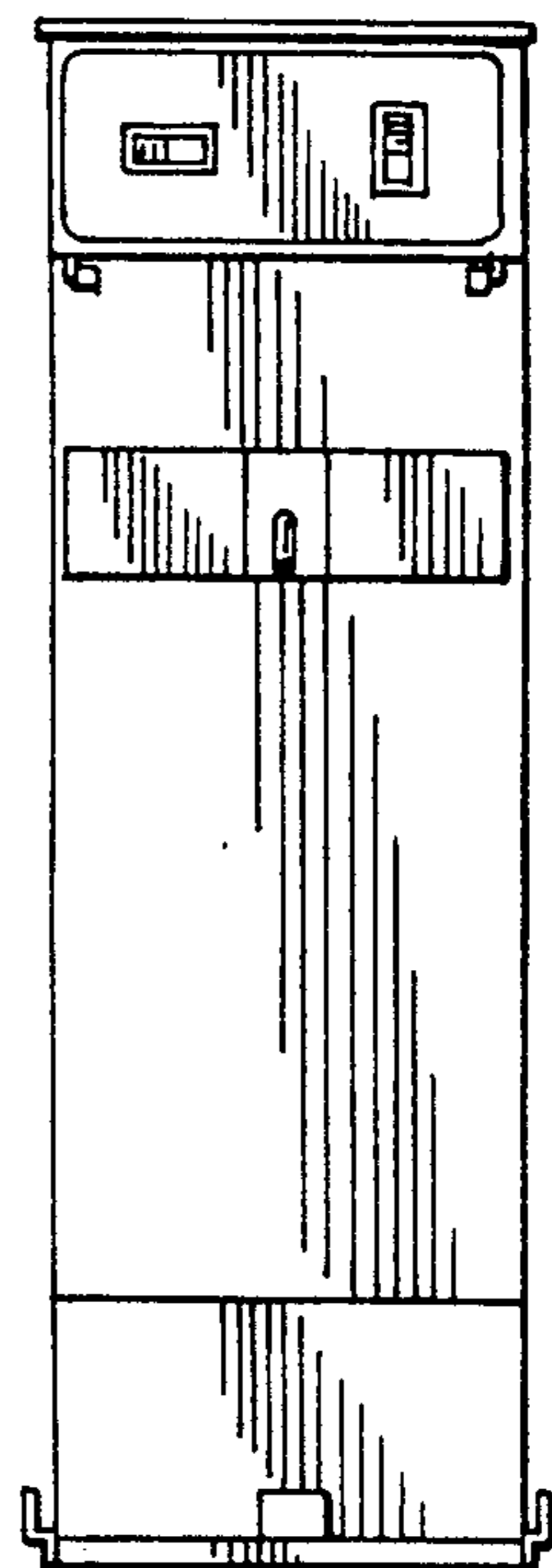

FIG. 4.

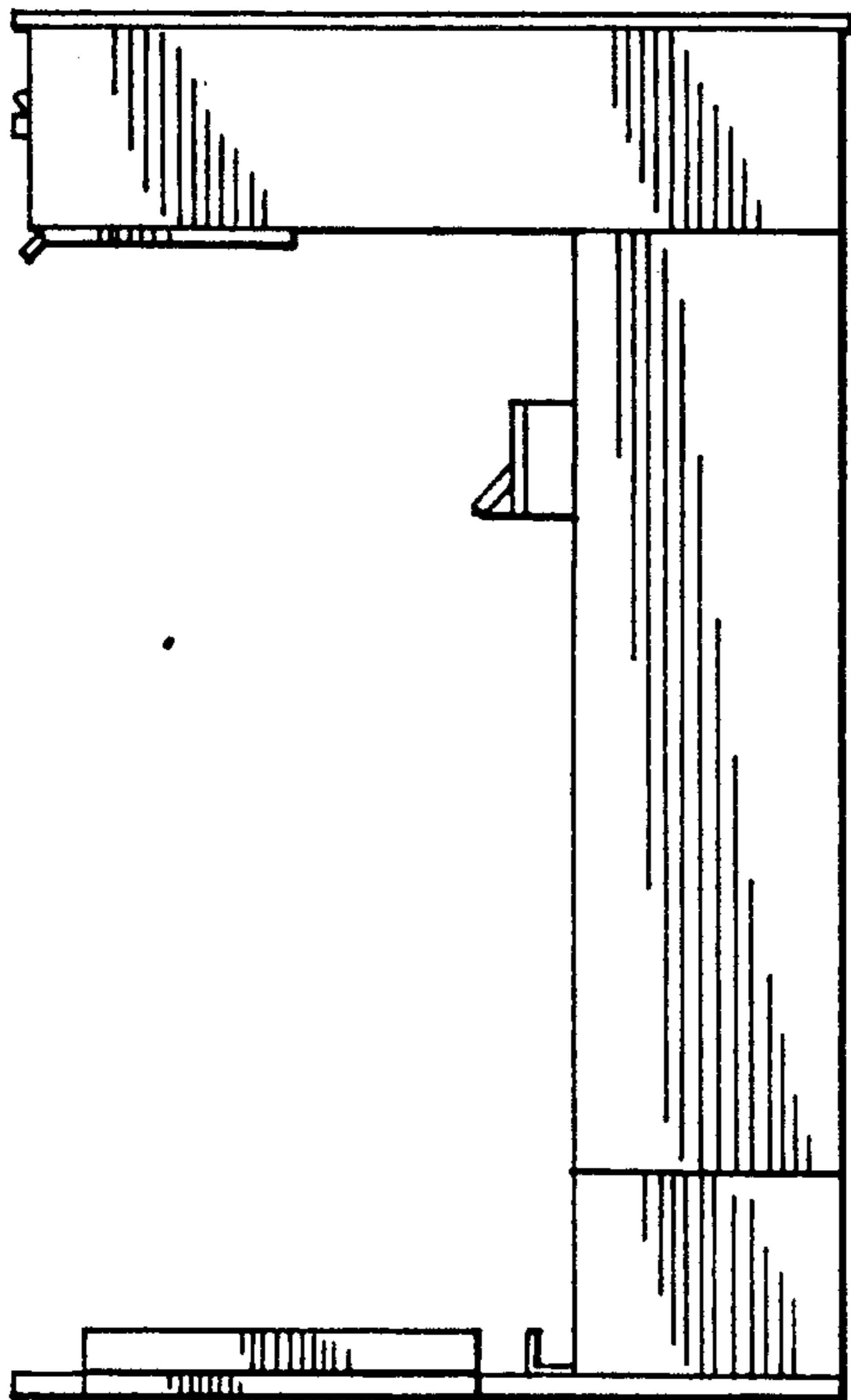

FIG. 5.

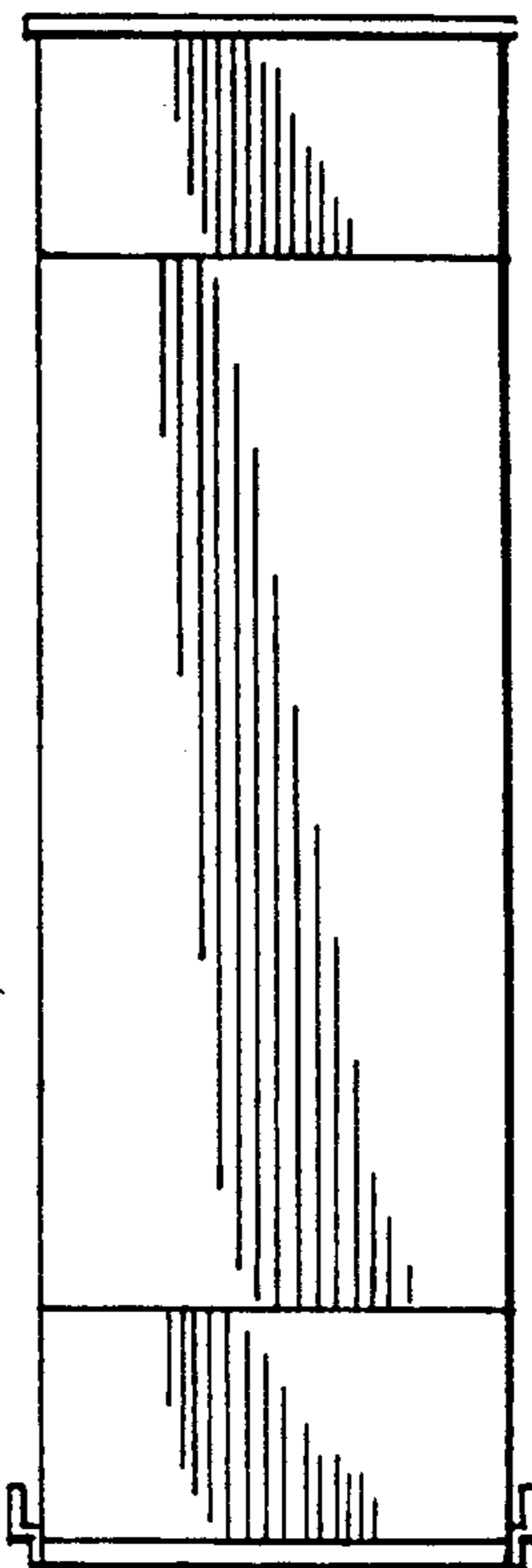

FIG. 6.

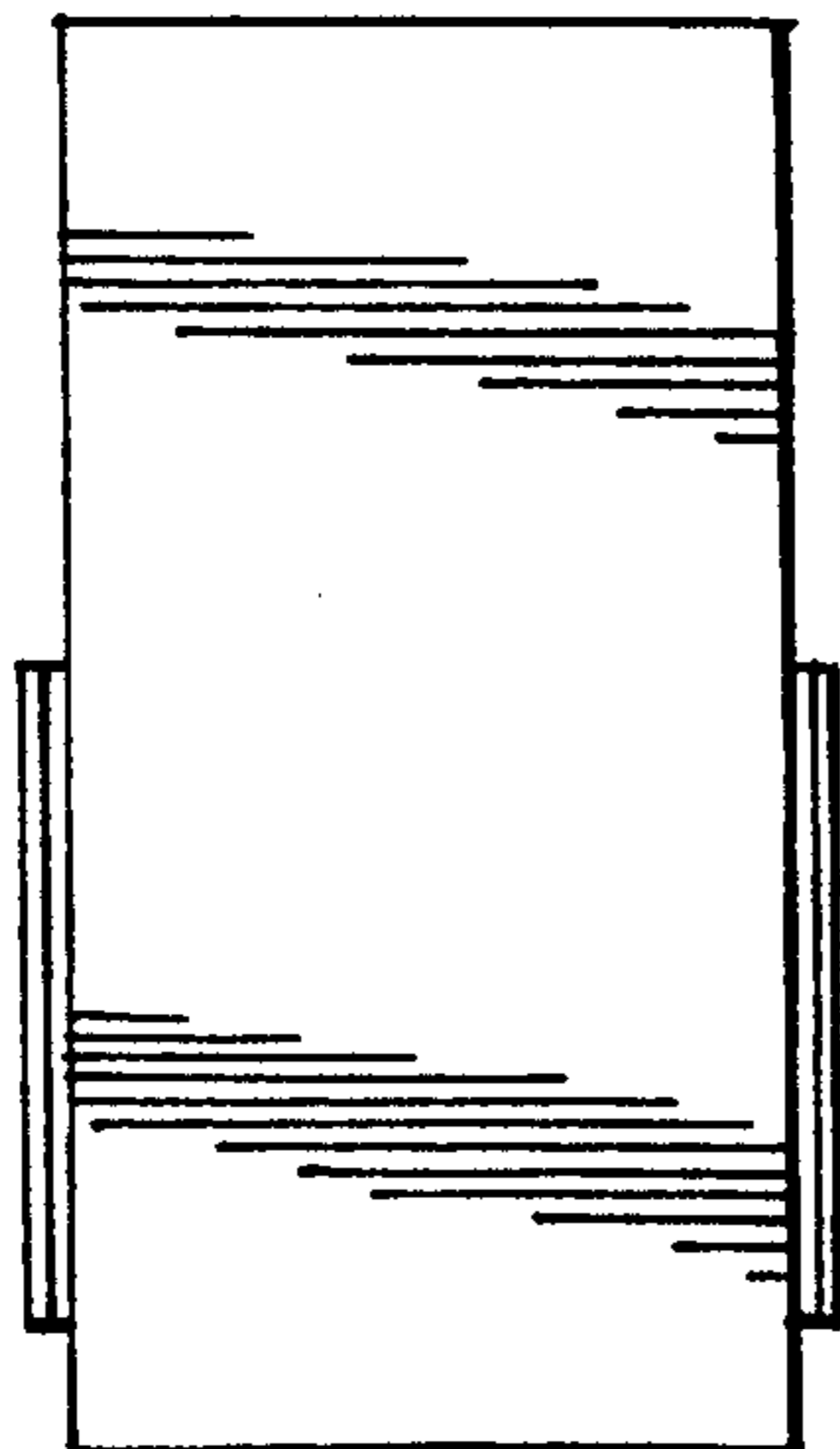

FIG. 7.

