

[54] **ACTIVITY DISPLAY PANEL FOR A DATA PROCESSOR OR THE LIKE**

[75] Inventors: **Jack M. King**, Towanda; **Robert T. Harvey**, Wichita, both of Kans.

[73] Assignee: **NCR Corporation**, Dayton, Ohio

[**] Term: **14 Years**

[21] Appl. No.: **322,819**

[22] Filed: **Mar. 10, 1989**

[52] U.S. Cl. **D14/113**

[58] Field of Search **D14/100, 101, 106, 113, D14/125, 126; 340/700, 706, 711, 712, 713; 341/22, 23; 358/248, 249, 254; 364/706-710; D34/28; D18/26; 178/18, 19, 20**

[56] **References Cited**

U.S. PATENT DOCUMENTS

4,459,449	7/1984	Hirata	340/713 X
4,567,480	1/1986	Blanchard	178/18 X
4,725,694	2/1988	Auer et al.	178/18
4,857,898	8/1989	Smith	341/22

Primary Examiner—Wallace R. Burke
Assistant Examiner—Freda S. Nunn
Attorney, Agent, or Firm—Wilbert Hawk, Jr.; Stephen F. Jewett; Jack R. Penrod

[57] **CLAIM**

The ornamental design for an activity display panel for a data processor or the like, as shown and described.

DESCRIPTION

FIG. 1 is a front perspective view of an activity display panel for a data processor or the like showing our new design;

FIG. 2 is a left side elevational view thereof, the right side being identical;

FIG. 3 is a top plan view thereof;

FIG. 4 is an enlarged front elevational view thereof with the activity display fully illuminated;

FIG. 5 is a front perspective view of a second embodiment of our design;

FIG. 6 is an enlarged front elevational view thereof; and

FIG. 7 is an enlarged fragmentary view of the upper portion of the panel appearing in both the first and the second embodiment, thus showing representative operation.

The broken lines shown in FIGS. 1-6 are for illustrative purposes only and form no part of the claimed design. The characteristic feature of our design resides in the columns of indicators which are sequentially illuminated as data processing activity increases until the highest indicator in each column is reached. The front cover is translucent.

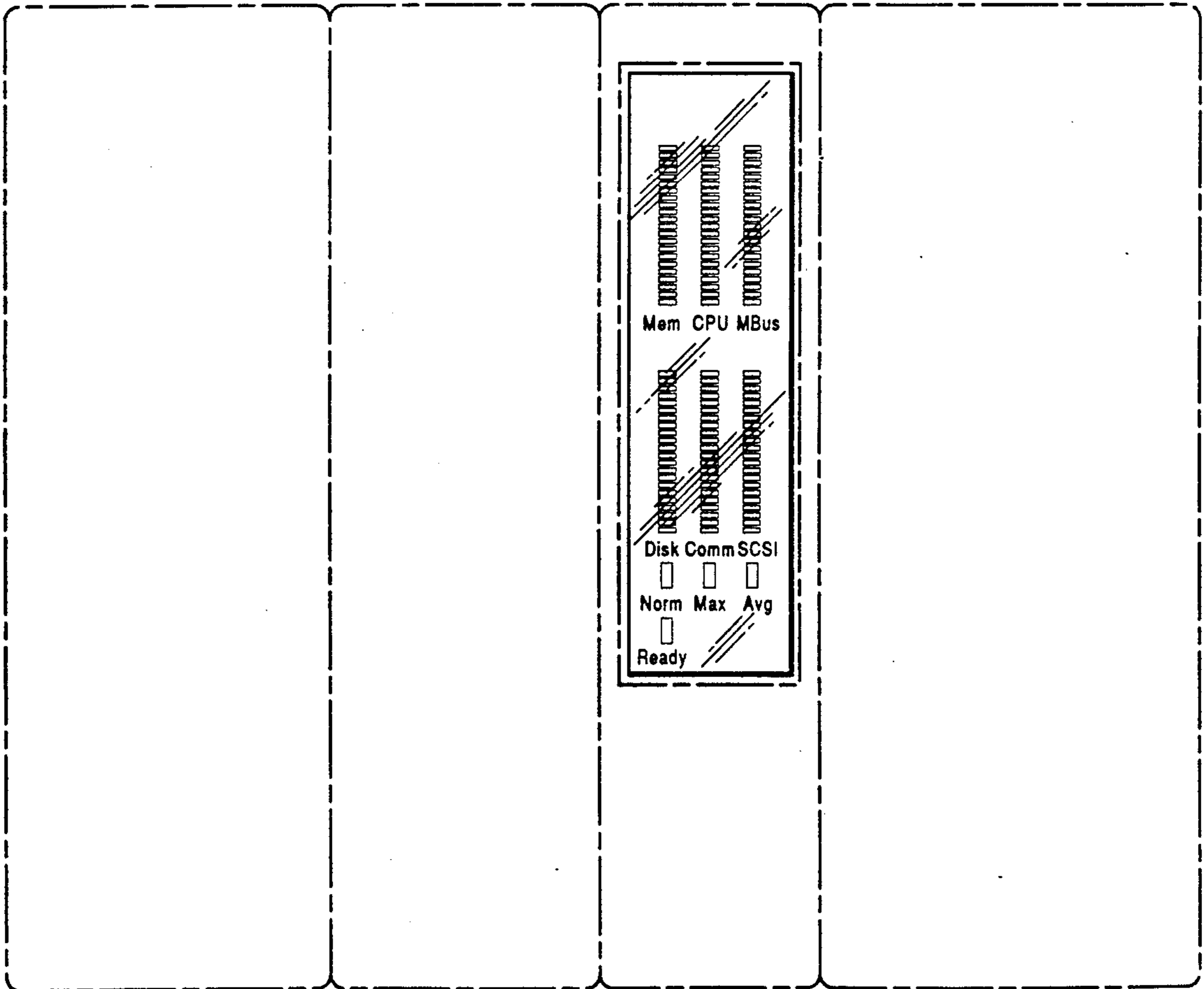

FIG. 1

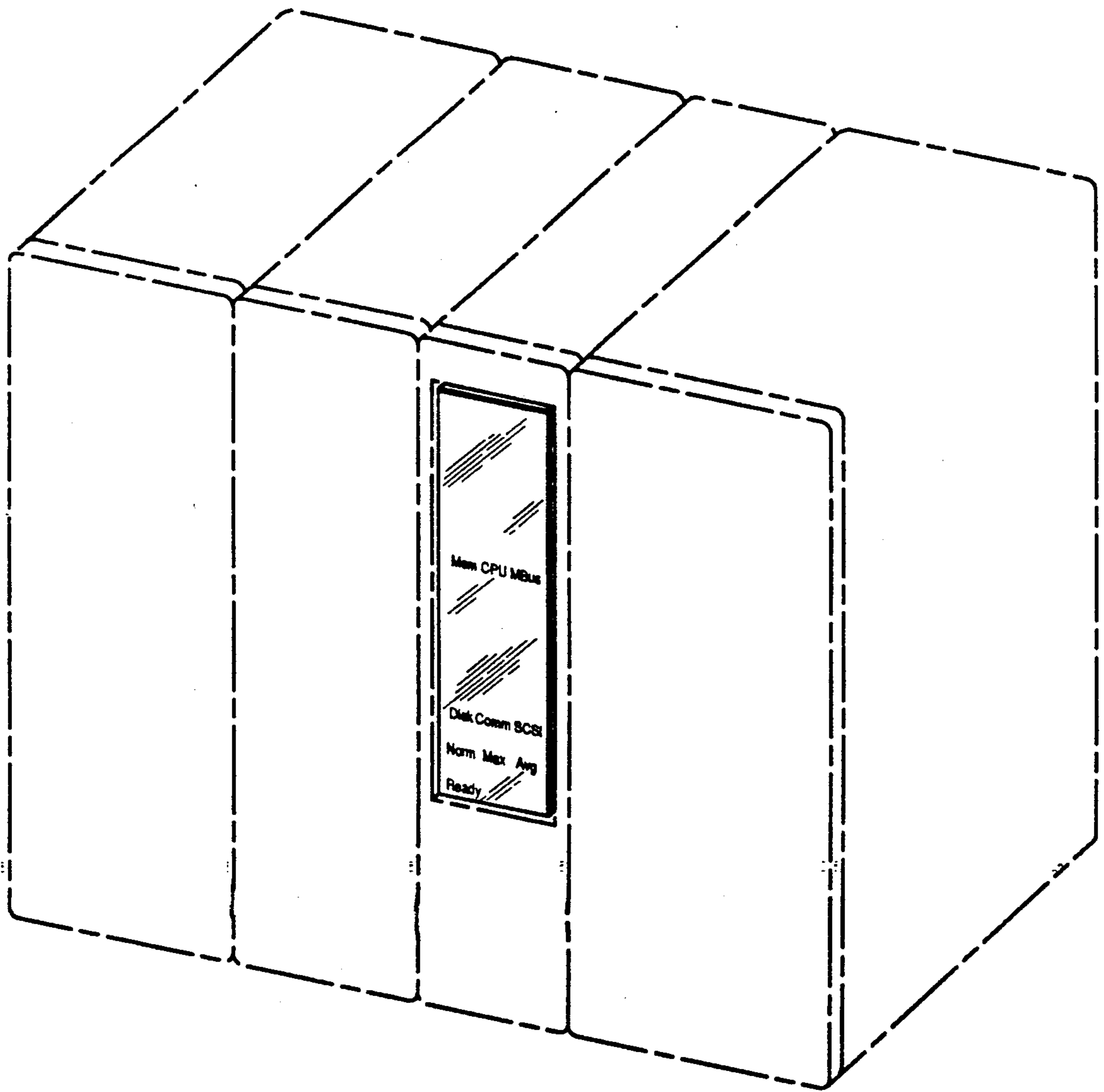

FIG. 2

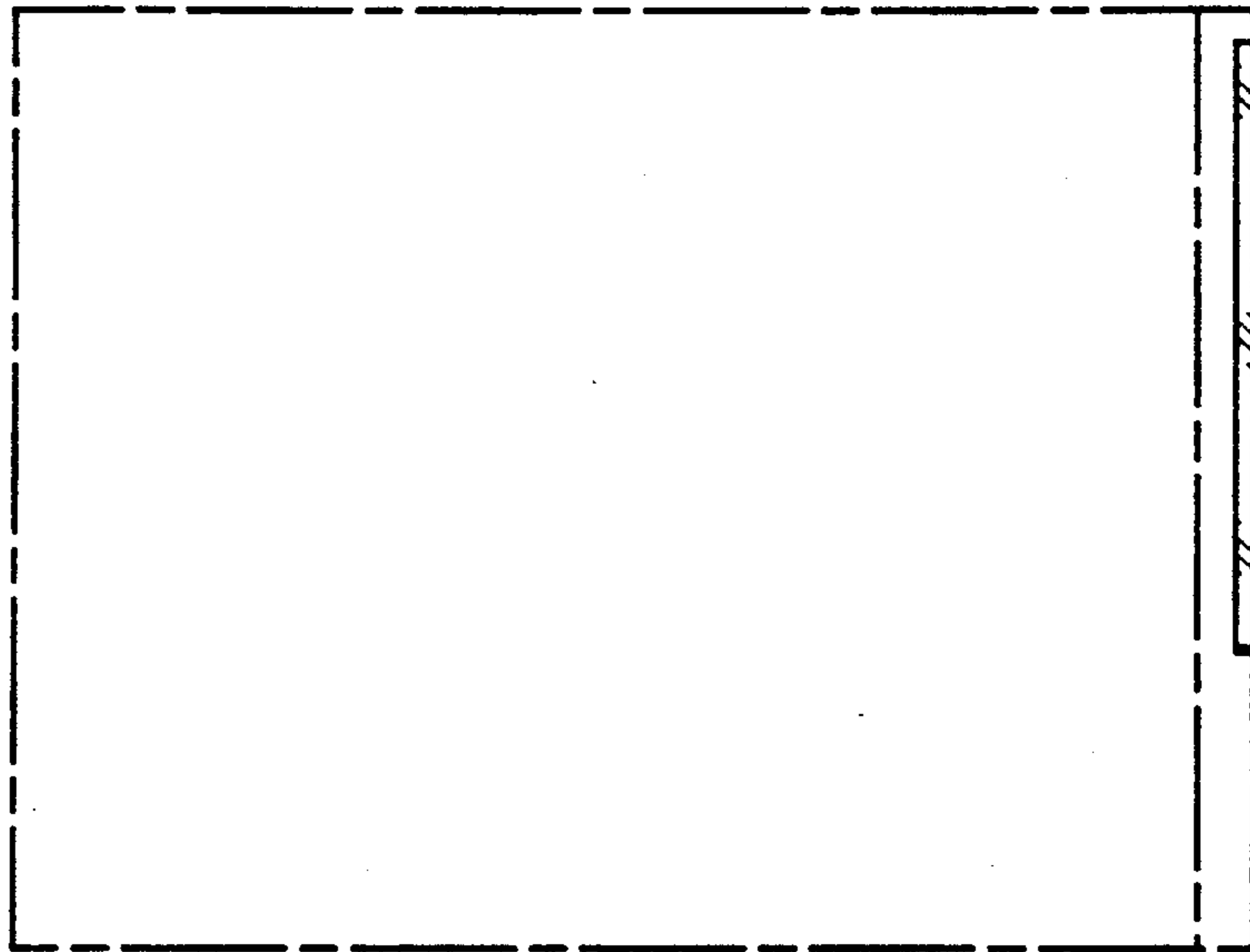

FIG. 3

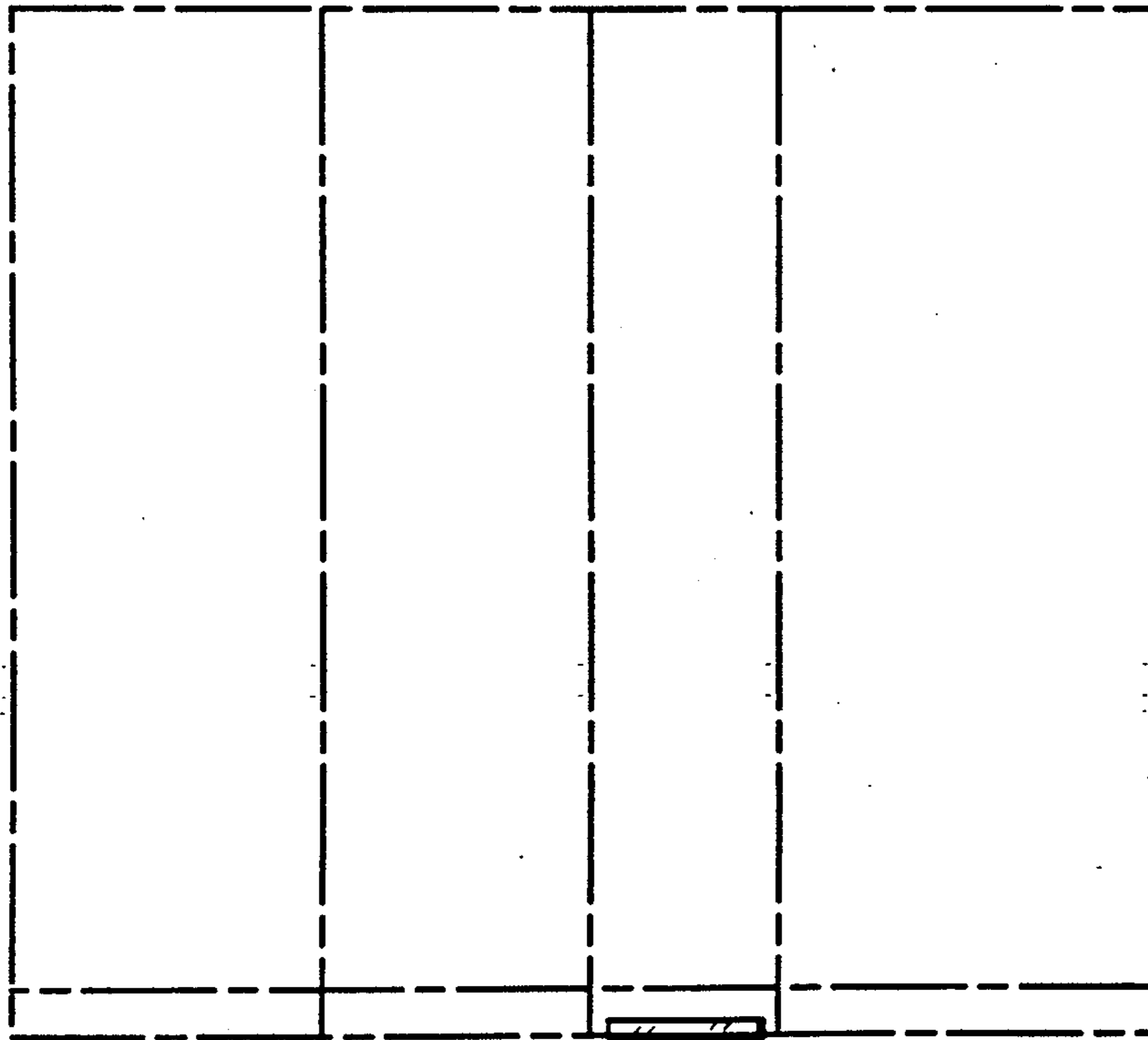

FIG. 4

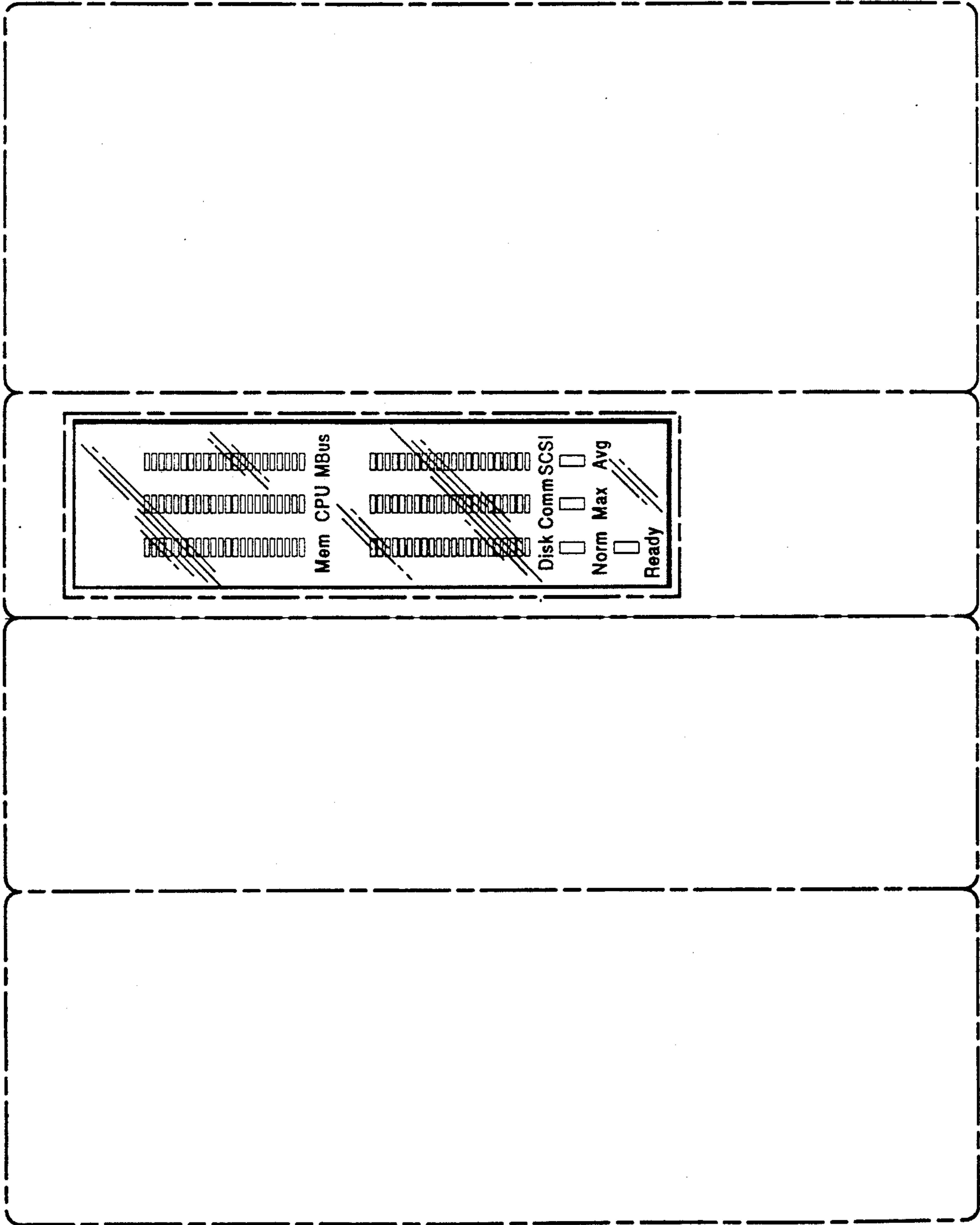
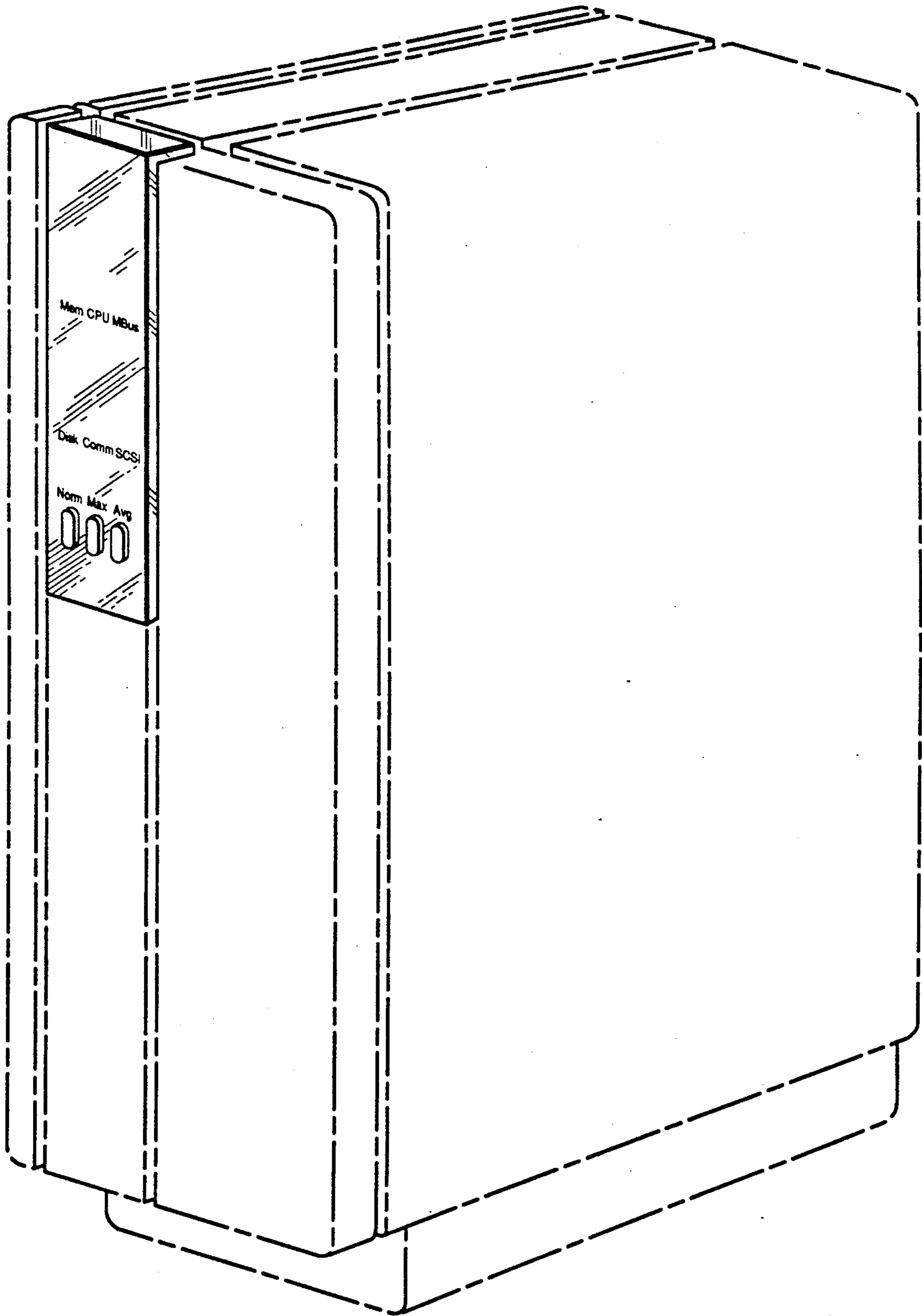

FIG. 5



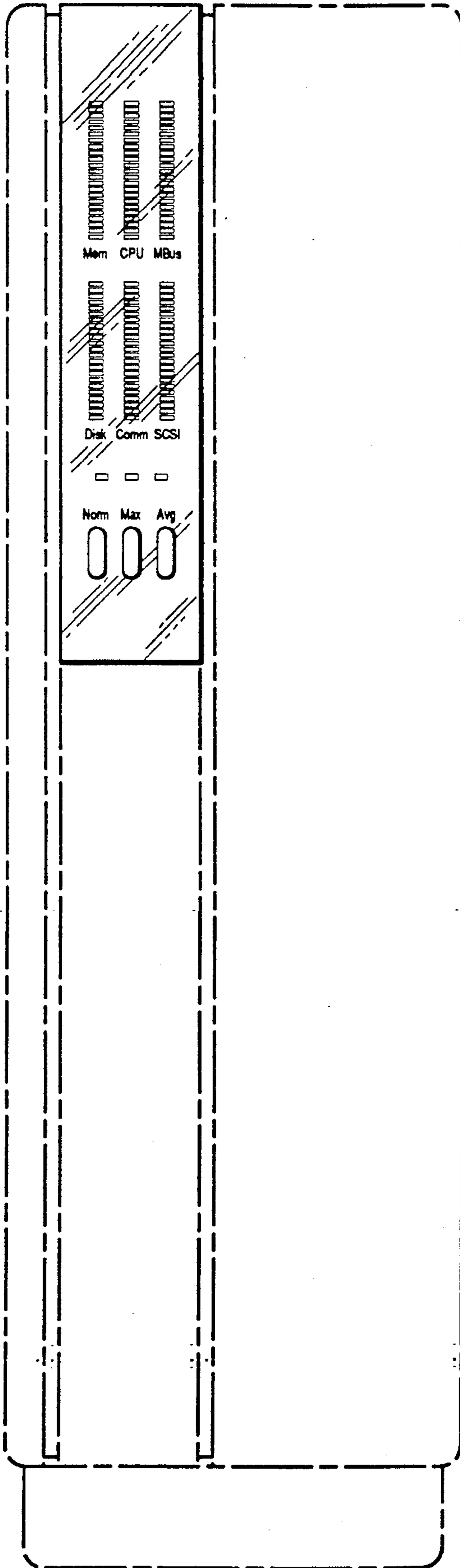

FIG. 6

FIG. 7

