

[54] RAILWAY WHEEL CONVERSION UNIT
FOR ROAD VEHICLES
[75] Inventor: Kelvin E. Styles, Glenroy, Australia
[73] Assignee: Railtrade Nominees Pty. Ltd.,
Kewdale, Australia
[**] Term: 14 Years
[21] Appl. No.: 1,533
[22] Filed: Jan. 6, 1987
[52] U.S. Cl. D12/42
[58] Field of Search D12/42, 45, 46;
105/215.2, 72.2; 280/515

[56] References Cited
U.S. PATENT DOCUMENTS
3,421,779 .1/1969 Shelby 280/515
3,704,671 12/1972 Horne, Jr. et al. 105/215.2
4,488,494 12/1984 Powell, Sr. 105/215.2
4,583,465 4/1986 Powell, Sr. 105/215.2
FOREIGN PATENT DOCUMENTS
323247 7/1920 Fed. Rep. of Germany ... 105/215.2

Primary Examiner—James M. Gandy
Assistant Examiner—Melody Brown
Attorney, Agent, or Firm—Kerkam, Stowell, Kondracki
& Clarke

[57] CLAIM
The ornamental design for a railway wheel conversion unit for road vehicles, as shown.

DESCRIPTION
FIG. 1 is an exploded perspective view of a railway wheel conversion unit for road vehicles showing my new design;
FIG. 2 is a top rear perspective view of one section of the railway wheel conversion unit shown separately for clarity of illustration;
FIG. 3 is a top perspective view of FIG. 2;
FIG. 4 is a rear perspective view of FIG. 2;
FIG. 5 is a side perspective view of FIG. 2;
FIG. 6 is a bottom perspective view of the second section of the railway wheel conversion unit shown separately for clarity of illustration;
FIG. 7 is a side perspective view of FIG. 6;
FIG. 8 is a rear perspective view of FIG. 6; and
FIG. 9 is a top rear perspective view of FIG. 6.

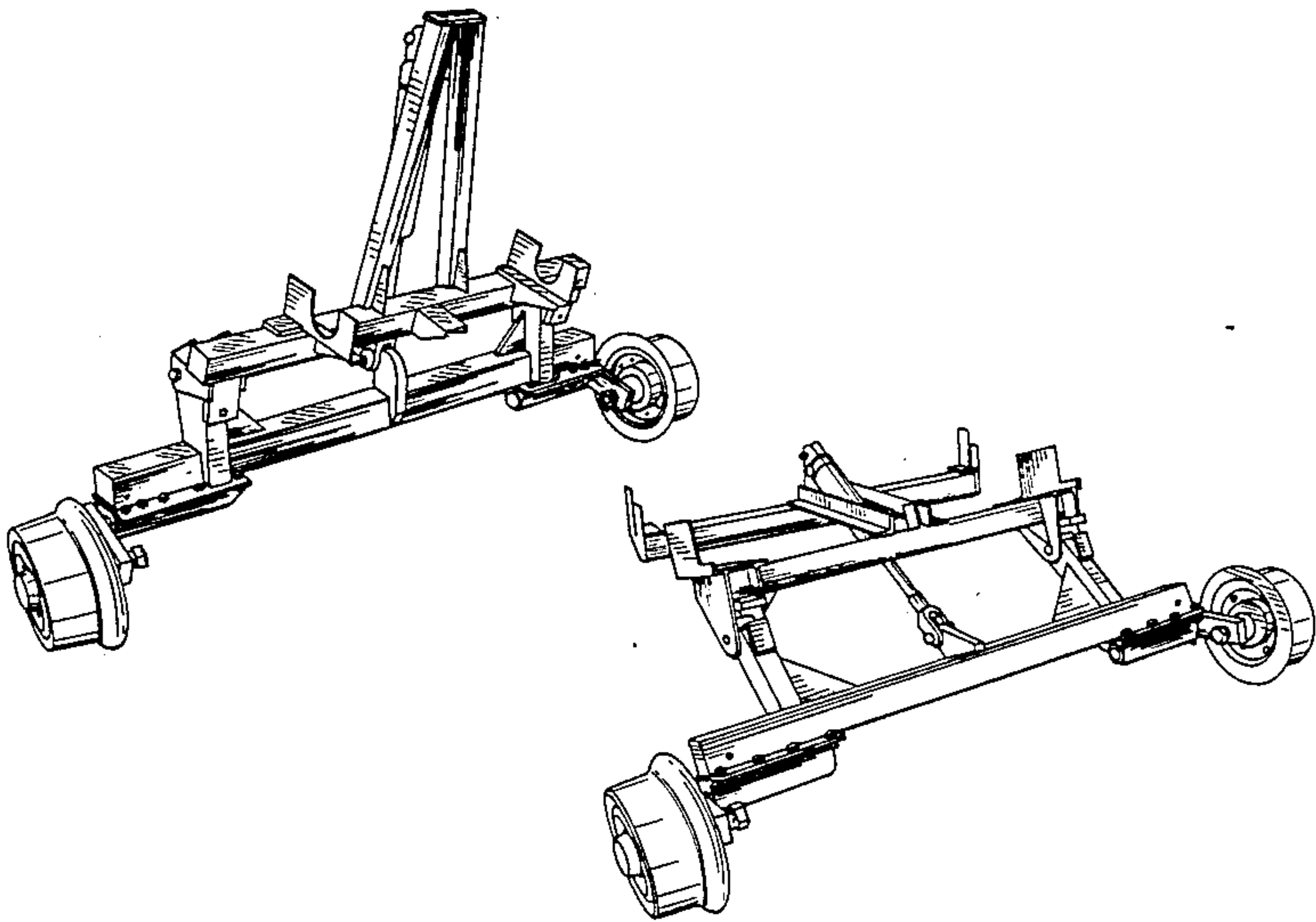

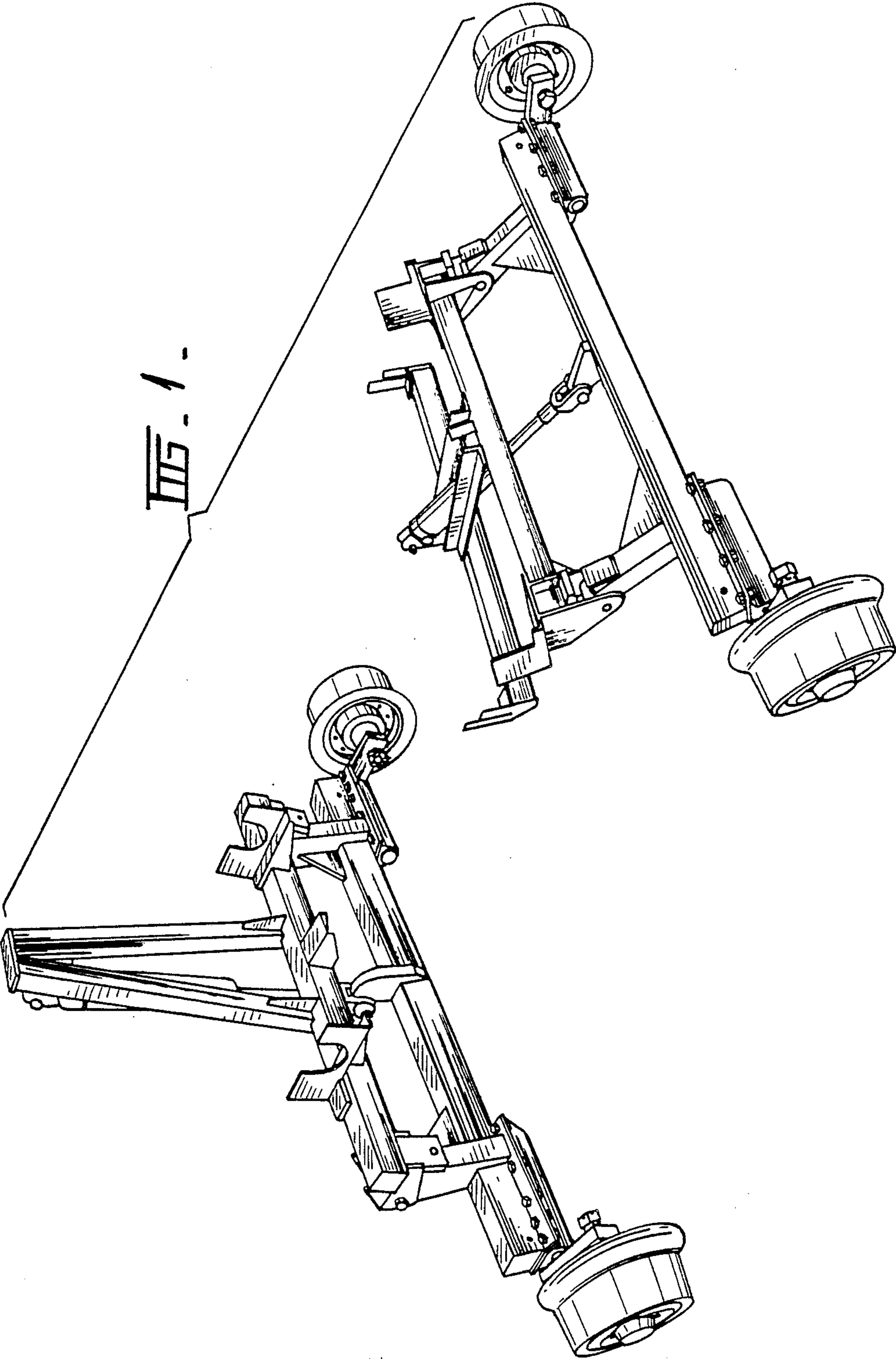

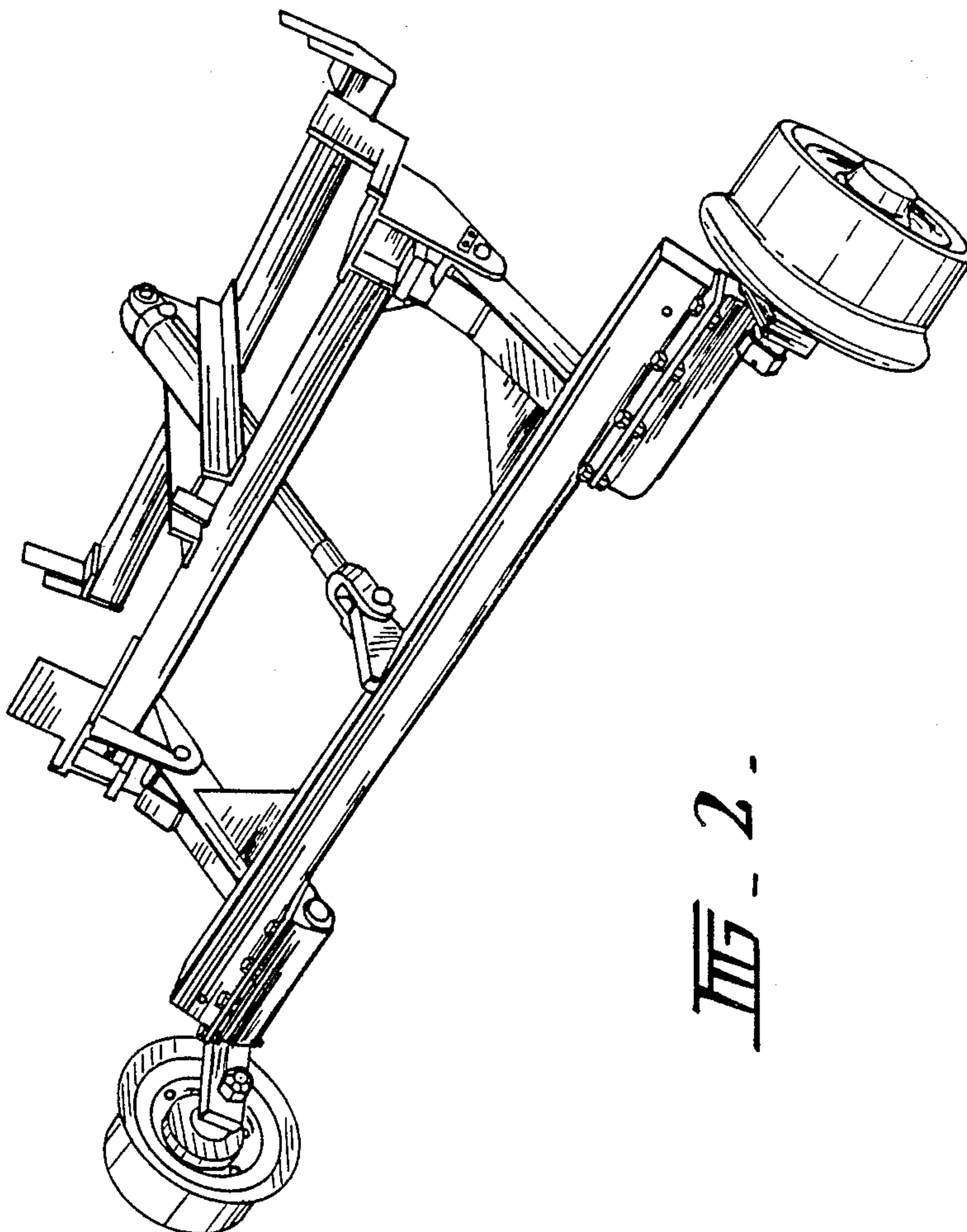

FIG. 2.

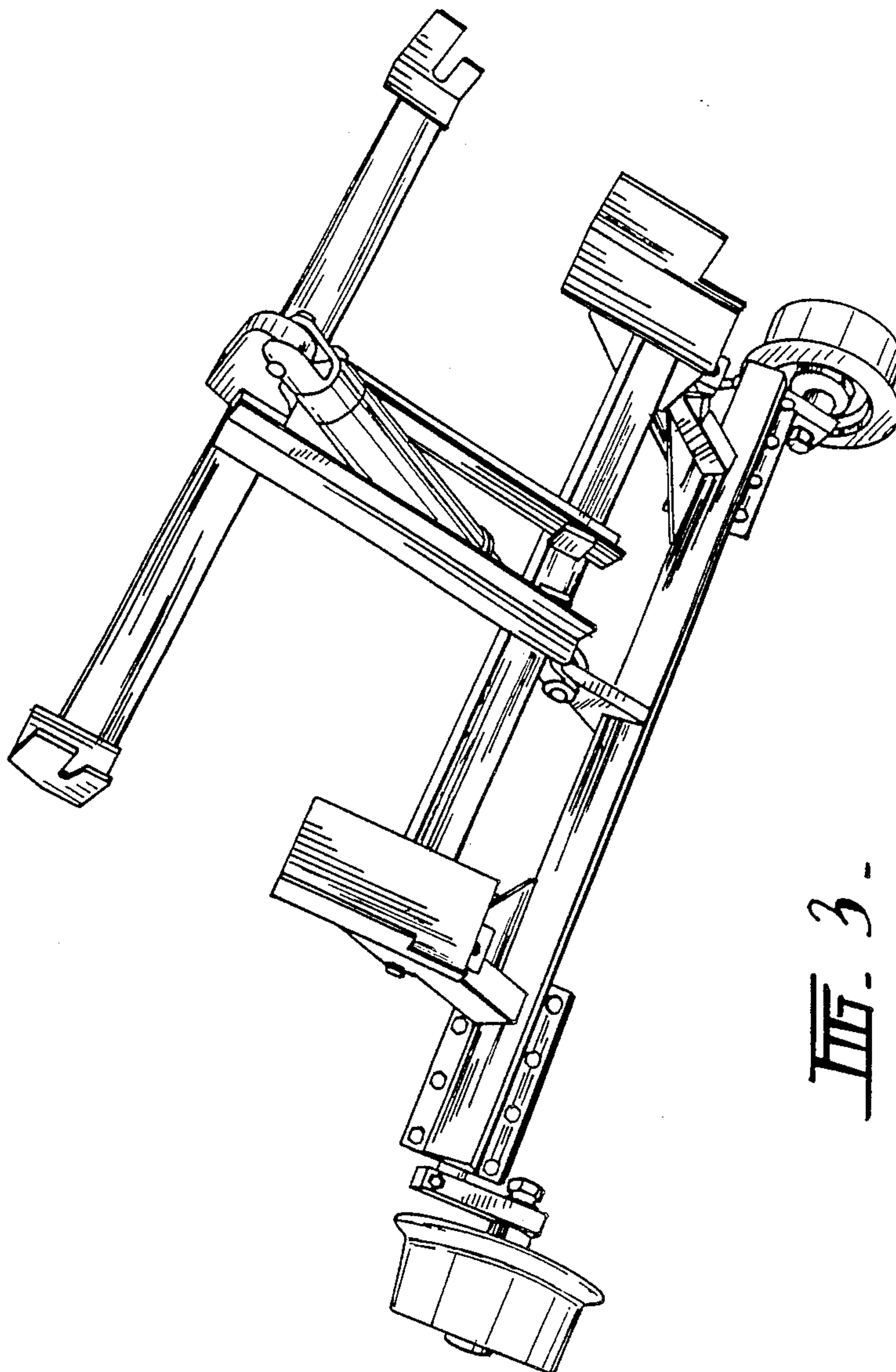

FIG. 3.

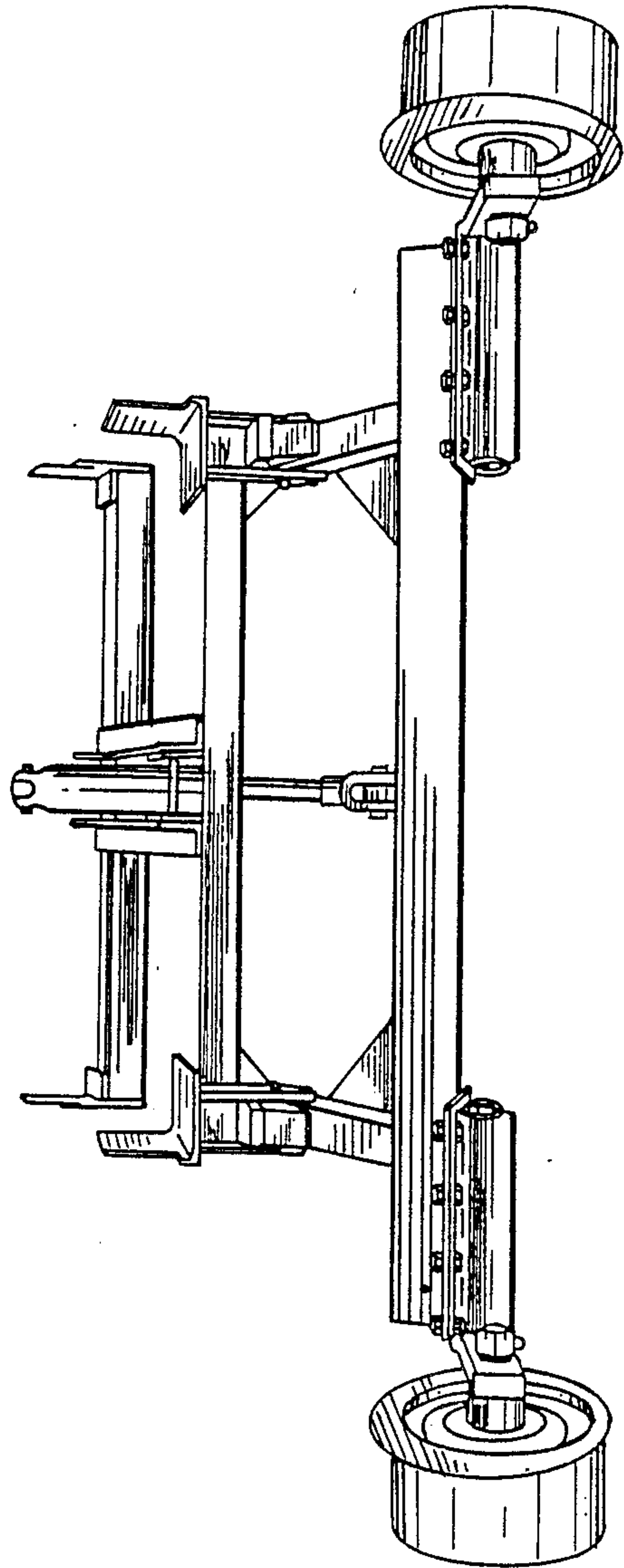
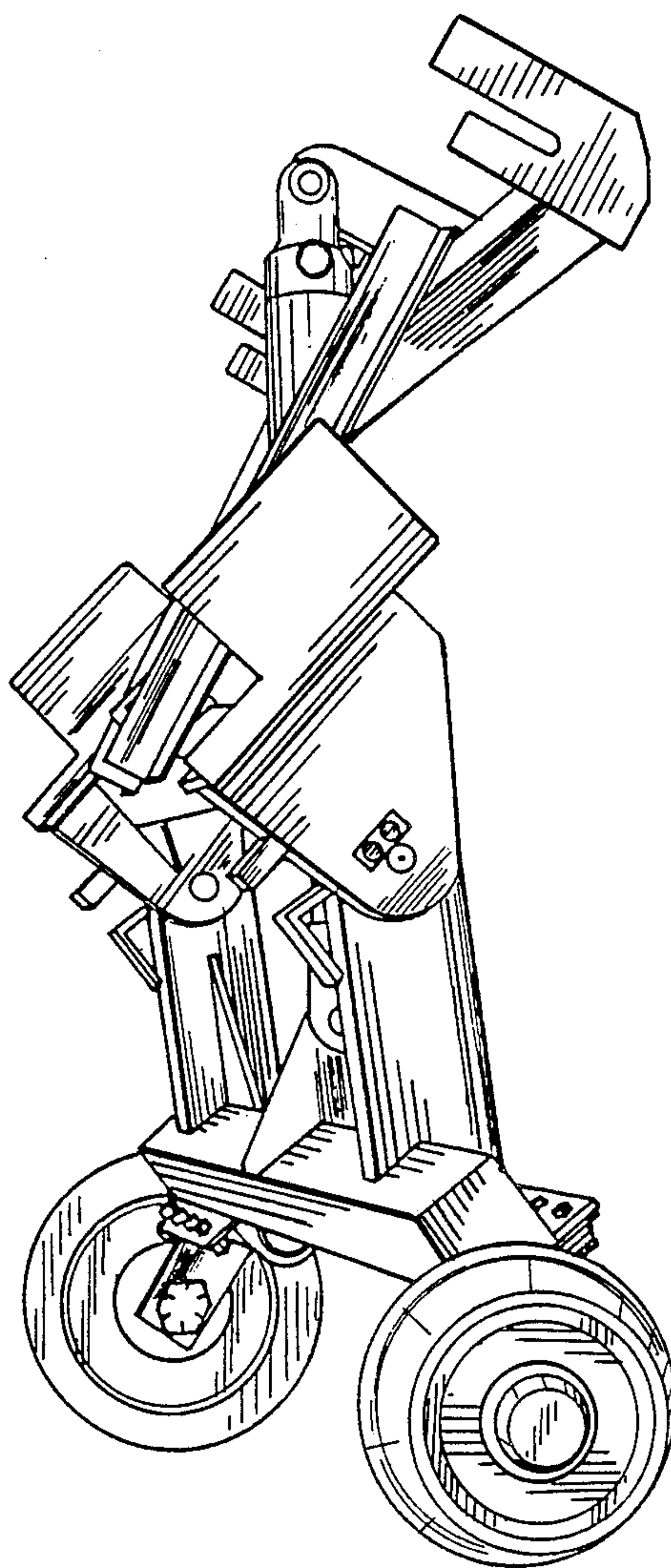

FIG. 4.



III - 5 -

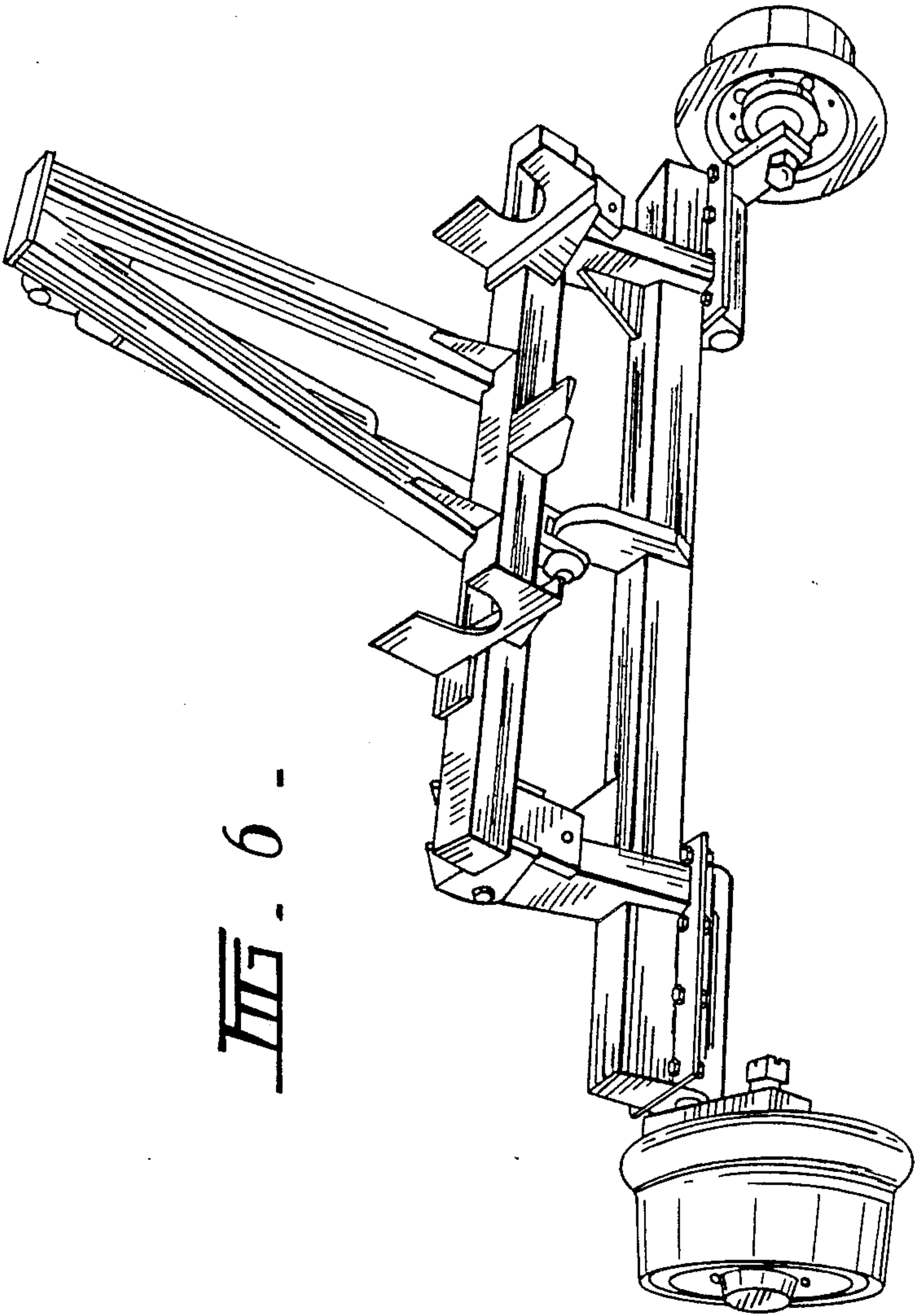

Fig. 6 -

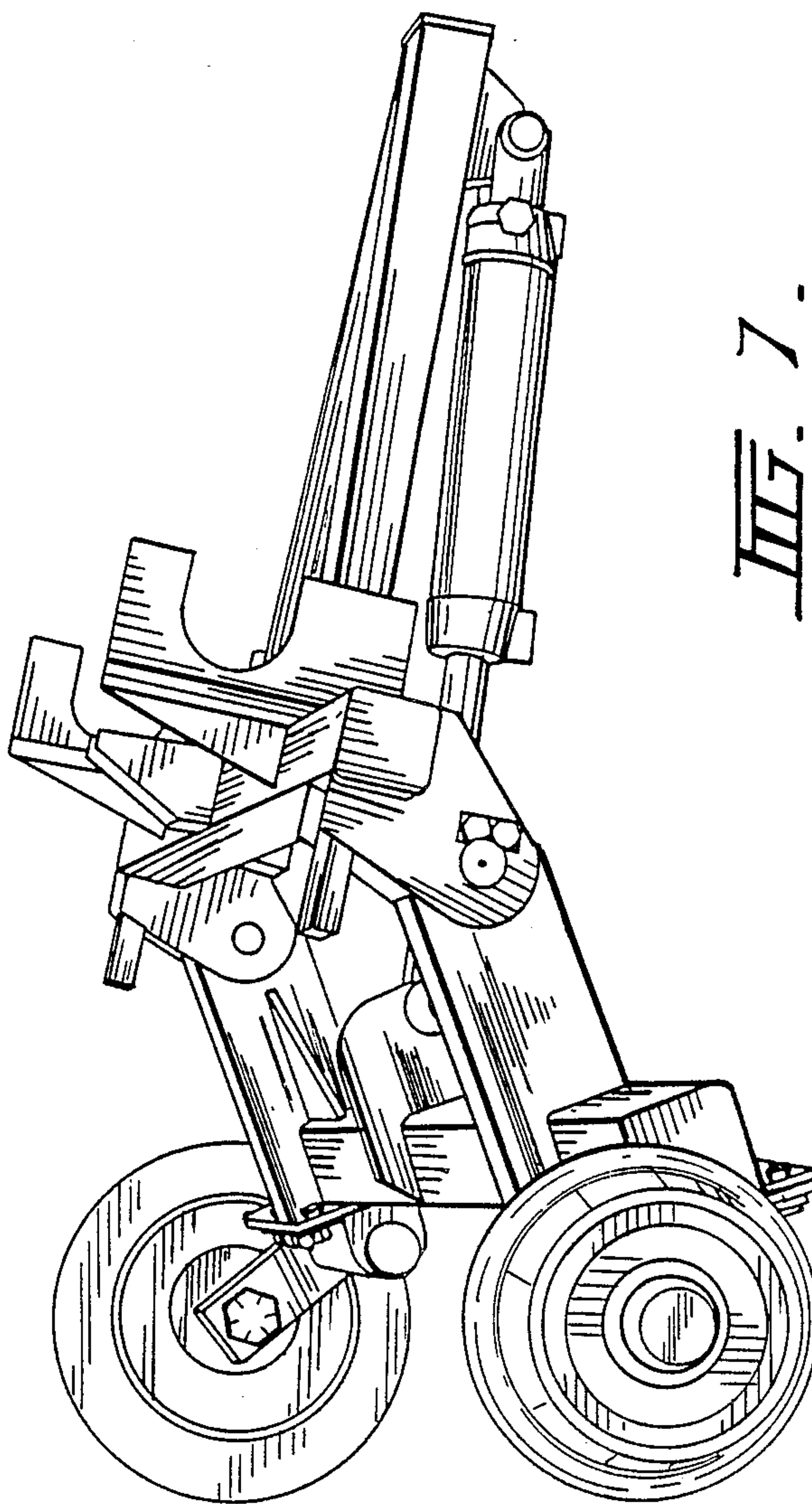
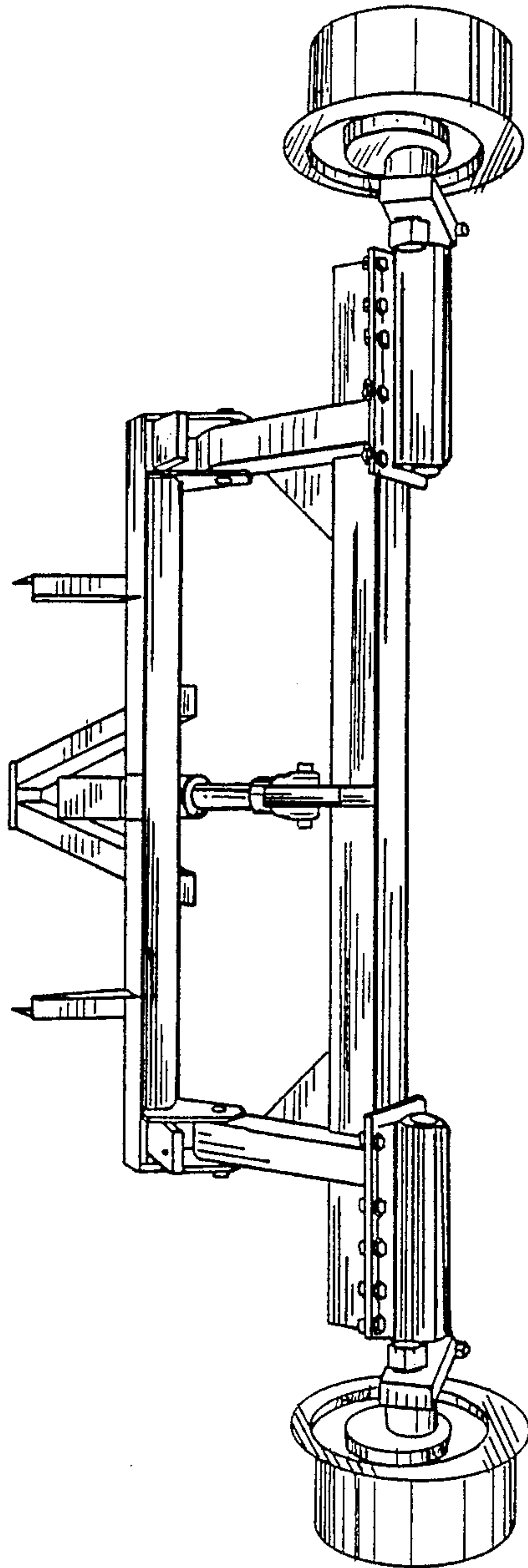

Fig. 7.



III - 8 -

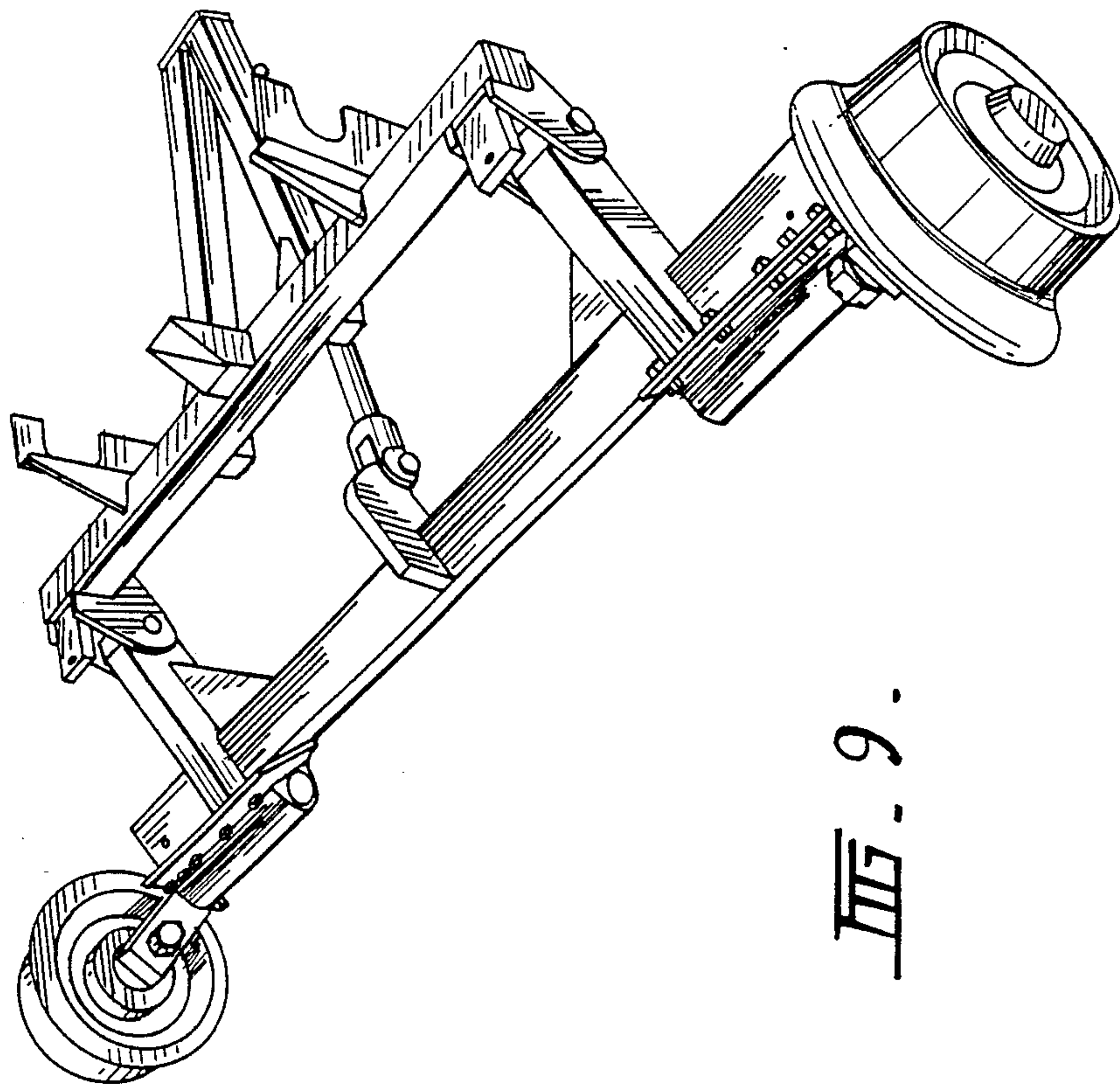

FIG. 9.