

[54] **FIREPLACE BUMPER PAD**

[76] **Inventor: Kristy M. Woods, 486 Sherwood Grns., Stone Mountain, Ga. 30087**

[\*\*] **Term: 14 Years**

[21] **Appl. No.: 270,505**

[22] **Filed: Nov. 14, 1988**

[52] **U.S. Cl. .... D23/403; D6/601**

[58] **Field of Search .... D23/403; 126/500; D6/601, 606, 610; 5/417, 420, 93 R, 424**

[56] **References Cited**

**U.S. PATENT DOCUMENTS**

2,738,834	3/1956	Jaffe et al. ....	5/420
2,751,609	6/1956	Oesterling et al. ....	5/420
3,563,837	2/1971	Smith et al. ....	5/420
3,672,354	6/1972	Weber .....	5/93 R
3,854,156	12/1974	Williams .....	5/93 R
4,076,872	2/1978	Lewicki et al. ....	5/417
4,480,715	11/1984	Brooks .....	5/420

*Primary Examiner*—James M. Gandy  
*Assistant Examiner*—Lisa Lichtenstein  
*Attorney, Agent, or Firm*—Leon Gilden

[57] **CLAIM**

The ornamental design for a fireplace bumper pad, as shown and described.

**DESCRIPTION**

FIG. 1 is a front elevational view of fireplace bumper pad showing my new design;  
FIG. 2 is a rear elevational view thereof;  
FIG. 3 is a right side elevational view thereof, on an enlarged scale;  
FIG. 4 is a left side elevational view thereof, on an enlarged scale;  
FIG. 5 is a top plan view thereof;  
FIG. 6 is a bottom plan view thereof.  
The broken line showing of a fireplace in FIGS. 3 and 4, is for illustrative purposes only and forms no part of the claimed design.

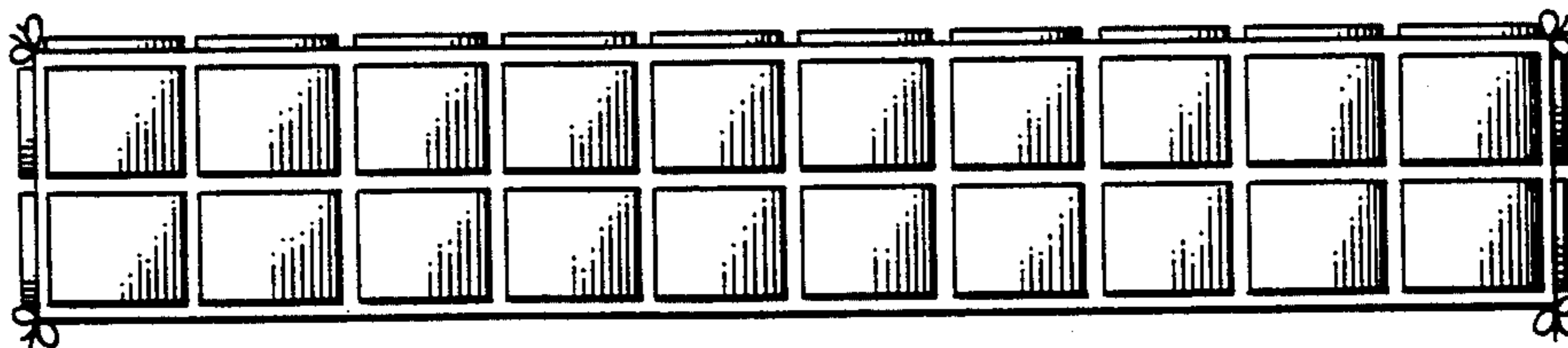

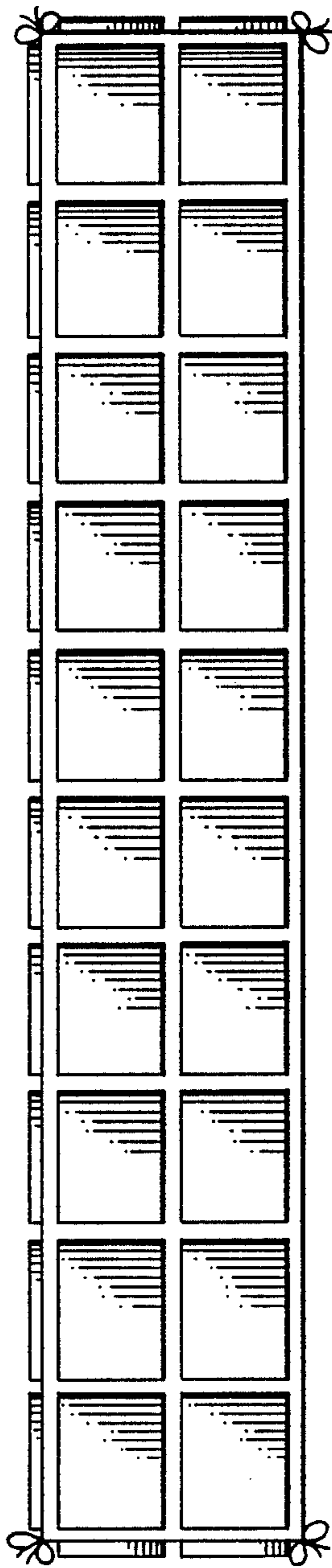

FIG. 1

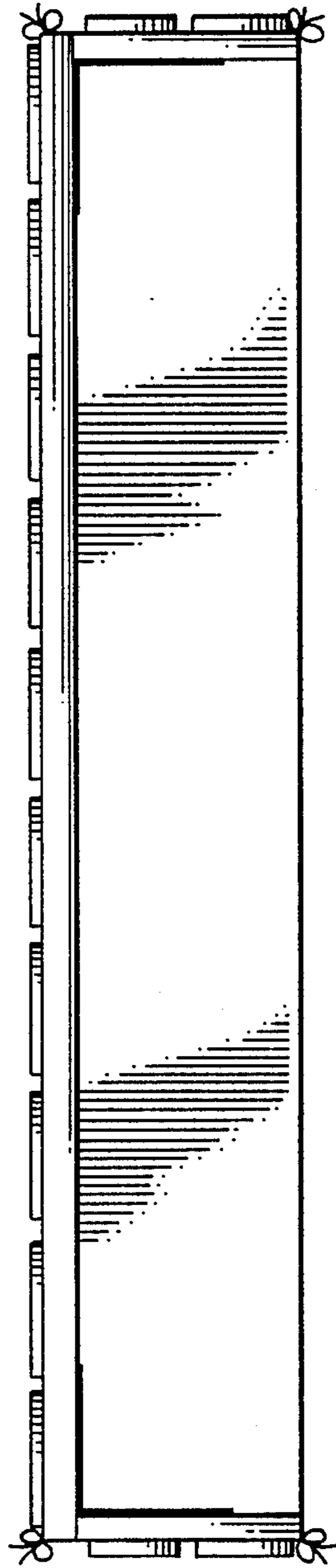

FIG. 2

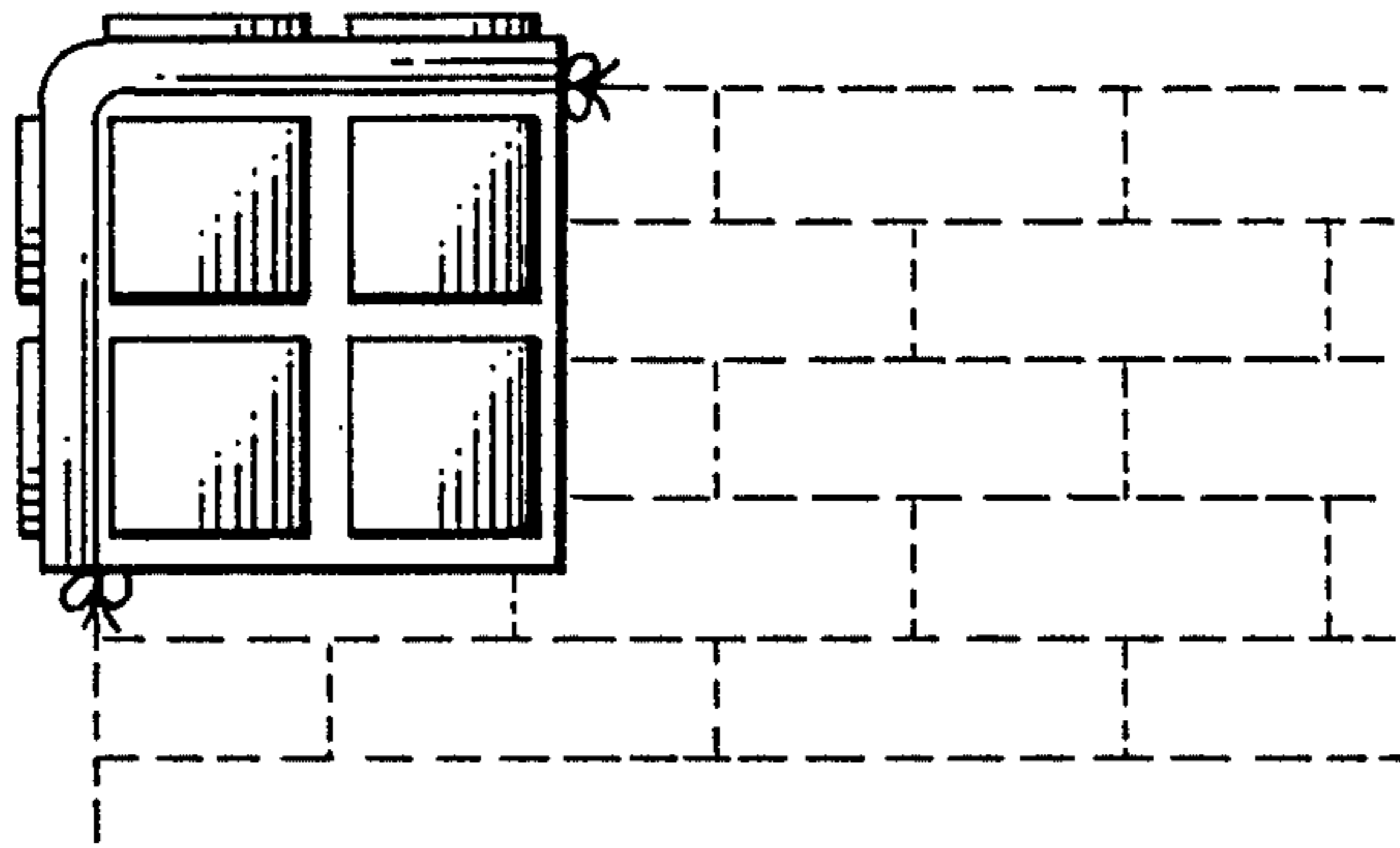

Fig. 2

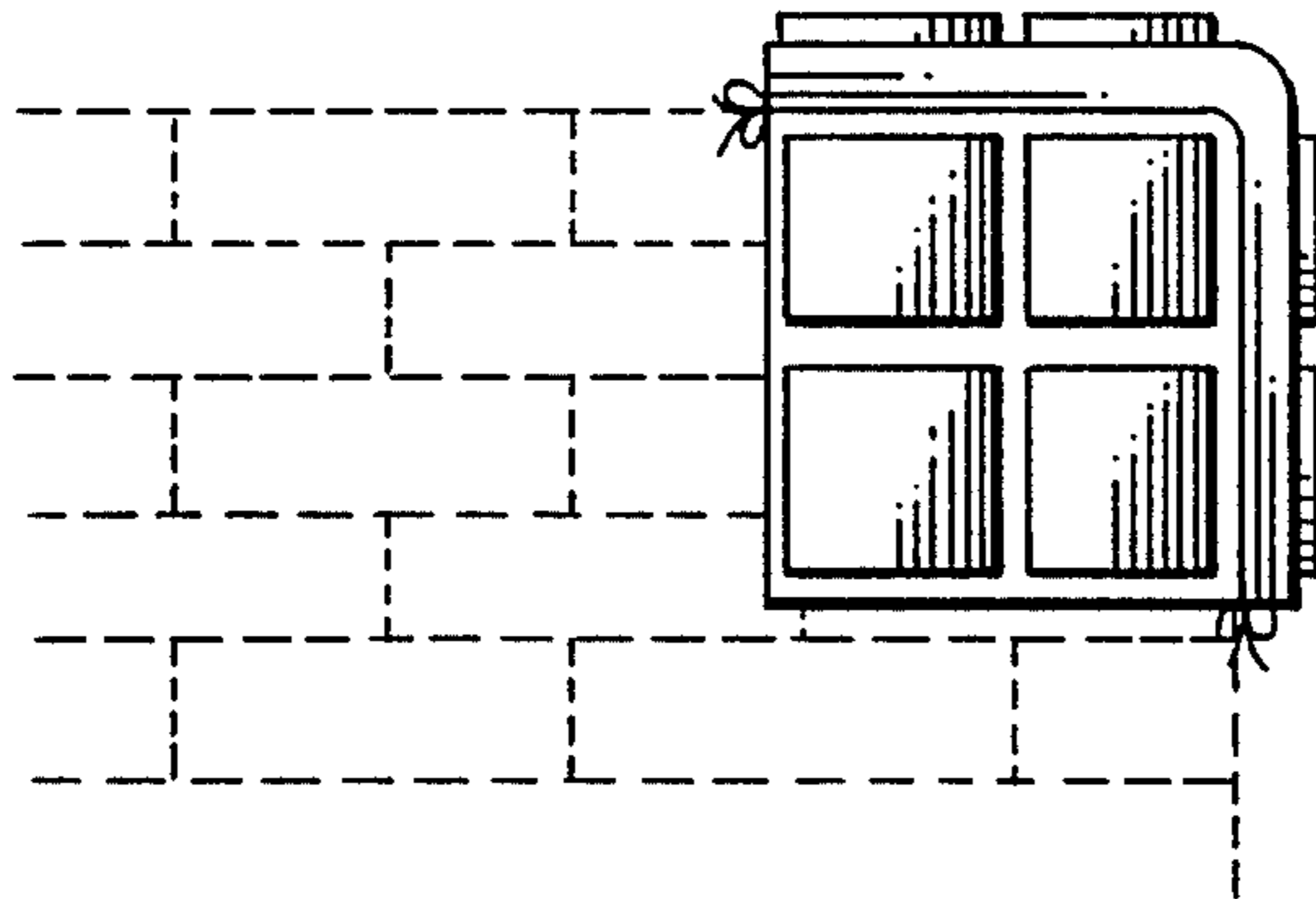

Fig. 3

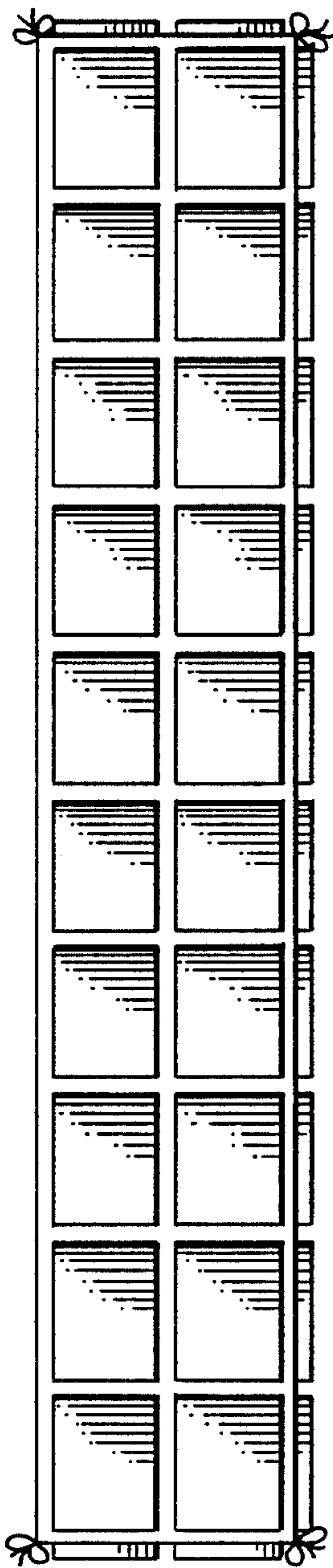

FIG. 5

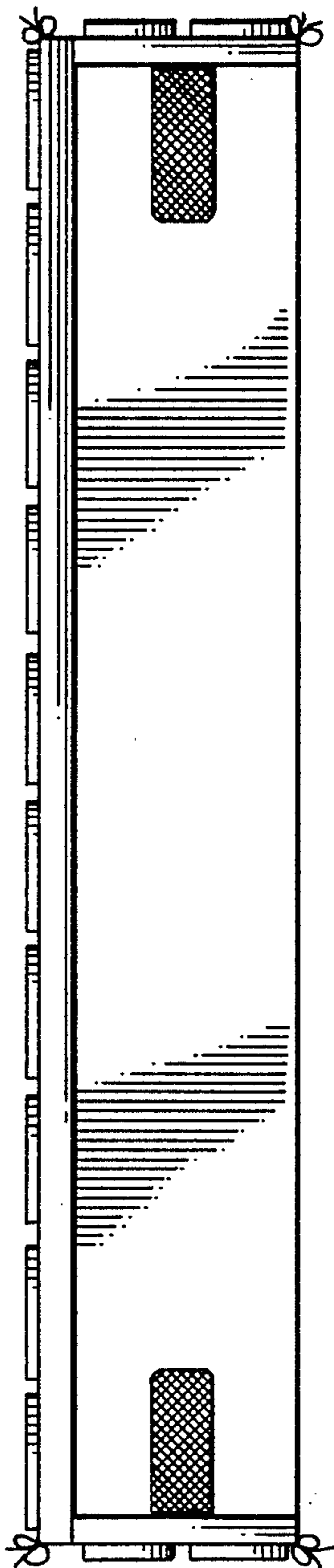

FIG. 6