

[54] MAIL REARRANGING/STAMPING MACHINE

[75] Inventor: Yoshiaki Nishida, Tokyo, Japan

[73] Assignee: Kabushiki Kaisha Toshiba, Kawasaki, Japan

[\*\*] Term: 14 Years

[21] Appl. No.: 868,346

[22] Filed: May 29, 1986

[52] U.S. Cl. .... D18/99; D15/147; D15/199; D18/13; D34/29

[58] Field of Search ..... D18/13, 99; 209/584, 209/900; 101/95; D15/199, 147; D34/28, 29; D14/110

[56] References Cited

U.S. PATENT DOCUMENTS

D. 198,686	7/1964	Breed et al. ....	D14/110
D. 230,861	3/1974	Shelkofsky et al. ....	D14/110
D. 299,354	1/1989	Panini .....	D15/199
D. 300,747	4/1989	Bain .....	D15/147
D. 301,150	5/1989	Bain .....	D15/147
2,991,996	7/1961	Kaye .....	D34/29
3,022,907	2/1962	Palasciano .....	D18/99

3,386,574	6/1968	Kaplan .....	209/900
3,420,368	1/1969	Rosenberg et al. ....	209/900
3,935,429	1/1976	Branecky et al. ....	209/900
3,952,874	4/1976	Owen .....	209/900

OTHER PUBLICATIONS

NEC Technical Journal, vol. 38, No. 4, pp. 51-52, published Mar. 20, 1985.

Primary Examiner—Bruce W. Dunkins  
Assistant Examiner—Caron D. Veynar  
Attorney, Agent, or Firm—Finnegan, Henderson, Farabow, Garrett and Dunner

[57] CLAIM

The ornamental design for a mail rearranging/stamping machine, as shown and described.

DESCRIPTION

FIG. 1 is a front elevational view of a mail rearranging/stamping machine showing my new design; FIG. 2 is a top plan view thereof; FIG. 3 is a rear elevational view thereof; FIG. 4 is a right side elevational view thereof; FIG. 5 is a left side elevational view thereof; FIG. 6 is a bottom plan view thereof; FIG. 7 is a perspective view taken from the top, front and left side thereof.

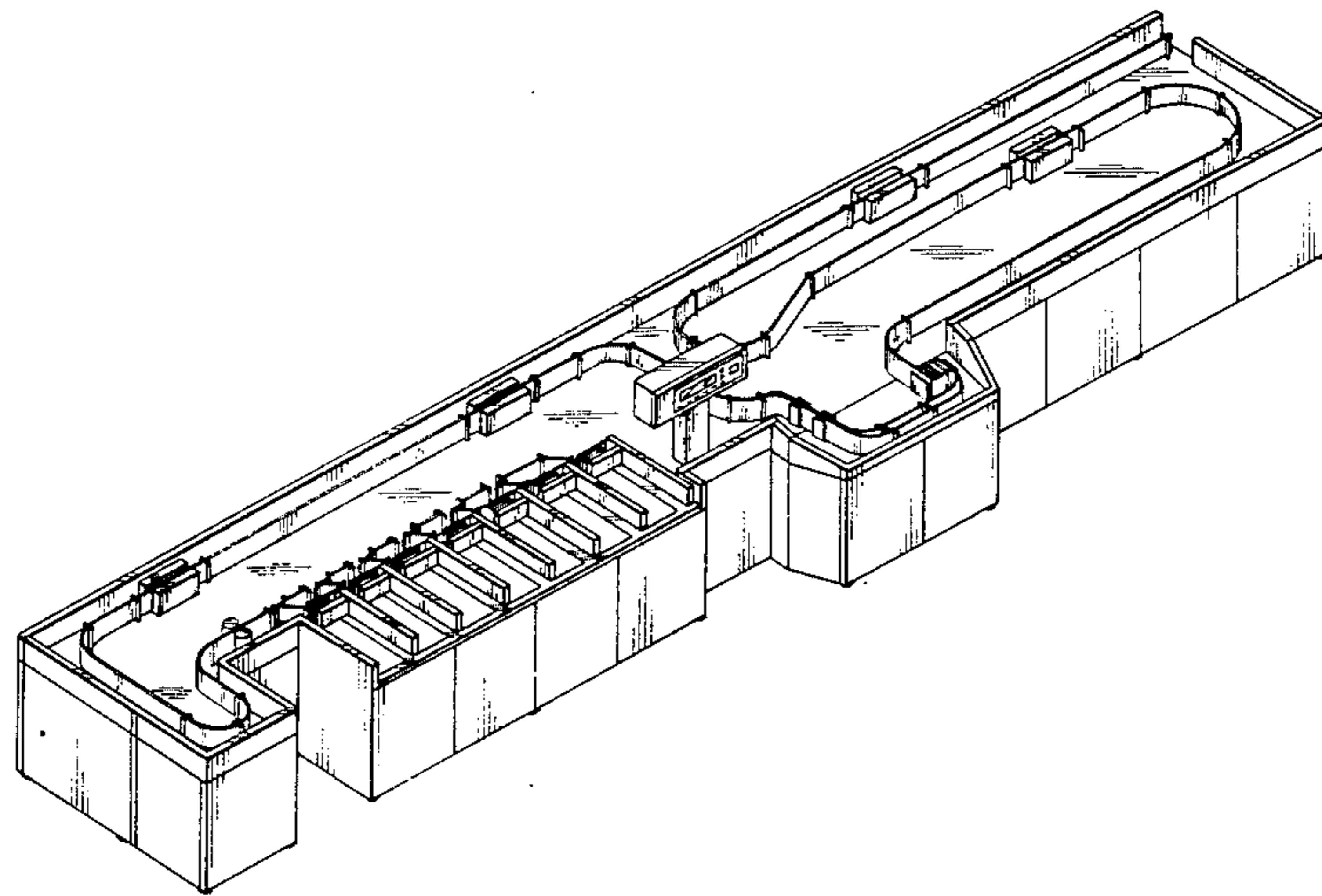

FIG. 1

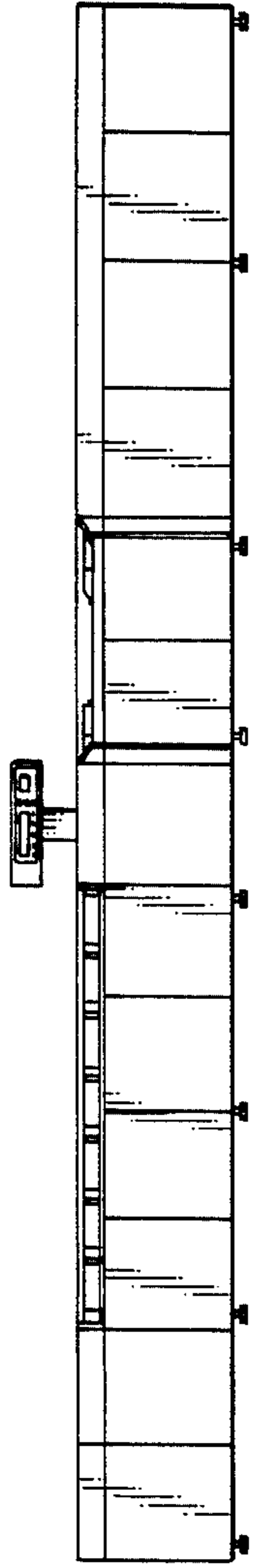

FIG. 4

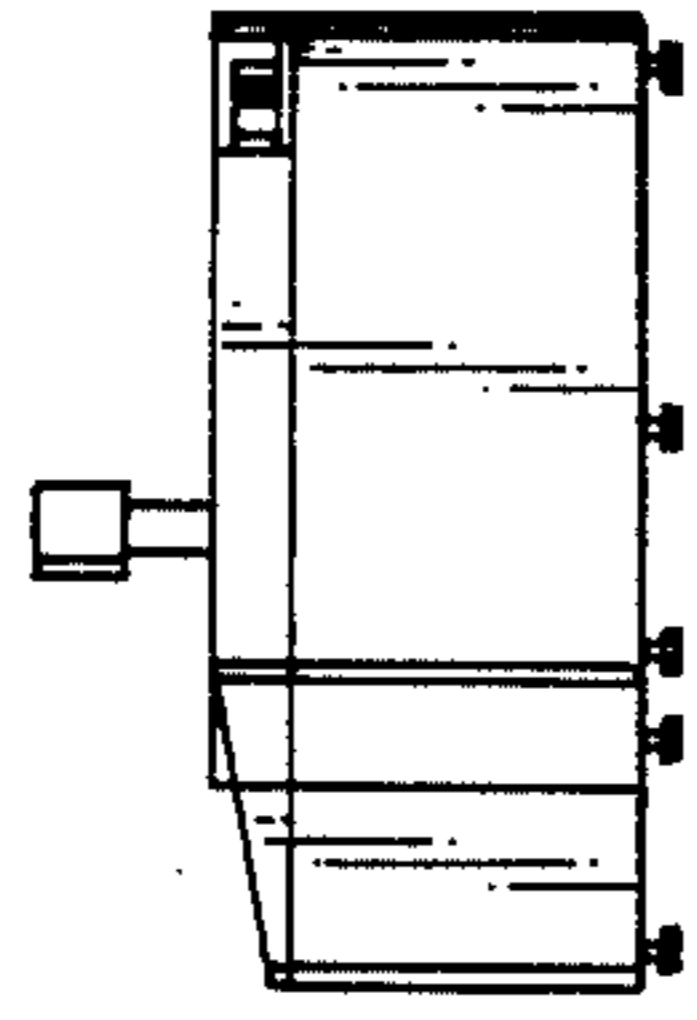

FIG. 2

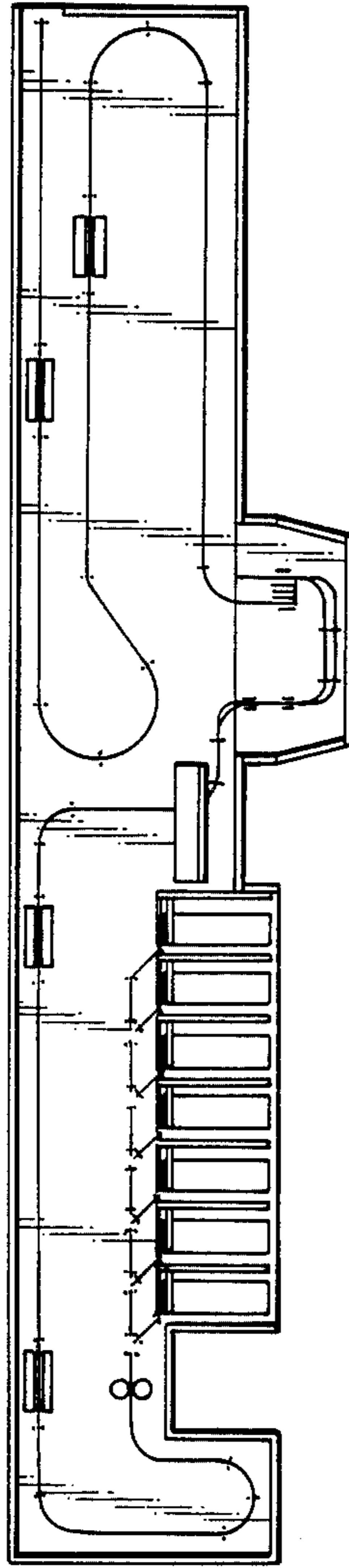

FIG. 5

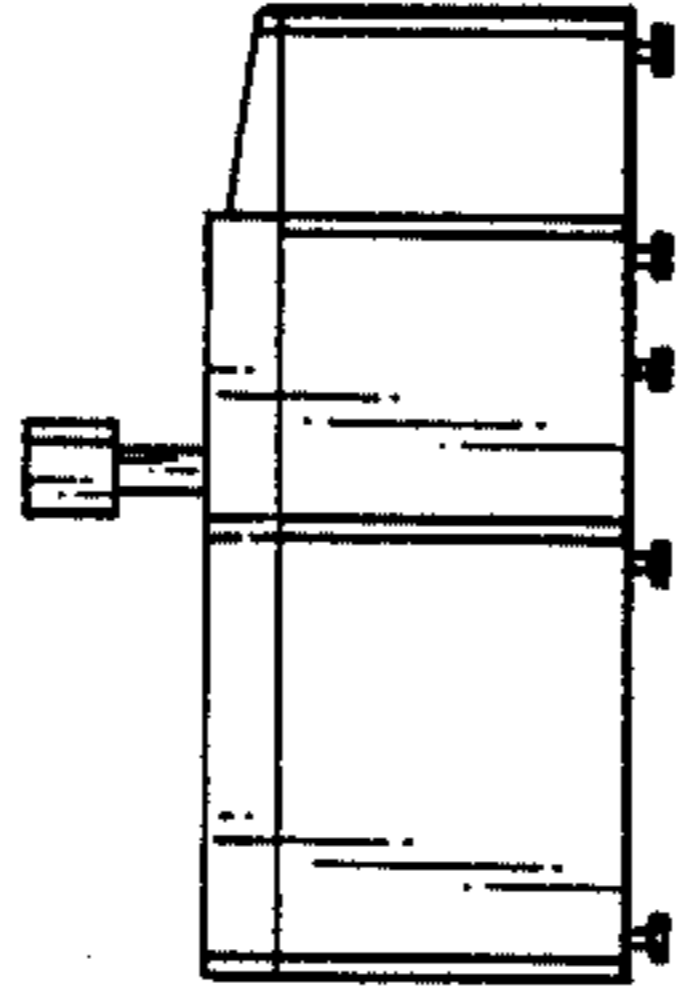

FIG. 3

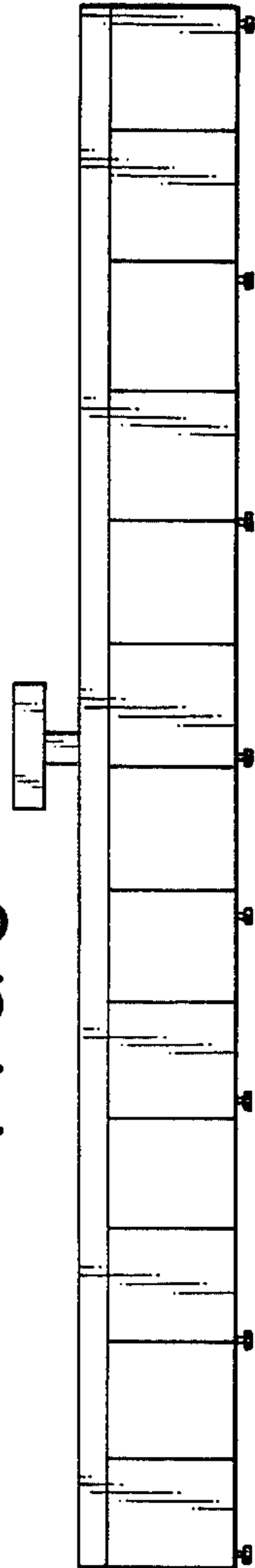
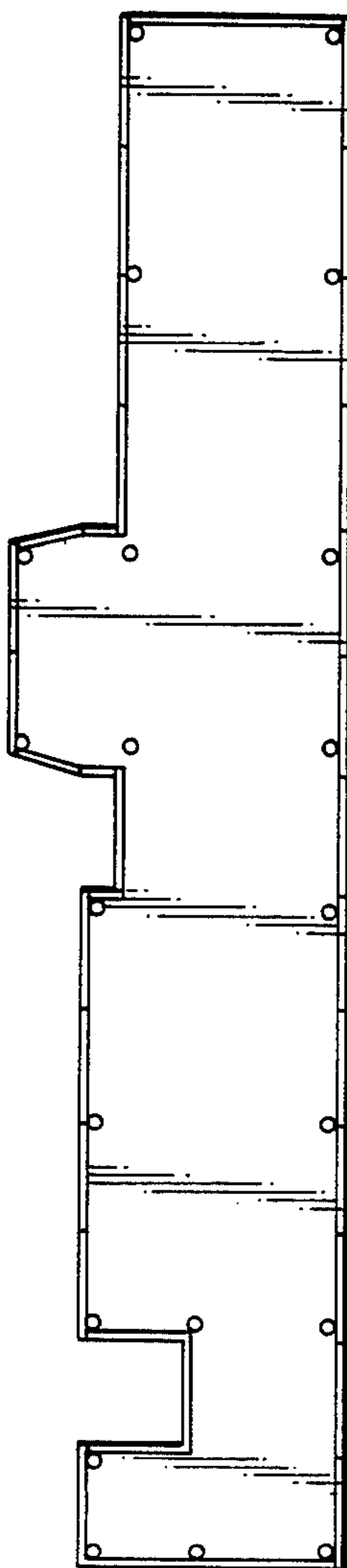

FIG. 6



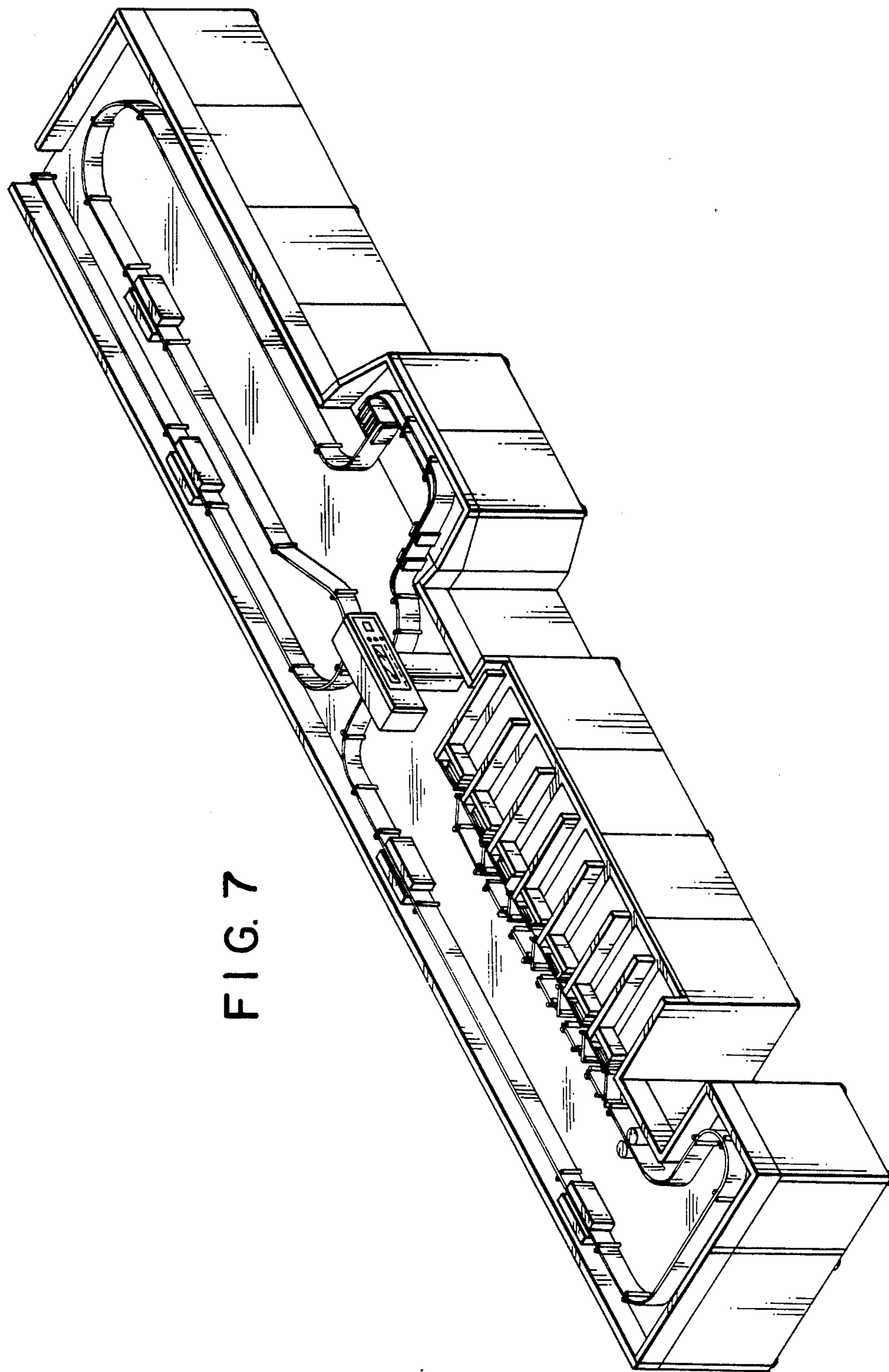

FIG. 7