

[54] ARTICULATED DOUBLE DECK BUS

[76] Inventor: James S. Mulhern, P.O. Box 847, Federal Square Bldg., Harrisburg, Pa. 17101

[**] Term: 14 Years

[21] Appl. No.: 226,533

[22] Filed: Jul. 27, 1988

Related U.S. Application Data

[63] Continuation-in-part of Ser. No. 707,436, Mar. 1, 1985, abandoned.

[52] U.S. Cl. D12/84

[58] Field of Search D12/84, 40; 296/178; 280/424

References Cited

U.S. PATENT DOCUMENTS

D. 195,233	5/1963	Cooney	D12/40
D. 287,113	12/1986	Fitzgerald	D12/84
1,575,675	3/1926	Eggleston	D12/84
4,582,354	4/1986	Halim	296/178

Primary Examiner—James M. Gandy
Attorney, Agent, or Firm—Jay M. Cantor

[57] CLAIM

The ornamental design for an articulated double deck bus, as shown and described.

DESCRIPTION

FIG. 1 is a perspective view of the rear and right side of an articulated double deck bus showing my new design with the pivoted rear panels and sliding side door panels in open condition;

FIG. 2 is a left side elevation view thereof;

FIG. 3 is a front elevation view thereof;

FIG. 4 is a rear elevation view thereof;

FIG. 5 is a perspective view of the rear and left side thereof with the pivoted rear panels and one of the upper and lower pivoted side window panels and the sliding side window panel in open condition; and

FIG. 6 is an interior elevation view thereof, taken from the left side with the outer side wall removed.

The broken lines shown in FIGS. 2 and 6 of the drawing are for illustrative purposes only and form no part of the claimed design.

The top of the articulated double deck is understood to be flat and unornamented.

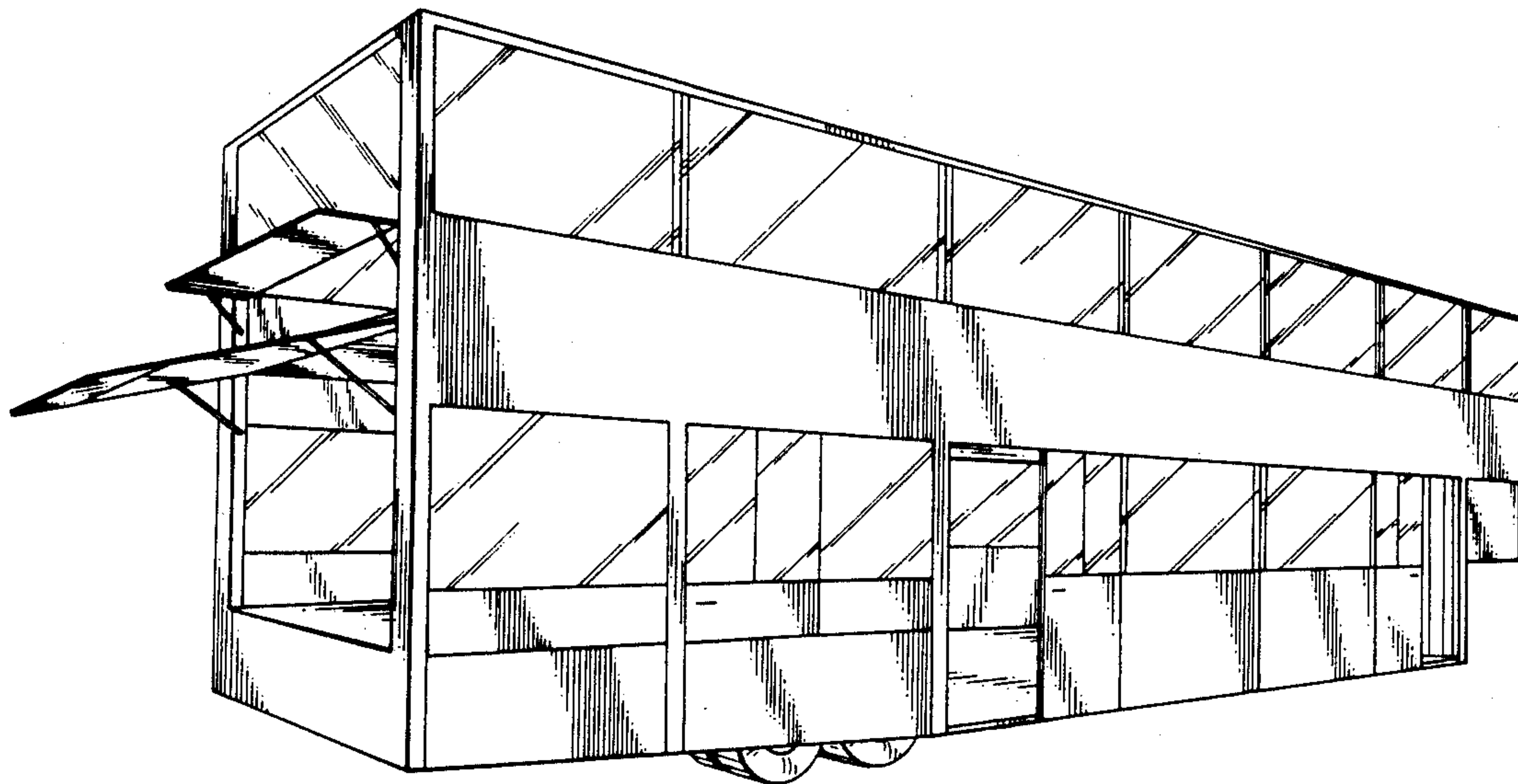

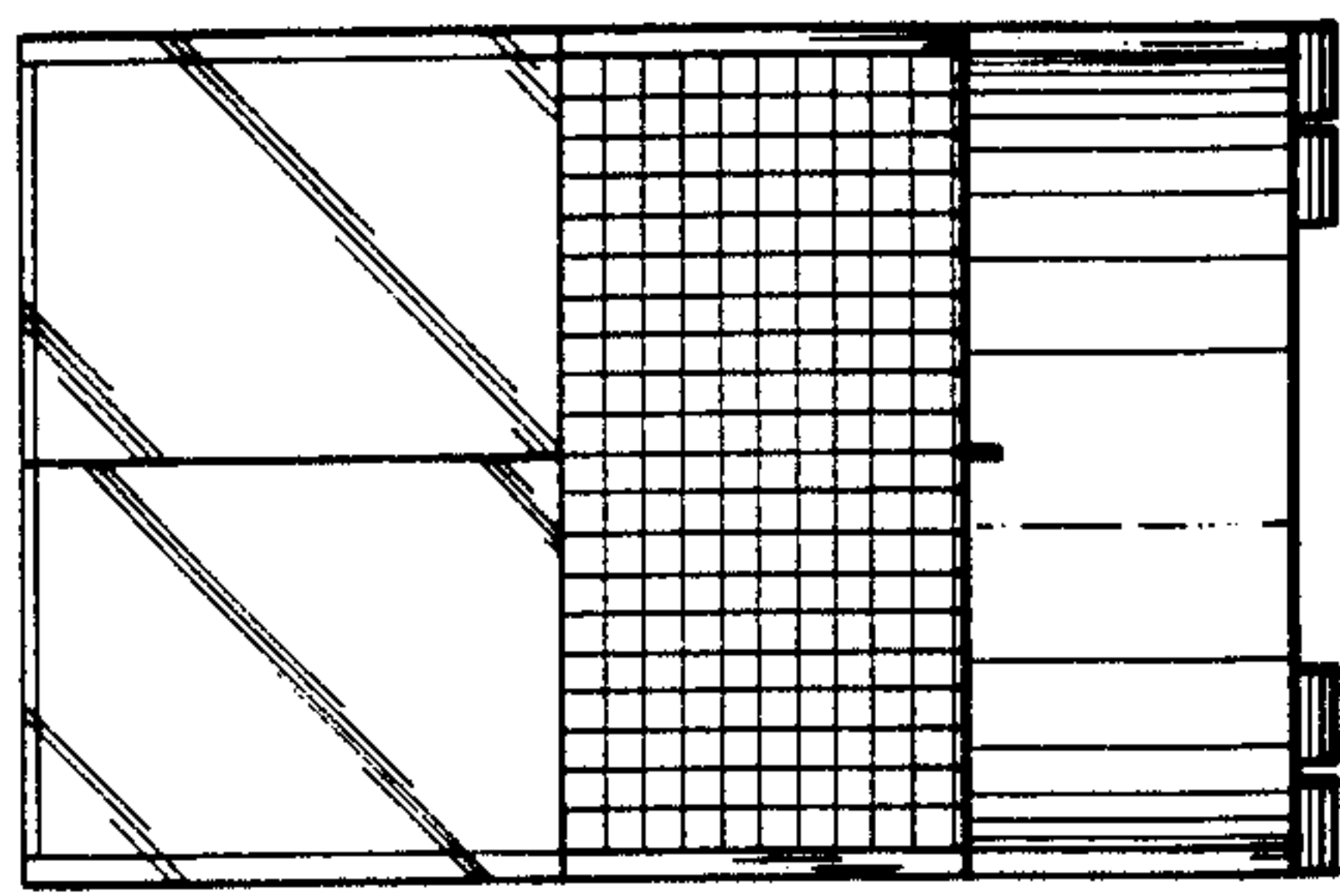

FIG. 3

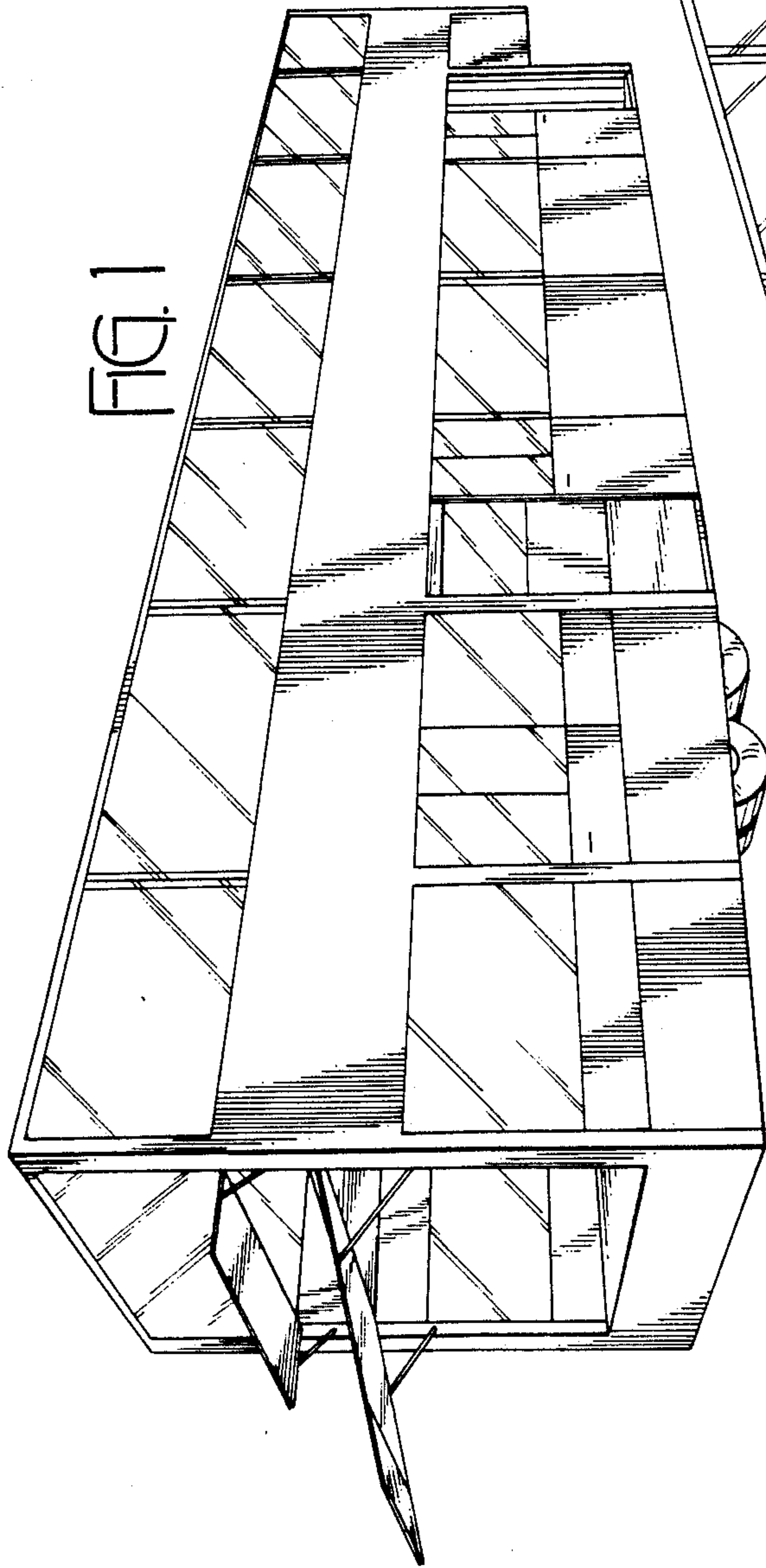

FIG. 1

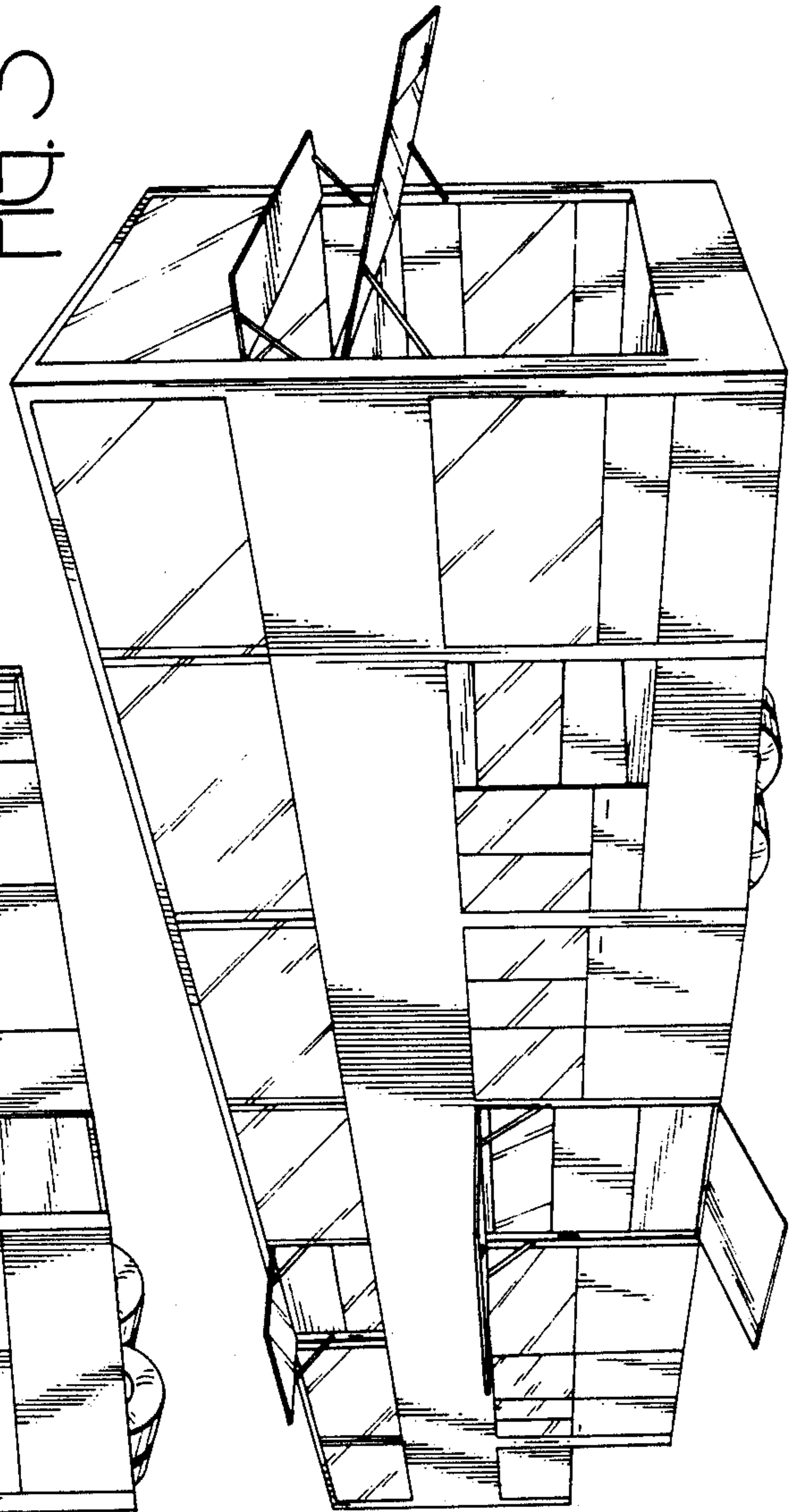

FIG. 5

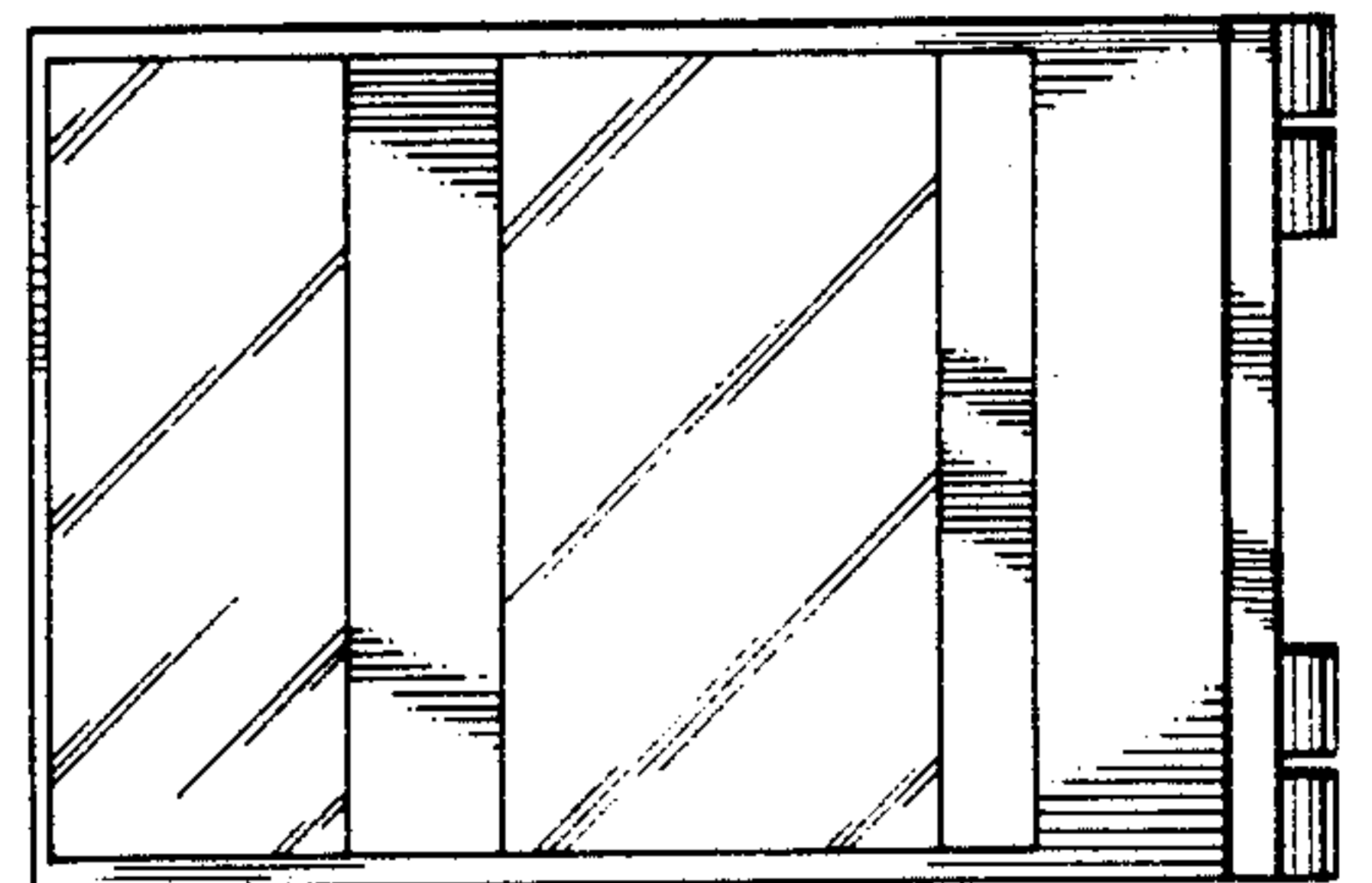

FIG. 4

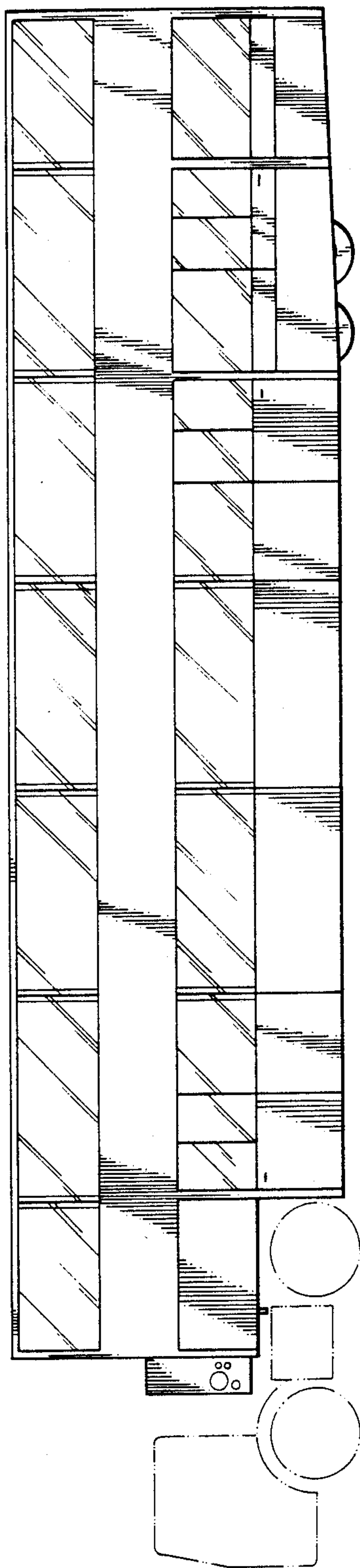

FIG. 2

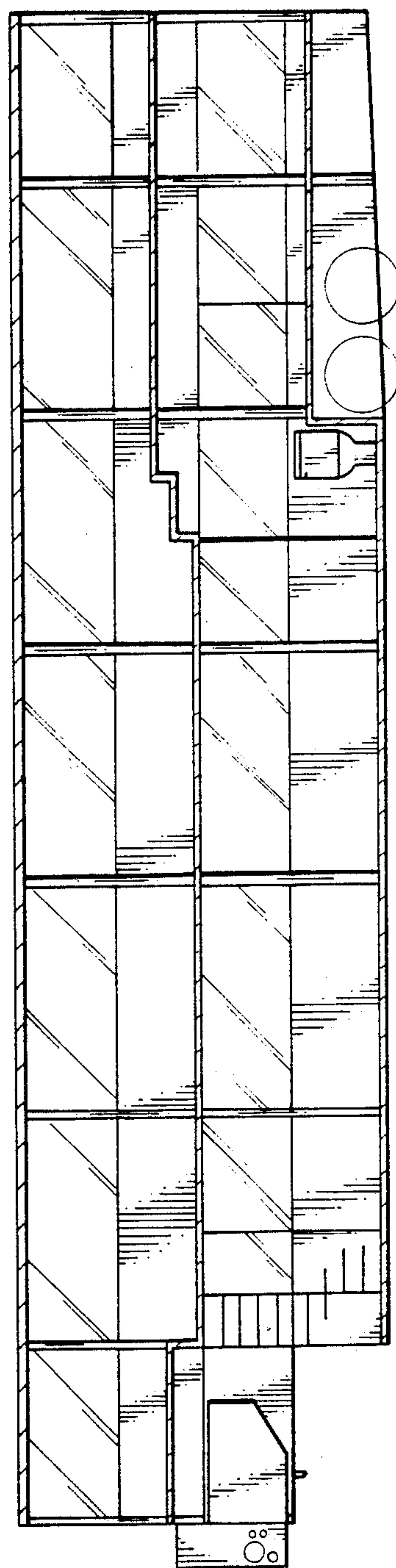

FIG. 6