

[54] **DISPLAY TERMINAL CONTROLLER**

[75] **Inventor: David L. Schaum, Woodstock, N.Y.**

[73] **Assignee: International Business Machines Corporation, Armonk, N.Y.**

[**] **Term: 14 Years**

[21] **Appl. No.: 940,719**

[22] **Filed: Dec. 9, 1986**

[52] **U.S. Cl. D14/100; D14/109**

[58] **Field of Search D14/100-117; D13/40, 41, 32, 24, 12, 4, 10, 13, 34; D18/1, 2, 5, 6, 7, 8, 11, 13; 360/97, 98, 99, 132, 133, 99.02; 361/330, 331, 334, 335, 332, 348, 352, 380, 381, 379, 390-395, 384, 415, 426, 358, 2, 4, 9; 312/299, 304, 208, 270, 275, 253; 211/41, 26, 126; 174/50, 52 R; 200/5 A, 5 R, 6 A, 6 R; 235/375, 378, 145 R; 364/708**

[56]

References Cited

U.S. PATENT DOCUMENTS

D. 279,675	7/1985	Akiyama	D14/109 X
D. 289,056	3/1987	Davis et al.	D14/109 X
D. 293,910	1/1988	Alfonso et al.	D14/109 X
D. 295,749	5/1988	Kelley, Jr. et al.	D14/109 X
4,760,502	7/1988	Ackeret	206/444 X

Primary Examiner—Susan J. Lucas

Assistant Examiner—Freda S. Nunn

Attorney, Agent, or Firm—Mark S. Walker; Joseph J. Connerton

[57]

CLAIM

The ornamental design for a display terminal controller, as shown and described.

DESCRIPTION

FIG. 1 is a front, top and right side perspective view of a display terminal controller, showing our new design; FIG. 2 is a rear, top and left side perspective thereof; FIGS. 3 and 4 are respective front and rear orthographic views thereof on a greatly enlarged scale. FIGS. 5 and 6 are respective right and left side orthographic view thereof on an enlarged scale. FIG. 7 is a top orthographic thereof.

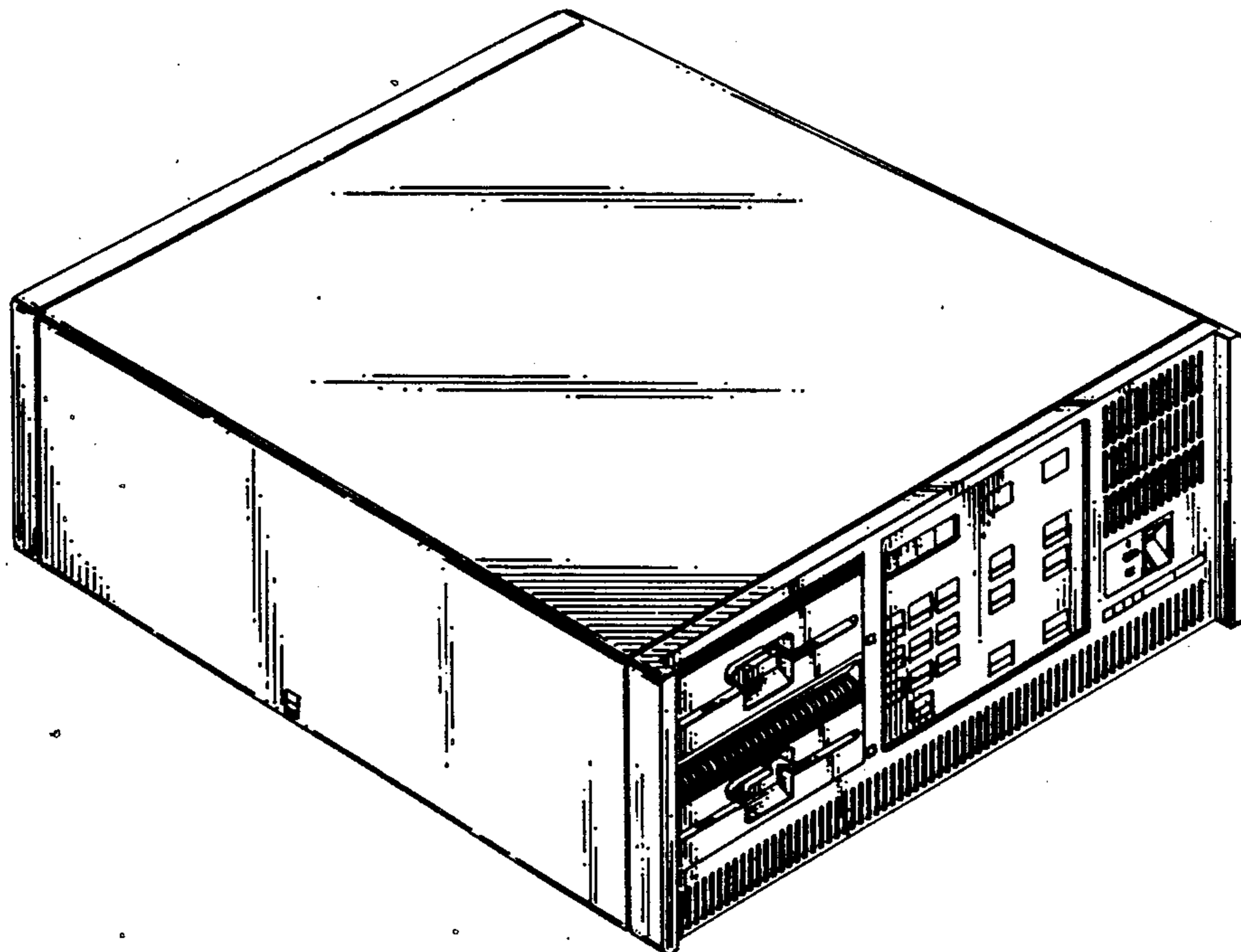

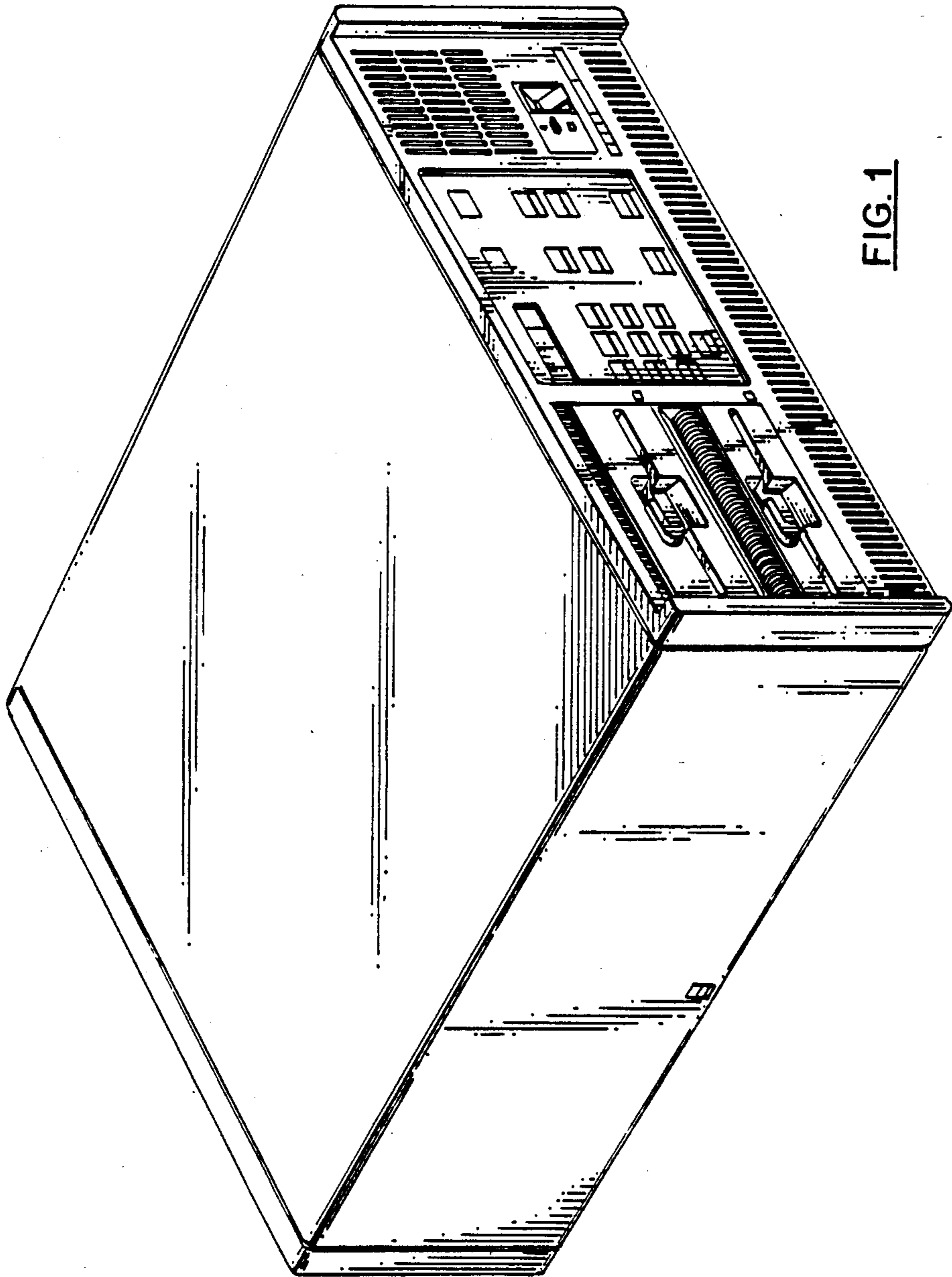

FIG. 1

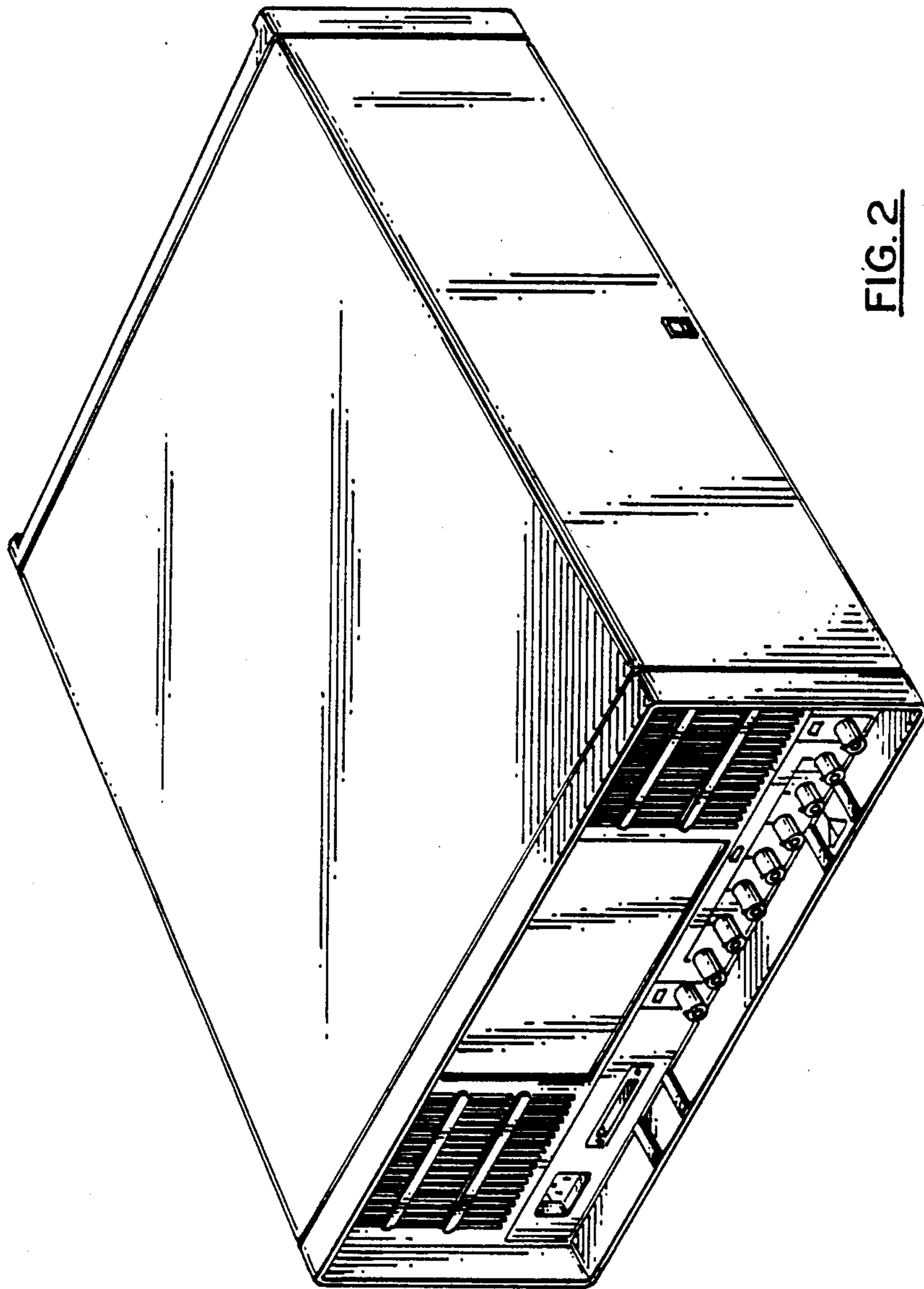

FIG. 2

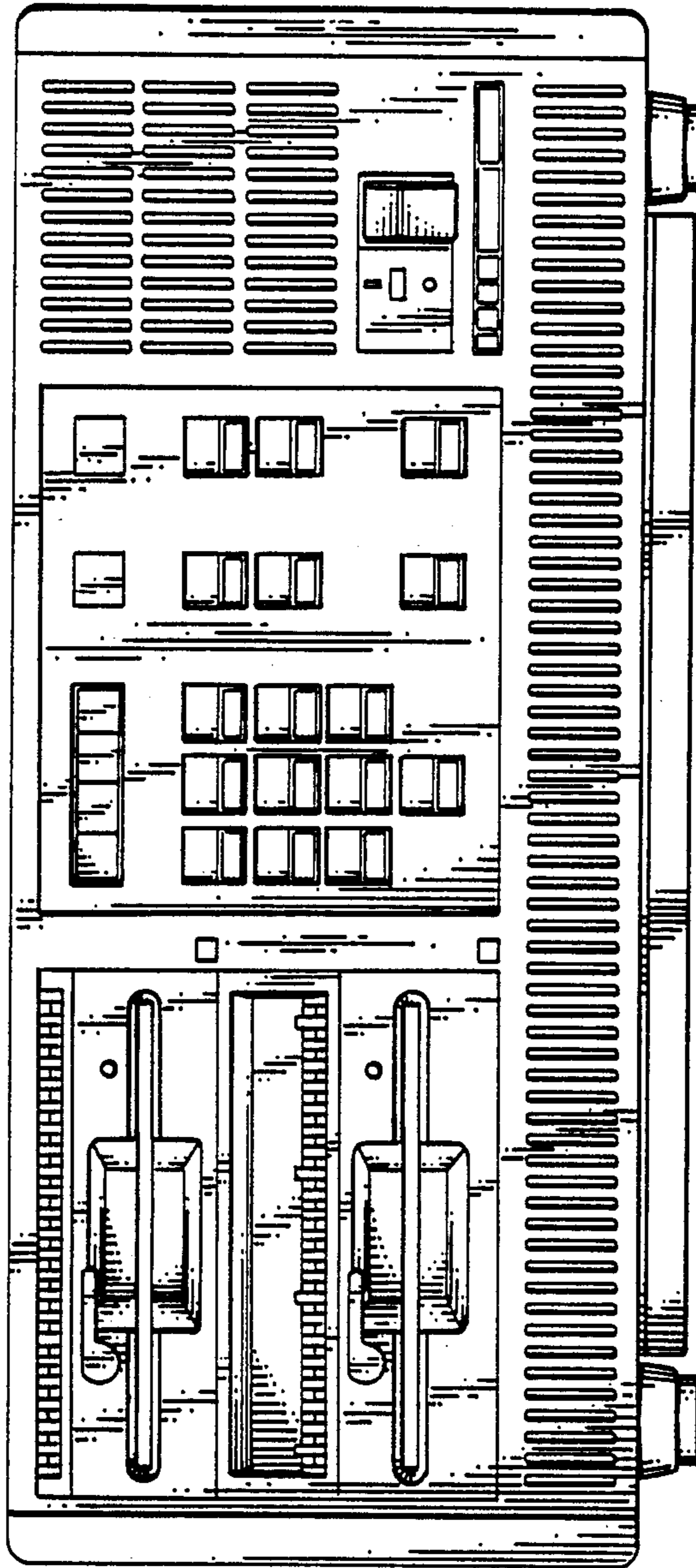

FIG. 3

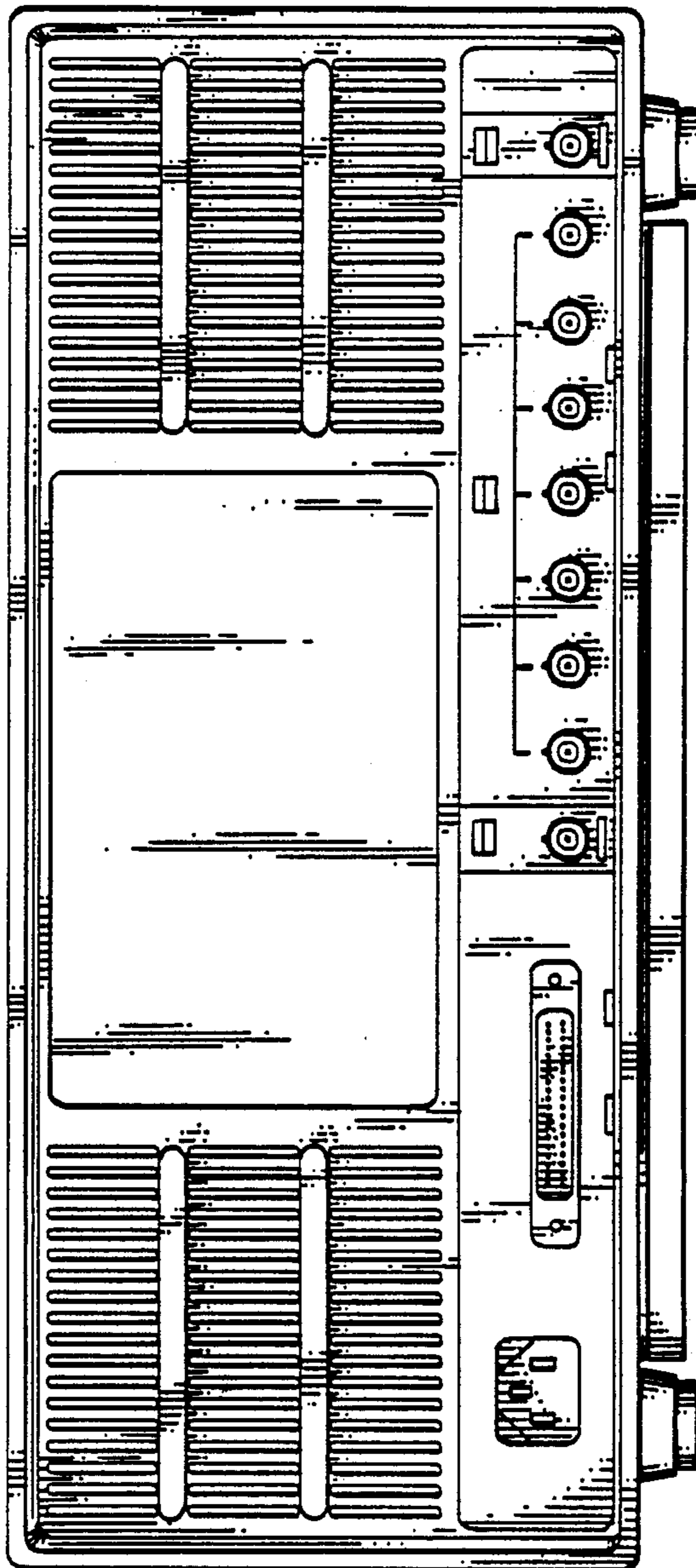

FIG. 4

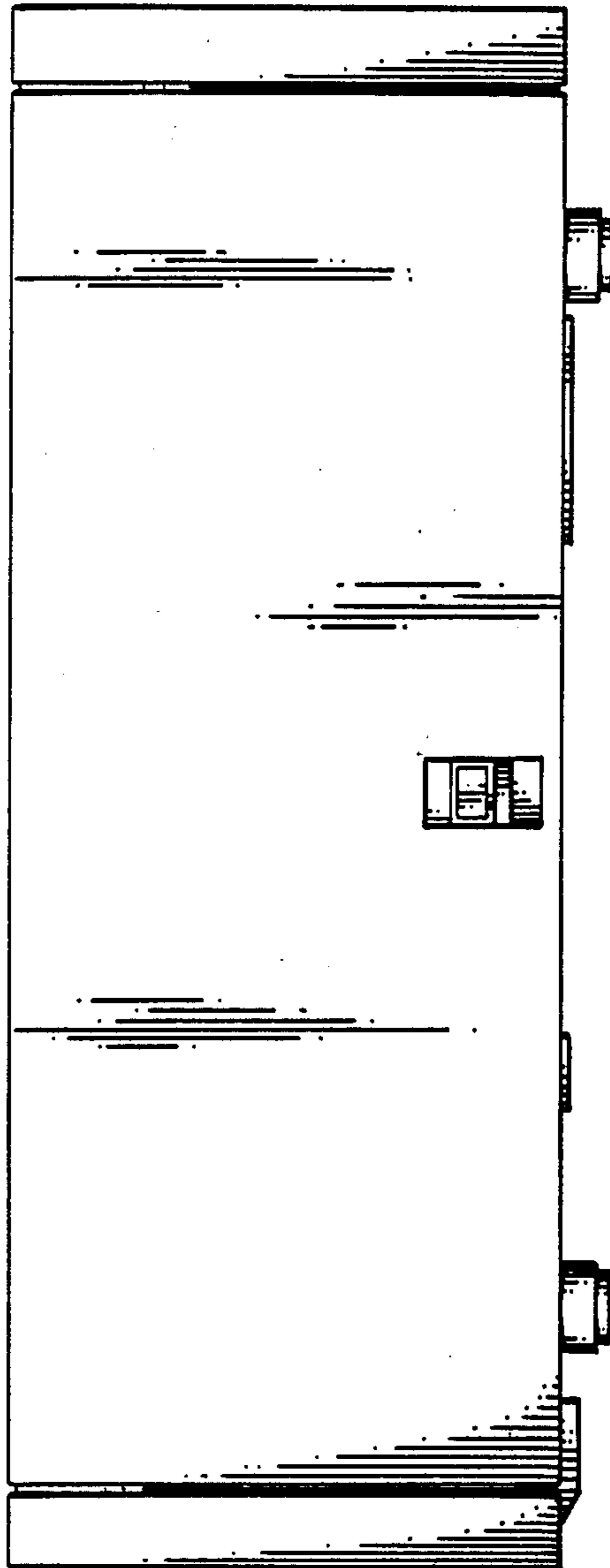

FIG. 5

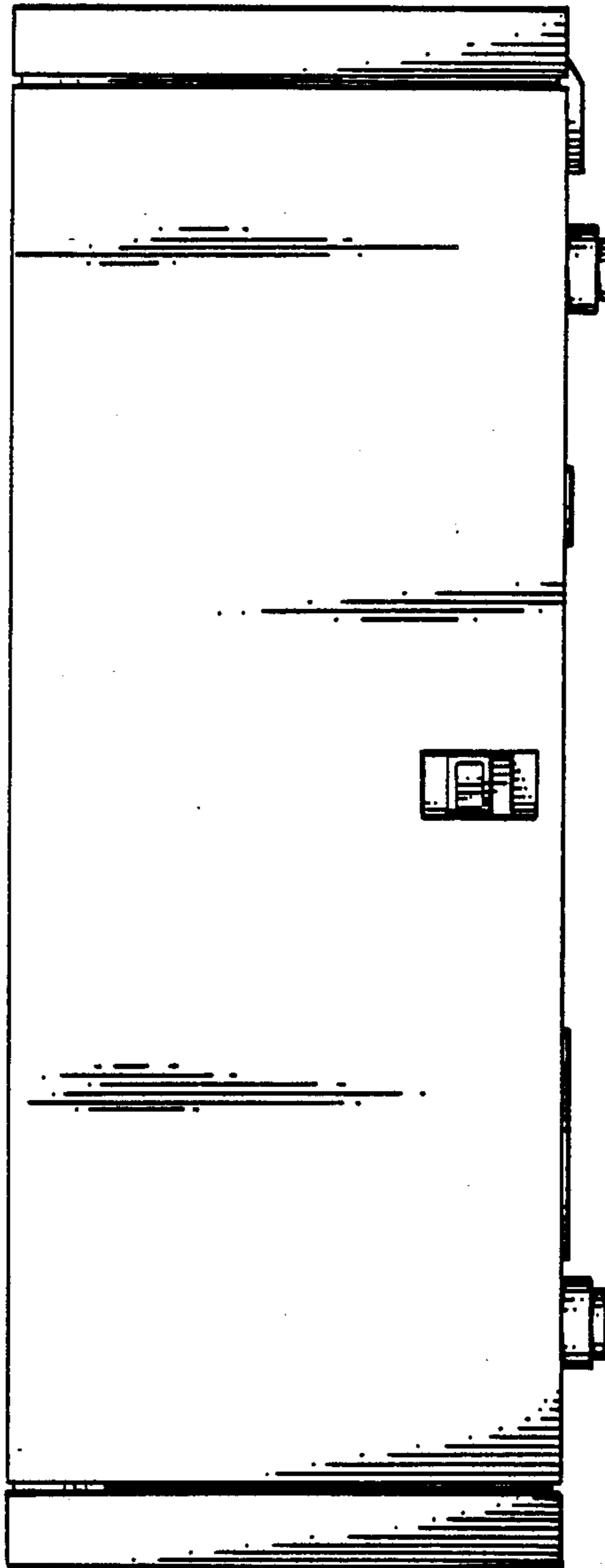

FIG. 6

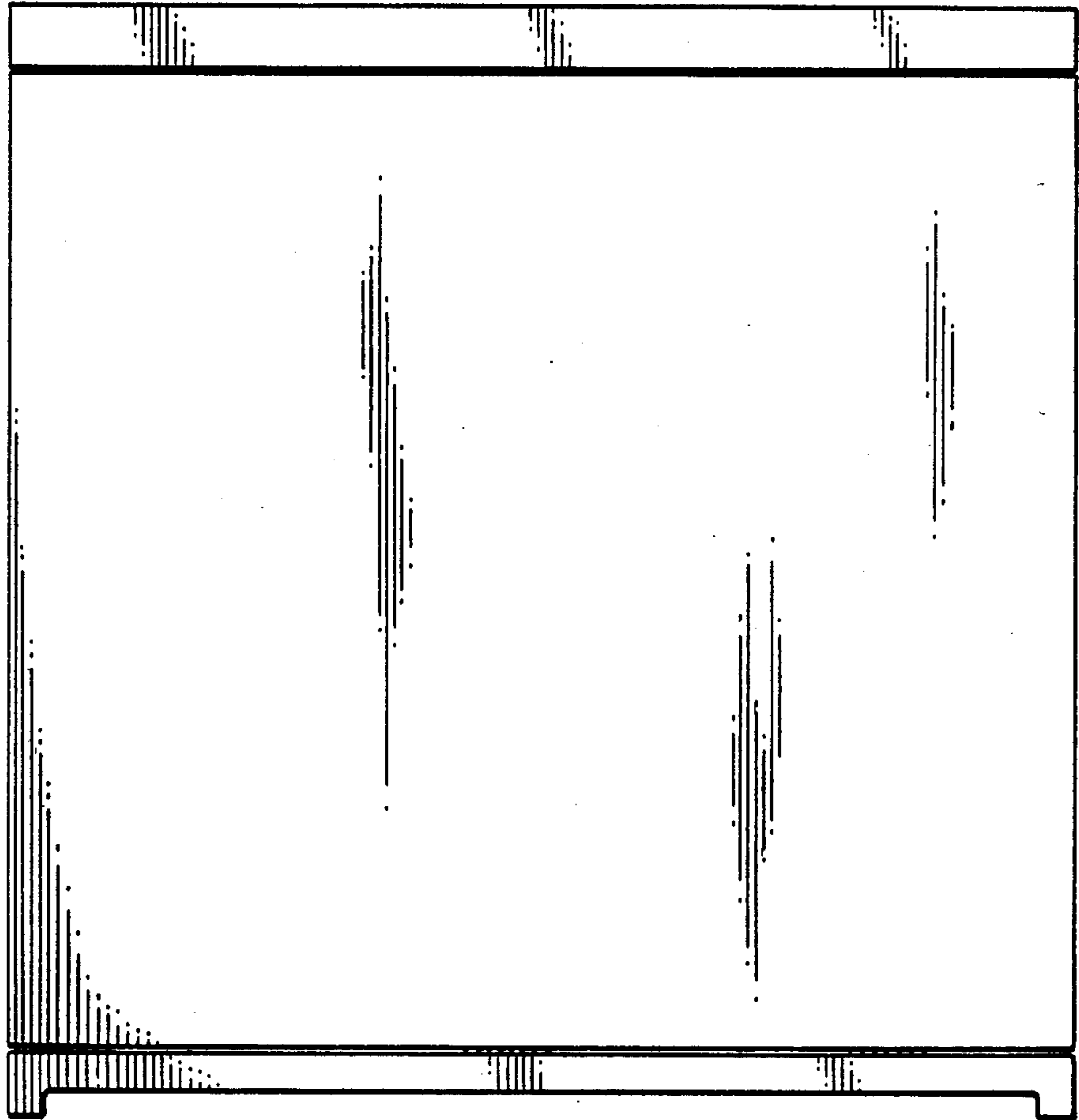

FIG. 7