

[54] KEY TELEPHONE SET

[75] Inventor: Akiyoshi Hattori, Kawasaki, Japan

[73] Assignee: Nitsuko Corporation, Kawasaki, Japan

[\*] Notice: The portion of the term of this patent subsequent to Feb. 14, 2006 has been disclaimed.

[\*\*] Term: 14 Years

[21] Appl. No.: 63,290

[22] Filed: Jun. 17, 1987

[30] Foreign Application Priority Data

Dec. 17, 1986 [JP] Japan ..... 61-49687

[52] U.S. Cl. .... D14/241; D14/151

[58] Field of Search ..... D14/52, 53, 57, 58, D14/59, 60, 63; 379/165, 156, 419, 420, 428, 432, 433, 436, 440

[56] References Cited

U.S. PATENT DOCUMENTS

- D. 236,627 7/1975 Henshaw et al. .... D14/63
- D. 282,841 3/1986 Inaba ..... D14/58
- D. 283,508 4/1986 Miyoke ..... D14/62 X
- D. 284,079 6/1986 Kita et al. .... D14/62 X
- D. 284,188 6/1986 Kondo et al. .... D14/58
- D. 287,012 12/1986 Yanagida et al. .... D14/53 X
- D. 287,361 12/1986 Sekiguchi et al. .... D14/62 X

- D. 293,439 12/1987 Nogas ..... D14/58
- D. 294,350 2/1988 Maliskas ..... D14/58
- D. 295,514 5/1988 Inaba ..... D14/62 X
- 4,602,132 7/1986 Nagafomi et al. .... 379/165 X

OTHER PUBLICATIONS

B. A. Pargh Catalog ©1985; p. 247, Sanyo MD3030; p. 250, Code-A-Phone 84106; GE 29280; p. 254 Panasonic VA8060; p. 255, Uniden XE 30; p. 260, Uniden XE 1040; Teleconcept Inc. 036212. Teleconnect Guide For Phone Systems, published 6/1985; Items #13; #15; #17; #32; #65 AT&T Merlin; #66; #72; #73; #74.

Primary Examiner—Horace B. Fay, Jr.  
Attorney, Agent, or Firm—Ladas & Parry

[57] CLAIM

The ornamental design for a key telephone set, as shown and described.

DESCRIPTION

FIGS. 1 and 2 are respectively front and rear elevational views of a key telephone set showing my new design; FIGS. 3 and 4 are respectively top and bottom plan views thereof; FIGS. 5 and 6 are respectively left and right side elevational views thereof; and FIG. 7 is a perspective view thereof with handset shown inverted and spaced apart from the base.

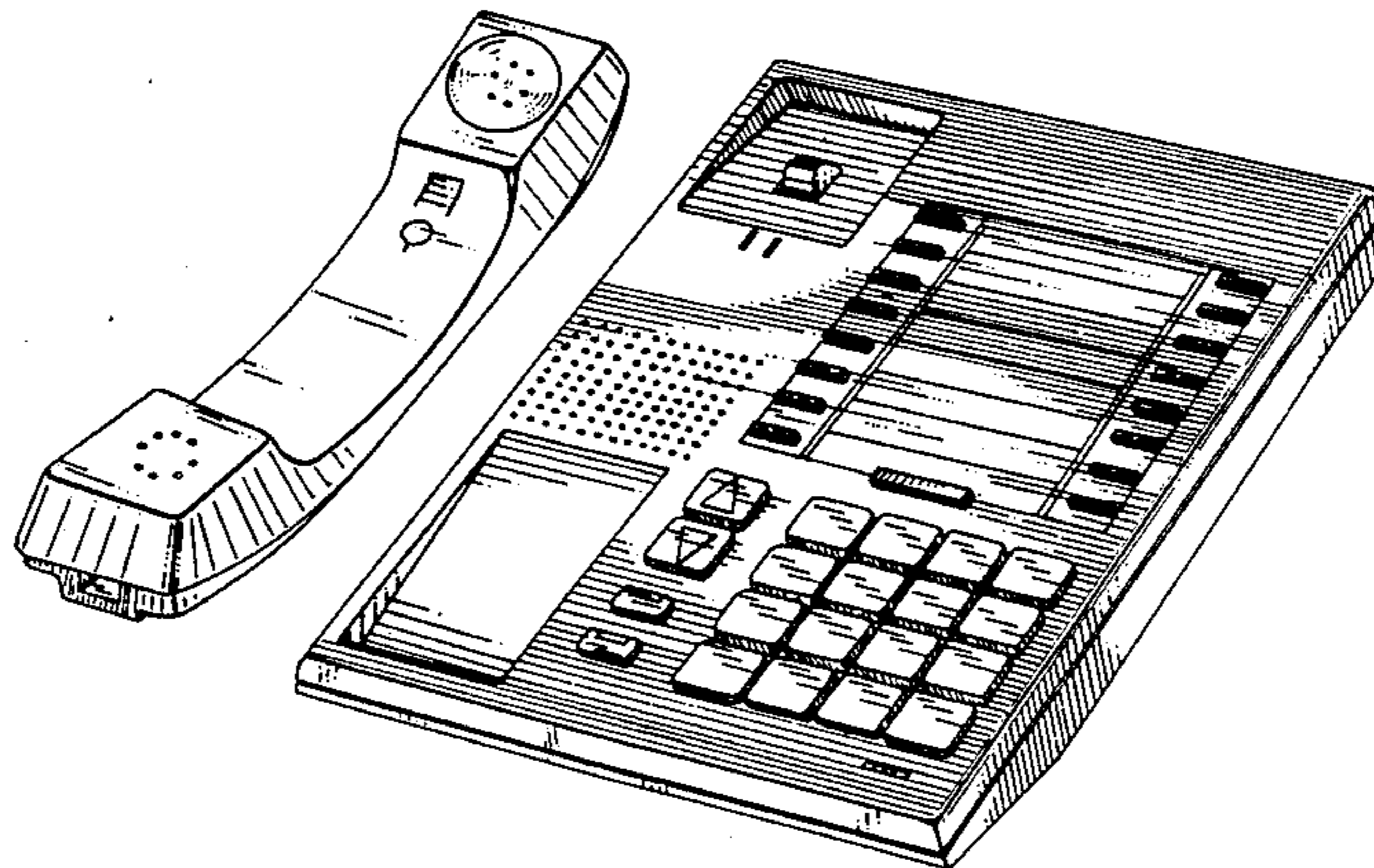
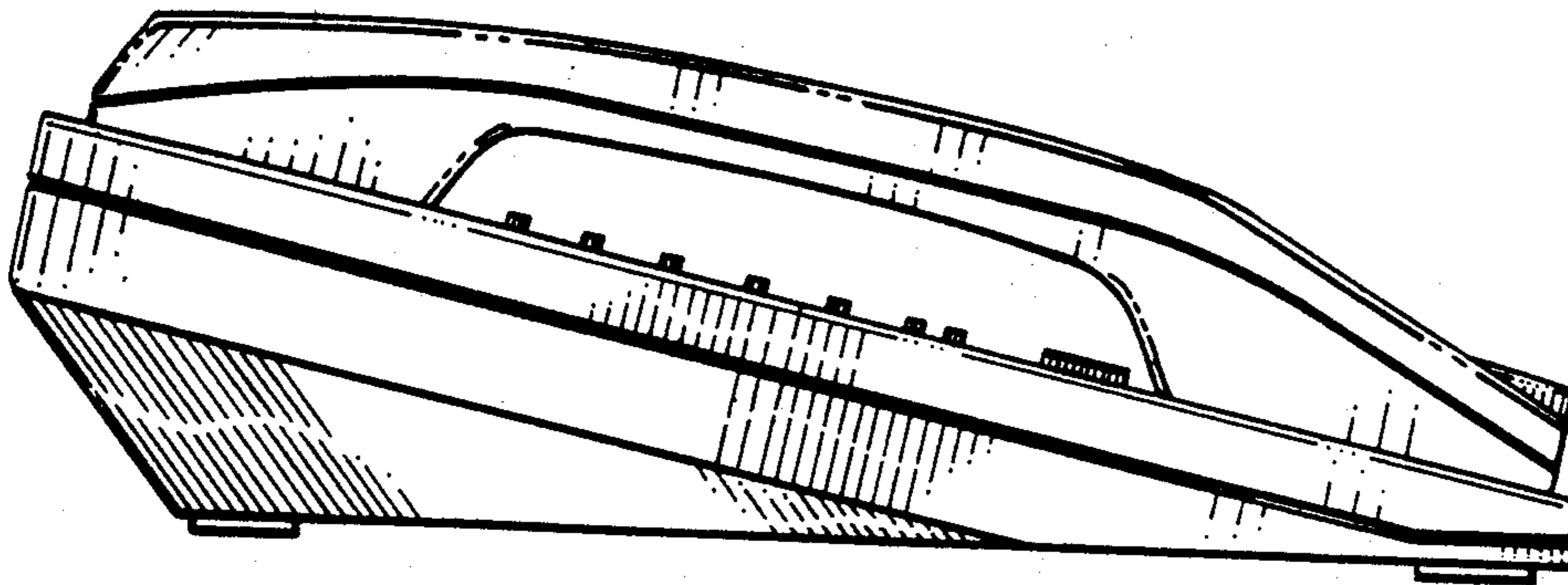

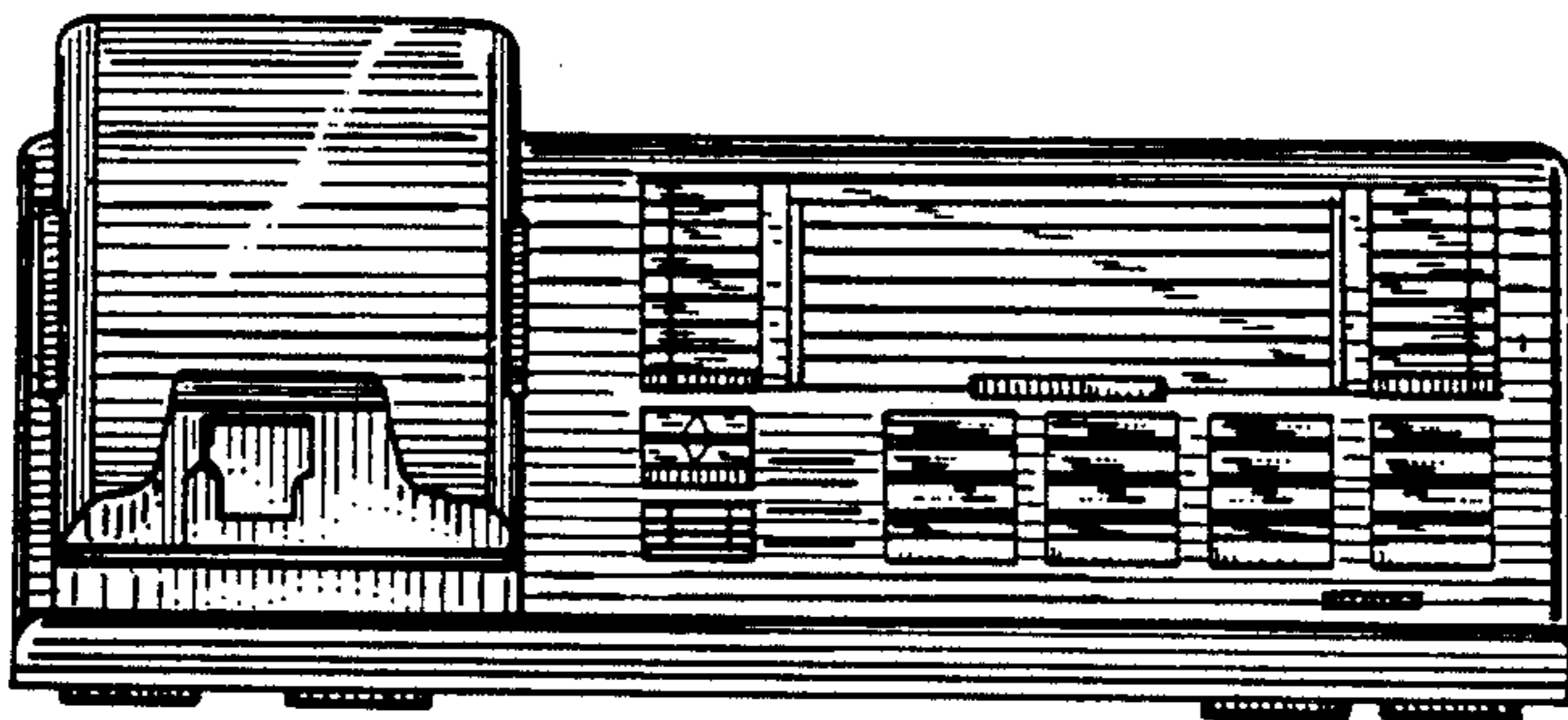

FIG. 1

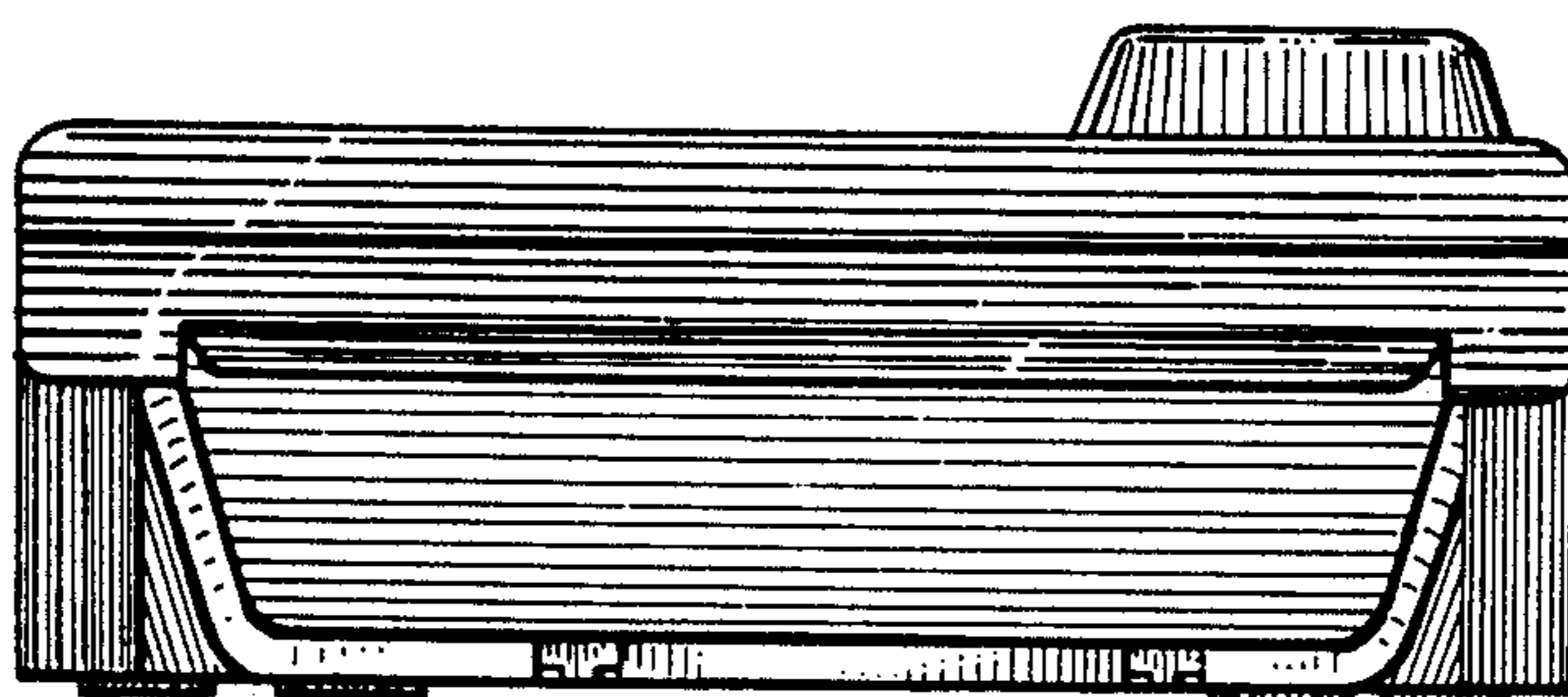

FIG. 2

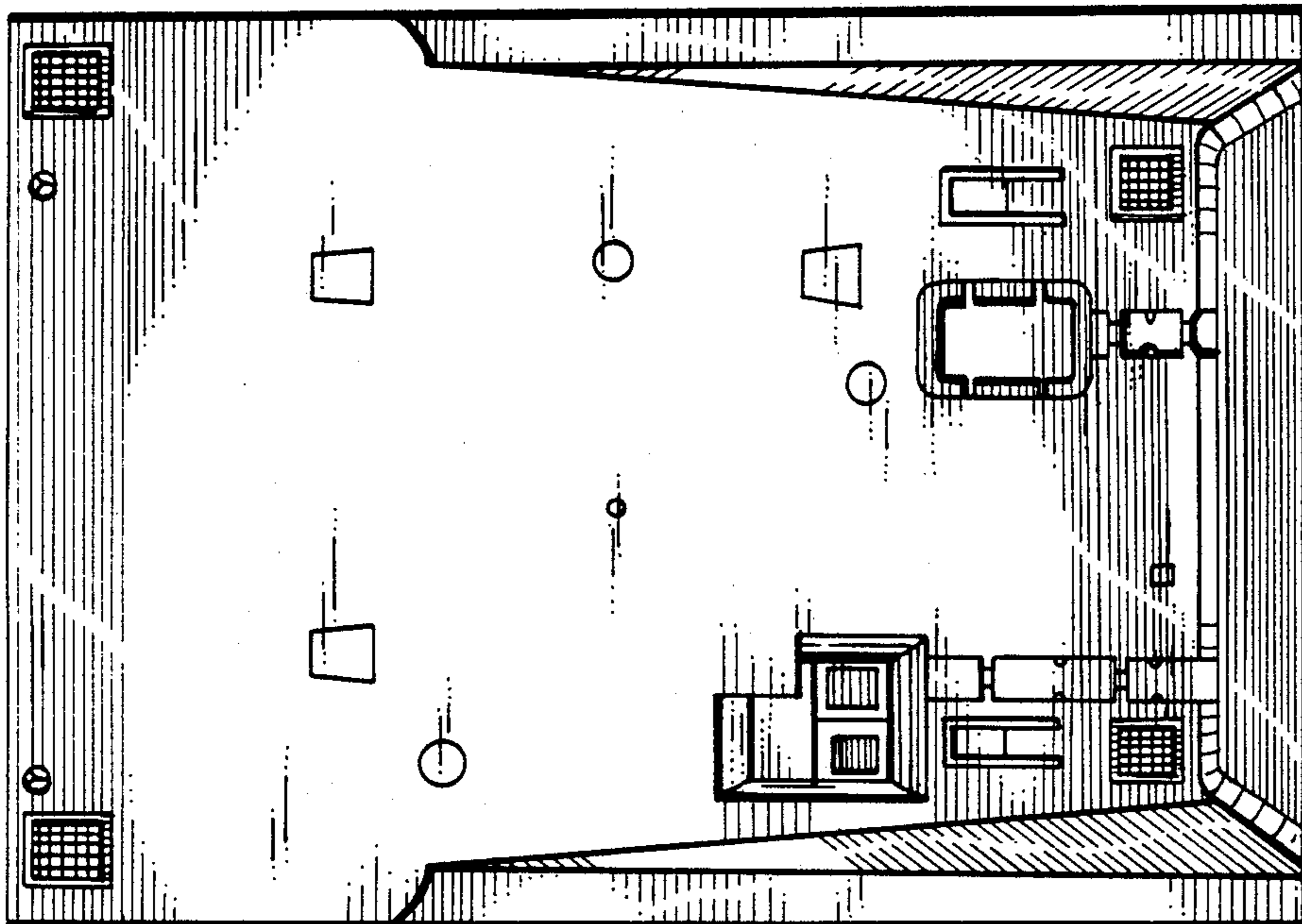

FIG. 4

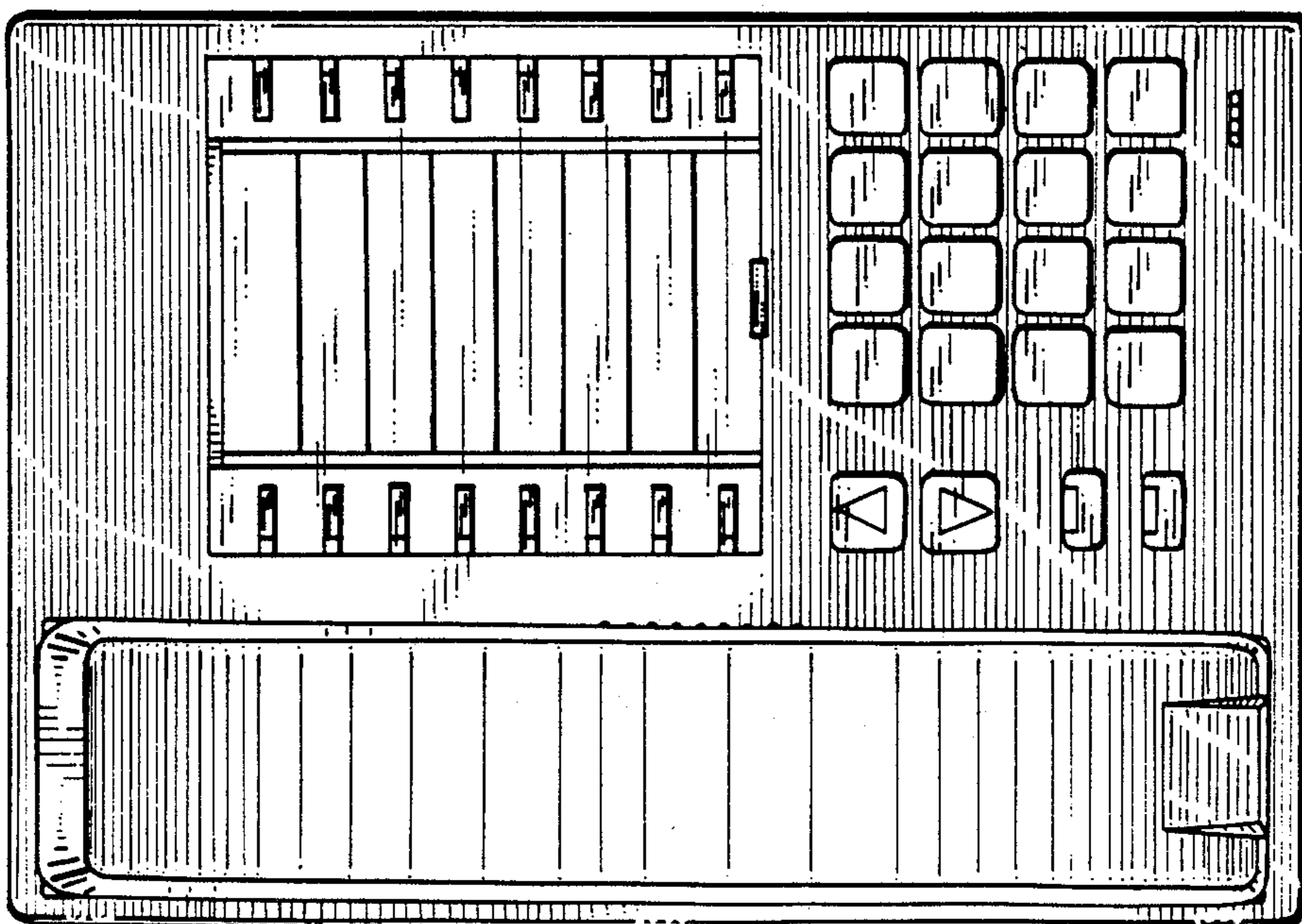

FIG. 3

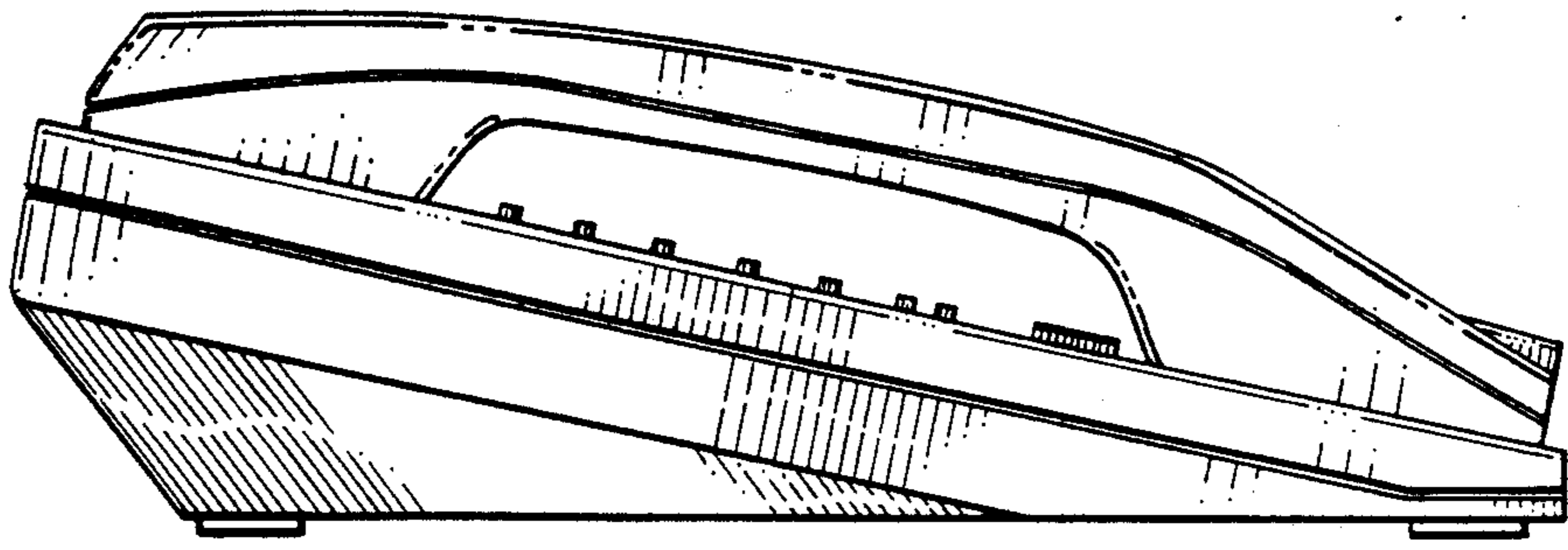

FIG. 5

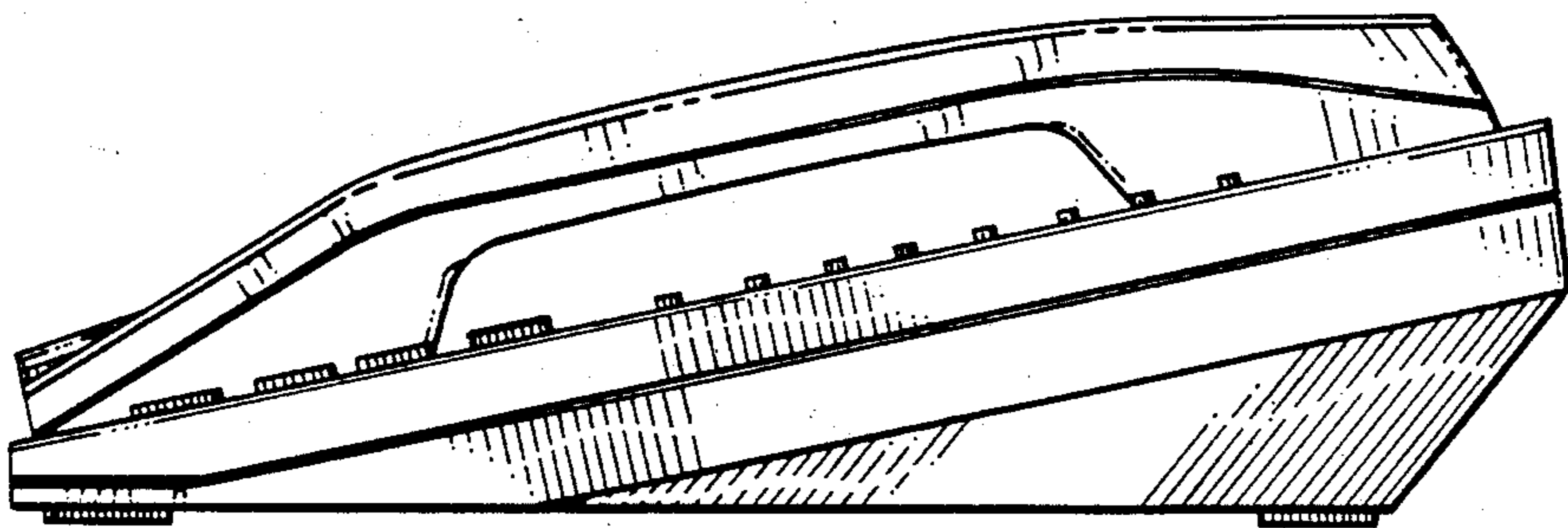

FIG. 6

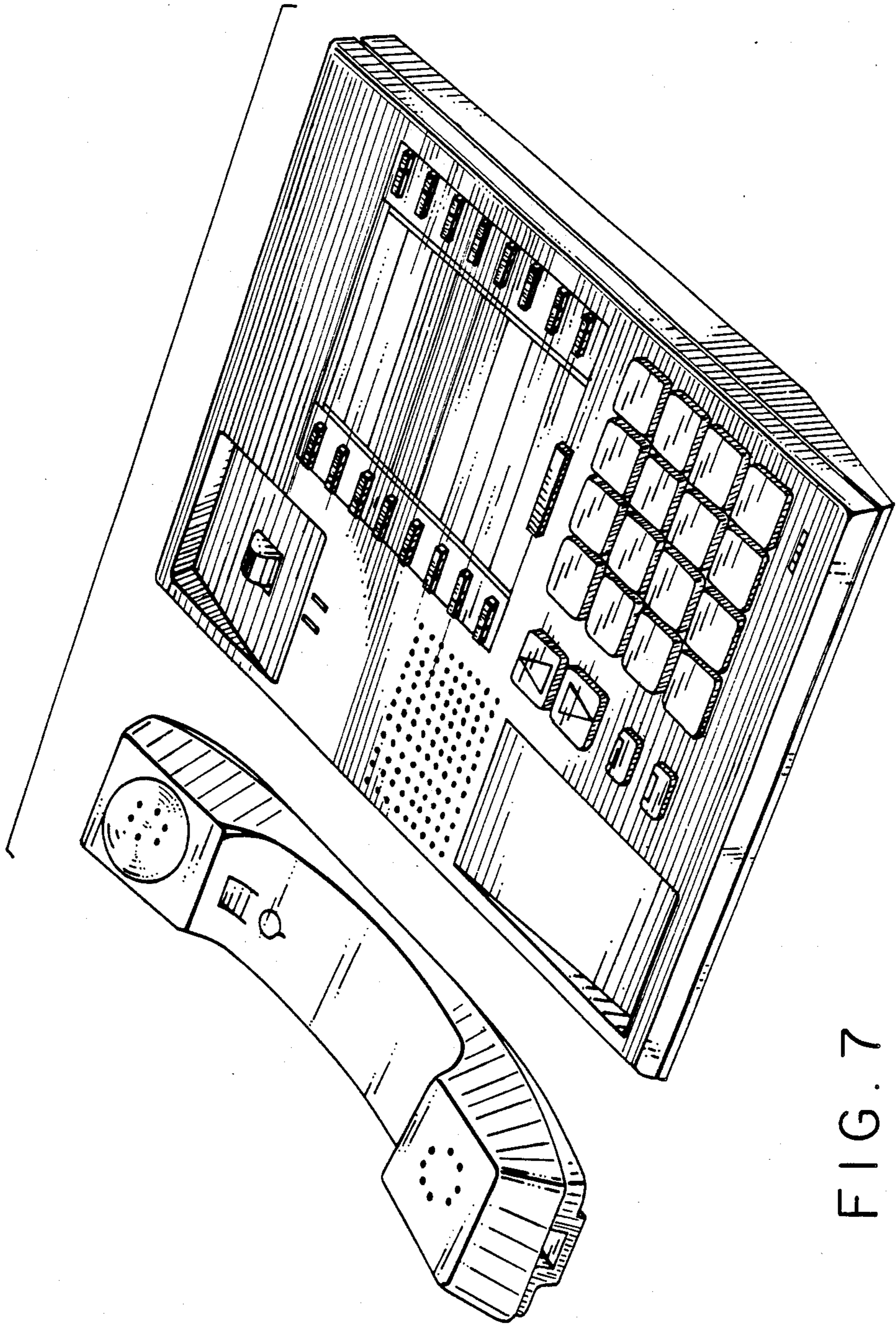

FIG. 7