

[54] CONTROL UNIT FOR A COMMUNICATIONS SYSTEM

[75] Inventor: Douglas M. Dickson, Lynchburg, Va.

[73] Assignee: General Electric Company, Lynchburg, Va.

[**] Term: 14 Years

[21] Appl. No.: 38,271

[22] Filed: Apr. 13, 1987

[52] U.S. Cl. D14/241; D14/142; D14/243; D14/247; D14/151; 379/440; 379/420

[58] Field of Search D14/140, 146, 142, 144, D14/151, 150, 241; 379/165, 440, 420, 419, 428, 432, 436

[56] References Cited

U.S. PATENT DOCUMENTS

- D. 121,131 6/1940 Stolzenberger, Jr. D14/241
D. 203,596 2/1966 Kamp D14/241
D. 211,253 6/1968 Sundquist et al. D14/241
D. 232,226 7/1974 Bee et al. D14/241
D. 243,536 3/1977 van de Poel D14/57
D. 247,174 2/1978 Janda D14/150
D. 253,937 1/1980 Sulek et al. D10/46
D. 255,032 5/1980 Maddock D14/92
D. 256,918 9/1980 White D14/241
D. 264,969 6/1982 McGourty D14/96
D. 268,109 3/1983 Richelet et al. D14/241
D. 269,780 7/1983 Doodson D14/57

- D. 278,812 5/1985 Topp D14/53
D. 282,358 1/1986 Campbell et al. D14/241
D. 289,644 5/1987 Aldrich et al. D14/142 X
D. 293,319 12/1987 Matsuda et al. D14/241
3,482,164 12/1969 Lawson 325/21

Primary Examiner—Horace B. Fay, Jr.
Attorney, Agent, or Firm—Nixon & Vanderhye

[57] CLAIM

The ornamental designs for a control unit for a communications system, as shown and described.

DESCRIPTION

FIG. 1 is a left side, top and front perspective view of a control unit for a communication system showing my new design;
FIG. 2 is a top plan view thereof;
FIG. 3 is a front elevational view thereof;
FIG. 4 is a right side elevational view thereof, the side opposite being a mirror image;
FIG. 5 is a rear elevational view thereof;
FIG. 6 is a bottom plan view thereof; and
FIGS 7, 8, and 9 are top plan views, similar to FIG. 2, are showing a second, third and fourth embodiment thereof, all other views of these said additional embodiments being identical to the side elevational view and bottom plan views of FIGS. 5 and 6.
FIGS. 7, 8 and 9 are views similar to FIG. 2 illustrating additional embodiments of the present invention, respectively, all other views of these embodiments being identical to the side elevational view of FIG. 4 and the rear and bottom plan views of FIGS. 5 and 6, respectively.

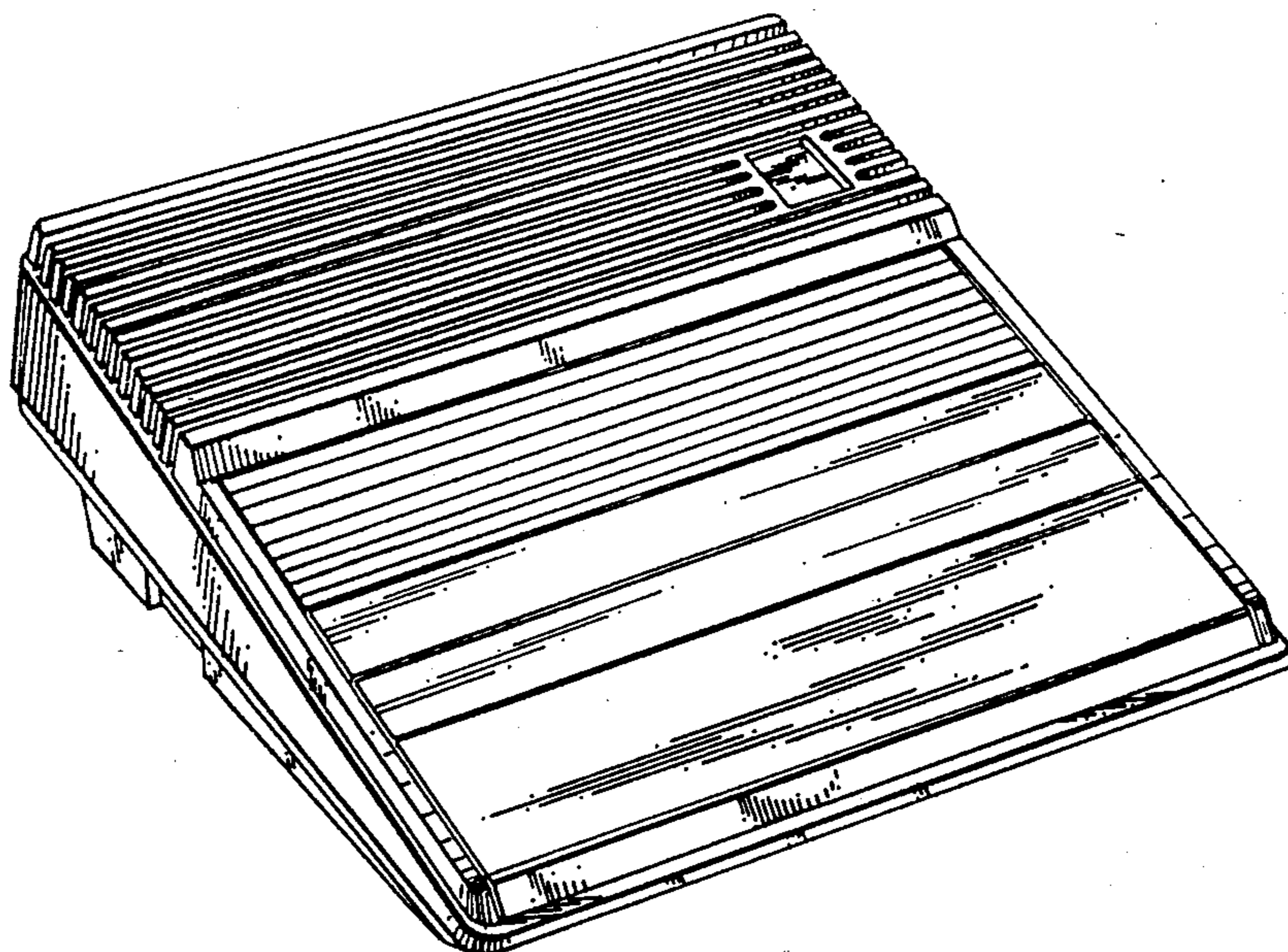

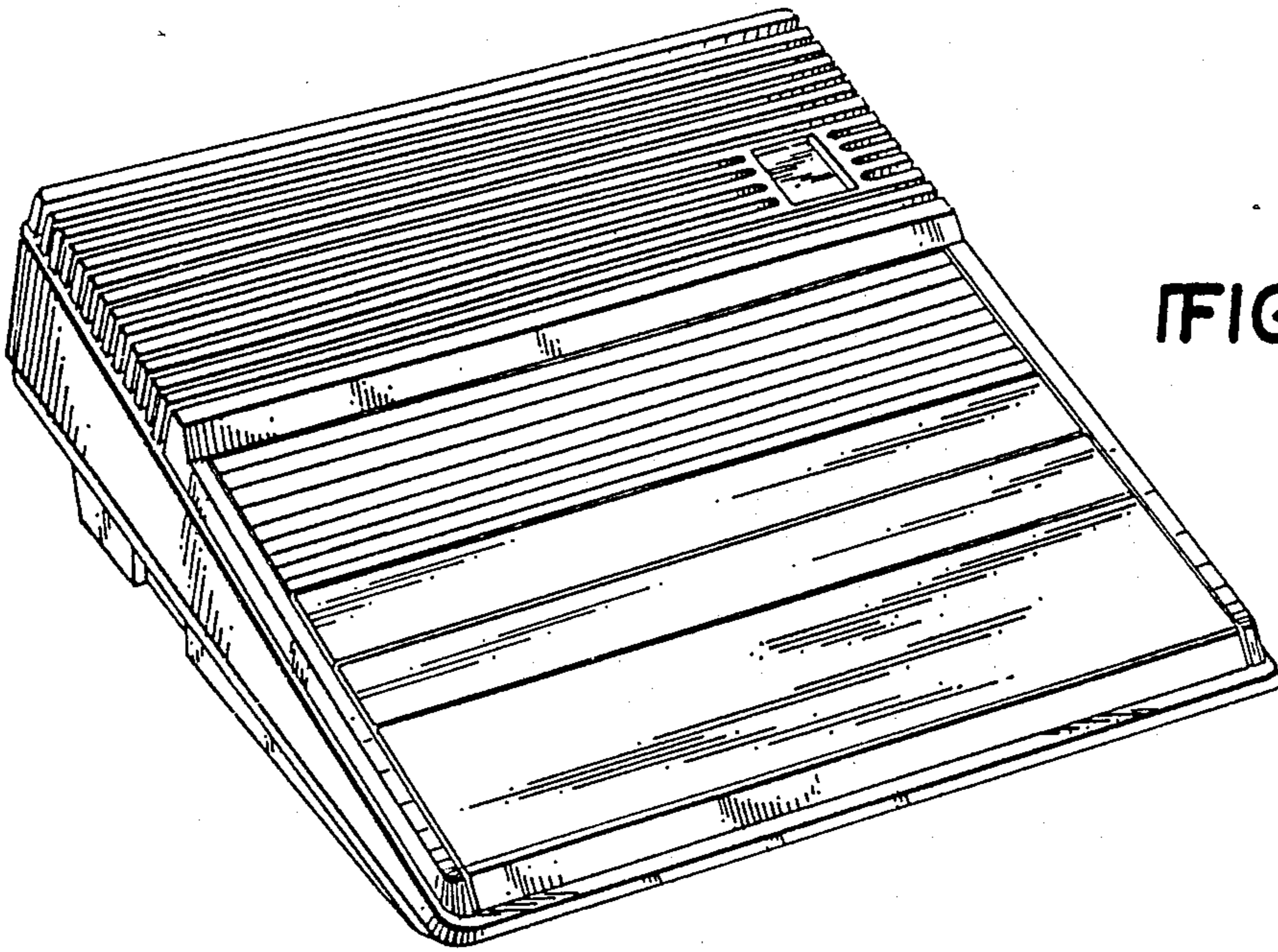

FIG. 1

FIG. 2

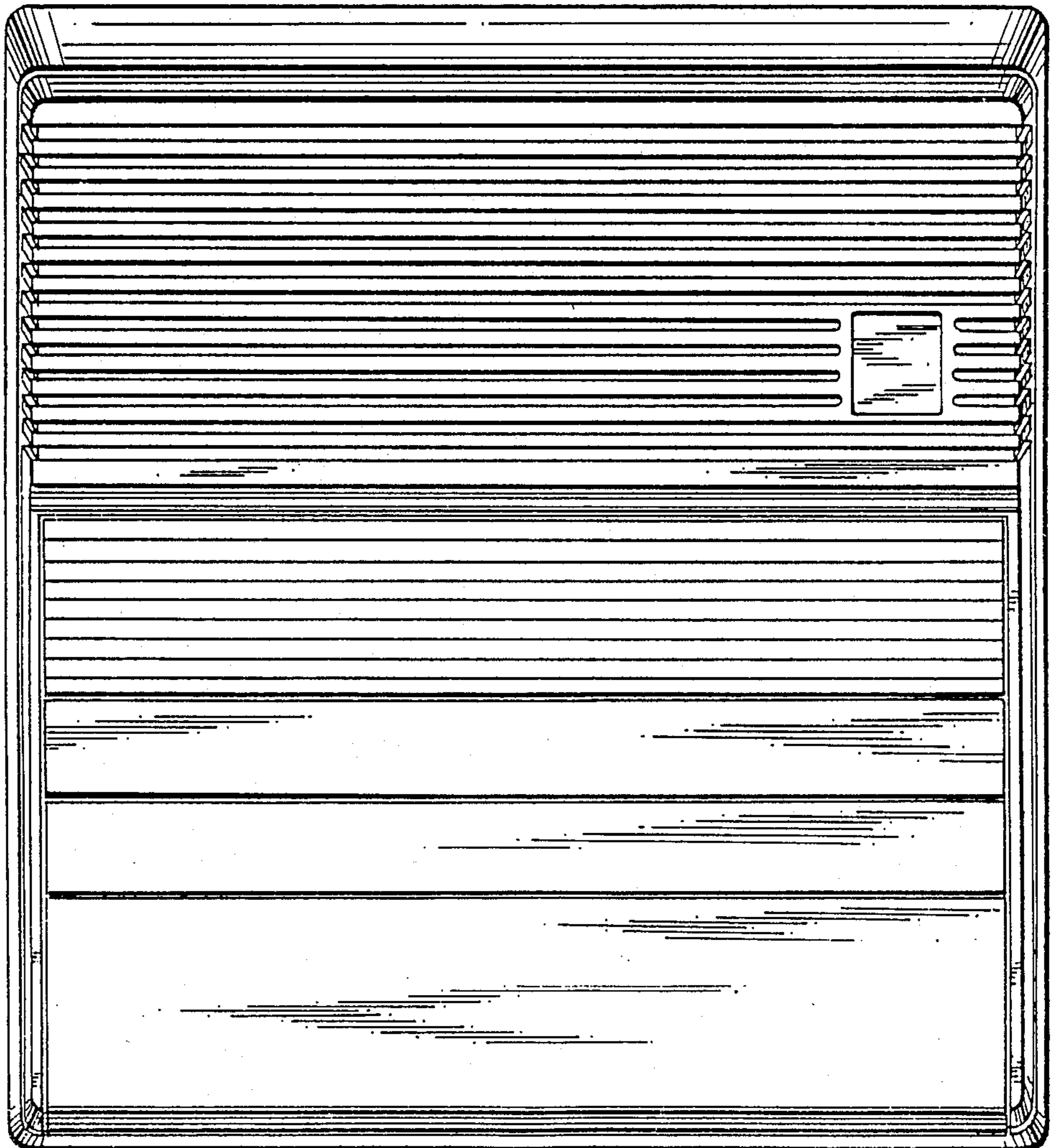

FIG. 3

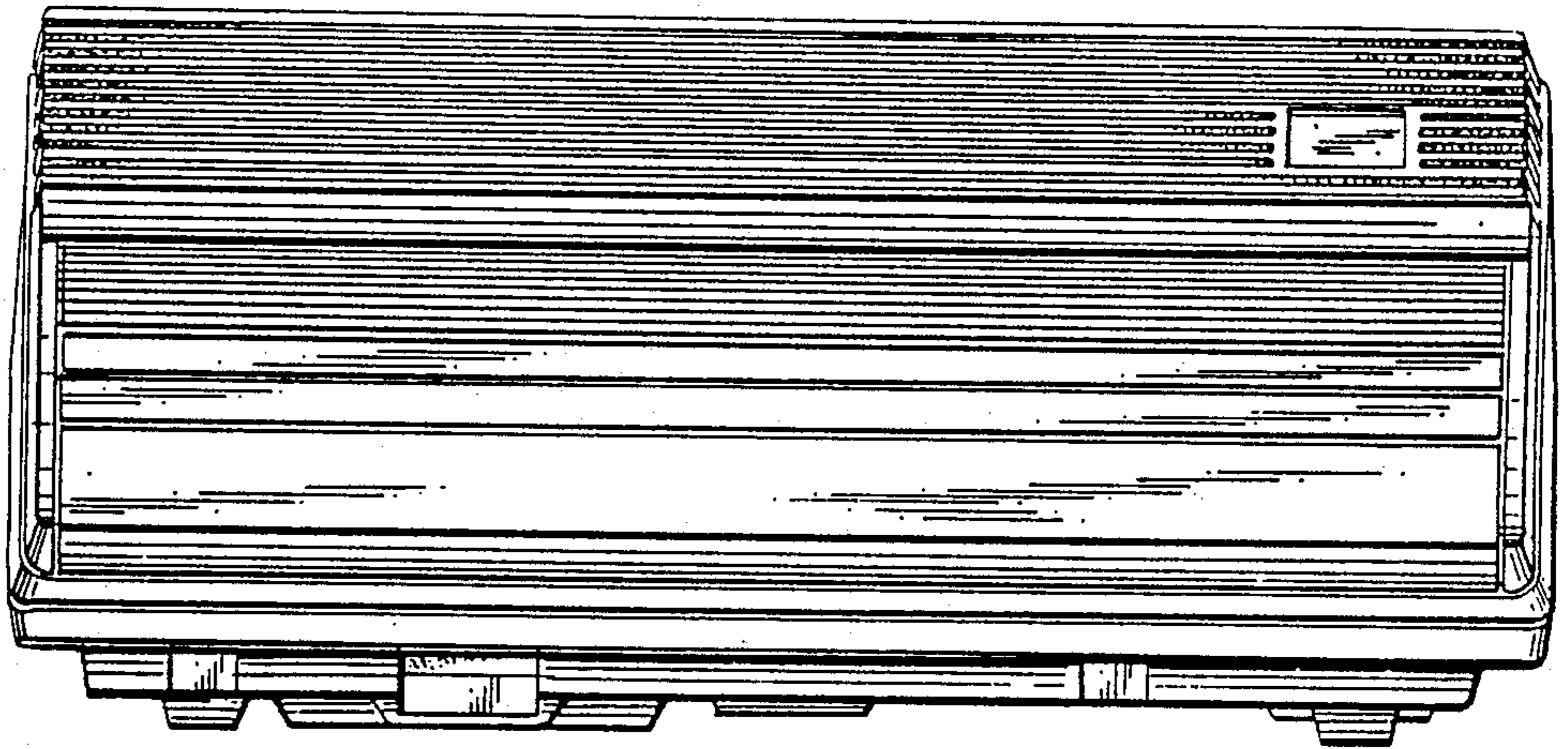

FIG. 4

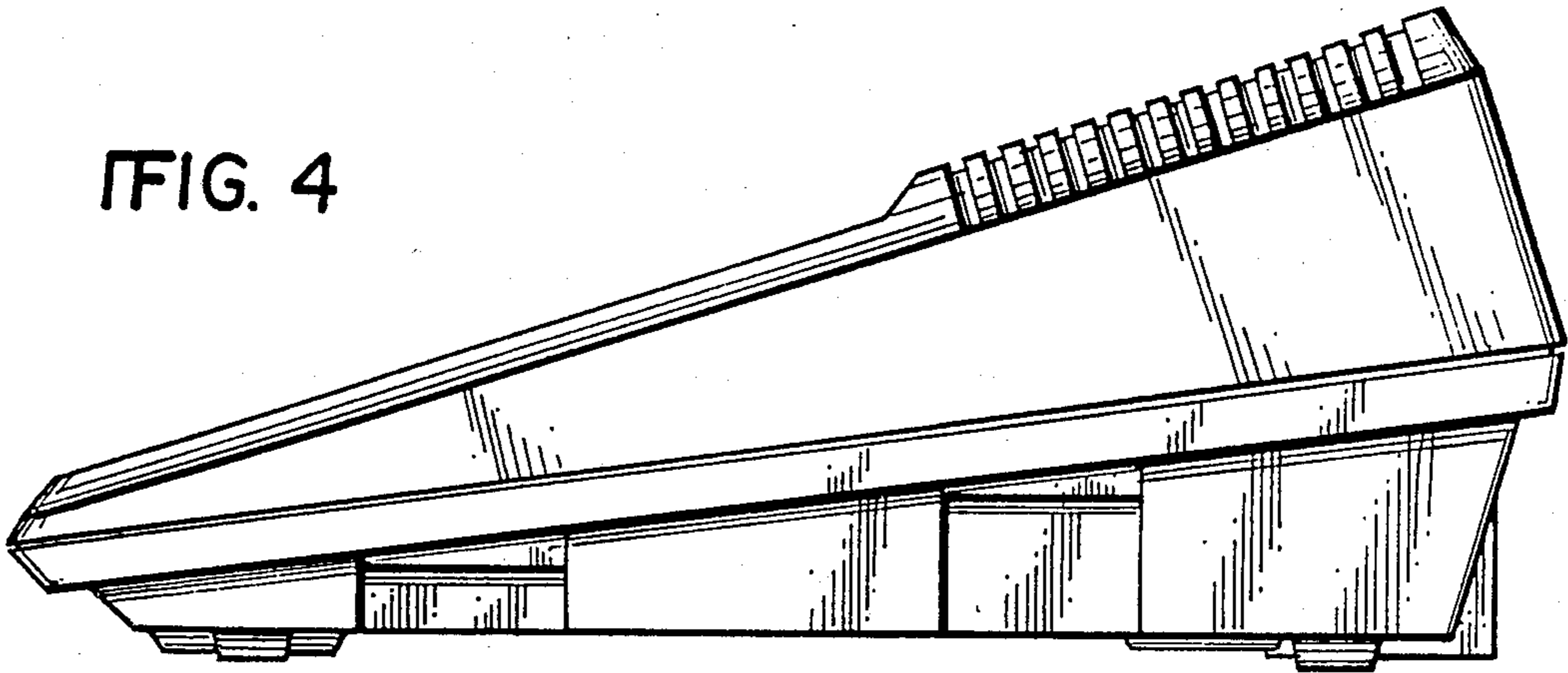

FIG. 5

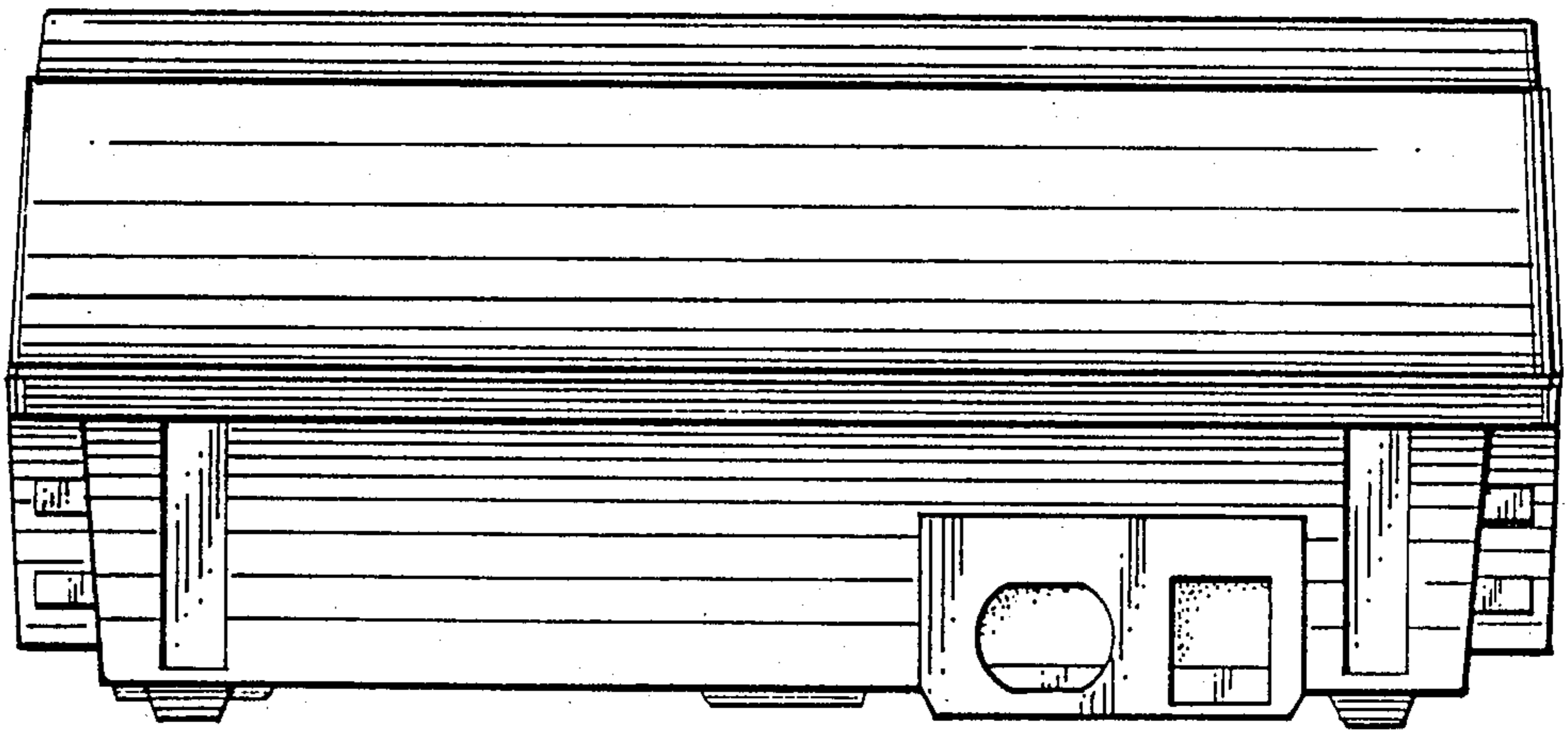

FIG. 6

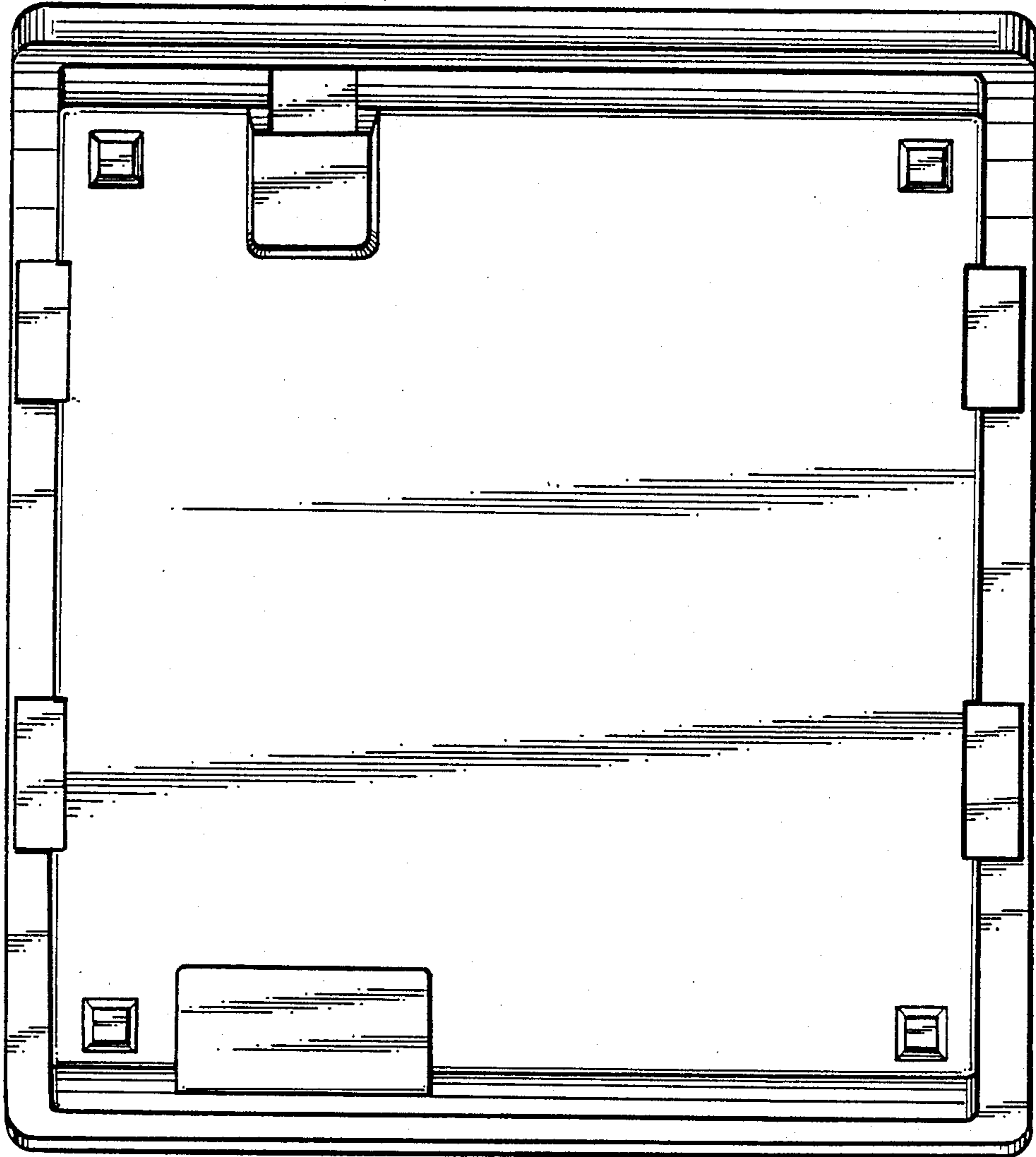

FIG. 7

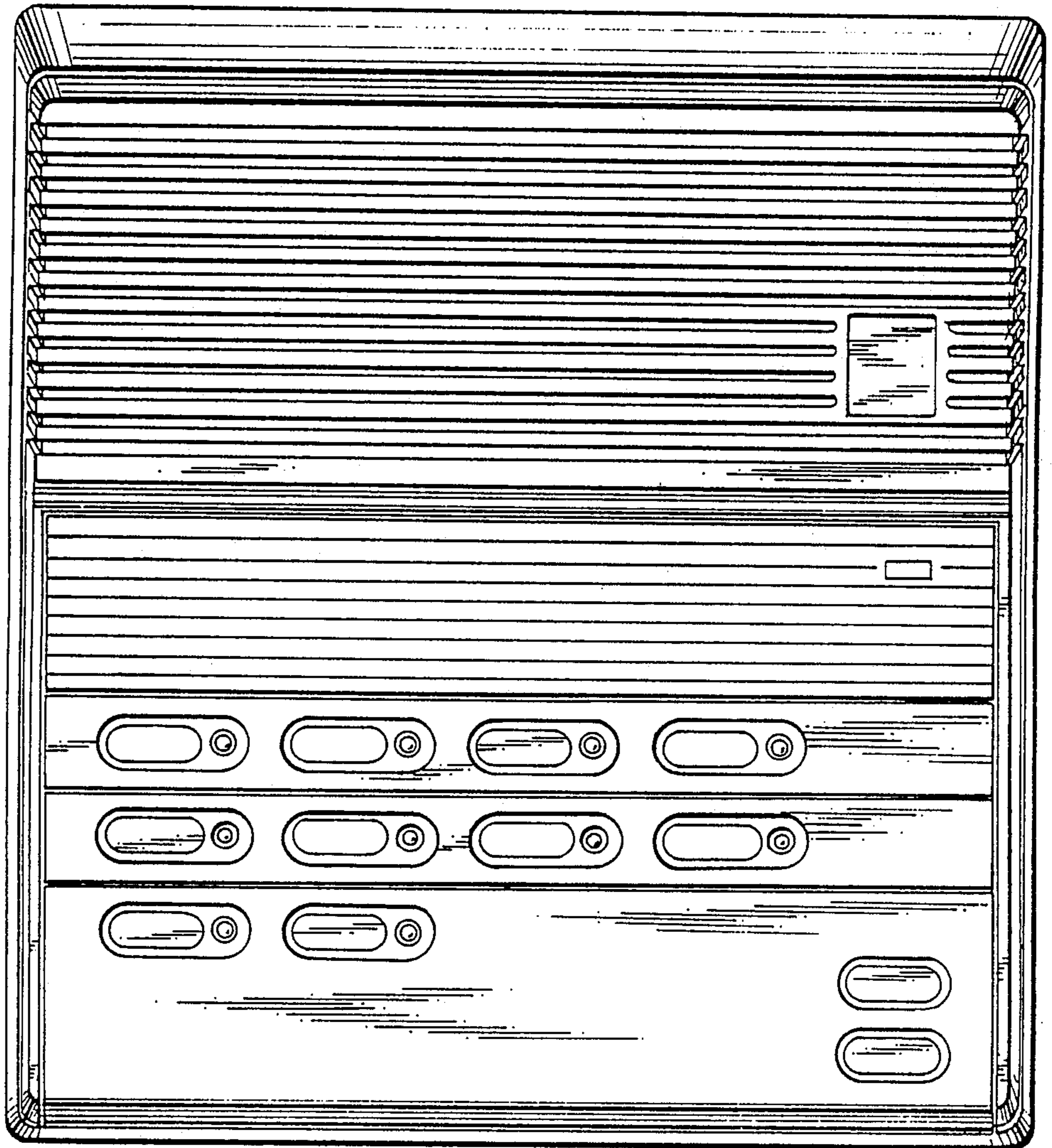

FIG. 8

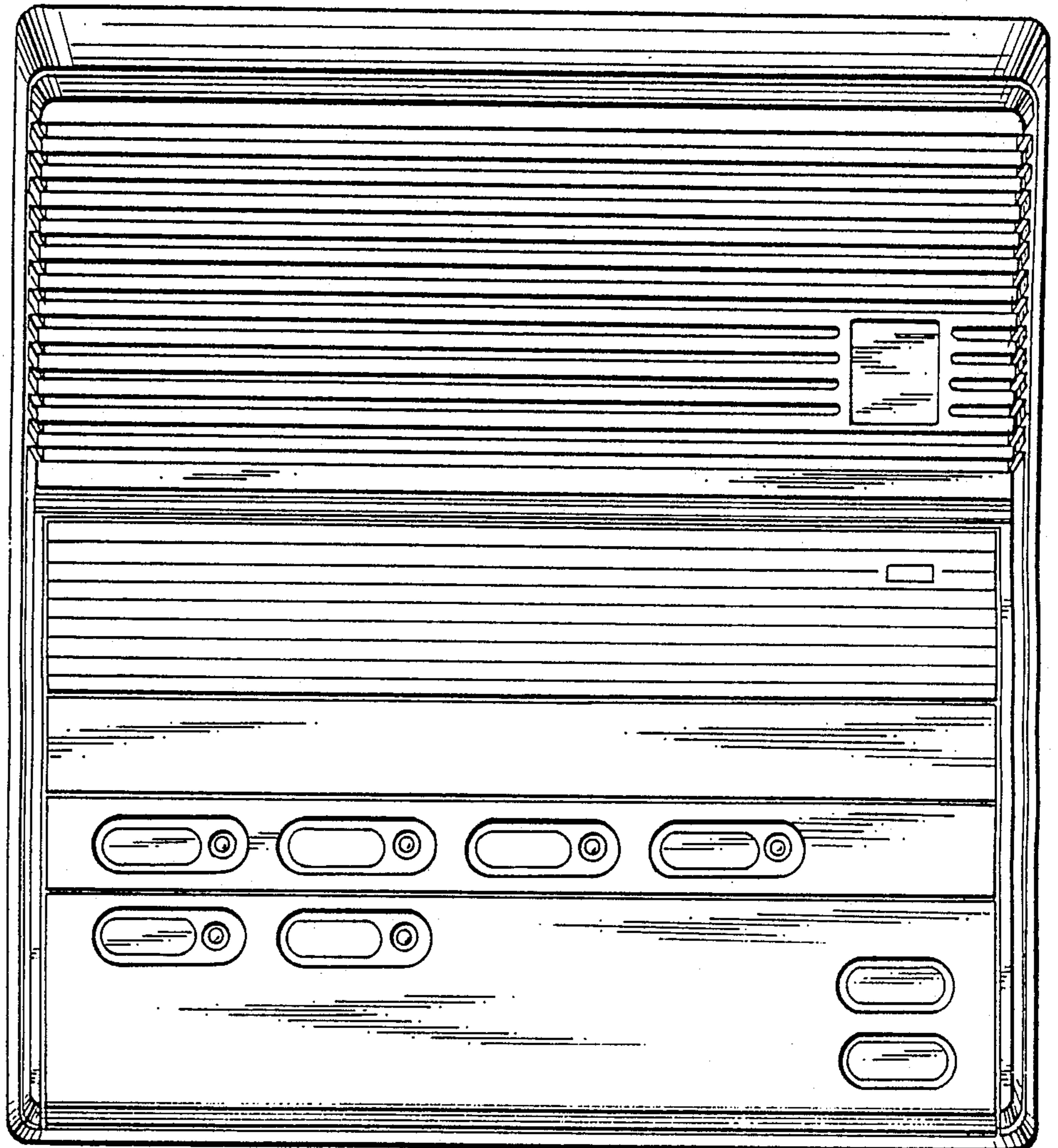

FIG. 9

