

[54] MANUAL IMPRINTER

[75] Inventors: Mark Cunnane, Clontarf; Richard P. Delaney, Portmarnock, both of Ireland

[73] Assignee: Security Imprinter Corporation, Walkersville, Md.

[\*\*] Term: 14 Years

[21] Appl. No.: 911,082

[22] Filed: Sep. 23, 1986

[30] Foreign Application Priority Data

May 30, 1986 [IE] Ireland ..... 166/86

[52] U.S. Cl. .... D18/14

[58] Field of Search ..... D18/13, 14, 21; 101/18, 101/28, 45, 56, 252, 269, 270

[56] References Cited

U.S. PATENT DOCUMENTS

- D. 191,332 9/1961 Maul ..... D18/14
- D. 217,398 4/1970 Barbour ..... D18/14
- D. 218,991 10/1970 Allport ..... D18/14
- D. 225,376 12/1972 Yamamoto ..... D18/14
- D. 229,234 11/1973 Kato ..... D18/21
- D. 261,151 10/1981 Barbour ..... D18/14

- D. 261,152 10/1981 Barbour ..... D18/14
- D. 291,812 9/1987 Gingras ..... D18/14
- 3,486,447 12/1969 Stocker ..... 101/269
- 4,281,596 8/1981 Bowen ..... 101/269
- 4,324,178 4/1982 Barbour ..... 101/45

Primary Examiner—Nelson C. Holtje  
Assistant Examiner—Caron D. Veynar  
Attorney, Agent, or Firm—Mason, Fenwick & Lawrence

[57] CLAIM

The ornamental design for a manual imprinter, as shown and described.

DESCRIPTION

FIG. 1 is a perspective view of a manual imprinter showing our new design;  
 FIG. 2 is a top plan view thereof;  
 FIG. 3 is a top plan view thereof, the imprinter handle in an alternate position;  
 FIG. 4 is a right side elevational view thereof;  
 FIG. 5 is a left side elevational view thereof;  
 FIG. 6 is a front elevational view thereof;  
 FIG. 7 is a front elevational view thereof, the imprinter handle in an alternate position;  
 FIG. 8 is a rear elevational view thereof;  
 FIG. 9 is a rear elevational view thereof, the imprinter handle in an alternate position;  
 FIG. 10 is a bottom plan view thereof.

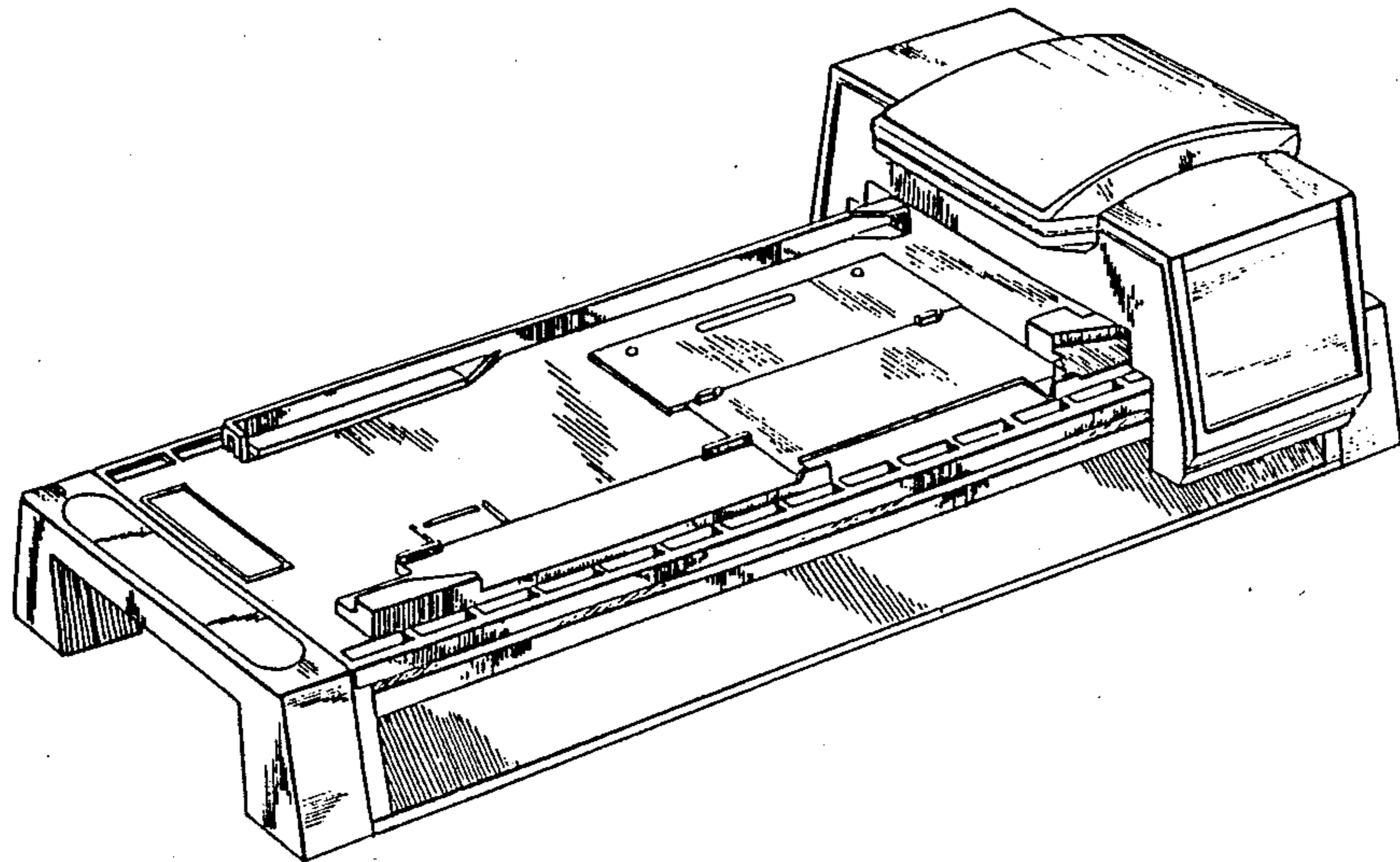

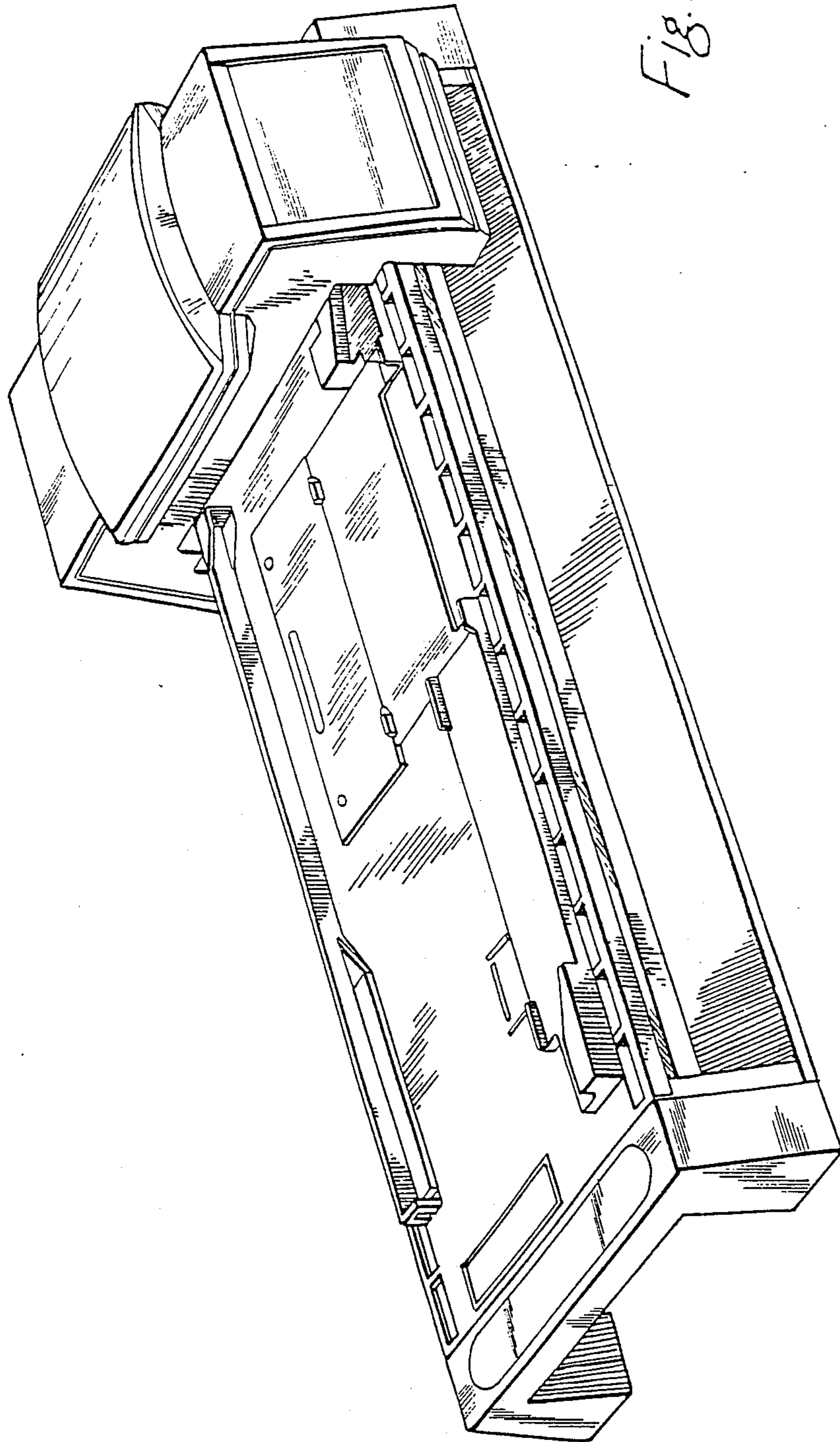

Fig. 1

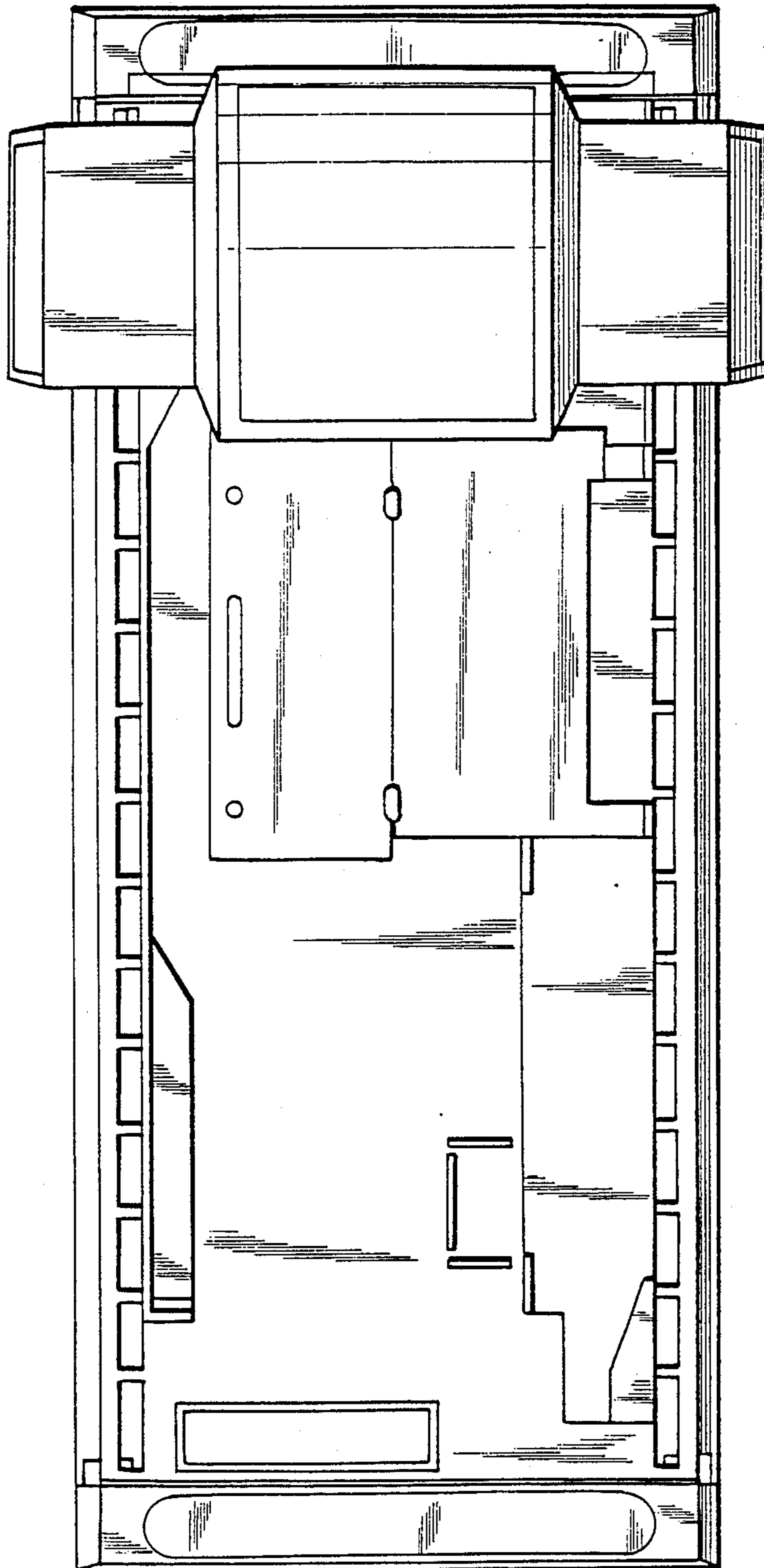

Fig. 2

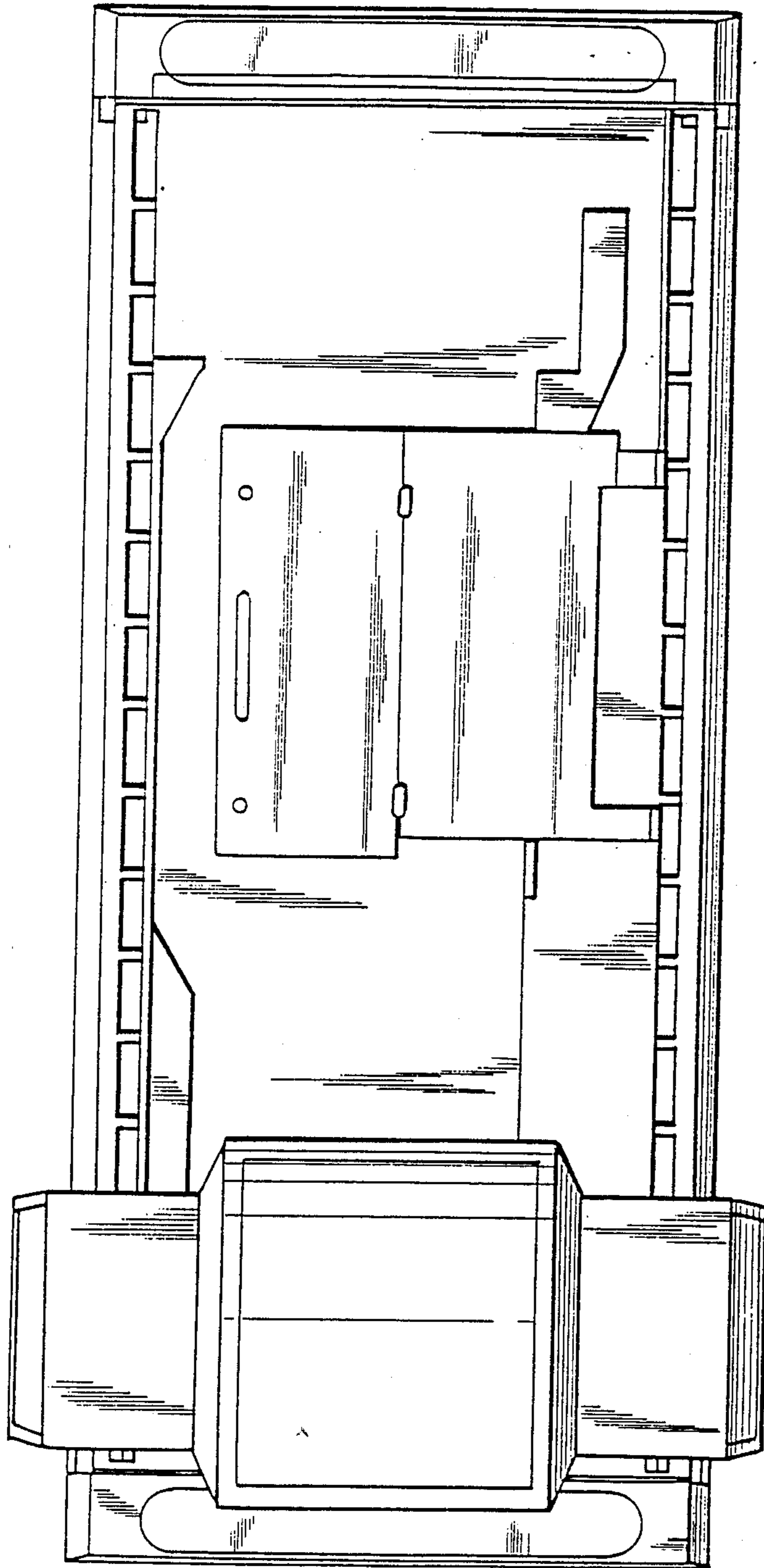

Fig. 3



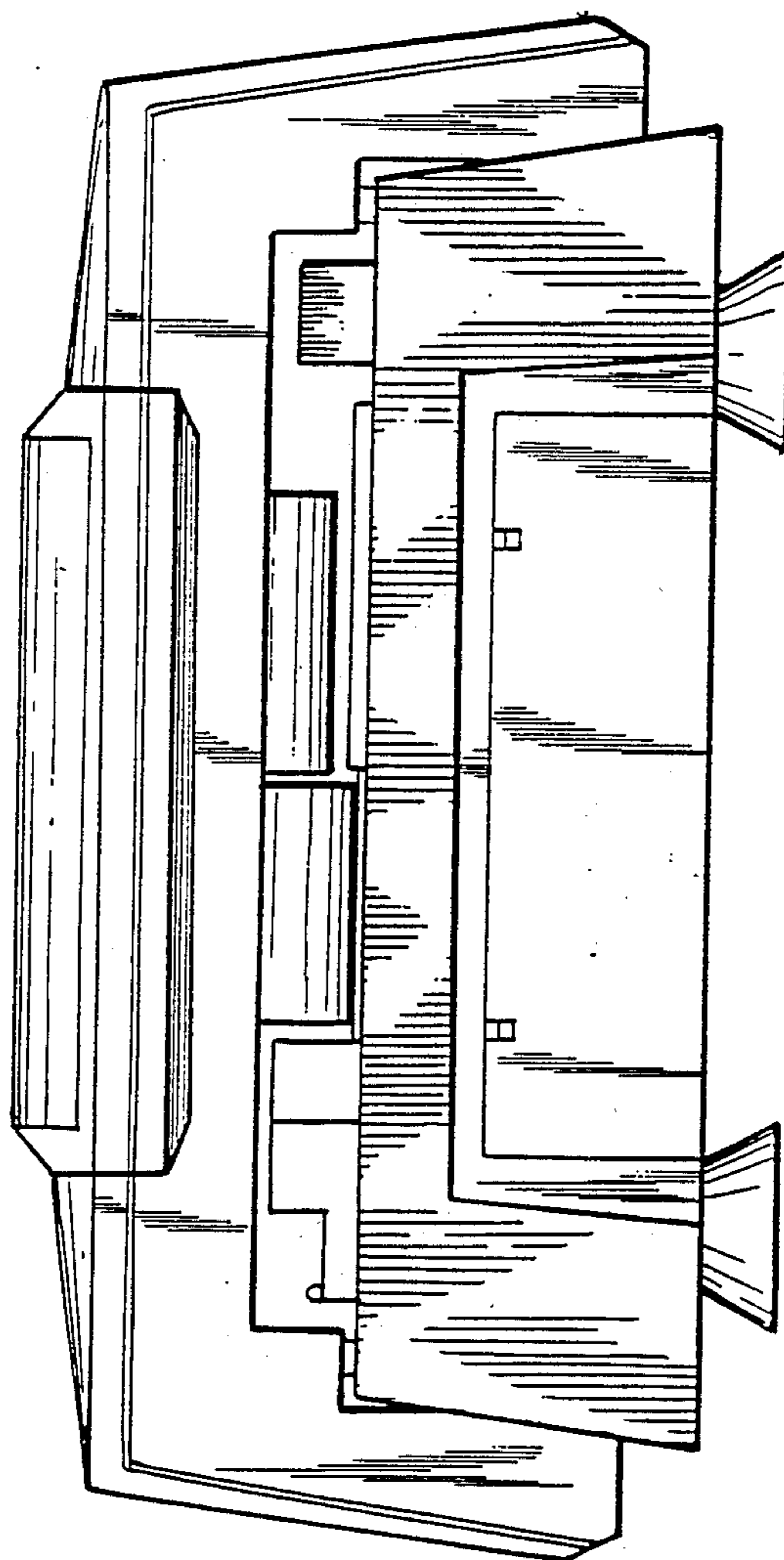

Fig. 4

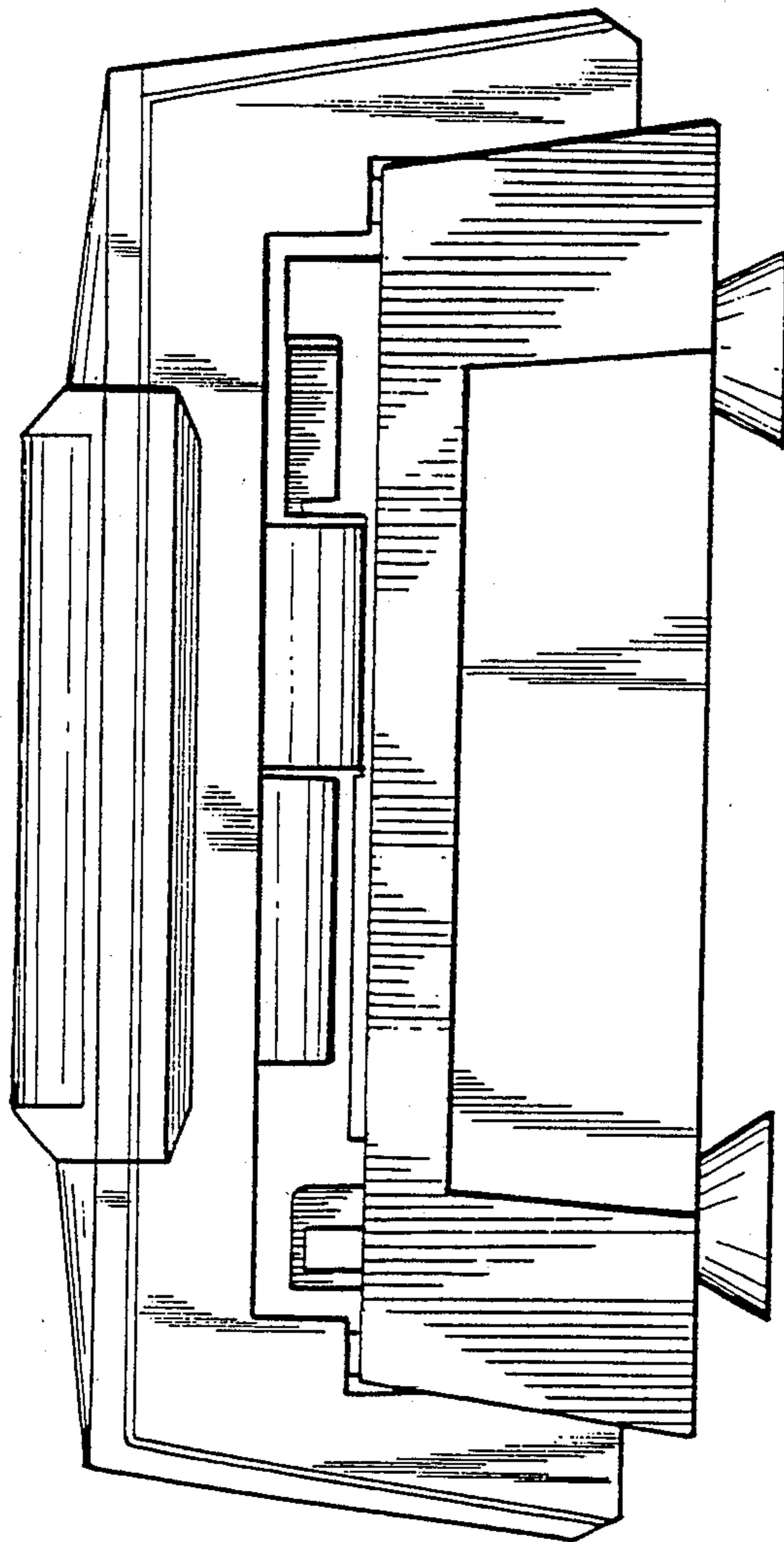

Fig. 5

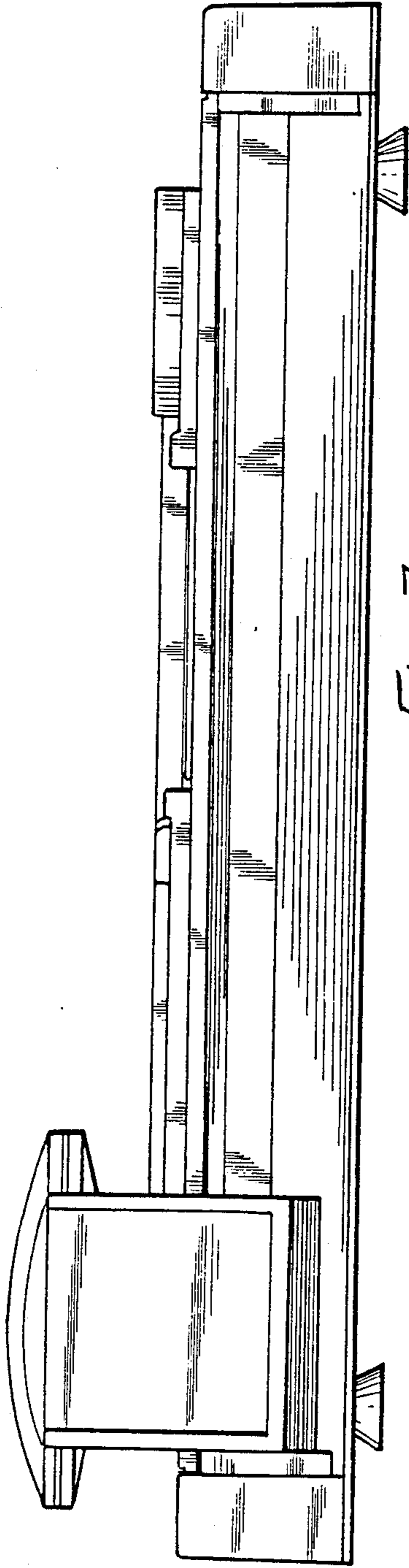

Fig. 7

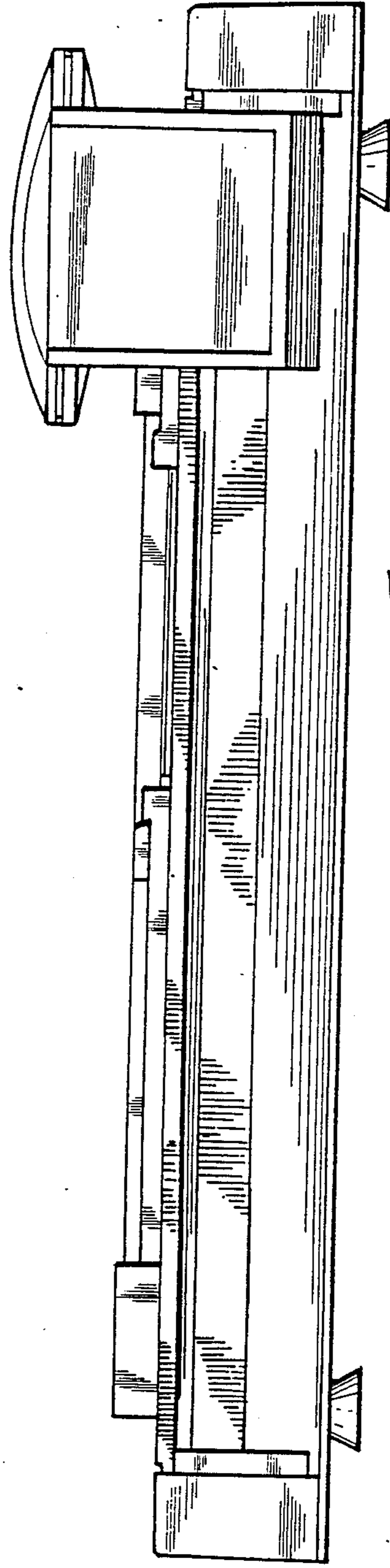

Fig. 6

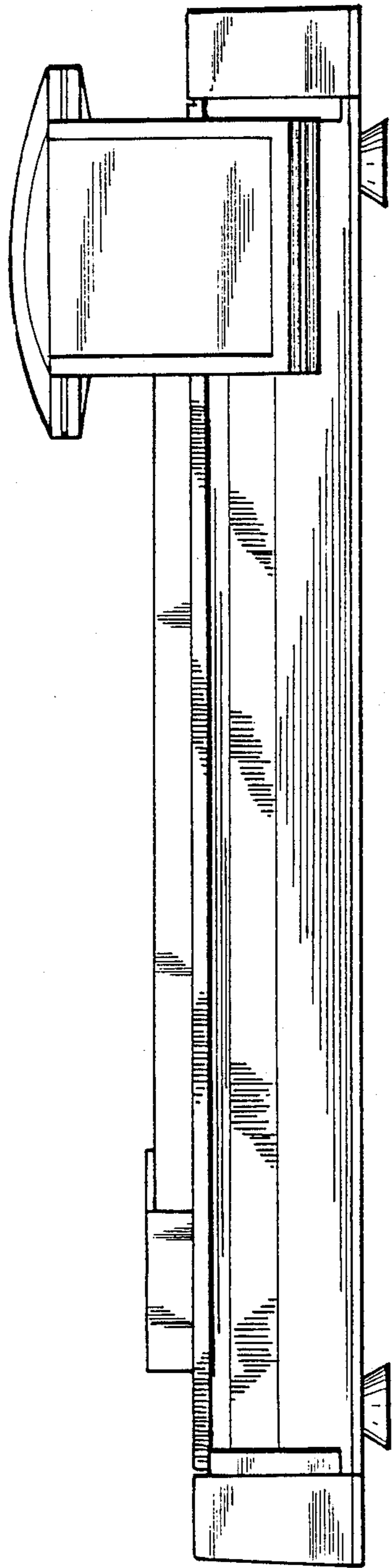

Fig. 9

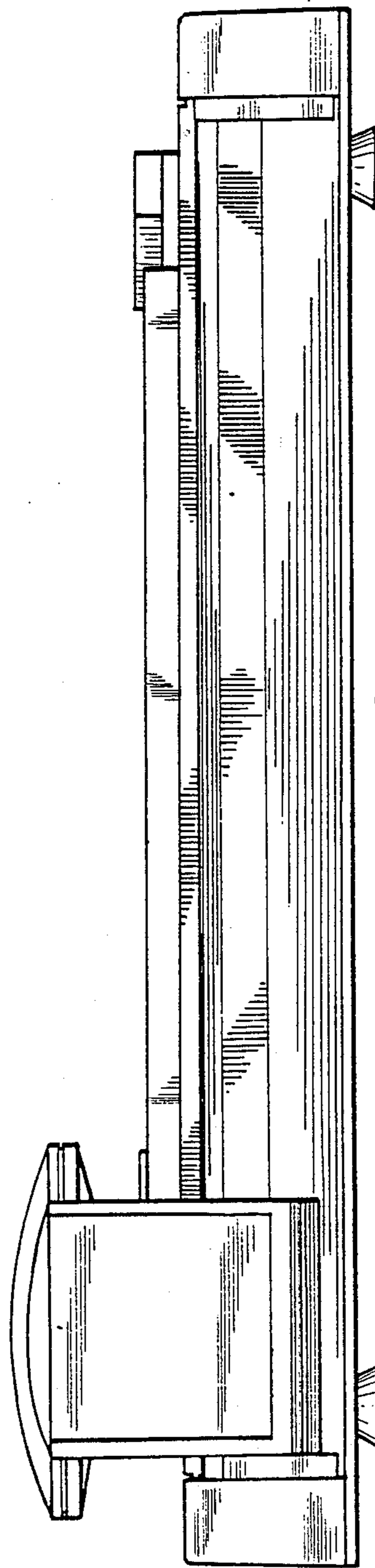
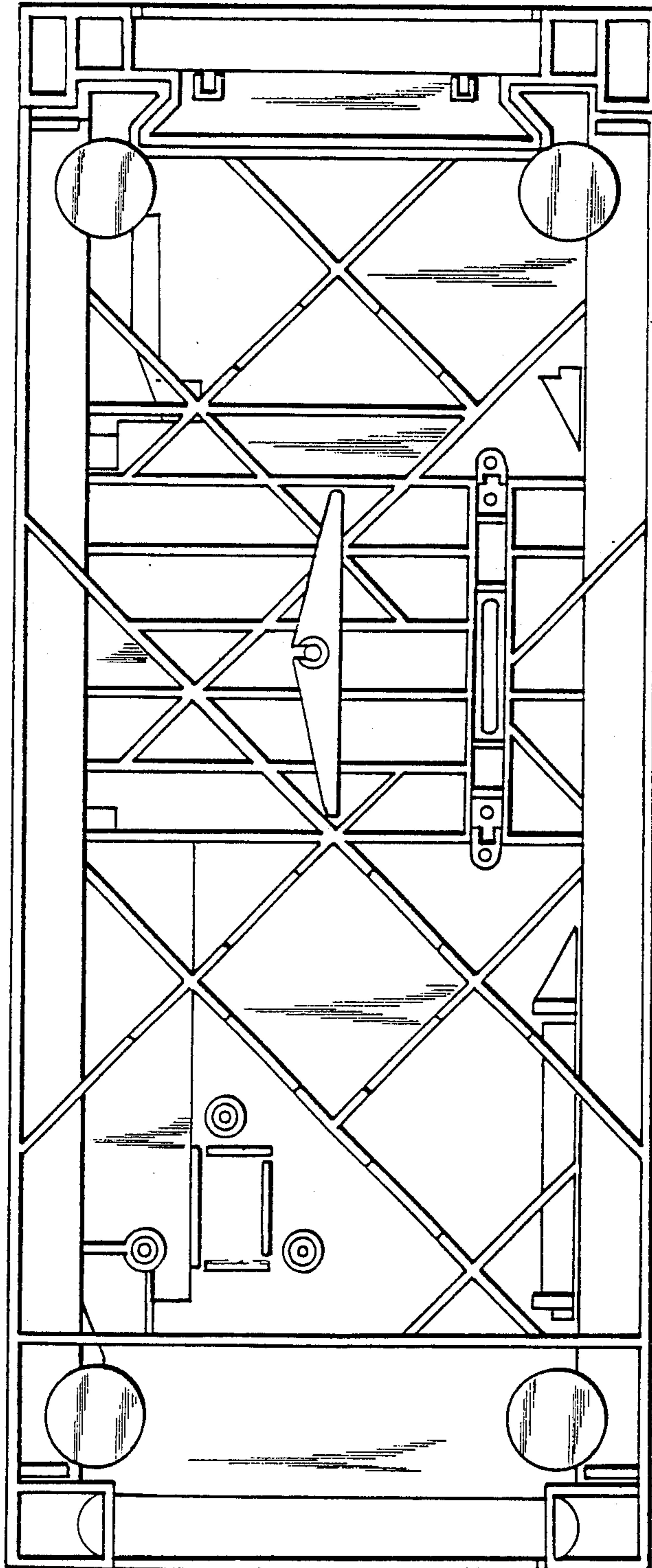

Fig. 8





*Fig. 10*