

[54] **SINGLE USER WORKSTATION**
[76] **Inventor: Margie A. Tingley, P.O. Box 700, San Antonio, Fla. 34266**
[**] **Term: 14 Years**
[21] **Appl. No.: 856,120**
[22] **Filed: Apr. 21, 1986**
[52] **U.S. Cl. D6/421; D6/423; D6/426**
[58] **Field of Search D6/421, 422, 423, 425, D6/426-428; 312/194-196; 108/60, 92, 93**

2,637,616 5/1953 MacDonald 108/60
3,572,787 3/1971 Timmerman 108/60
3,698,104 10/1972 Sutton 108/60 X

Primary Examiner—Carmen H. Vales-Lado
Attorney, Agent, or Firm—Pettis & McDonald

[57] **CLAIM**

The ornamental design for a single user workstation, as shown.

DESCRIPTION

FIG. 1 is a front elevational view of the single user workstation showing my new design.
FIG. 2 is a top plan view thereof.
FIG. 3 is a bottom plan view thereof.
FIG. 4 is a rear elevational view thereof.
FIG. 5 is a right side elevational view thereof.
FIG. 6 is a left side elevational view thereof.
FIG. 7 is a perspective view thereof.

[56] **References Cited**

U.S. PATENT DOCUMENTS

D. 183,995 11/1958 McCartan D6/423
D. 187,652 4/1960 McCartan D6/423
D. 197,652 3/1964 Courtwright D6/423 X
D. 207,004 2/1967 Carlson D6/423 X
D. 249,609 9/1978 Kramer D6/421

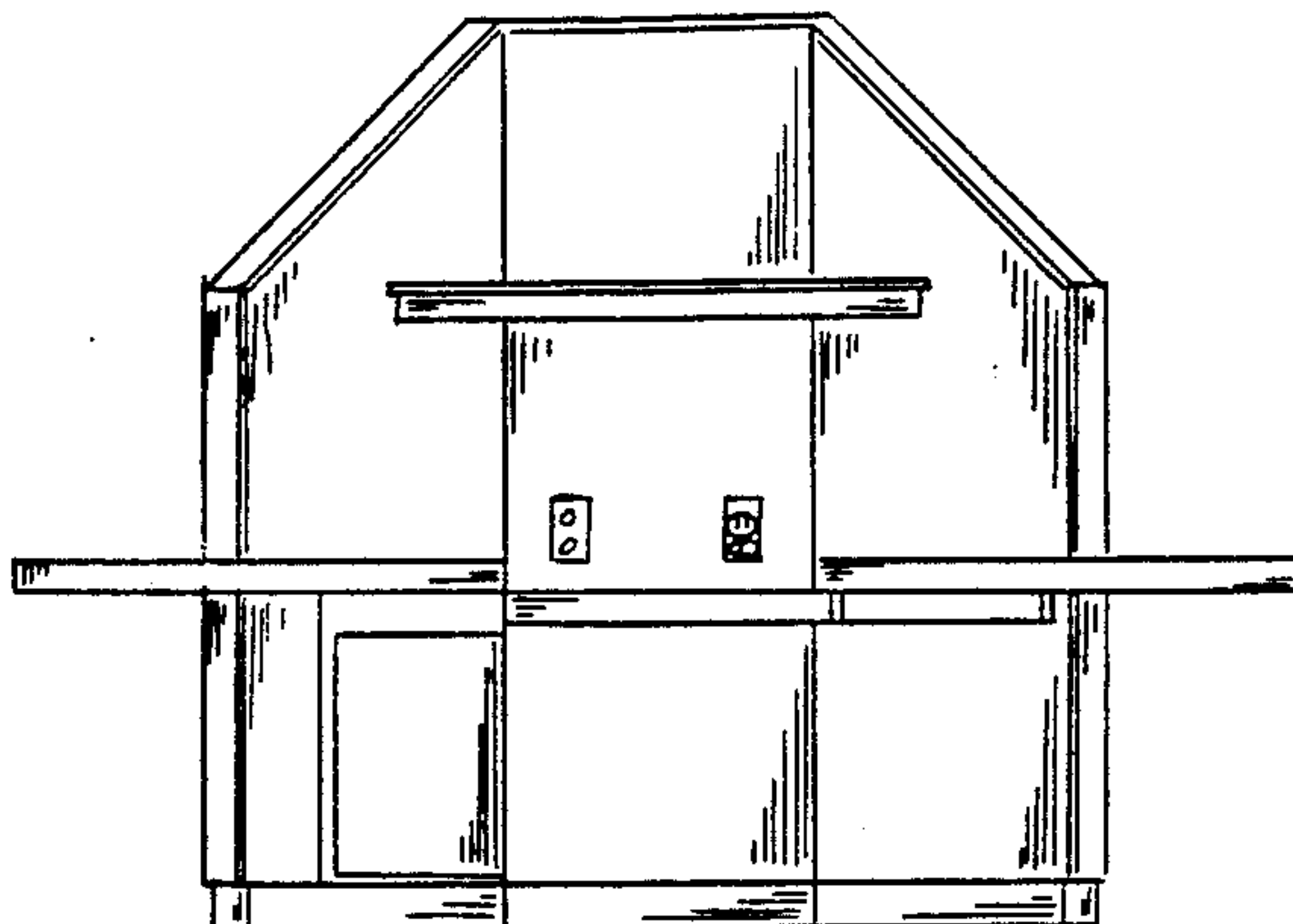
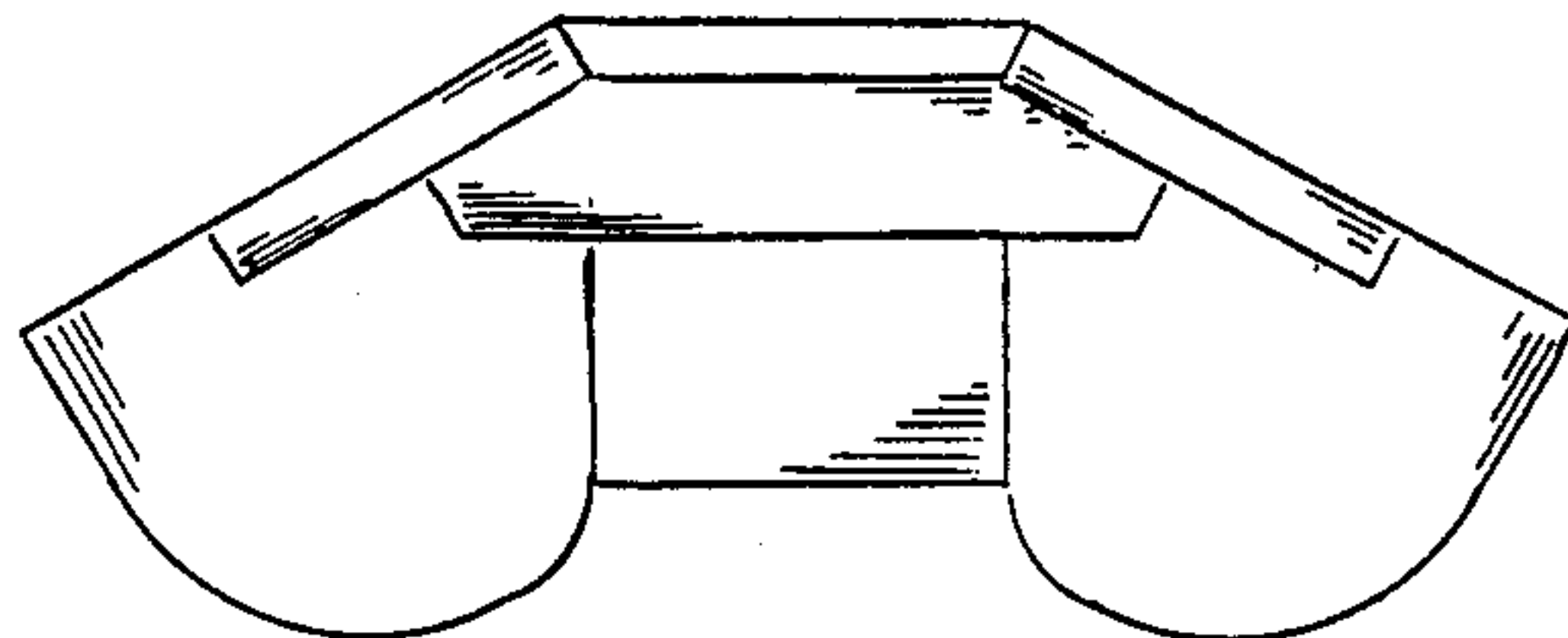

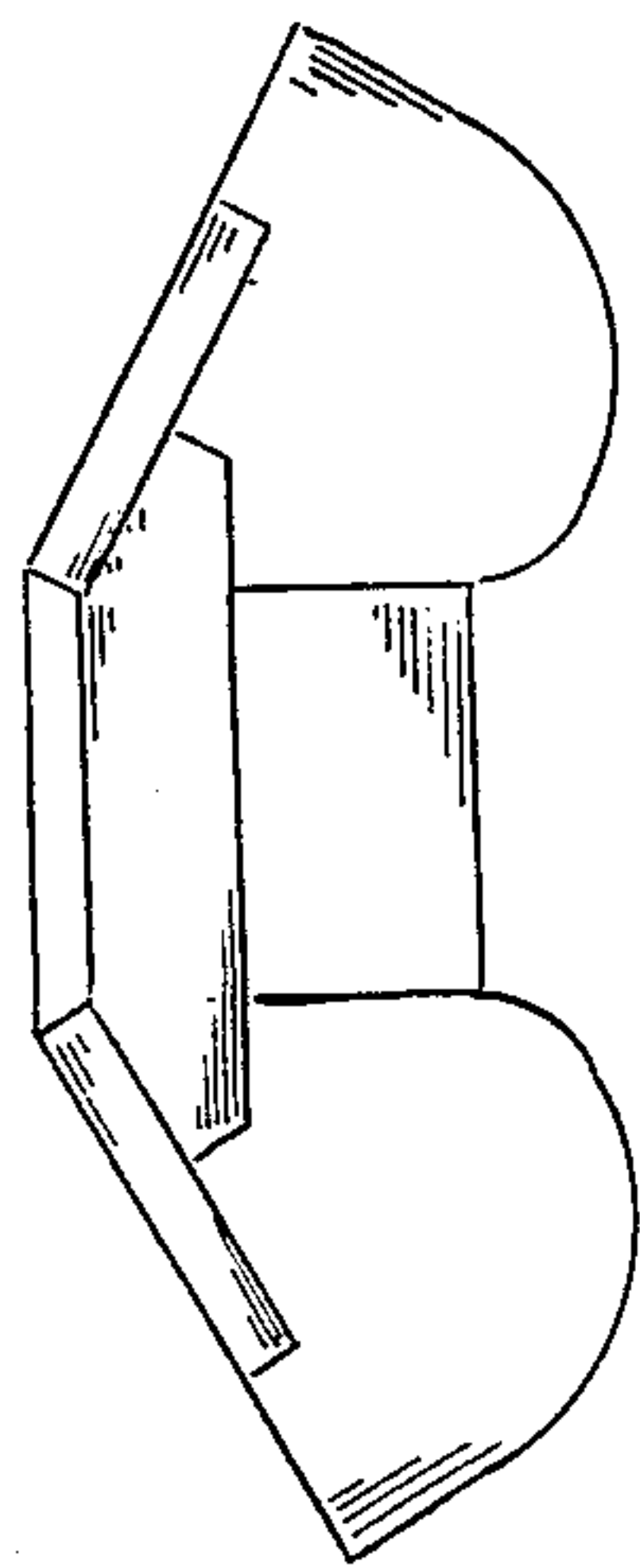

FIG. 2

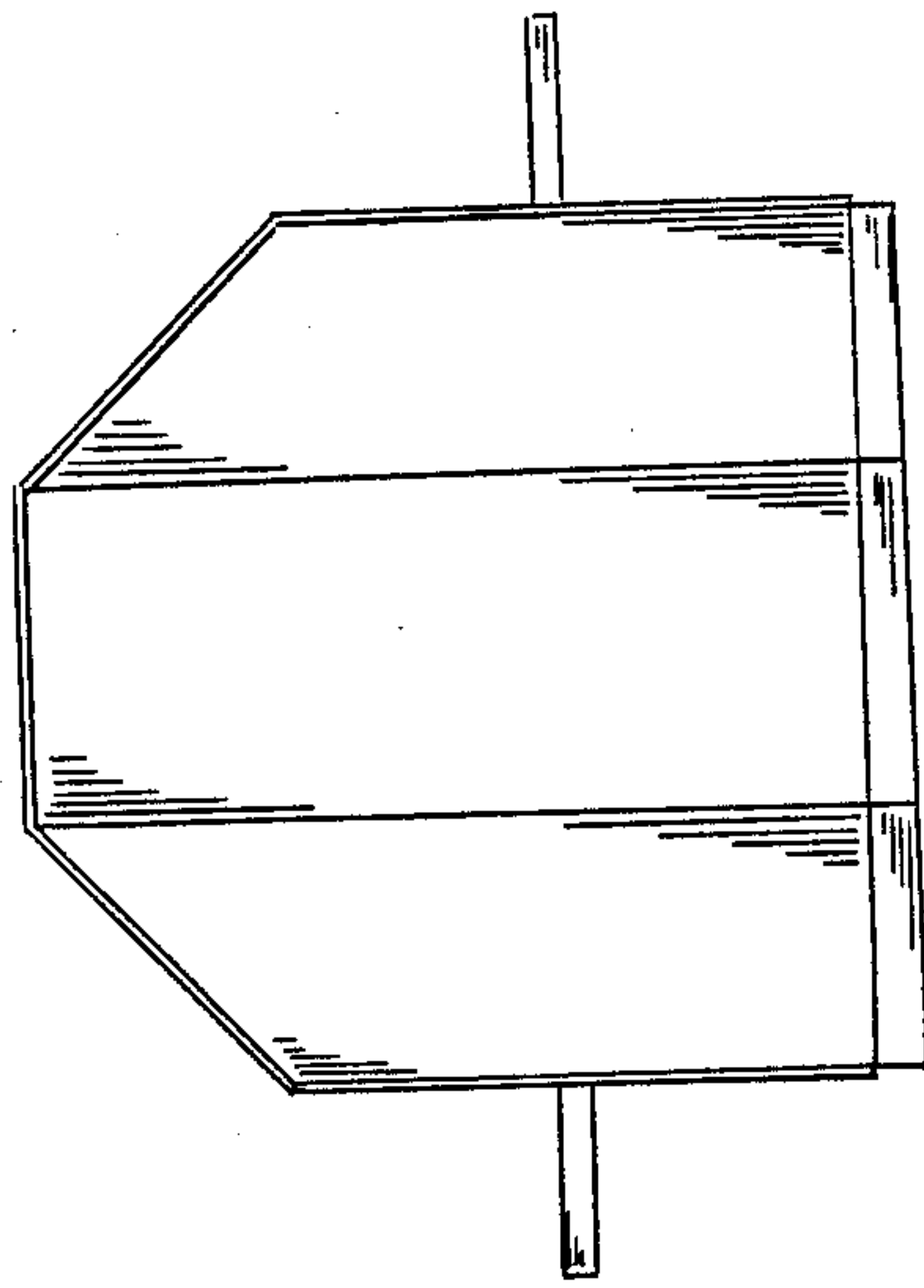

FIG. 4

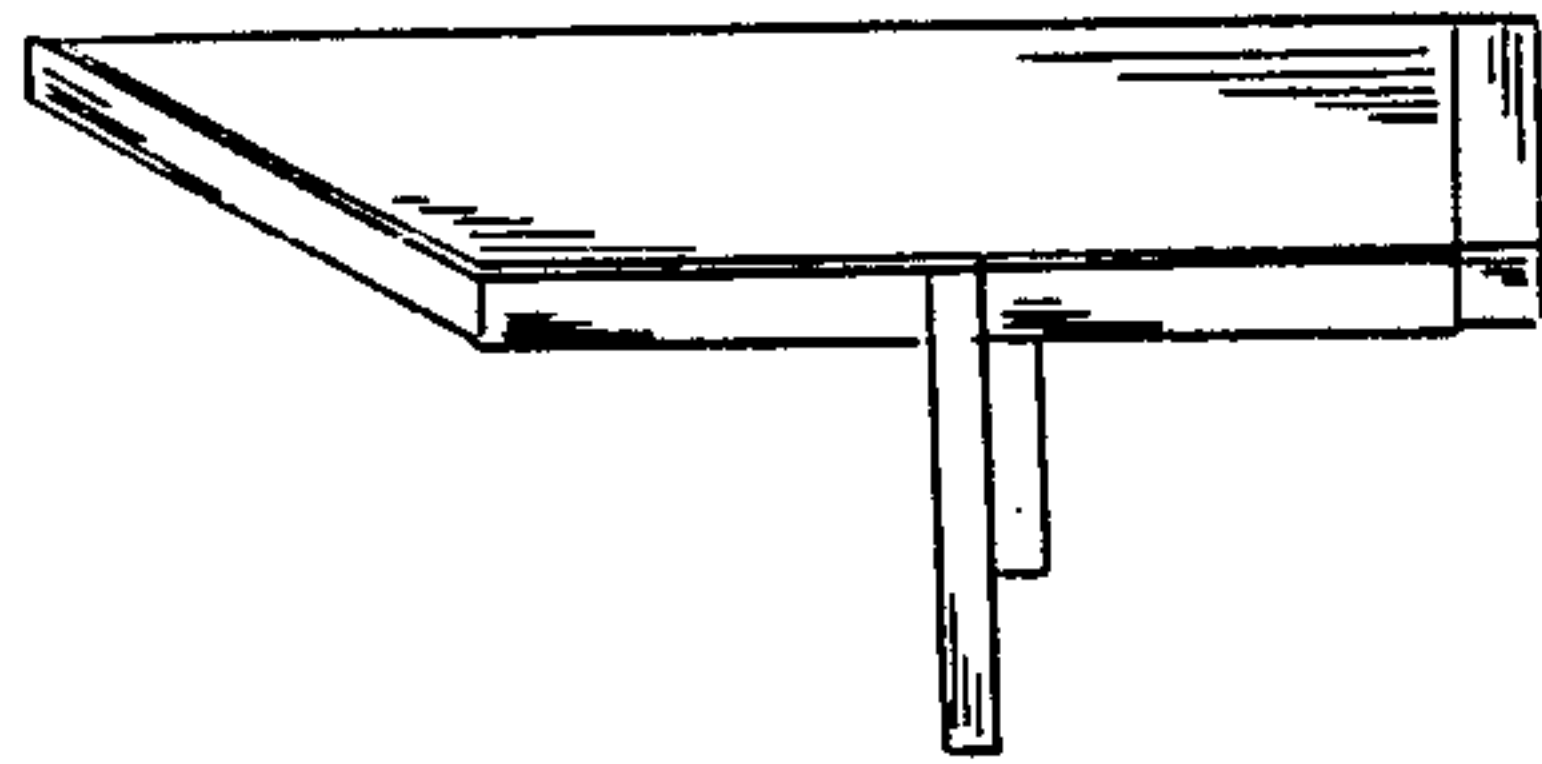

FIG. 5

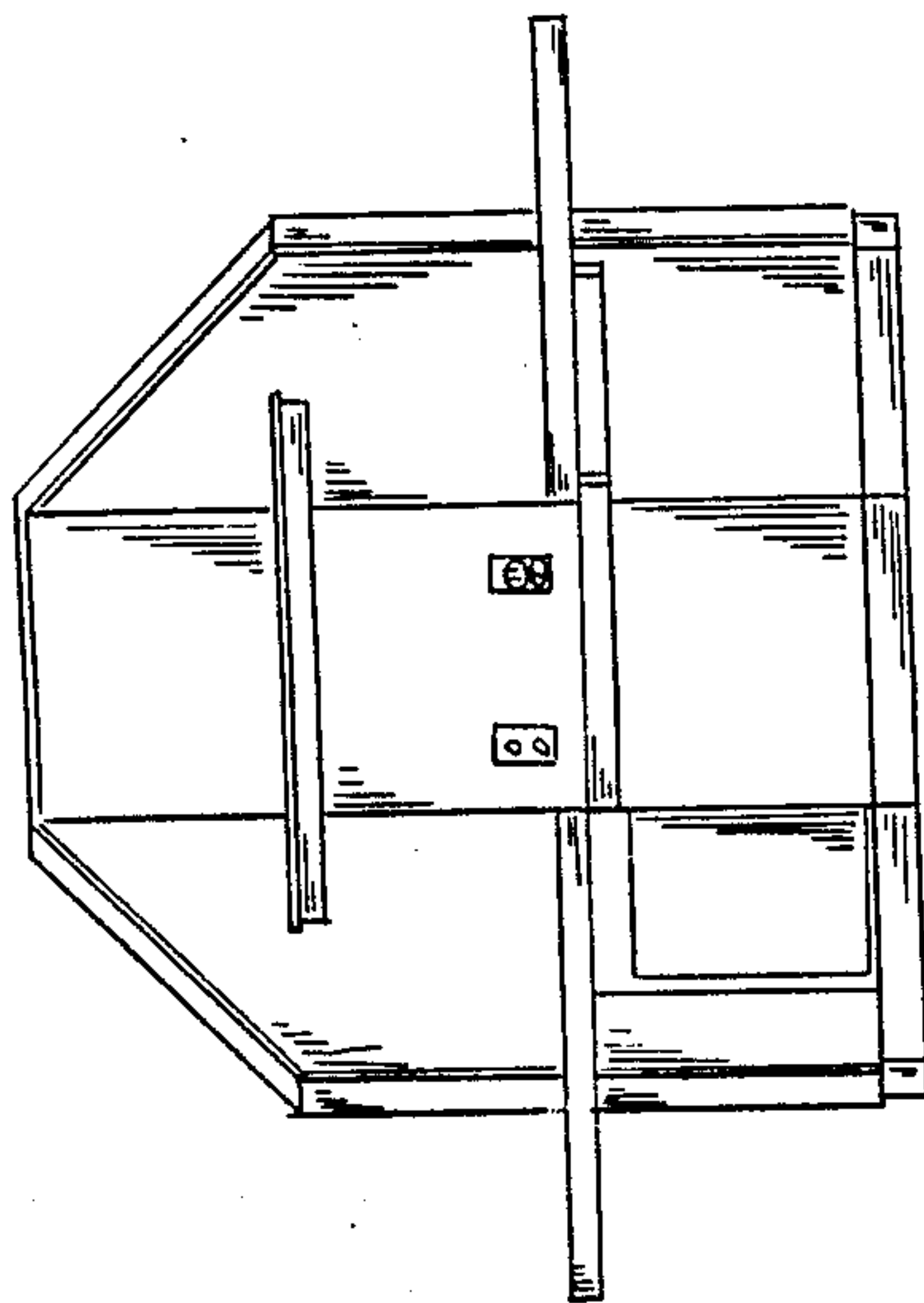

FIG. 1

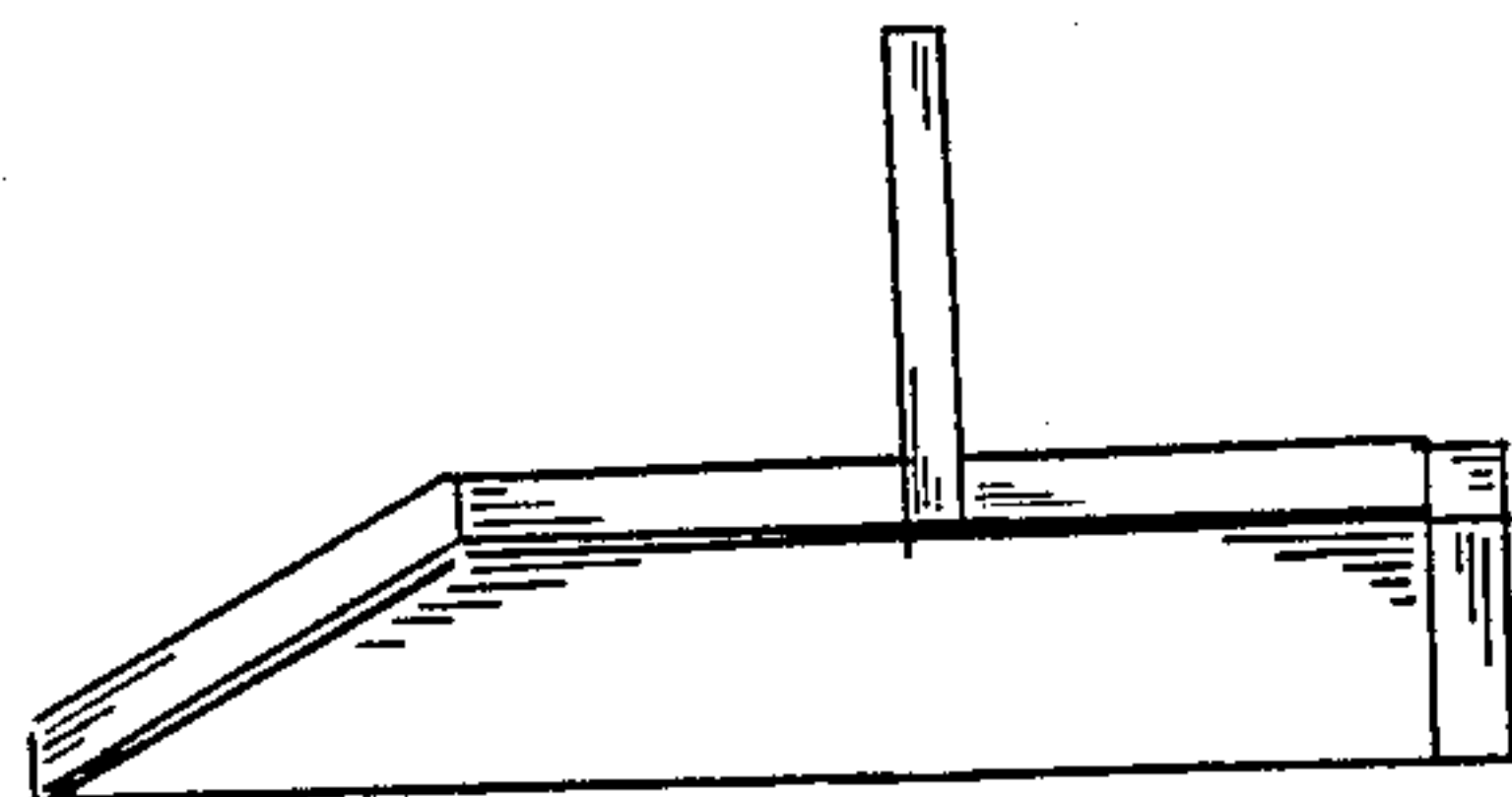

FIG. 6

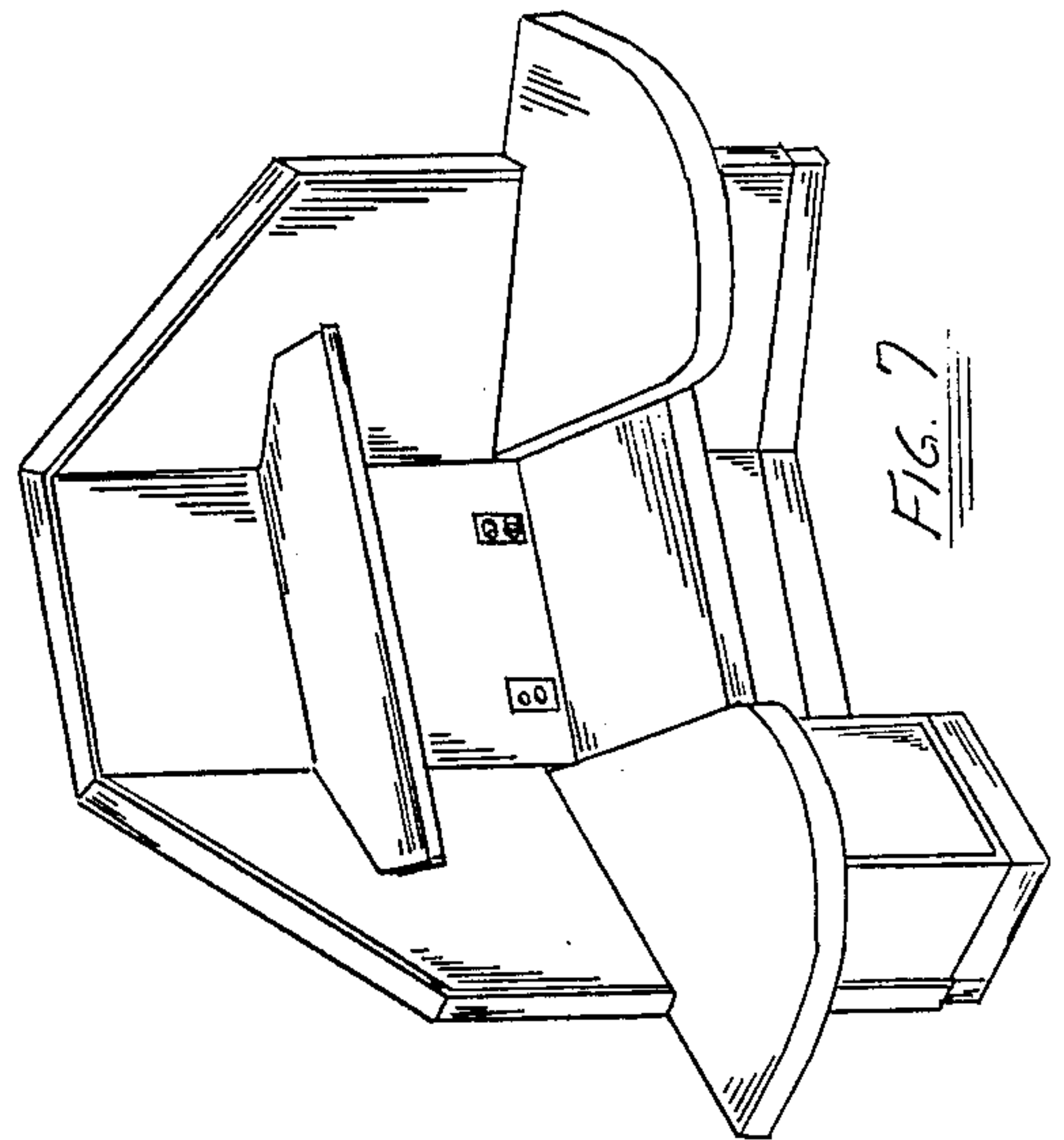

FIG. 7

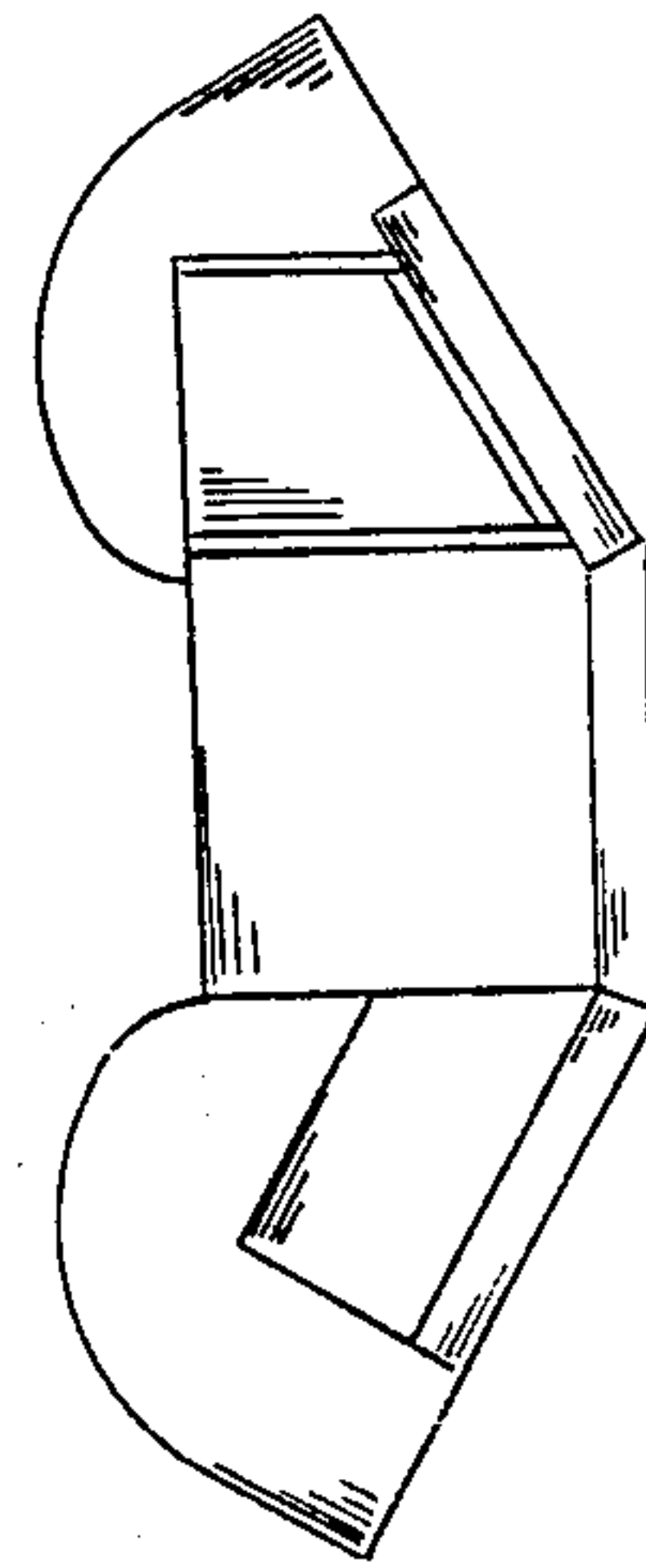

FIG. 3