

[54] RECONFIGURABLE TOY TRUCK

[75] Inventor: Takayuki Ishizawa, Souka, Japan

[73] Assignee: Takara Co., Ltd., Tokyo, Japan

[**] Term: 14 Years

[21] Appl. No.: 930,373

[22] Filed: Nov. 12, 1986

[30] Foreign Application Priority Data

Sep. 22, 1986 [JP] Japan 61-37444

[52] U.S. Cl. D21/150; D21/134/166

[58] Field of Search D21/59, 128, 132, 138, D21/150, 166; 446/71-78, 383, 381, 487

[56] References Cited

U.S. PATENT DOCUMENTS

D. 289,069	3/1987	Ohno	D21/132
D. 289,187	4/1976	Ohno	D21/150
D. 289,308	4/1987	Lerch	D21/134
D. 289,309	4/1987	Wickes	D21/134
D. 297,035	8/1988	Yoke	D21/134
3,605,331	9/1971	Linstead	D21/134

Primary Examiner—Charles A. Rademaker
Attorney, Agent, or Firm—Price, Gess & Ubell

[57] CLAIM

The ornamental design for a reconfigurable toy truck, as shown and described.

DESCRIPTION

FIG. 1 is a front perspective view of a reconfigurable toy truck showing my new design;
 FIG. 2 is a front elevational view thereof;
 FIG. 3 is a right side elevational view thereof;
 FIG. 4 is a left side elevational view thereof;
 FIG. 5 is a rear elevational view thereof;
 FIG. 6 is a top plan view thereof;
 FIG. 7 is a bottom plan view thereof;
 FIG. 8 is another front perspective view of the design shown in FIGS. 1 through 7 in a humanoid robot reconfiguration;
 FIG. 9 is a front elevational view thereof;
 FIG. 10 is a right side elevational view thereof;
 FIG. 11 is a left side elevational view thereof;
 FIG. 12 is a rear elevational view thereof;
 FIG. 13 is a top plan view thereof; and
 FIG. 14 is a bottom plan view thereof.

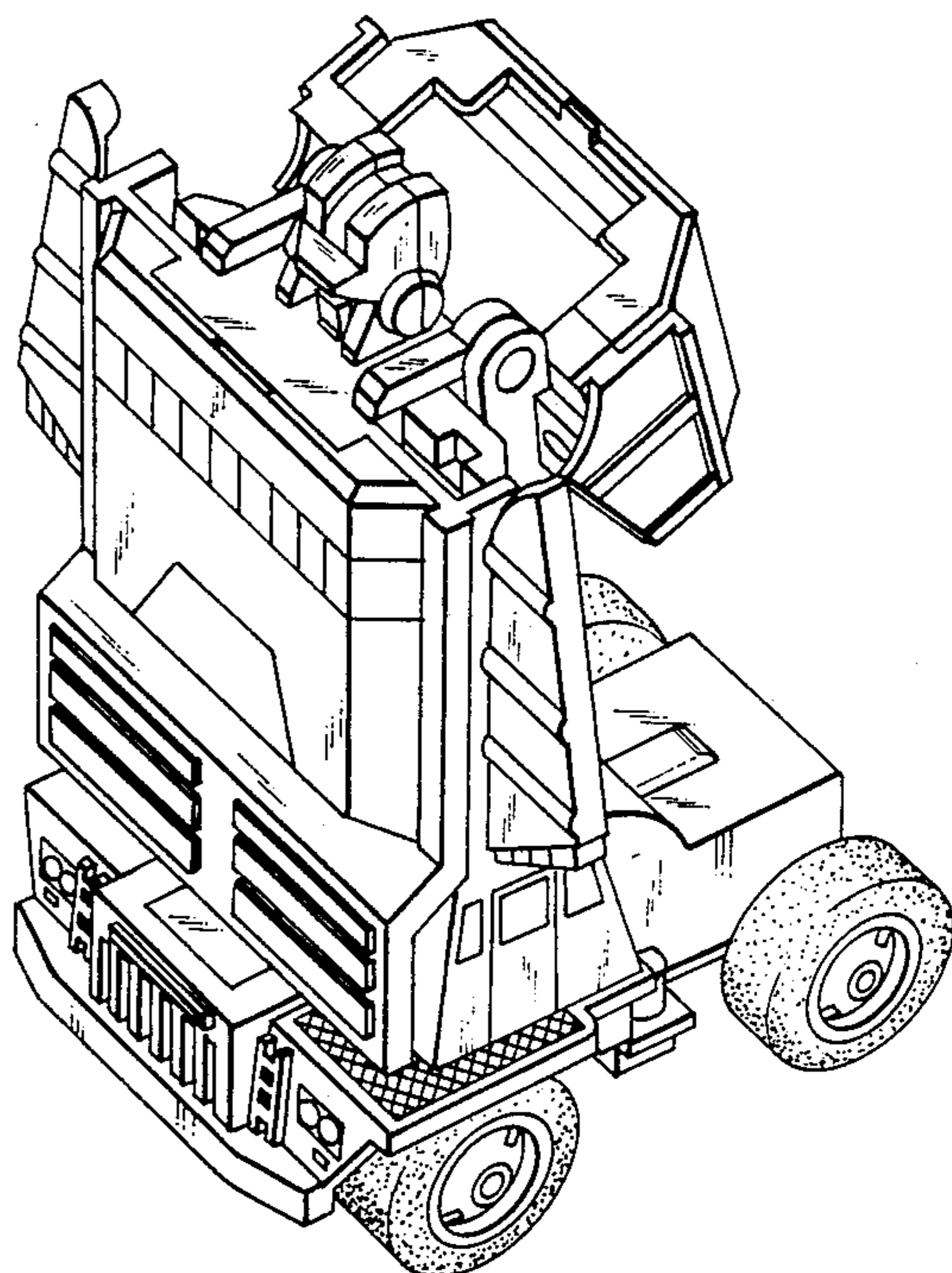
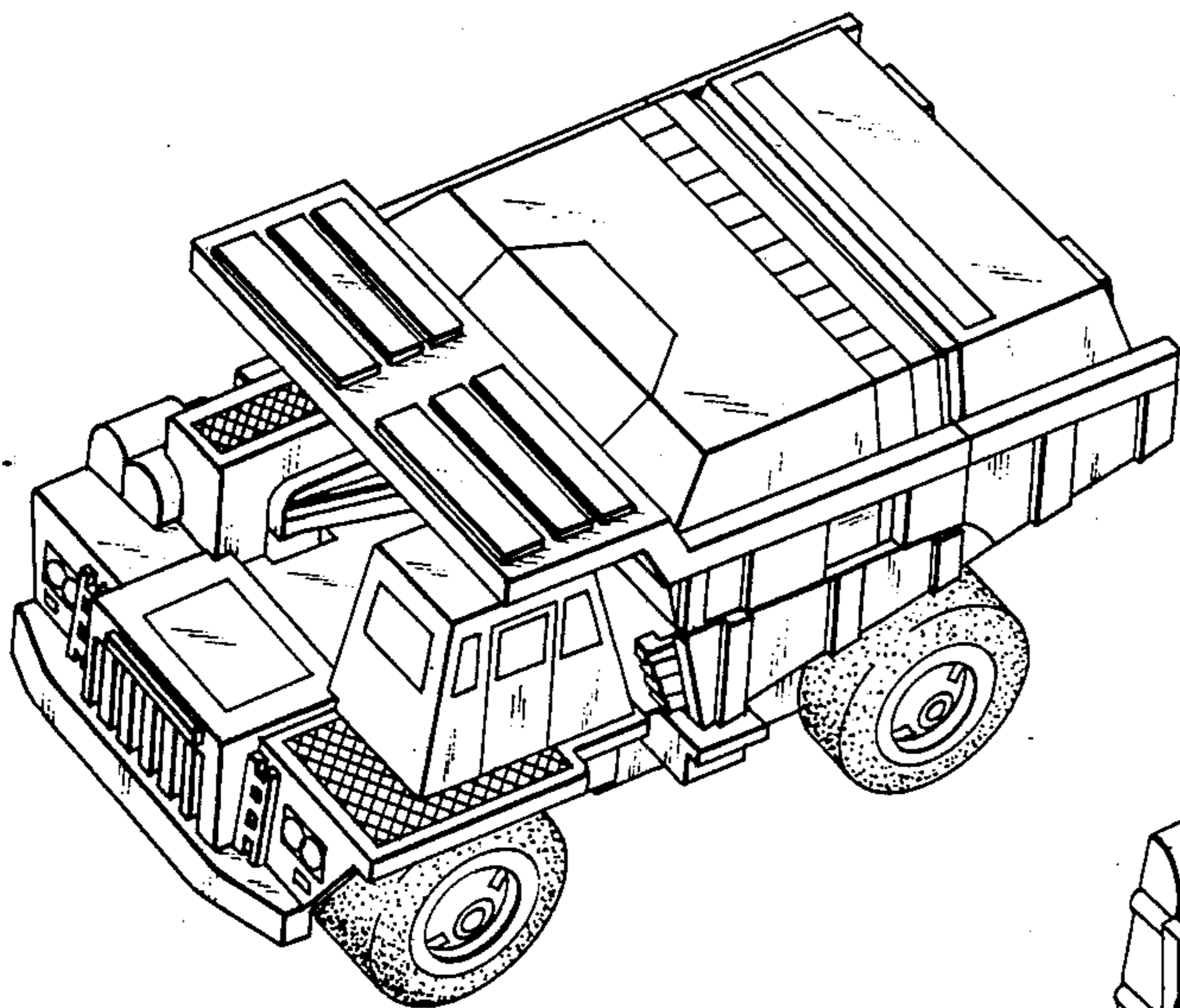

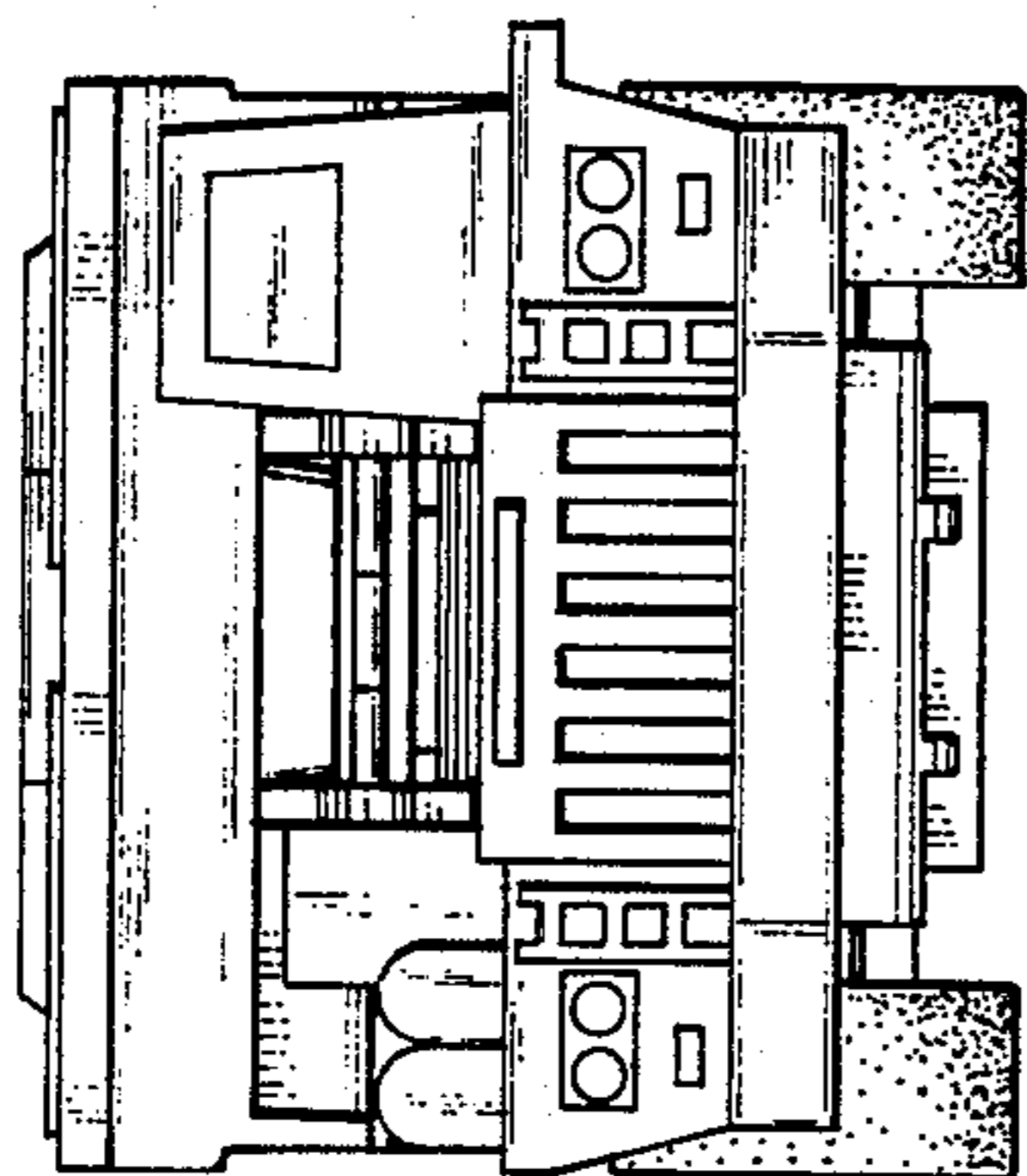

FIG. 2

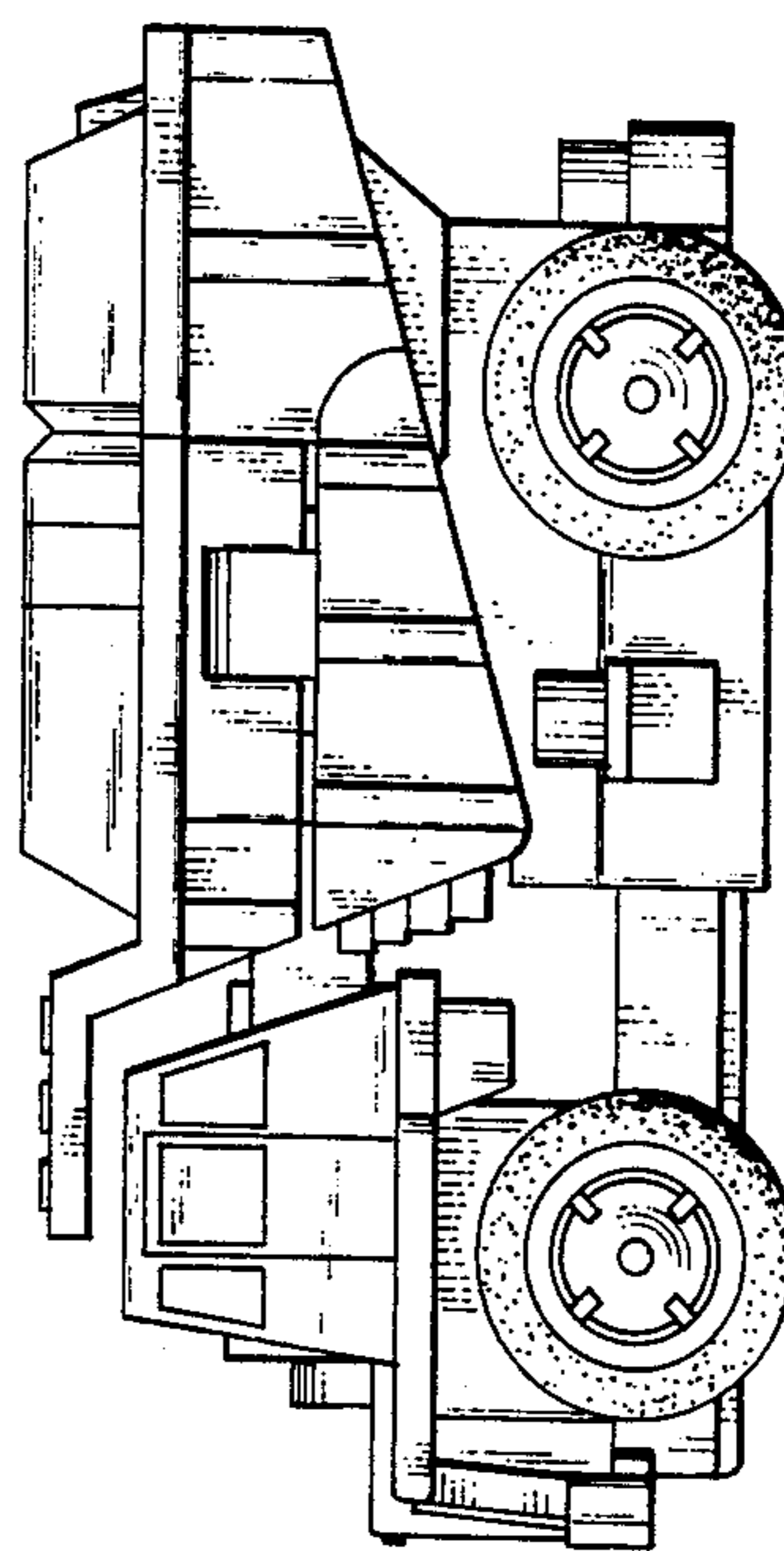

FIG. 3

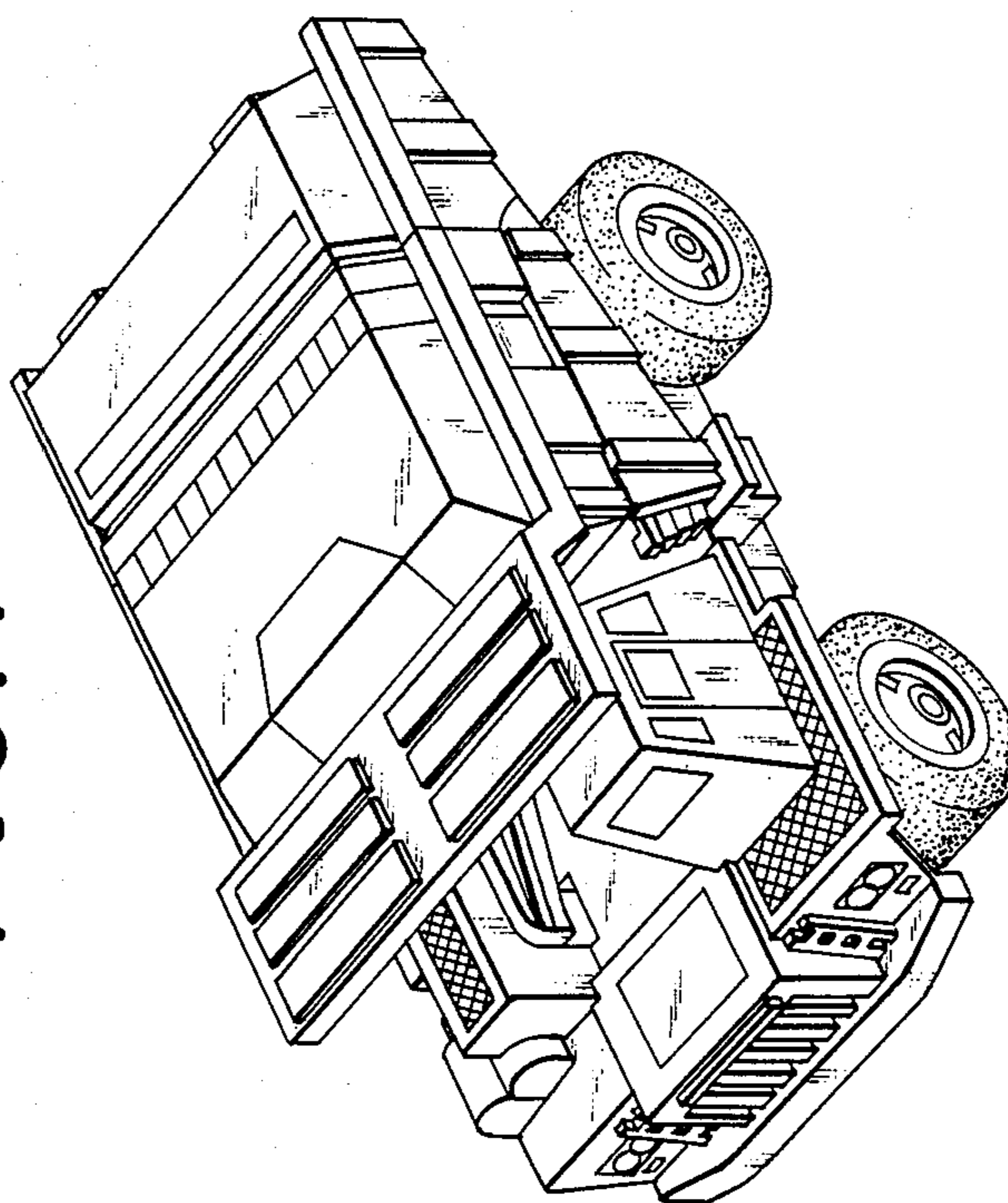

FIG. 1

FIG. 4

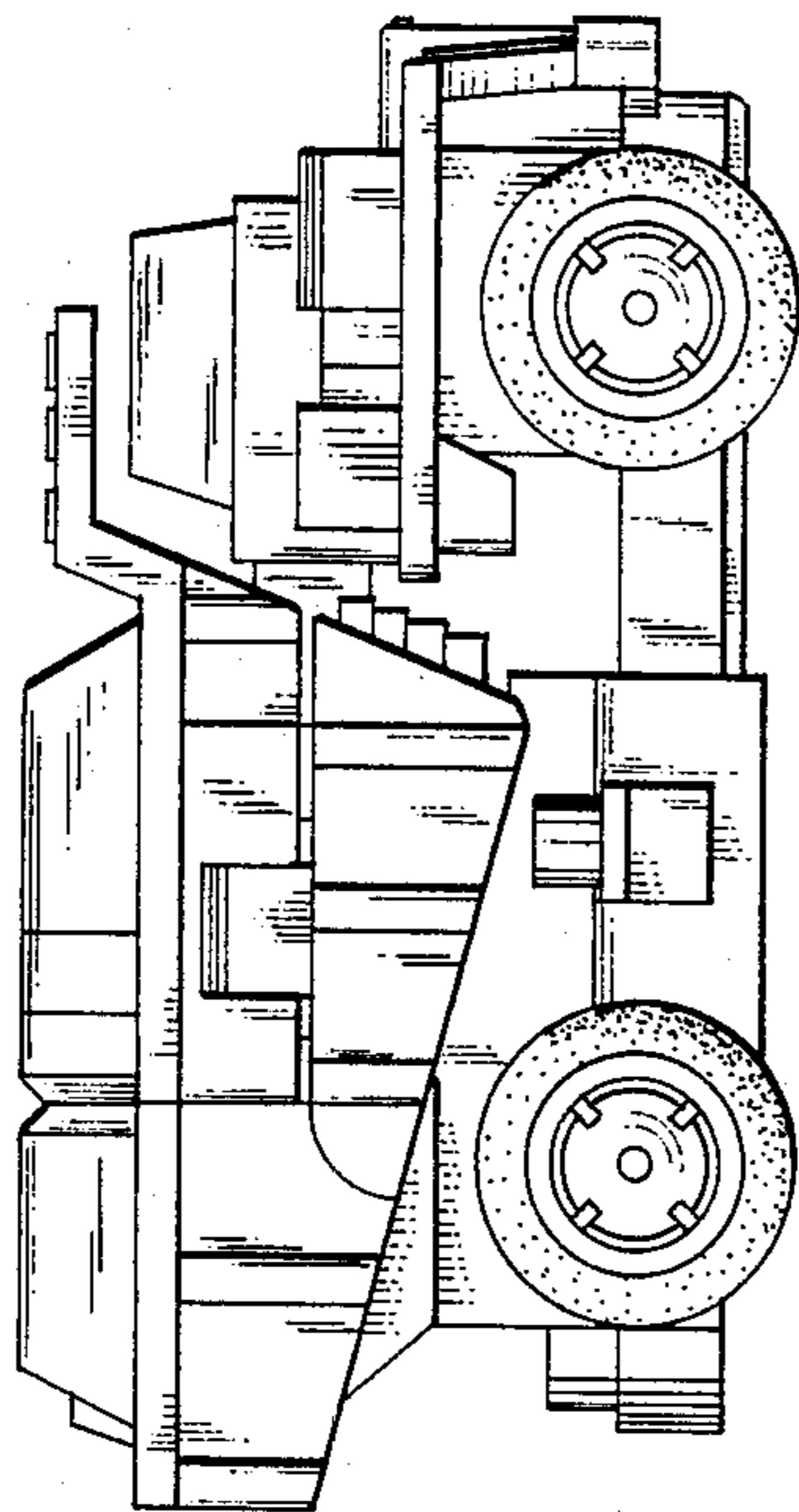

FIG. 6

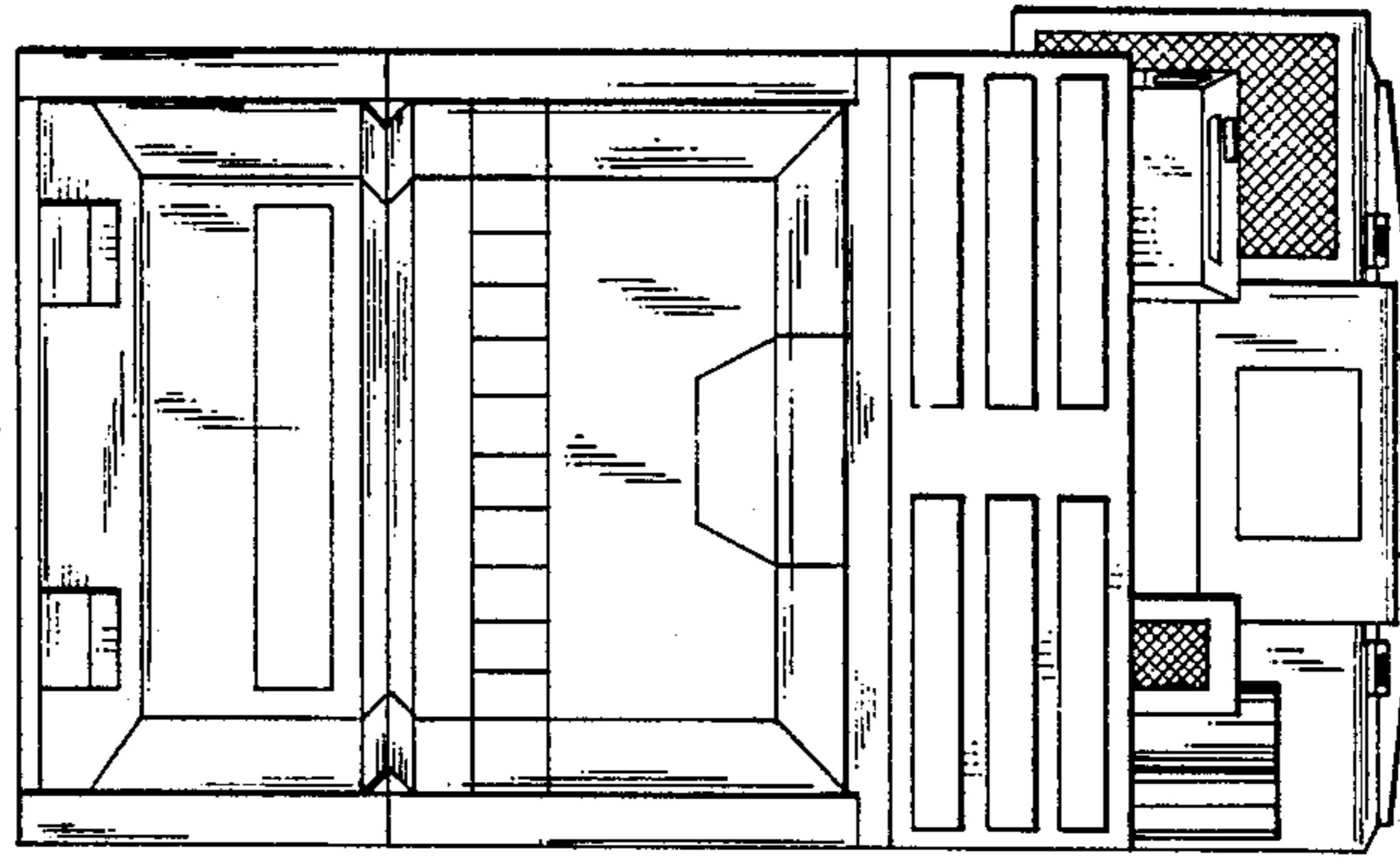

FIG. 7

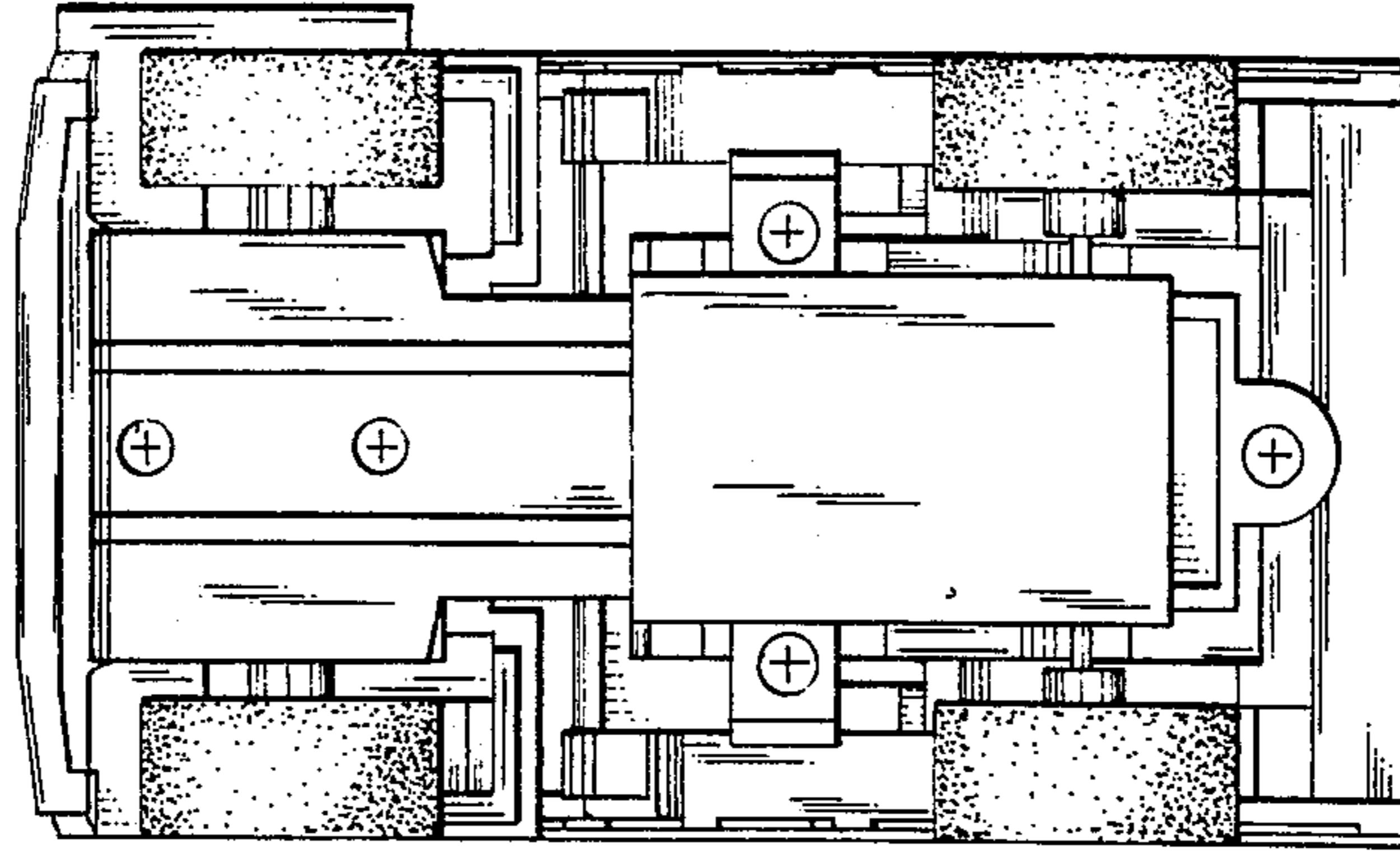

FIG. 5

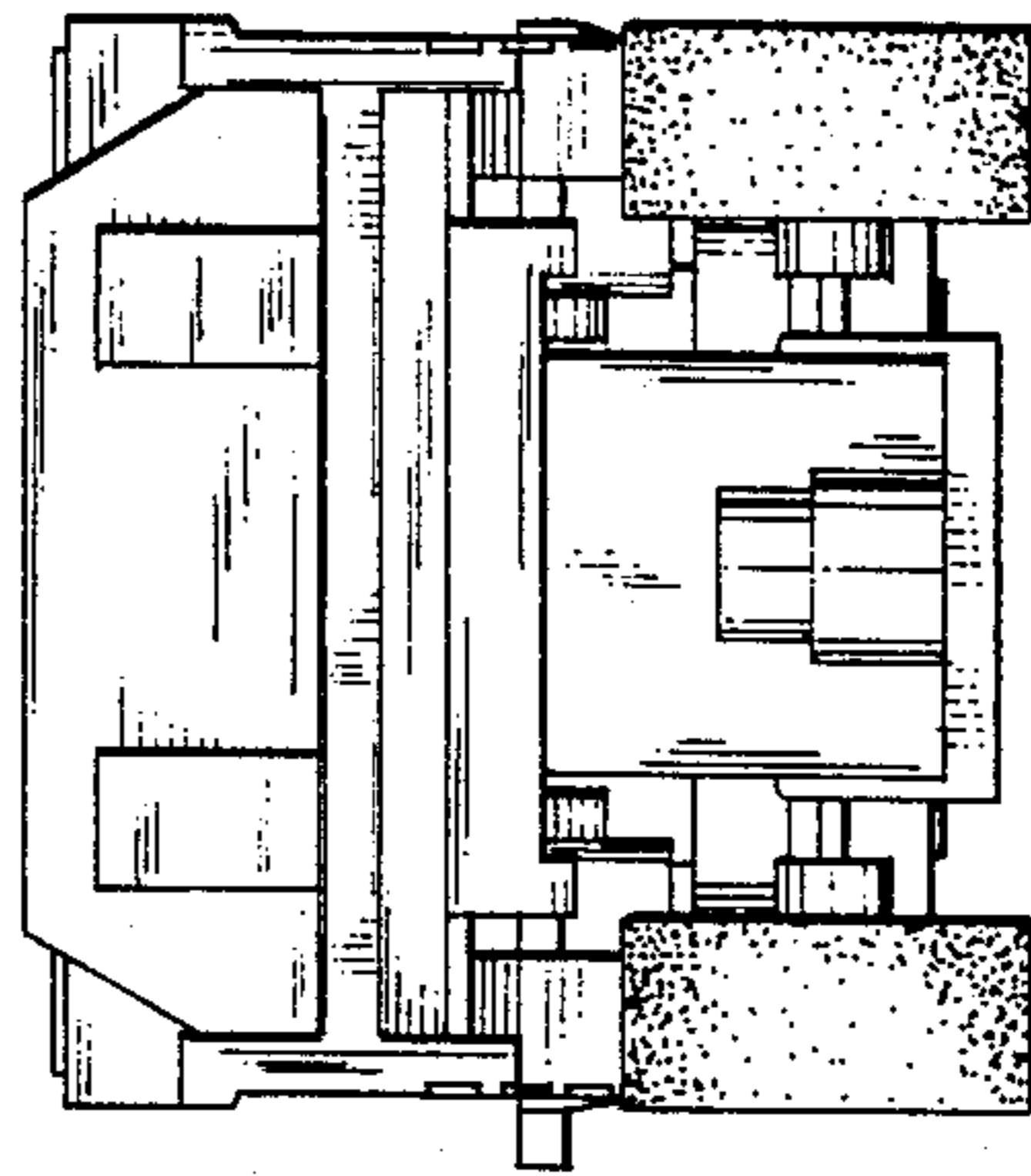

FIG. 9

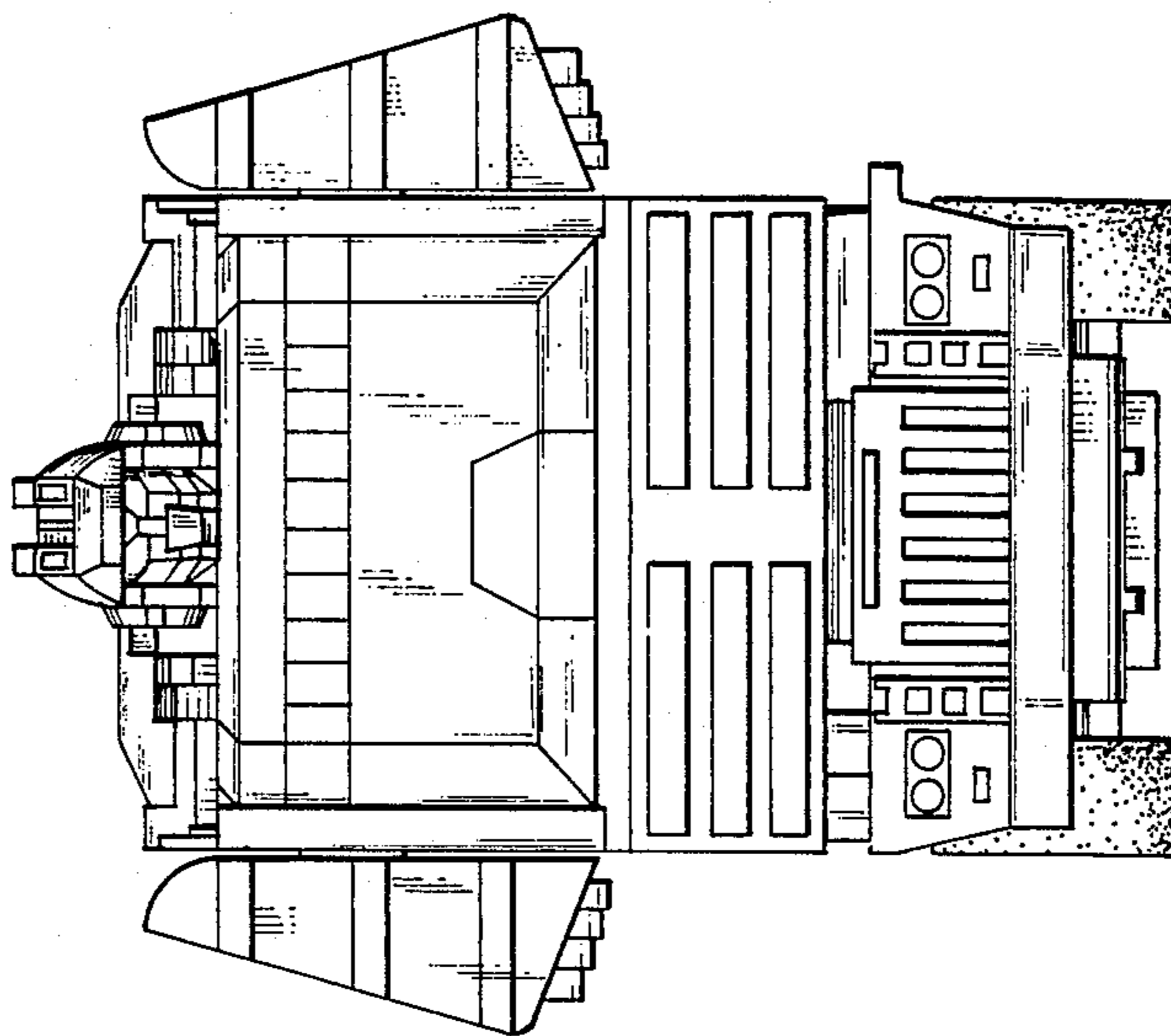

FIG. 8

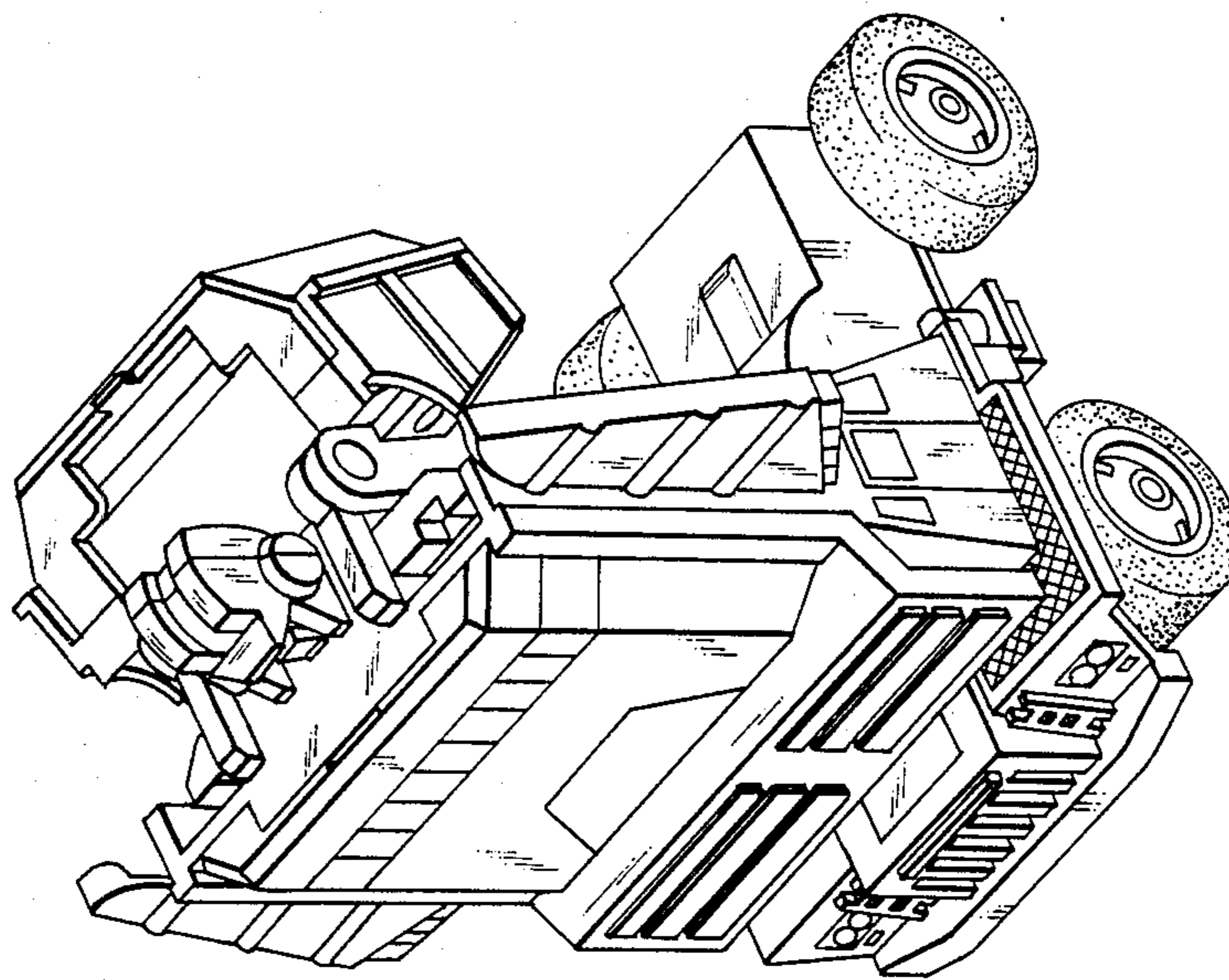

FIG.11

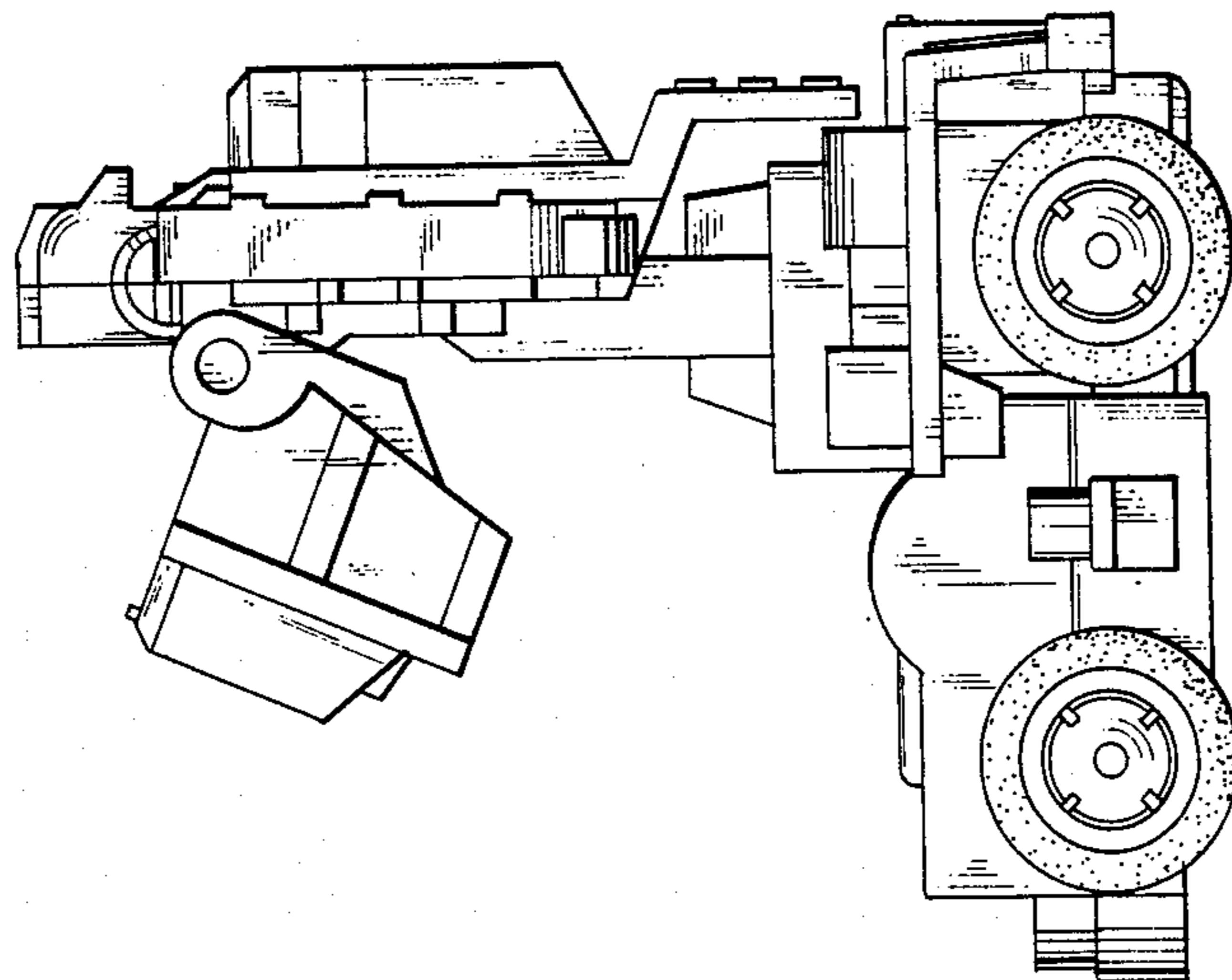
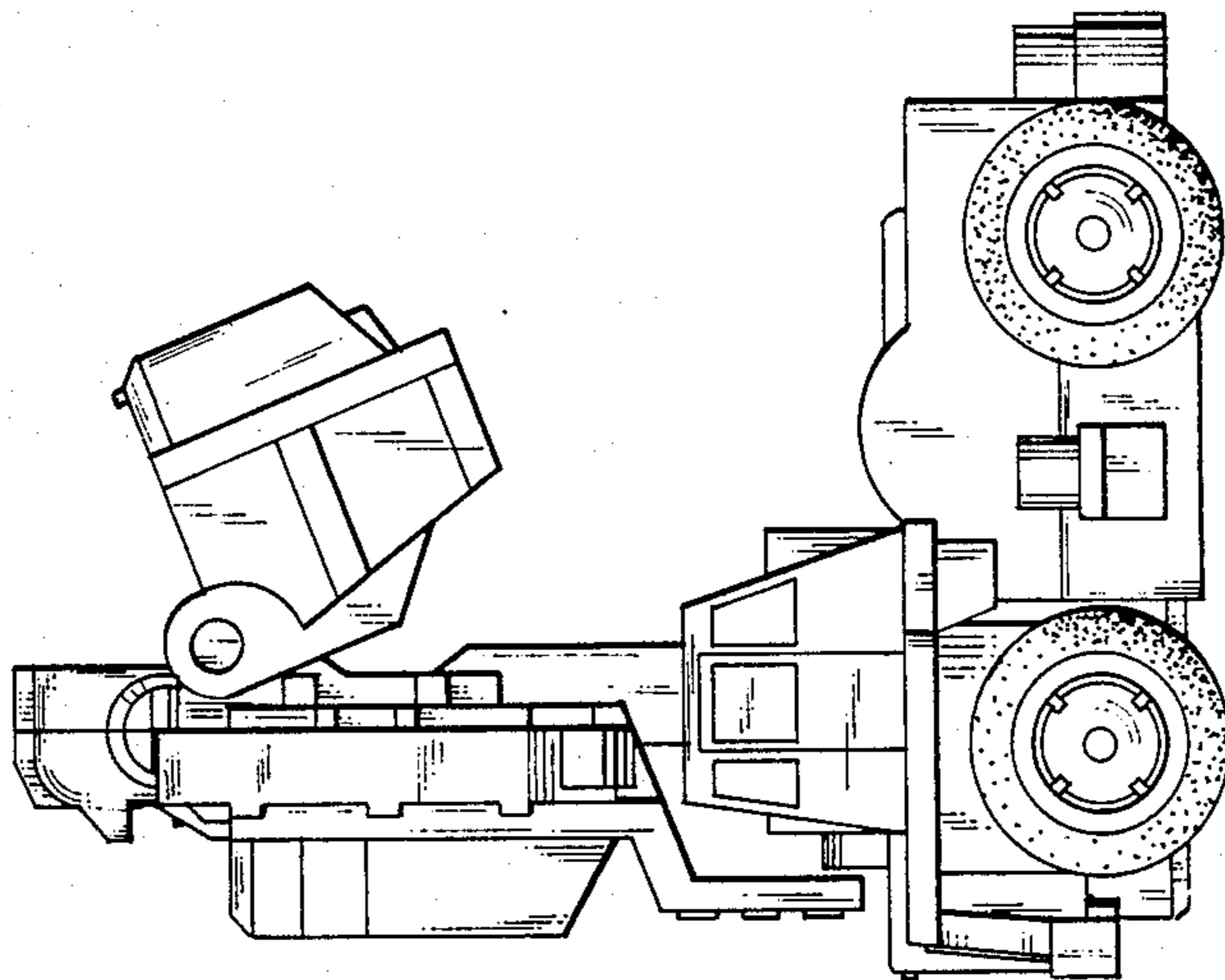

FIG.10



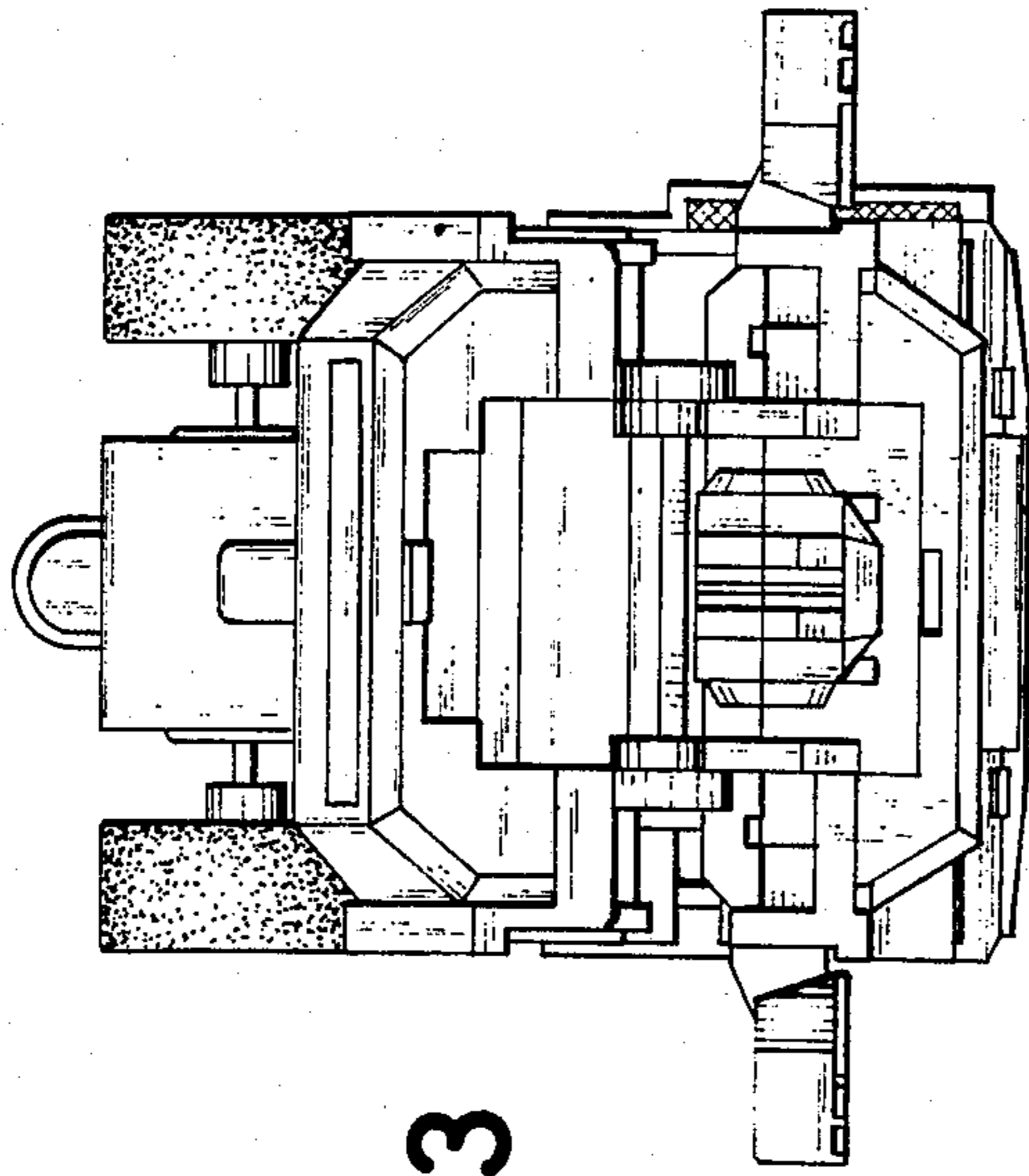

FIG. 13

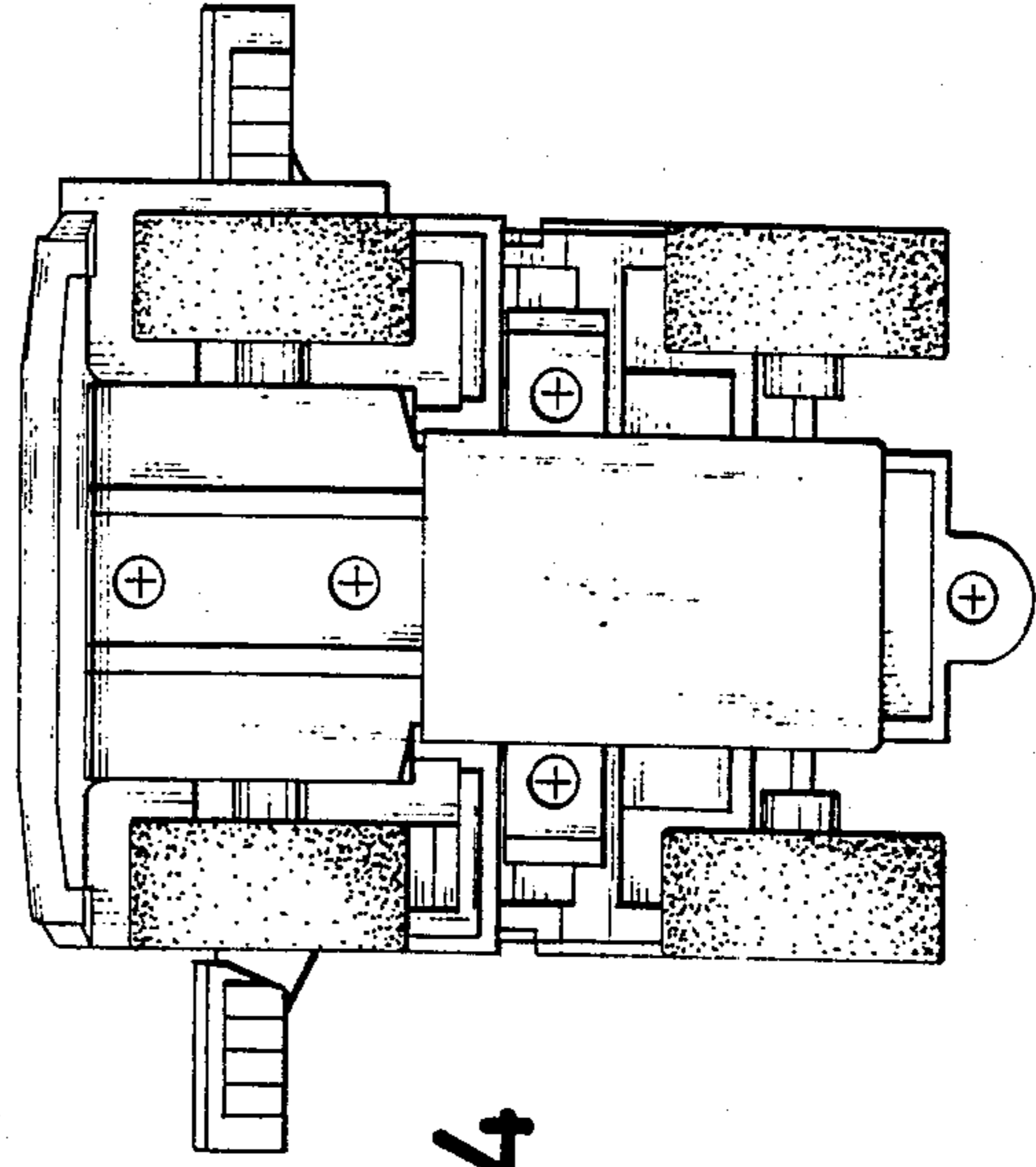

FIG. 14

FIG. 12

