

United States Patent [19]

Kame et al.

[11] Patent Number: **Des. 298,854**

[45] Date of Patent: **** Dec. 6, 1988**

[54] **AUTOMATIC ENZYME IMMUNOLOGICAL ANALYZER**

4,078,895 3/1978 Moran 422/66
4,483,823 11/1984 Umetsu et al. 422/64 X

[75] Inventors: **Masaharu Kame, Sagamihara;
Kenichi Abe, Hachioji, both of Japan**

Primary Examiner—Wallace R. Burke
Assistant Examiner—Stella M. Reid
Attorney, Agent, or Firm—Ostrolenk, Faber, Gerb &
Soffen

[73] Assignee: **Olympus Optical Company, Inc.,
Japan**

[57] **CLAIM**

[**] Term: **14 Years**

The ornamental design for an automatic enzyme immunological analyzer, as shown and described.

[21] Appl. No.: **858,298**

DESCRIPTION

[22] Filed: **Apr. 30, 1986**

[52] U.S. Cl. **D24/1.1**

[58] Field of Search **D24/8, 1.1, 17;
422/63-68, 50; 356/39, 40, 41; 436/43, 48;
D10/81**

FIG. 1 is a front, top, and right side perspective view of an automatic enzyme immunological analyzer, showing our new design;

FIG. 2 is a rear, bottom, and left side perspective view thereof;

FIG. 3 is a front elevational view thereof;

FIG. 4 is a rear elevational view thereof;

FIG. 5 is a right side elevational view thereof;

FIG. 6 is a left side elevational view thereof;

FIG. 7 is a top plan view thereof; and

FIG. 8 is a bottom plan view thereof.

[56] **References Cited**

U.S. PATENT DOCUMENTS

D. 264,873 6/1982 Olson et al. D24/1.1
D. 281,310 11/1985 Hattori et al. D24/1.1 X
D. 282,203 1/1986 Leonard et al. D24/1.1

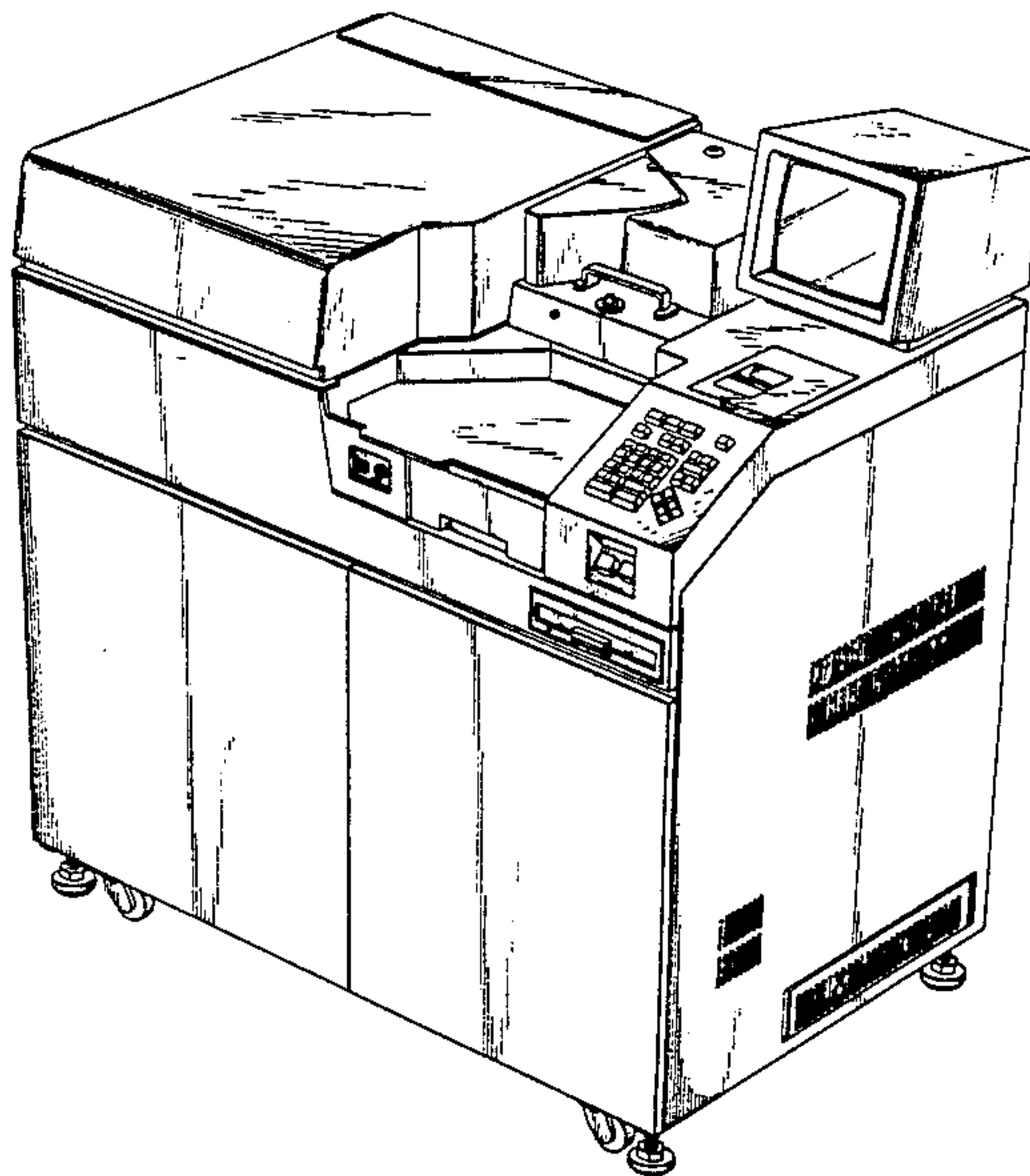

FIG. 1

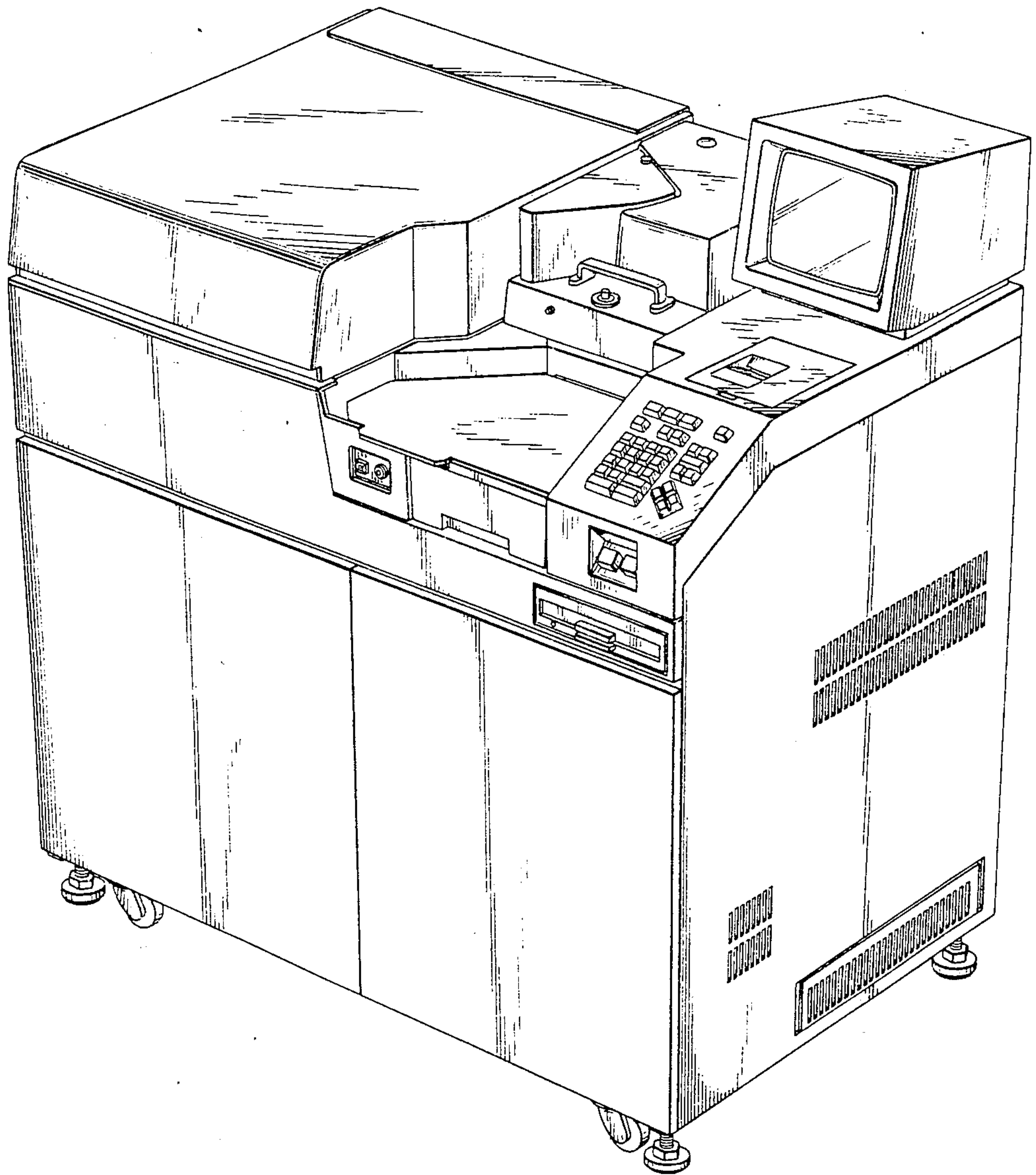

FIG. 2

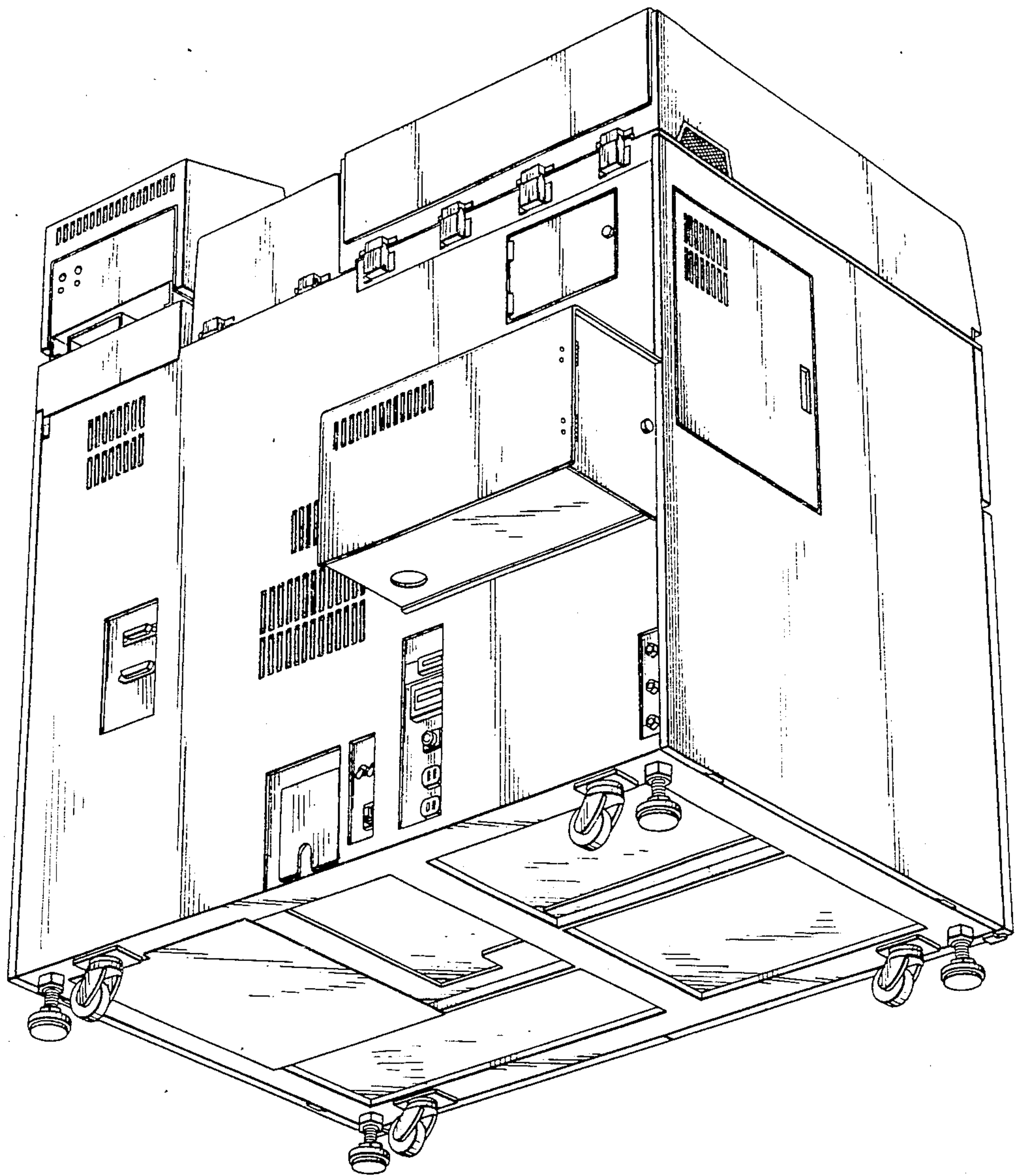

FIG. 3

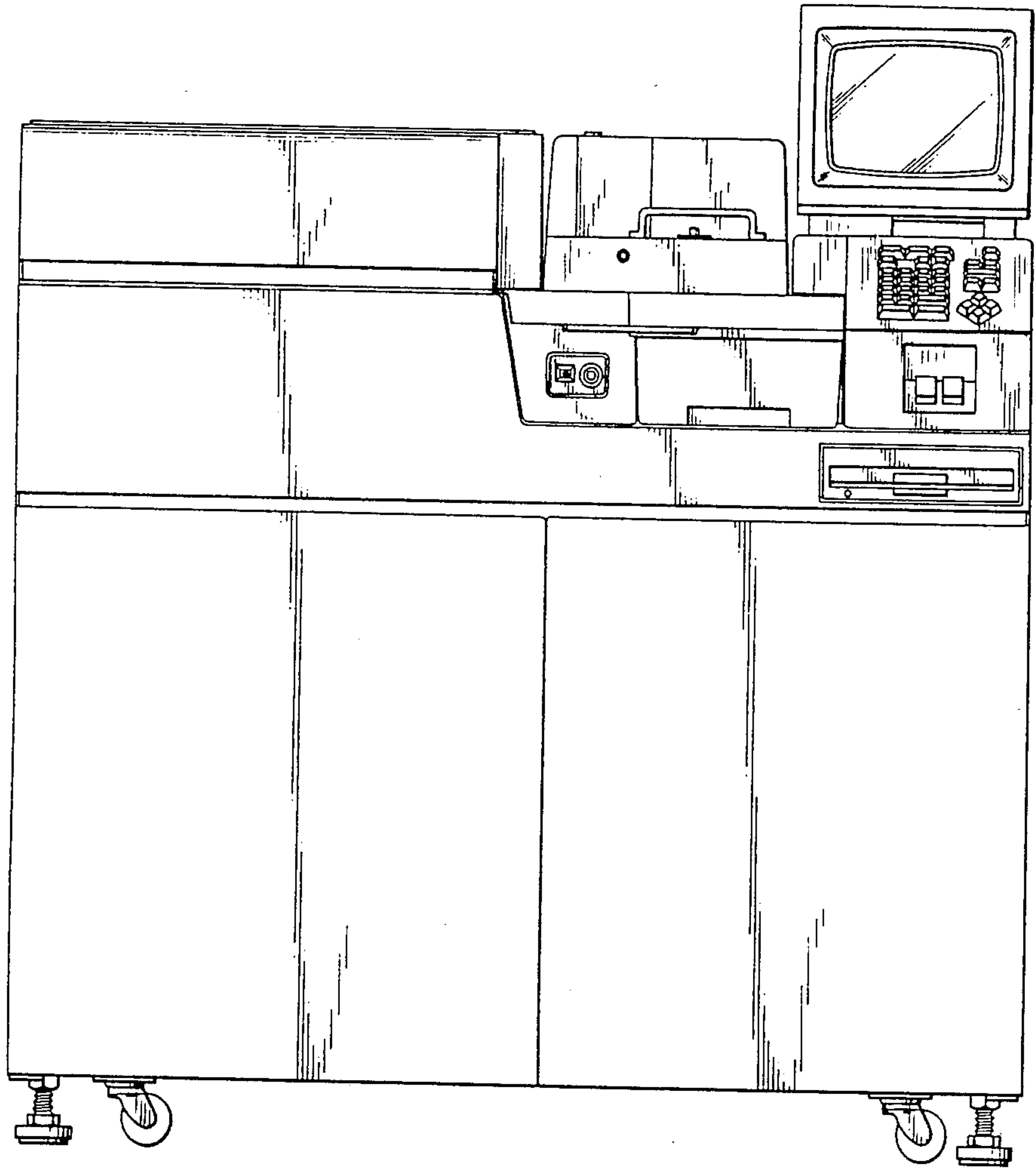

FIG. 4

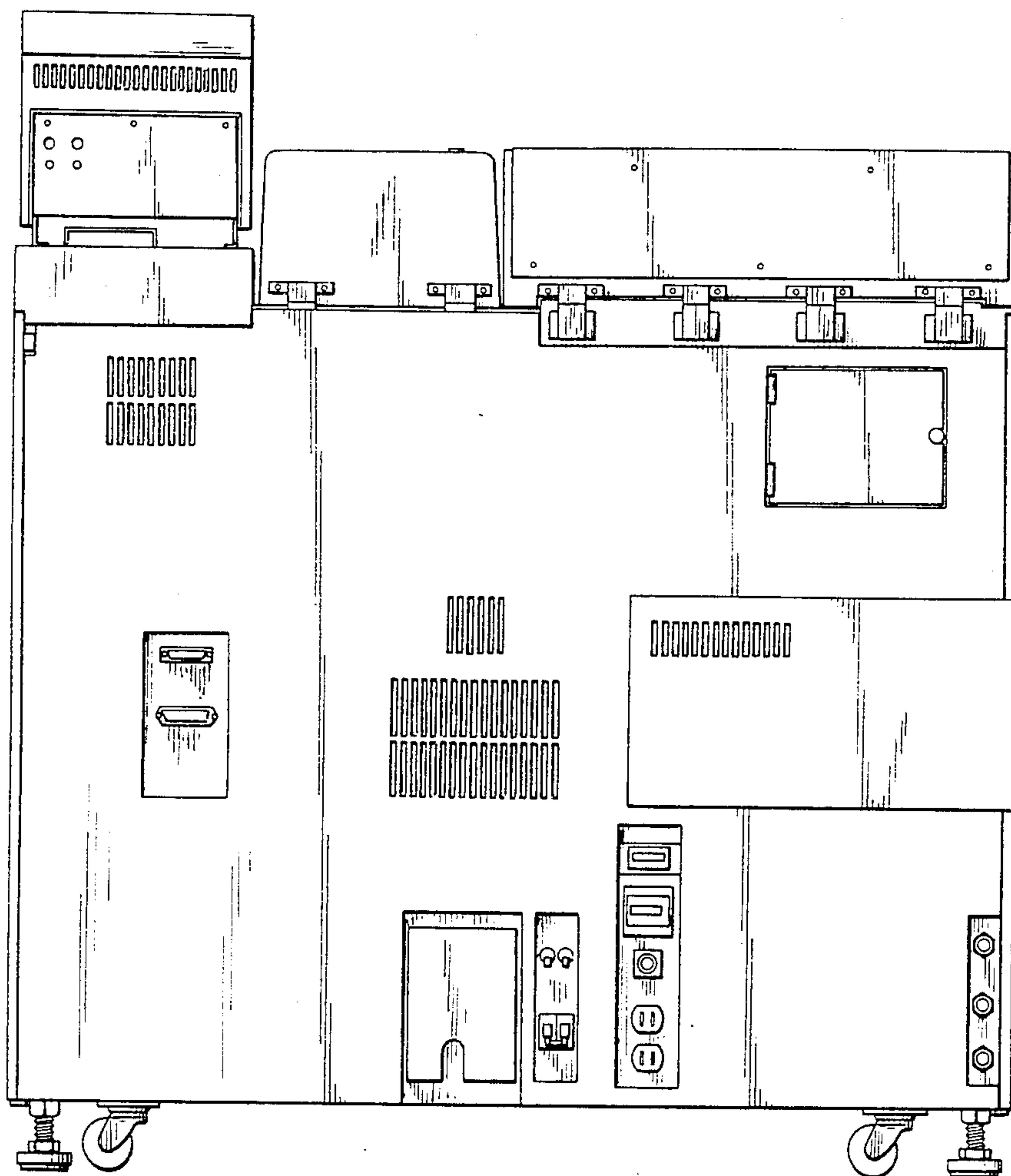

FIG. 5

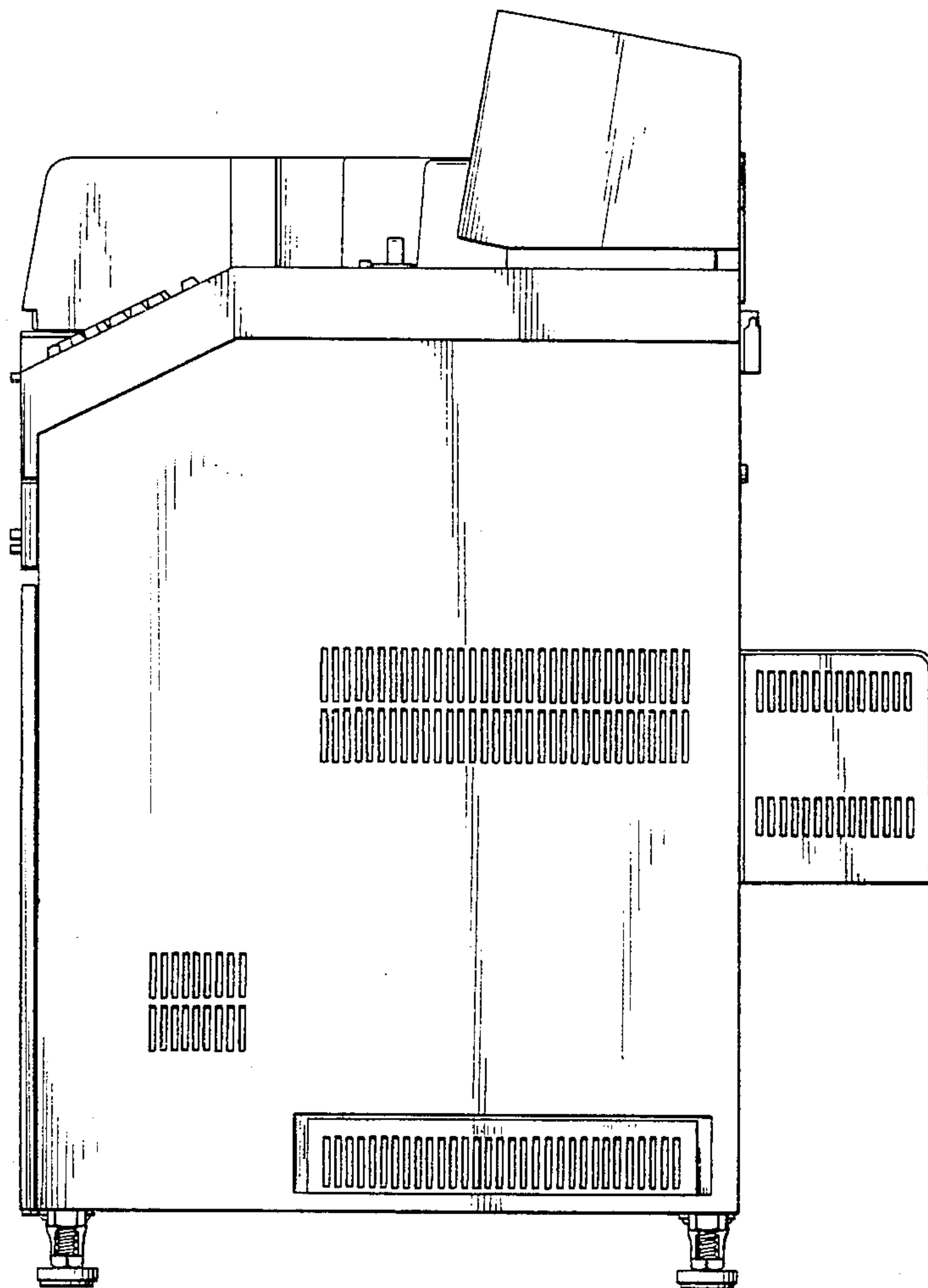

FIG. 6

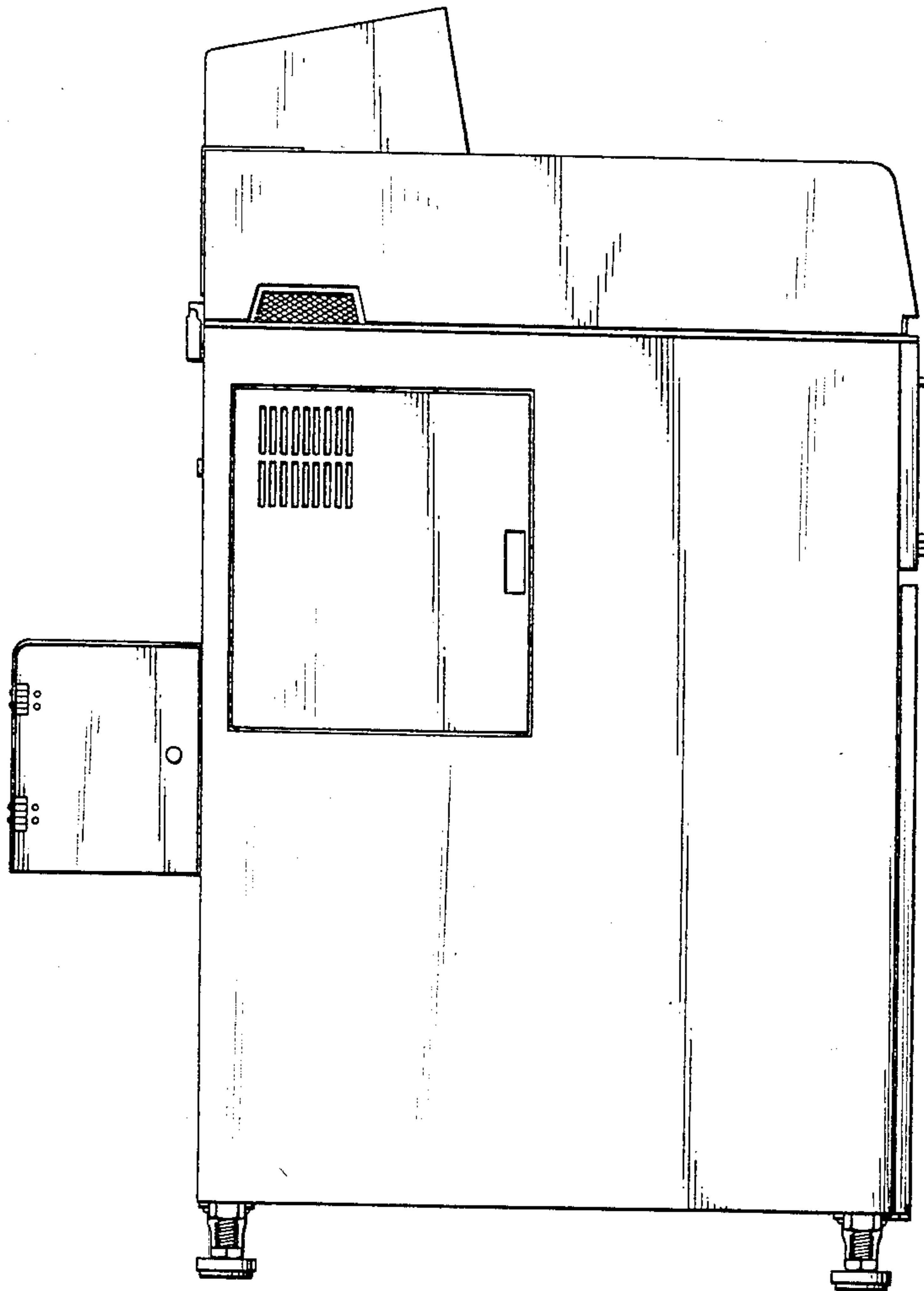

FIG. 7

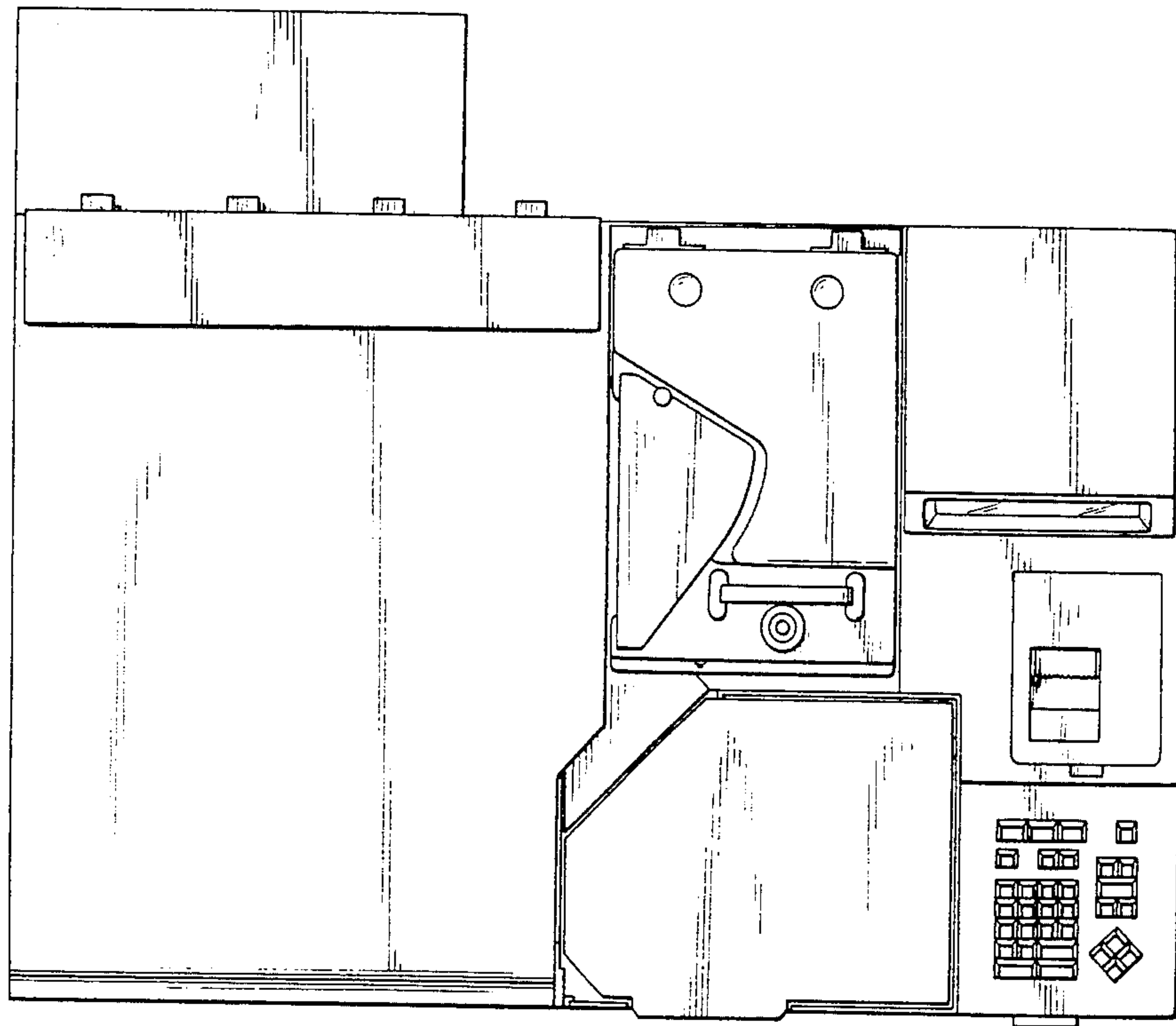

FIG. 8

