

[54] TRUSS

[76] Inventor: Otis D. Funk, 3006 E. Washington,
North Little Rock, Ark. 72114

[**] Term: 14 Years

[21] Appl. No.: 744,400

[22] Filed: Jun. 13, 1985

[52] U.S. Cl. D25/61

[58] Field of Search D25/61, 60, 35; 52/90,
52/33, 642, 731

[56] References Cited

U.S. PATENT DOCUMENTS

D. 184,475 2/1959 Feffer D25/61
2,904,139 9/1959 Prudhon D25/61
3,039,152 6/1962 Hillesheim D25/61

Primary Examiner—A. Hugo Word

[57] CLAIM

The ornamental design for a truss, as shown and described.

DESCRIPTION

FIG. 1 is a front end elevational view of a truss showing my new design;

FIG. 2 is a top plan view thereof;

FIG. 3 is a bottom plan view thereof;

FIG. 4 is a side elevational view thereof, the opposite side being a mirror image;

FIG. 5 is a rear elevational view thereof;

FIG. 6 is an enlarged fragmentary perspective view of the apex portion of the truss; and,

FIG. 7 is an enlarged fragmentary perspective view of the corner section of the truss.

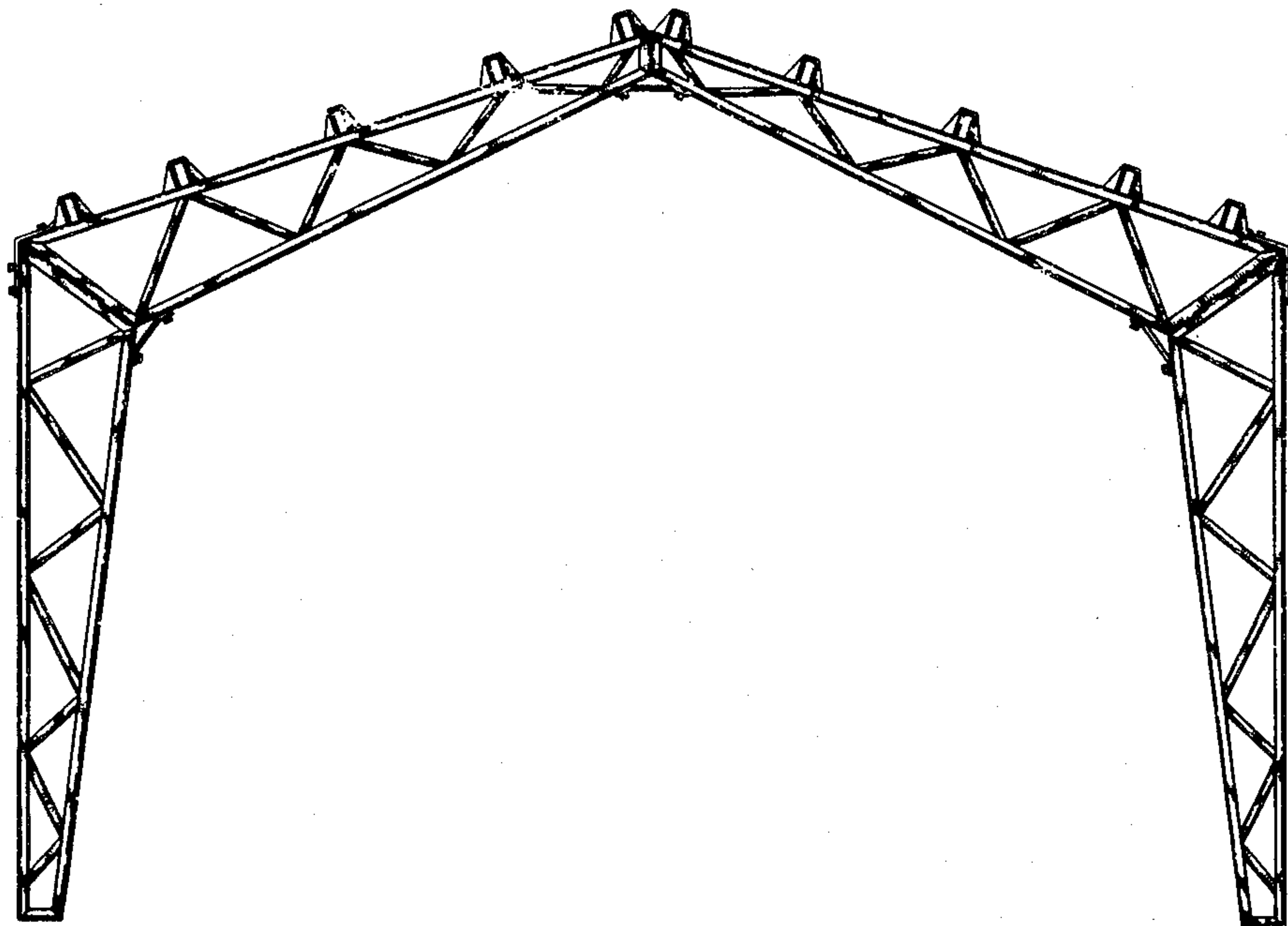

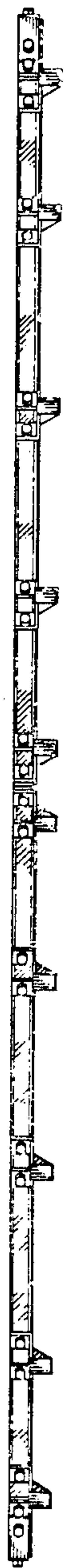

FIG. 2

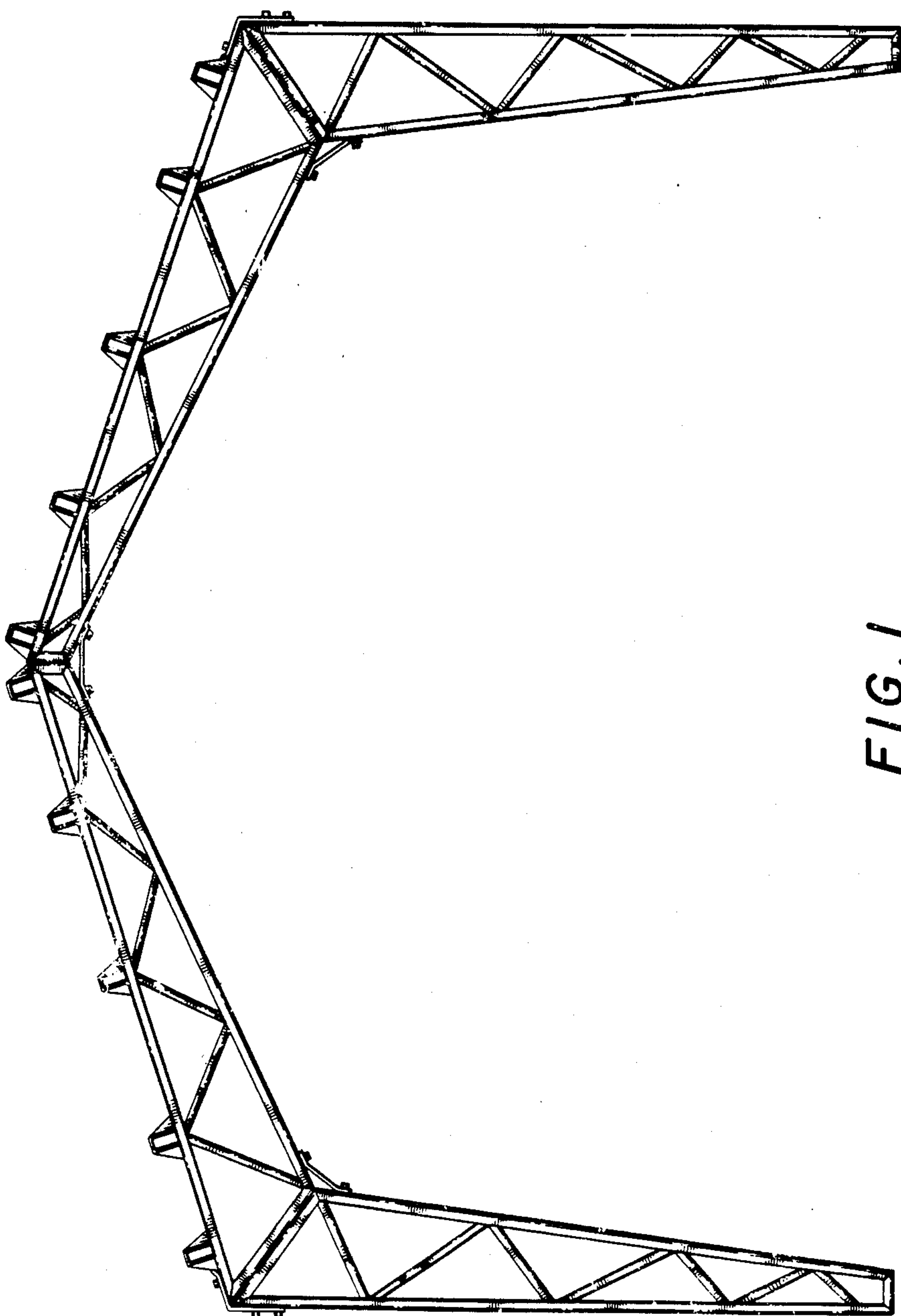

FIG. 1



FIG. 3

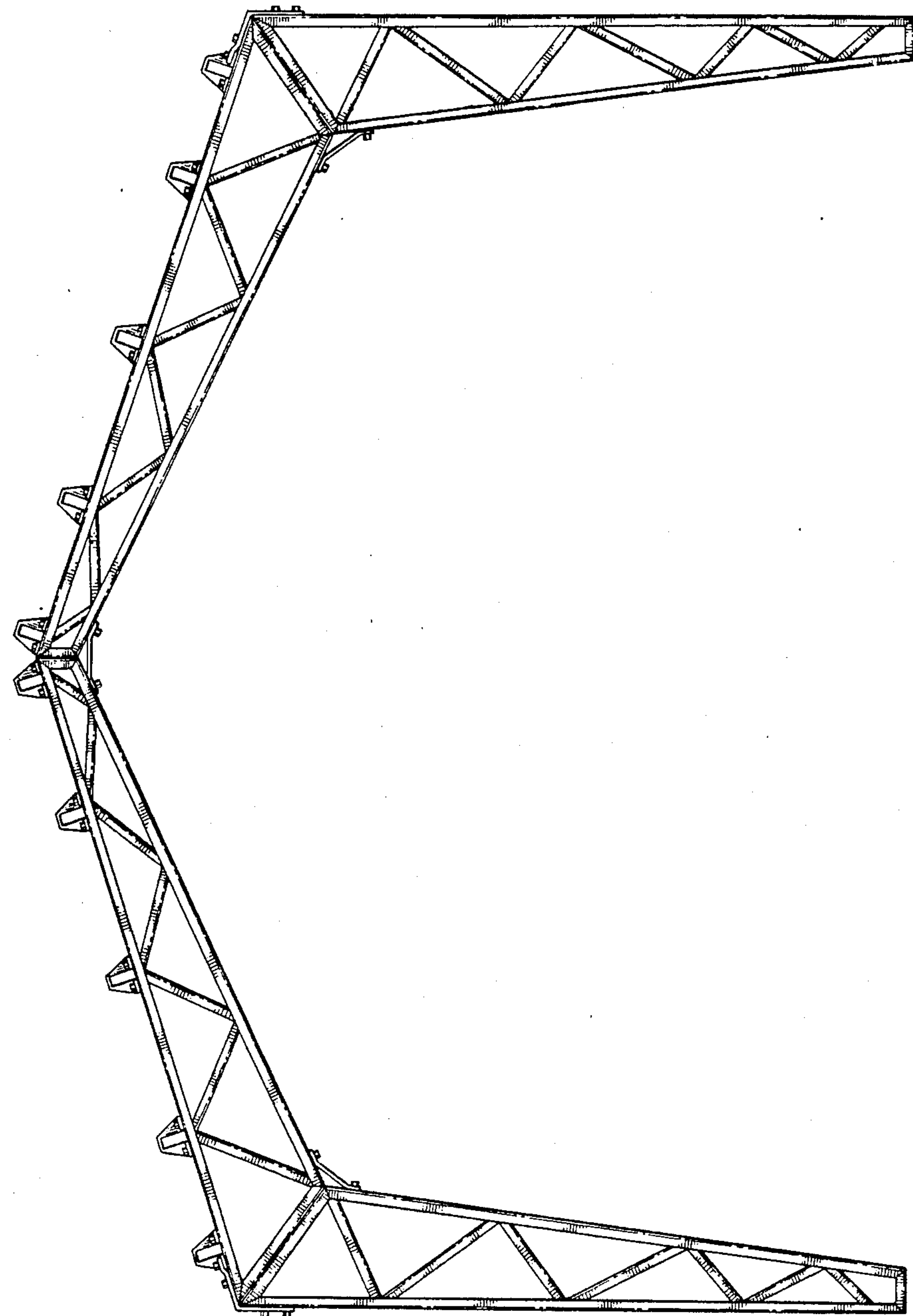

FIG. 5



FIG. 4

