

[54] PALLET

[75] Inventors: Richard C. Rothwell, Waunakee, Wis.; Kevin D. Rose, Davenport, Iowa

[73] Assignee: Oscar Mayer, Madison, Wis.

[**] Term: 14 Years

[21] Appl. No.: 731,865

[22] Filed: May 8, 1985

[52] U.S. Cl. D34/38

[58] Field of Search D34/38; 108/51.1, 52.1, 108/53.1, 53.3, 55.3

[56] References Cited

U.S. PATENT DOCUMENTS

35,174	10/1901	Conklin et al.	D34/38
2,991,965	7/1961	Drieborg	108/51.1
3,667,403	6/1972	Angelbeck, Jr.	108/51.1

FOREIGN PATENT DOCUMENTS

2232488 1/1975 France 108/51.1

Primary Examiner—James M. Gandy

Assistant Examiner—Kay H. Chin

Attorney, Agent, or Firm—Joseph T. Harcarik; Thomas R. Savoie; Daniel J. Donovan

[57] CLAIM

The ornamental design for a pallet, as shown and described.

DESCRIPTION

FIG. 1 is a top perspective view of a pallet showing our new design;

FIG. 2 is a top plan view thereof;

FIG. 3 is a cross sectional view thereof, taken along the line 3—3 of FIG. 1;

FIG. 4 is a bottom plan view thereof;

FIG. 5 is an end elevation view thereof, the opposite end elevation view being a mirror image of that shown;

FIG. 6 is a side elevation view thereof, the opposite side elevation view being a mirror image of that shown.

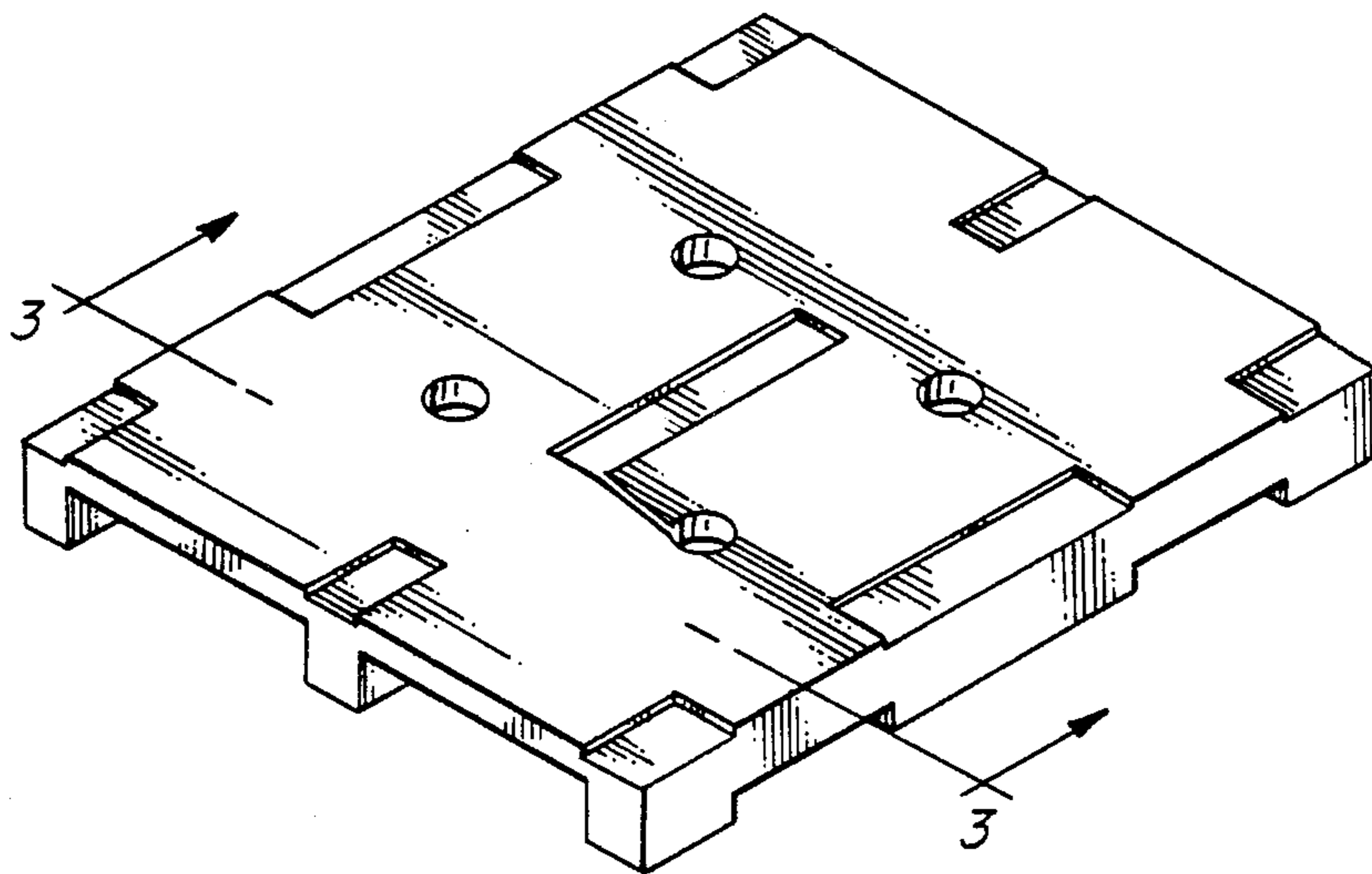

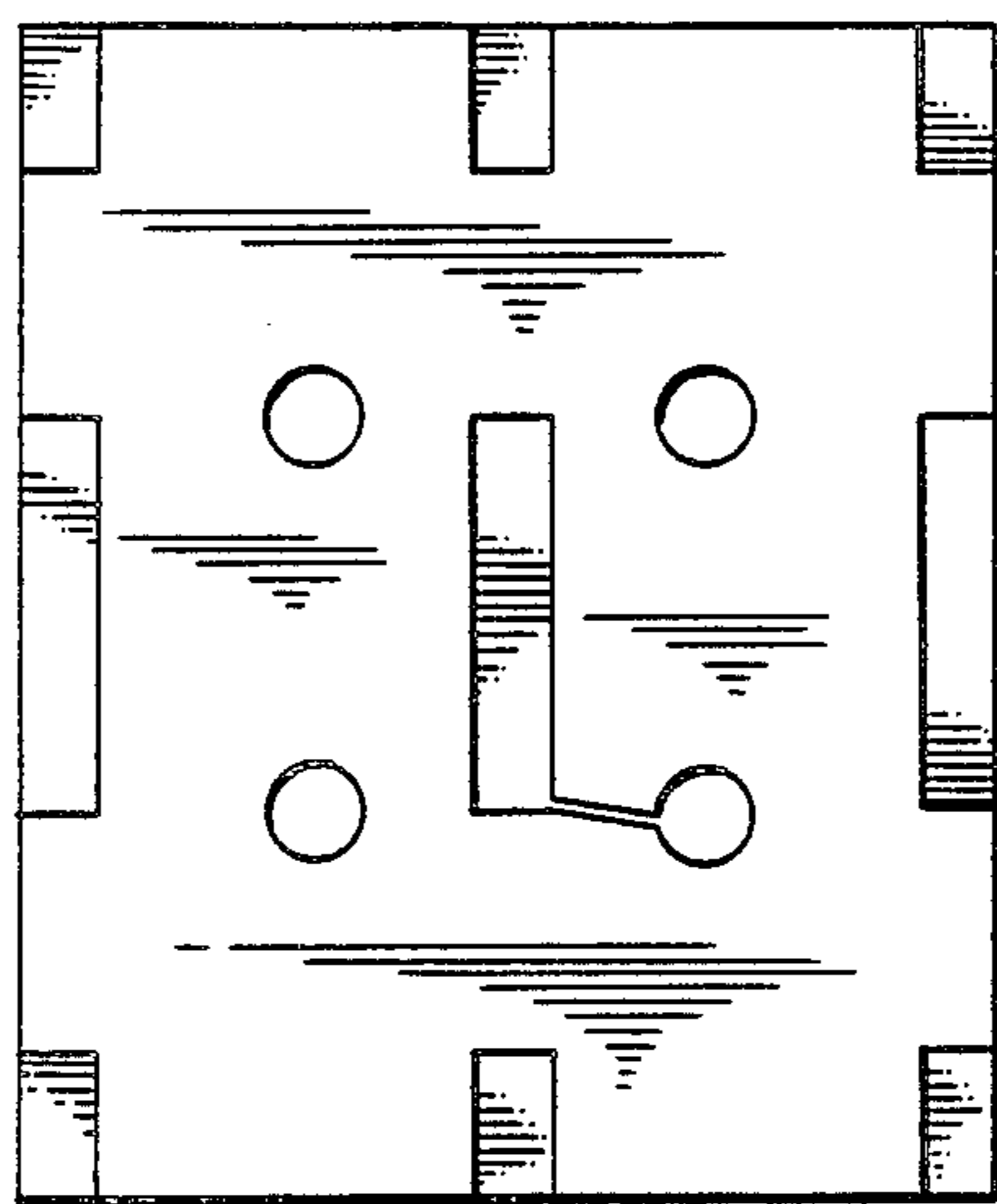
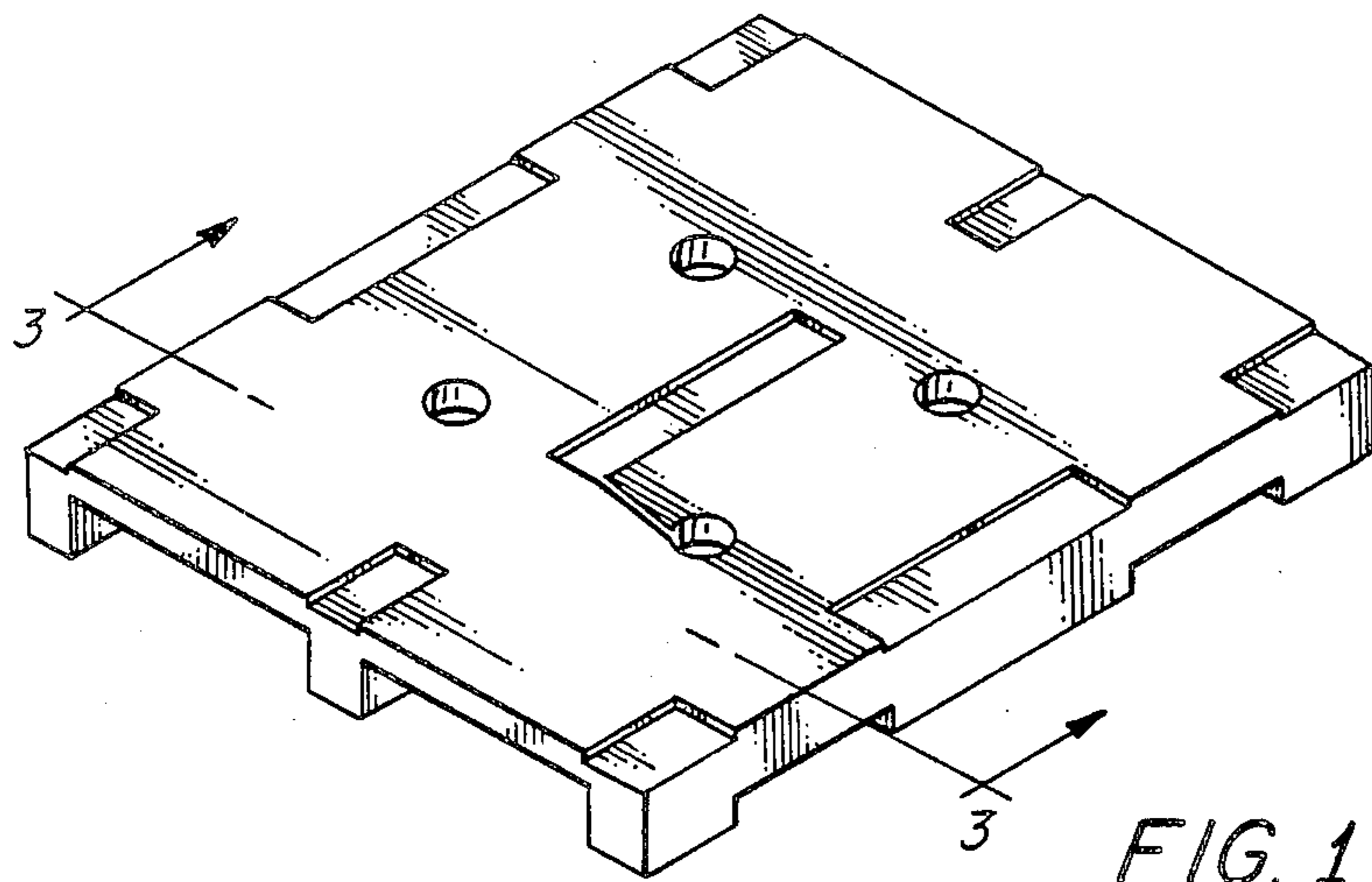

FIG. 2



FIG. 3

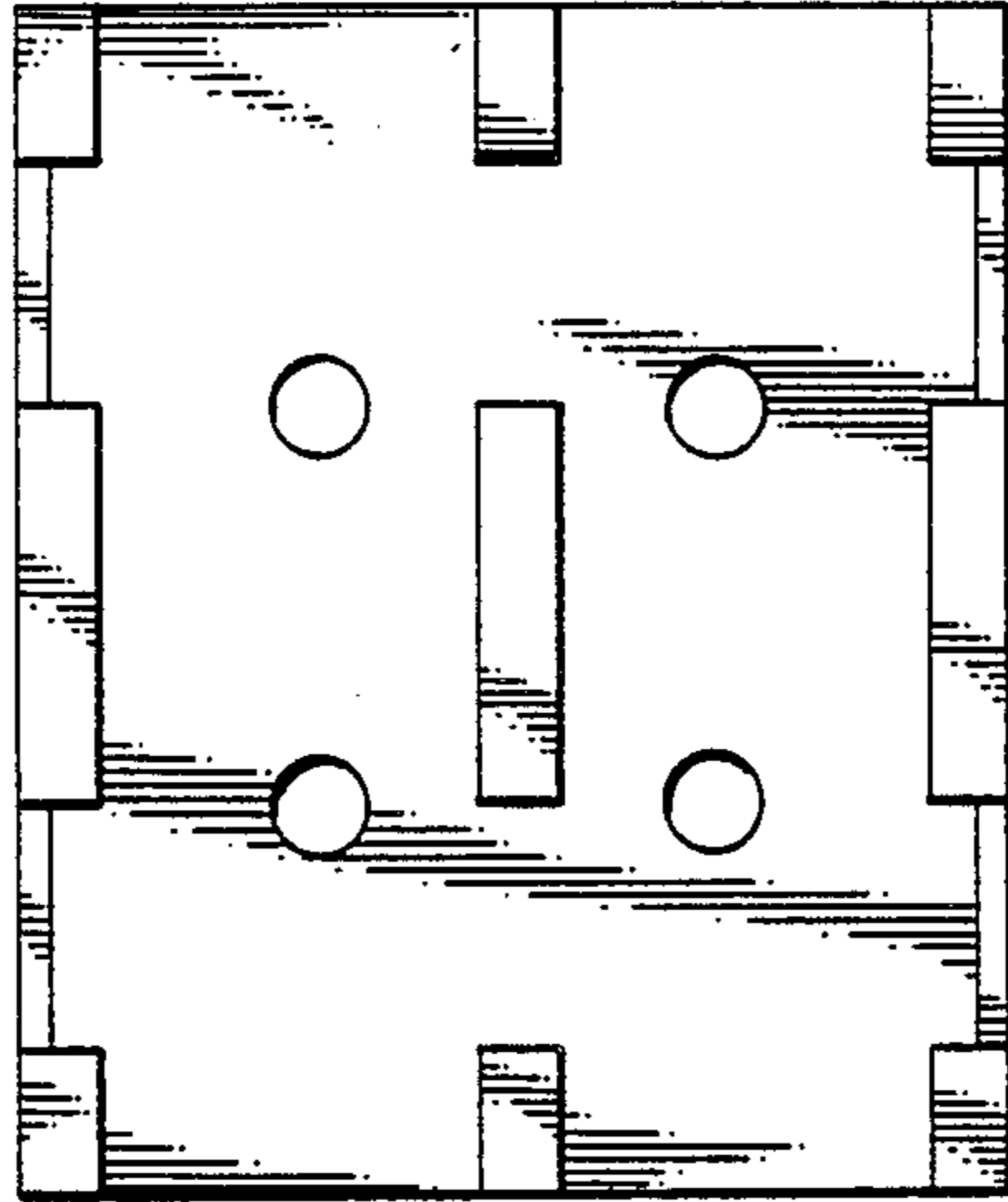

FIG. 4



FIG. 5

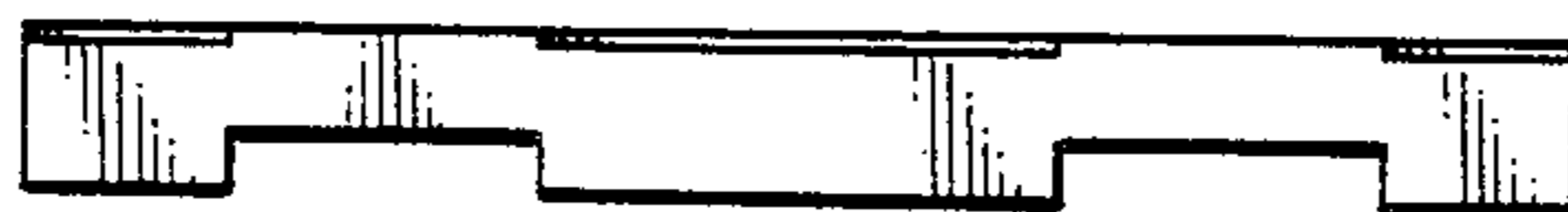

FIG. 6