

[54] CONTROL PANEL FOR VENDING MACHINE OR THE LIKE

D. 290,619 6/1987 Brandes et al. D20/5

[75] Inventors: Don S. Summerville, Snellville; Phillip J. Snoke; Lionel D. Gillespie, both of Atlanta; Frank B. Golley, Decatur, all of Ga.

Primary Examiner—Bernard Ansher
Assistant Examiner—Theodore M. Shooman
Attorney, Agent, or Firm—Birch, Stewart, Kolasch & Birch

[73] Assignee: The Coca-Cola Company, Atlanta, Ga.

[57] CLAIM

The ornamental design for a control panel for a vending machine or the like, as shown and described.

[**] Term: 14 Years

DESCRIPTION

[21] Appl. No.: 748,224

FIG. 1 is a front and right side perspective view of a control panel for a vending machine or the like showing our new design;

[22] Filed: Jun. 24, 1985

FIG. 2 is a left side elevational view thereof;

[52] U.S. Cl. D20/8; D20/5

FIG. 3 is a top plan view thereof;

[58] Field of Search D20/1-9; 194/206, 207, 233, 248, 255, 350; 221/92, 129, 131, 133, 155

FIG. 4 is a front elevational view of a second embodiment of the control panel illustrated in FIG. 1; and
FIG. 5 is a front elevational view of a third embodiment of the control panel illustrated in FIG. 1.

[56] References Cited

The bottom and rear of the control panel are flat and unornamented.

U.S. PATENT DOCUMENTS

The broken line showings are environmental only and form no part of the claimed design.

- D. 282,084 1/1986 Koch D20/1
- D. 288,574 3/1987 King et al. D20/5

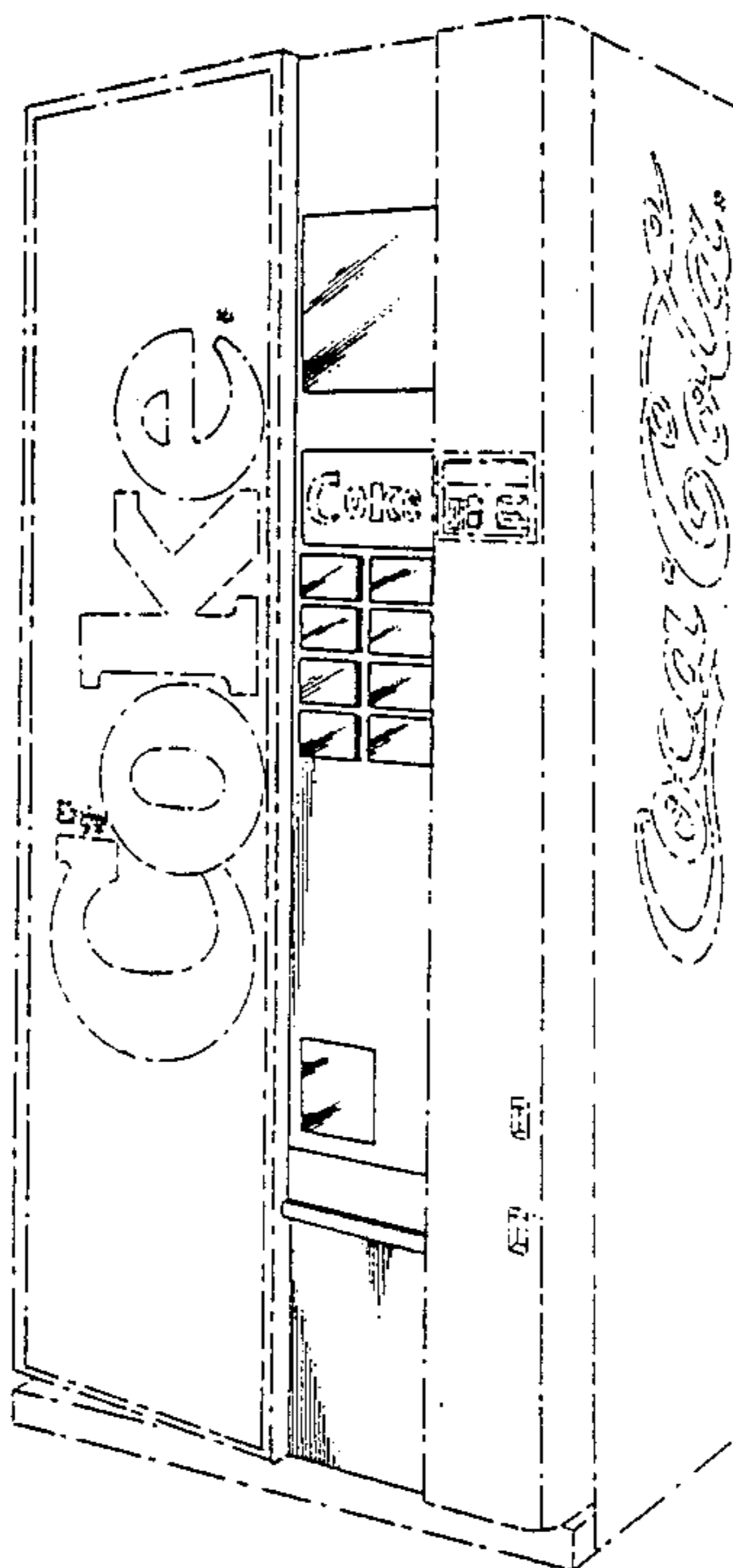

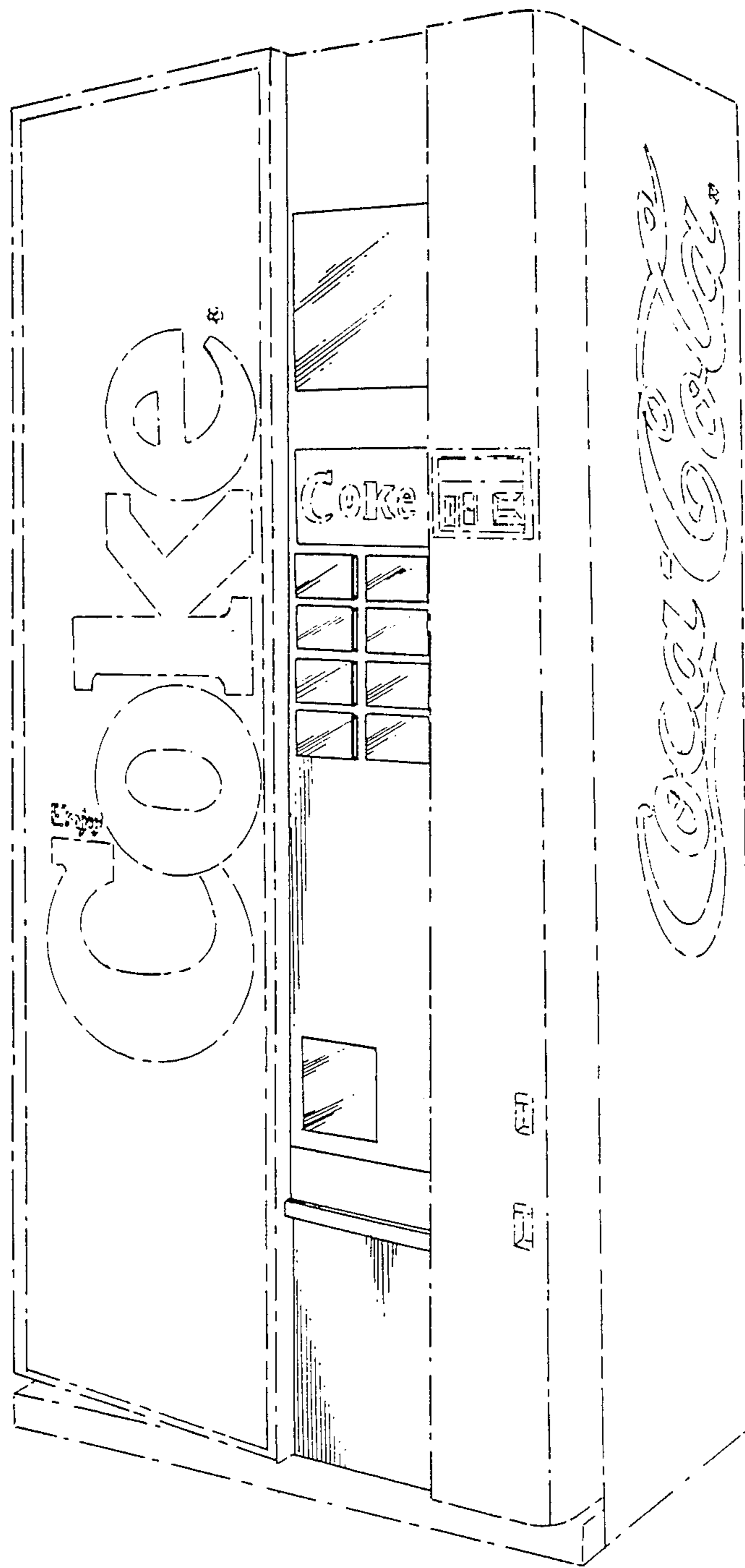

FIG. 1

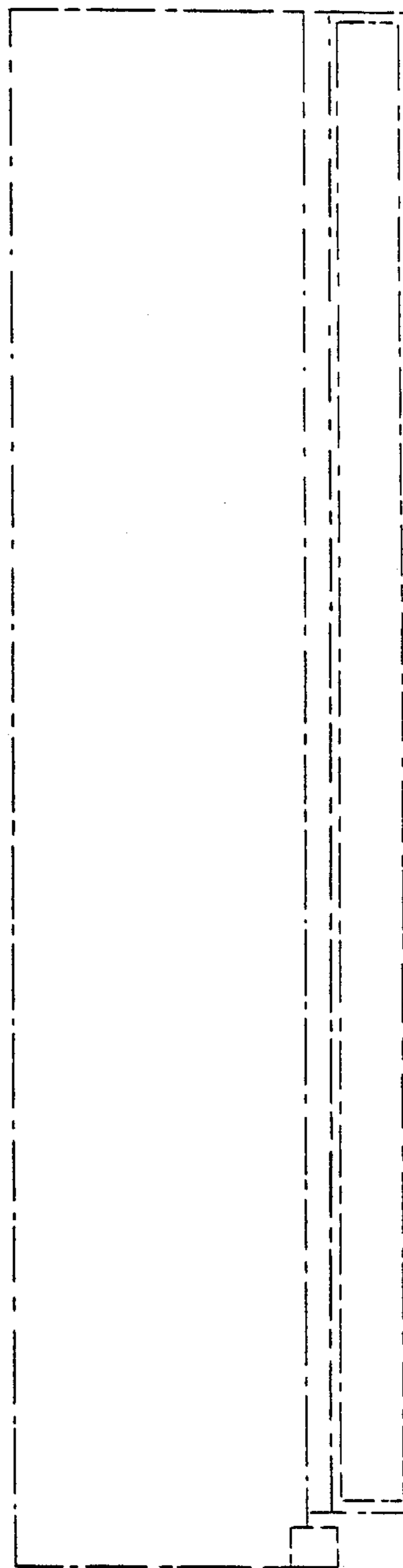

FIG. 2

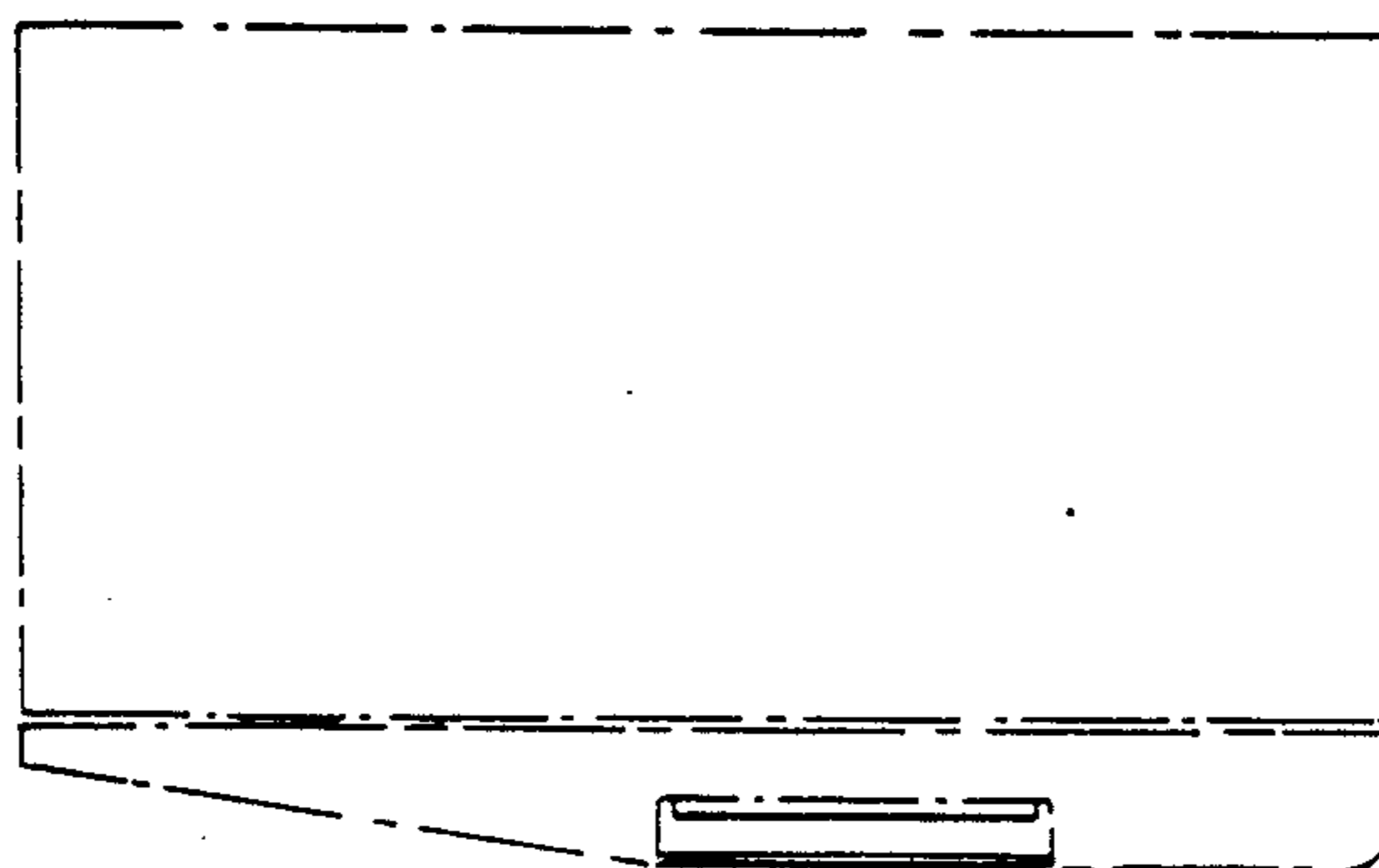

FIG. 3

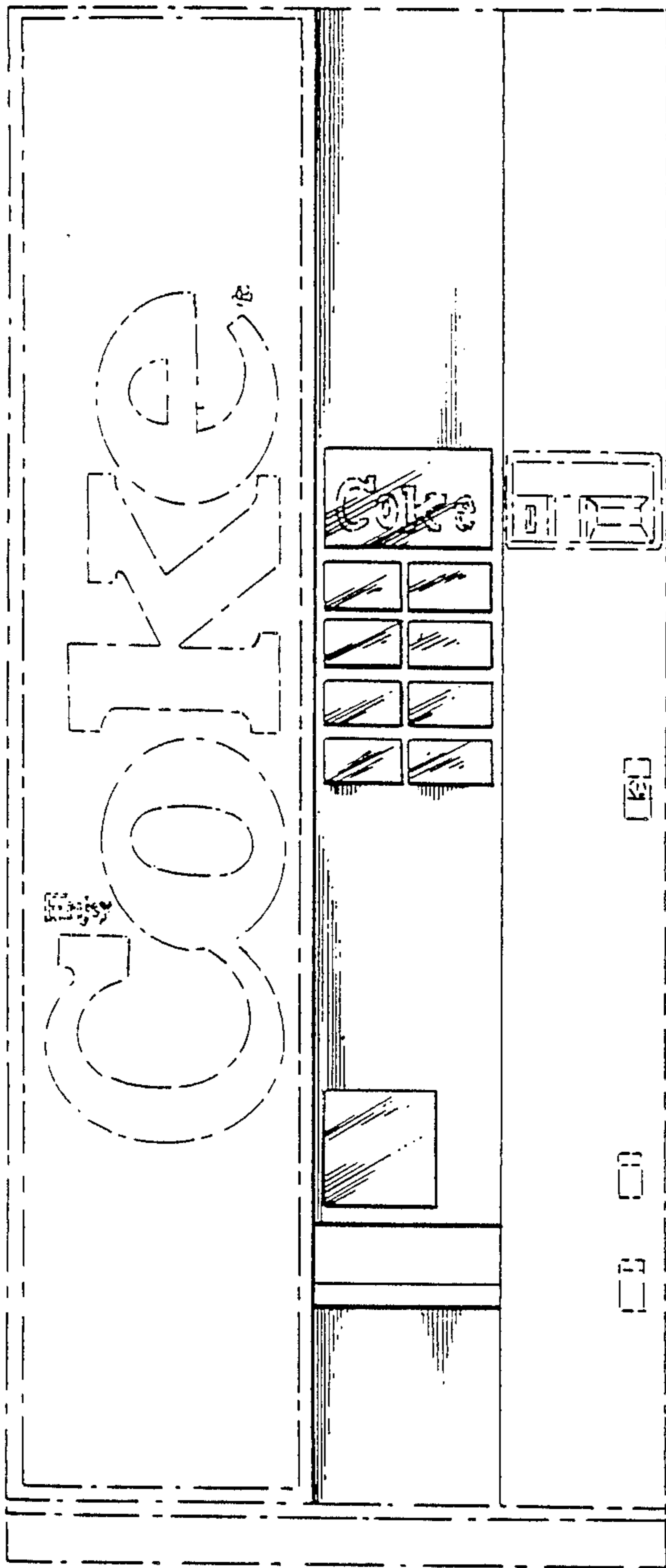

FIG. 4

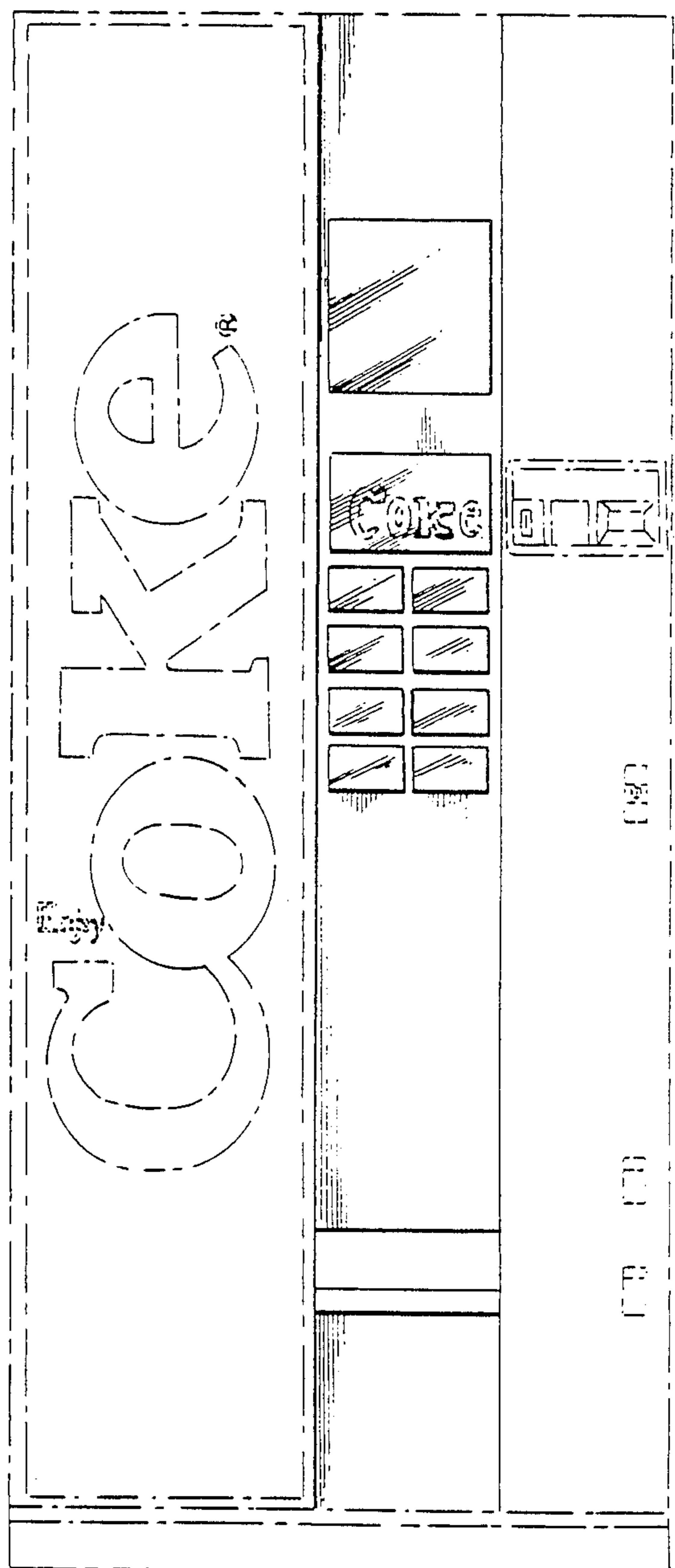

FIG. 5