

[54] HOUSING FOR A DESK TELEPHONE
PAYSTATION BASE

[75] Inventor: E. Randall Cochran, Decatur, Ala.

[73] Assignee: GTE Communication Systems,
Northlake, Ill.

[**] Term: 14 Years

[21] Appl. No.: 702,283

[22] Filed: Feb. 15, 1985

[52] U.S. Cl. D14/60; D14/55;
D14/62

[58] Field of Search D14/53, 55, 60, 62;
379/155, 144, 143

[56] References Cited

U.S. PATENT DOCUMENTS

D. 57,022	1/1921	Steen	D21/111
D. 157,849	3/1950	Dreyfuss	D14/65
D. 203,505	1/1966	Bohm	D14/65 X
D. 203,831	2/1966	Chipping	D14/53
D. 216,641	2/1970	Phillips	D14/65
D. 232,648	9/1974	Brass	D21/111
D. 233,611	11/1974	Kramer	D14/55
D. 247,491	3/1978	Fukushima et al.	D14/56

D. 253,703	12/1979	Hillmer et al.	D14/65
D. 259,260	5/1981	Blomborg	D14/53
D. 260,769	9/1981	Thomas	D21/111
D. 263,611	3/1982	Bergman	D21/111
D. 268,674	4/1983	Jordan	D21/111
D. 270,260	8/1983	Appel et al.	D14/55 X
D. 275,196	8/1984	Huang	D14/54
D. 284,659	7/1986	Marlin	D21/62 X

Primary Examiner—Wallace R. Burke
Assistant Examiner—Horace B. Fay
Attorney, Agent, or Firm—Robert J. Black

[57] CLAIM

The ornamental design for a housing for a desk telephone paystation base, as shown and described.

DESCRIPTION

FIG. 1 is a front, top and right side perspective view of a housing for a desk telephone paystation base showing my new design;
FIG. 2 is a top plan view thereof;
FIG. 3 is a front elevational view thereof;
FIG. 4 is a left side elevational view thereof; and
FIG. 5 is a right side elevational view thereof.
The broken line showing of a switch hook, coin apertures and dial pushbutton is for illustrative purposes only and forms no part of the claimed design.

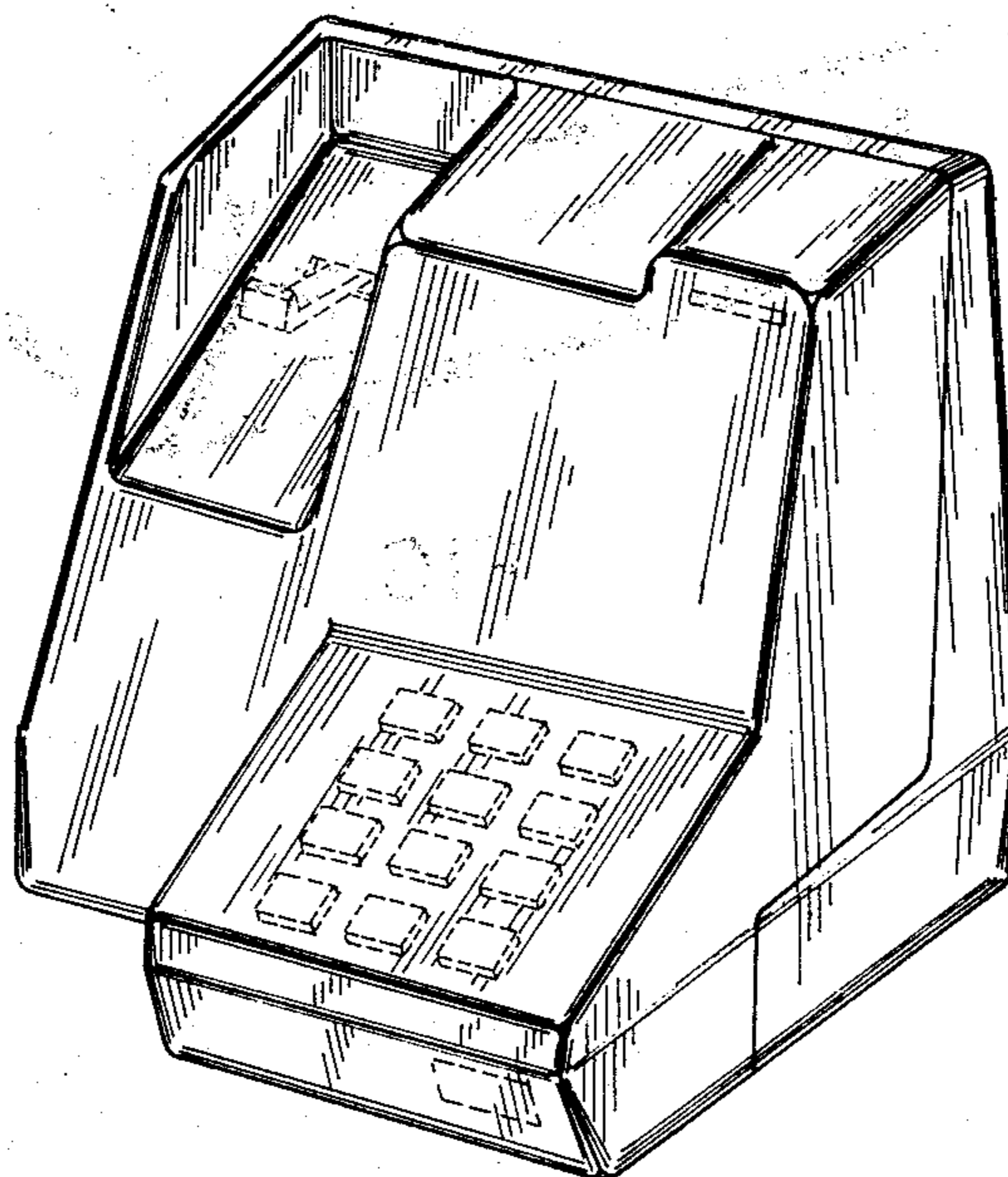

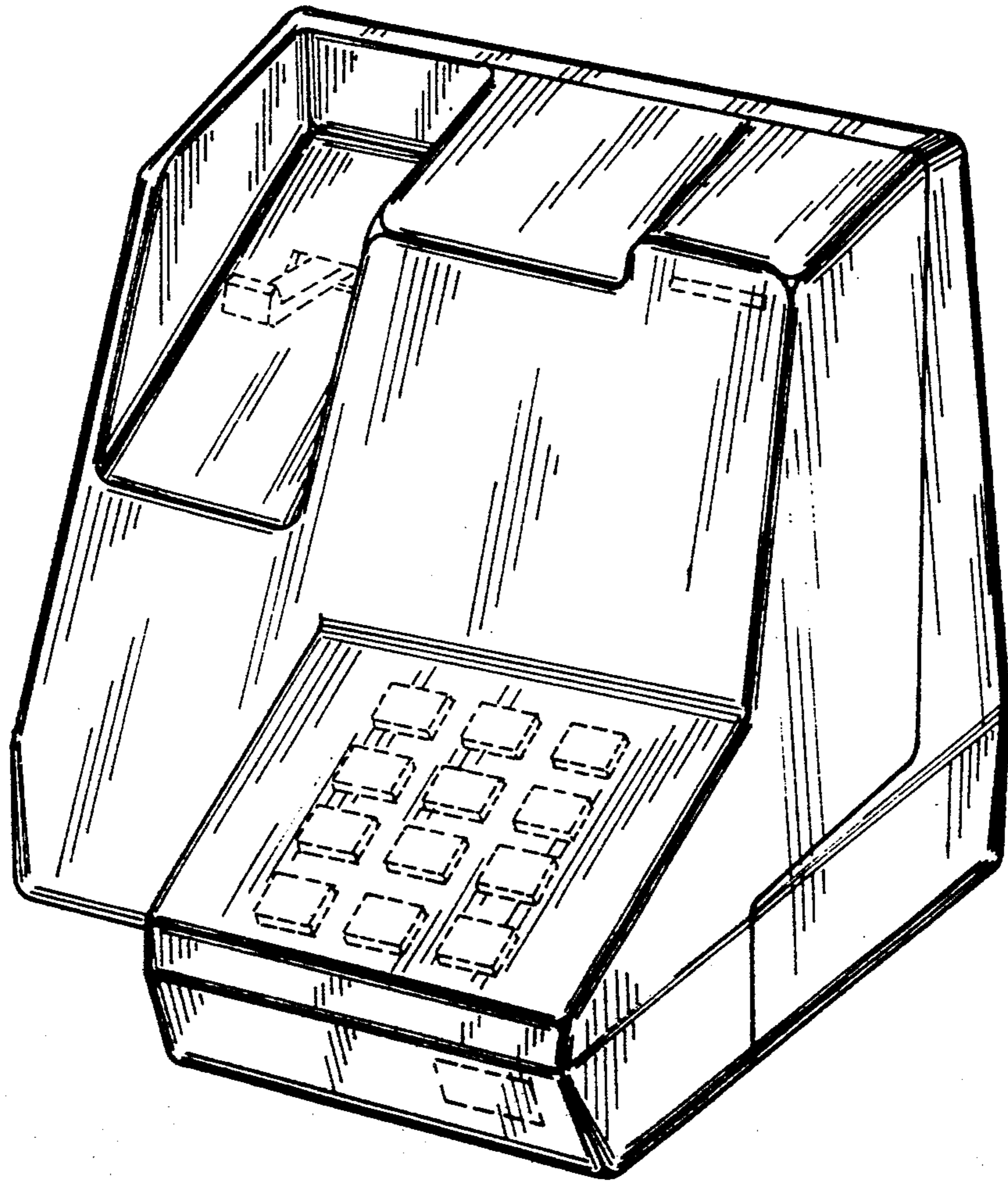

FIG. 1

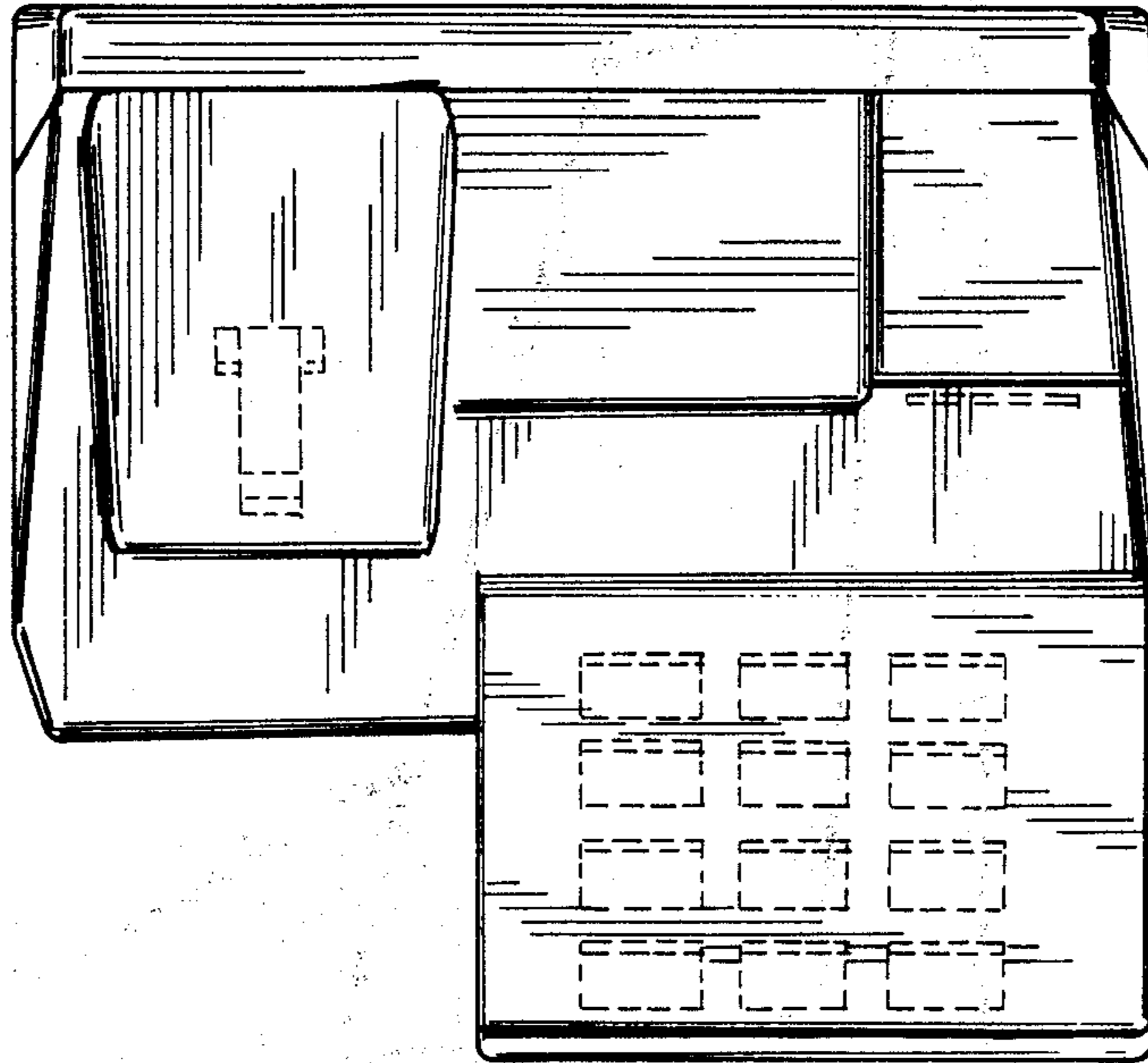

FIG. 2

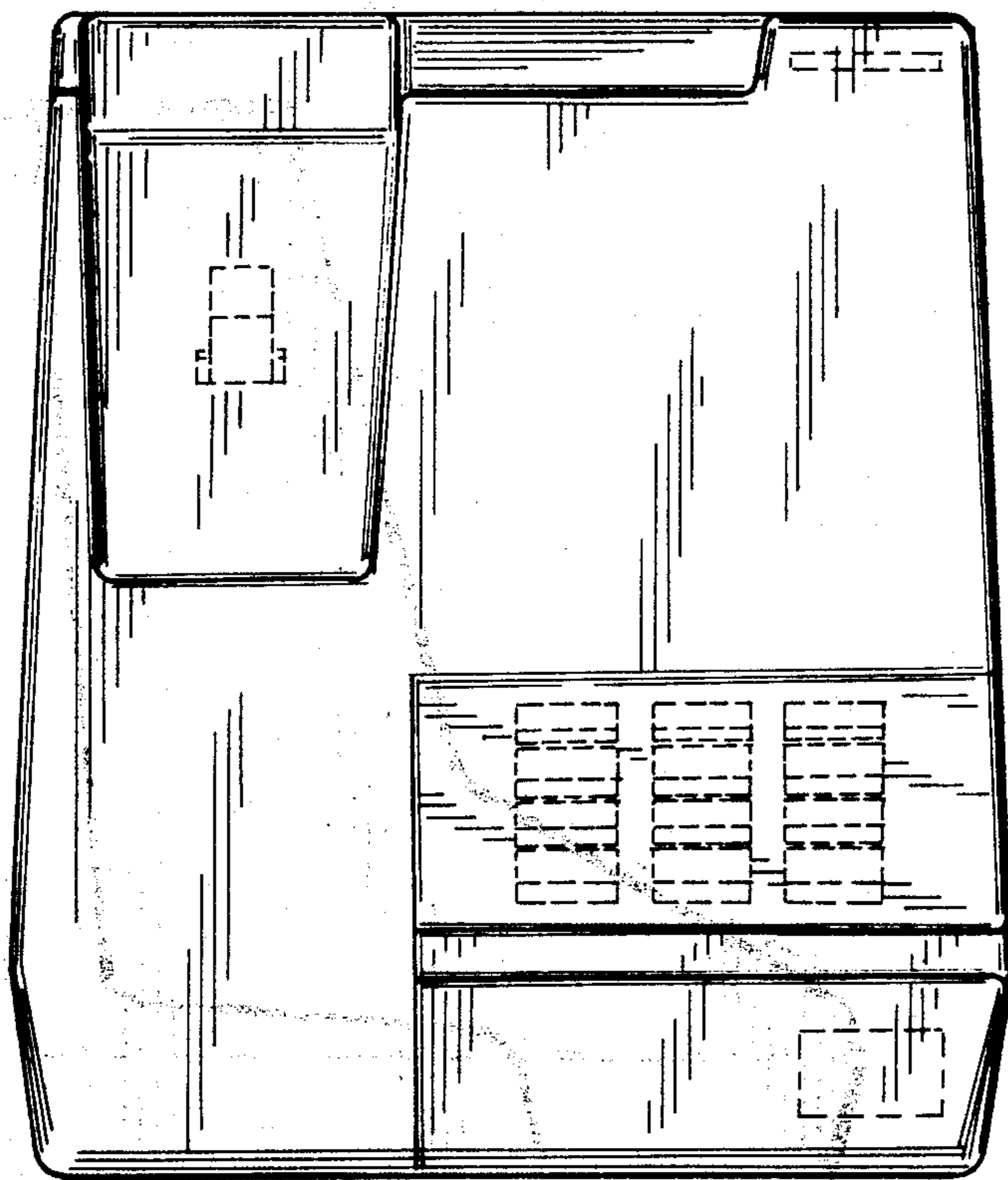

FIG. 3

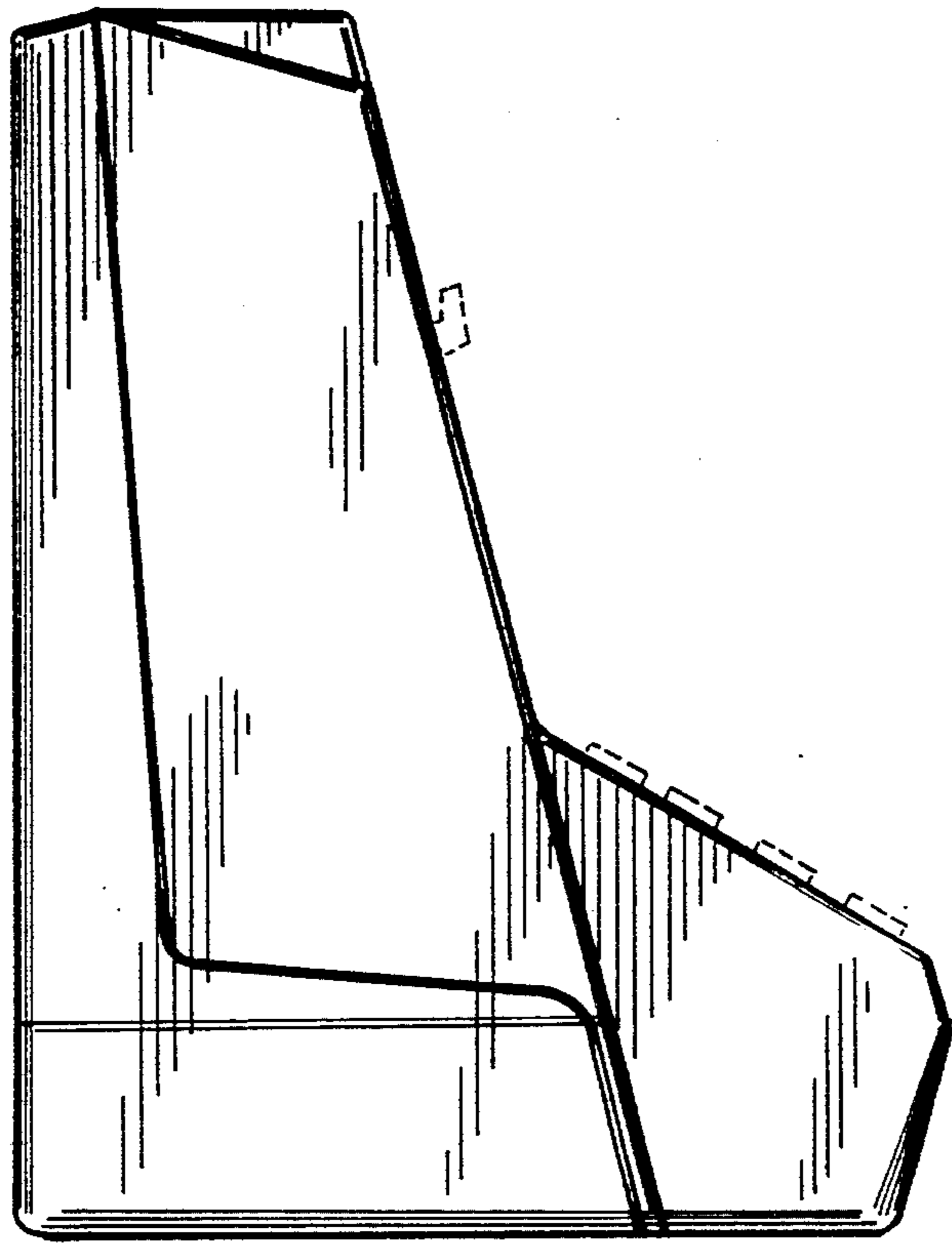

FIG. 4

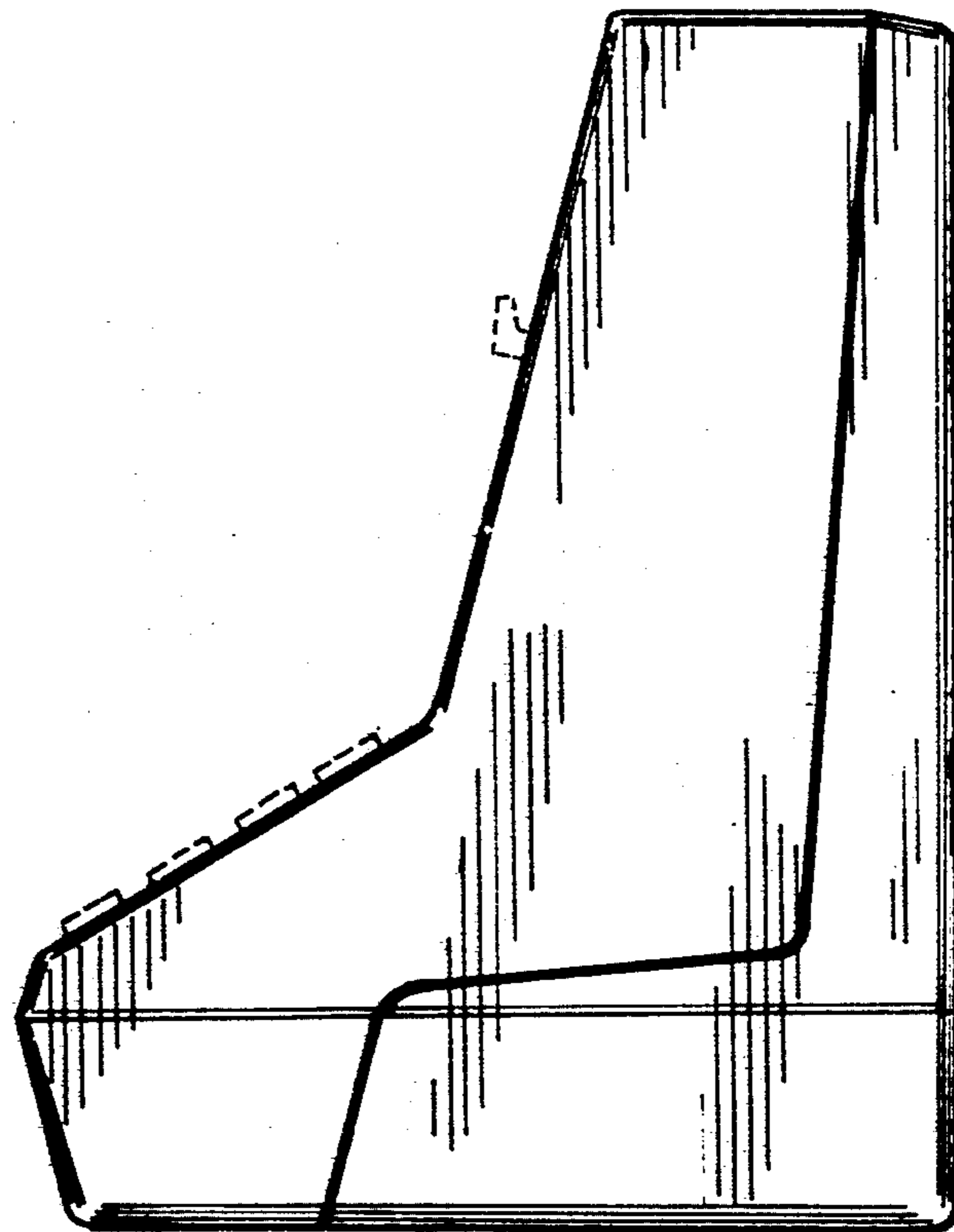

FIG. 5