

[54] **COMBINED DISPENSER AND CADDY FOR BABY TOILETRIES**

[76] Inventor: **Jonathan Helinsky**, 198 Woodward Ave., Staten Island, N.Y. 10314

[**] Term: **14 Years**

[21] Appl. No.: **615,467**

[22] Filed: **May 30, 1984**

[52] U.S. Cl. **D3/74; D3/39; D6/461; D6/467**

[58] Field of Search **D6/449, 461, 467, 524, D6/525; D7/58; D34/44; D3/39, 74; 206/581, 823; 132/79 R; 211/13**

[56] **References Cited**

U.S. PATENT DOCUMENTS

D. 212,995 12/1968 Myers D34/44

D. 217,160 4/1970 Levy D6/407
D. 262,928 2/1982 Medders D34/44
D. 281,929 12/1985 Strobel et al. D34/44
4,140,223 2/1979 Rau et al. D7/58
4,574,822 3/1986 Helinsky 132/79 R

Primary Examiner—B. J. Bullock
Attorney, Agent, or Firm—Richard L. Miller

[57] **CLAIM**

The ornamental design for a combined dispenser and caddy for baby toiletries, as shown and described.

DESCRIPTION

FIG. 1 is a top plan view of a combined dispenser and caddy for baby toiletries showing my new design; FIG. 2 is a right side elevational view thereof; FIG. 3 is a front elevational view thereof; FIG. 4 is a left side elevational view thereof; FIG. 5 is a bottom plan view thereof; and FIG. 6 is rear elevational view thereof.

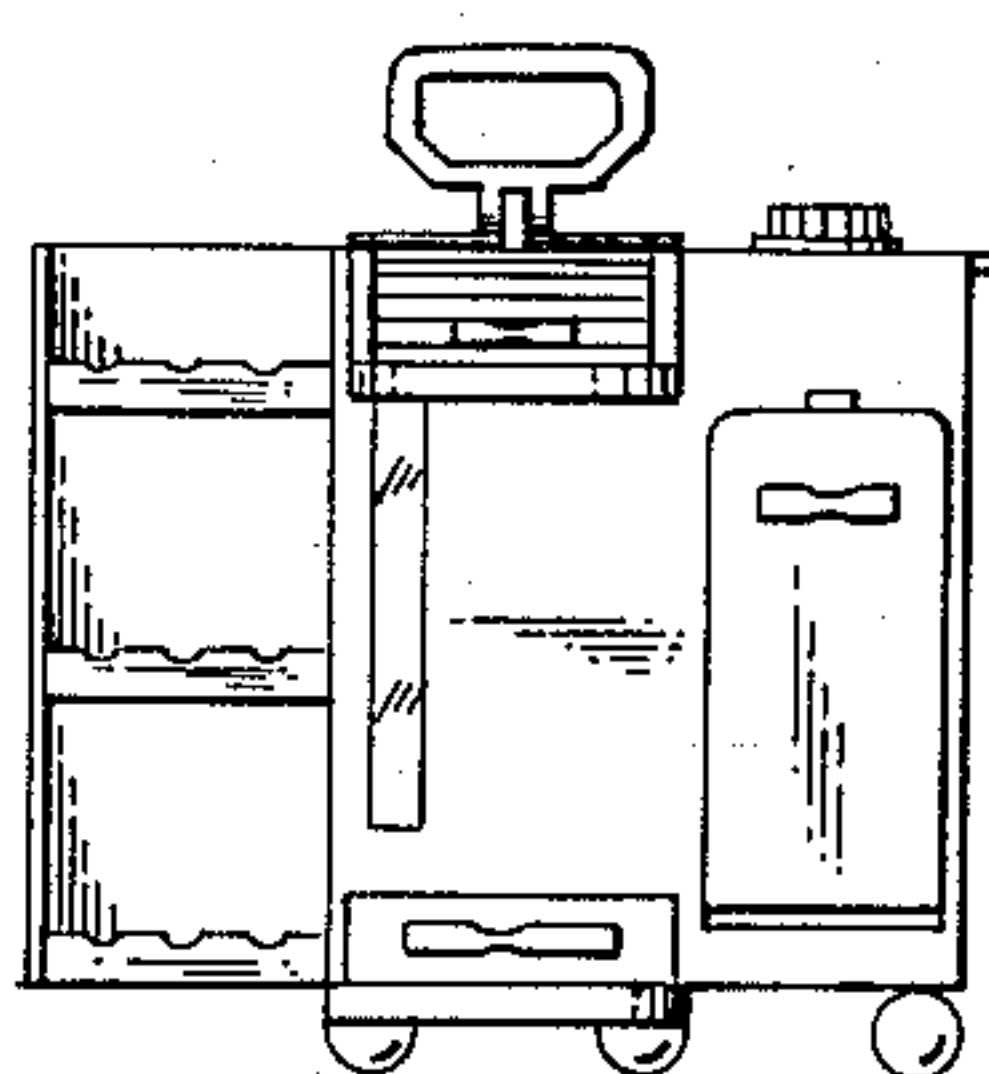
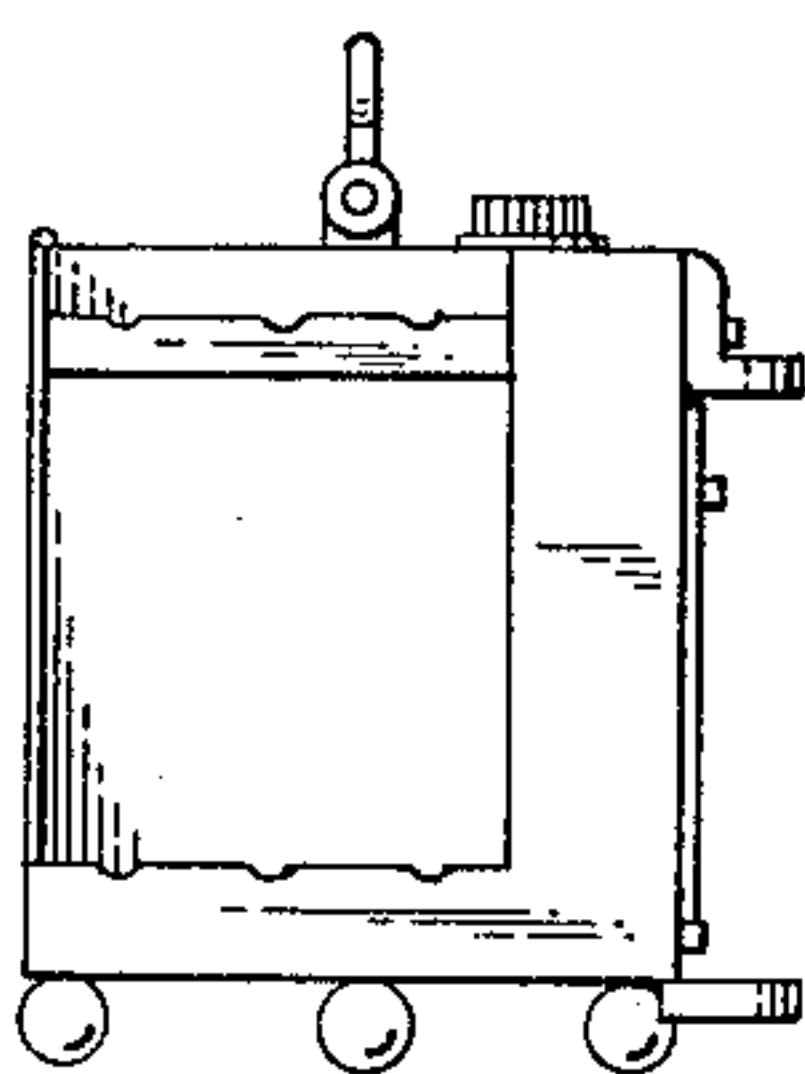
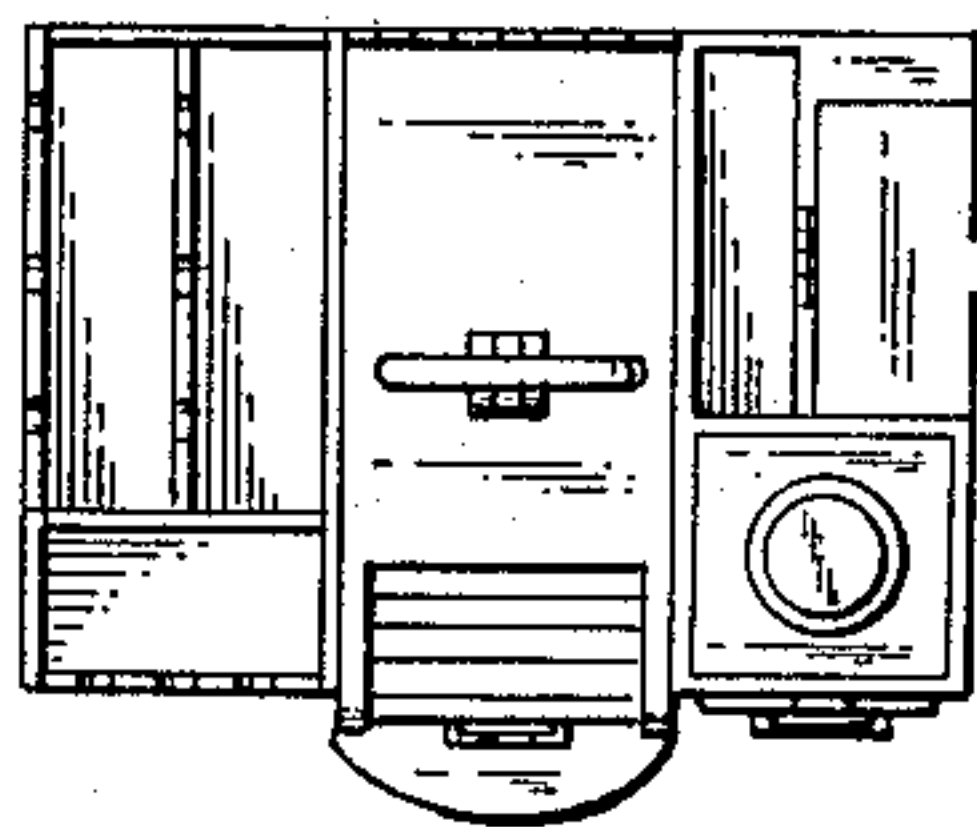

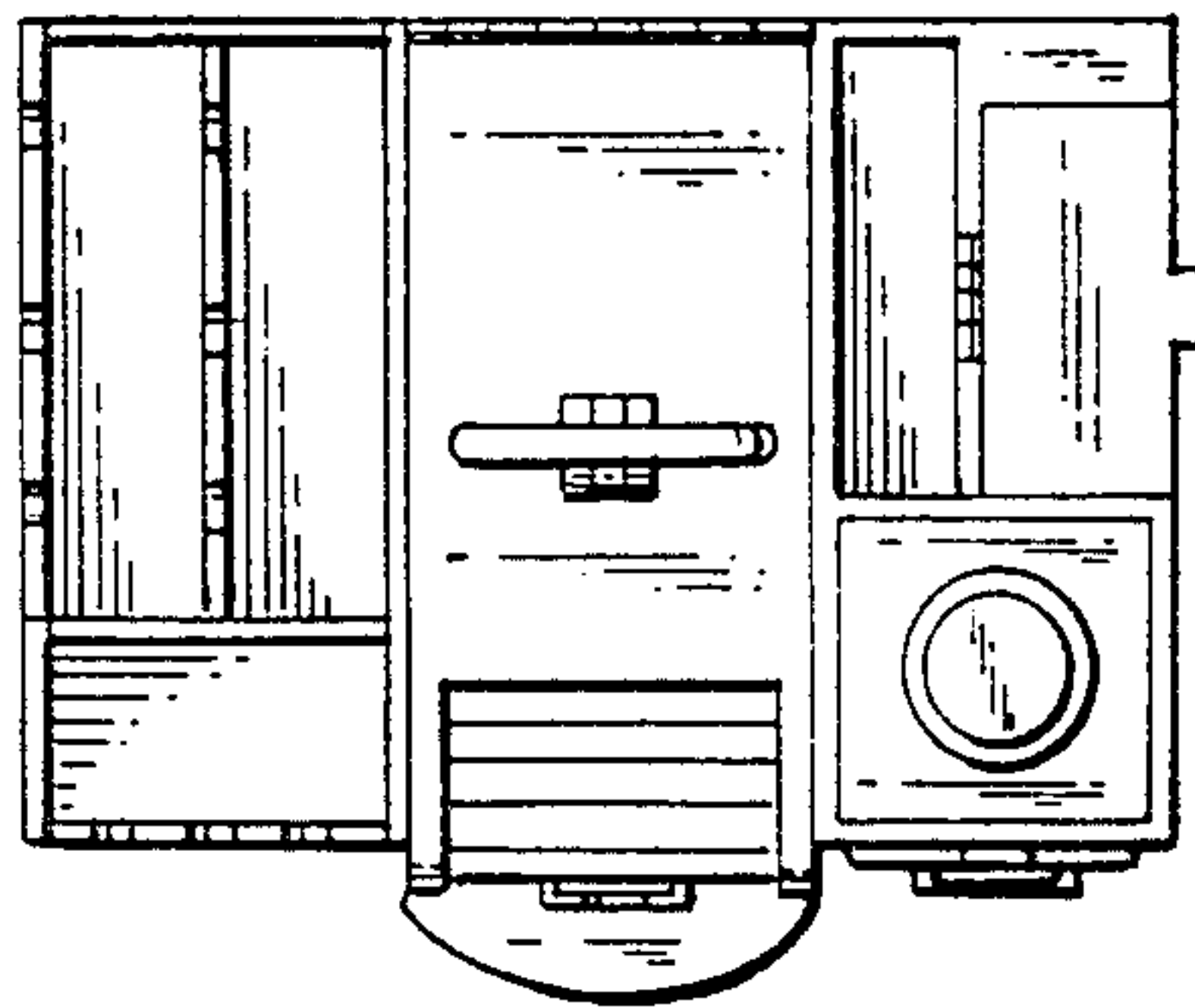

Fig. 1

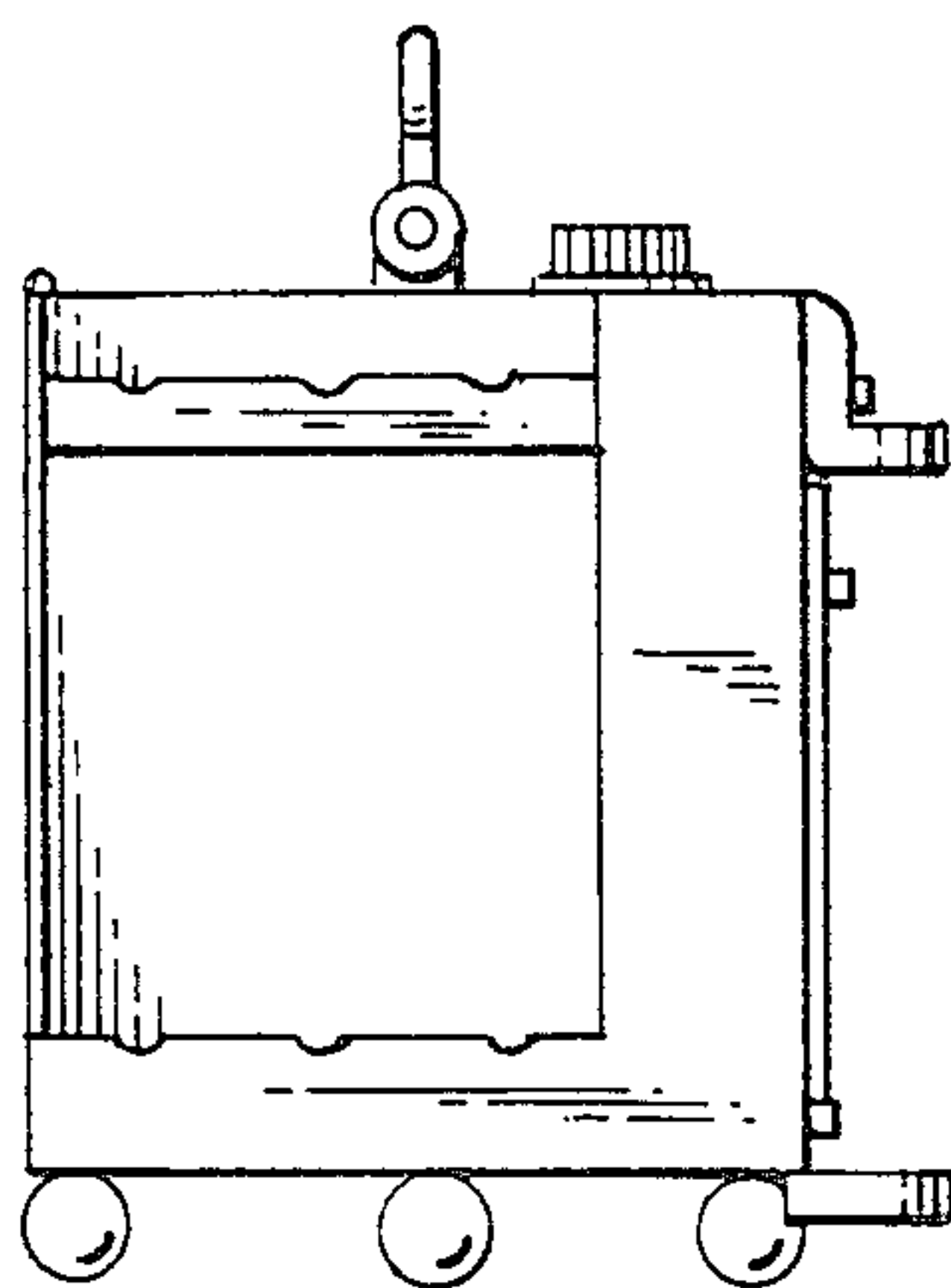

Fig. 2

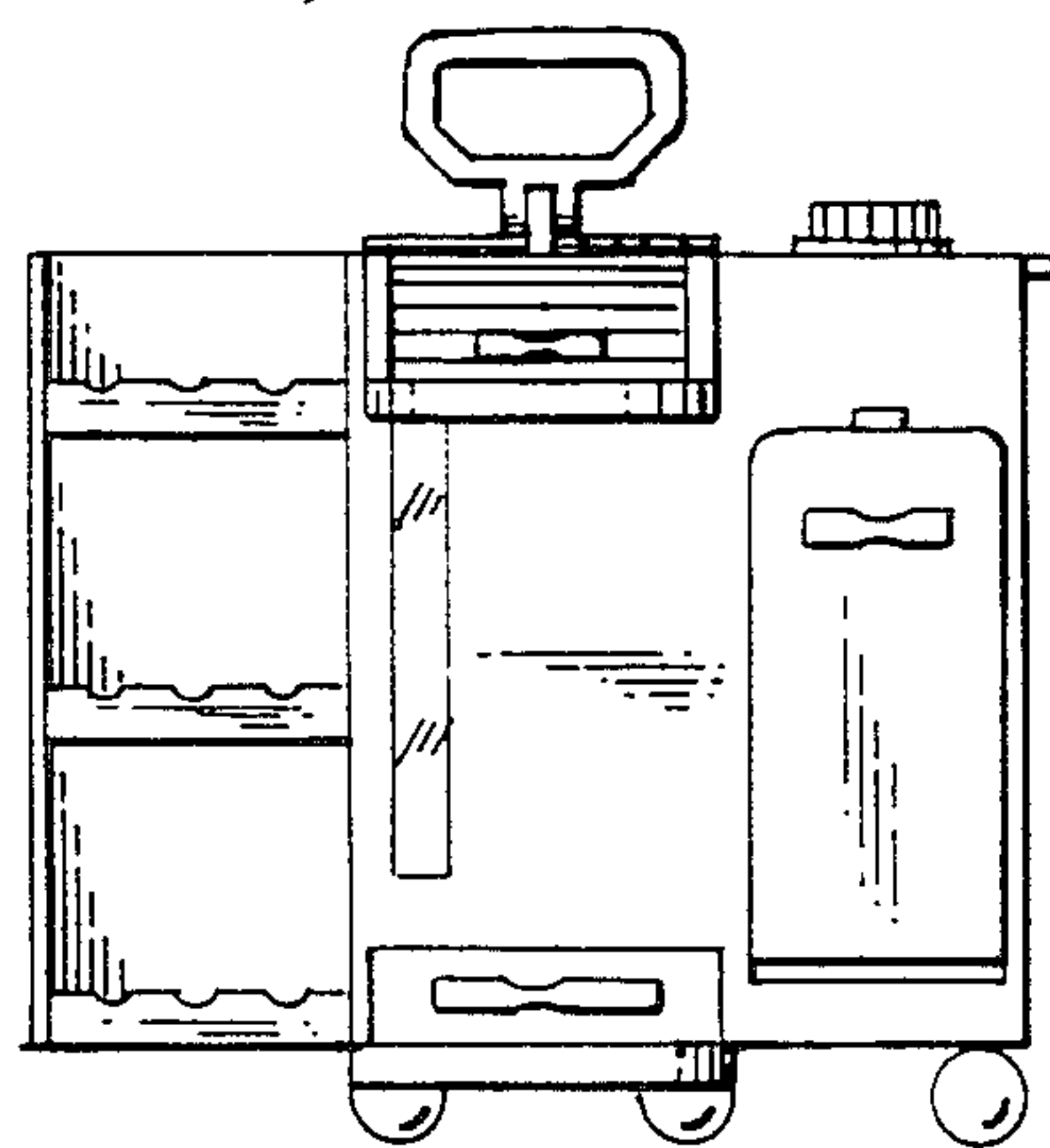

Fig. 3

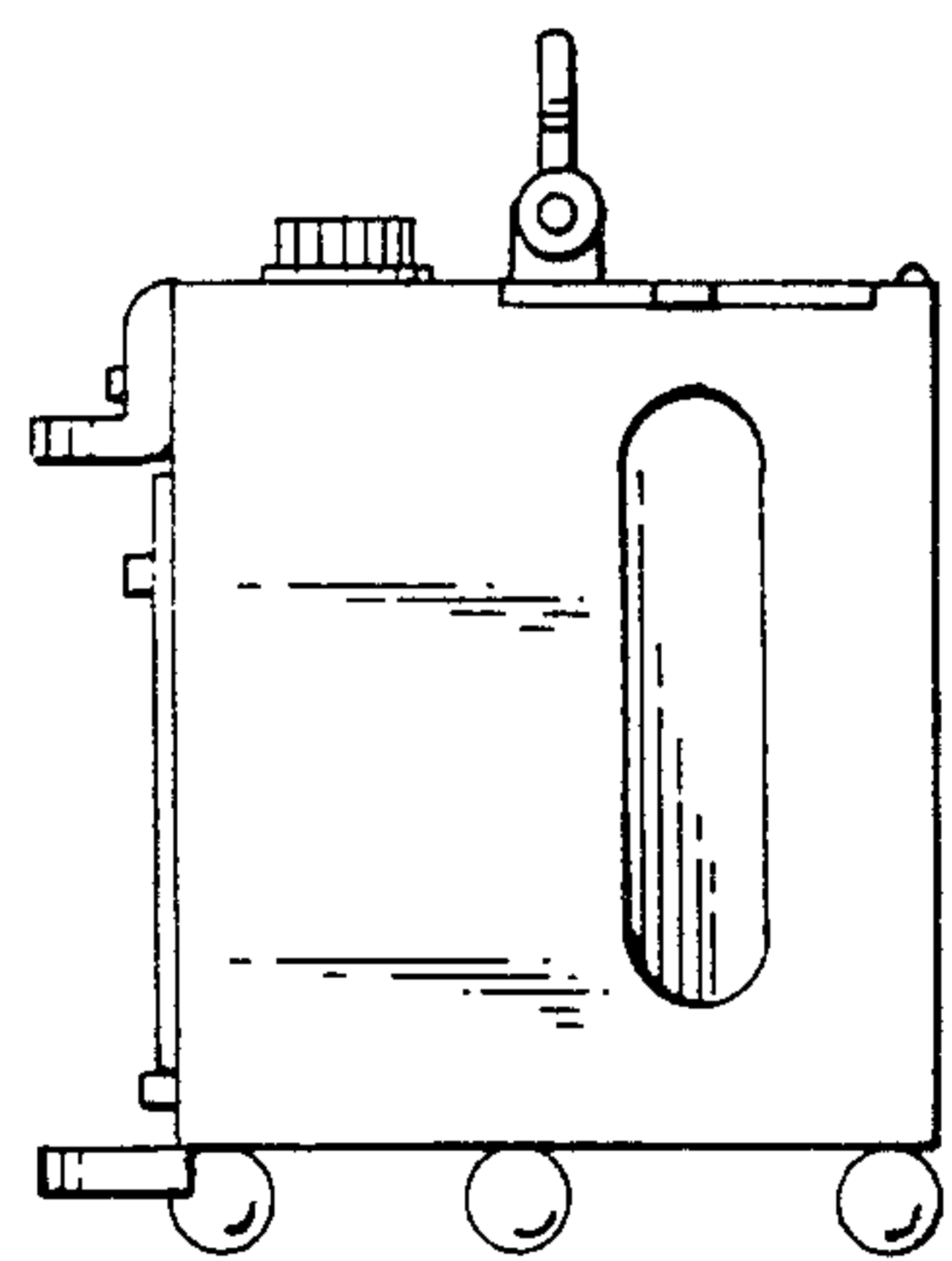

Fig. 4

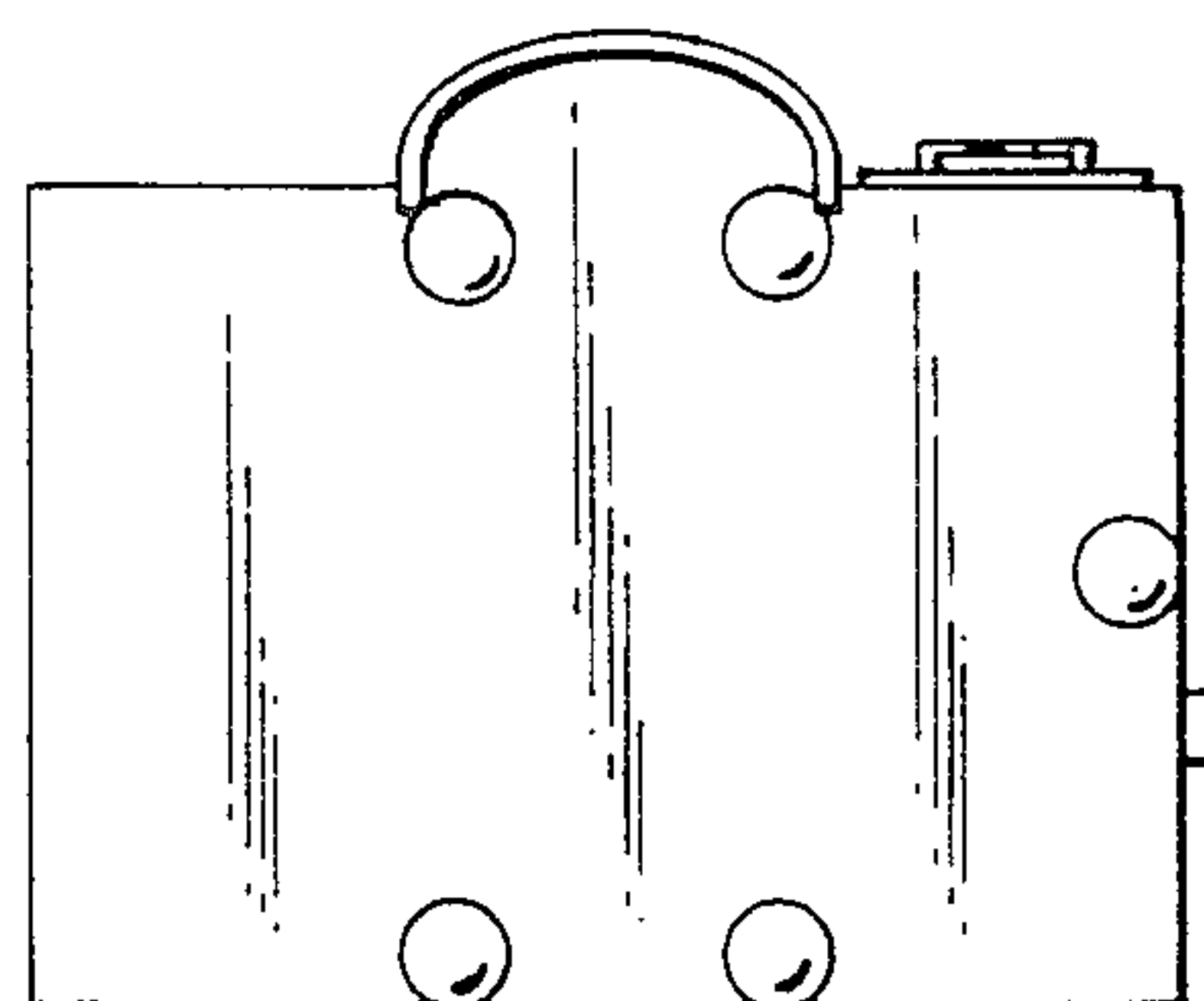

Fig. 5

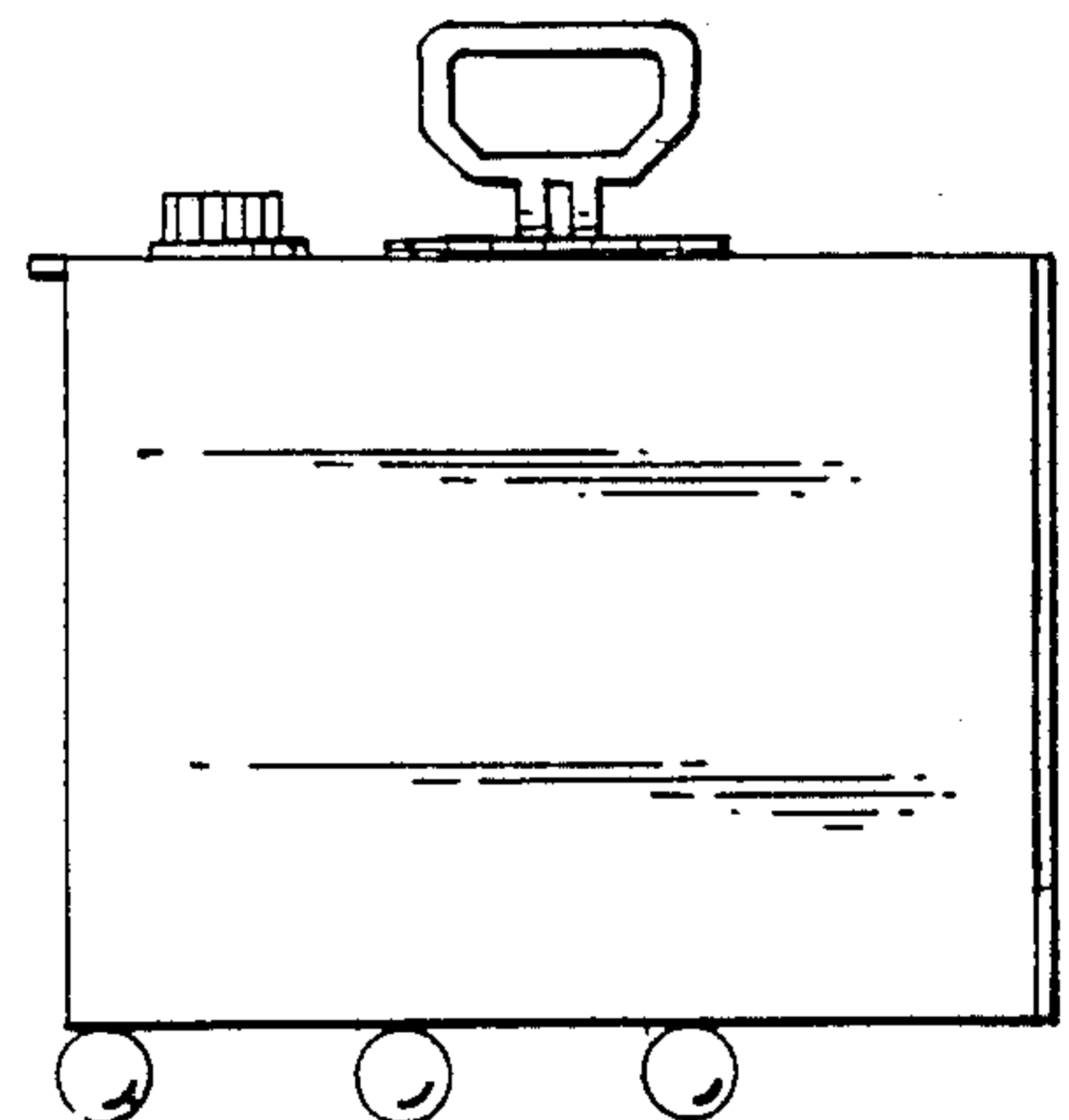

Fig. 6