

[54] BODY OF EXCAVATOR

[75] Inventors: Takehiko Takamatsu, Yokohama; Kazuo Kurihara, Tokyo, both of Japan

[73] Assignee: Kabushiki Kaisha Komatsu Seisakusho, Tokyo, Japan

[**] Term: 14 Years

[21] Appl. No.: 669,987

[22] Filed: Nov. 9, 1984

[52] U.S. Cl. D15/30

[58] Field of Search D15/10, 22, 23, 26, D15/28, 30, 31, 33; 180/189.1, 189.2; 296/190

[56] References Cited

U.S. PATENT DOCUMENTS

- D. 234,794 4/1975 Kennicutt D15/30
- D. 238,807 2/1976 Garie D15/30

- D. 272,071 1/1984 Baconet et al. D15/30
- 3,860,083 1/1975 Yancey 296/190
- 3,869,018 3/1975 Muller 296/190

Primary Examiner—B. J. Bullock
Assistant Examiner—Suzanne N. Gitlin
Attorney, Agent, or Firm—Armstrong, Nikaido Marmelstein & Kubovcik

[57] CLAIM

The ornamental design for the body of excavator, as shown and described.

DESCRIPTION

FIG. 1 is a front elevational view of the body of an excavator showing our new design; FIG. 2 is a right side elevational view thereof; FIG. 3 is a left side elevational view thereof; FIG. 4 is a top plan view thereof; FIG. 5 is a rear elevational view thereof; and FIG. 6 is a bottom plan view thereof.

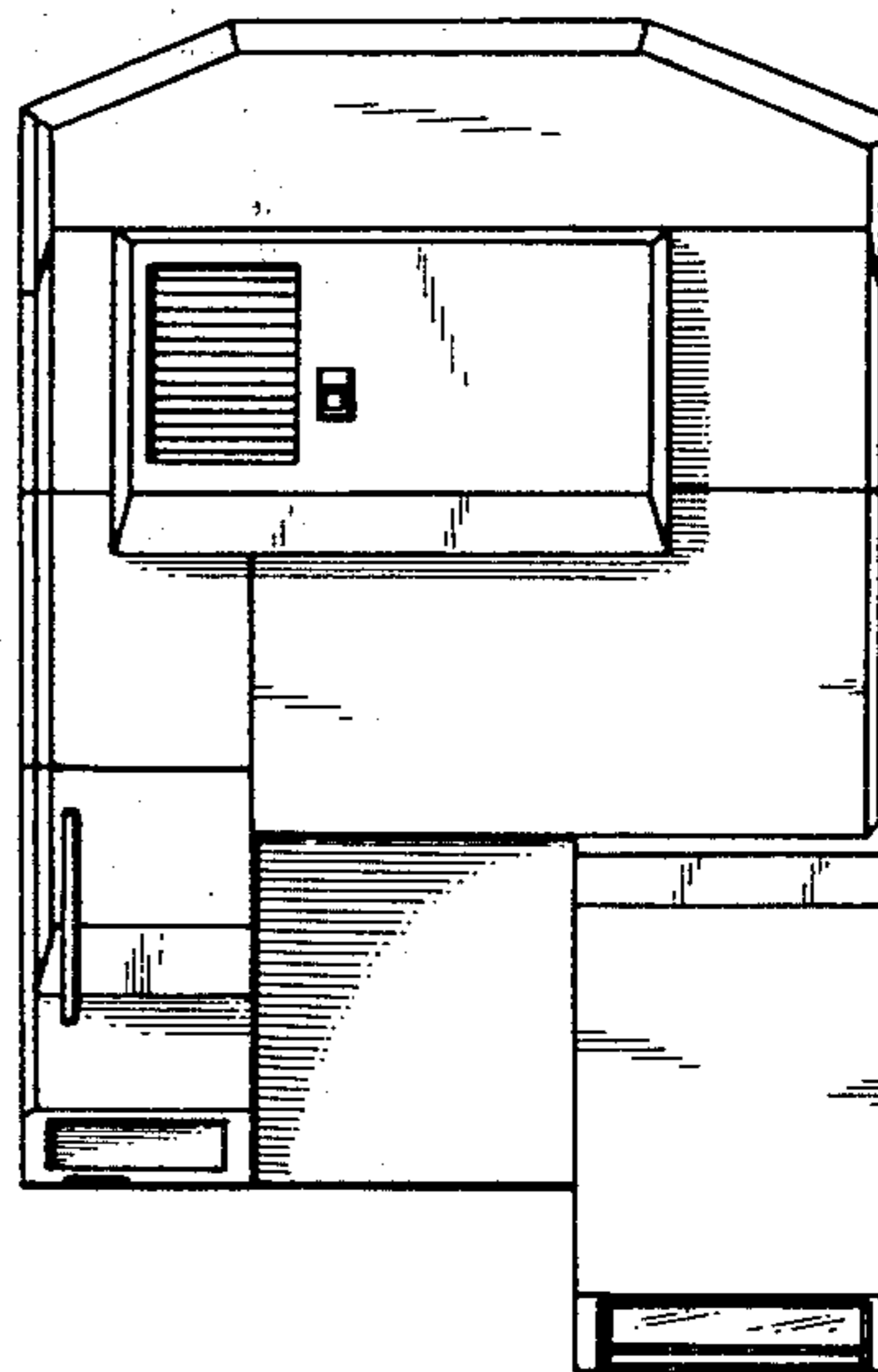
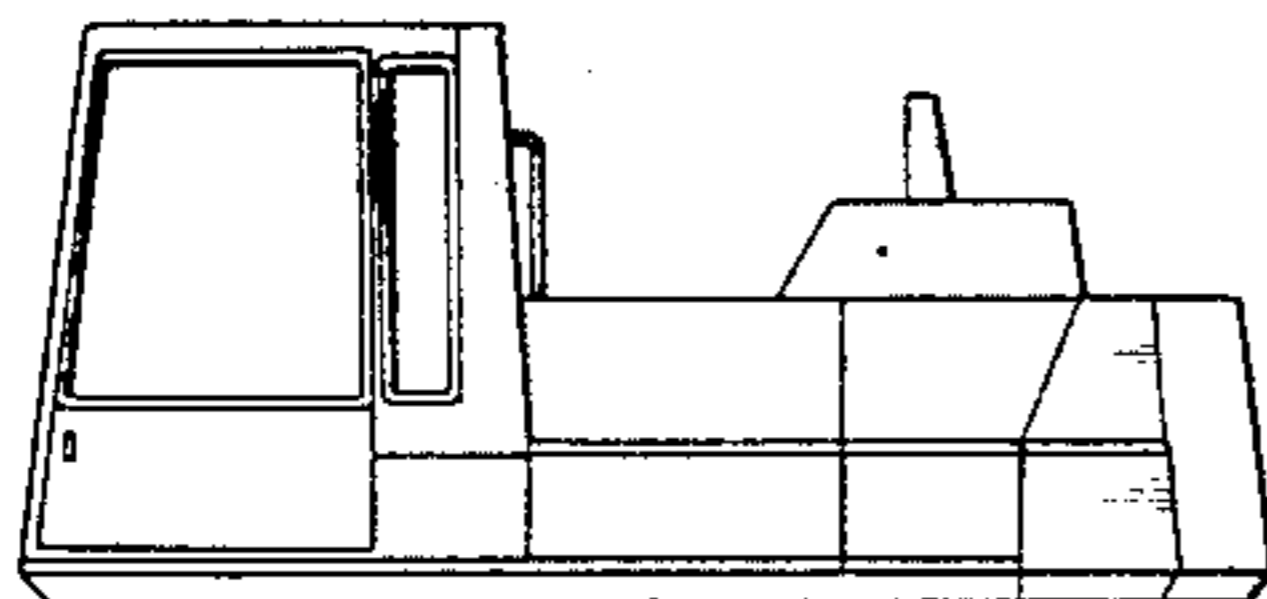
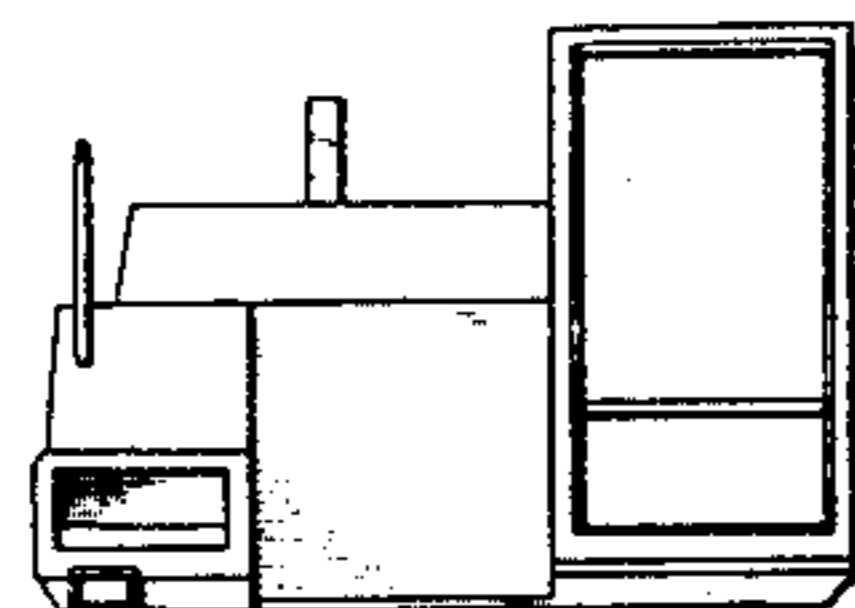

FIG. 1

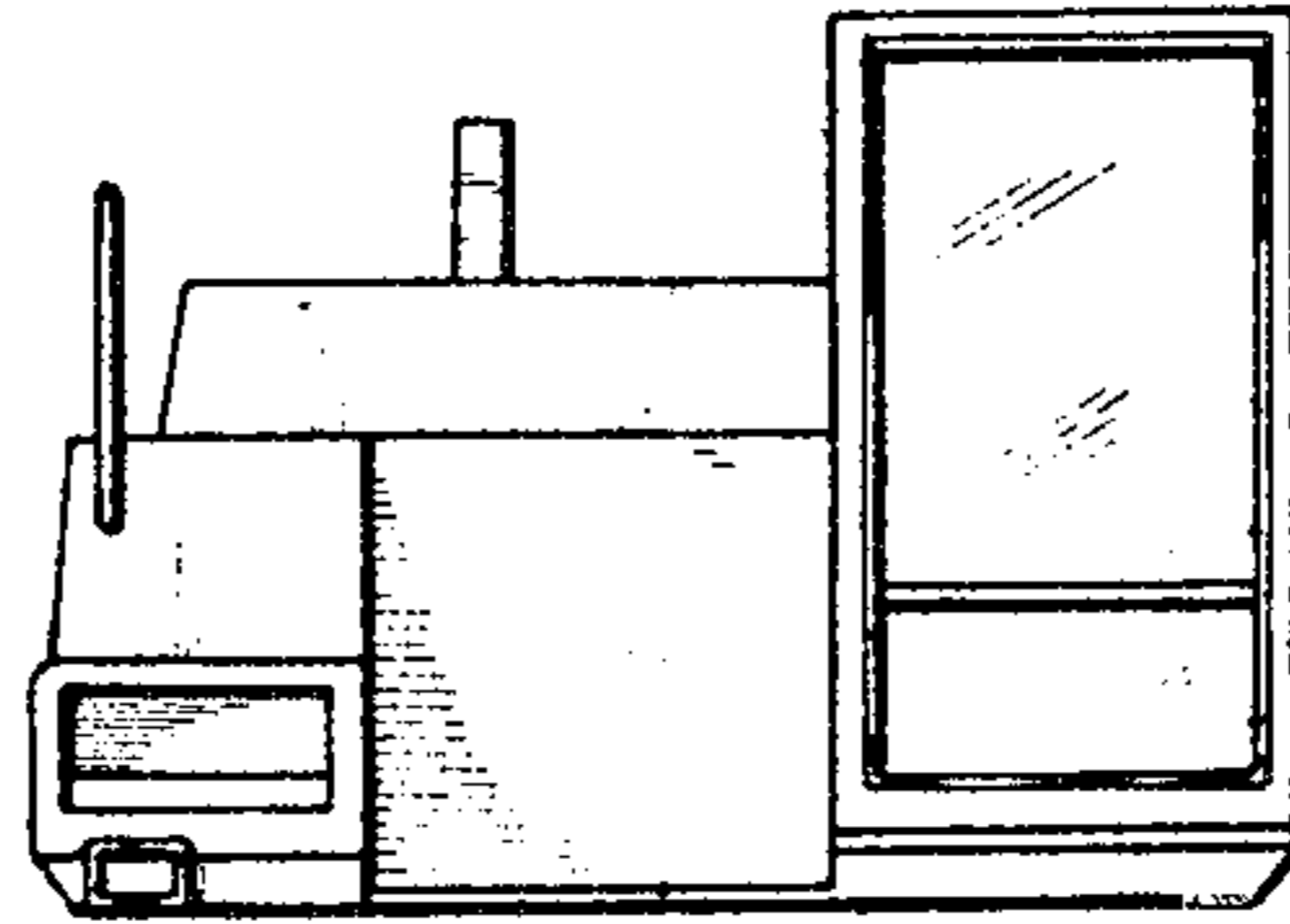

FIG. 2

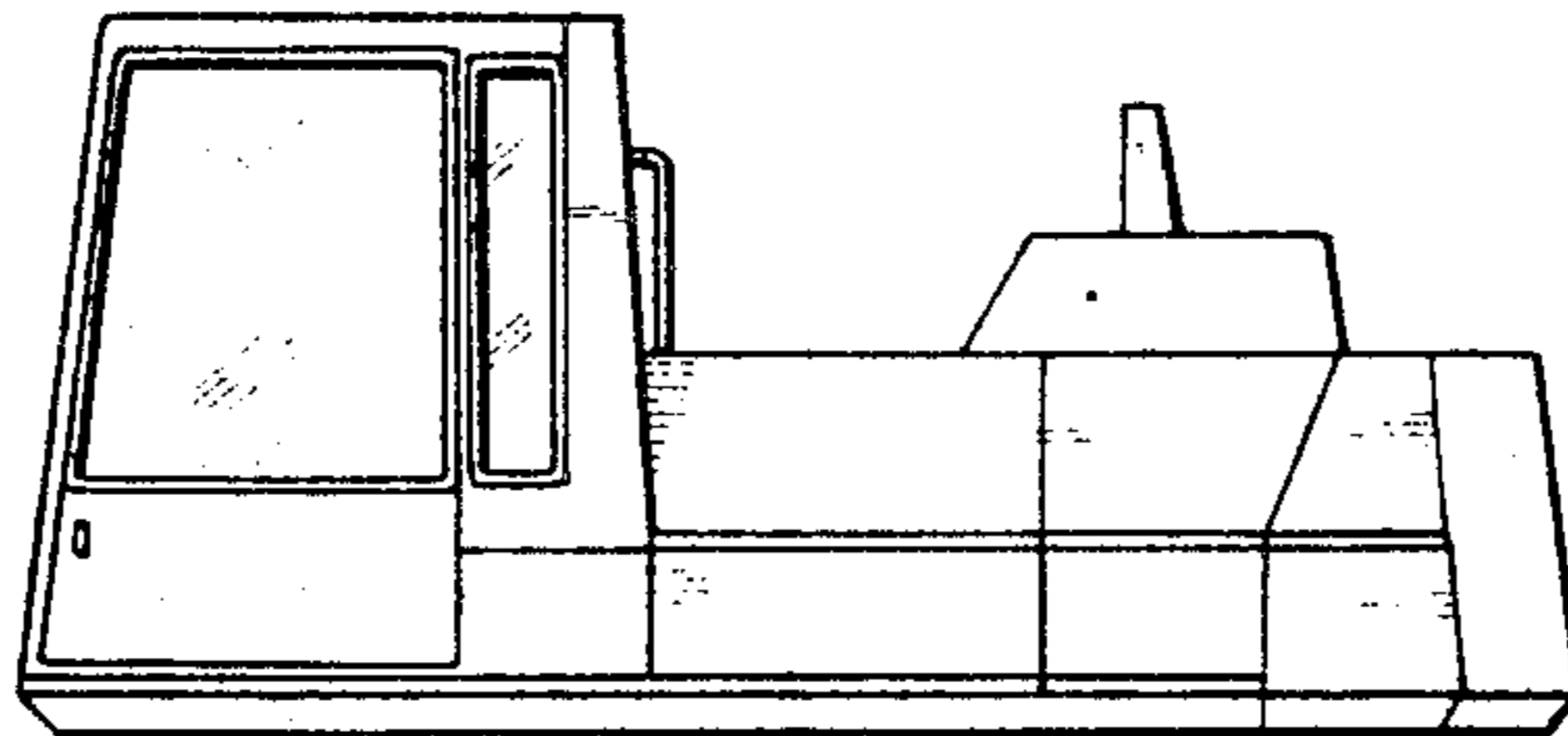

FIG. 3

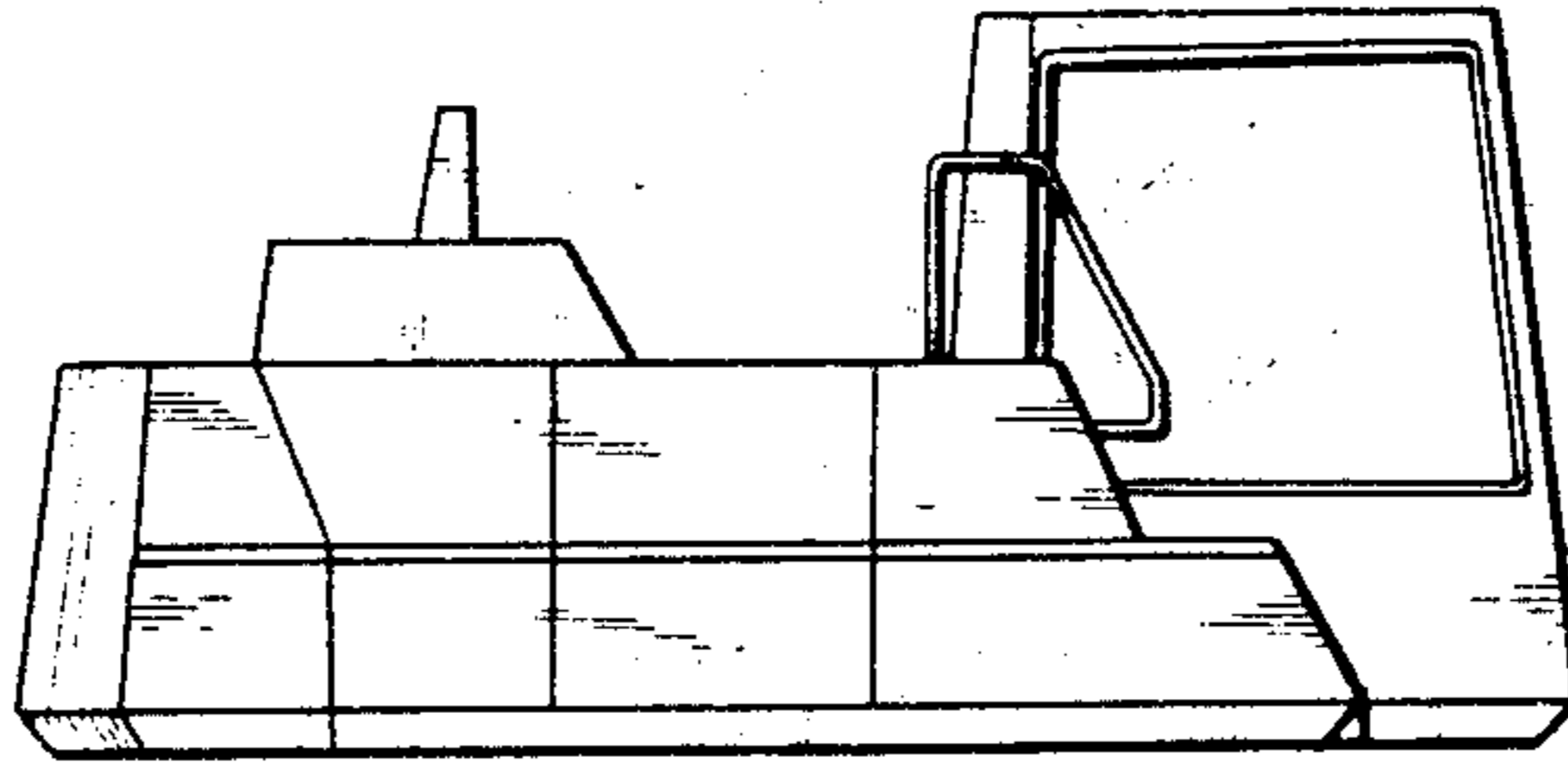

FIG. 4

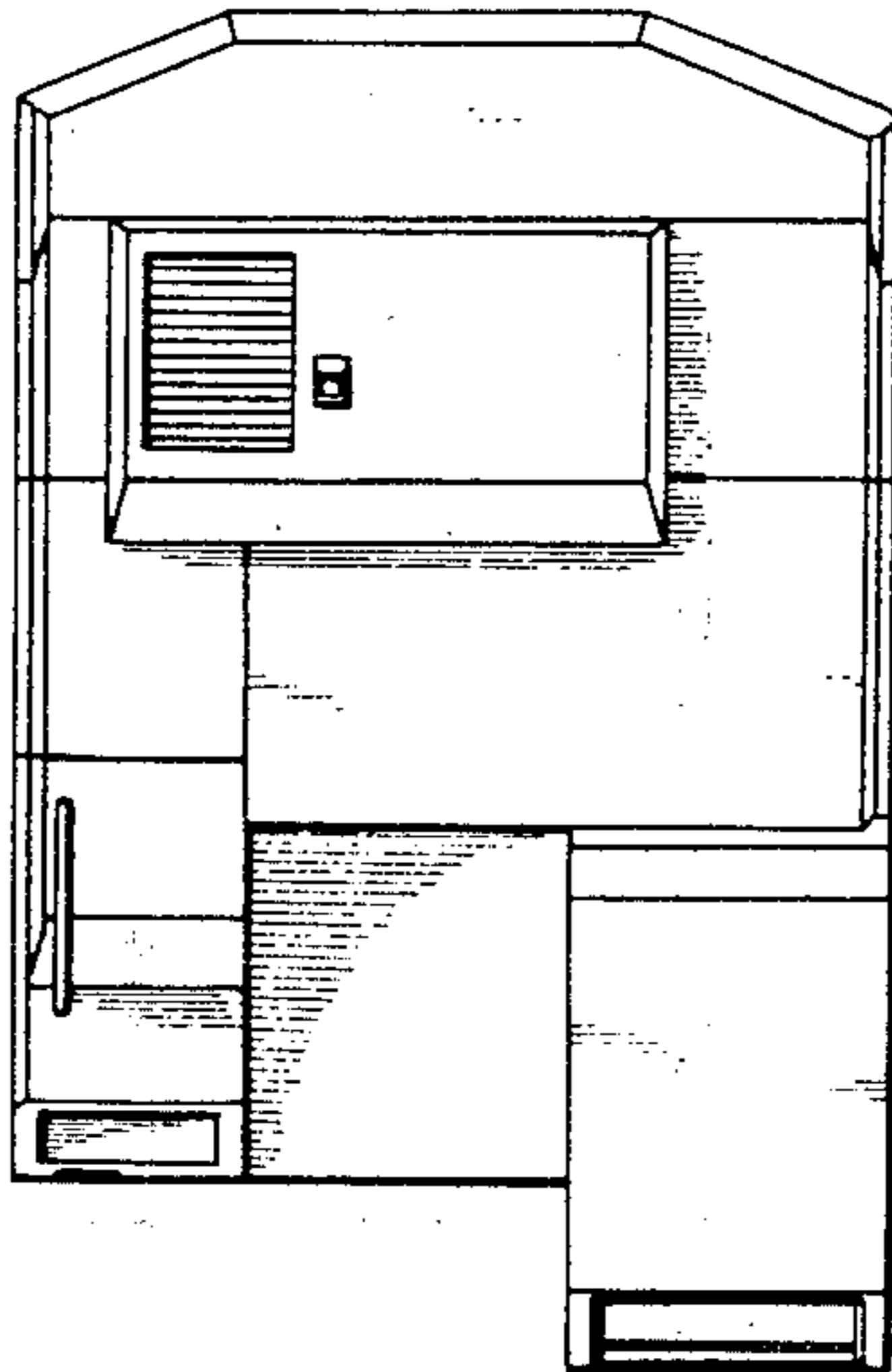

FIG. 5

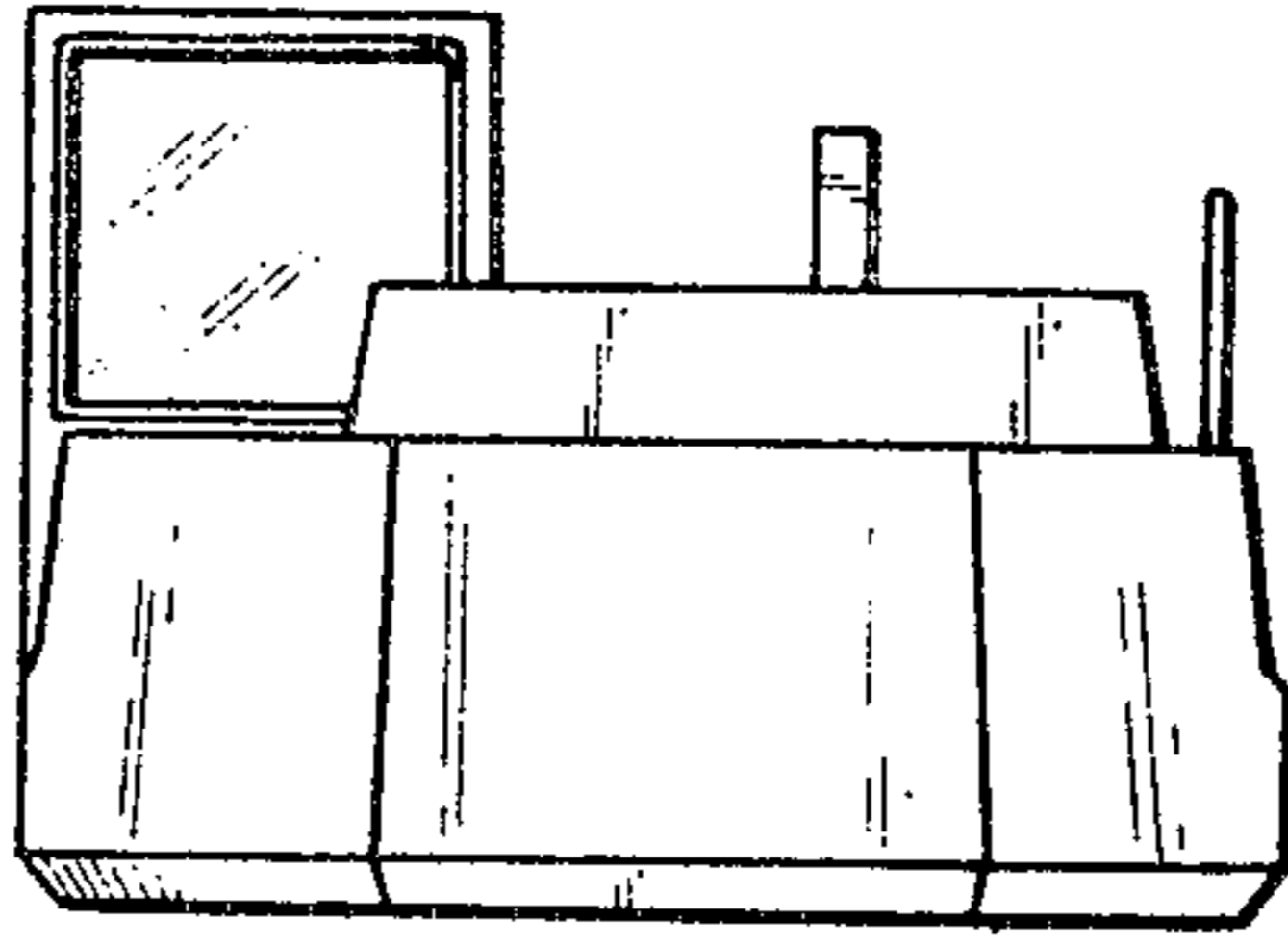

FIG. 6

