

[54] **LIGHTING FIXTURE FOR DECK  
UMBRELLA**

[76] Inventor: **Richard A. Schumann**, 1602 Buena  
Vista Dr., Huntington, W. Va. 25704

[\*\*] Term: **14 Years**

[21] Appl. No.: **478,676**

[22] Filed: **Mar. 25, 1983**

[52] U.S. Cl. .... **D26/67; D26/37;  
D26/60**

[58] Field of Search ..... **D26/37-50,  
D26/60, 67, 70; 362/157, 158, 183-208,  
410-414, 431**

[56] **References Cited**

**U.S. PATENT DOCUMENTS**

D. 206,284 11/1966 Ota ..... D26/24  
4,174,532 11/1979 Kelley ..... 362/102  
4,225,909 9/1980 Scholz et al. .... 362/414 X

*Primary Examiner*—Susan J. Lucas  
*Attorney, Agent, or Firm*—Siegmar Silber

[57] **CLAIM**

The ornamental design for a lighting fixture for deck umbrella, as shown and described.

**DESCRIPTION**

FIG. 1 is a front perspective view of a first embodiment of a lighting fixture for a deck umbrella showing my new design;

FIG. 2 is a top plan view thereof;

FIG. 3 is a front elevational view thereof;

FIG. 4 is a side elevational view thereof;

FIG. 5 is a bottom plan view thereof;

FIG. 6 is a front perspective view of a second embodiment of a lighting fixture for a deck umbrella showing my new design distinguished from the first embodiment by having a different lamp socket arrangement;

FIG. 7 is a front elevational view of FIG. 6 hereof; and, FIG. 8 is a bottom plan view of FIG. 6 hereof.

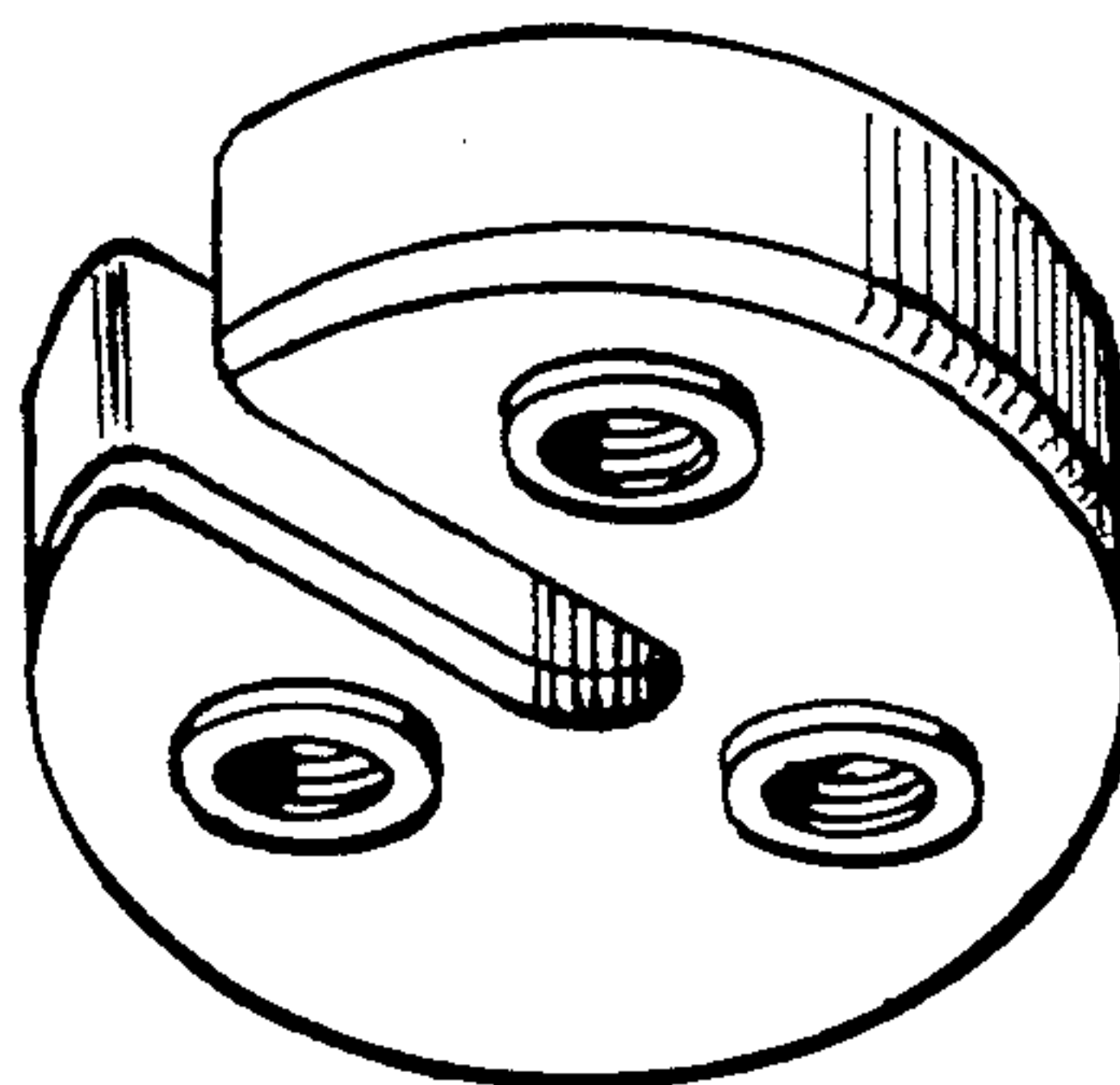

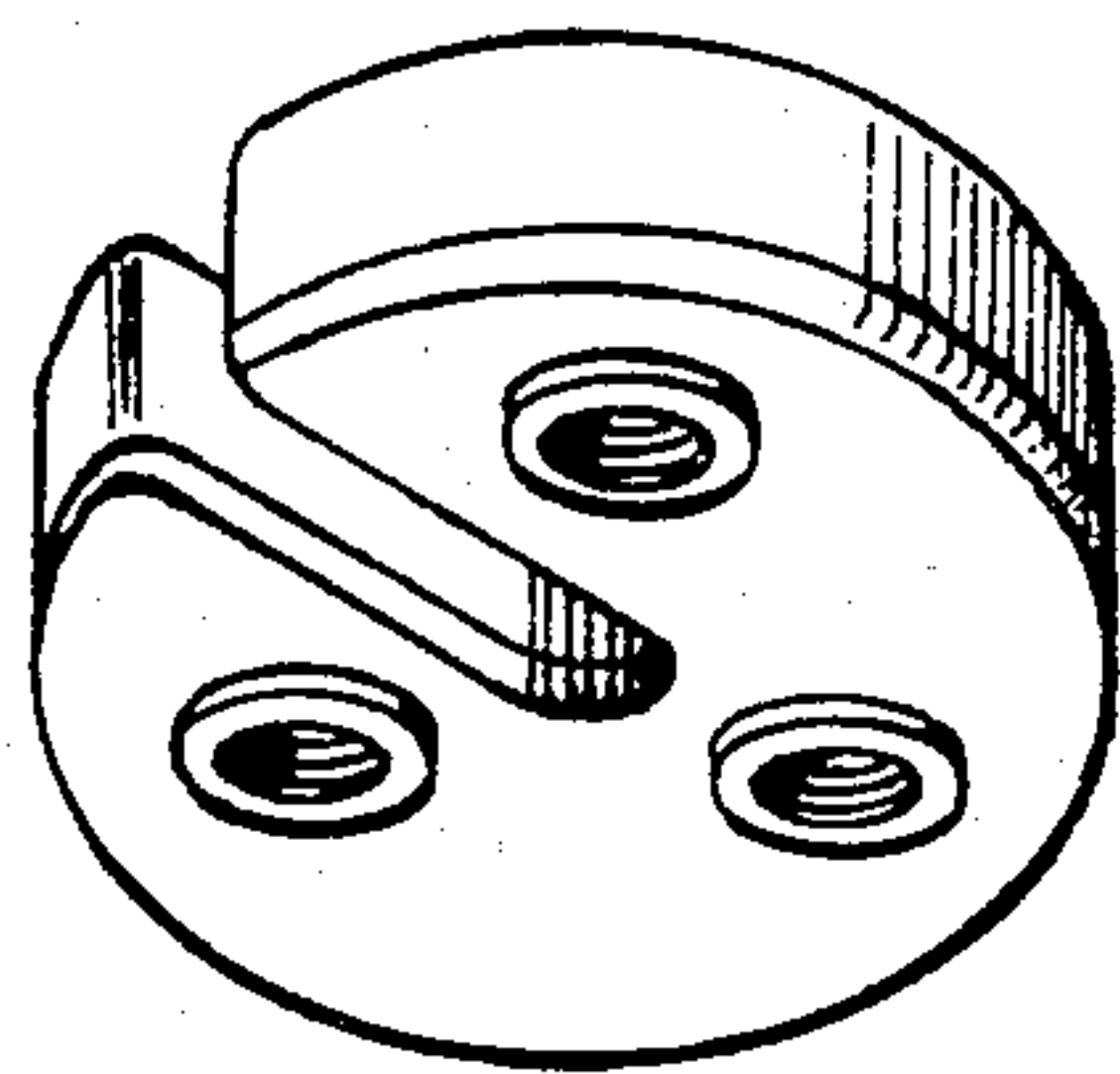

Fig. 1.

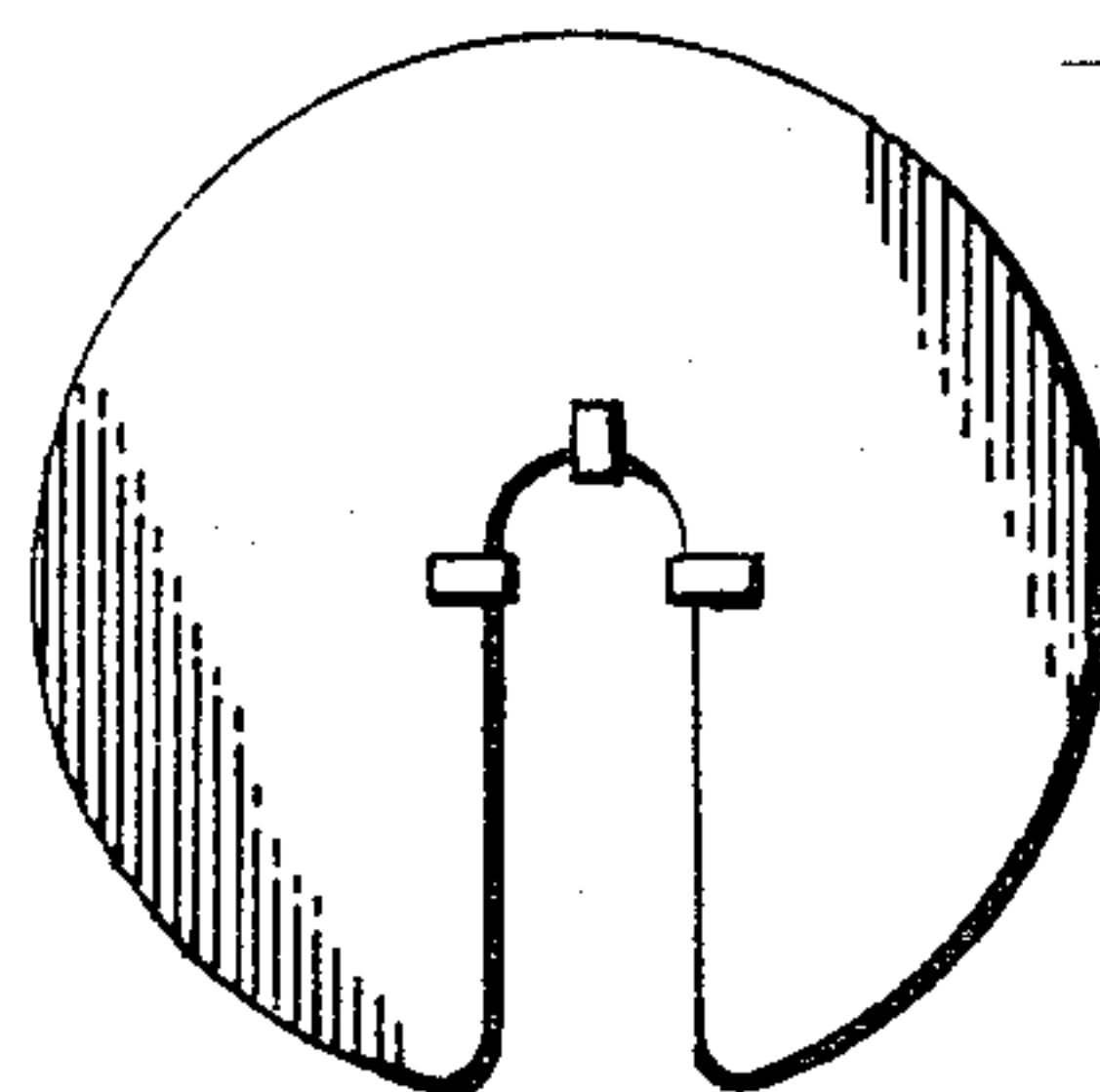

Fig. 2.



Fig. 3.

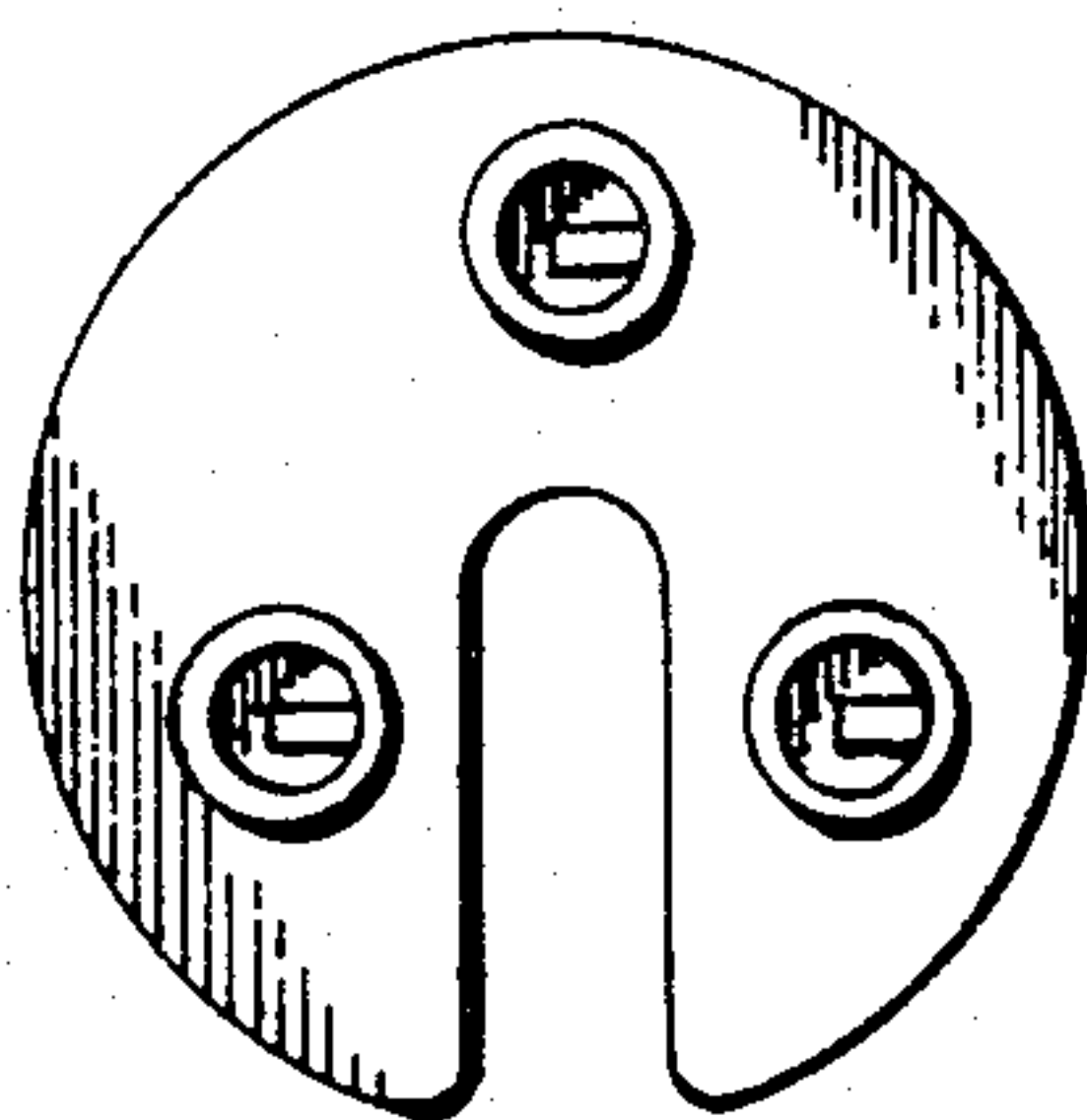

Fig. 5.

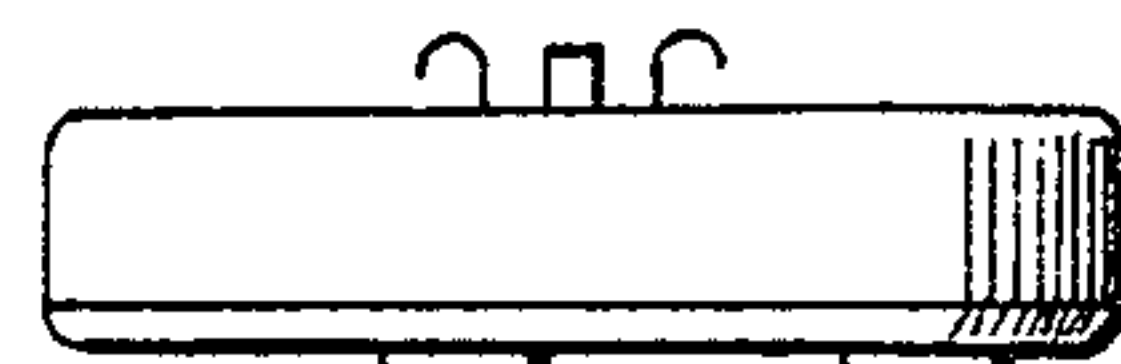

Fig. 4.

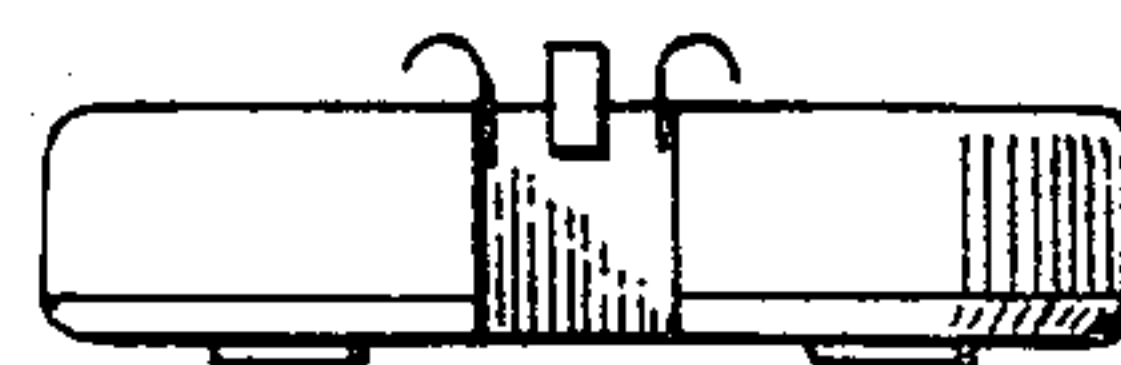

Fig. 7.

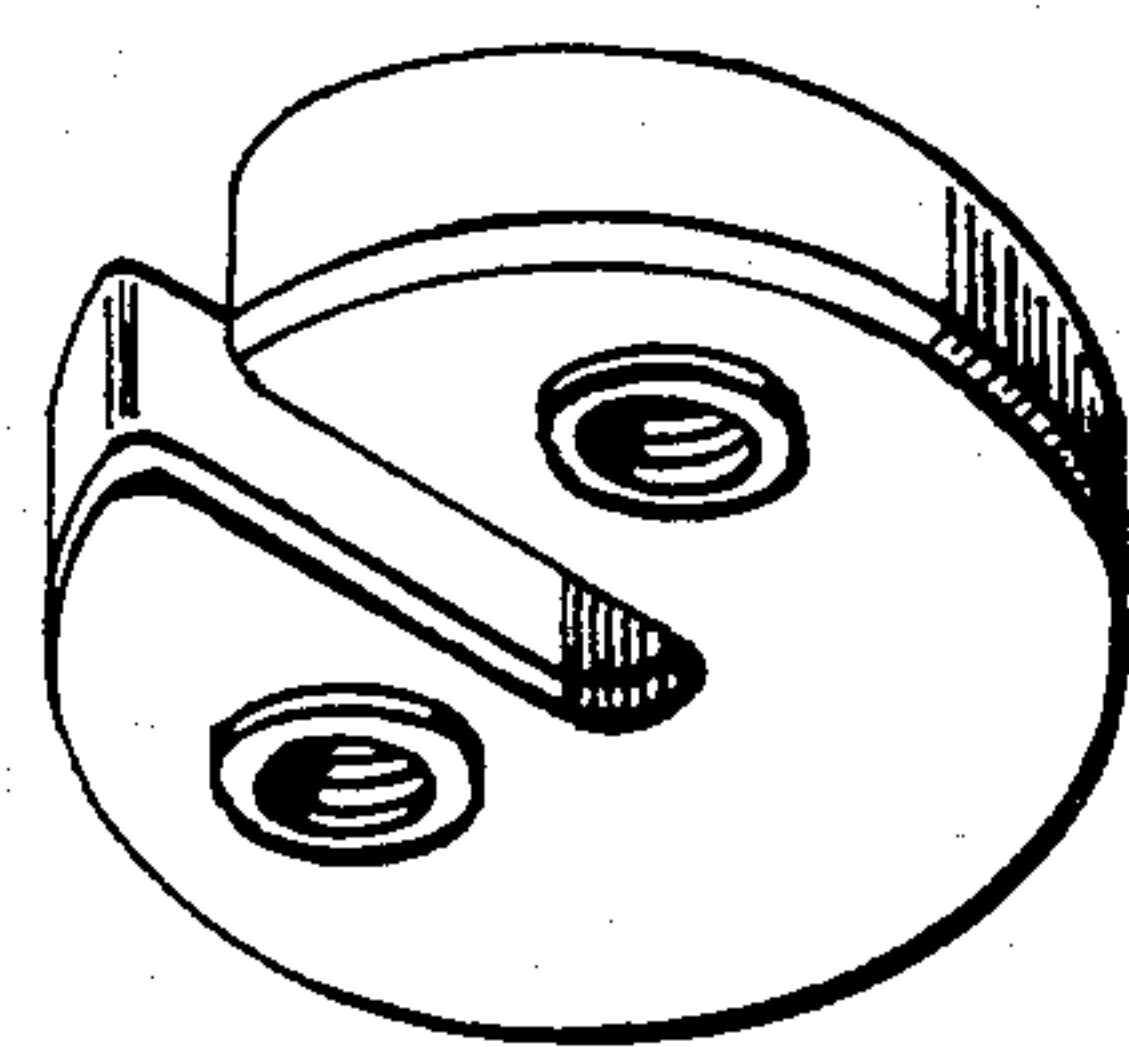

Fig. 6.

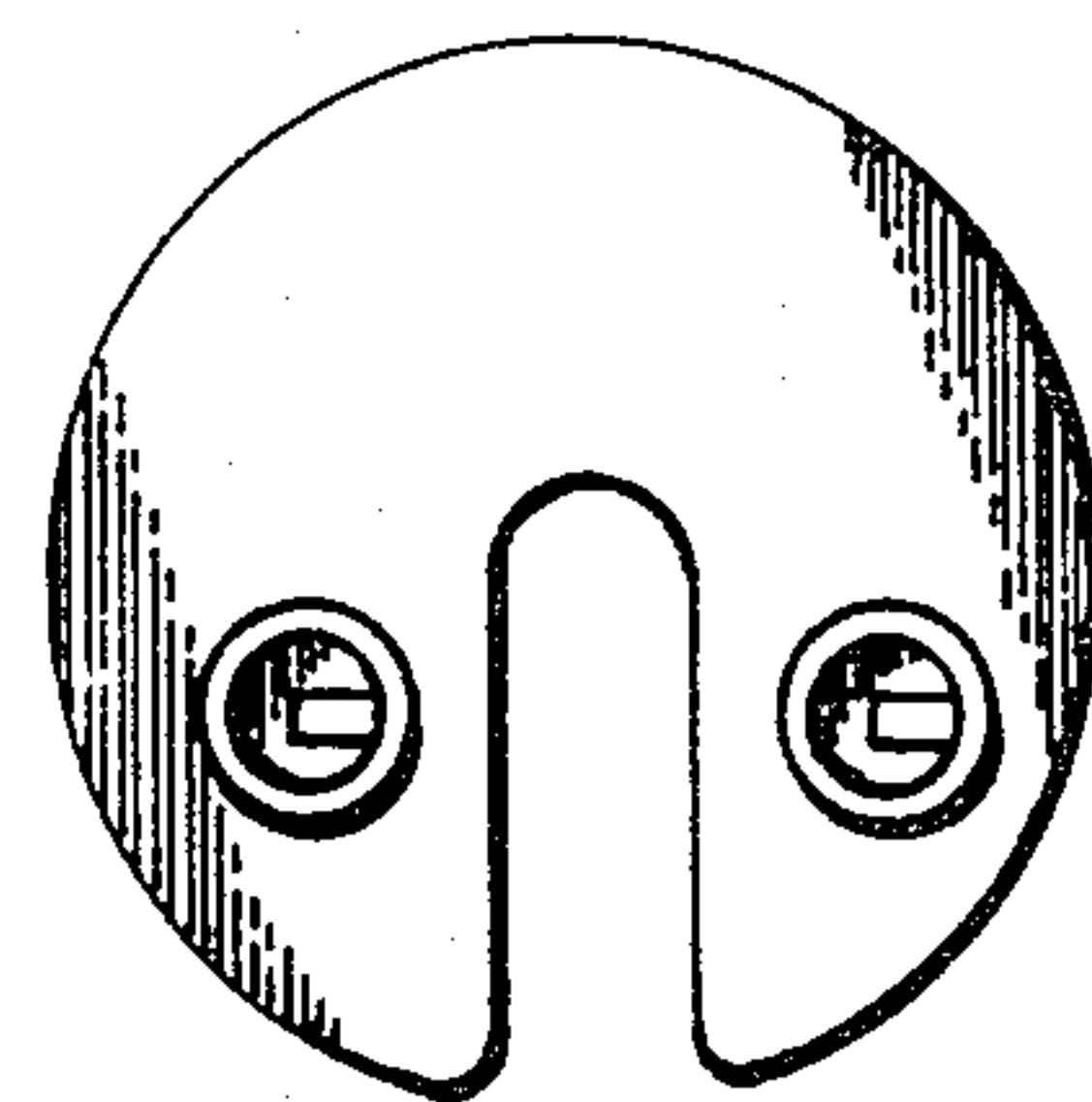

Fig. 8.