

[54] **OPERATORY MODULE SYSTEM FOR A HEALTH TREATMENT FACILITY**

[75] Inventors: **Robert Case**, Chicago, Ill.; **Joe H. Kennedy**; **Randall N. Bartlett**, both of Bay Minette, Ala.; **James D. Alsup, Jr.**, Conyers, Ga.

[73] Assignee: **Syntex (U.S.A.) Inc.**, Palo Alto, Calif.

[**] Term: **14 Years**

[21] Appl. No.: **514,915**

[22] Filed: **Jul. 18, 1983**

[52] U.S. Cl. **D24/4; D6/422; D23/59; D24/1.1**

[58] **Field of Search** **D24/1.1, 2, 4, 5, 7; D23/26, 48, 49, 59; D6/432, 436, 445, 447, 446, 448, 422-426; 433/77-79; 312/107, 198, 199, 200, 201, 203, 209, 228, 229, 237; 4/630-636, 638**

[56] **References Cited**

U.S. PATENT DOCUMENTS

D. 225,996	1/1973	Schwartz	D24/4
D. 226,483	3/1973	Schwartz	D24/4
D. 227,891	7/1973	Welsh	D23/49 X
D. 229,463	12/1973	Marshall et al.	D24/4 X
D. 240,134	6/1976	Pierson	D24/4
D. 267,340	12/1982	Watanabe	D24/4
3,250,583	5/1966	Phillips	312/209
3,455,620	7/1969	Coburn	433/77 X
3,524,256	8/1970	Barker	433/78
3,547,505	12/1970	Ott et al.	312/209
3,997,218	12/1976	Wolf et al.	312/209

FOREIGN PATENT DOCUMENTS

886999	11/1971	Canada	433/77
2439687	3/1976	Fed. Rep. of Germany	433/77
2808294	8/1978	Fed. Rep. of Germany	433/77

Primary Examiner—Catherine E. Kemper
Attorney, Agent, or Firm—Derek P. Freyberg; David A. Lowin

[57] **CLAIM**

The ornamental design for an operatory module system for a health treatment facility, as shown and described.

DESCRIPTION

FIG. 1 is a front elevational view of an operatory module system for a health treatment facility, showing our new design;
FIG. 2 is a rear elevational view thereof;
FIG. 3 is a right side elevational view thereof;
FIG. 4 is a left side elevational view thereof;
FIG. 5 is a top plan view thereof;
FIG. 6 is a front perspective view thereof;
FIG. 7 is a rear perspective view thereof;
FIG. 8 is a top plan view of a second embodiment of an operatory module system for a health treatment facility, wherein the only difference resides in the inclusion of a lighting module;
FIG. 9 is a front perspective view of a third embodiment of an operatory module system for a health treatment facility;
FIG. 10 is a top plan view thereof; and
FIG. 11 is a top plan view of a fourth embodiment of an operatory module system for a health treatment facility, which differs from the third embodiment only in the inclusion of a lighting module.

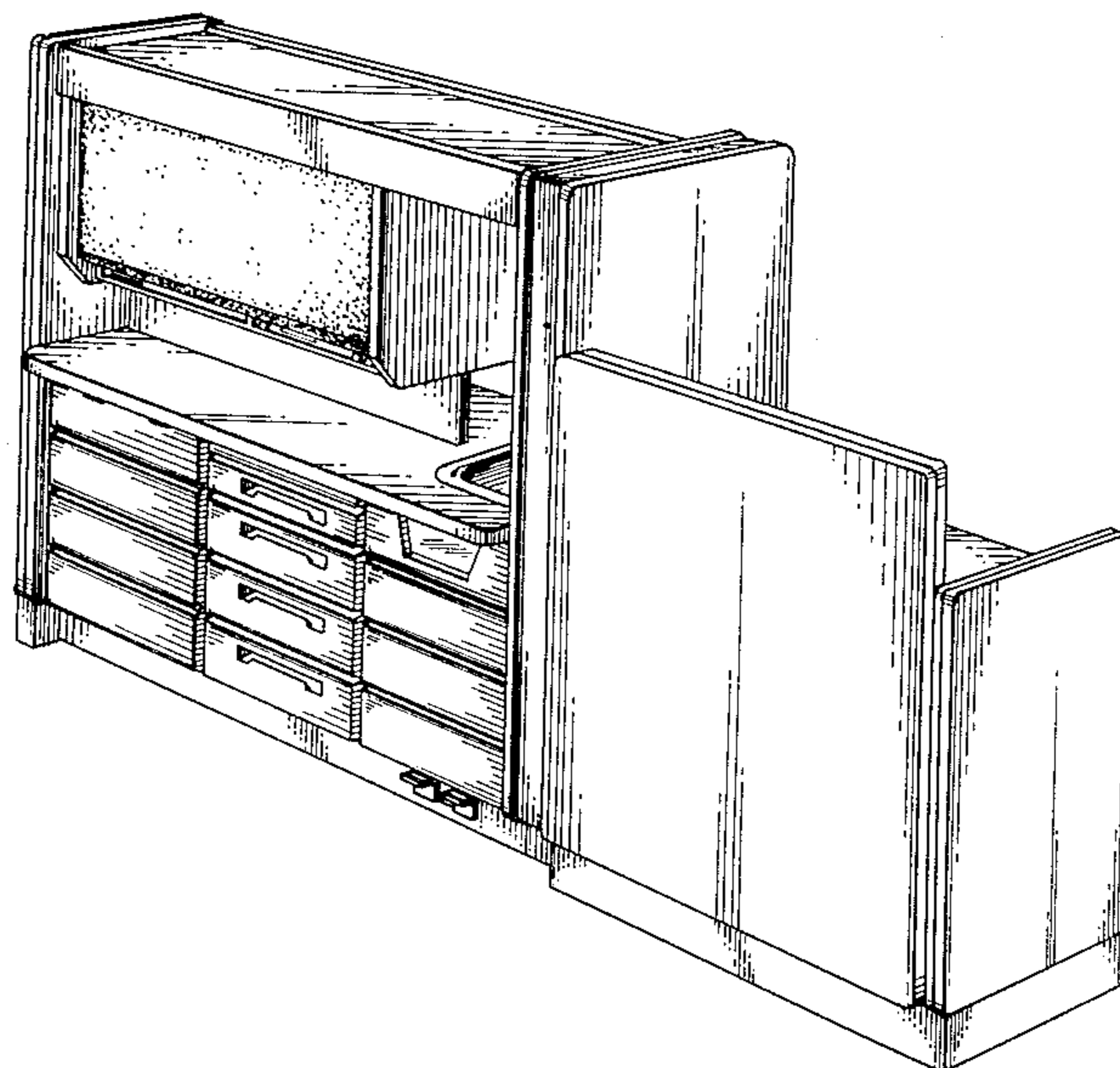

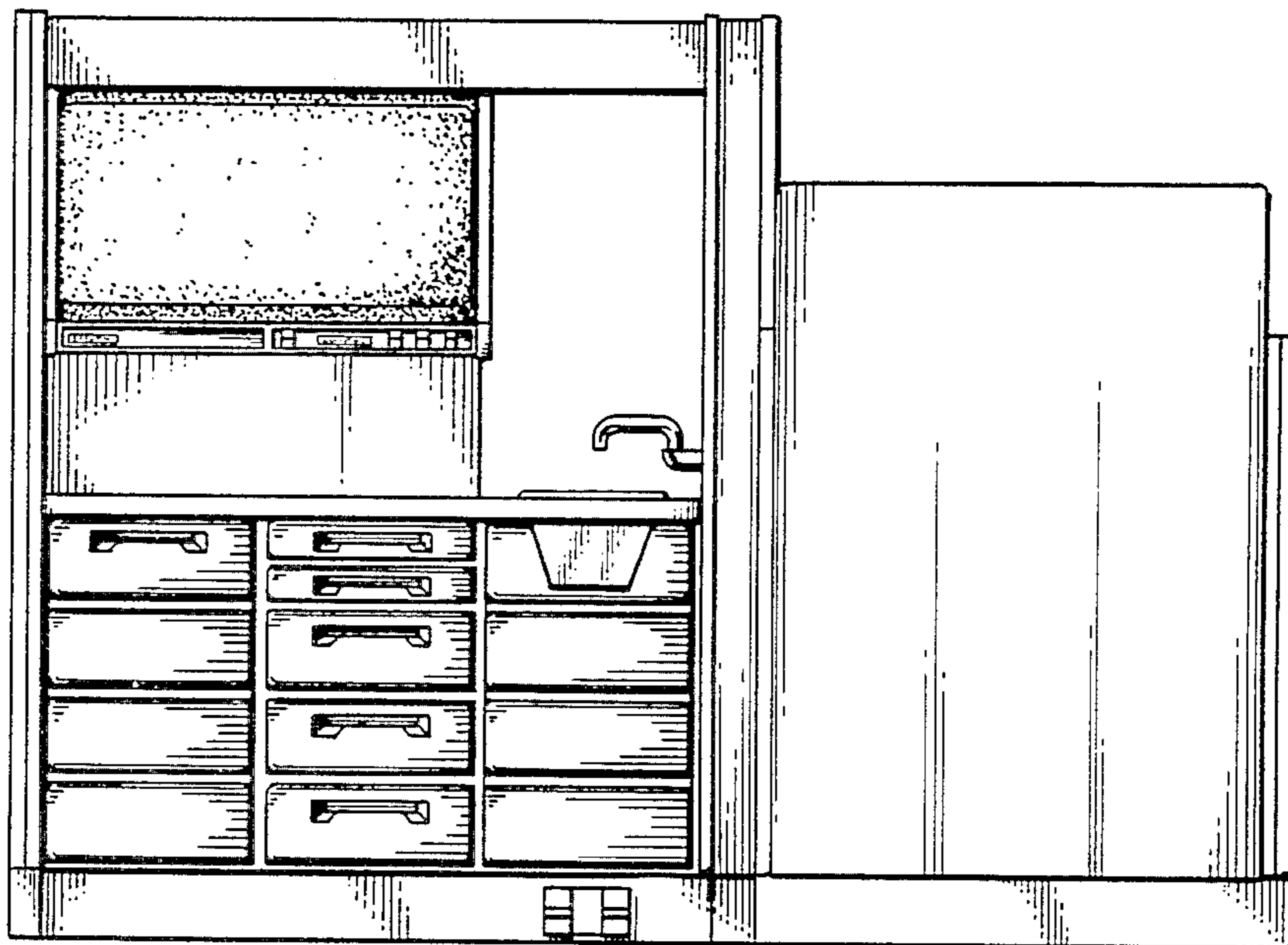

FIG. 1

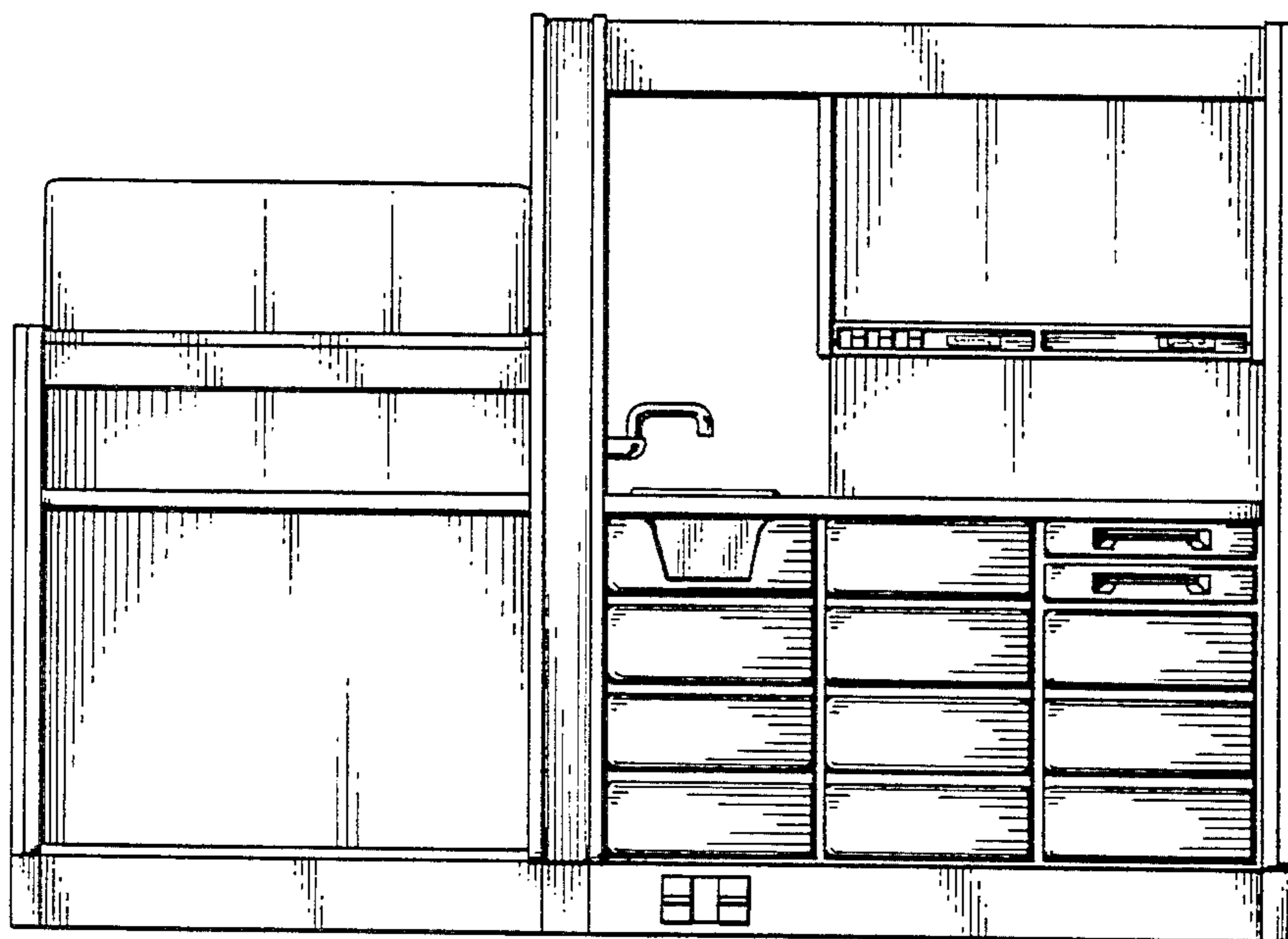

FIG. 2

FIG. 3

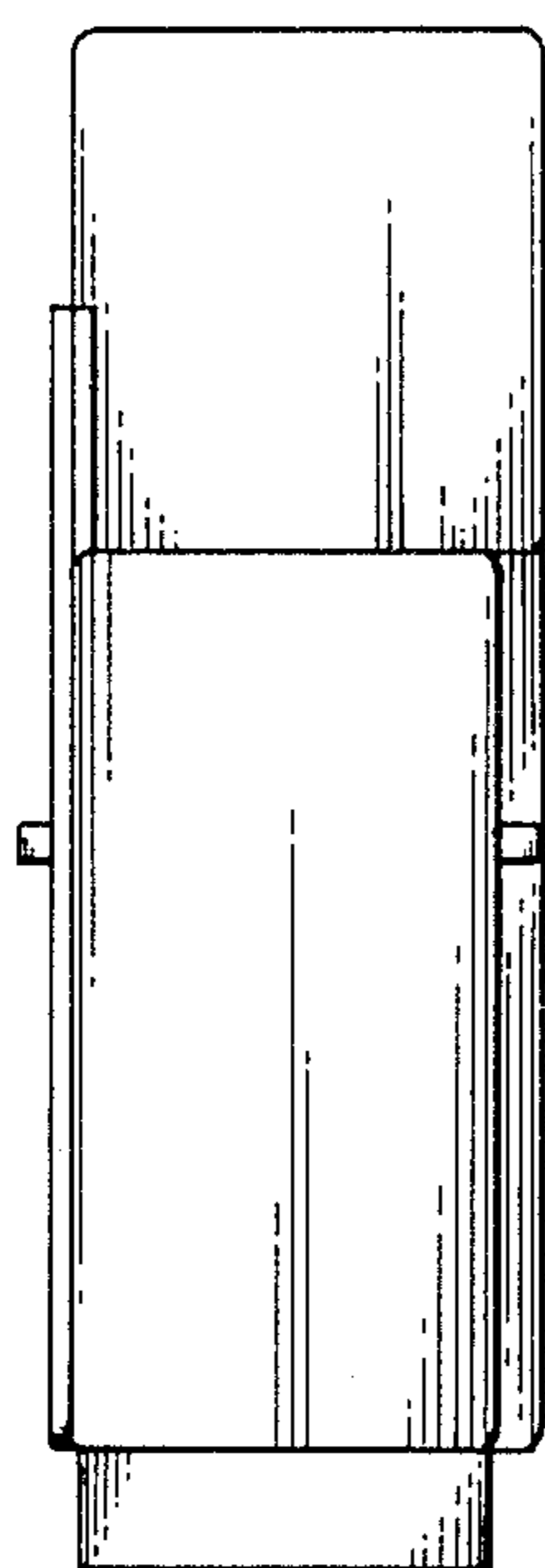

FIG. 4

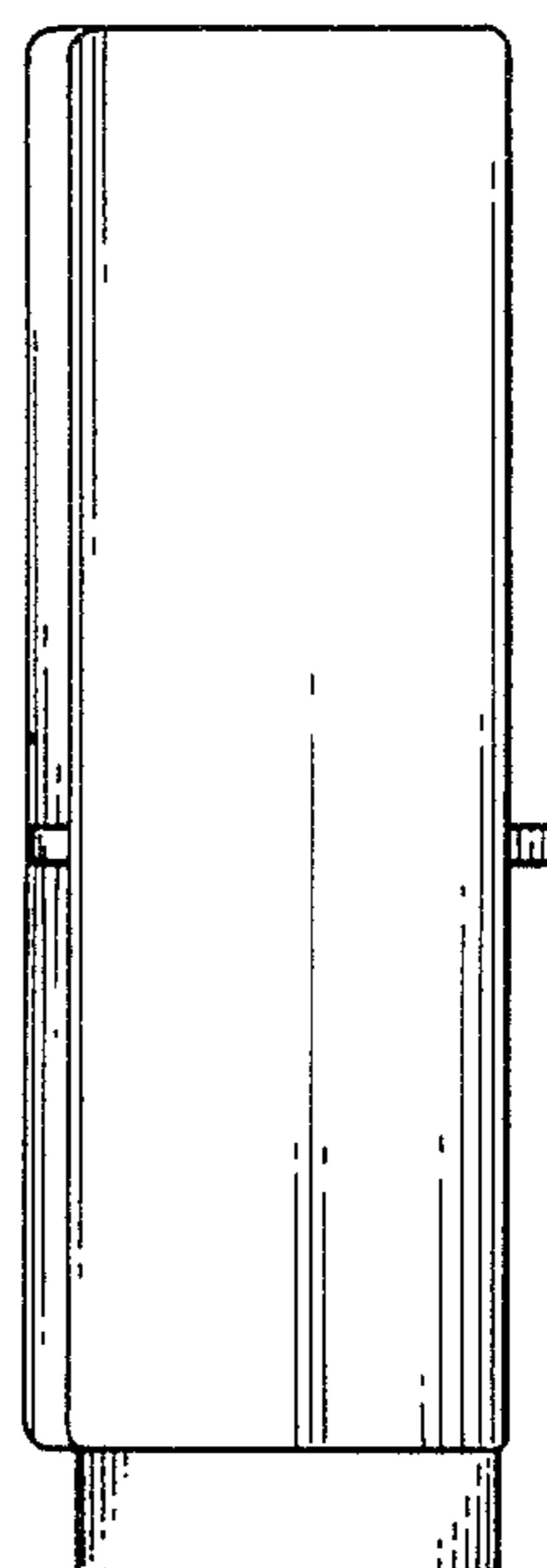

FIG. 5

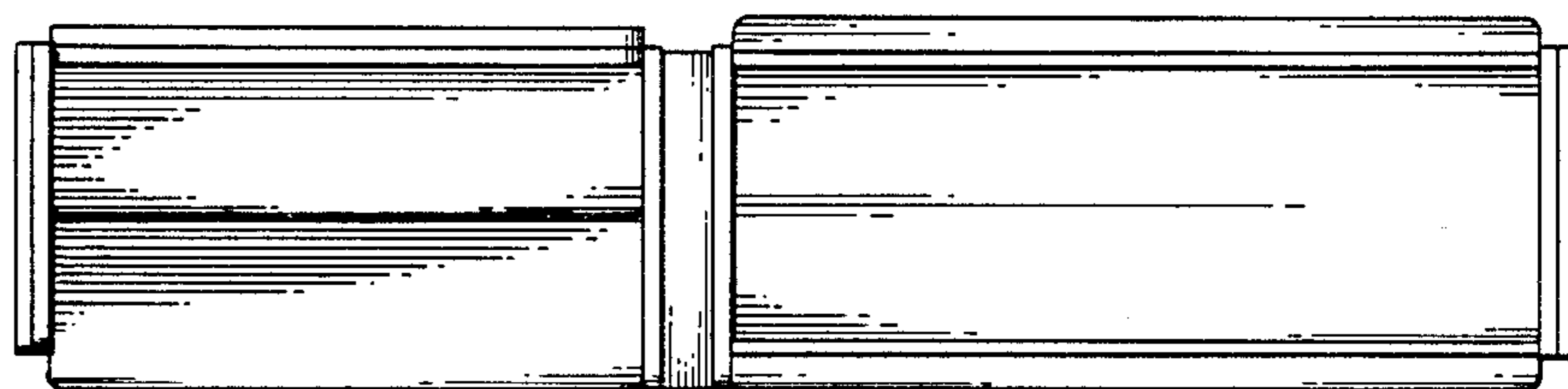
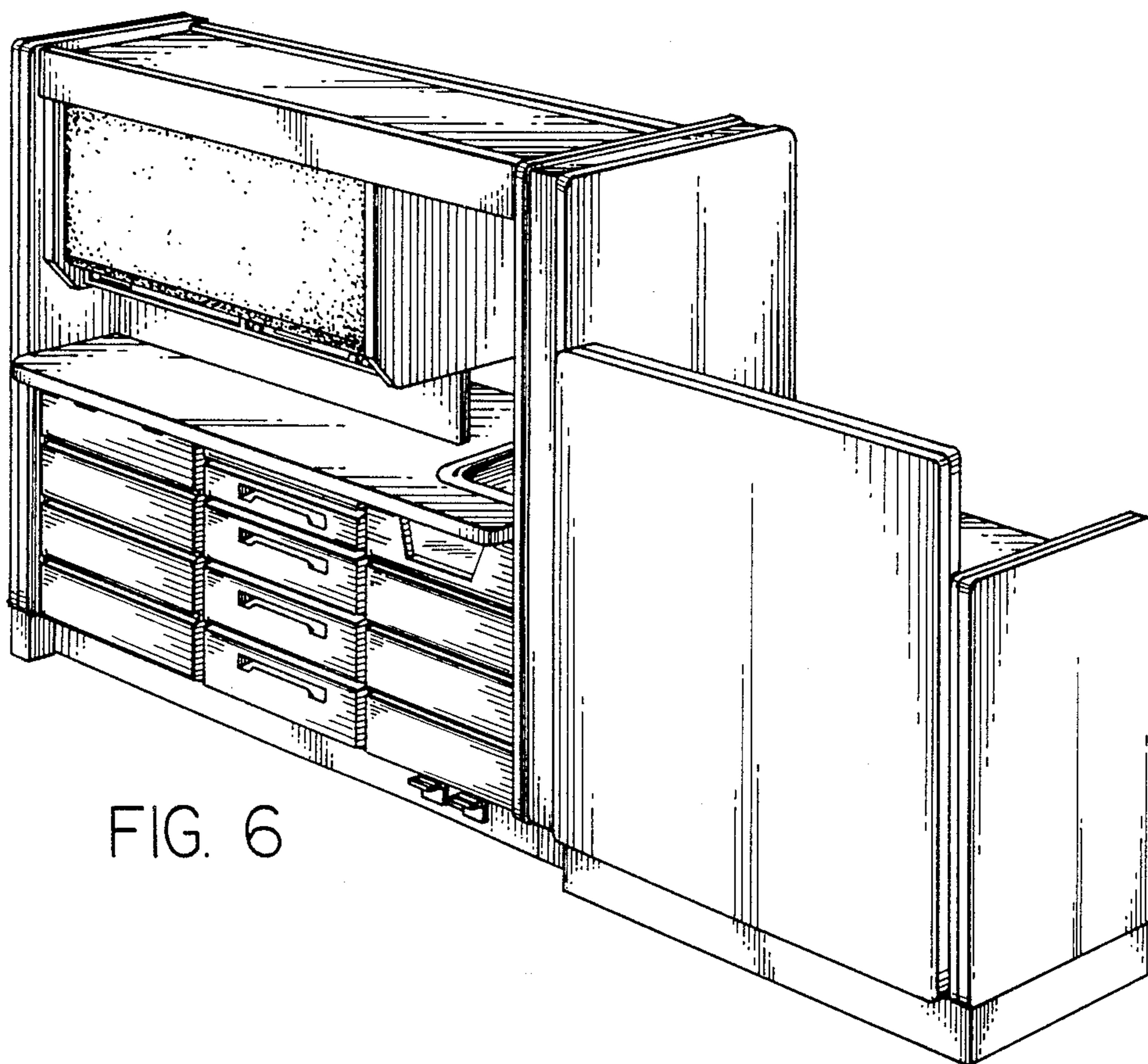

FIG. 6



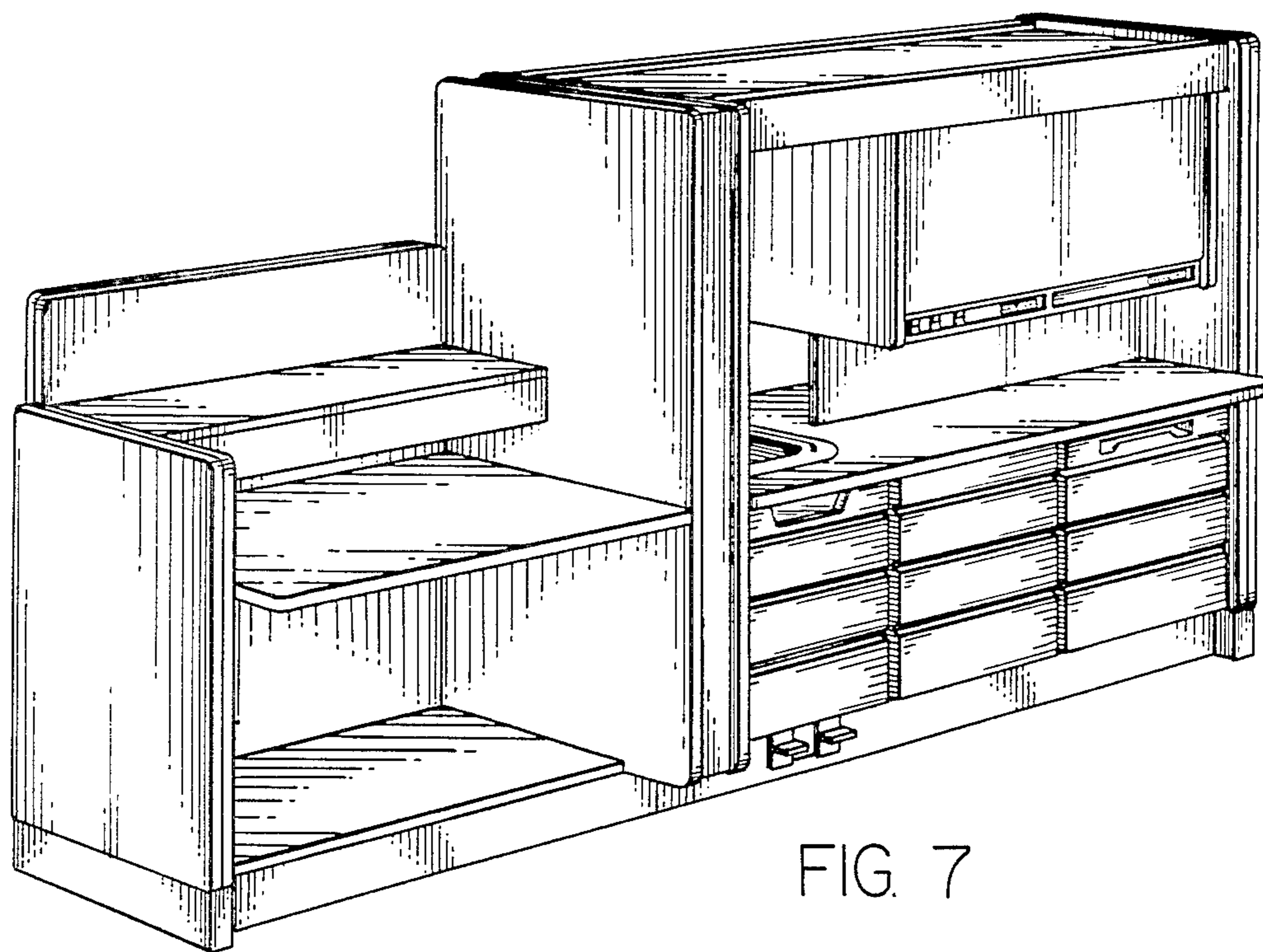

FIG. 7

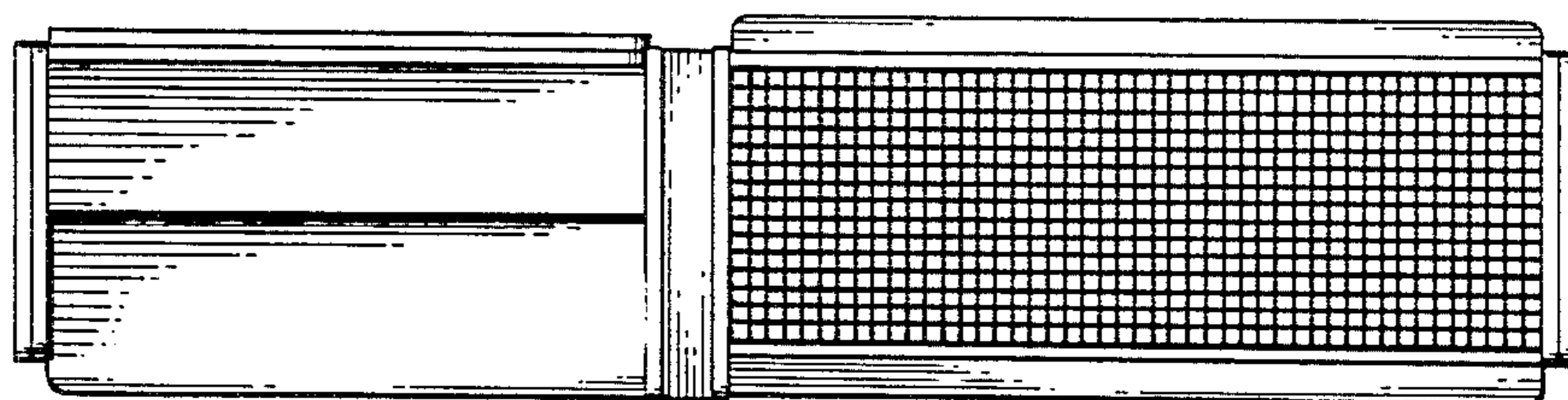

FIG. 8

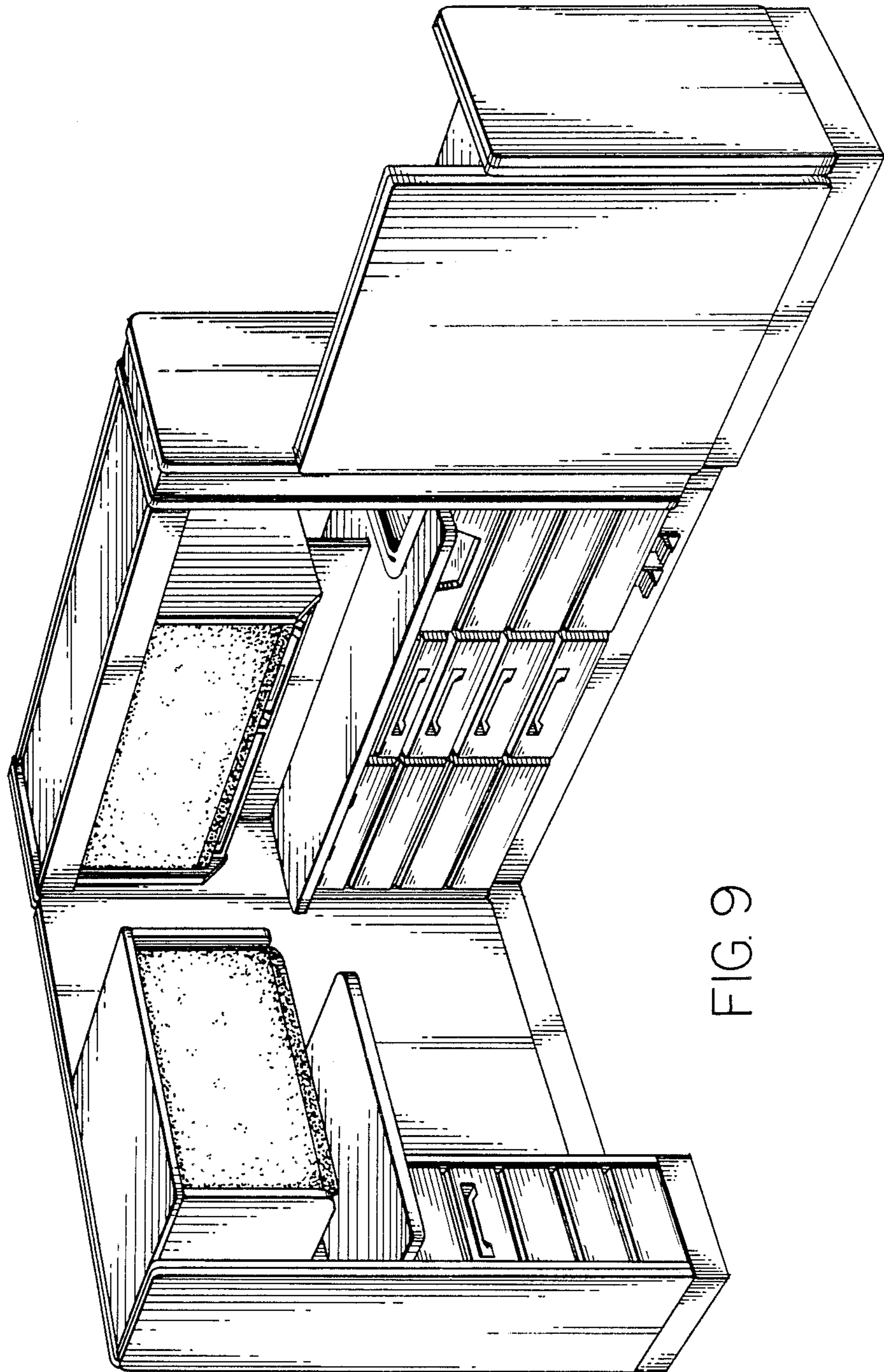

FIG. 9

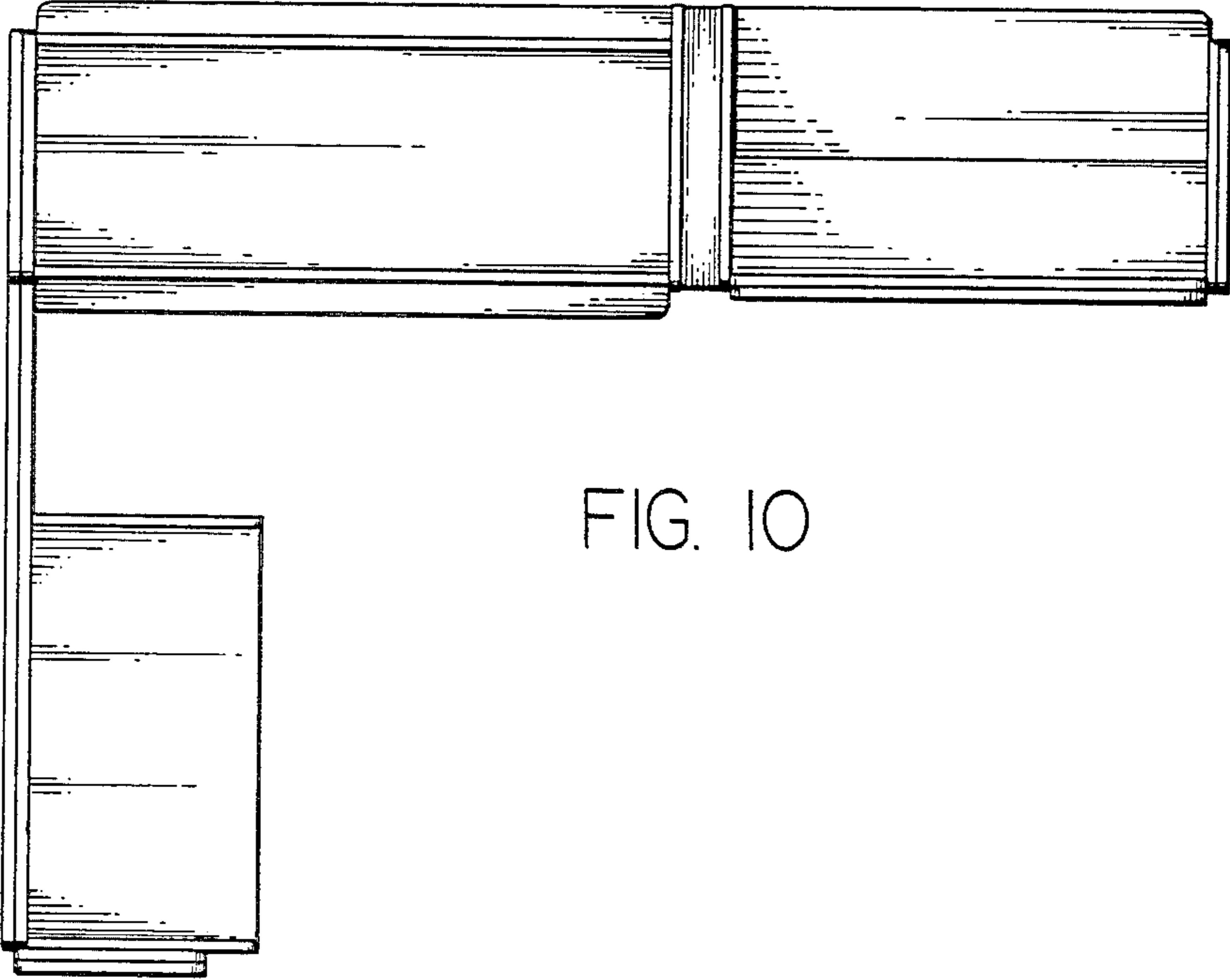

FIG. 10

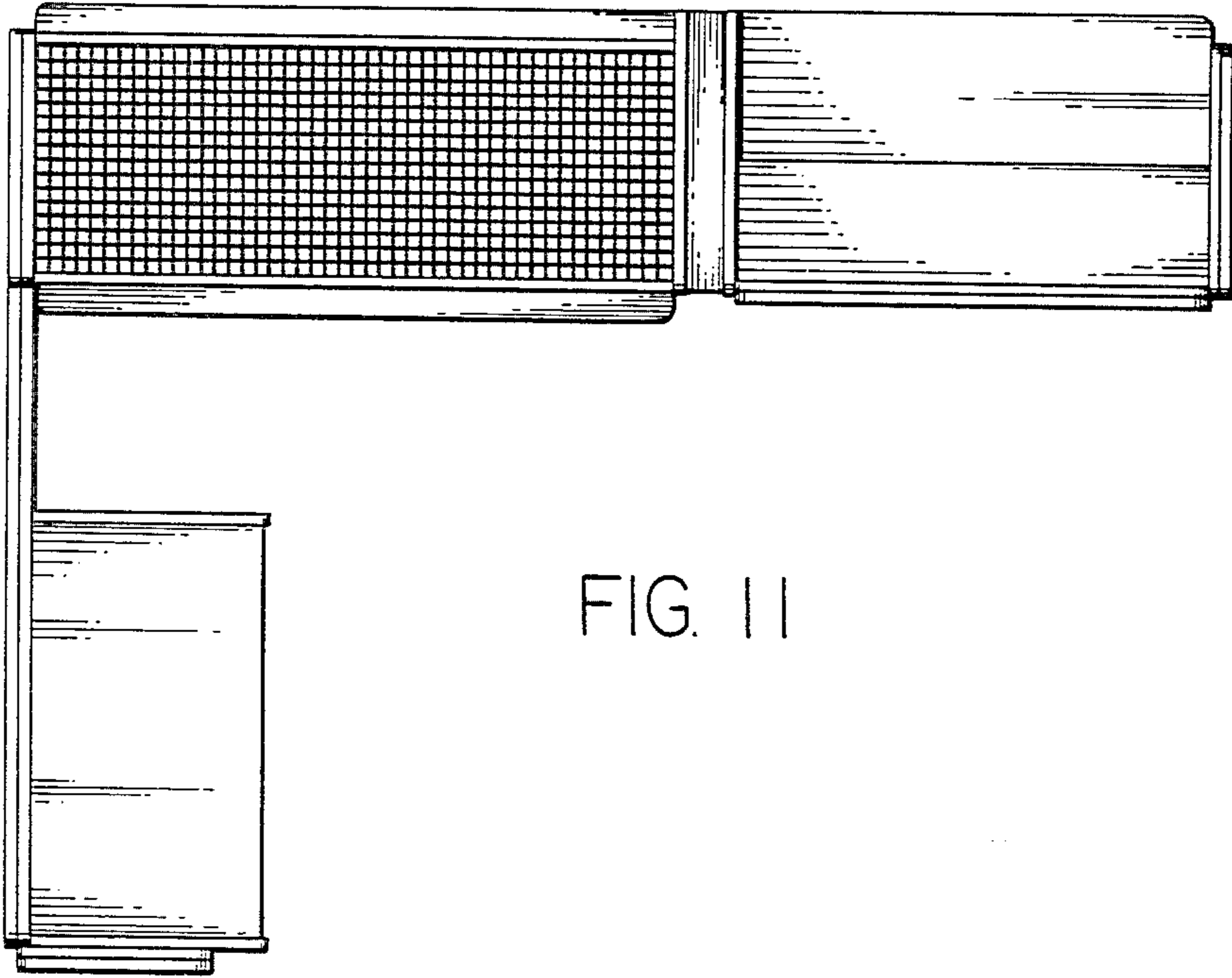

FIG. 11