

[54] INTERNAL COMBUSTION ENGINE

[75] Inventor: Tetsuo Nakamura, Saitama, Japan

[73] Assignee: Honda Giken Kogyo Kabushiki Kaisha, Tokyo, Japan

[**] Term: 14 Years

[21] Appl. No.: 478,941

[22] Filed: Mar. 25, 1983

[30] Foreign Application Priority Data

Oct. 20, 1982 [JP] Japan 57-47691

[52] U.S. Cl. D15/1

[58] Field of Search D15/1; 123/56 B, 56 BC, 123/56 BA, 41.66, 41.67, 41.7, 195 G, 195 B, 195 R, 198 E

[56] References Cited

U.S. PATENT DOCUMENTS

- D. 247,177 2/1978 Stevens D15/1
- D. 257,844 1/1981 Stevens D15/1
- D. 276,160 10/1984 Tuggle et al. D15/1

OTHER PUBLICATIONS

Implement & Tractor, 2-21-79, p. 37, Kawasaki Engine.

Implement & Tractor, 3-21-79, p. 11, Kawasaki Engine.

Primary Examiner—Wallace R. Burke
Assistant Examiner—Lynn Wilder
Attorney, Agent, or Firm—Sughrue, Mion, Zinn, Macpeak & Seas

[57] CLAIM

The ornamental design for an internal combustion engine, as shown.

DESCRIPTION

FIG. 1 is a front, top and left side perspective view of an internal combustion engine showing my new design; FIG. 2 is a left side elevational view thereof; FIG. 3 is a front elevational view thereof; FIG. 4 is a rear elevational view thereof; FIG. 5 is a top plan view thereof; FIG. 6 is a right side elevational view thereof; and FIG. 7 is a bottom plan view thereof.

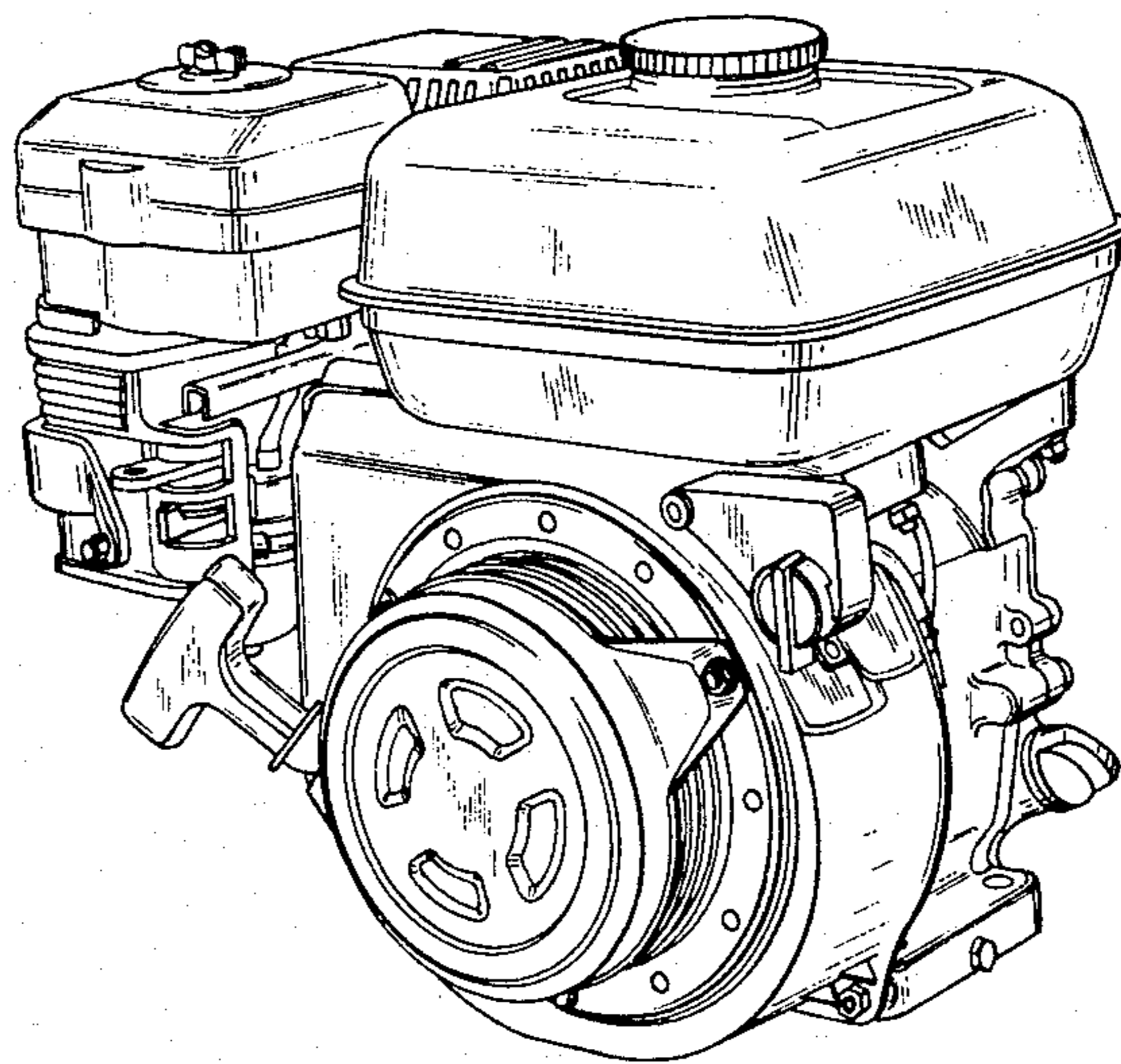

FIG. 1

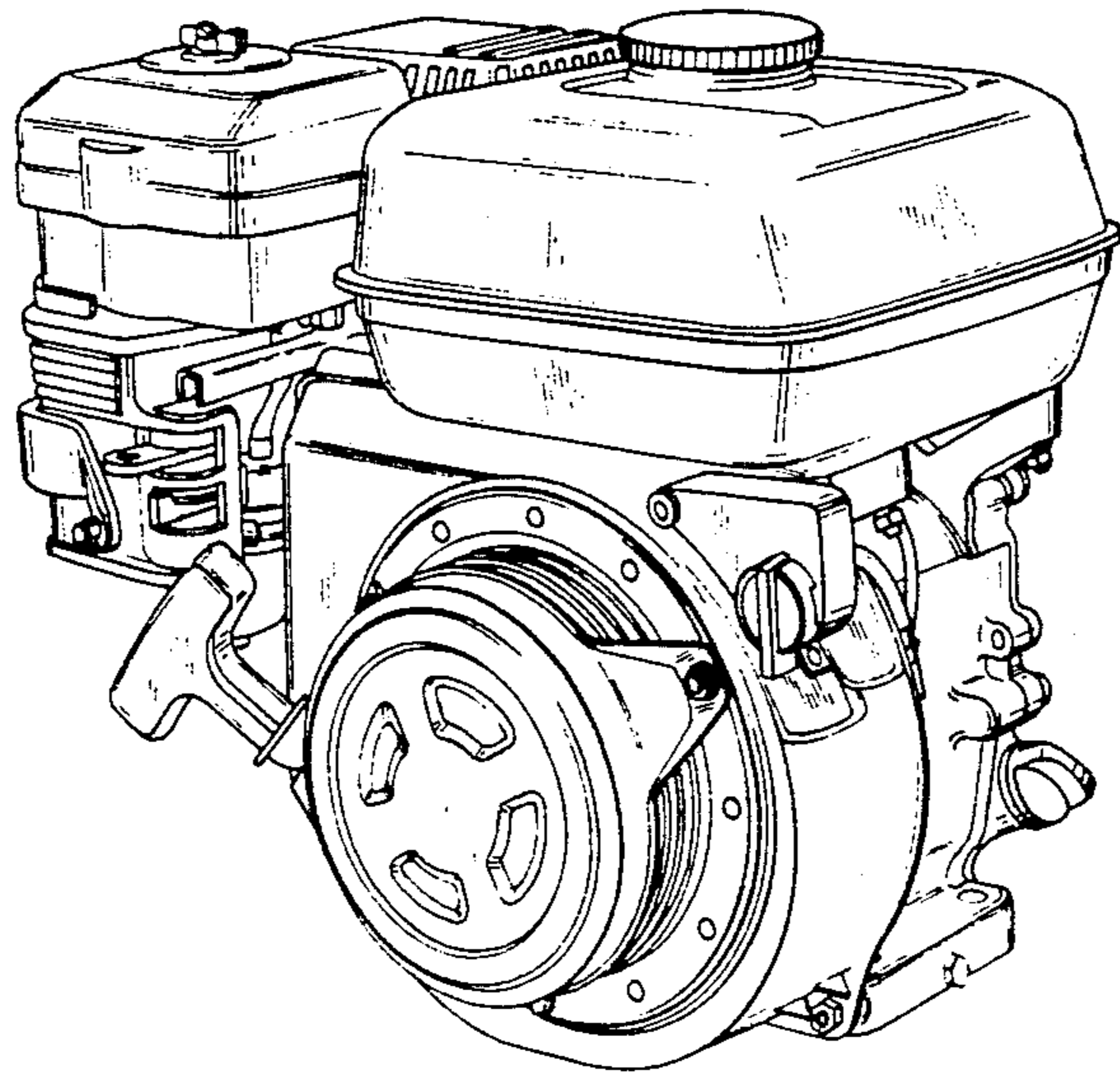

FIG. 2

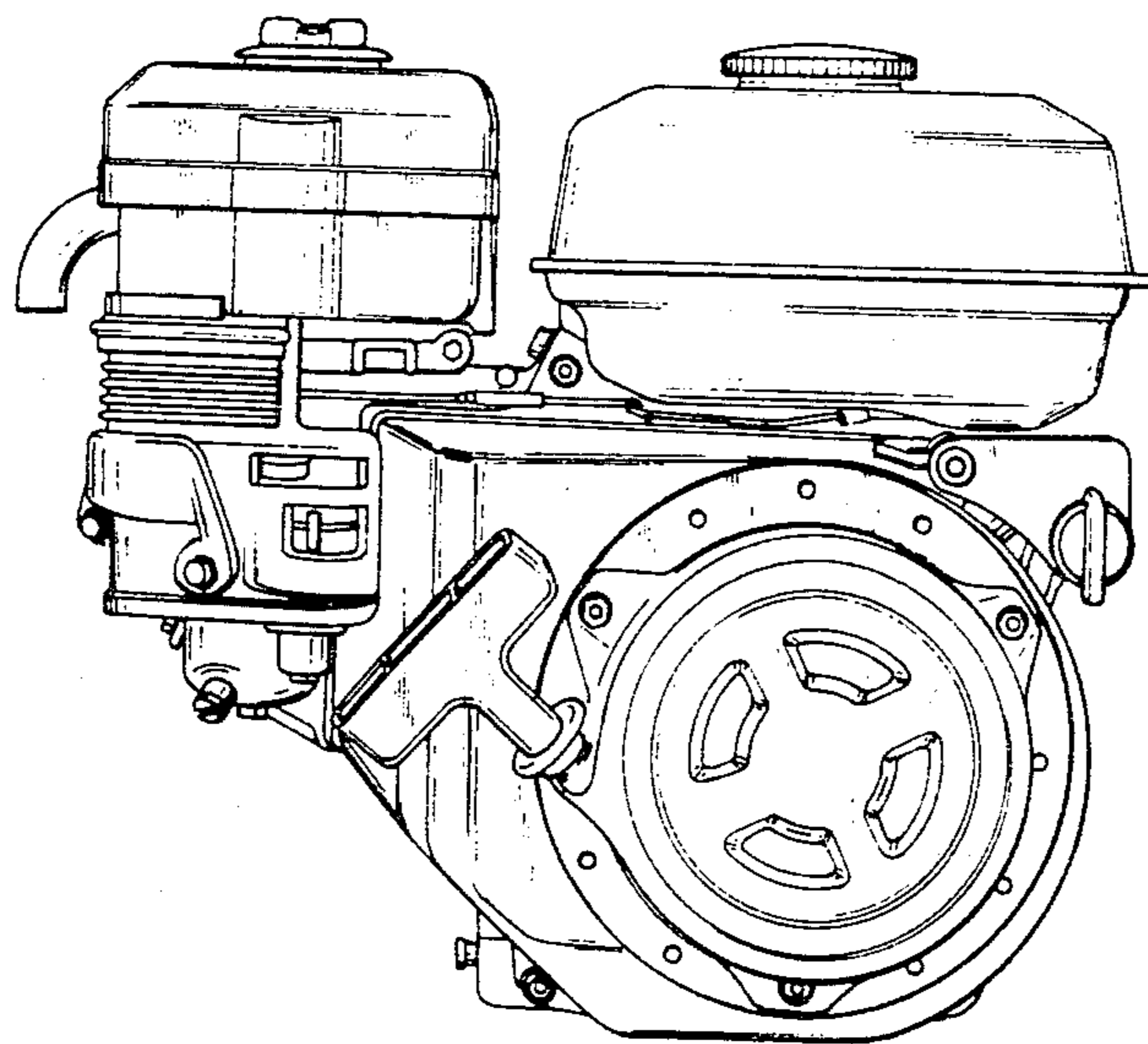

FIG. 3

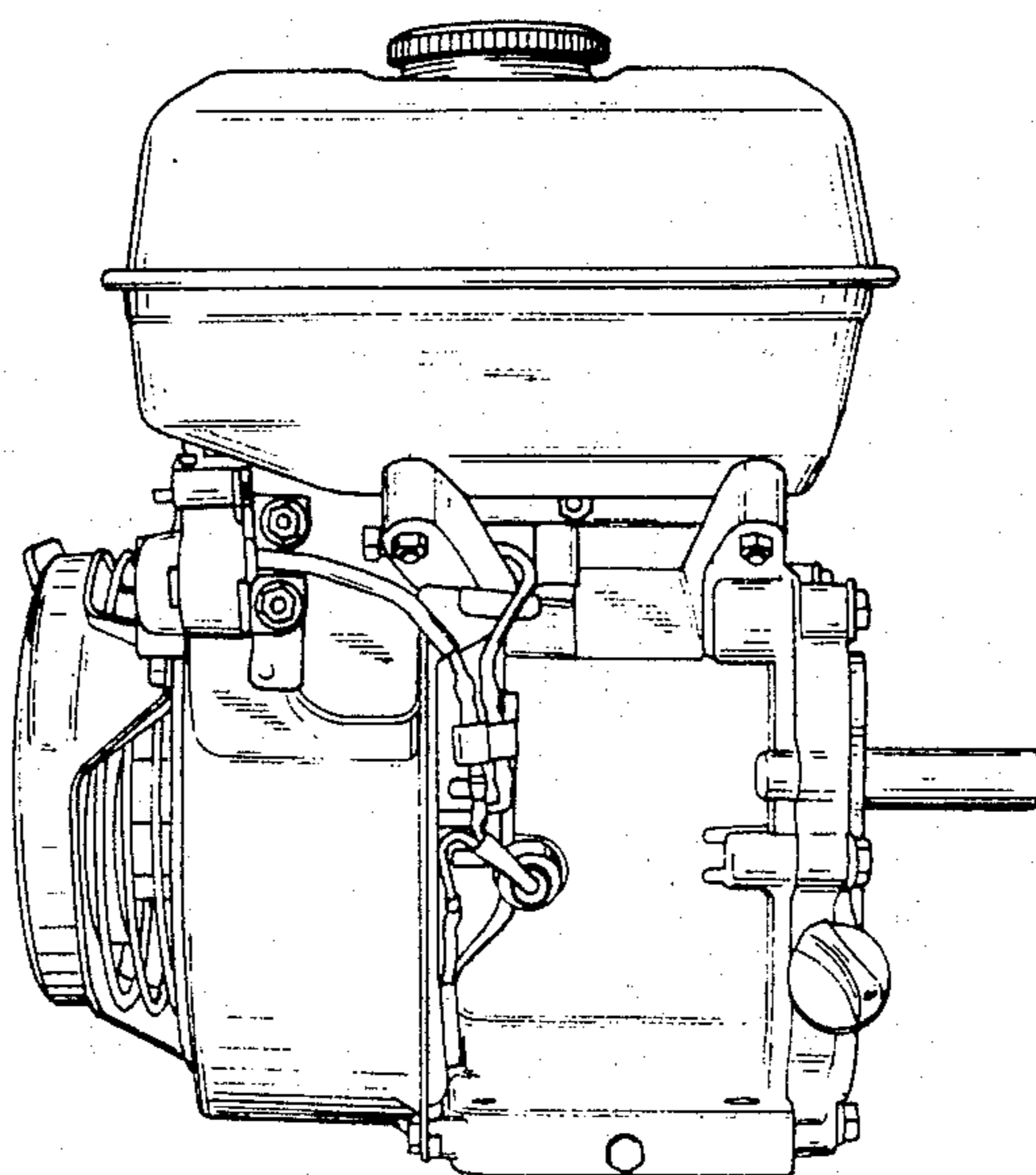

FIG. 4

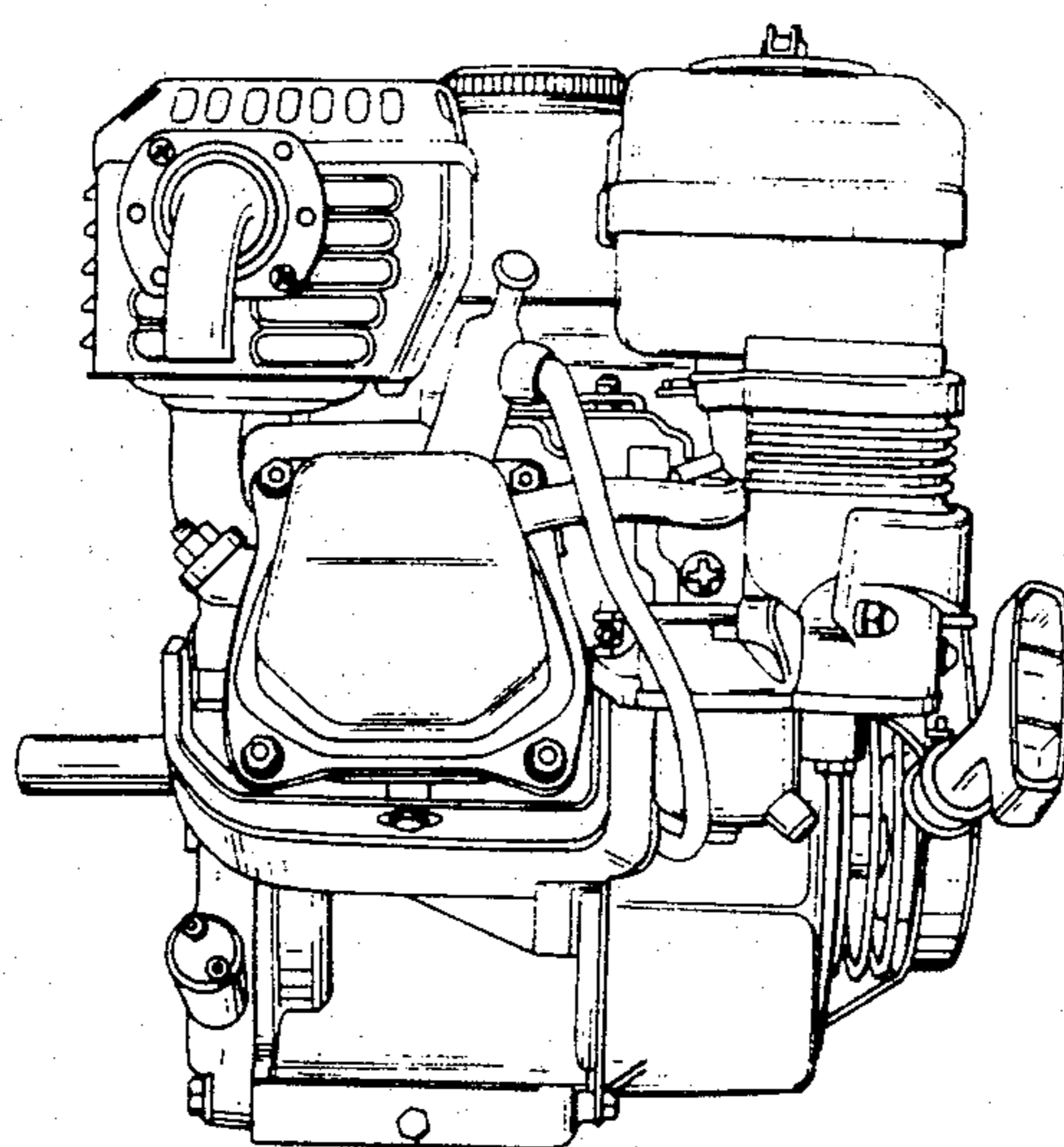

FIG. 5

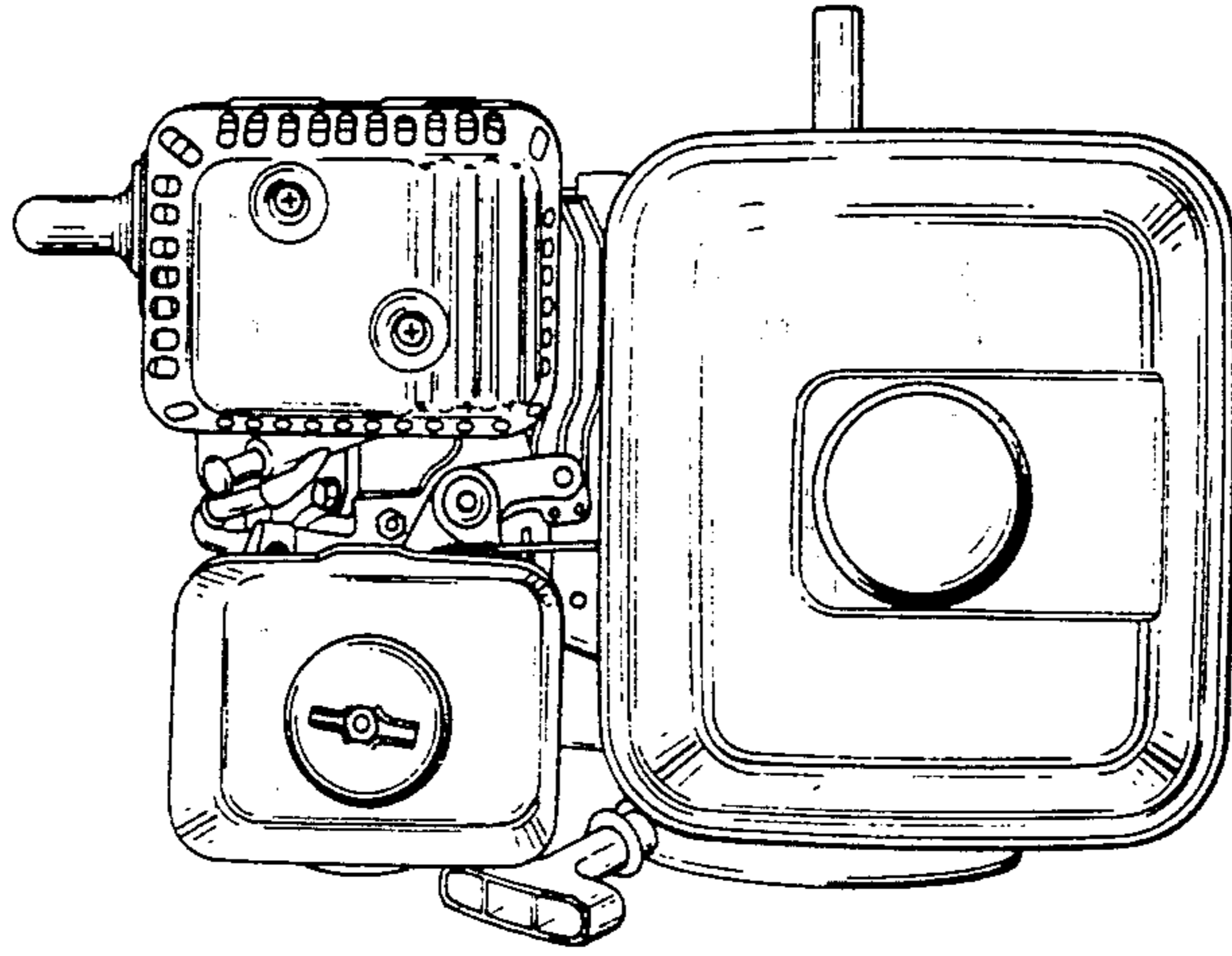

FIG. 6

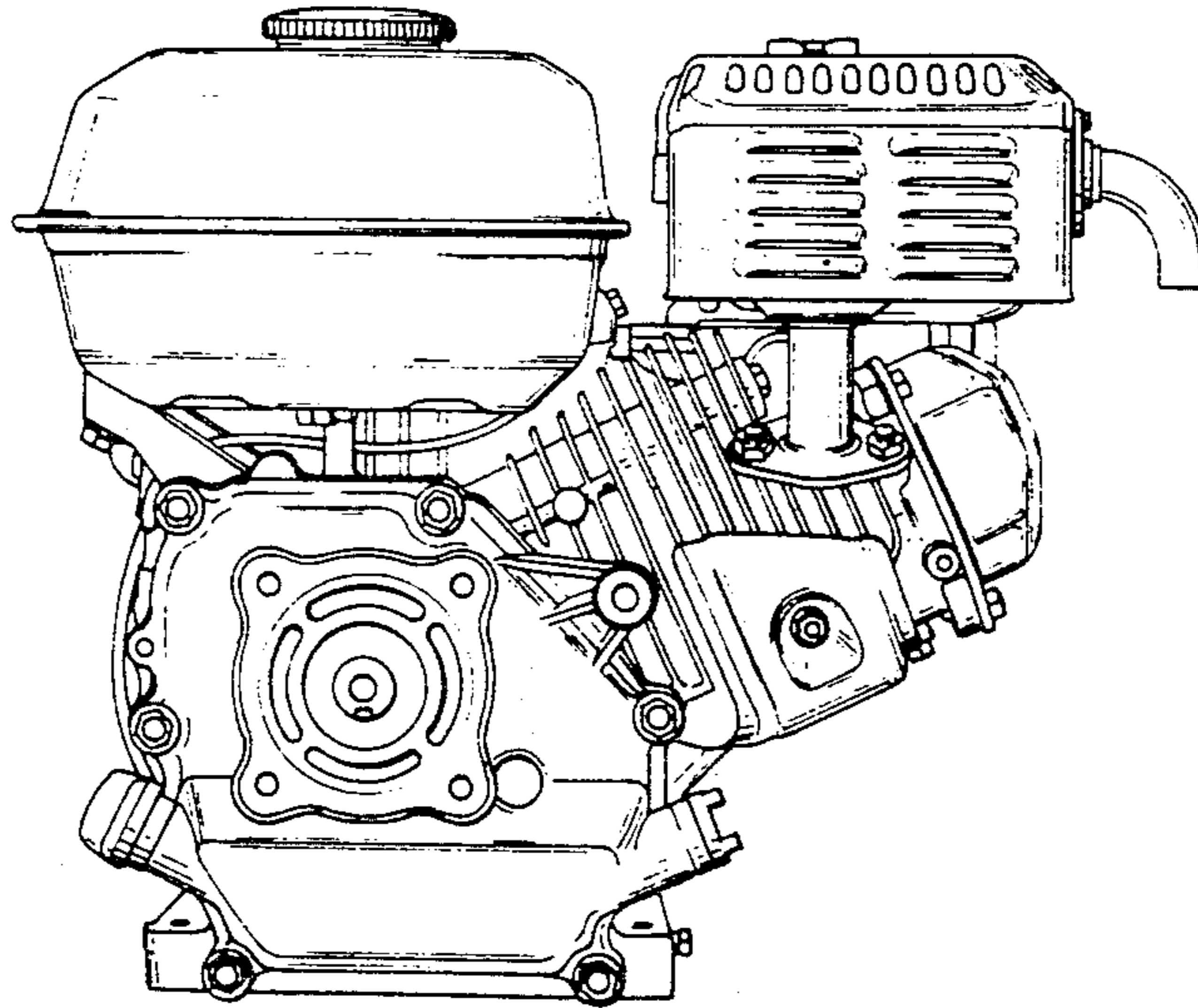

FIG. 7

